



31M04SW0076 29 BRIGGS

010

Diamond Drilling

Township of BRIGGS

Report N^o 29

Work performed by: Titanic Construction

Claim N ^o	Hole N ^o	Footage	Date	Note	
T 51528	1	350.0'	July/62		
	2	352.0'	July/62		
	5	300.0'	July/62		
	6	305.0'	July/62		
	7	556.0'	July/62		
	T 51523	3	352.0'	July/62	
		4	355.0'	July/62	
		<u>7ddh</u>	<u>2570'</u>		

Notes:

DIAMOND DRILL RECORD

Hole No. **1** Sheet No. **1**
 Property **Titanic**
 Drilled by **Smith & Caswell**
 Date Begun **July 7, 1962**
 Date Finished **July 14, 1962**
 Contractor's Footage

Co-ordinates Collar
 Lat. Dept.
 Elev. Collar
 Bearing **S. 40° E.**
 Angle **-15°**
 Working Place **Claim T. 51528**

Total Depth **350.0'**
 Ft. of Core Recovered
 % Recovery
 Size Bit Used
 Size Core **AST.**

Depth Feet	Formation	Sample No.	Width	Ozs. Au.	Ozs. Ag.	% Cu.	% Ni.	% Zn.
0.0 55.0'	<u>CASING:</u> Boulder Overburden							
55.0 77.0	<u>ANDALUSITE</u> Brecciated with 20% quartz vein material.							
	55.0' - 61.0' pyritized with blobs of pyrite and disseminated grains. <u>SAMPLE</u>	1	6.5'	Tr.				
77.0' 102.0	<u>ANDALUSITE & RHYOLITE</u> Sheared 45° to core with some pyritized rhyolite starting at 92.0'							
102.0 140.0	<u>RHYOLITE.</u> Fair pyritization with numerous small quartz veins and shearing 45° to core.							
	109.0 - 110.5 graphite							
	112.0 - 112.6 "							
	118.5 - 121.0 "							
	<u>SAMPLE</u> 101.5-105.0	2	3.5'	Tr.				
	118.5-121.5	3	3.0'	Tr.				
140.0 150.0'	<u>RHYOLITE</u> sheared with two massive granite zones each 12" long. All well pyritized							
	<u>SAMPLE</u> 140.0-145.0'	4	5.0'	.005				
	<u>SAMPLE</u> 145.0-150.0	5	5.0'	.005				
150.0 175.0'	<u>IRON FORMATION</u> Alternating chert & magnetite bands - 15% - 20% magnetite 30° to core.							
	Heavily pyritized							
	5% - 10% pyrite							
	<u>SAMPLE</u> 150.0 - 155.0	6	5.0'	Tr.				
	<u>SAMPLE</u> 155.0 - 160.0	7	5.0'	.005				

Log By.....
for E. L. MacVEIGH

DIAMOND DRILL RECORD

Ho. **1** Sheet No. **2** Co-ordinates Collar
 Property **TRONIC** Lat. Dept.
 Drilled by Elev. Collar
 Date Begun Bearing
 Date Finished Angle
 Contractor's Footage Working Place **Claim T. 51528** Total Depth
 Ft. of Core Recovered
 % Recovery
 Size Bit Used
 Size Core

Depth Feet	Formation	Sample No.	Width	Ozs. Au.	Ozs. Ag.	% Cu.	% Ni.	% Zn.
150.0	Cont'd.	SAMPLE 160.0-165.0	8	5.0	Tr.			
175.0		SAMPLE 165.0-170.0	9	5.0	.005			
		SAMPLE 170.0-175.0	10	5.0	Tr.			
175.0	<u>IRON FORMATION</u> 10% - 15%							
190.0'	Magnetite. Mostly chert with thin bands of iron & massive graphite from 183.0-184.5'.							
	Very heavy pyrite in sections up to 12" long (Massive)							
	Highly brecciated & recemented.							
	SAMPLE 175.0-180.0	11	5.0'	Tr.				
	SAMPLE 180.0 - 185.0	12	5.0'	.01				
	SAMPLE 185.0-190.0	13	5.0'	Tr.				
190.0	<u>IRON FORMATION</u> 30° - 35°							
203.0	Magnetite with pyrite in bedding. Less than 2% pyrite.							
203.0	<u>IRON FORMATION</u> largely chert.							
240.0'	Iron 10% - 15%							
	Magnetite in disseminated grains							
	220.0 - 222.0' chlorite section, may be small altered dyke	SAMPLE 227.5-230.0'	14	2.5'	Tr.			
		SAMPLE 235.0-240.0	15	5.0	Tr.			
240.0	<u>GREENSTONE WITH BANDS of</u>							
287.0'	<u>DISSEMINATED MAGNETITE</u>							
	Magnetite in sections up to 3' long in sheared greenstone.							
	Some disseminated pyrite 5% magnetite							

Log By. _____
for E. L. MacVEIGH

DIAMOND DRILL RECORD

Hole No. **2** Sheet No. **1** Co-ordinates Collar
 Property **MINARIC** Lat. Dept.
 Drilled by **W. H. GIBSON** Elev. Collar
 Date Begun **July 11, 1962** Bearing **N. 40° W.**
 Date Finished **July 17, 1962** Angle **-45°**
 Contractor's Footage Working Place **Claim T. 51528**

Total Depth **352.0'**
 Ft. of Core Recovered
 % Recovery
 Size Bit Used
 Size Core **ACT.**

Depth Feet	Formation	Sample No.	Width	Ozs. Au.	Ozs. Ag.	% Cu.	% Ni.	% Zn.
0.0	<u>CASING:</u>							
45.0								
45.0	<u>VEIN</u> - Sheared and brecciated							
47.5	greenstone with quartz and carbonate stringers and some pyrite. SAMPLE 45.0 - 47.5'	21	2.5'	Tr.				
47.5	<u>GREENSTONE</u> , Gray well sheared rock with banding							
75.0	45° to core. Numerous narrow quartz and calcite veins, mostly barren. Some pyritized sections. SAMPLE 73.0 - 73.8'	22	0.8'	Tr.				
75.0	<u>GREENSTONE</u> , sheared and silicified with numerous quartz veins, mostly barren. Few short pyritized sections.							
120.0	<u>GREENSTONE</u> dark green andesite, light shearing, many quartz and carbonate veins. Some short pyritized sections. SAMPLE 126.0 - 127.0'	23	1.0'	Tr.				
177.0	<u>GREENSTONE</u> . Massive andesite with many quartz and carbonate veins. Some pyritization.							
270.0	<u>GREENSTONE</u> - sheared with barren quartz stringers.							
277.5	<u>VEIN MATERIAL</u> - sheared greenstone and quartz and carbonate. Shearing 20° to core. well pyritized in short sections with disseminated pyrite between.							
277.5								
294.0								

Log By.....
for E. L. MacVEIGH

DIAMOND DRILL RECORD

Hole No. **2** Sheet No. **2**
 Property **TITANIC**
 Drilled by
 Date Begun
 Date Finished
 Contractor's Footage

Co-ordinates Collar
 Lat. Dept.
 Elev. Collar
 Bearing
 Angle
 Working Place **Claim T. 51 S 2 8**

Total Depth
 Ft. of Core Recovered
 % Recovery
 Size Bit Used
 Size Core

Depth Feet	Formation	Sample No.	Width	Ozs. Au.	Ozs. Ag.	% Cu.	% Ni.	% Zn.
277.5	CONT'D.							
294.0'	SAMPLES 277.5 - 280.0'	24	2.5'	Tr.				
	280.0 - 285.0	25	5.0'	.005				
	285.0 - 290.0	26	5.0'	Tr.				
	290.0 - 294.0	27	4.0'	Nil.				
294.0	<u>DESCRIPTIONS</u> - Lightly sheared							
351.5	with numerous quartz-carbonate vein sections, mostly 90° to core. Some lightly pyritized.							
	<u>HOLE END - 372.0'</u>							
	<u>NOTE:</u> This hole drilled north from near collar of No. 1 Hole to cross section area for gold bearing vein material. Section from 277.5 to 294.0' looked interesting. Widespread shearing is localized along north side of iron.							
	E. L. MacVeigh.							

Log By. *E. L. MacVeigh*
 for E. L. MacVEIGH
 BA, 115

DIAMOND DRILL RECORD

Hole No. 3 Sheet No. 1 Co-ordinates Collar Total Depth 352.0'
 Property ITANIC Dept.
 Drilled by W. J.
 Date Begun July 15, 1932
 Date Finished July 20, 1932
 Contractor's Footage Working Place ... 51523
 Lat. Collar
 Elev. Collar
 Bearing 50°
 Angle -45°
 Ft. of Core Recovered
 % Recovery
 Size Bit Used
 Size Core 1 1/2"

Depth Feet	Formation	Sample No.	Width	Ozs. Au.	Ozs. Ag.	% Cu.	% Ni.	% Zn.
0.0	<u>... gray and dark</u> <u>... and sheared at 45° to</u> <u>... mostly pyritized</u> <u>throughout. ... 45° to</u> <u>... numerous small quartz</u> <u>veins, ...</u> <u>7 1/2" ... pyrite, barren with</u> <u>5" light veins in wall rock.</u>							
75.0'								
75.0	<u>... massive rock</u> <u>with several bleached sections,</u> <u>with ... irregular</u> <u>barren quartz veins.</u>							
137.5								
137.5	<u>... with narrow</u> <u>3" - 6" red ... por-</u> <u>phyre host, low ... quartz</u> <u>strings.</u>							
150.0								
150.0								
150.0	<u>... sheared at 45° to core with</u> <u>small irregular quartz vein.</u> <u>Vary little pyrite.</u> <u>250' - ... of ... shear.</u>							
250.0								
250.0								
250.0	<u>... dark green</u> <u>rock, ... sheared with</u> <u>irregular quartz veins.</u> <u>... sections.</u>							
302.0								
302.0								
302.0	<u>... with</u> <u>several ... sections</u> <u>280.0 - 282.0 - 1" quartz</u> <u>30" ... - pyrite</u>		4"					
320.0	<u>... but core</u> <u>sheared. ... last ...</u> <u>last 20' of core ...</u>							

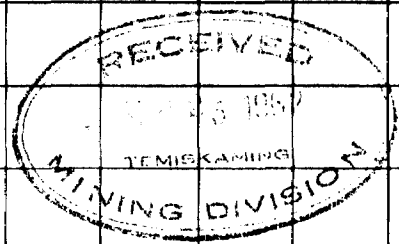

Log By E. L. MacVeigh
 for E. L. MacVEIGH
 B.A., M.S.

DIAMOND DRILL RECORD

Hole No. **4** Sheet No. **1** Co-ordinates Collar Lat. **38° 30'** Long. **110° N.W.** Total Depth **355'**
 Property **Titanic Construct.** Lat. **38° 30'** Dept. **110° N.W.** Ft. of Core Recovered **355'**
 Drilled by **Smith & Connell** Elev. Collar **40'** % Recovery **100%**
 Date Begun **July 21, 1962** Bearing **45°** Size Bit Used **4.75"**
 Date Finished **July 21, 1962** Angle **45°** Size Core **4.75"**
 Contractor's Footage Working Place **Claim 31513**

Depth Feet	Formation	Sample No.	Width	Ozs. Au.	Ozs. Ag.	% Cu.	% Ni.	% Zn.
0.0 5.0	<u>CASING</u>							
5.0 125.0'	<u>PHYLLITE & QUARTZITE BEDS</u> Light colored siliceous rock showing long sections of fine brownish bands of which (Feldspar?) fragments in some ground mass. Many quartz veins - 0° to 30° to core. Some pyrite usually with quartz - pyrite in cubes and aggregates - 36.3 - 36.4' - pyritized phyllite <u>SAMPLE</u>	35	1.0'	Tr.				
	64.3 - 64.4' quartz vein material in phyllite <u>SAMPLE</u> to core.	36	5.1'	Tr.				
125.0	Sheared - 45° to core <u>AMPHIBOLITE (SILICIFIED AMPHIBOLITE?)</u>							
213.0	Coarse grained, green carbonated rock with numerous small quartz carbonate veins, mostly - 30° to core. Some well pyritized <u>AMPHIBOLITE</u> sheared - 45° to core							
	193.0 - 204.0 quartz-carbonate vein material in sheared amphibolite with pyrite <u>SAMPLE</u>	37	1.00'	Tr.				
	153.0 - 154.5' - same - <u>SAMPLE</u>	38	1.00'	Tr.				
	103.0 - 104.0' - same - <u>SAMPLE</u>	39	1.00'	Tr.				
223.0 244.0	<u>GREEN SLATE</u> Dark green soft rock with hornblende. Fractured and rusty. Contact 30° to core.							
274.0 275.0	<u>AMPHIBOLITE</u> as above							

Log By *E. L. MacVeigh*
 for E. L. MacVEIGH
 B.A., U.S.

DIAMOND DRILL RECORD

Hole No. **5** Sheet No. **1**
 Property **Smith & Causell**
 Drilled by **Smith & Causell**
 Date Begun **July 25, 1962**
 Date Finished **July 27, 1962**
 Contractor's Footage

Co-ordinates Collar
 Lat. Dept.
 Elev. Collar
 Bearing **S. 45° W.**
 Angle **-45°**
 Working Place **Clinic. 51528**

Total Depth **300.0'**
 Ft. of Core Recovered
 % Recovery
 Size Bit Used
 Size Core **A.A.T.**

Depth Feet	Formation	Sample No.	Width	Ozs. Au.	Ozs. Ag	% Cu.	% Ni.	% Zn.
0.0	CASING: 3' of decomposed				AU.			
17.5'	sulphides reported at collar							
17.5	BANDED IRON FORMATION							
25.0'	(10% to 15% Magnetite)							
	and GREENSTONE, narrow bands of magnetite and some hematite							
	to 60' to core. Massive pyrite at start of hole							
	SAMPLE 17.5' - 20.0'	16	2.5'		0.005			
	" 20.0 - 25.0'	17	5.0'		Tr.			
	10% - 15% magnetite							
25.0	BANDED & DISSEMINATED (10% magnetite) MAGNETITE and GREEN-							
50.0	STONE with narrow bands and disseminated pyrite. Few bands of hematite up to 1' wide. Banding to 60' to core. (10% magnetite) 49' - 50' - lost core 53' - 54.6' - lost core 10% magnetite.							
50.0	GREENSTONE with disseminated magnetite and pyrite							
75.0	10% Magnetite							
	SAMPLE 70.0 - 75.0'	18	5.0'		Tr.			
75.0	IRON OXIDATION (15% magnetite)							
107.0	1/2" - 2" bands of magnetite in chert. Approx. 15% magnetite. 80.0-82.5' - 75% pyrite							
	SAMPLE 80.0 - 82.5'	19	2.5'		0.005			
107.0	GREENSTONE. Sheared andesite or tuff showing some flow structure							
233.8	Shearing 45° to core. Abundant quartz and calcite							

Log By *Shanley*
 for E. L. MacVEIGH
B.D., M.S.

DIAMOND DRILL RECORD

Hole No. **5** Sheet No. **2** Co-ordinates Collar
 Property **SHAWK** Lat. Dept.
 Drilled by Elev. Collar
 Date Begun Bearing
 Date Finished Angle
 Contractor's Footage Working Place **C. 1111-2.51528** Total Depth
 Ft. of Core Recovered
 % Recovery
 Size Bit Used
 Size Core

Depth Feet	Formation	Sample No.	Width	Ozs. Au.	Ozs. Ag.	% Cu.	% Ni.	% Zn.
107.0	Coal.							
233.8	stringers some bearing light sulphide mineralization.							
	Interval 114.0' - 144.5	20	0.5'	NIL	NIL			
233.8	V.L. quartz and breccia with fair pyritization							
234.8	Interval 233.0' - 234.8							
234.8	IRONSTONE, sheared argillite with quartz and carbonate veinlets parallel to shear-							
300.	mostly barren. Some acylatoidal sections.							
	Interval 234.8' - 300.0'							
	NOTE: This hole collapsed in iron formation.							
	NOTE: Iron formation from 17.5' to 107' runs approx. 10% arsenite. Considerable pyrite present throughout. Much shearing and vein matter throughout with some associated pyrite.							
	E. L. MacVeigh.							

Log By
for E. L. MacVEIGH

DIAMOND DRILL RECORD

Hole No. 26 Sheet No. 1.
 Drilled by Titania Contract.
 Date Begun July 28, 1962
 Date Finished July 28, 1962
 Contractor's Footage

Co-ordinates Collar
 Lat. 76° 12' 25" Dept. 103° NW
 Elev. Collar 25'
 Bearing 45° 35'
 Angle 45°
 Working Place 1123. 51528

Total Depth 305.0'
 Ft. of Core Recovered
 % Recovery
 Size Bit Used
 Size Core

Depth Feet	Formation	Sample No.	Width	Ozs. Au.	Ozs. Ag.	% Cu.	% Ni.	% Zn.
0.0 20.0	<u>CL. 136:</u>							
20.0 69.0	<u>ADYALITE (or tuff) Light coloured, dense fractured rock sheared 60° to core with numerous quartz-calcite veins mostly 60%. Low short lentic sections. Whole fairly well pyritized</u>							
69.0 110.0	<u>30.0-35.0 SAMPLE</u> <u>IRON ORE (136):</u> <u>banded chert and greenstone with 30% pyrite content. Magnetite less than 5%</u>	<u>32</u>		<u>Nil</u>				
110.0 147.0	<u>IRON ORE (136):</u> <u>Chert and quartz with pyrite and magnetite - 10%. Some bands of greenstone 140.0 - 145.0 quartz with abundant pyrite</u>	<u>33</u>		<u>Nil</u>				
147.0 167.0	<u>GREENSTONE andesite with disseminated magnetite - less than 5%. Sheared 45° to core.</u>							
167.0 305.0	<u>ADYALITE or andesite sheared 45° to core with many small green quartz-calcite stringers.</u> <u>187.5 - 200.0 quartz and sheared greenstone - well pyritized.</u>	<u>34</u>		<u>Tr.</u>				
	<u>HOLES TO 305.0'</u>							

Log By MacKeef
 for E. L. MacVEIGH
B.P., N.S.

DIAMOND DRILL RECORD

Hole No. **7** Sheet No. **1** Co-ordinates Collar Total Depth **556'**
 Pro. **Titanic** Lat. **08' NW** Dept. **1310' SW** Ft. of Core Recovered
 Drilled by **Smith & Cansell** Elev. Collar **4'** % Recovery
 Date Begun **July 13, 1962** Bearing **S. 30° E.** Size Bit Used
 Date Finished **1249 1262** Angle **-45°** Size Core
 Contractor's Footage Working Place **Claim T. 51528** **AXT.**

Depth Feet	Formation	Sample No.	Width	Ozs. Au.	Ozs. Ag.	% Cu.	% Ni.	% Zn.
0.0 26.0'	<u>CASTLE</u>							
26.0 104.0	<u>GREENSTONE</u> Keewatin andesite. Fairly coarse grained sheared rock with dioritic texture. Could be diorite dyke. Numerous small quartz-calcite veins at various angles. 40.2' - 43.5' - Vein material quartz and sheared greenstone with considerable pyrite							
	<u>SAMPLE</u>	28	3.3'	Nil				
	47.0 - 49.0' - Vein material quartz and sheared greenstone with pyrite							
	<u>SAMPLE</u>	29	1.0'	Nil				
104.0' 145.0	<u>GREENSTONE</u> Keewatin andesite with numerous quartz calcite veins as above. Finer grained rock than 26' to 104'							
145.0 300.0	<u>GREENSTONE (?)</u> with dioritic texture, as above with sheared sections and small quartz-carbonate veinlets at various angles. Some with pyrite. 278.5 - 279.3' quartz and sheared gr. with pyrite							
	<u>SAMPLE</u>	30	0.8'	Nil				
300.0' 366.0	<u>RYOLITE</u> or Tuff, siliceous Fine-grained light coloured rock with some banded sections. sheared at 45° to core.							

Log By
for E. L. MacVEIGH

DIAMOND DRILL RECORD

Hole No. **7** Sheet No. **2** Co-ordinates Collar
 Property **Titanic** Lat. Dept.
 Drilled by **Smith & Caswell** Elev. Collar
 Date Begun Bearing
 Date Finished Angle **-45°**
 Contractor's Footage Working Place **Claim 7. 51528**

Total Depth
 Ft. of Core Recovered
 % Recovery
 Size Bit Used
 Size Core

Depth Feet	Formation	Sample No.	Width	Ozs. Au.	Ozs. Ag.	% Cu.	% Ni.	% Zn.
300.0	<u>CONT'D.</u>							
366.0'	Lightly pyritized. @ 313' - 314' - lost core @ 324' - 325' - lost core.							
366.0	<u>RHYOLITE</u> or tuff as above							
376.5	with graphite sections.							
376.5	<u>PYRITE</u> 75%							
395.8'	massive pyrite mineralization with chert and one graphite section. Small remnant patches of magnetite. @ 390.0 - 395.0' practically massive pyrite. (Specimen from 390.8 - 391.6 given to Mr. Wilton)							
	SAMPLE	31	5.0'	0.005				
395.8	<u>CHERT</u> with bands and streaks of pyrite (7%)							
403.0	<u>RHYOLITE</u> or tuff as above							
425.0	<u>BANDED IRON FORMATION</u> (Less than 10% iron)							
425.0	Thin bands of magnetite in tuff 45° to core.							
453.0	Massive pyrite in chert. Disseminated magnetite in greenstone. @ 438' - 443' - few bands of red hematite. Banding 45° to core.							
453.0	<u>GREENSTONE</u> with disseminated magnetite. Sheared @ 45° to core.							
480.0	Less than 5% iron.							
480.0	<u>IRON FORMATION</u>							
487.5'	disseminated magnetite in greenstone							

Log By.....
for E. L. MacVEIGH

RECEIVED
 SEP 23 1962
 TEMAGAMI
 MINING DIVISION

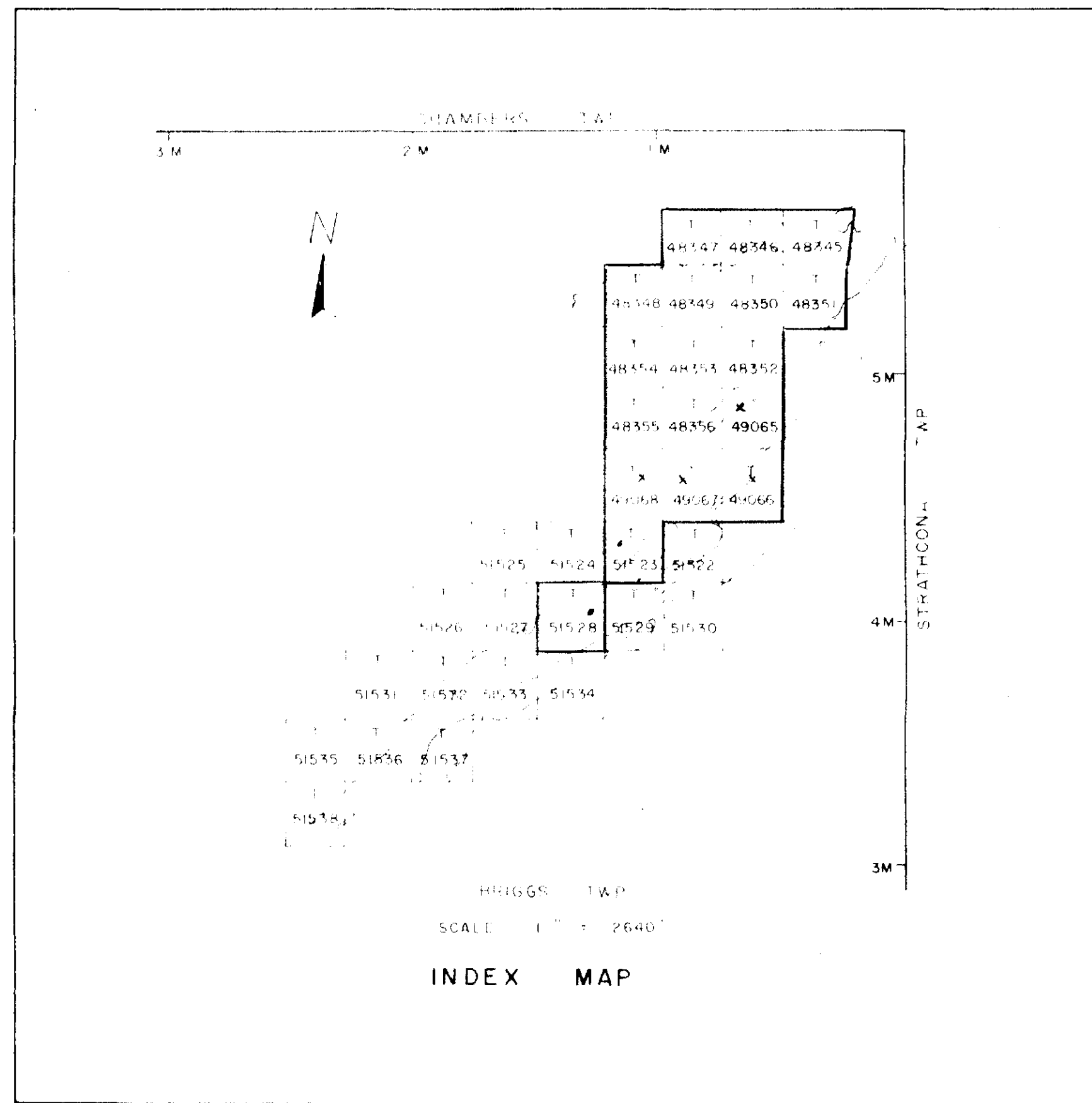
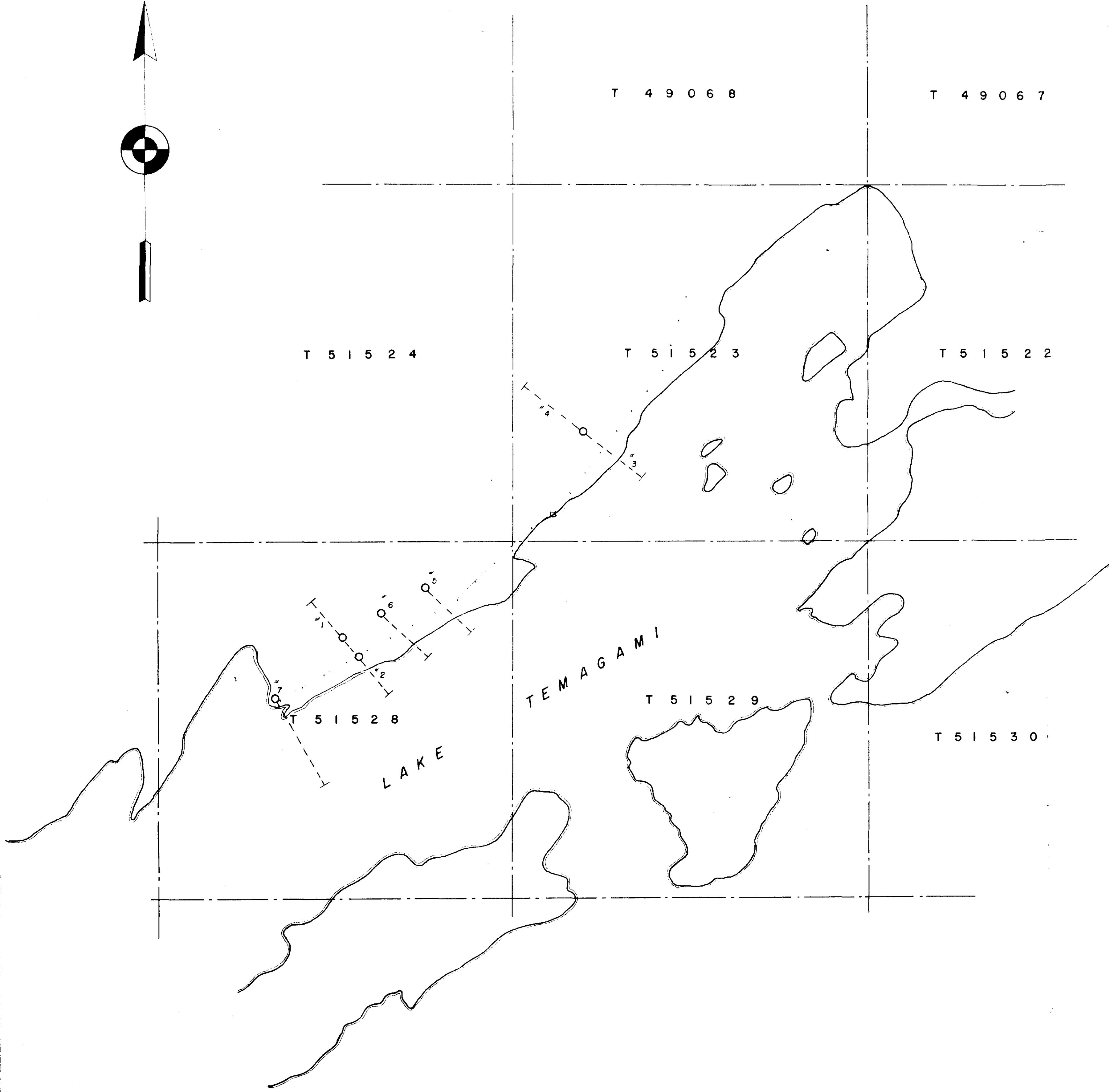

O-----X Diamond Drill Hole
 X-----X Chainage Picket

TITANIC CONSTRUCTION CO. LTD.

DIAMOND DRILL HOLE LOCATIONS
 BRIGGS TWP, TEMAGAMI AREA, ONT.

