



31M04SW0094 37 STRATHY

010

Diamond Drilling

Township of STRATHY

Report N<sup>o</sup> 37

Work performed by: Herbert Niemetz

Claim N <sup>o</sup>	Hole N <sup>o</sup>	Footage	Date	Note
S 398978	A-1	160.0'	Sept/76	(1)
	B-1	31.0'	Sept/76	(1)
	B-2	30.0'	Sept/76	(1)
	C-1	35.0'	Sept/76	(1)

Notes:

(1) #84-76

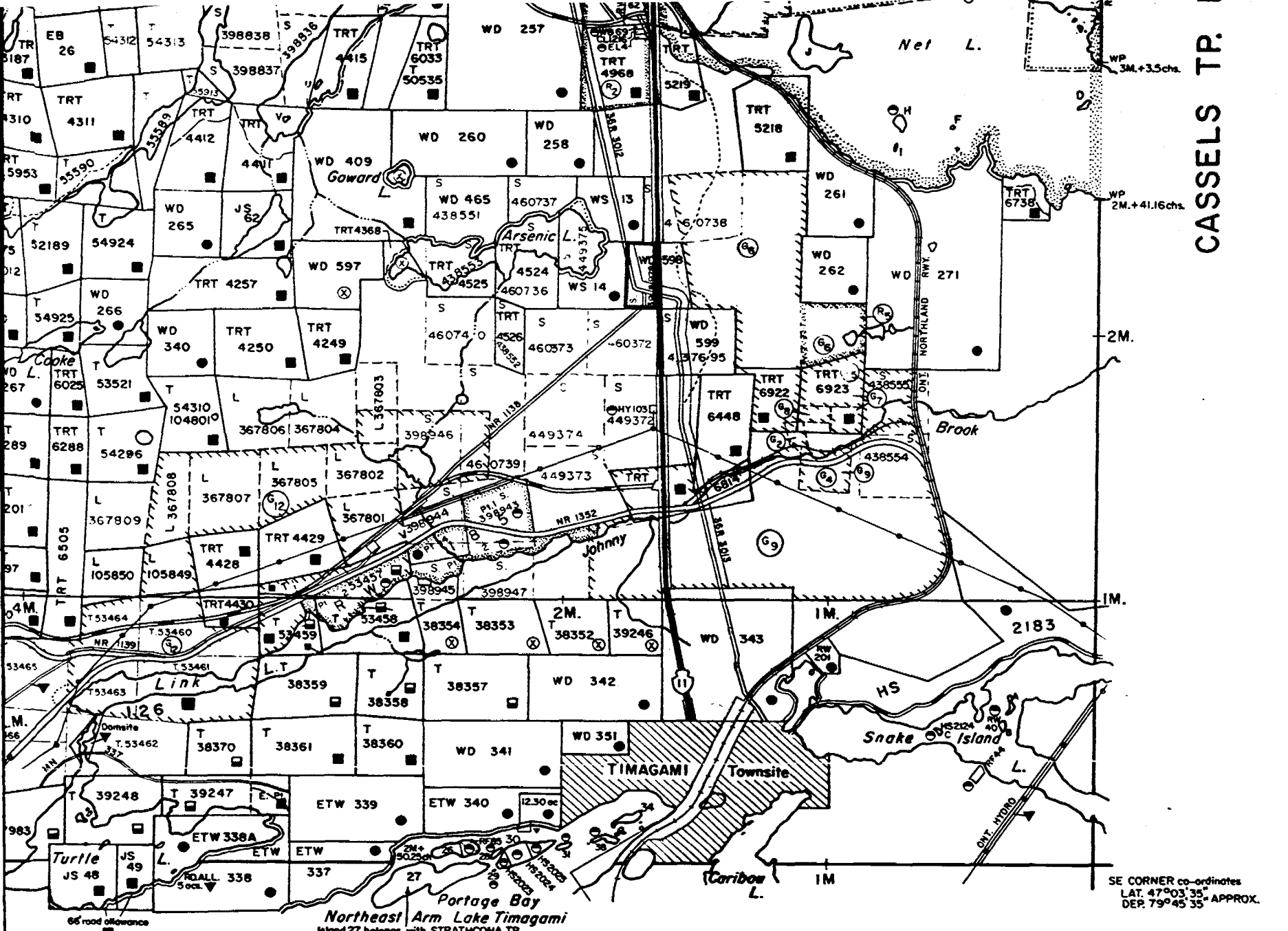

CASSELS TR.

ORDER-IN-COUNCIL  
 RESERVATION  
 CANCELLED  
 SAND & GRAVEL

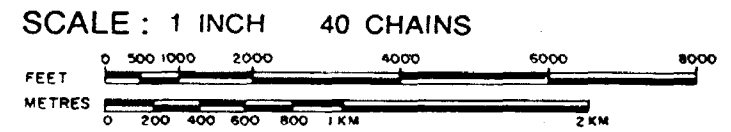

ACRES      HECTARES

40	16
----	----

#84-76  
 HERBERT NIEMETZ

TOWNSHIP

# STRATHY

DISTRICT

NIPISSING

MINING DIVISION

SUDBURY



Ministry of Natural Resources

Ontario      Surveys and Mapping Branch

Date      MARCH 1974

Plan No. ....

Whitney Block  
 Queen's Park, Toronto

## M.596

STRATHCONA TP. M.595

SE CORNER co-ordinates  
 LAT. 47°03'35" APPROX.  
 DEP. 79°45'35"

Portage Bay  
 Island 27 belongs with STRATHCONA TP.

66 road allowance

WS  
13

Please find enclosed  
all core logs, & 184 1/4  
days work to be recorded  
on claim S. 398978  
also Miner's Lic.  
C. 24368.

Highway 11 North

660 FT East to Highway 11

Claim No  
S 398978

D.D.H # C-1 is located  
660 FT E. & 250 FT South  
of No 4 Post  
Depth 35 FT @ 55° Minus  
10° West of North or the Asimuth

D.D.H # B-1 is located  
660 FT E. & 525 FT South  
of No 4 Post  
Depth 31 FT @ 55° Minus  
70° East of the Asimuth

D.D.H # B-2 is located  
660 FT E. & 555 FT South  
of No 4 Post  
Depth 36 FT @ 55° Minus  
70° East of the Asimuth.

WS  
14

500 FT South

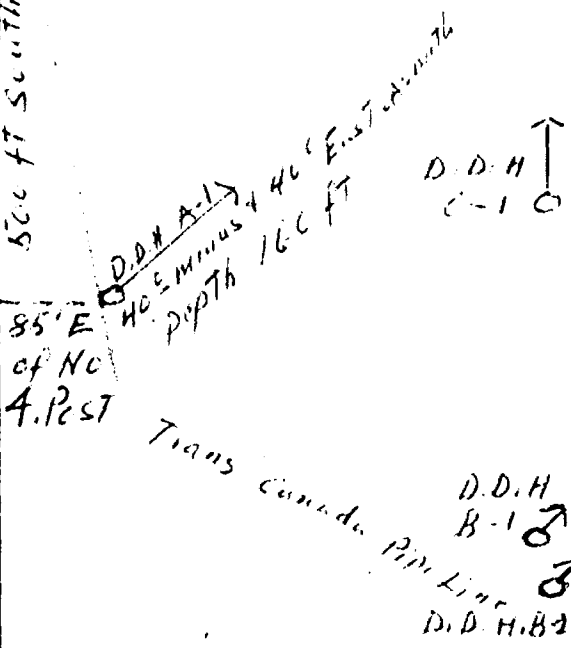

North

13

All core is EXT dis  
15/16 of an inch in

Trust of Statby  
Dist of Mining  
Subby Mining Division

Diameter

Hole No.	Depth	Diameter
D.D.H. A-1	160 FT	1 1/2"
B-1	31	1 1/2"
B-2	36	1 1/2"
C-1	35	1 1/2"
Total days work		184 1/4

Scale 220 FT = 1 inch

Robert L. Smith  
2000

Property held by Herbert Niemetz Lic C. 24368  
 Box 252 Temagami ONT

DIAMOND DRILL RECORD — ~~GODFREY'S MINING CORP.~~

Started Sept 18/76 Purpose Assesment work & Testing Hole No. A-1  
 Completed Sept 22/76 Depth 160 FT Sheet No. 2 of A.1.  
 Twp. STRATHY Claim S. 398978 Location 500's. 85'E of No 4 Post Zone \_\_\_\_\_  
 Lat. \_\_\_\_\_ Dep. \_\_\_\_\_ Az. 40° Elev. \_\_\_\_\_ Dips 40°

FOOTAGE		DESCRIPTION	SAMPLE NO.	FOOTAGE		WIDTH	NO ASSAYS 4 ET		
FROM	TO			FROM	TO		% CU	% NI	% CO
0'	2'	Casing							
2'	5'	Pale green dacitic Flows, Fractured with minor Chlomite							
5'	15'	Talc & Chlomite with minute Carbonate Stringers in dacite							
15'	20'	As above but with Approx 1% Pyrite							
20'	24'	As above but no Pyrite							
24'	30'	As above but with Approx 1% Pyrite							
30'	32'	Gauartz with Pyrite, Arseno Pyrite & minor Chalcopyrite Approx 10% mineral combined							
32'	45'	Dacite, some Chlomite & Approx 1% Pyrite.							
45'	55'	Dacite with Carbonate Stringers no mineral							
55'	60'	Chlomite, some gauartz, Pyrite Arsenopyrite, Chalcopyrite Approx 5%							
60'	65'	Chlomite, some gauartz, Pyrite, Arsenopyrite & Chalcopyrite Approx 3%							
65'	71'	Chlomite, Dacite, Pyrite about 1%							
71'	160'	Dacite Flows with some Chlomite & carbonate Stringers. more abundant at bottom of Hole.							
		END OF Hole							

SUDBURY  
 MINING DIV.  
**RECEIVED**  
 OCT 7 1976  
 A.M. 7:59 P.M. 12:45:00

TPC Drilled by Herbert Niemetz Logged by Herbert Niemetz

Property held by Herbert Niemetz Lic. 24368  
~~COPPERFIELD MINING COMPANY~~ Box 252, Timagami Ont.

DIAMOND DRILL RECORD

Started Sept 23/76 Purpose Assesment work. & Testing Hole No. B-1  
 Completed Sept 24/76 Depth 31 feet Sheet No. 2 of B.1  
 Twp. STRATHY Claim S-398978 Location 660'E 820'S. of No 4. Post Zone  
 Lat. \_\_\_\_\_ Dep. \_\_\_\_\_ Az. 70° Elev. \_\_\_\_\_ Dips 65°

FOOTAGE		DESCRIPTION	SAMPLE NO.	FOOTAGE		WIDTH	NO ASSAYS YET		
FROM	TO			FROM	TO		% CU	% NI	% CO
0	5'-8"	Chlorite with Approx 1% pyrite & minor Chalcopyrite							
5'-8"	7	Gauartz, Chlorite, Pyrite & Arsenopyrite, with minor Chalcopyrite Combined mineral Assemblage Approx 25%							
7	10	Chlorite, with Approx 1% Pyrite, minor Chalcopyrite							
10	11	Chlorite with Approx 10% pyrite minor Chalcopyrite							
11	31	Dacite with Carbonate Stringers Criss Crossing Cove @ all angles, Some Stringers up to 2" wide							
END OF HOLE									

SUDBURY  
 RECEIVED  
 OCT 7 1976  
 AM. 7 8 9 10 11 12 1 2 3 4 5 6 P.M.

Drilled by Herbert Niemetz TPC  
 Logged by Herbert Niemetz

Property held by Herbert Niemetz Lic C. 24368  
~~COPPERFIELDS MINING CORP. LTD.~~ Box 252 Temagami Ont

DIAMOND DRILL RECORD

Started Sept 24/76

Purpose Assessment work & Testing

Hole No. B-2

Completed Sept 24/76

Depth 30 feet

Sheet No. 2 of B.2

Twp. STRATHY

Claim S-398978 Location 660'E. 855'S of No 4. Post Zone

Lat. Dep. Az. 70° Elev. Dips 80°

FOOTAGE		DESCRIPTION	SAMPLE NO.	FOOTAGE		WIDTH	NO ASSAYS YET.		
FROM	TO			FROM	TO		% CU	% NI	% CO
0'	5'	CHlorite with Appro 1% Pyrite minor Chalcopyrite							
5'	10'	CHlorite with Pyrite, Arsenopyrite, & Chalcopyrite Approx 5% mineral							
10'	30'	Dacite with Carbonate stringers criss crossing core, some stringers up to 2" wide							
END OF HOLE									

SUBBURY  
 MINING DIV.  
**RECEIVED**  
 OCT 7 1976  
 P.M.  
 7, 8, 9, 10, 11, 12, 3, 4, 5, 6

TPC Drilled by Herbert Niemetz

Logged by Herbert Niemetz

DIAMOND DRILL RECORD —

Property held by. Herbert Niemetz Lic C. 24368  
 Box 252. Tenigami Ont

Started Sept. 26/76

Purpose Assessment work & Testing

Hole No. C. 1

Completed Sept 27/76

Depth 35 Feet

Sheet No. 2. of C. 1.

Twp. STRATHY

Claim S. 398978 Location 660' E. 250' S. of #4 Post Zone

Lot. Dep. 35 Feet Az. 350° Elev. Dips 85°

FOOTAGE		DESCRIPTION	SAMPLE NO.	FOOTAGE		WIDTH	NO ASSAYS Taken Yet		
FROM	TO			FROM	TO		% CU	% NI	% CO
0'	2'	Casing.							
2'	20'	Dacitic Flows, Pale green with Pheno crysts of chert highly fractured & silicified, with occasional carbonates in fracture planes criss crossing core @ No definite angle.							
20'	27'-6"	Dark Basaltic Rock, highly fractured, weakly magnetic							
27'-6"	35'	Dacitic Flows, Pale green with Carbonate stringers criss crossing core, very sparse pyrite in carbonate seams, some seams of carbonate up to 1/4" wide							
END OF HOLE									

TPC Drilled by Herbert Niemetz

Logged by Herbert Niemetz