



31M04SW0122 63.363 STRATHY

63.363

010

63 363

REPORT ON GEOPHYSICAL SURVEY
EAST PART OF STRATHY OPTION,
STRATHY TOWNSHIP, ONTARIO.

INTRODUCTION

This report covers the results of a geophysical survey carried out on a group of claims in Strathy Township, Timiskaming Mining Division, Ontario. The following claims are included in the area surveyed: TRT 6991, TRT 6992, TRT 6448, TRT 6993, TRT 6994, TRT 6995, TRT 6996.

The property is readily accessible from the town of Timagani, three-quarters of a mile to the south, and is crossed by No. 11 Highway and the Ontario Northland Railway.

GENERAL GEOLOGY

The area was mapped by the Ontario Department of Mines on a scale of one mile to the inch.

Ref: W. W. Moorehouse - The Northeastern Portion of the Timagani Lake Area, Ontario Department of Mines, Annual Report Vol. LI, Part VI, 1942.

The consolidated rocks of the area consist of Keewatin-type volcanics which have been intruded by a variety of dikes.

Trending in a northeast direction across the property is a band of acid flow and pyroclastic rocks which have been locally altered to carbonate and sericite schists. Basic to intermediate flows with minor pyroclastics outcrop to the north and south of the acid volcanics.

Intruding the volcanic rocks are basic dikes which include olivine diabase and lamprophyre.

ECONOMIC GEOLOGY

Surface work and diamond drilling have indicated chalcopyrite, arsenopyrite, pyrite and sphalerite mineralization with copper, gold, silver and zinc values.

GEOPHYSICAL SURVEY

The mineralized zone was traced out using an electrical self-potential method. Line spacing varied from 300 feet to 50 feet. Readings were taken at 50 foot intervals with detailed readings at 25 or 10 foot intervals in anomaly areas.

DISCUSSION OF GEOPHYSICAL RESULTS

The self-potential survey indicated six anomalies along a zone roughly one mile long. The area surveyed is shown on a map to the scale of 1" equals 100 feet, with detailed work on the anomalies shown on a scale of 1" equals 40 feet.

Anomaly #1 is located on claim TRT 6733 and has a strike length of 500 to 600 feet.

Anomaly #2 on claim TRT 6923 is a broad feature to the west of Anomaly #1. The broadness of the anomaly probably indicates a body extending to an appreciable depth. Associated with this anomaly are two smaller anomalies #2A and #2B. Copper, gold and silver assays were obtained from a pit on Anomaly #2B.

Detailed self-potential work on Anomaly #3 indicates two bodies. The western body has a roughly east-west trend, and the eastern body a south-west trend.

3.

Anomaly #4 is caused by a roughly east-west trending body over 300 feet long located near the eastern edge of claim TRT 6922.

Anomaly #5 is located near the old Ferguson Highway. An old trench near this anomaly exposes a mineralized shear zone.

Anomaly #6 is located west of No. 11 Highway and has a roughly east-west strike. On the east side of the highway at the eastern end of the anomaly a gossan zone which is reported to give low assays in zinc can be observed.

CONCLUSIONS AND RECOMMENDATIONS

It is believed that the electrical anomalies discussed above are caused by sulphide mineralization, with associated graphite. It is recommended that the anomalies be investigated by diamond drilling.

Respectfully submitted,

MINING GEOPHYSICS CORPORATION LIMITED

J. C. Franz,

Toronto,
February 11, 1953.

H. B. Keovil



31M04SW0122 63.363 STRATHY

020

Geoph Sur Rpt

S Part of Strathy Opt.

Strathy Twp

Mng Geoph Corp Ltd

1953

REPORT ON GEOPHYSICAL SURVEY
OF
SOUTH PART OF STRATHY OPTIONS
STRATHY TOWNSHIP, ONTARIO.

INTRODUCTION

The property covered by the present report and termed the South Part of Strathy Options consists of three claims, TRT 6993, TRT 6994 and T30676 in Strathy Township, Timiskaming Mining Division, Province of Ontario.

The property is located about three-quarters of a mile north of the town of Timagami and can be reached by motor road to the lumber mill immediately to the south.

GENERAL GEOLOGY

The area has been mapped by the Ontario Department of Mines on a scale of 1 inch to the mile.

Ref: W. W. Moorehouse, Ontario Department of Mines Annual Report, Vol. LI, Part VI, 1942.

The property is located on a north-east trending belt of Kewatin-type volcanic rocks. Outcrops in the southern section of the three claims include rhyolite, tuffs, carbonate and sericite schists. More basic volcanic rocks and diorite are exposed near the northern boundaries of the claims covered by this report.

A north-west trending olivine diabase dike is exposed in several places on claim TRT 6994.

GEOPHYSICAL SURVEY

Readings of electrical self-potentials were taken at 50 foot intervals with a potentiometer along lines spaced 300 feet apart. The results of the survey were tied in to the electrical self-potential survey carried out on the claims to the northeast.

DISCUSSION OF GEOPHYSICAL RESULTS

The base level of readings in this area is somewhat higher than in the claims to the north and east.

A small local anomaly is indicated on claim TRT 6995 near a diabase dike. This anomaly is probably the expression of a small sulphide body.

Somewhat higher-than-average negative self-potential values along the west boundary of claim T30676 may indicate sulphides to the west of the area surveyed.

CONCLUSIONS AND RECOMMENDATIONS

The results of the survey do not suggest other than relatively small concentrations of sulphides on these claims. No further work is, therefore, recommended at this time.

Respectfully submitted,

MINING GEOPHYSICS CORPORATION LIMITED

N. B. Keevil

J. C. Frantz,

Toronto,
February 12, 1953.

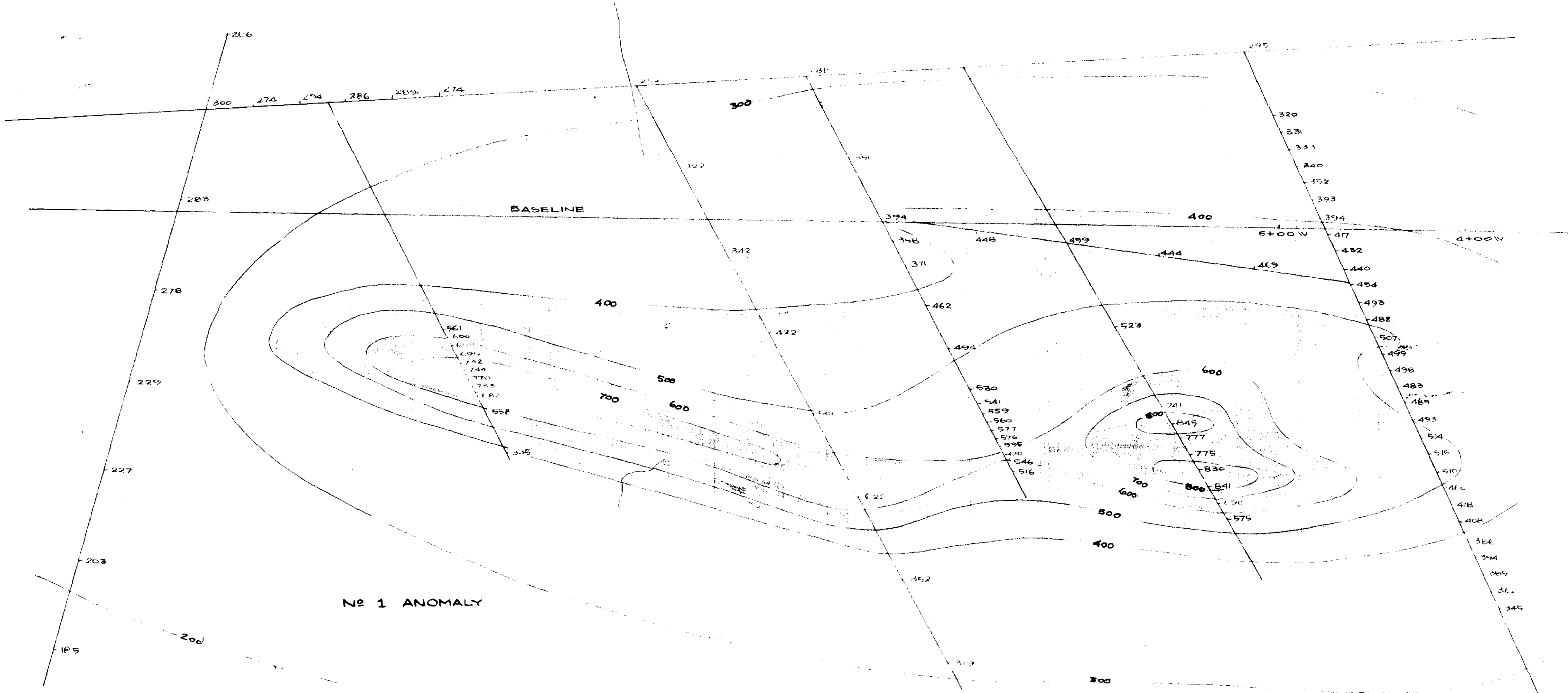
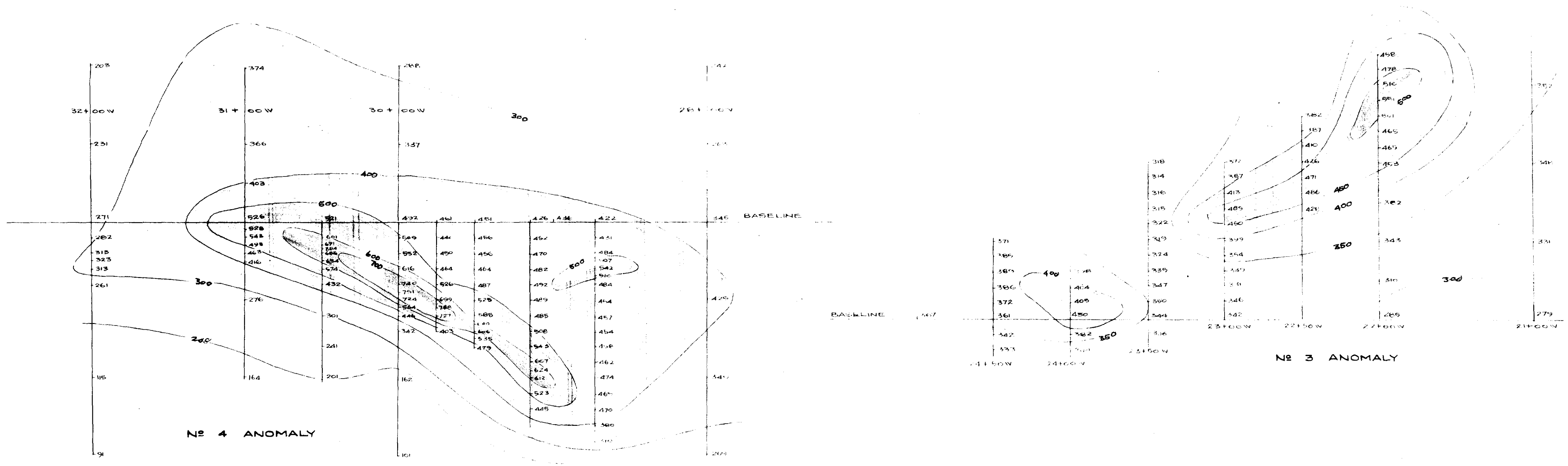

DETAIL SELF-POTENTIAL SURVEY
 ANOMALIES 1-3 AND 4
 EAST PART OF
 STRATHY OPTIONS
 STRATHY TWP. ONT.
 BY
 MINING GEOPHYSICS CORP. LTD.

NOTE: READINGS ARE SHOWN AS NEGATIVE
 SELF-POTENTIALS IN MILLIVOLTS

SCALE 1 INCH = 40 FEET

MINING GEOPHYSICS
 CORPORATION - LIMITED
 11 JORDAN ST.
 TORONTO, ONT.

DRAWN BY R.B.E.	DATE FEB. 11th. 1953
TO ACCOMPANY REPORT 340	COPY No. 2

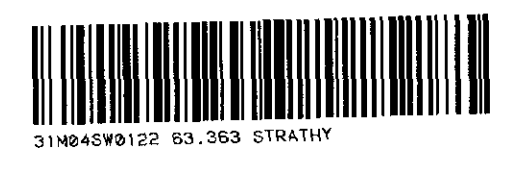

3140490122 63.353 STRATHY

200



NOTE: READINGS ARE SHOWN AS NEGATIVE
 SELF-POTENTIALS IN MILLIVOLTS.

SELF-POTENTIAL SURVEY
 EAST PART OF
STRATHY OPTIONS
 STRATHY TWP. ONT.
 BY
 MINING GEOPHYSICS CORP. LTD.
 SCALE IN FEET
 0 100 200 300 400 500

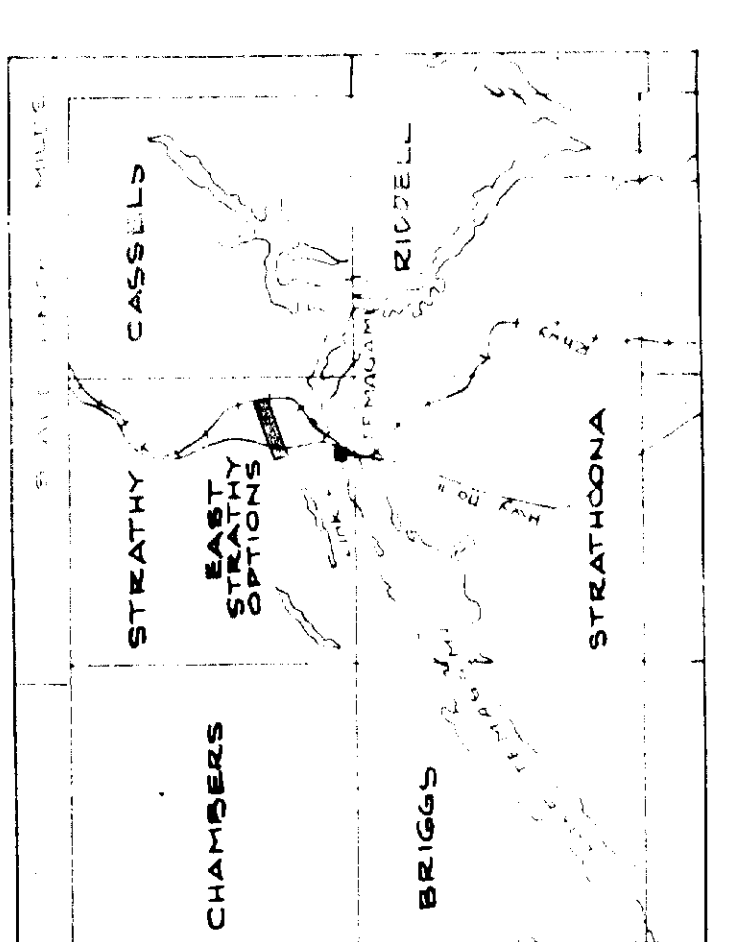

LOCATION MAP

SELF-POTENTIAL SURVEY
 OF
 SOUTH PART OF
STRATHY OPTIONS
 STRATHY TWP. ONT.
 BY
 MINING GEOPHYSICS CORP. LTD.

SCALE IN FEET

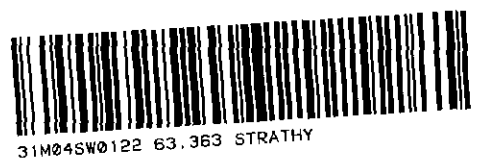
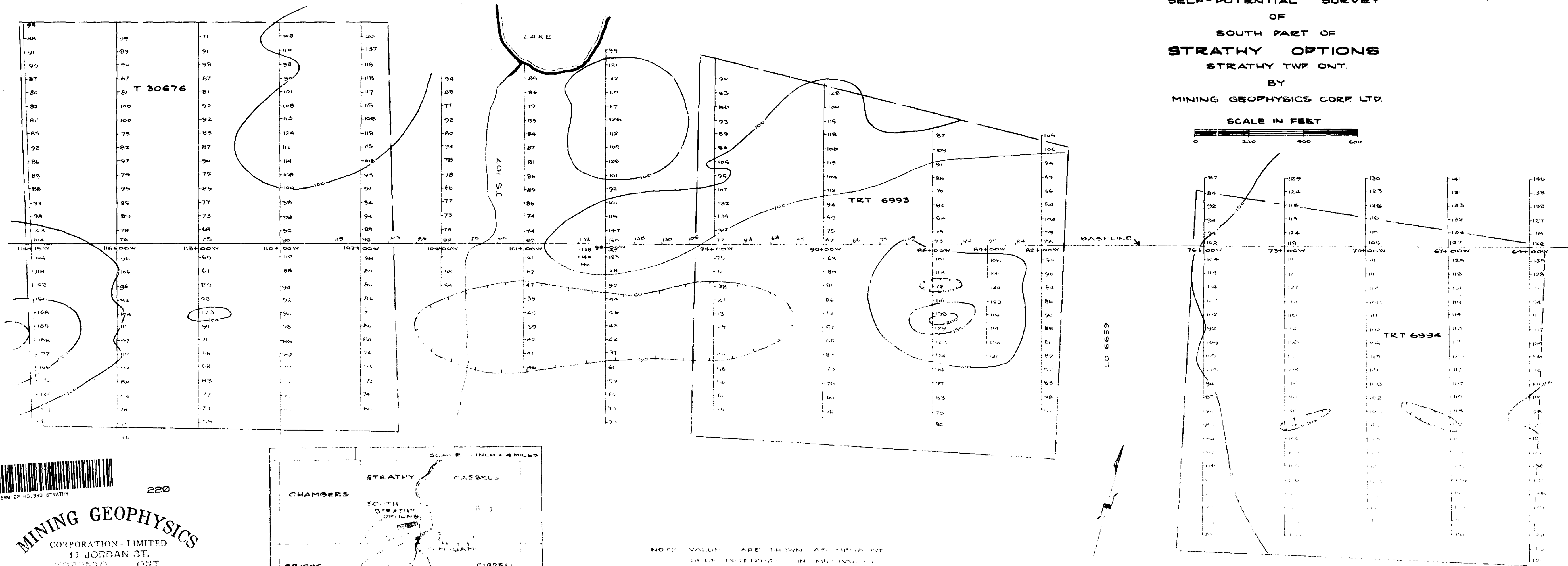
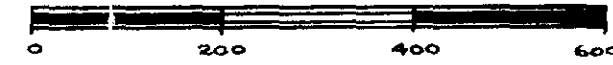

220

MINING GEOPHYSICS
 CORPORATION-LIMITED
 11 JORDAN ST.
 TORONTO, ONT.

DEPT. BY R.B.C.	DATE FEB. 26. 1958
NO. OF COPIES 542	COPY NO. 2

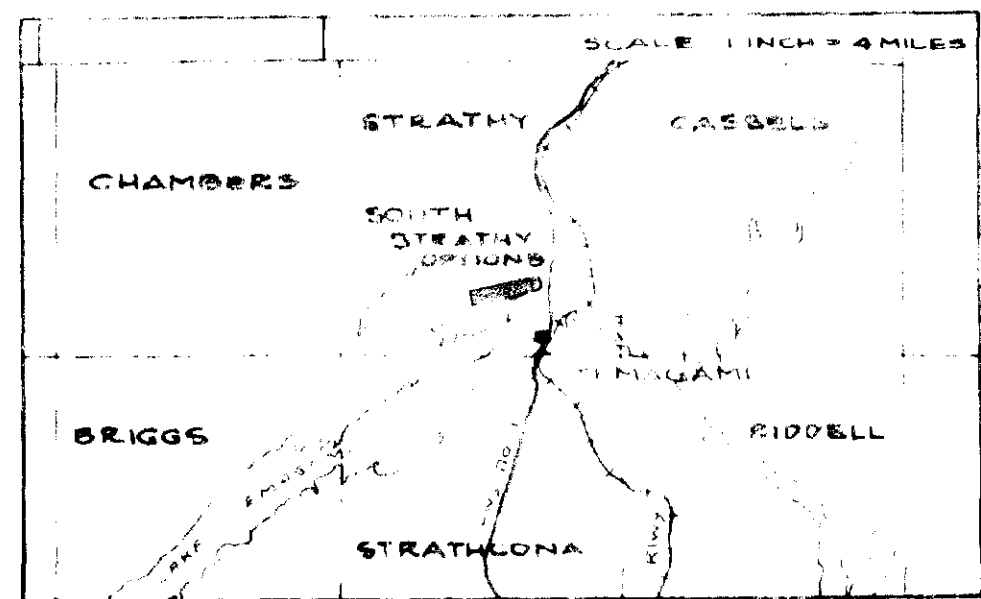

NOTE: VALUES ARE SHOWN AS POSITIVE
 SELF-POTENTIAL IN MILLIVOLTS