

Diamond Rock Resources Inc

WEST BLOCK - WESTIN PROPERTY

Strathy Township
Sudbury Mining Division

Report on Work Performed on Claims
1165520, 1165521, 1165522 and 1212263

Geological Mapping

2.17571

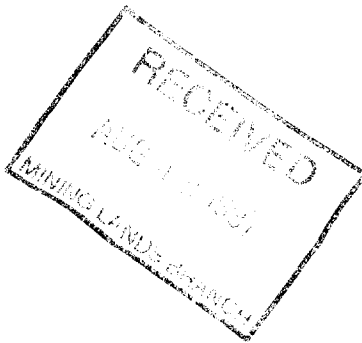

David Brez Carlisle
Vice President
May 26, 1997

Qual #
2.17368



31M04SW0168 2.17571 STRATHY

TABLE OF CONTENTS

	<i>Page</i>
1. Introduction	
1.1 Property Location	1
1.2 Access	1
1.3 Property Ownership	1
1.4 Previous Work Summary	4
1.5 Regional Geology	4
1.6 Economic Geology	6
2. Current Work	7
2.1 Line Cutting	7
2.2 Geological Survey and Mapping	7
2.3 Geological Map	End Pocket
3. Recommendations	8
4. References	8
5. Personnel	9
6. Statement of Qualifications	10



LIST OF FIGURES

		<i>Page</i>
Figure 1	Location Map	2
Figure 2	Claim Map	3
Figure 3	Regional Geological Map	5
Figure 4	Detailed Geological Map (1:5,000)	End Pocket

1. INTRODUCTION

1.1 Property Location

The Westin Property is a group of 10 claims comprising 13 units and 520 acres, which is located in Strathy Township, District of Temiskaming, in the Sudbury Mining Division west of Lake Temiskaming, Ontario (Figure 1). This report summarizes geological mapping of claims 1165520, 1165521, 1165522 and 1212263, as illustrated in Figure 2 (Map G-3451).

1.2 Access

Access to the property is gained by the Kaniche Mine Road which turns west off Highway 11 4.5 km north of the town of Temagami. Following the Kaniche Road proceed 4 km to the old mine workings then south another 1.5 km at which point there is a sharp curve. A further 450 m west of this curve along the road is the baseline for this west block. Upon crossing Alfreda Creek the road forks to the northwest and southwest and the baseline lies adjacent to this fork.

1.3 Property Ownership

The Westin Property is held by Bjarne Anton Westin of New Liskeard, Ontario. Title to these claims rests with the Crown.

1.4 Previous Work Summary

1964 (Keevil Consultants Ltd.)

On the Doris Lake Claim Group, a 300 mV self-potential survey was done 100 m south of Alfreda Creek in claim 1165517 on the East Grid of the Westin Property.

1965 (Keevil Mining Ltd.)

Geological mapping, sampling, trenching. Trench samples assayed up to 0.56 oz/t gold over 5.4 feet in the southeast corner of claim 1165517 on the East Grid of the Westin Property.

1973 (Kanichee Mining Inc.)

Ground magnetometer and VLF-EM surveys including the area covered by the current West Grid claims.

1992-93 (Bjarne Anton Westin)

Geophysics (magnetometer and VLF surveys) and soil sampling and prospecting programmes were completed (Ewanchuck and Westin, 1994; Westin, 1993).

1993-94 (J. Ewanchuck and B.A. Westin)

Prospecting, geological and geophysical surveys, stripping, trenching and detailed sampling were performed.

1.5 Regional Geology

The property is underlain by steeply dipping, northeasterly striking metavolcanics of Archean age. A series of mafic to felsic volcanic units underlie the area. A number of contacts between the units are present on the claims. Passing through the eastern claim group is the Vermilion Lake deformation zone. This is a regional zone of shearing associated with numerous gold, copper and molybdenum showings.

Mafic to ultramafic (gabbro or peridotite) intrusions resembling the Kanichee Mine intrusion are present in both the East and West Grids.

See Figure 3 (Table of lithologic units for the Northeast Temagami area) and Figure 4 (Chambers and Strathy Township geology map).

1.6 Economic Geology

The two claim blocks covered by the East and West Grids have good potential for several different types of mineral deposits.

Copper-Nickel- The past producing copper-nickel Kanichee Mine is located approximately one kilometre north of the East Grid claims. The Kanichee deposit is a massive sulphide deposit associated with mafic to ultramafic gabbro intrusions. Similar intrusions are known to exist on the West Grid claim group and are inferred to exist on the East Grid.

Gold- A gold showing was reported during the 1965 exploration programme of Keevil Mining. The showing is located in the southeast corner of claim 1165517, at the east end of the East Grid. Trenching and sampling yielded samples assaying as high as 0.56 oz/t Au over 5.4 feet. Several old shafts and surface workings are present in the Strathy Township area. Included is the former Beanland prospect approximately 1500 metres east of the property. A shaft and extensive underground workings date from the 1940's. A 3000 tonne surface bulk sample was removed for test milling by Gwen Resources in March 1992.

Massive Sulphides- The felsic to mafic volcanic assemblages of Strathy Township are potential hosts of polymetallic massive sulphide deposits. Contacts between felsic and mafic volcanics are known on both claim groups covered in this report.

GSC Open File 1091, Sudbury-Timmins-Algoma Mineral Program Project 4B, entitled "The metamorphic mineralogy and chemical alteration of the Temagami Greenstone Belt" indicates that the probability of sulphide mineralization is high. Two statistical analyses (Versions 1 and 2) of the lithogeochemical data in this report show high probability of sulphide mineralization. Version 1 of the statistical analysis predicts a greater than 60% probability of mineralization. Version 2 indicates a greater than 70% probability of sulphide mineralization.

2. CURRENT WORK

2.1 Line Cutting

6.7 kilometres of survey lines were cut.

2.2 Geophysical Survey and Mapping

A party led by Dr. C.H. Hale carried out geological mapping and a magnetometer survey of claims 1165520, 1165521 and 1165522 and 1212263 during the summer of 1996, and a member of this party drew the geological map (Figure 4) in August 1996.

3. RECOMMENDATIONS

This property is known to include massive auriferous sulphide deposits. Channel sampling on these four claims may indicate the extent and grade of the mineralization. In addition, I recommend undertaking a geochemical and a more extensive geophysical survey, especially VLF-EM mapping and induced polarization, which has proved so fruitful on the Heather Lake property.

REFERENCES

Assessment Files, Resident Geologist's Office, Sudbury, Ontario.

Bennett, G. 1978. Geology of the Northeast Temagami Area. OGS Report 163.

Downie, I.F. 1973. Report on geological mapping and exploration, Doris Lake group, Strathy Township, Ontario, for Keevil Consultants Ltd..

Ewanchuck, J. and B.A. Westin, 1994. 1993-94 OPAP Report for John Ewanchuck- Report on activities for (a) Strathy Project, Strathy Township, Sudbury Mining Division; (b) EMS Property, Bryce and Tudhope Townships, Larder Lake Mining Division.

Johns, G. W. 1986. Geology of the Hill Lake Area, District of Timiskaming, Ontario Geological Survey Report 250.

Westin, B.A., 1993. Report on exploration activities performed under OPAP 1992-93, Strathy Township, Sudbury Mining Division, Province of Ontario.

4. **PERSONNEL**

Dr. David Brez Carlisle, Ph. D., D. Sc., Vice President, Diamond Rock Resources, directed the work and wrote the report.

Dr. C. H. Hale, Ph. D., Consulting Geologist, led the field team.

Dr. Katherine Smuk, Ph. D., Consulting Geologist.

Vanessa Gale, B. Sc., Consulting Geologist.

Bart Wilson, B. Sc., Consulting Geologist.

5. STATEMENT OF QUALIFICATIONS

I, David Brez Carlisle, of 47 Kawartha Drive, Pontiac, Quebec, do hereby certify that

- i I am a graduate of Oxford University, U.K., holding a first class honours Bachelor's Degree in Natural Science, a Master's degree in Science, a Doctorate of Philosophy in science, and the degree of Doctor of Science.
- ii I have been engaged in geological work for a period of thirty years.
- iii I have personally directed the work indicated in this report.
- iv I am a director, vice president and chairman of the board of Diamond Rock Resources Inc.

A handwritten signature in black ink, reading "David Brez Carlisle". The signature is written in a cursive, flowing style.

David Brez Carlisle

2.17571

Diamond Rock Resources Inc

WEST BLOCK - WESTIN PROPERTY

Strathy Township
Sudbury Mining Division

Appendix to Report on Work on Claims
1165520, 11655212, 1165522 and 1212263
Submitted May 26, 1997

Technical Report

David Brez Carlisle
Vice President
August 5, 1997



31M04SW0168 2.17571 STRATHY

020

RECEIVED
AUG 05 1997
11:00 AM
GEOSCIENCE ASSESSMENT
OFFICE

OK

2.17571

2.3 Technical Report

The greater part of these four claims is covered in dense bush, but there are sufficient outcrops to obtain a general impression of the underlying geology.

The majority of the outcrops consist of felsic volcanics, chiefly breccias and tuffs, of a generally pyroclastic nature of Archaean age. Many of the outcrops lie along northwesterly trending lines. A particularly prominent line of outcrops of felsic breccias lies on claim 1165521 almost exactly along the line running between the northwesterly and the southeasterly claim posts (chain #4). Parallel to this line, 150 metres to the southwest, lies a second chain of felsic breccia outcrops (Chain #3), with two more (Chains #2 and #1), not quite so well-marked, each a further 150 metres to the southwest.

To the northeast of chain #4, about 150 metres away, is found another chain of outcrops with the same northwesterly trend, cutting through claim 1165521 and 1165522 (chain #5), with more chains lying northeast at the same spacing on claim 1165522 (chains #6 to #9)).

Examination of these outcrops indicates that the whole area is cut by a series of steeply dipping breaks running parallel to the chains of outcrops and another series cross-cutting them roughly at right-angles. Many of these breaks show shear zones and fragmentation, and some of them sulphide mineralization as well. Ten grab samples, numbered 96TMG1 to 96TMG10, were taken from these semi-massive sulphide mineralizations (see map) on chains #5, #6, #7, #8 and #9. These await assay.

While most of the outcrops consist of felsic breccias, a few consist of tuffs. In addition, mafic to ultramafic diorite or gabbro intrusions resembling the Kaniche Mine intrusion are found in the block. Most noteworthy is a large outcrop in chain #5 lying across the boundary of claims 1165521 and 1165522. No sulphides were found in these mafic rocks; sulphides were confined to the felsic or mesofelsic outcrops.

In summary, the entire block consists of Archaean felsic pyroclastic deposits, thinly overlain by heavily vegetated till. Outcrops lie in northwesterly trending chains. The block is cut by a rectilinear grid of veins and breaks, one set parallel to the chains of outcrops, the other orthogonal to this direction. The strata dip steeply. Some of the breaks show shear zones which often include semi-massive sulphide mineralizations. The block shows mafic to ultramafic gabbroic or dioritic intrusions, evident in outcrops, resembling the Kaniche Mine intrusions, but without any sign of sulphides.

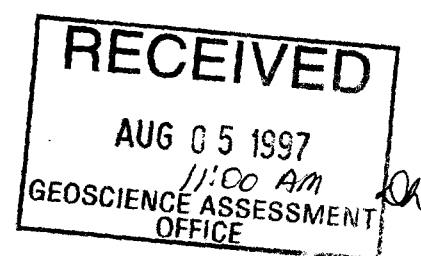

Personal information collected on this form is obtained under the authority of subsections 65(2) and 66(3) of the Mining Act. Under section 8 of the Mining Act, the information must correspond with the mining land holder. Development and Mines, 6th Floor.

Minin
 Quez
 933 F



31M04SW0168 2.17571 STRATHY

Inst

m 0240

2.17571

900

1. Recorded holder(s) (Print name)

Name WESTIN, Bjorne Anton	Client Number 207919
Address 1455 Lakeshore Rd Box 657 New Liskeard, ON P0J 1P0	Telephone Number 705-647-6354
Name	Client Number
Address	Telephone Number
	Fax Number

2. Type of work performed: Check (✓) and report on only ONE of the following groups for this declaration.

Geotechnical: prospecting, surveys, assays and work under section 18 (regs) Physical: drilling, stripping, trenching and associated assays Rehabilitation

Work Type Geological Survey & Mapping	Office Use
	Commodity
	Total \$ Value of Work Claimed 7940
Dates Work Performed From 30 Day 02 Mo 06 To 5 Day 08 Mo 96	NTS Reference
Global Positioning System Data (if available)	Mining Division Sudbury
Township/Area Strathelyup	Resident Geologist District
No. of G-Plan Number G-345	

Please remember to: - obtain a work permit from the Ministry of Natural Resources as required;
 - provide proper notice to surface rights holders before starting work;
 - complete and attach a Statement of Costs, form 0212;
 - provide a map showing contiguous mining lands that are linked for assigning work;
 - include two copies of your technical report.

3. Person or companies who prepared the technical report (Attach a list if necessary)

Name Diamond Rock Resources Inc	Telephone Number 613-234-9119
Address 246 Slater St, Ottawa, ON K1P 5J1	Fax Number 613-234-3428
Name	Telephone Number
Address	Fax Number
Name	Telephone Number
Address	Fax Number

4. Certification by Recorded Holder or Agent

I, **David Bree CARLISLE** (Print Name), do hereby certify that I have personal knowledge of the facts set forth in this Declaration of Assessment Work having caused the work to be performed or witnessed the same during or after its completion and, to the best of my knowledge, the annexed report is true.

Signature of Recorded Holder or Agent <i>David Bree Carlisle</i>	Date 28 May 97
Agent's Address Vice President Diamond Rock Res, 246 Slater St, Ottawa, Ont K1P 5J1	Telephone Number 613-234-9119
	Fax Number 613-234-3428

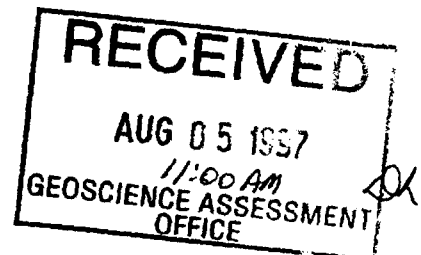
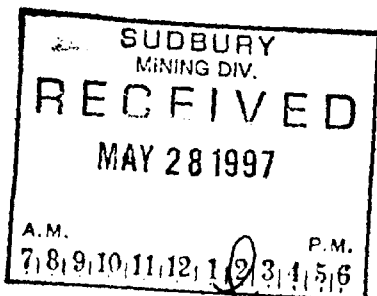

Deemed Aug. 26/97

5. Work to be recorded and distributed. Work can only be assigned to claims that are contiguous (adjoining) to the mining land where work was performed, at the time work was performed. A map showing the contiguous link must accompany this form.

Mining Claim Number. Or if work was done on other eligible mining land, show in this column the location number indicated on the claim map.	Number of Claim Units. For other mining land, list hectares.	Value of work performed on this claim or other mining land.	Value of work applied to this claim.	Value of work assigned to other mining claims.	Bank. Value of work to be distributed at a future date.
eg TB 7827	16 ha	\$26,825	N/A	\$24,000	\$2,825
eg 1234567	12	0	\$24,000	0	0
eg 1234568	2	\$ 8,892	\$ 4,000	0	\$4,892
1 1165520	1	800	800	0	
2 1165521	1	800	800	0	
3 1165522	4	6340	1600	0	4340
4 1212263	1	400	400	0	
5	Total,	7940	3600	0	
6					
7					
8					
9					
10					
11					
12					
13					
14					
15					
Column Totals		7940	3600	0	4340

I, David Brez CARLISLE (Print Full Name), do hereby certify that the above work credits are eligible under subsection 7 (1) of the Assessment Work Regulation 6/96 for assignment to contiguous claims or for application to the claim where the work was done.

Signature of Record Holder or Agent Authorized to Sign: [Signature] Date: 28 May 97

6. Instructions for cutting back credits that are not approved.

Some of the credits claimed in this declaration may be cut back. Please check (✓) in the boxes below to show how you wish to prioritize the deletion of credits:

- 1. Credits are to be cut back from the Bank first, followed by option 2 or 3 or 4 as indicated.
- 2. Credits are to be cut back starting with the claims listed last, working backwards; or
- 3. Credits are to be cut back equally over all claims listed in this declaration; or
- 4. Credits are to be cut back as prioritized on the attached appendix or as follows (describe):

Note: If you have not indicated how your credits are to be deleted, credits will be cut back from the Bank first, followed by option number 2 if necessary.

For Office Use Only

Received Stamp	Deemed Approved Date	Date Notification Sent
	Date Approved	Total Value of Credit Approved
	Approved for Recording by Mining Recorder (Signature)	

2.17571

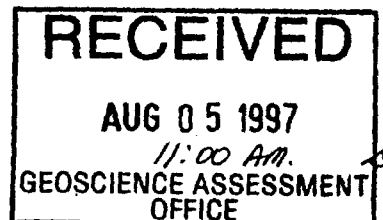

October 15, 1997

BJARNE ANTON WESTIN
1455 LAKESHORE ROAD
BOX 657
NEW LISKEARD, Ontario
P0J-1P0

Geoscience Assessment Office
933 Ramsey Lake Road
6th Floor
Sudbury, Ontario
P3E 6B5

Telephone: (888) 415-9846
Fax: (705) 670-5863

Dear Sir or Madam:

Submission Number: 2.17571

Status

Subject: Transaction Number(s): W9770.00379 Approval After Notice

We have reviewed your Assessment Work submission with the above noted Transaction Number(s). The attached summary page(s) indicate the results of the review. **WE RECOMMEND YOU READ THIS SUMMARY FOR THE DETAILS PERTAINING TO YOUR ASSESSMENT WORK.**

If the status for a transaction is a 45 Day Notice, the summary will outline the reasons for the notice, and any steps you can take to remedy deficiencies. The 90-day deemed approval provision, subsection 6(7) of the Assessment Work Regulation, will no longer be in effect for assessment work which has received a 45 Day Notice.

Please note any revisions must be submitted in DUPLICATE to the Geoscience Assessment Office, by the response date on the summary.

If you have any questions regarding this correspondence, please contact Steve Beneteau by e-mail at beneteau_s@torv05.ndm.gov.on.ca or by telephone at (705) 670-5855.

Yours sincerely,



ORIGINAL SIGNED BY
Blair Kite
Supervisor, Geoscience Assessment Office
Mining Lands Section

Work Report Assessment Results

Submission Number: 2.17571

Date Correspondence Sent: October 15, 1997

Assessor: Steve Beneteau

Transaction Number	First Claim Number	Township(s) / Area(s)	Status	Approval Date
W9770.00379	1165520	STRATHY	Approval After Notice	October 13, 1997

Section:

12 Geological GEOL

The revisions outlined in the Notice dated August 29, 1997, have been corrected. As well, the 45 days outlined in the Notice have passed. Assessment work credit has been approved as outlined on the attached Distribution of Assessment Work Credit sheet.

Correspondence to:

Resident Geologist
Sudbury, ON

Recorded Holder(s) and/or Agent(s):

D.B. CARLISLE
OTTAWA, ON, CANADA

Assessment Files Library
Sudbury, ON

BJARNE ANTON WESTIN
NEW LISKEARD, Ontario

Distribution of Assessment Work Credit

The following credit distribution reflects the value of assessment work performed on the mining land(s).

Date: October 15, 1997

Submission Number: 2.17571

Transaction Number: W9770.00379

<u>Claim Number</u>	<u>Value Of Work Performed</u>
1165520	628.00
1165521	628.00
1165522	4,665.00
1212263	314.00
Total: \$	6,235.00

October 22, 1997

BJARNE ANTON WESTIN
1455 LAKESHORE ROAD
BOX 657
NEW LISKEARD, Ontario
P0J-1P0

Geoscience Assessment Office
933 Ramsey Lake Road
6th Floor
Sudbury, Ontario
P3E 6B5

Telephone: (888) 415-9846
Fax: (705) 670-5863

Dear Sir or Madam:

AMENDED

Submission Number: 2.17571

Status

Subject: Transaction Number(s): W9770.00379 Approval After Notice

We have reviewed your Assessment Work submission with the above noted Transaction Number(s). The attached summary page(s) indicate the results of the review. **WE RECOMMEND YOU READ THIS SUMMARY FOR THE DETAILS PERTAINING TO YOUR ASSESSMENT WORK.**

If the status for a transaction is a 45 Day Notice, the summary will outline the reasons for the notice, and any steps you can take to remedy deficiencies. The 90-day deemed approval provision, subsection 6(7) of the Assessment Work Regulation, will no longer be in effect for assessment work which has received a 45 Day Notice.

Please note any revisions must be submitted in DUPLICATE to the Geoscience Assessment Office, by the response date on the summary.

If you have any questions regarding this correspondence, please contact Steve Beneteau by e-mail at beneteau_s@torv05.ndm.gov.on.ca or by telephone at (705) 670-5855.

Yours sincerely,



ORIGINAL SIGNED BY
Blair Kite
Supervisor, Geoscience Assessment Office
Mining Lands Section

Work Report Assessment Results

Submission Number: 2.17571

Date Correspondence Sent: October 22, 1997

Assessor: Steve Beneteau

Transaction Number	First Claim Number	Township(s) / Area(s)	Status	Approval Date
W9770.00379	1165520	STRATHY	Approval After Notice	October 13, 1997

Section:

12 Geological GEOL

A geology survey and mapping prior to claim recording is not eligible for assessment credit. The geology and mapping performed on claim 1212263 was performed prior to recording this claim. Therefore, the work performed on this claim will be reduced to \$0.00. Assessment credits have been approved as outlined on the attached Assessment Credit Distribution form.

Correspondence to:

Resident Geologist
Sudbury, ON

Recorded Holder(s) and/or Agent(s):

D.B. CARLISLE
OTTAWA, ON, CANADA

Assessment Files Library
Sudbury, ON

BJARNE ANTON WESTIN
NEW LISKEARD, Ontario

Distribution of Assessment Work Credit

The following credit distribution reflects the value of assessment work performed on the mining land(s).

Date: October 22, 1997

Submission Number: 2.17571

Transaction Number: W9770.00379

<u>Claim Number</u>	<u>Value Of Work Performed</u>
1165520	628.00
1165521	628.00
1165522	4,665.00
1212263	0.00
	<hr/>
Total: \$	5,921.00

INDEX TO LAND DISPOSITION

PLAN
G-3451
TOWNSHIP

M.N.R. ADMINISTRATIVE DISTRICT
TEMAGAMI
MINING DIVISION
SUDBURY
LAND TITLES/REGISTRY DIVISION
NIPISSING

STRATHY

DATE OF ISSUE

OCT 14 1997

PROVINCIAL RECORDING OFFICE - SUDBURY

Scale 1:20 000

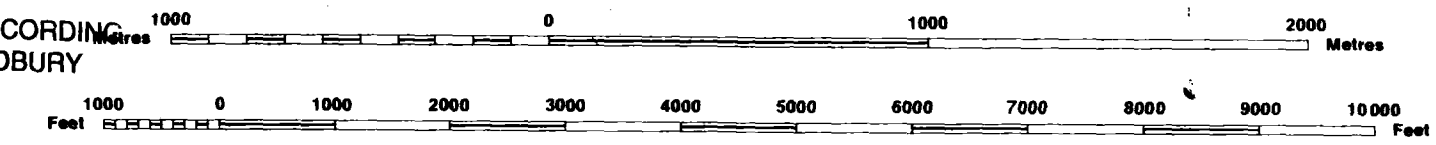

Contour Interval 10 Metres

SYMBOLS

- Boundary
- Township, Meridian, Baseline
- Road allowance; surveyed, shoreline
- Lot/Concession; surveyed, unsurveyed
- Parcel; surveyed, unsurveyed
- Right-of-way; road, railway, utility
- Reservation
- Chf. Pit, Pile
- Contour
- Interpolated
- Approximate
- Depression
- Control point (horizontal)
- Flooded land
- Mine head frame
- Pipeline (above ground)
- Railway; single track, double track, abandoned
- Road; highway, county, township, access, trail, bush
- Shoreline (original)
- Transmission line
- Wooded area
- Land Use Permit

AREAS WITHDRAWN FROM DISPOSITION

Description	Order No.	Date	Disposition	File
36(R)S.O.1960	OC 2022/66	OC 2022/66	S.R.O.	3596
SEC.36/90	M.1/84	15/03/84	M & S	108640
4	#-01/91/ONT	SEP.20/91	S.R.O.	LAND ROLL
REC.36/80	#-3-02/91 NER		M & S	19880
PENDING DISPOSITION UNDER THE PUBLIC LANDS ACT - LAND NOT OPEN FOR STAKING SUB-SECTION 30(B) OF THE MINING ACT R.S.O. 1990 - NOTICE RECEIVED 08/JAN/90				
PENDING DISPOSITION UNDER THE PUBLIC LANDS ACT - LAND NOT OPEN FOR STAKING SUB-SECTION 30(B) OF THE MINING ACT R.S.O. 1990 - NOTICE RECEIVED 02/JAN/90				
REC.35/90	W-5-30/84	APR.15/84	M & S	19850
SEC.35/90	0-3-10/85	AUG.11/85	M & S	198180
SEC.35/90	W-5-70/84 OR	MAY.07/84	M & S	108680
SEC.35/90	0-3-31/84	AUG.1/84	M & S	19850
SEC.35/90	W-5-32/85	JUNE.1/85	M & S	195150
SEC.35/90	W-5-77/84	09/13/84	M & S	195150
SEC.35/90	W-5-157/86	APR.16/86	M & S	195150
Pending Disposition MNR Not Open For Staking				
Pending Disposition MNR Not Open For Staking				
SEC.35/90	W-5-60/86	09/13/86	M & S	195150
SEC.35/90	W-5-47/86	09/10/86	M & S	195150

THIS TOWNSHIP FALLS WITHIN THE TEMAGAMI COMPREHENSIVE PLANNING AREA. SPECIAL WORKING CONDITIONS MAY APPLY TO EXPLORATION ACTIVITIES. FOR MORE DETAILS PLEASE CONTACT: DISTRICT MANAGER, NORTH BAY DISTRICT, MINISTRY, NATURAL RESOURCES

NOTES

ISLAND 27 BELONGS WITH STRATHCONA TWP. ISLANDS IN LAKE TEMAGAMI - NOT OPEN FOR STAKING SFC 16/79/90 W-5-41/84 M & S 19560 W-5-72/84 03/13/84 * JUNE 1, 1994 OPENINGS ONTARIO GAZETTE-VOL.127-20 MAY 14, 1994 PAGE 1579

SKYLINE RESERVE AREA DEEMED IN NEED OF PROTECTION BY THE CROWN AND WILL REMAIN WITHDRAWN

LAKE TEMAGAMI

LAND COVERED BY THE WATERS OF LAKE TEMAGAMI IS WITHDRAWN FROM PROSPECTING AND STAKING OUT

THE INFORMATION THAT APPEARS ON THIS MAP HAS BEEN COMPILED FROM VARIOUS SOURCES AND ACCURACY IS NOT GUARANTEED. THOSE WISHING TO STAKE MINING CLAIMS SHOULD CONSULT WITH THE MINING RECORDER, MINISTRY OF NORTHERN DEVELOPMENT AND MINES, FOR ADDITIONAL INFORMATION ON THE STATUS OF THE LANDS SHOWN HEREON.

DISPOSITION OF CROWN LANDS

- Patent
- Surface & Mining Rights
- Surface Rights Only
- Mining Rights Only
- Lease
- Surface & Mining Rights
- Surface Rights Only
- Mining Rights Only
- Licence of Occupation
- Order-in-Council
- Cancelled
- Reservation
- Sand & Gravel

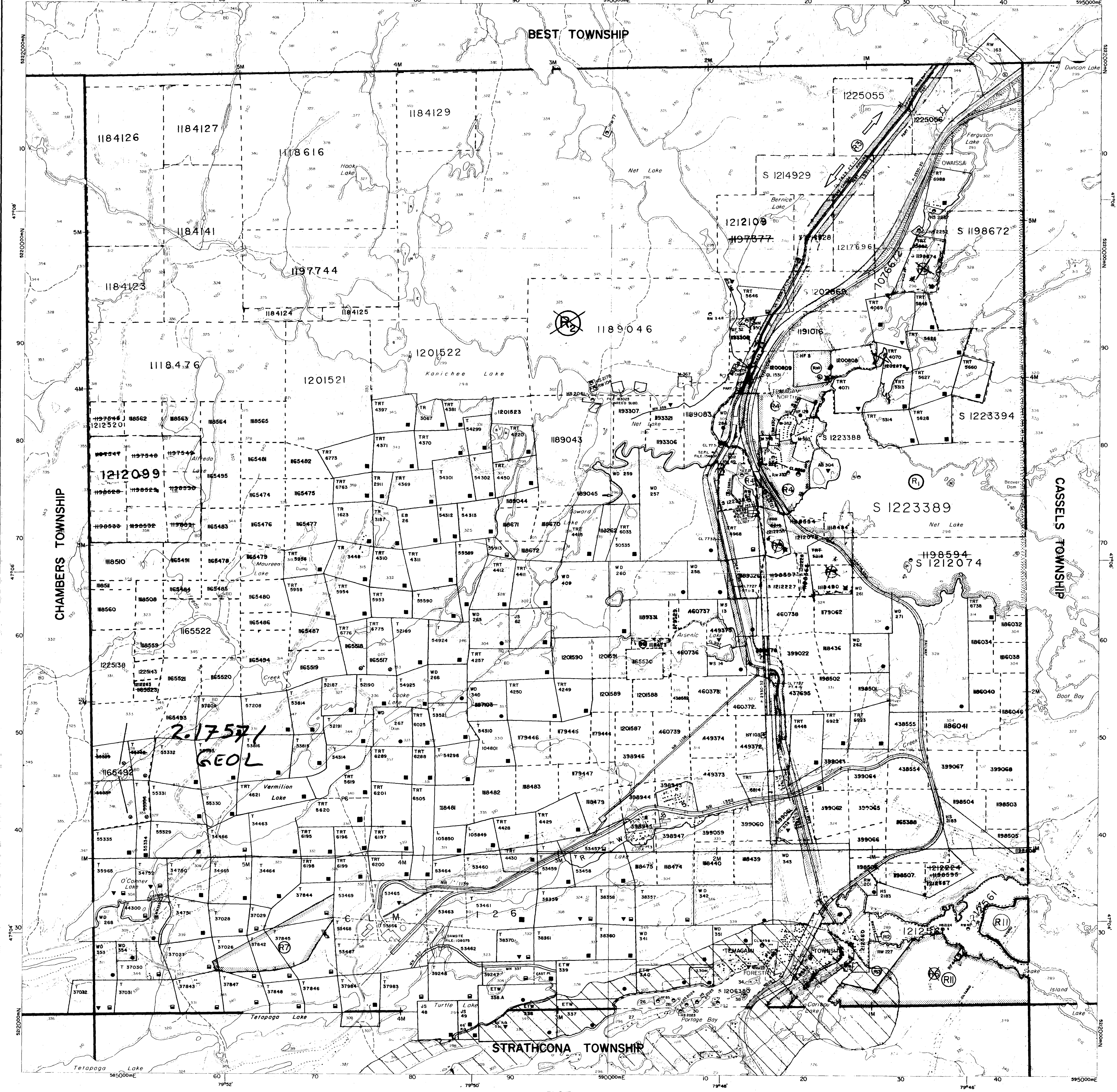

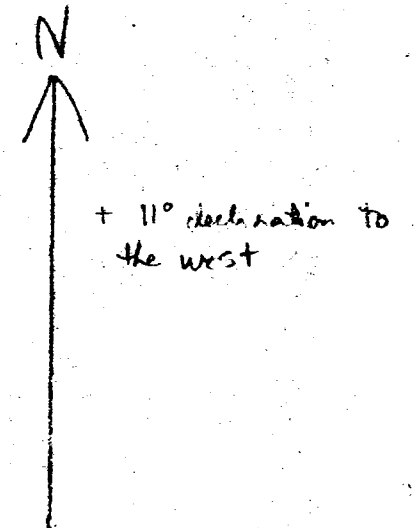

LEGEND

- 2e sheared intermediate to felsic volcanic
- 2c felsic volcanic breccia
- 2f intermediate volcanic breccia
- 1a massive to foliated quartzite to basalt
- 5c diorite to gabbro
- 5e quartz diorite
- 2d felsic tuff
- S sulfide mineralization
- Q quartz mineralization
- breccia
- branch
- swamp boundary
- vein network
- vein strike and dip
- cliff face
- shear orientation and dip
- bedding (dip unknown)
- fracture orientation and dip
- swamp
- claim post (inferred)
- claim (located)
- claim boundary

GEOLOGY
 DFR CLAIMS IN TEMAGAMI AREA
 MAPPED JULY 31 - AUGUST 5
 MAPPED BY K. SMUK AND V. GALE

2.17571

RECEIVED
 AUG 6 1997
 MINING BRANCH

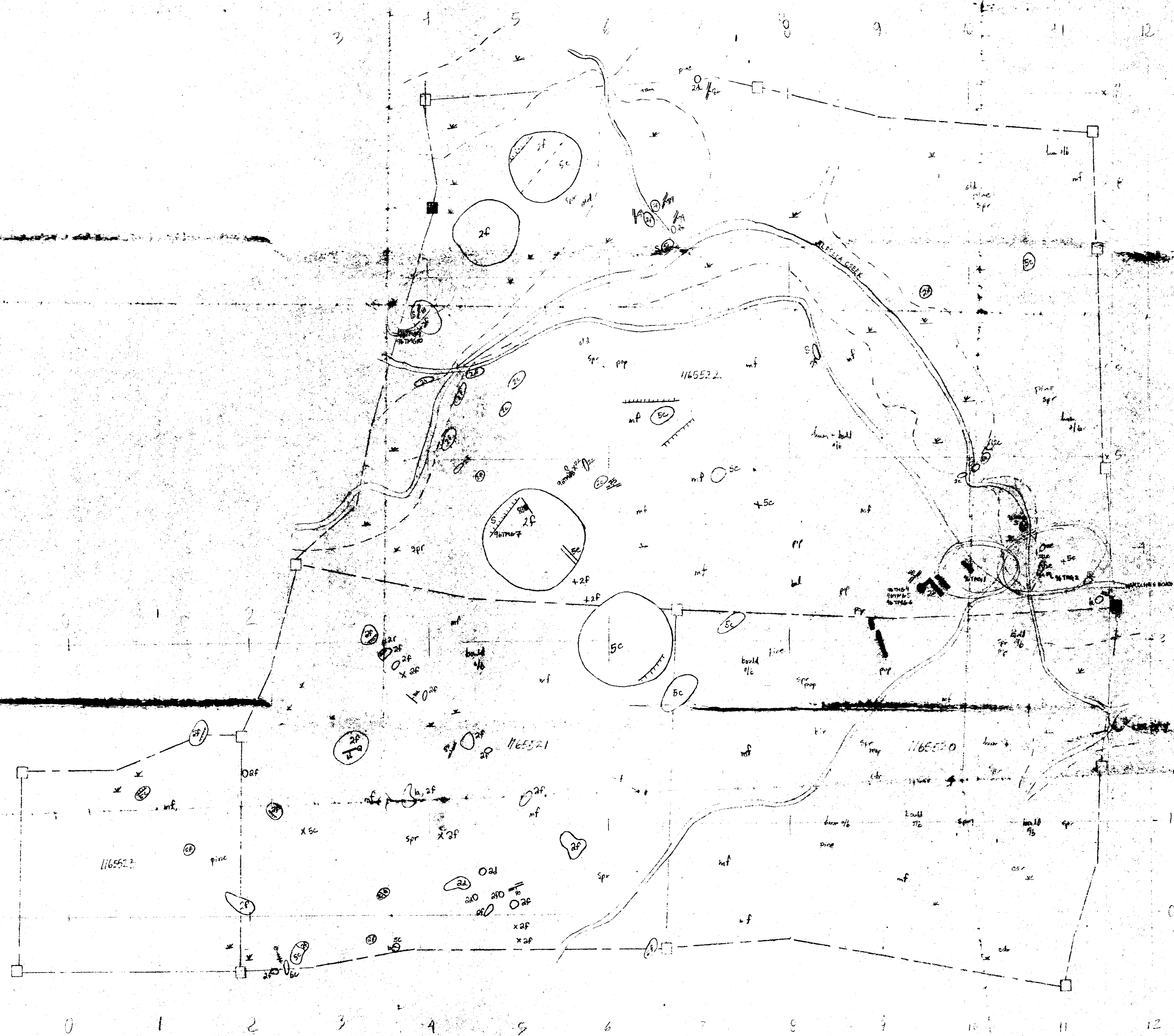
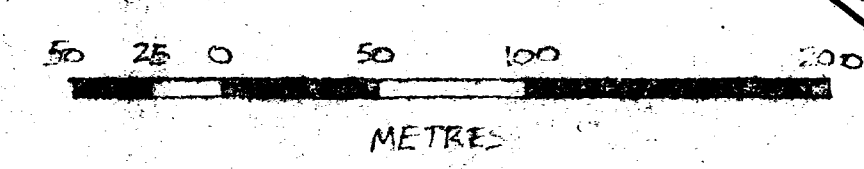

SYMBOLS

- ☒ CLAIMPOST FOUND
- ☐ CLAIMPOST NOT FOUND
- TOPOGRAPHIC RIDGE
- ⊛ SWAMP
- ⊞ VEIN WITH DIP
- ⊞ NET VEIN
- ⊞ SHEAR, INCLINED
- ⊞ JOINT, INCLINED
- ⊞ BEDDING
- S SULFIDES
- ⊞ TRENCH
- b o/b BOULDER OVERBURDEN
- cdr CEDAR
- pine PINE
- tan TAMARACK
- spr SPRUCE
- ald ALDERS
- pop POPLAR
- mf MIXED FOREST
- bal BALSUM
- bir BIRCH
- map MAPLE
- h o/b HUMMOCKY OVERBURDEN
- S SULFIDE MINERALIZATION

LEGEND

- OUTCROP
- TRAVERSE LINES
- TRENCHING
- CLAIM BOUNDARY

GEOLOGY

- 5c DIORITE TO GABBRO
- 5e QUARTZ DIORITE
- 2c FELSIC VOLCANIC BRECCIA
- 2d FELSIC TUFF
- 2e SHEARED INTERMEDIATE TO FELSIC VOLCANIC
- 2f INTERMEDIATE VOLCANIC BRECCIA
- 1a MASSIVE TO FOLIATED ANDESITE TO BASALT

ASSAY RESULTS

	Au	Au	Check	Cu
	PPB	PPB	PPB	PPM
96 TMG 1	147	-	-	136
96 TMG 2	19800	19543	-	37
96 TMG 3	720	-	-	16
96 TMG 4	1730	1920	-	322
96 TMG 5	192	-	-	76
96 TMG 6	1306	1234	-	308
96 TMG 7	50	-	-	34
96 TMG 8	84	-	-	48
96 TMG 9	51	53	-	28
96 TMG 10	14	-	-	174
96 TMG 11	15	-	-	436
96 TMG 12	3	-	-	22

2.17571

SCALE 1:2500

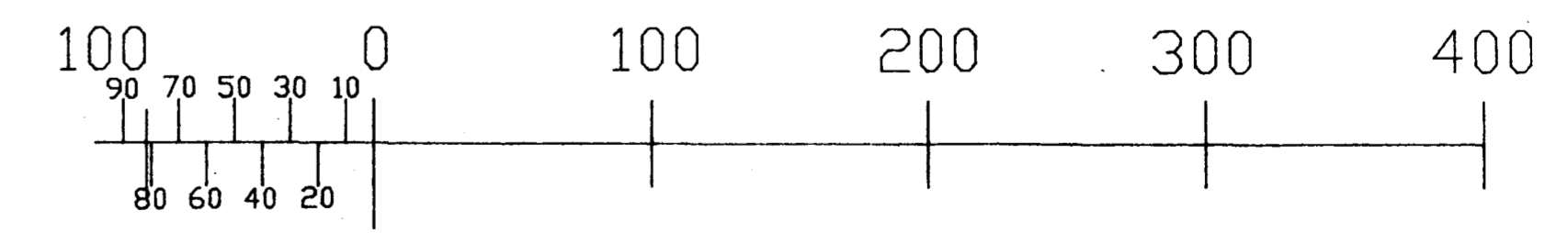

DIAMOND ROCK RESOURCES
 TITLE: 1165520-1165523
 DATE: AUGUST 18, 1996.
 DRAWN BY: BART WILSON
 LOCATION: STRATHY TWP.

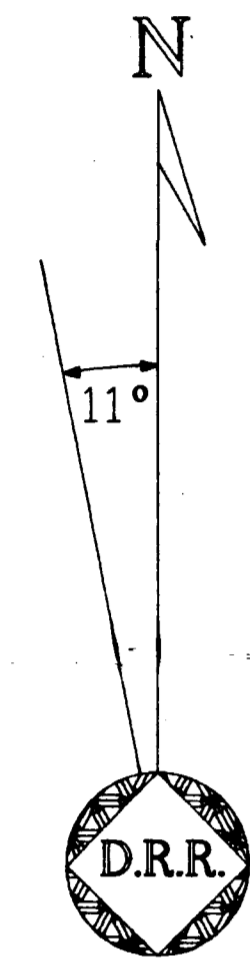
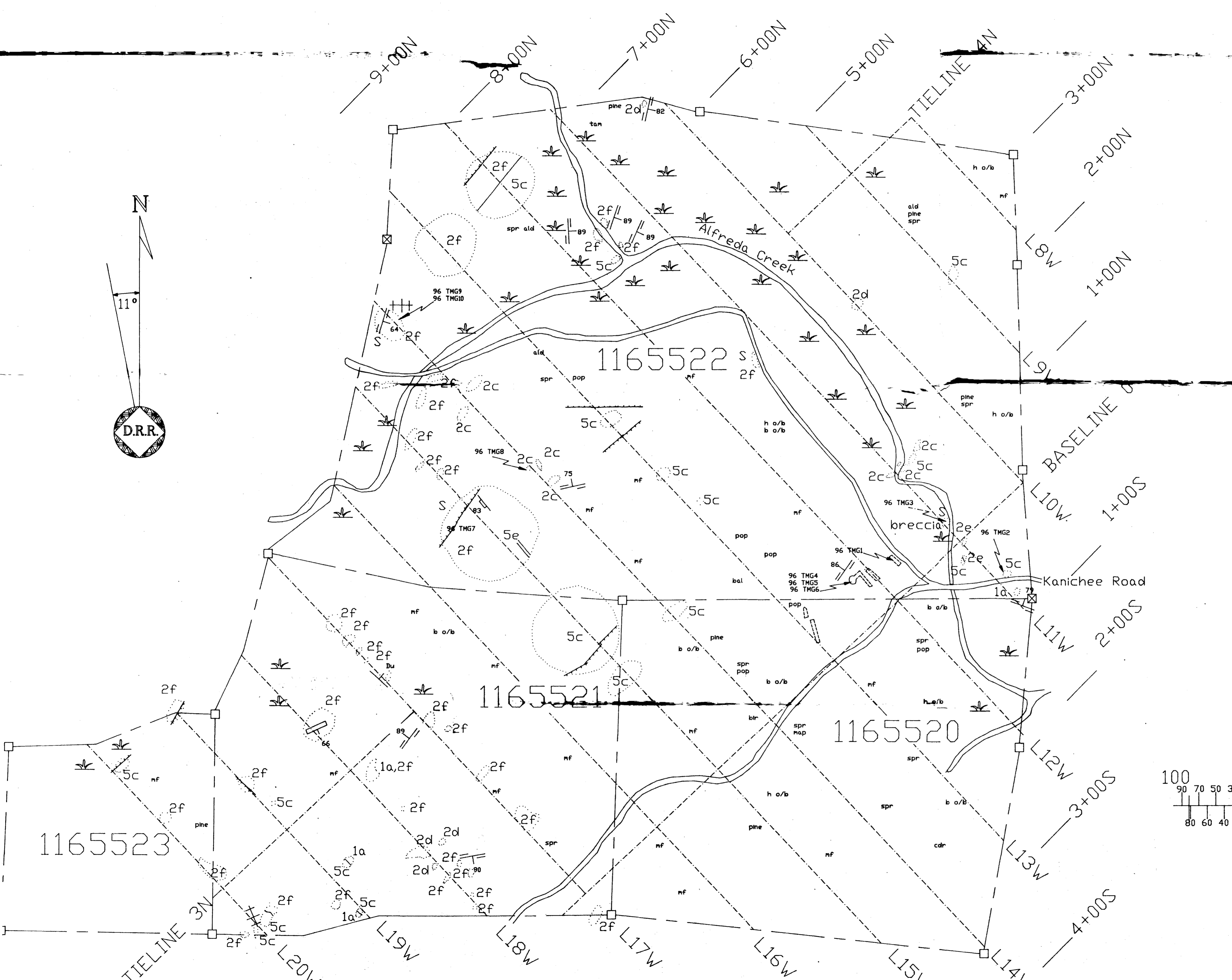

REPORT FOR THIS MAP WAS WRITTEN BY KATHERINE SMUCK.

