

2

PROSPECTOR REPORT
KING CLAIM
1200808
STRATHY TOWNSHIP
SUDBURY MINING DIVISION
DISTRICT OF NIPISSING

October. 23, 2002

Douglas King
254 Eighth Ave.
Kitchener, Ontario
N2C 1S7



31M04SW2057 2.24473

STRATHY

010

TABLE OF CONTENTS

INTRODUCTION. 3

GENERAL GEOLOGY 4

PRESENTATION OF FIELD OBSERVATIONS 5

MINERALIZATION 6

CONCLUSIONS AND RECOMMENDATIONS 7

CERTIFICATE 7

ASSAYERS' CERTIFICATES 8

FIGURES

1. REGIONAL LOCATION 1

2. CLAIMS LOCATION 2

4. SKETCH MAP: GEOLOGY, TRAVERSES, SAMPLE LOCATIONS
(Back Pocket)

5. SKETCH MAP: ASSAY SAMPLE LOCATIONS
(Back Pocket)

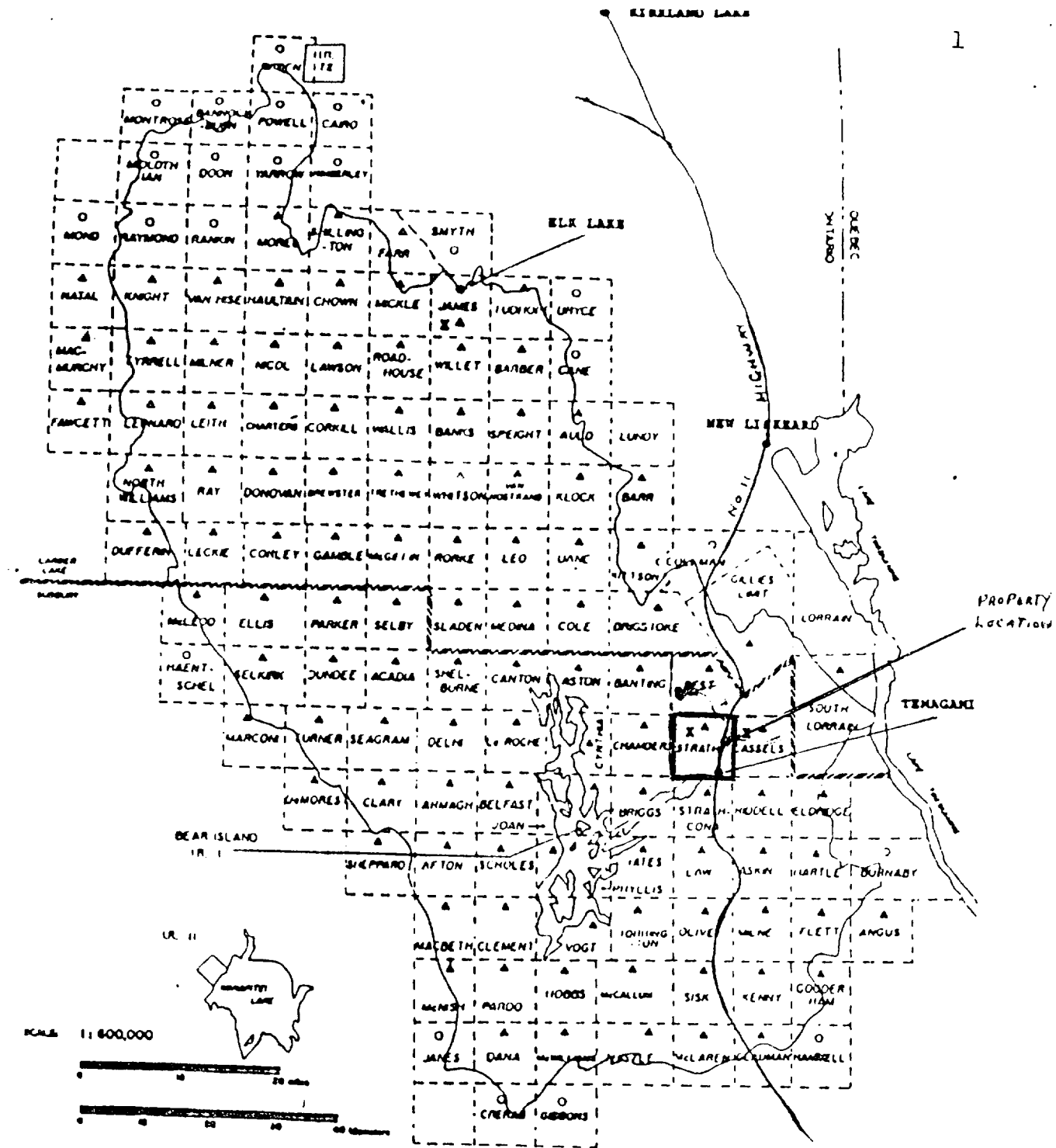

Figure 1
REGIONAL LOCATION

INTRODUCTION

Claim 1200808 is a single unit claim in the north east corner of Strathy Township, east of No. 11 Highway and Temagami North, on the west shore of Net Lake.

See regional and claim map locations, Figures 1,2.

Owner of claim: Douglas King
254 Eighth Ave.
Kitchener, Ontario, N2C 1S7

Previous work was reported by D. King Prospector, in 1998 and 2001.

GENERAL GEOLOGY

The O. G. S. Report 165, titled Geology of North Eastern Temagami Area, by G. Bennett, 1978, indicates on the geological map 2323, Chambers and Strathy Townships, a tongue of mafic to intermediate metavolcanic rocks extends into the northeast part of Strathy Township, partly into claim 1200808, intruded by the Strathy -Chambers batholith in the north and the south

PRESENTATION OF FIELD OBSERVATIONS

The field data is presented on a map at a horizontal scale of 1cm to 25m (Figures 4, 5, back pocket).

The dates compiling, recutting claim lines, prospecting, traversing, geological sampling on claim 1200808, are as follows:

2002

Oct. 6, Start cutting claim lines.

Oct. 7, Continue recutting claim lines.

Oct. 8, Prospecting traverses, geological sampling, collect samples for assay.

Oct.10 Prospecting traverses, geological sampling.

Filed survey conducted by D.King.

D.King
Oct. 23, 2002

6

MINERALIZATION

To date anomalous assays of gold, silver, copper and nickel.

D. King
Oct. 23, 2002

7

CONCLUSIONS AND RECOMMENDATIONS

Conduct geophysical E.M. and I. P. surveys in conjunction with the owners of the adjoining claims.

Respectfully submitted,

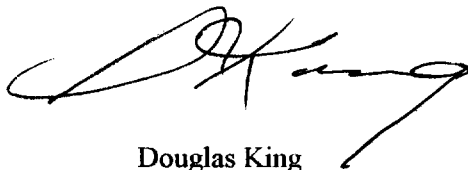
A handwritten signature in black ink, appearing to read 'D. King', written in a cursive style.

Douglas King
Bona Fide Prospector

Oct. 23, 2002



CERTIFICATE OF ANALYSIS



Geoscience Laboratories (Geo Labs)
 933 Ramsey Lake Road, Bldg A4
 Sudbury, ON P3E 6B5
 Phone: (705) 670-5637
 Toll Free : 1-866-436-5227
 Fax: (705) 670-3047

Issued To : Mr. D King Consultant 254 8th Avenue Kitchener, ON N2C 1S7 Canada	Certificate Date : 11/26/2002 Certificate No. : 12834 Project Number : n/a Geo Labs Job No. : 02-0272 Submission Date : 10/15/2002
Phone : 519-893-1405 Fax : - E-Mail : - Client No. : 549	Delivery Via : MAIL QC Requested : NO

Method Code reported with this certificate : **IM-100**

Method Code	Description	Qty	Status
GFA	Gravimetric Fire Assay	1	COMPLETE
IM-100	ICP_MS Total Digestion	1	COMPLETE

2.24473

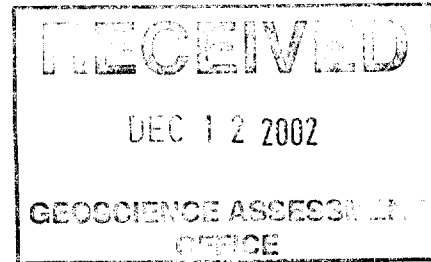

Legend:

N.R. = Analysis not requested
 N.D.= Not detected
 N.M. = Not measured

Please refer to Geo Labs Job No. 02-0272 if you have any questions.

CERTIFIED BY

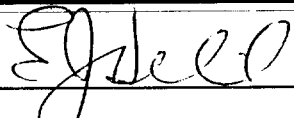
 Date : November 26, 2002

Ed Debicki, Laboratory Manager

Except by special permission, reproduction of these results must include any qualifying remarks made by this Ministry with reference to any sample.
 Results are for samples as received.

9501 RAMSEY LAKE RD 270-01698
 NUMBER

GEOSCIENCE LABORATORIES CERTIFICATE OF ANALYSIS



CLIENT : King
GL JOB # : 02-0272
DATE : 11/04/2002
METHOD CODE : GFA



Client ID	Ag	Au
Units	oz/ton	oz/ton
Detection Limit	0.10	0.010

KB-7-808	0.5	0.06
----------	-----	------



GEO SCIENCE LABORATORIES CERTIFICATE OF ANALYSIS



CLIENT : King
Geo Labs JOB # : 02-0272
DATE : 11/26/2002
METHOD CODE : IM-100

Client ID	Ag	Au	Ti	Li	Be	Mg	Al	Ca	Sc	V	Cr	Mn
Units	ppm	ppm	ppm	ppm	ppm	ppm	ppm	ppm	ppm	ppm	ppm	ppm
Detection Limit	0.500	0.0500	10.0	1.00	2.00	20.0	100	100	0.500	1.00	1.00	0.100
KB-7-808	N.M.	N.M.	3728.15	28.31	N.D.	23851.20	41427.80	24706.50	15.46	98.07	>500.00	578.10

Client ID	Fe	Co	Ni	Cu	Zn	Ga	Rb	Sr	Y	Zr	Nb	Mo
Units	ppm	ppm	ppm	ppm	ppm	ppm	ppm	ppm	ppm	ppm	ppm	ppm
Detection Limit	5.00	1.00	5.00	2.00	5.00	1.00	1.00	2.00	0.0500	1.00	0.0200	1.00
KB-7-808	91545.20	45.59	96.55	>1000.00	85.20	15.82	81.19	109.35	18.18	97.82	6.95	4.44

Client ID	Cd	Sn	Sb	Cs	Ba	La	Ce	Pr	Nd	Sm	Eu	Gd
Units	ppm	ppm	ppm	ppm	ppm	ppm	ppm	ppm	ppm	ppm	ppm	ppm
Detection Limit	1.00	0.100	0.500	0.100	5.00	0.200	0.200	0.200	0.500	0.500	0.200	0.300
KB-7-808	N.D.	2.47	N.D.	10.81	321.45	13.07	24.51	3.10	12.66	2.96	1.05	2.99

Client ID	Tb	Dy	Ho	Er	Tm	Yb	Lu	Hf	Ta	W	Hg	Tl
Units	ppm	ppm	ppm	ppm	ppm	ppm	ppm	ppm	ppm	ppm	ppm	ppm
Detection Limit	0.500	0.300	0.200	0.0500	0.300	0.500	0.0100	0.0100	0.500	0.0500	n/a	0.300
KB-7-808	0.52	2.79	0.61	1.65	N.D.	1.71	0.24	2.61	N.D.	0.38	N.M.	0.74

Client ID	Pb	Th	U
Units	ppm	ppm	ppm
Detection Limit	0.100	0.500	0.0300

KB-7-808	28.59	2.05	1.04
----------	-------	------	------

Work Report Summary

Transaction No: W0270.01698 Status: APPROVED
Recording Date: 2002-NOV-07 Work Done from: 2002-SEP-06
Approval Date: 2002-DEC-12 to: 2002-SEP-10

Client(s):
152217 KING, DOUGLAS F

Survey Type(s):
ASSAY PRECUT PROSP

Work Report Details:

Claim#	Perform	Perform Approve	Applied	Applied Approve	Assign	Assign Approve	Reserve	Reserve Approve	Due Date
S 1200808	\$1,260	\$1,260	\$600	\$600	\$0	0	\$660	\$660	2003-NOV-15
	\$1,260	\$1,260	\$600	\$600	\$0	\$0	\$660	\$660	

External Credits: \$0

Reserve: \$660 Reserve of Work Report#: W0270.01698

\$660 Total Remaining

Status of claim is based on information currently on record.



31M04SW2057 2.24473 STRATHY

900

Date: 2002-DEC-12

GEOSCIENCE ASSESSMENT OFFICE
933 RAMSEY LAKE ROAD, 6th FLOOR
SUDBURY, ONTARIO
P3E 6B5

DOUGLAS F KING
254 8TH AVENUE
KITCHENER, ONTARIO
N2C 1S7 CANADA

Tel: (888) 415-9845
Fax: (877) 670-1555

Submission Number: 2.24473
Transaction Number(s): W0270.01698

Dear Sir or Madam

Subject: Approval of Assessment Work

We have approved your Assessment Work Submission with the above noted Transaction Number(s). The attached Work Report Summary indicates the results of the approval.

At the discretion of the Ministry, the assessment work performed on the mining lands noted in this work report may be subject to inspection and/or investigation at any time.

If you have any question regarding this correspondence, please contact STEVEN BENETEAU by email at steve.beneteau@ndm.gov.on.ca or by phone at (705) 670-5855.

Yours Sincerely,



Ron Gashinski
Senior Manager, Mining Lands Section

Cc: Resident Geologist

Douglas F King
(Claim Holder)

Assessment File Library

Douglas F King
(Assessment Office)



MINING LAND TENURE MAP

Date / Time of Issue Nov 18 2002 14:08h Eastern
TOWNSHIP / AREA PLAN
STRATHY G-3461
ADMINISTRATIVE DISTRICTS / DIVISIONS
Mining Division Sudbury
Land Titles/Registry Division NIPISSING
Ministry of Natural Resources District NORTH BAY

TOPOGRAPHIC and LAND TENURE legends. Includes symbols for Administrative Boundaries, Topographic, Concession, Lot, Private Fee, etc. and Land Tenure Withdrawals descriptions.

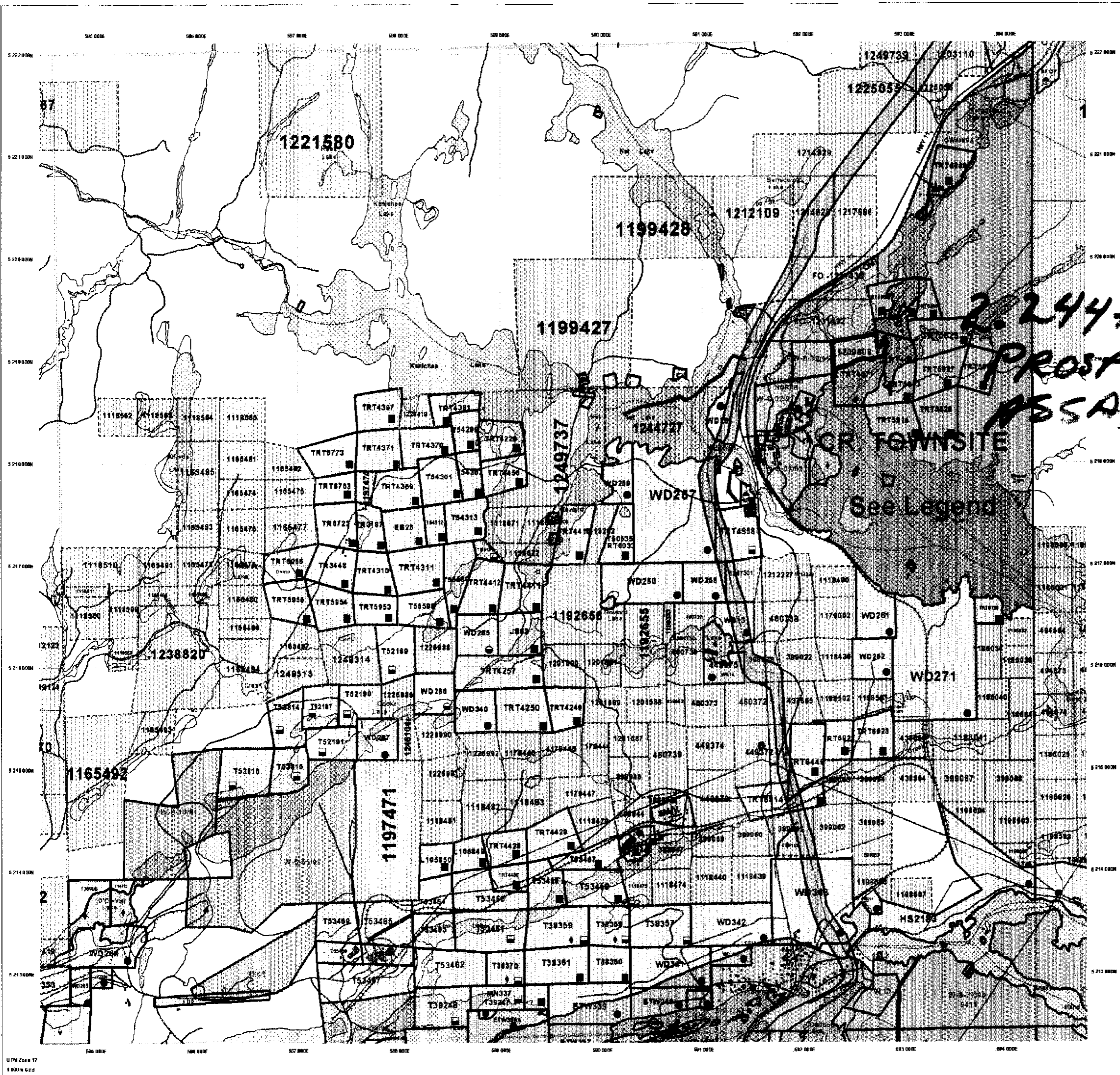

2-24473
PROSP
ASSAY
See Legend

LAND TENURE WITHDRAWAL DESCRIPTIONS

Table with columns: Withdrawal No., Type, Date, Description. Lists various withdrawal areas and their corresponding dates and descriptions.

General Information and Limitations
This map is not a registered land tenure and interests in land including certain interests, easements, rights of way, mining rights, etc.

31M04SW2057 2.24473
STRATHY



NET LAKE

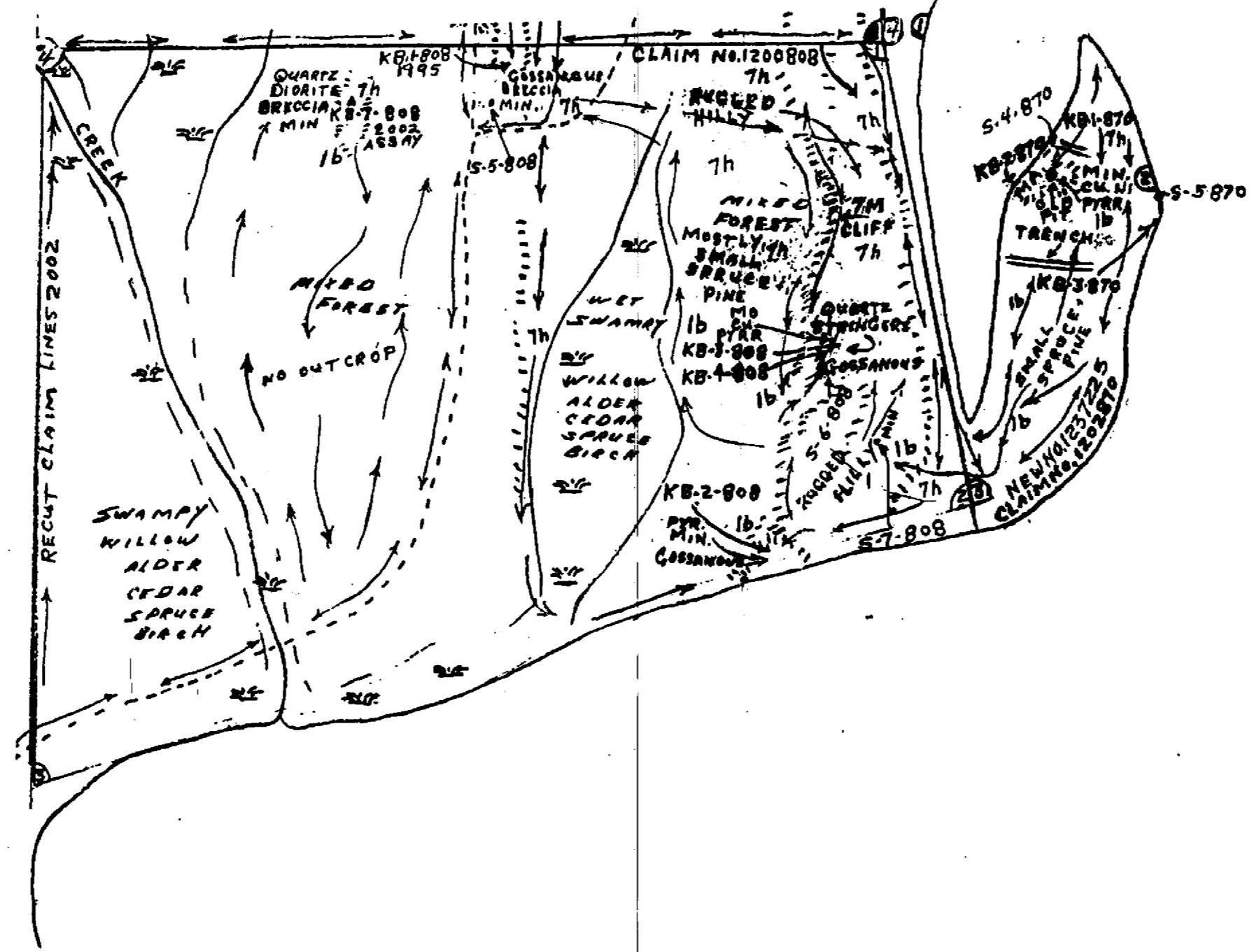

SYMBOLS

- TRAILS
- ROCK OUTCROP
- TRAVERSES
- ASSAY SAMPLE NO.
- PIT
- TRENCH
- SHAFT
- MUSKEG OR SWAMP

ABBREVIATIONS

- Mo. - MOLYBDENITE
- Cu. - COPPER
- Pyr. - PYRITE
- Min. - MINERALIZED
- Ma. - MAGNETIC ATTRACTION
- Pyrr. - PYRRHOTITE

LEGEND SOURCE GEOLOGICAL MAPS

- 8** MAFIC INTRUSIVE ROCKS
- 7** GRANITIC PLUTONIC ROCKS
 - b QUARTZ MONZONITE
 - a QUARTZ DIORITE, GRANODIORITE, (CONTAMINATED PHASES)
- 6** HYPABYSSAL FELSIC INTRUSIVE ROCKS
 - b QUARTZ PORPHYRY
 - c QUARTZ FELDSPAR PORPHYRY
- 5** INTERMEDIATE TO ULTRAMAFIC INTRUSIVE ROCKS
- 1** MAFIC TO INTERMEDIATE METAVOLCANICS
 - a MASSIVE TO FOLIATED ANDESITE AND BASALT
 - b PORPHYRITIC ANDESITE AND BASALT
 - d FINE GRAINED AMPHIBOLITE HORNFELS

FIGURE 4.
CLAIM PLAN
STRATHY T.W.P.
DISTRICT OF NIPPISSING



D KING
1998-2000-2

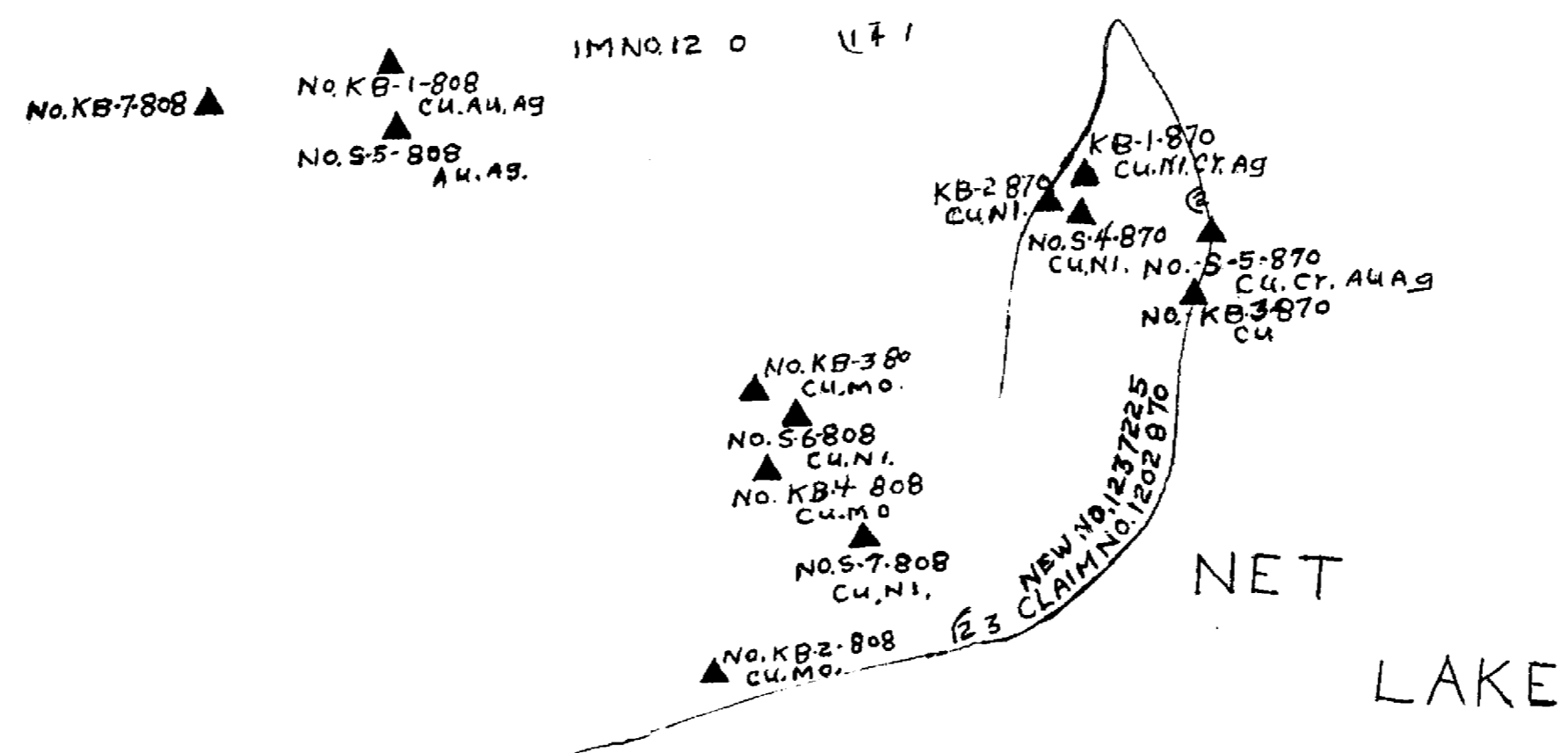
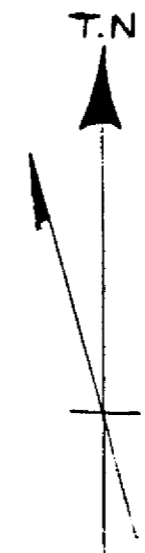

ANOMALOUS MI ERA. VALUES
FIGUR 5
 ASSAY SAMPLE LOCATIONS
 WITH NUMBERS
 CLAIMS-12008081237225
 STRATHY T.WP.
 DISTRICT O NIPISSING

ABBREVIATIONS
 AU-GOLD
 AG-SILVER
 CU-COPPER
 NI-NICKEL
 CR-CHROMIUM
 MO-MOLYBDENUM

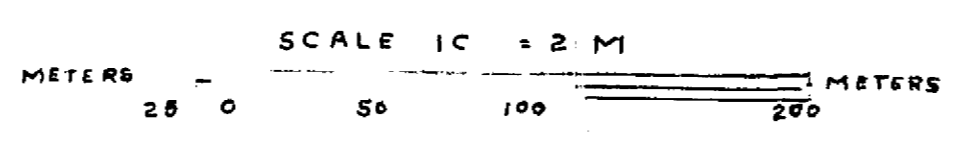

D. KING
1995-2000-2

