



31M04SW9746 2.14974 STRATHY

010

2.14974

STRATHY PROJECT

REPORT ON EXPLORATION ACTIVITIES
PERFORMED UNDER O.P.A.P. 1992-93

STRATHY TOWNSHIP

SUDBURY MINING DIVISION, PROVINCE OF ONTARIO

Bjarne Westin

OPAP 92-594

January, 1992

RECEIVED

APR 07 1993

MINING LANDS BRANCH



31M045W9746 2.14974 STRATHY

010C

TABLE OF CONTENTS

STRATHY PROJECT

1.0 INTRODUCTION
2.0 LOCATION AND ACCESS
3.0 PROPERTY DESCRIPTION
4.0 TOPOGRAPHY
5.0 PREVIOUS WORK
6.0 GENERAL GEOLOGY
6.1 ECONOMIC GEOLOGY
7.1 LINECUTTING
7.2 MAGNETOMETER SURVEY
7.3 VLF SURVEY
7.4 SOIL SAMPLING
7.5 PROSPECTING
8.0 RECOMMENDATIONS
9.0 CERTIFICATE OF QUALIFICATIONS
10.0 REFERENCES

APPENDIX I ASSAY CERTIFICATES

List of Figures and Graphs

Figure 1 Property Location
Figure 2 Strathy Township Claim Map
Figure 3 Lithological Units Strathy Township
Figure 4 Geology Map of Strathy Township
Figure 5 Soil Sampling, Table of Assays and Locations

Graph 1 Soil Sampling, Gold Distribution

Back Pocket Maps

Strathy Project, Location Map, East and West Grids
Strathy Project, Magnetometer Survey
Strathy Project, VLF-EM Survey, Dip Angle Profiles, Cutler Maine.
Strathy Project, VLF-EM Survey, Dip Angle Profiles, Annapolis,
Maryland
Strathy Project, Soil Sampling - B Horizon Gold

1.0 INTRODUCTION

The 1992 exploration program was made possible by the Ontario Prospectors Assistance Program (OPAP) as administered by the Ontario Ministry of Northern Development and Mines. The program was financed by the OPAP grant to the author, Bjarne Westin (file 1992-594).

The program was designed to explore for possible mineralized zones on claims in Strathy Township, using geophysical, geological, and geochemical techniques.

2.0 LOCATION AND ACCESS

The property is located in Strathy Township, District of Timiskaming, NTS 31 M/4, in the Sudbury Mining Division.

Access is by the Kanichee Mine road which turns west off Highway 11 approximately 4.5 kilometres north of the town of Temagami. Following the Kanichee road, proceed approximately 4 kilometres to the old Kanichee Mine workings. Continue southerly another 1.5 kilometres until reaching a sharp westerly curve in the road. Adjacent this corner is the East Grid Baseline 0 - Station 0.

The West Grid baseline is a further 450 metres westerly along the road. Upon crossing Alfreda creek, the road forks to the northwest and southwest. The station at Baseline 0, 11+75 West is located adjacent this fork.

COBALT RESIDENT GEOLOGIST'S AREA

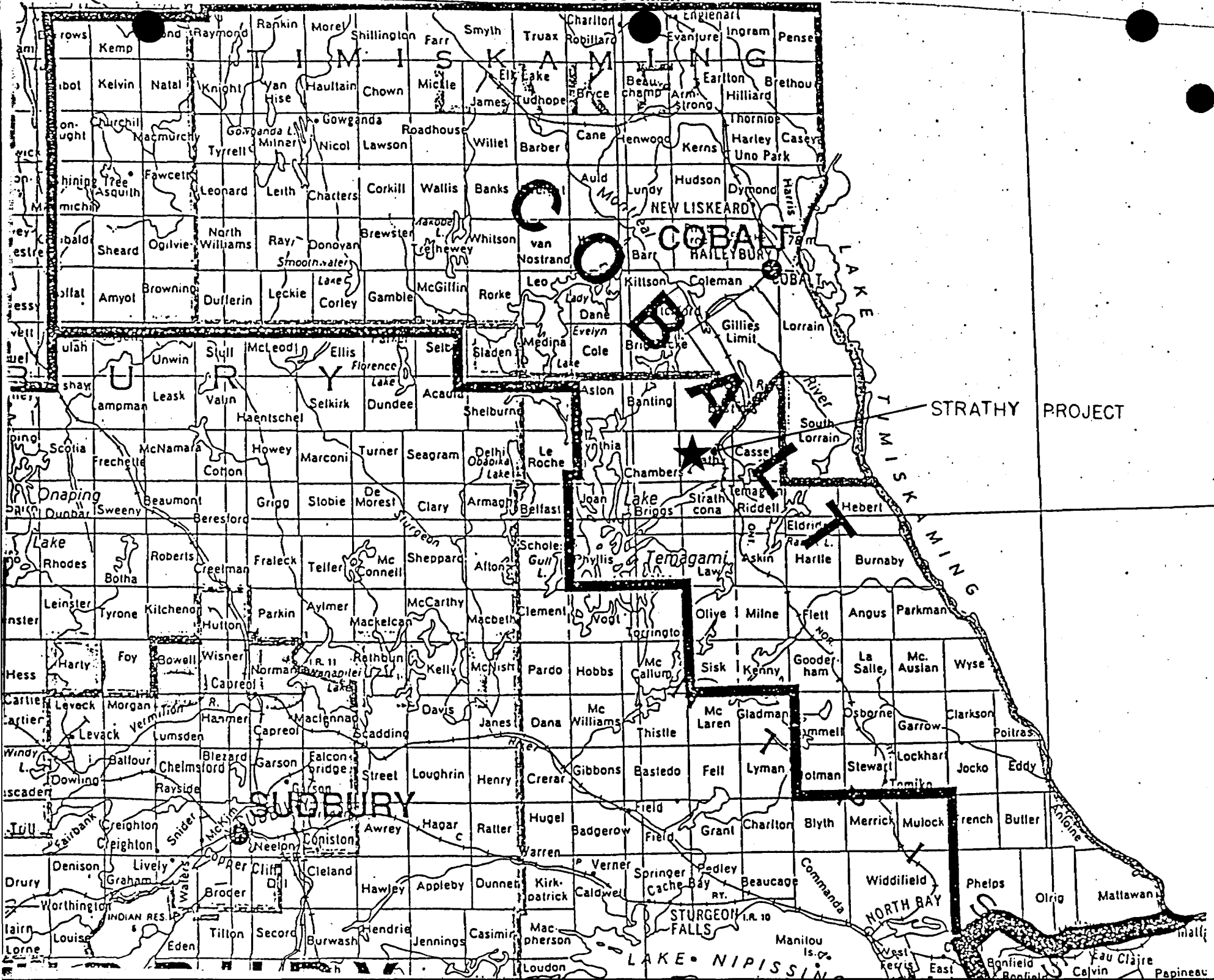

3.0 PROPERTY DESCRIPTION

The Strathy Township property is held by the author, Bjarne A. Westin of New Liskeard.

The East Grid block consists of three contiguous, single unit, unpatented mining claims numbered 1165517, 1165518, 1165519. The West Grid claim group consists of three single unit claims numbered 1165520, 1165521, and 1165523, and one four unit claim numbered 1165522.

See Figure 2, Strathy Township Claim Map.

4.0 TOPOGRAPHY

The terrain has moderate relief, the highest hills on the property being in the range of 30 metres.

Good drainage of the property area is provided by Alfreda Creek which passes through both grid areas.

Jack pine, poplar, and birch dominate the higher ground, while cedar, black spruce, and tag alders dominate lower areas. Several one hectare to five hectare spruce reforestation plantations are scattered throughout the claims.

CHAMBERS TOWNSHIP



Ministry of Natural Resources
Ministry of Northern Development and Mines

INDEX TO LAND DISPOSITION

PLN
G-3451
TOWNSHIP
STRATHY

M.N.R. ADMINISTRATIVE DISTRICT
TEMAGAMI
MINING DIVISION
SUDBURY
LAND TITLES/REGISTRY DIVISION
NIPISSING

5.0 PREVIOUS WORK

There has been little exploration work carried out on these claims since the early 1970's because of the Bear Island - Temagami Indian Land Caution. The current claims were staked in January and June of 1992 as the lands in three local townships were released from the caution area.

Several exploration programs prior to the land caution included portions of the current property. Some of these reports are as follows:

1964 Keevil Consultants Ltd.

Doris Lake Group, Self Potential Survey. A 300 millivolt self potential survey was outlined 100 metres south of Alfreda Creek in claim 1165517.

1965 Keevil Mining Ltd.

Geological mapping, sampling, trenching. Trench assays of up to 0.56 oz / ton gold over 5.4 feet in the southeast corner of claim 1165517 on the East Grid.

1973 Kanichee Mining Inc.

Magnetometer and VLF-EM surveys on ground including the area covered by the current West Grid claims.

6.0 GENERAL GEOLOGY

The property is underlain by steeply dipping, northeasterly striking, Archean aged metavolcanics. Numerous felsic to mafic sequences are known to exist throughout the area. It is thought that the contact of several of these sequences underlie the claim groups. Passing through the eastern claim group is the Vermillion Lake deformation zone, a regional zone of shearing associated with numerous gold, copper, and molybdenum occurrences.

Mafic to ultramafic gabbroic or peridotitic intrusives, resembling the Kanichee Mine intrusive, are present in both the East and West Grid areas.

See Figure 3, Table of Lithological Units for the Northeast Temagami Area, and Figure 4, Chambers and Strathy Townships Geology Map.

6.1 ECONOMIC GEOLOGY

The two claim blocks covered by the East and West Grids have good potential for several mineral deposit types.

Copper - Nickel

The past producing copper - nickel Kanichee Mine is located approximately one kilometre north of the East Grid claims. The Kanichee deposit is a massive sulphide deposit associated with mafic to ultramafic gabbroic intrusives. Similar intrusives are known to exist on the West Grid claim group and are inferred on the East Grid claims.

Gold

A gold showing was reported during the 1965 Keevil Mining geological mapping program. This showing was located in the southeast corner of the claim currently numbered 1165517 at the east end of the East Grid. Trenching and sampling produced assays of up to 0.56 oz / ton gold over a length of 5.4 feet.

Several old shafts and surface workings are present in the Strathy Township area. Included is the former Beanland prospect approximately 1500 metres east of the property. A shaft and extensive underground development are present dating from the 1940's. A 3000 tonne surface bulk sample was removed for test milling by Gwen Resources in March, 1992.

Massive Sulphides

The felsic - mafic metavolcanic assemblages through Strathy Township are potential hosts to polymetallic massive sulphide deposits. Felsic - mafic contacts are known on both claim groups covered in this report.

The Geological Society of Canada report "Open File 1091, Sudbury - Timmins- Algoma Mineral Program Project 4B, The

metamorphic Mineralogy and Chemical Alteration of the Temagami Greenstone Belt" indicates high mineralisation potential. Two separate statistical analyses of the lithogeochemical data in this report show high probabilities of sulphide mineralisation. Version 1 of these statistical analyses predicts a greater than 60 percent probability of mineralisation. The second version of the analyses indicates a greater than 70 percent probability of sulphide mineralisation.

TABLE 1

TABLE OF LITHOLOGIC UNITS FOR THE NORTHEAST TEMAGAMI AREA.

PHANEROZOIC

CENOZOIC

QUATERNARY

PLEISTOCENE AND RECENT

Swamp and stream deposits, till, sand and gravel

UNCONFORMITY

PALEOZOIC

CAMBRIAN

Carbonatite

INTRUSIVE CONTACT

PRECAMBRIAN

LATE PRECAMBRIAN

MAFIC INTRUSIVE ROCKS

Olivine diabase (Sudbury type), granophyric diabase, porphyritic diabase, intrusive breccia

INTRUSIVE CONTACT

MIDDLE PRECAMBRIAN

MAFIC INTRUSIVE ROCKS (NIPISSING TYPE)

Quartz diabase, gabbro, pegmatite-gabbro, diorite

INTRUSIVE CONTACT

HURONIAN SUPERGROUP

COBALT GROUP

Gowganda Formation

Polymictic paraconglomerate, greywacke, arkose, feldspathic quartzite, siltstone, argillite

UNCONFORMITY

EARLY PRECAMBRIAN (ARCHEAN)

MAFIC INTRUSIVE ROCKS

Diabase and gabbro dikes (Matachewan type), mafic chloritic dikes, biotite and hornblende-rich lamprophyre

INTRUSIVE CONTACT

INTERMEDIATE TO FELSIC INTRUSIVE ROCKS

GRANITIC PLUTONIC ROCKS

Quartz monzonite, porphyritic quartz monzonite, trondhjemite, hornblende trondhjemite, quartz diorite, hornblende quartz diorite, chlorite trondhjemite, granodiorite, leucogranite, aplite, pegmatite, agmatite, migmatite

INTRUSIVE CONTACT

HYPABYSSAL FELSIC INTRUSIVE ROCKS

Quartz porphyry, quartz-feldspar porphyry, hornblende-feldspar porphyry, feldspar porphyry

INTRUSIVE CONTACT

INTERMEDIATE TO ULTRAMAFIC INTRUSIVE ROCKS

Diorite, quartz diorite, gabbro, quartz gabbro, serpentinite, pyroxenite

INTRUSIVE CONTACT

METAVOLCANICS AND METASEDIMENTS

DETRITAL METASEDIMENTS

Volcanic wacke, volcanic conglomerate, lithic greywacke, siltstone, slate, tuffaceous sandstone, conglomerate, carbonatized and sheared metasediments

IRON FORMATION

Banded silicate-oxide facies, sulphide facies

FELSIC TO INTERMEDIATE METAVOLCANICS

Dacite, rhyodacite, rhyolite; felsic volcanic breccia, tuff-breccia, tuff and lapilli tuff; intermediate volcanic breccia, tuff-breccia, lapilli-tuff and crystal tuff; carbonatized metavolcanics; minor andesite and agglomerate

MAFIC TO INTERMEDIATE METAVOLCANICS

Pillowed, porphyritic, amygdaloidal and massive basaltic and andesite flows; mafic lapilli-tuff and agglomerate; amphibolite and hornfels

7.1 LINECUTTING

Two control grids, East and West, were cut covering the east and west claim groups. These grids provide location control for the various geotechnical surveys conducted.

The East grid was cut between June and August, 1992. The West Grid was cut in January 1993.

The East Grid consists of an 1100 metre east - west baseline with twelve north - south transect lines at 100 metre intervals. Line 0 East was displaced to 0+25 metres east on the baseline to circumvent a stretch of Alfreda Creek. The total length of the twelve transect lines is 4580 metres.

The West Grid has a 740 metre baseline oriented northeast - southwest (045 degrees). Eight transect lines at 315/135 degrees were cut at 100 metre intervals. The transect lines are numbered 10+00 West to 17+00 West from east to west. Two tielines, both parallel to the base lines, were cut to allow full coverage of the claim block. Tieline 400 North is located northeast of Line 10, 400 m north. Transect lines 9+00 West and 8+00 West were cut along this two hundred metre tieline. Tieline 3+00 North extends 325 metres southwest of Line 17+00 W, 3+00 N. Lines 18+00 W to 20+00 W are located along tieline 3+00 N.

7.2 MAGNETOMETER SURVEY

A total field ground magnetometer survey was carried out by the author using a Barringer GM-122 Ground Magnetometer. The survey covered 15.225 line kilometres with 649 station readings recorded. Readings were taken at 25 metre intervals. Additional readings at 12.5 metre intervals were taken where warranted by large changes in the magnetic fields.

Survey dates were January 18, 20, and 26, 1993.

Diurnal drift was levelled by looping survey methods, using repeated readings along the baselines and correcting in a linear manner.

The values have been plotted on a plan of 1:2500 scale and contoured at 25 gamma intervals (see back pocket map, Magnetometer Survey). The background datum is 57000 gammas.

Discussion

East Grid

A 150 m to 250 m wide, linear trend of magnetically contrasting bands is noted striking east north east from Line 0 E, 200 S to Line 11 E, 300 N. This trend is thought to reflect the strike of the underlying metavolcanic flows.

Two areas of slightly elevated magnetic values are located in the southwest part of the East Grid. One is centred around Lines 6 E and 7 E at the baseline (0N). The second area is in the southeast corner of the grid, being south and east of Line 9 E, 25 S and Line 11 E, 100 N.

North of station 325 N on Lines 7 E to 10 E the magnetic signature is moderately (50 to 100 gammas) lower.

West Grid

Several areas of high magnetic fields are present on the West Grid.

The largest of these anomalies is located on Lines 14 W and 15 W, between the baseline and 250 m north. The peak field readings are over 2500 gammas above the background values. A similar anomaly exists on Lines 14 W and 15 W between 250 S and 300 S. The extent of this anomaly is unknown as it appears to continue beyond the south boundary of the claim block. Two other much smaller anomalies exist at Line 10 W, 362 N, and on Baseline 0 at 11+00 W. These anomalies are thought to be the result of gabbroic intrusions, as indicated on the Chambers and Strathy Twp Geology Map (ODM Map 2323).

A northeast striking highly magnetic trend is observed on Lines 19 W and 20 W. This anomaly is interpreted as representing a northwest trending Sudbury type olivine diabase dike.

The alternating patterns of 25 to 50 metres wide bands ranging

from 57400 to 57600 gammas display the northeasterly geological trend of the metavolcanics. This northeast trend has occasional displacements, possibly due to north - south faulting.

7.3 VLF ELECTROMAGNETIC SURVEY

VLF-EM surveys were conducted in January, 1993 on both the East and West Grids.

West Grid Surveys

A VLF-EM survey was conducted by the author from January 21 to 23, 1993. The instrument used was a Geonics EM-16.

Two surveys were carried out, using the transmitter stations at Cutler, Maine (NAA 24.0 kHz) and Annapolis, Maryland (NSS 21.4 kHz).

Station intervals for the readings was 25 metres. 344 readings on both frequencies were taken over 8.28 line kilometres.

Readings were taken as in phase percentages. These percentages were later converted to dip angle readings before plotting.

Discussion

Cutler, Maine

Eleven conductors were identified on the West Grid by the Cutler, Maine survey. These conductors have been labelled G through S on the back pocket map "VLF-EM Survey, Dip Angle Profiles, Station : Cutler Maine".

Conductor G is a possible overburden conductor, located near the edge of a swamp.

Conductor H coincides with an east north east striking magnetic low.

Conductor J may be an overburden response, although a significant magnetic contrast lies under the creek and swamp bed.

Conductors K, Q and R may represent a north - south fault zone along the eastern edge of the claim block.

Conductors L, M, and P all tend to follow local magnetic

trends, and may represent geological contacts or faults.

Conductor N coincides with the southern margin of the large magnetic anomaly in the south central part of the claim block.

Conductor S is coincidental to the magnetic anomaly in the southeast corner of the claim block.

Annapolis, Maryland Survey

Six separate conductors were identified in the Annapolis Transmitter VLF-EM survey. These conductors have been labelled A through F on the back pocket map "VLF-EM Survey, Dip Angle Profiles, Station : Annapolis, Maryland.

Anomalies A, B, and C are all coincidental with creeks and swamps, indicating overburden responses.

Conductors D and E are probable bedrock conductors, associated with the flanks of the large magnetic anomaly in the south central part of the claim group.

Conductor F coincides with the magnetic anomaly in the south east corner of the claim block.

East Grid Survey

A VLF-EM survey was conducted on the East Grid claim block on January 26 by Glenn McBride of New Liskeard, Ontario. The instrument used was a Crone Radem.

201 stations were taken at 25 metre intervals over 5.68 line kilometres. The transmitter station used was Cutler, Maine (NAA 24.0 kHz). Readings were taken as dip angles.

Discussion

Three separate conductors were identified on the East Grid by the VLF-EM survey.

Conductor T strikes east north east across the entire length of the three claims. The conductor runs from Line 0, 225 S to Line 11 E 225 N. This conductor is thought to represent the regional

fault shown on ODM Map 2323. This fault runs from the Chambers - Strathy boundary northeasterly through Alfreda Creek, Net Lake, and continuing along Highway 11 off the map sheet.

Conductor U is coincidental with a spot magnetic low at 425 N on Line 10 W.

Conductor V coincides with the magnetic contrast on Lines 10 E and 11 E between 75 N and 100 N. A geological contact is indicated. This conductor may represent the Self Potential Survey anomaly identified in the 1964 Keevil Consultants Ltd., Doris Lake Group report.

7.4 SOIL SAMPLING

A limited soil sampling program was carried out on the Strathy Township claims in an attempt to locate the previously reported gold showing.

A total of 41 "B" horizon soil samples were collected on October , 1992 on claim 1165517, along lines 9 to 11 East.

See Figure 13, Soil Sampling Table of Assays and Locations.

Results

All 41 soil samples were analyzed for gold. Table 1, "Soil Sampling Results", provides a summary of the sample numbers, locations, and analyses of these samples. Assay values ranged from 6 to 12 parts per billion (ppb). None of the results are considered anomalous.

Graphs 1 is a bar graph showing the distribution of gold assays. Also given on the graph are some basic statistical data including the mean, standard deviation, and an "Anomaly Threshold" which has been calculated as two times the mean plus one standard deviation.

Table 1
Strathy Project Soil Sampling

Sample No.	Line East	Station	Gold ppb
T1	9	50 N	12
T2	9	75 N	8
T3	9	100 N	10
T4	9	125 N	8
T5	9	150 N	10
T6	9	162 N	12
T7	9	237 N	8
T8	9	285 N	10
T9	9	300 N	8
T10	9	325 N	8
T11	9	350 N	6
T12	9	365 N	8
T13	9	400 N	10
T14	9	425 N	12
T15	9	450 N	8
T16	10	475 N	12
T17	10	450 N	12
T18	10	425 N	8
T19	10	400 N	10
T20	10	375 N	12
T21	10	300 N	8
T22	10	275 N	10
T23	10	0 N	12
T24	10	25 S	12
T25	10	50 S	6
T26	10	62 S	8
T27	10	75 S	12
T28	10	95 S	10
T29	11	165 N	10
T30	11	150 N	10
T31	11	125 N	10
T32	11	100 N	8
T33	11	75 N	8
T34	11	50 N	12
T35	11	0 N	10
T36	11	25 S	12
T37	11	50 S	10
T38	11	67 S	8
T39	11	75 S	12
T40	11	87 S	10
T41	0	0	10

7.5 PROSPECTING

One day was spent July 21, 1992 by B. Bernstein and the author prospecting on claim 1165517. Two grab samples were collected and assayed from the southeast corner of claim 1165517.

Location	Sample No	Au ppb	Silver ppm	Copper ppm	Lead ppm	Zinc ppm
11+15E, 70S	28501	62	3.0	63	65	139
11+15E, 65S	28502	8	0.4	9	96	46

Descriptions

Sample 28501, grab sample, medium green, very fine grained mafic to intermediate metavolcanics, rusty, up to 5 percent fine grained pyrite.

Sample 28502 felsic volcanic, coarse grained, moderately carbonatitic, slightly rusty appearance, trace to one percent pyrite.

8.0 RECOMMENDATIONS

Further investigations of the non-overburden VLF-EM conductors is warranted. Additional geophysical surveys such as vertical loop, induced polarization, or other advanced EM method would more clearly categorize the VLF anomalies.

Detailed surface mapping, prospecting and soil sampling are required to assess the mineral potential of the two claim blocks.

9.0 CERTIFICATE OF QUALIFICATIONS

I, Bjarne A. Westin, of 1455 Lakeshore Road, Haileybury, Ontario, do hereby certify that:

- I. I am a graduate of the University of Western Ontario and hold a B.Sc. degree in geology (1986).
- II. I have been engaged as a geologist in the mining and exploration industry for seven years.
- II. I have personally conducted or supervised the fieldwork as indicated within this report.

Bjarne A. Westin, B.Sc.

10.0 REFERENCES

Beswick, A.E., and James, R.S.

1984, Sudbury - Timmins - Algoma Mineral Program Project 4B, The metamorphic Mineralogy and Chemical Alteration of the Temagami Greenstone Belt, Geological Society of Canada, Open File Report 1091.

Beard, R.C.

1973 Report on the Magnetometer Survey and VLF-EM Survey for Kanichee Mining Inc. Cobalt Resident Geologists Office Assessment Files.

Bennett, G.

1978, Geology of the Northeast Temagami Area, Ontario Geological Survey Report 163

Downie, I.F.

1963, Report on Geological Mapping and Exploration, Doris Lake Group, Strathy Township, for Keevil Consultants. Cobalt Resident Geologists Office Assessment Files.

Frantz, J.C.

1964, Report on Self Potential Survey, Doris Lake Group, Strathy Township, for Keevil Consultants, Cobalt Resident Geologists Office Assessment Files.

Dates of work performed.

Bjarne A. Westin
1455 Lakeshore Rd
New Liskeard, Ontario

June	8	Linecutting
	11	"
	18	"
	22	"
	23	"
July	7	"
	8	"
	15	"
	21	Prospecting
	22	Linecutting
	23	"
Oct	22	Soil Sampling
Jan	6	Linecutting
	8	"
	12	"
	13	"
	14	"
	15	"
	16	"
	17	Map, Report preparation
	18	Magnetometer Survey
	19	Linecutting
	20	Magnetometer Survey
	21	VLF-EM Survey
	22	"
	23	"
	24	Data plotting
	25	Data plotting, drafting
	26	Magnetometer Survey
	27	Data plotting, drafting
	28	Drafting, report writing
	29	Report writing, map duplicating
	30	Report writing
	31	Report writing, assembling, Accounting.

Ben Bernstein
Lakeshore Rd.,
Haileybury, Ontario

June	8	Linecutting
	11	"
	18	"
	22	"
	23	"
July	7	"
	8	"
	15	"
	21	Prospecting
	22	Linecutting
	23	"

Terry Caldwell
Regina St.
New Liskeard, Ontario

Oct 22 Soil Sampling

Glenn McBride
New Liskeard, Ontario

Jan 26 VLF-EM Survey



BELL - WHITE ANALYTICAL LABORATORIES LTD.

P.O. BOX 187,
POJ 1KO

HAILEYBURY, ONTARIO

TEL: 672-3107
FAX: (705) 672-5843

Certificate of Analysis

1

NO. 293

DATE: October 27, 1992

SAMPLE(S) OF: Rock(2)

RECEIVED: October 1992

SAMPLE(S) FROM: Mr. B. J. Westin.
Strathy Project.

Sample #	Au ppb	Ag ppm	Cu ppm	Pb ppm	Zn ppm
F28501	62**	3.0	63*	65*	139*
F28502	8	0.4	9	96	46

* No charge.

** Checked.

IN ACCORDANCE WITH LONG-ESTABLISHED NORTH AMERICAN CUSTOM, UNLESS IT IS SPECIFICALLY STATED OTHERWISE GOLD AND SILVER VALUES REPORTED ON THESE SHEETS HAVE NOT BEEN ADJUSTED TO COMPENSATE FOR LOSSES AND GAINS INHERENT IN THE FIRE ASSAY PROCESS.

BELL-WHITE ANALYTICAL LABORATORIES LTD.

PER 



BELL - WHITE ANALYTICAL LABORATORIES LTD.

P.O. BOX 187,
POJ 1KO

HAILEYBURY, ONTARIO

TEL: 672-3107
FAX: (705) 672-5843

Certificate of Analysis

NO. 292

1

DATE: October 27, 1992

SAMPLE(S) OF: Soils(41)

RECEIVED: October 1992

SAMPLE(S) FROM: Mr. B. J. Westin.
Strathy Project.

Sample #	Au ppb
T1	12
T2	8
T3	10
T4	8
T5	10
T6	12
T7	8
T8	10
T9	8
T10	8
T11	6
T12	8
T13	10
T14	12
T15	8
T16	12
T17	12
T18	8
T19	10
T20	12
T21	8
T22	10
T23	12
T24	12
T25	6
T26	8
T27	12
T28	10
T29	10
T30	10
T31	10
T32	8
T33	8

IN ACCORDANCE WITH LONG-ESTABLISHED NORTH AMERICAN CUSTOM, UNLESS IT IS SPECIFICALLY STATED OTHERWISE GOLD AND SILVER VALUES REPORTED ON THESE SHEETS HAVE NOT BEEN ADJUSTED TO COMPENSATE FOR LOSSES AND GAINS INHERENT IN THE FIRE ASSAY PROCESS.

BELL-WHITE ANALYTICAL LABORATORIES LTD.

PER 



BELL - WHITE ANALYTICAL LABORATORIES LTD.

P.O. BOX 187,
POJ 1KO

HAILEYBURY, ONTARIO

TEL: 672-3107
FAX: (705) 672-5843

Certificate of Analysis

NO. 292

2

DATE: October 27, 1992

SAMPLE(S) OF: Soils(41)

RECEIVED: October 1992

SAMPLE(S) FROM: Mr. B. J. Westin.
Strathy Project.

Sample #	Au ppb
T34	12
T35	10
T36	12
T37	10
T38	8
T39	12
T40	10
T41	10

IN ACCORDANCE WITH LONG-ESTABLISHED NORTH AMERICAN CUSTOM, UNLESS IT IS SPECIFICALLY STATED OTHERWISE GOLD AND SILVER VALUES REPORTED ON THESE SHEETS HAVE NOT BEEN ADJUSTED TO COMPENSATE FOR LOSSES AND GAINS INHERENT IN THE FIRE ASSAY PROCESS.

BELL-WHITE ANALYTICAL LABORATORIES LTD.

PER 



31M04SW9746 2.14974 STRATHY

900

Ministry of
Northern Development
and Mines

Ministère du
Développement du Nord
et des Mines

Geoscience Approvals Section
Mining Lands Branch
Willet Green Miller Centre
933 Ramsey Lake Road
6th Floor
Sudbury, Ontario
P3E 6B5

Telephone: (705) 670-5853
Fax: (705) 670-5863

Our File: 2.14974
Transaction #: W9370.00019
W9370.00020
W9370.00021

May 28, 1993

Mining Recorder
Ministry of Northern Development
and Mines
933 Ramsey Lake Road
3rd Floor
Sudbury, Ontario
P3E 6B5

Dear Sir:

**RE: Approval of Assessment Work submitted for Geophysics on mining
claims S 1165517 et al. in Strathy Township.**

The assessment work submitted on the above mentioned Reports of Work
has been approved under section 6 (5) of the Mining Act Regulations,
as of May 20, 1993.

Please address any inquiries to Dale Messenger at (705) 670-5858.

Yours sincerely,

Ron C. Gashinski
Senior Manager, Mining Lands Branch
Mines and Minerals Division

DEM/jl
Enclosures:

cc: Assessment Files Office
Toronto, Ontario

Resident Geologist
Sudbury, Ontario

Personal information collected on this form is obtained under the authority of the Mining Act. This information will be used for correspondence. Questions about this collection should be directed to the Provincial Manager, Mining Lands, Ministry of Northern Development and Mines, Fourth Floor, 159 Cedar Street, Sudbury, Ontario, P3E 6A5, telephone (705) 670-7264.

20149

- Instructions:
- Please type or print and submit in duplicate.
 - Refer to the Mining Act and Regulations for requirements of filing assessment work or consult the Mining Recorder.
 - A separate copy of this form must be completed for each Work Group.
 - Technical reports and maps must accompany this form in duplicate.
 - A sketch, showing the claims the work is assigned to, must accompany this form.

Recorded Holder(s) BJARNE A. WESTIN		Client No. 207919
Address 1455 LAKESHORE RD BOX 657 NEW LISKEARD		Telephone No. 705-647-6354
Mining Division SUDBURY	Township/Area STATHY	M or G Plan No. 6-3451
Dates Work Performed From: JULIE 8/92		To: JAN 31/93

Work Performed (Check One Work Group Only)

Work Group	Type
<input checked="" type="checkbox"/> Geotechnical Survey	GEOPHYSICS - MAGNETOMETER AND VLF-EM
<input type="checkbox"/> Physical Work, Including Drilling	
<input type="checkbox"/> Rehabilitation	
<input type="checkbox"/> Other Authorized Work	
<input type="checkbox"/> Assays	
<input type="checkbox"/> Assignment from Reserve	

RECEIVED **RECORDED**

APR 07 1993 FEB 19 1993

MINING LANDS BRANCH Receipt: *20149*

Total Assessment Work Claimed on the Attached Statement of Costs \$ 3557

Note: The Minister may reject for assessment work credit all or part of the assessment work submitted if the recorded holder cannot verify expenditures claimed in the statement of costs within 30 days of a request for verification.

Persons and Survey Company Who Performed the Work (Give Name and Address of Author of Report)

Name	Address
BJARNE A. WESTIN (author)	1455 LAKESHORE, BOX 657 NEW LISKEARD, ONT
BOB BERNSTEIN	LAKESHORE ROAD, HAILEYBURY, ONT
GLENN McBRIDE	MAY STREET, NEW LISKEARD
ERWIN JAMESON	Route Duve Du Nord, QUEBEC

(attach a schedule if necessary)

Certification of Beneficial Interest * See Note No. 1 on reverse side

I certify that at the time the work was performed, the claims covered in this work report were recorded in the current holder's name or held under a beneficial interest by the current recorded holder.	Date Feb 18/93	Recorded Holder or Agent (Signature) <i>[Signature]</i>
--	-------------------	--

Certification of Work Report

I certify that I have a personal knowledge of the facts set forth in this Work report, having performed the work or witnessed same during and/or after its completion and annexed report is true.		
Name and Address of Person Certifying BJARNE A. WESTIN, 1455 LAKESHORE, NEW LISKEARD		
Telephone No. 705-647-6354	Date Feb 18/93	Certified By (Signature) <i>[Signature]</i>

For Office Use Only

Total Value Or. Recorded	Date Recorded 9/92	Mining Recorder <i>[Signature]</i>	RECEIVED FEB 19 1993 A.M. 7:10 P.M. 5:15 <i>[Signature]</i>
	Date Approved May 19/93	Date Approved <i>[Signature]</i>	
Date Name for Amendment Sent			

État des coûts aux fins
du crédit d'évaluation

Mining Act/Loi sur les mines

Personal information collected on this form is obtained under the authority of the Mining Act. This information will be used to maintain a record and ongoing status of the mining claim(s). Questions about this collection should be directed to the Provincial Manager, Minings Lands, Ministry of Northern Development and Mines, 4th Floor, 159 Cedar Street, Sudbury, Ontario P3E 6A5, telephone (705) 670-7264.

Les renseignements personnels contenus dans la présente formule sont recueillis en vertu de la Loi sur les mines et serviront à tenir à jour un registre des concessions minières. Adresser toute question sur la collecte de ces renseignements au chef provincial des terrains miniers, ministère du Développement du Nord et des Mines, 159, rue Cedar, 4^e étage, Sudbury (Ontario) P3E 6A5, téléphone (705) 670-7264.

1. Direct Costs/Coûts directs

Type	Description	Amount Montant	Totals Total global
Wages Salaires	Labour Main-d'oeuvre	2975	
	Field Supervision Supervision sur le terrain		2975
Contractor's and Consultant's Fees Droits de l'entrepreneur et de l'expert- conseil	Type		
Supplies Used Fournitures utilisées	Type Field Supplies	41.79	
	Office/Report Supplies	33.53	
Equipment Rental Location de matériel	Type Magnetometer	25.00	
Total Direct Costs Total des coûts directs			7532

2. Indirect Costs/Coûts indirects

** Note: When claiming Rehabilitation work indirect costs are not allowable as assessment work.
Pour le remboursement des travaux de réhabilitation, les coûts indirects ne sont pas admissibles en tant que travaux d'évaluation.

Type	Description	Amount Montant	Totals Total global
Transportation Transport	Type Truck 1540km	462	
Food and Lodging Nourriture et hébergement			
Mobilization and Demobilization Mobilisation et démobilisation			
Sub Total of Indirect Costs Total partiel des coûts indirects			462
Amount Allowable (not greater than 20% of Direct Costs) Montant admissible (n'excédant pas 20 % des coûts directs)			
Total Value of Assessment Credit (Total of Direct and Allowable indirect costs)		Valeur totale du crédit d'évaluation (Total des coûts directs et indirects admissibles)	

Note: The recorded holder will be required to verify expenditures claimed in this statement of costs within 30 days of a request for verification. If verification is not made, the Minister may reject for assessment work all or part of the assessment work submitted.

RECEIVED
Le titulaire enregistré sera tenu de vérifier les dépenses demandées dans le présent état des coûts dans les 30 jours suivant une demande à cet effet. Si la vérification n'est pas effectuée, le ministre peut rejeter tout ou une partie des travaux d'évaluation présentés.

APR 07 1993

Filing Discounts

MINING LANDS BRANCH Règles pour dépôt

1. Work filed within two years of completion is claimed at 100% of the above Total Value of Assessment Credit.
2. Work filed three, four or five years after completion is claimed at 50% of the above Total Value of Assessment Credit. See calculations below:

1. Les travaux déposés dans les deux ans suivant leur achèvement sont remboursés à 100 % de la valeur totale susmentionnée du crédit d'évaluation.
2. Les travaux déposés trois, quatre ou cinq ans après leur achèvement sont remboursés à 50 % de la valeur totale du crédit d'évaluation susmentionné. Voir les calculs ci-dessous.

Total Value of Assessment Credit	Total Assessment Claimed
	× 0.50 =

Valeur totale du crédit d'évaluation	Évaluation totale demandée
	× 0,50 =

Certification Verifying Statement of Costs

I hereby certify:
that the amounts shown are as accurate as possible and these costs were incurred while conducting assessment work on the lands shown on the accompanying Report of Work form.

that as [Signature] I am authorized
(Recorded Holder, Agent, Position in Company)

to make this certification

Attestation de l'état des coûts

J'atteste par la présente :
que les montants indiqués sont le plus exact possible et que ces dépenses ont été engagées pour effectuer les travaux d'évaluation sur les terrains indiqués dans la formule de rapport de travail ci-joint.

Et qu'à titre de [Signature] je suis autorisé
(titulaire enregistré, représentant, poste occupé dans la compagnie)

à faire cette attestation.

Signature	Date
<u>[Signature]</u>	<u>26/03/93</u>

Nota: Dans cette formule, lorsqu'il désigne des personnes, le masculin est utilisé au sens neutre.

Personal information collected on this form is obtained under the authority of the Mining Act. This information will be used for correspondence. Questions about this collection should be directed to the Provincial Manager, Mining Lands, Ministry of Northern Development and Mines, Fourth Floor, 166 Cedar Street, Sudbury, Ontario, P3E 8A5, telephone (705) 670-7264.

2.14974

- Instructions:**
- Please type or print and submit in duplicate.
 - Refer to the Mining Act and Regulations for requirements of filing assessment work or consult the Mining Recorder.
 - A separate copy of this form must be completed for each Work Group.
 - Technical reports and maps must accompany this form in duplicate.
 - A sketch, showing the claims the work is assigned to, must accompany this form.

Recorded Holder(s) BJARNE A. WESTIN		Client No. 207919
Address 1455 LAKESHORE, BOX 657 NEW LISKEARD ONT P0J 1P0		Telephone No. 705 647 6354
Mining Division SUDBURY	Township/Area STATHY	M or G Plan No. 63451
Date Work Performed From: JUN 8 /92		To: JAN 31/93

Work Performed (Check One Work Group Only)

Work Group	Type
<input checked="" type="checkbox"/> Geotechnical Survey	GEOPHYSICS MAGNETOMETER and VLF-EM
<input type="checkbox"/> Physical Work, including Drilling	RECEIVED
<input type="checkbox"/> Rehabilitation	APR 07 1993
<input type="checkbox"/> Other Authorized Work	MINING LANDS BRANCH
<input type="checkbox"/> Assays	
<input type="checkbox"/> Assignment from Reserve	

Total Assessment Work Claimed on the Attached Statement of Costs \$ 4791

Note: The Minister may reject for assessment work credit all or part of the assessment work submitted if the recorded holder cannot verify expenditures claimed in the statement of costs within 30 days of a request for verification.

Persons and Survey Company Who Performed the Work (Give Name and Address of Author of Report)

Name	Address
BJARNE A WESTIN	1455 LAKESHORE RD. New Liskeard P0J 1P0
ERIN JAMESON	Notre Dame du Nord, Quebec
BEN BERNSTEIN	LAKESHORE RD, Haileybury Ont.

RECORDED
FEB 19 1993

(attach a schedule if necessary)

Certification of Beneficial Interest * See Note No. 1 on reverse side

I certify that at the time the work was performed, the claims covered in this work report were recorded in the current holder's name or held under a beneficial interest by the current recorded holder.

Date: Feb 18/93
Recorded Holder or Agent (Signature): [Signature]

Certification of Work Report

I certify that I have a personal knowledge of the facts set forth in this Work report, having performed the work or witnessed same during and/or after its completion and annexed report is true.

Name and Address of Person Certifying: BJARNE A. WESTIN Box 657 New Liskeard

Telephone No.: 705-647-6354 Date: Feb 18 /93 Certified By (Signature): [Signature]

For Office Use Only

Total Value Cr. Recorded	Date Recorded	Mining Recorder	Received Stamp
	19/92	[Signature]	RECEIVED
	Deemed Approval Date: FEB 19 1993 DM	Date Approved	FEB 19 1993 P.M.
	File Number for Amendments Sent		7:51:00 111211211516

S. H. Oberholt

Personal information collected on this form is obtained under the authority of the Mining Act. This information will be used to maintain a record and ongoing status of the mining claim(s). Questions about this collection should be directed to the Provincial Manager, Minings Lands, Ministry of Northern Development and Mines, 4th Floor, 159 Cedar Street, Sudbury, Ontario P3E 6A5, telephone (705) 670-7264.

Les renseignements personnels contenus dans la présente formule sont recueillis en vertu de la Loi sur les mines et serviront à tenir à jour un registre des concessions minières. Adresser toute question sur la collecte de ces renseignements au chef provincial des terrains miniers, ministère du Développement du Nord et des Mines, 159, rue Cedar, 4^e étage, Sudbury (Ontario) P3E 6A5, téléphone (705) 670-7264.

1. Direct Costs/Coûts directs

Type	Description	Amount Montant	Totals Total global
Wages Salaires	Labour Main-d'oeuvre	2650	
	Field Supervision Supervision sur le terrain		2650
Contractor's and Consultant's Fees Droits de l'entrepreneur et de l'expert- conseil	Type Linecutting	1320	
			1320
Supplies Used Fournitures utilisées	Type Field Supplies	83.57	
	Office/Report Supplies	67.07	
			150.64
Equipment Rental Location de matériel	Type Magneton	50.00	
Total Direct Costs Total des coûts directs			

2. Indirect Costs/Coûts indirects

** Note: When claiming Rehabilitation work indirect costs are not allowable as assessment work.
Pour le remboursement des travaux de réhabilitation, les coûts indirects ne sont pas admissibles en tant que travaux d'évaluation.

Type	Description	Amount Montant	Totals Total global
Transportation Transport	Type TRUCK 1960km	588.-	
	Skidoo gun	32	
			620.00
Food and Lodging Nourriture et hébergement			
Mobilization and Demobilization Mobilisation et démobilisation			

Sub Total of Indirect Costs
Total partiel des coûts indirects

Amount Allowable (not greater than 20% of Direct Costs)
Montant admissible (n'excedant pas 20 % des coûts directs)

Total Value of Assessment Credit
(Total of Direct and Allowable
Indirect costs)
Valeur totale du crédit
d'évaluation
(Total des coûts directs
et indirects admissibles)

Note: The recorded holder will be required to verify expenditures claimed in this statement of costs within 30 days of a request for verification. If verification is not made, the Minister may reject for assessment work all or part of the assessment work submitted.

Note: Le titulaire enregistré sera tenu de vérifier les dépenses demandées dans le présent état des coûts dans les 30 jours suivant une demande à cet effet. Si la vérification n'est pas effectuée, le ministre peut rejeter tout ou une partie des travaux d'évaluation présentés.

RECEIVED

Filing Discounts

1. Work filed within two years of completion is claimed at 100% of the above Total Value of Assessment Credit.
2. Work filed three, four or five years after completion is claimed at 50% of the above Total Value of Assessment Credit. See calculations below:

Total Value of Assessment Credit	Total Assessment Claimed
	x 0.50 =

Remises pour dépôt

1. Les travaux déposés dans les deux ans suivant leur achèvement sont remboursés à 100 % de la valeur totale susmentionnée du crédit d'évaluation.
2. Les travaux déposés trois, quatre ou cinq ans après leur achèvement sont remboursés à 50 % de la valeur totale du crédit d'évaluation susmentionné. Voir les calculs ci-dessous.

Valeur totale du crédit d'évaluation	Évaluation totale demandée
	x 0,50 =

Certification Verifying Statement of Costs

I hereby certify:
that the amounts shown are as accurate as possible and these costs were incurred while conducting assessment work on the lands shown on the accompanying Report of Work form.

that as Richard Holter I am authorized
(Recorded Holder, Agent, Position in Company)

to make this certification

Attestation de l'état des coûts

J'atteste par la présente :
que les montants indiqués sont le plus exact possible et que ces dépenses ont été engagées pour effectuer les travaux d'évaluation sur les terrains indiqués dans la formule de rapport de travail ci-joint.

Et qu'à titre de _____ je suis autorisé
(titulaire enregistré, représentant, poste occupé dans la compagnie)

à faire cette attestation.

Signature [Signature] Date 21/12/15

Personal information collected on this form is obtained under the authority of the Mining Act. This information will be used for correspondence. Questions about this collection should be directed to the Provincial Manager, Mining Lands, Ministry of Northern Development and Mines, Fourth Floor, 150 Cedar Street, Sudbury, Ontario, P3E 6A5, telephone (705) 670-7264.

2.14974

- Instructions:**
- Please type or print and submit in duplicate.
 - Refer to the Mining Act and Regulations for requirements of filing assessment work or consult the Mining Recorder.
 - A separate copy of this form must be completed for each Work Group.
 - Technical reports and maps must accompany this form in duplicate.
 - A sketch, showing the claims the work is assigned to, must accompany this form.

Recorded Holder(s) BJARNE A. WESTIN	Client No. 207919
Address 1455 LAKESHORE RD. BOX 657 NEW LISKEARD ONT	Telephone No. 705-647-6354
Mining Division SUDBURY	Township/Area STRATHY
M or G Plan No. G-3451	
Date Work Performed From: JUN 8/92	To: JAN 31/93

Work Performed (Check One Work Group Only)

Work Group	Type
Geotechnical Survey	
Physical Work, including Drilling	
Rehabilitation	
Other Authorized Work	
<input checked="" type="checkbox"/> Assays	Soil Sampling, Rock Sampling
Assignment from Reserve	

Total Assessment Work Claimed on the Attached Statement of Costs \$ 1349

Note: The Minister may reject for assessment work credit all or part of the assessment work submitted if the recorded holder cannot verify expenditures claimed in the statement of costs within 30 days of a request for verification.

Persons and Survey Company Who Performed the Work (Give Name and Address of Author of Report)

Name	Address
BJARNE A. WESTIN	1455 Lakeshore Rd, New Liskeard
BEN KERNSTEIN	Lakeshore Rd. Haileybury
TERRY CALDWELL	Regina St. REBECCA

RECORDED
FEB 19 1993
Receipt - [Signature]

(attach a schedule if necessary)

APR 07 1993

Certification of Beneficial Interest * See Note No. 1 on reverse side

I certify that at the time the work was performed, the claims covered in this work report were recorded in the current holder's name or held under a beneficial interest by the current recorded holder.	Date Feb 13/93	Recorded Holder or Agent (Signature) [Signature]
--	-------------------	---

Certification of Work Report

I certify that I have a personal knowledge of the facts set forth in this Work report, having performed the work or witnessed same during and/or after its completion and annexed report is true.		
Name and Address of Person Certifying BJARNE A. WESTIN 1455 Lakeshore Rd, New Liskeard		
Telephone No. 705-647-6354	Date Feb 13 1993	Certified By (Signature) [Signature]

For Office Use Only

Total Value of Assessment	Date Recorded Feb 13/93	Mining Recorder [Signature]	SUDBURY RECEIVED FEB 19 1993 A.M. 7:51 P.M. 12:15 [Signature]
	Recorded Approval Date Feb 27 1993	Date Approved [Signature]	
	Date Notice for Amendment Sent		

Personal information collected on this form is obtained under the authority of the Mining Act. This information will be used to maintain a record and ongoing status of the mining claim(s). Questions about this collection should be directed to the Provincial Manager, Minings Lands, Ministry of Northern Development and Mines, 4th Floor, 159 Cedar Street, Sudbury, Ontario P3E 6A5, telephone (705) 670-7264.

Les renseignements personnels contenus dans la présente formule sont recueillis en vertu de la Loi sur les mines et serviront à tenir à jour un registre des concessions minières. Adresser toute question sur la collecte de ces renseignements au chef provincial des terrains miniers, ministère du Développement du Nord et des Mines, 159, rue Cedar, 4^e étage, Sudbury (Ontario) P3E 6A5, téléphone (705) 670-7264.

1. Direct Costs/Coûts directs

Type	Description	Amount Montant	Totals Total global
Wages Salaires	Labour Main-d'oeuvre	800	
	Field Supervision Supervision sur le terrain		800
Contractor's and Consultant's Fees Droits de l'entrepreneur et de l'expert- conseil	Type Assays	364.60	
			364.60
Supplies Used Fournitures utilisées	Type Field Supplies	66.79	
	Office/Report	33.53	
			100.32
Equipment Rental Location de matériel	Type		
Total Direct Costs Total des coûts directs			3265

2. Indirect Costs/Coûts Indirects

** Note: When claiming Rehabilitation work indirect costs are not allowable as assessment work.
Pour le remboursement des travaux de réhabilitation, les coûts indirects ne sont pas admissibles en tant que travaux d'évaluation.

Type	Description	Amount Montant	Totals Total global
Transportation Transport	Type Truck 230 km	84.00	
			84
Food and Lodging Nourriture et hébergement			
Mobilization and Demobilization Mobilisation et démobilisation			
Sub Total of Indirect Costs Total partiel des coûts indirects			84
Amount Allowable (not greater than 20% of Direct Costs) Montant admissible (n'excédant pas 20 % des coûts directs)			16.8
Total Value of Assessment Credit (Total of Direct and Allowable indirect costs)			1349

Note: The recorded holder will be required to verify expenditures claimed in this statement of costs within 30 days of a request for verification. If verification is not made, the Minister may reject for assessment work all or part of the assessment work submitted.

Note : Le titulaire enregistré sera tenu de vérifier les dépenses demandées dans le présent état des coûts dans les 30 jours suivant une demande à cet effet. Si la vérification n'est pas effectuée, le ministre peut rejeter tout ou une partie des travaux d'évaluation présentés.

Filing Discounts

1. Work filed within two years of completion is claimed at 100% of the above Total Value of Assessment Credit.
2. Work filed three, four or five years after completion is claimed at 50% of the above Total Value of Assessment Credit. See calculations below:

Total Value of Assessment Credit $\times 0.50 =$ Total Assessment Claimed

Remises pour dépôt

1. Les travaux déposés dans les deux ans suivant leur achèvement sont remboursés à 100 % de la valeur totale susmentionnée du crédit d'évaluation.
2. Les travaux déposés trois, quatre ou cinq ans après leur achèvement sont remboursés à 50 % de la valeur totale du crédit d'évaluation susmentionné. Voir les calculs ci-dessous.

Valeur totale du crédit d'évaluation $\times 0,50 =$ Évaluation totale demandée

Certification Verifying Statement of Costs

I hereby certify:
that the amounts shown are as accurate as possible and these costs were incurred while conducting assessment work on the lands shown on the accompanying Report of Work form.

that as [Signature] I am authorized
(Recorded Holder, Agent, Position in Company)

to make this certification

Attestation de l'état des coûts
MINING LANDS BRANCH

J'atteste par la présente :
que les montants indiqués sont le plus exact possible et que ces dépenses ont été engagées pour effectuer les travaux d'évaluation sur les terrains indiqués dans la formule de rapport de travail ci-joint.

Et qu'à titre de [Signature] je suis autorisé
(titulaire enregistré, représentant, poste occupé dans la compagnie)

à faire cette attestation.

Signature [Signature] Date Feb 13/95

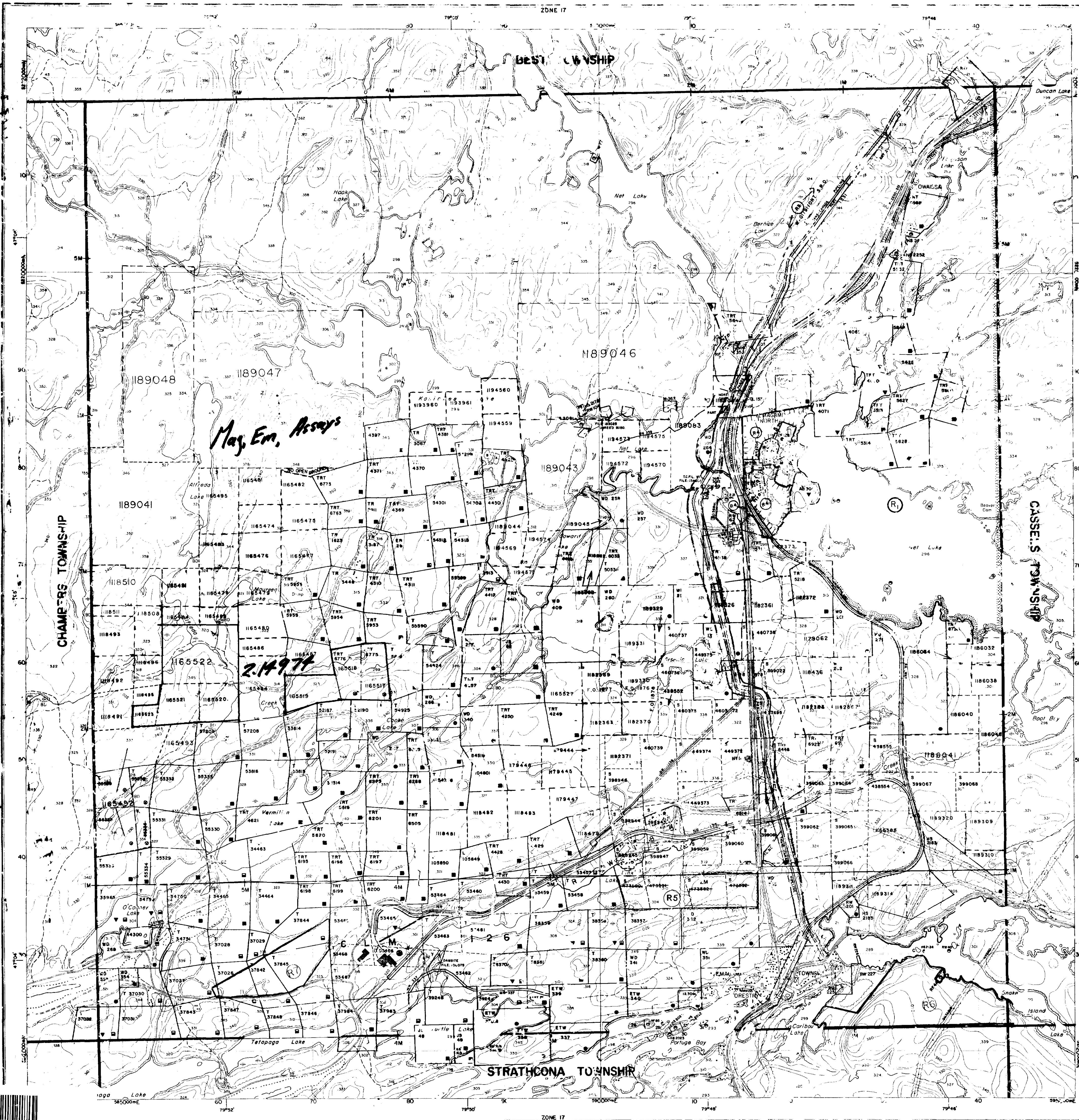

INDEX TO LAND DISPOSITION

PLAN
G-3451
 TOWNSHIP

STRATHY

M.N.R. ADMINISTRATIVE DISTRICT
TEMAGAMI
 MINING DIVISION
SUBURRY
 LAND TITLES/REGISTRY DIVISION
NIPISSING

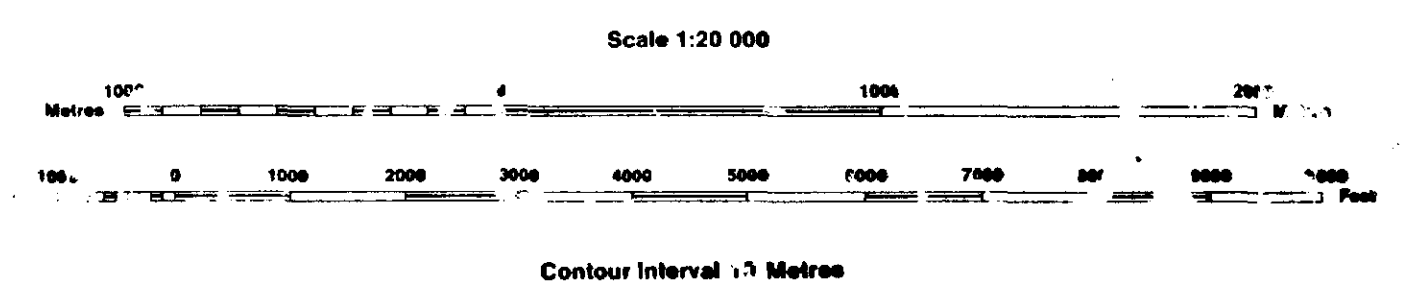

IN SERVICE JANUARY 10, 1990

DATE OF ISSUE
 APR - 5-1993
 SUBURRY
 MINING RECORDER'S OFFICE

SYMBOLS

- Boundary
- Township Meridian, Baseline
- Road allowance, surveyed
- showline
- lot/conclusion surveyed
- unsurveyed
- Right-of-way, road
- utility
- Reservat
- Cik, Pk, Pk
- Contour
- Inter-related
- Approximate
- ession
- Control point (horizontal)
- Flooded land
- Mine head frame
- Pipeline (above ground)
- Railway: single track
- double track
- abandoned
- Road; highway, county, township
- access
- oil, bush
- Shoreline (original)
- transmission line
- Woods area

AREAS WITHDRAWN FROM DISPOSITION

- MRO - Mining Rights Only
 - SHO - Surface Rights Only
 - M+S - Mining and Surface Rights
- | Description | On an No. | Date | Legis. | File |
|------------------------|------------|-----------|--------|---------|
| (1) 36(1)30/1980 | 2022/66 | 8/2/80 | S.A. | 1994 |
| (2) 96(1)30/1980 | 16/03/84 | 16/03/84 | S.A. | 1984-85 |
| (3) W-01/81/ONT S.R.O. | SEP. 20/81 | L.R. FILE | | |
| (4) SEC. 34/80 | W-5-02/81 | NER | M B S | 198180 |
| (5) SEC. 35/80 | W-5-01/81 | CR | M B S | 198180 |
- (6) AREAS WITHDRAWN UNDER THE PUBLIC LANDS ACT (AND NOT OPEN FOR STAKING (SUB-SECTION 30(B) OF THE Mining Act R.S.O. 1990) Notice received 9/2/JAN/86
- (7) AREAS WITHDRAWN UNDER THE PUBLIC LANDS ACT (AND NOT OPEN FOR STAKING (SUB-SECTION 30(B) OF THE Mining Act R.S.O. 1990) Notice received 9/2/JAN/86
- (8) O-ONT-08/92/NER/CR MAR. 16/92 M B S 198180
- (9) O-ONT-07/92/NER/CR JUNE. 11/92 M B S 198180

DISPOSITION OF CROWN LANDS

- Patent
- Surface & Mining Rights
- Surface Rights Only
- Mining Right Only
- Lease
- Surface & Mining Rights
- Surface Rights Only
- Mining Rights Only
- Licence of Occupation
- Order-in-Council
- Cancelled
- Reservation
- Sand & Gravel

NOTES

ISLAND 27 BELONGS WITH STRATHCONA TWP.
 ISLANDS IN LAKE TEMAGAMI - NOT OPEN FOR STAKING

THE INFORMATION THAT APPEARS ON THIS MAP HAS BEEN COMPILED FROM VARIOUS SOURCES, AND ACCURACY IS NOT GUARANTEED. THOSE WISHING TO STAKE MINING CLAIMS SHOULD CONSULT WITH THE MINING RECORDER, MINISTRY OF NORTHERN DEVELOPMENT AND MINES, FOR ADDITIONAL INFORMATION ON THE STATUS OF THE LANDS SHOWN HEREON.

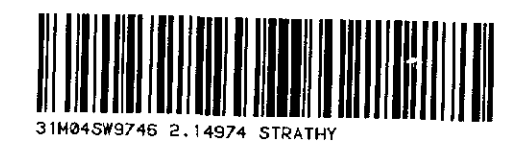

G-3451 STRATHY TOWNSHIP

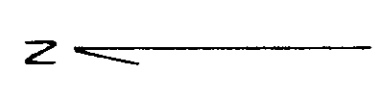

WEST GRID

EAST GRID

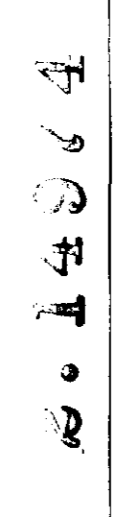
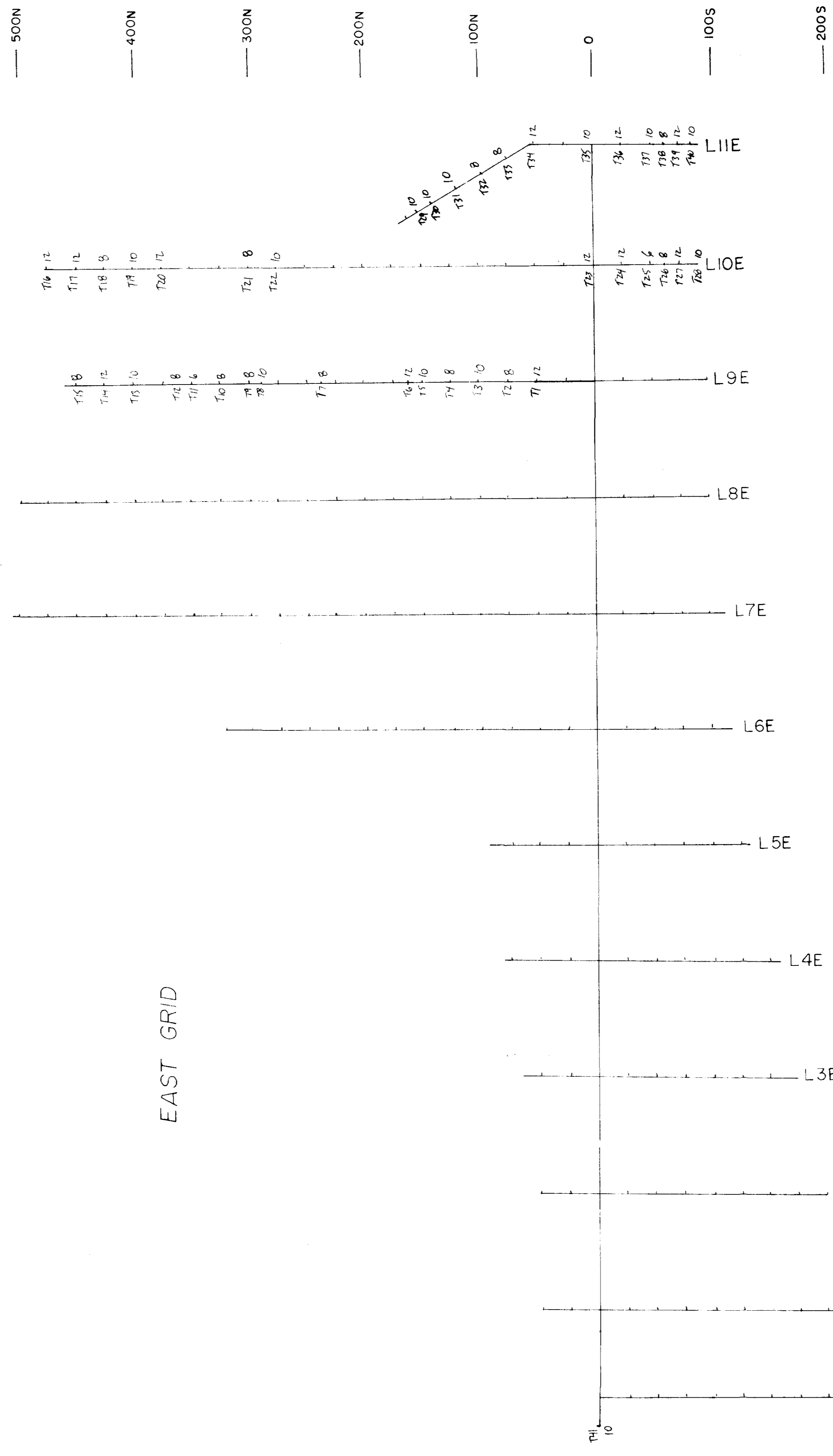

STRATHY PROJECT	
SOIL SAMPLING - B HORIZON	
GOLD	
SCALE 1:2500	DATE JAN 1993
	DRN BY B. WESTIN



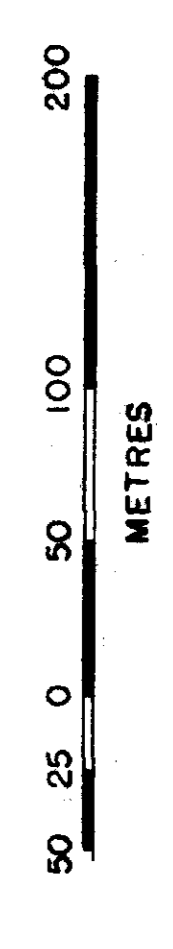
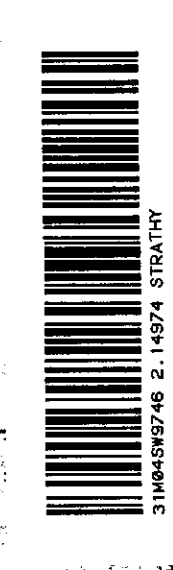

LEGEND

— 25 GAMMA

- - - 100 GAMMA

○ MAGNETIC DEPRESSION

BACKGROUND 57000 GAMMAS

STRATHY PROJECT

MAGNETOMETER SURVEY

2.14974

SCALE 1:2500

DATE JAN 1993

DRN BY B WESTIN

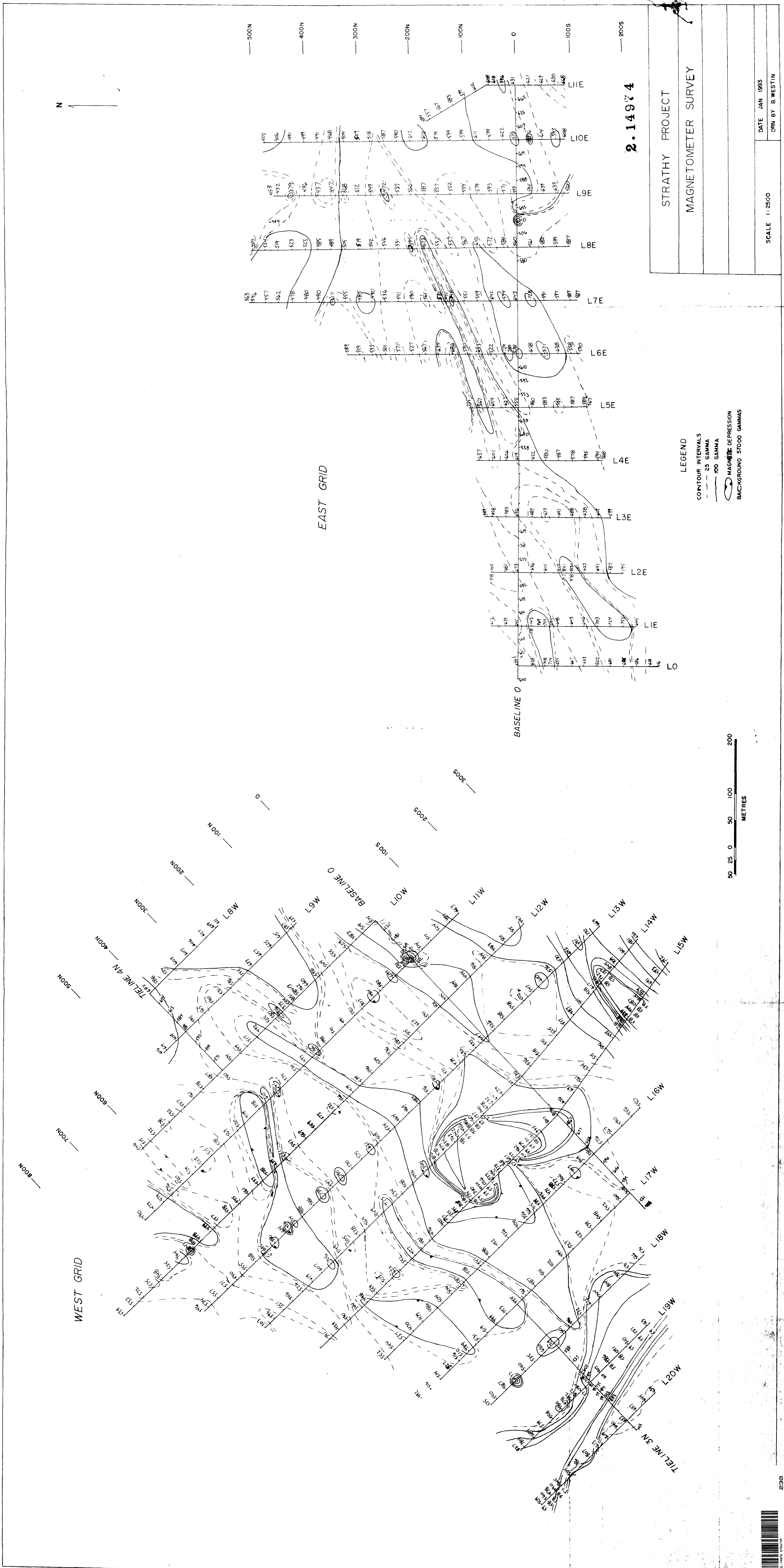

N

ANNAPOLIS MARYLAND
NSS 21.4 kHz

EAST GRID

WEST GRID

2.14974

STRATHY PROJECT

VLF-EM SURVEY, DIP ANGLE PROFILES

Station: ANNAPOLIS, MARYLAND

SCALE 1:2500

DATE JAN 1993

DRN BY B. WESTIN

DIP ANGLE DEGREES
POSITIVE PLOTTED RIGHT
NEGATIVE PLOTTED LEFT

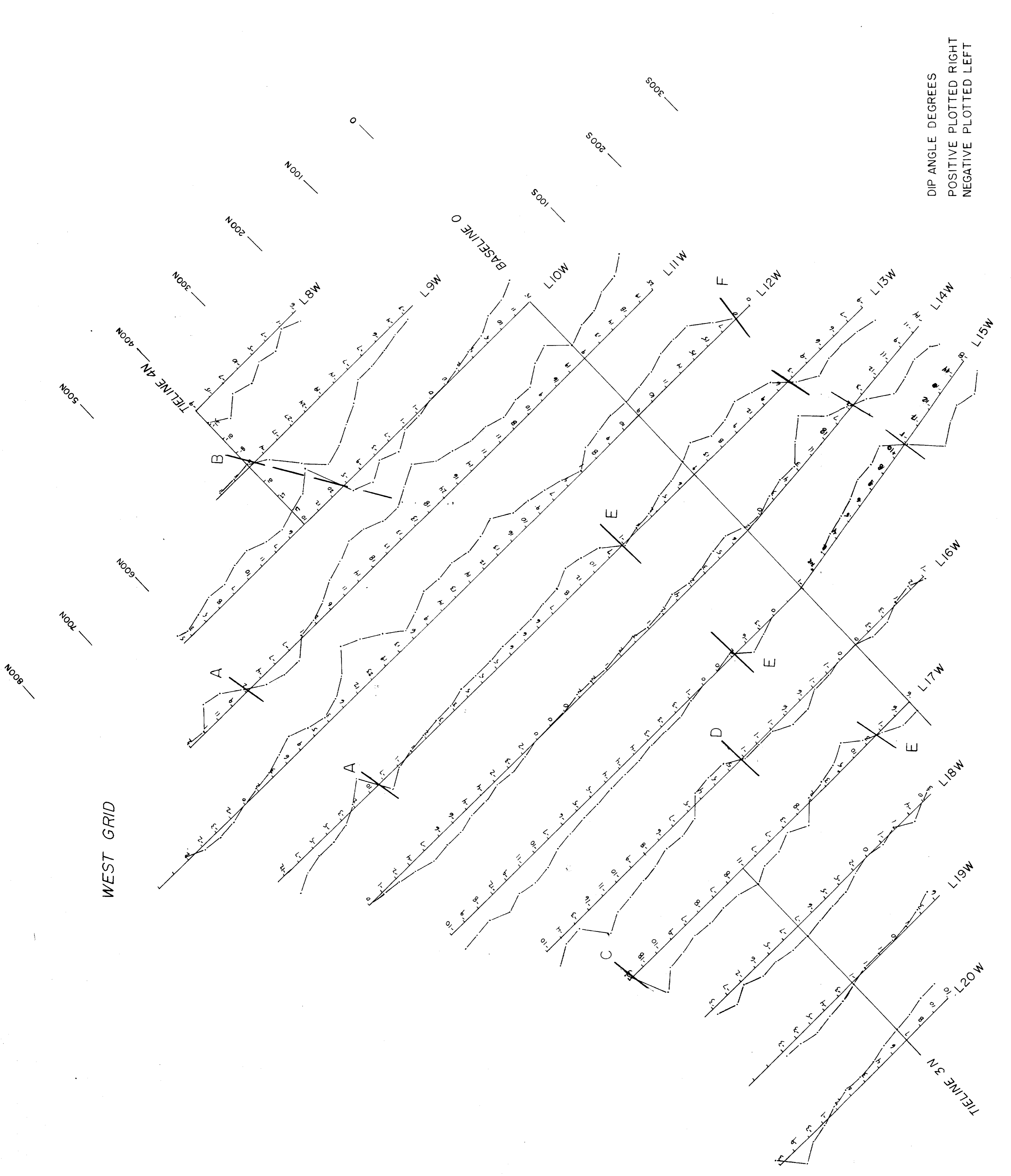
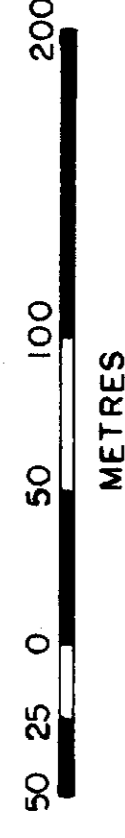

N

CUTLER MAINE
NAA 24.0 KHZ

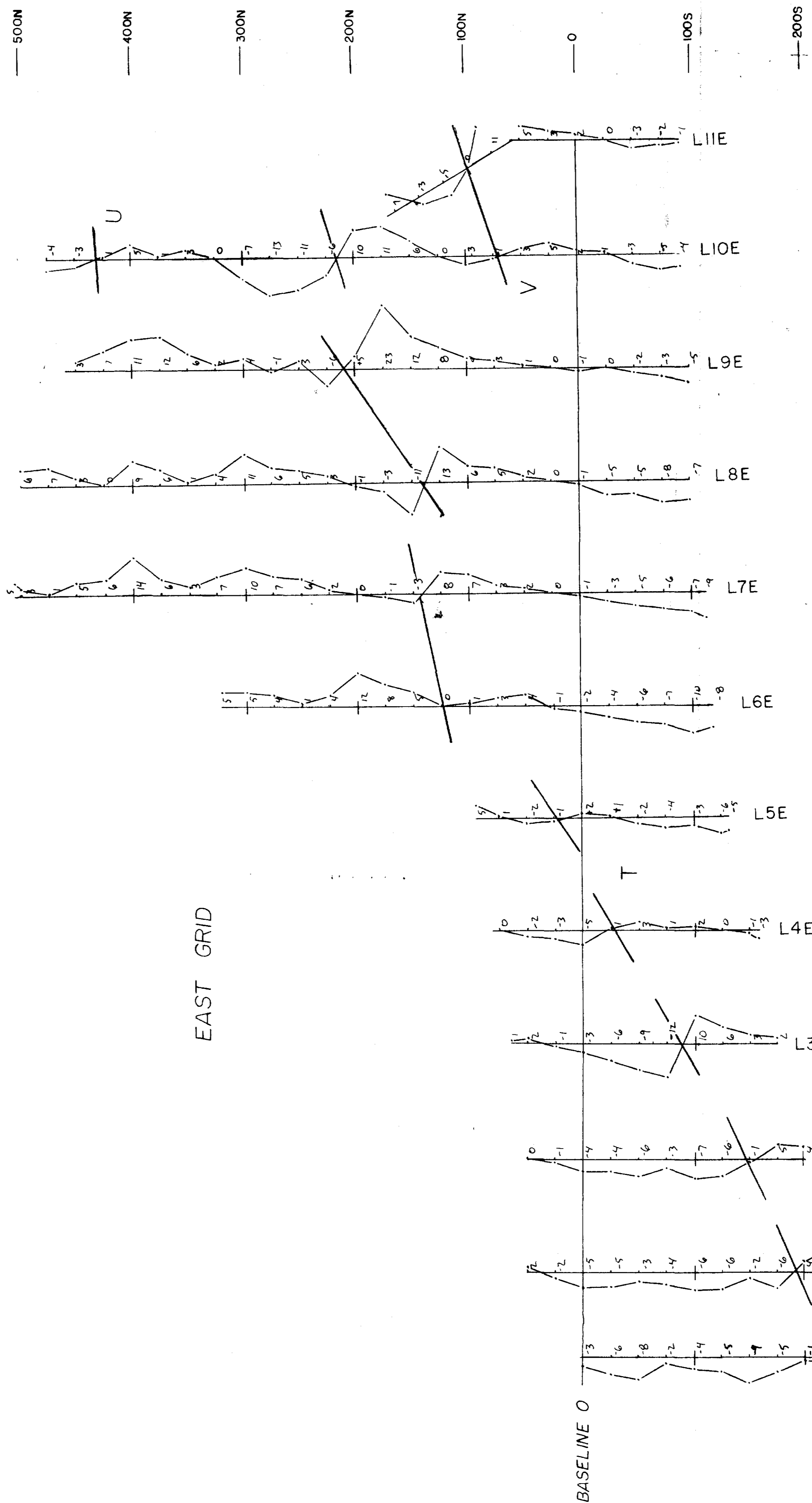

2-14974

STRATHY PROJECT
VLF-EM SURVEY DIP ANGLE PROFILES
Station: CUTLER, MAINE

SCALE 1:2500

JAN. 1993
DRN BY B. WESTIN

