



31M05NE0014 63.5193 BUCKE

010

REPORT ON
EXPLORATION PROJECT
COBALT ONTARIO AREA
FOR
ARMSHER RESOURCES INC.
BY
JAMES E. ARMSTRONG, P. Eng.
MARCH 15, 1988

DM87-6-C-227



31M05NE0014 63.5193 BUCKE

010C

TABLE OF CONTENTS

	<u>PAGE</u>
INTRODUCTION	1
SUMMARY	1
PROPERTY DESCRIPTION	1
HISTORY	2
REGIONAL GEOLOGY	2
GEOLOGY OF PROPERTY	3
PROJECT DESCRIPTION	4
OBSERVATIONS	4
CONCLUSIONS AND RECOMMENDATIONS	5

APPENDICES

AREA MAP	1" = 1 mile
PROPERTY MAP	1" = 400 feet
DIAMOND DRILL HOLE LOGS	

63. 5193

OM87-6-C-227

Please Note:

Similar diamond drilling logs can be found in the following record series:

holes # B1 & B2 - see Toronto diamond drilling file #48 Bucke Twp.

holes # B2, B3, B4 - see Toronto diamond drilling file #51 Bucke Twp.

hole # B5 - see Toronto diamond drilling file #50 Bucke Twp.

JAMES E. ARMSTRONG, B. SC. P. ENG.

MINING ENGINEER

INTRODUCTION

The following report was prepared to cover the recent exploration program carried out by Armsher Resources Inc. on its property in the Cobalt Area from October 1, 1987 to February 15, 1988.

SUMMARY

The twelve claim property group lies about 1½ miles north west of the town of Cobalt.

The property has had considerable exploration by diamond drill and geophysical equipment since 1904 but no record of silver production.

The regional geology conforms to that at the productive zones in the Cobalt Area.

A major Fault zone, probably the westerly extension of Fault #64, cuts north westerly through the property.

The most probable zone or bed of silver enrichment varies from a few feet below surface on the easterly part of the claims to over 800 feet in the westerly section.

Several calcite vein zones were located in the drilling but so far metallic mineralization has been limited to Cu, Pb, and Zinc.

PROPERTY DESCRIPTION

The Armsher Group of properties includes twelve (12) unpatented mining claims in Bucke and Coleman Townships as follows:

<u>Claim No</u>	<u>Acres</u>	<u>Description</u>	<u>Date Staked</u>
789169	40	NW¼, S½, Lot 5, conc 1 Bucke Twp	May 1985
789170	40	NE¼, S½, Lot 5, conc 1 Bucke Twp	May 1985
789171	40	SE¼, S½, Lot 5, conc 1 Bucke Twp	May 1985
789172	40	SW¼, S½, Lot 5, conc 1 Bucke Twp	May 1985
980222	40	NE¼, S½, Lot 4, conc 1 Bucke Twp	Oct 21, 1987
980223	40	NW¼, S½, Lot 4, conc 1 Bucke Twp	Oct 26, 1987
895593	40	SE¼, S½, Lot 4, conc 1 Bucke Twp	Nov 12, 1986
895594	40	SW¼, S½, Lot 4, conc 1 Bucke Twp	Nov 12, 1986
895595	40	NW¼, N½, Lot 8, conc 6 Coleman Twp	Nov 20, 1986
895596	40	NE¼, N½, Lot 9, conc 6 Coleman Twp	Nov 20, 1986
895597	40	NW¼, N½, Lot 9, conc 6 Coleman Twp	Nov 20, 1986
895598	40	NE¼, N½, Lot 8, conc 6 Coleman Twp	Nov 20, 1986

PROPERTY DESCRIPTION, continued

The property group is located about 1½ miles north-west of the Town of Cobalt, lying between the lakes of Sasaginoga and Sharp. The property may be reached by a township road west through West Cobalt, followed by a bush road north along the east side of Sharp Lake as far as the common Township boundary.

All twelve claims have been transferred to and are held by Armsher Resources Inc. under company prospecting liscence #4936. Two hundred (200) days assessment or credits have been recorded against each of the claims and it is planned to apply for 21 year leases from the Province on all 12 claims.

HISTORY

The property group has been held by various owners and companies since 1904 but to date no commercial mineral deposits have been located on the ground. Three shallow shafts have been sunk in the south east corner of claim 895595 and a short 150 foot adit was driven into the cliff face on the north east corner of the same claim.

All claims have been covered with some geophysical surveys and limited diamond drilling, more recently by St. Joseph Exploration and Highland Crow Resources.

In 1972-73, St. Joseph Exploration, as part of a larger group of claims, drilled 4 relatively shallow holes in the eastern part of the group. Although some sulphides were encountered no significant veins were apparently noted. The claims were allowed to lapse in 1985.

In 1983, Highland Crow Resources also as part of a larger group holdings, covered part of the west claims with a deep E.M. survey, and although 2 major anomalies were registered the claims were allowed to lapse in 1986. (See Appendice)

REGIONAL GEOLOGY

The cobalt-silver area is underlain by late Precambrian, gently dipping Huronian sediments (conglomerates, arkose, greywacke and quartzites) which rest upon older rocks consisting of Temiskaming sediments, Algoman or Laurentian granite and gneiss, and Keewatin lavas and tuffs. These are all cut by a quartz diabase dike of Keeweenawan age, called Nipissing diabase. The Nipissing diabase is the youngest Precambrian rock of the region with the exception of some post-Keeweenawan olivine and quartz diabase dikes.

All the silver-cobalt occurrences in the Temiskaming area, whether economic or otherwise, show a genetic connection either directly or indirectly with Nipissing diabase, even when, as has frequently been the case, this formation is not the host rock of the deposits. Ore occurrences are definitely related to contacts between the diabase and the intruded rocks. A second feature of the utmost importance is the pre-existing faults, which appear to limit or control ore deposition. Commercial deposits of cobalt and silver minerals are as a rule confined to a zone within 500 feet from the contact and measured at right angles to it.

GEOLOGY OF PROPERTY

A large portion of the silver production recovered from the Cobalt area has come from structures associated with #64 fault system. This major fault cuts through the north side of the cobalt area at about N 80°W and its projection north west appears to cut through the Armsher claim group. A sharp defile or east west valley could be the topographical indication of this fault extension and many fault gouge zones have appeared in drilling to date.

Except for a small zone in the south east corner of the property, the claims are completely covered by flat lying sedimentary rocks of the Huronian, Cobalt Series, lying unconformably on the basement, steeply dipping, Deewatin formation.

The Nipissing diabase sill, which originally overlaid this area, has been eroded.

Narrow calcite veinlets occur in black Deewatin slate rocks, exposed in the south-east corner of claim 895595. Considerable pyrite and some copper and zinc mineralization are also evident in this area.

Two major anomalies originally registered by a Highland Crow survey, have been more correctly placed in the south part of claim 895593 and the north part of claim 895596. These conductances have been interpreted as extensions north-west of the interflow, sulphide and chert bands contained in the Keewatin formation which underlies the majority of the silver producing mines of the Cobalt area.

This correction was registered by an O.G.S. team on a field exercise checking these reported anomalies in mid November 1986 and pointed out to J.E. Armstrong who was on the claims at the time. The discrepancy apparently occurred when the claim staker mistook an east west trail for the Coleman Township line which was actually about 500 feet further south. The equipment used by the O.G.S. party was elaborate and extensive for deep E.M. surveys and reportedly similar to that used by Highland Crow.

Generally in this particular structural condition, the basal layer of the Cobalt Series, just above its contact with the underlying Keewatin, has been the host rock for most of the silver enrichment.

This contact occurs on surface, on the west shore of Sasaginoga Lake and travelling west, this contact drops down to over 1,000 feet below surface near the east shore of Sharp Lake. The surface topography west of Sasaginoga Lake rises abruptly 200 feet or more making exploration of the favourable zone at the base of the Huronian, very difficult. There is also a possibility of a fault displacement similar to that which occurred to the roughly parallel Cobalt Lake Fault.

PROJECT DESCRIPTION

In December 1973, a hole, diamond drilled by St. Joseph Explorations, encountered minor calcite stringers and a heavy flow of water in the Cobalt Series. This flow still carries considerable sulphide content. This hole did not reach the underlying Keewatin formation.

The present program was designed to cut the mineralization below this St. Joe hole, to locate the Keewatin contact in this area and generally to explore for east-west trending vein systems.

The program in the west section of the claims was designed to explore for veins in the area outlined by the deep E.M. anomalies.

OBSERVATIONS

Eight holes were drilled for a total of 6875.0 feet. Hole B₂ was a deepening of a previous hole drilled. Most of the core was stored at the core storage of Ministry of Northern Affairs and Mines of Cobalt as indicated.

<u>HOLE NO</u>	<u>DIP</u>	<u>DEPTH</u>	<u>FOOTAGE STORED</u>	<u>AMOUNT STORED</u>
B ₂	45 ⁰	836.0	197.0 - 836.0	639.0
B ₃	60 ⁰	827.0	0.0 - 827.0	827.0
B ₄	40 ⁰	377.0	0 - 377.0	377.0
B ₅	40 ⁰	484.0	0 - 484.0	484.0
B ₆	45 ⁰	1032.0	0 - 1032.0	1032.0
B ₇	45 ⁰	1089.0	500 - 1089.0	589.0
B ₈	37 ⁰	1467.0	500 - 1467.0	967.0
B ₉	45 ⁰	957.0	400 - 957.0	557.0
TOTAL		6872.0		5422.0

- Hole B₂ - Several calcite veins in the Huronian but only pyrite and zinc mineralization noted.
- Hole B₃ - Considerable fault gouge zones and narrow vein intersections pyrite, galena and chalc^o at 753 feet but low silver assays matching down dip zone of B₁.
- Hole B₄ - Narrow calcite stringers, some cpg, and zn.
- Hole B₅ - Calcite threads and veinlets, no visible silver.
- Hole B₆ - Major calcite vein at 930.8 ft. Strs. 943' to 947'.
- Hole B₇ - Veins at 962, 965, 971 - no visible silver.
- Hole B₈ - Broken ground throughout hole, no water return several narrow calcite stringer zones.
- Hole B₉ - Some calcite str. but no vein to connect veins in holes B₂ and B₆.

CONCLUSIONS AND RECOMMENDATIONS

Several vein zones have been registered with a general east-west strike but continuity has not been established. Mineralization to date has been limited to base metal Cu, Pb and Zn. Further testing of known veins at different horizons may have success in locating silver zones in this structure.

Yours truly,

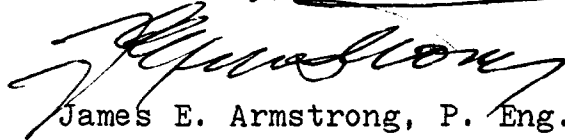
A handwritten signature in cursive script, appearing to read "James E. Armstrong".

James E. Armstrong, P. Eng.

JAMES E. ARMSTRONG, B. SC. P. ENG.
MINING ENGINEER

February 15, 1988.

Ministry of Northern Affairs and mines
OMEP Department

Dear Sir or Madam; Re Armsher Resources Inc

In regard to the OMEP grant, previously applied for and the recently completed diamond drill exploration program carried out by Armsher in the Townships of Coleman and Bucke, northwest of the town of COBALT Ontario, please find enclosed, 2 sets of the following information, covering this program:

1. Location map
2. Property map
3. Tabulation of the holes drilled
4. Diamond drill hole logs.

Yours truly,

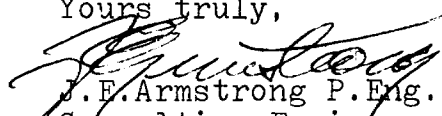
J.E. Armstrong P. Eng.
Consulting Engineer

FEB 15/80 ARMOURER RESOURCES INC

CORE STORED IN MINISTRY OF NORTHERN AFFAIRS + MINES

CORBAT AREA CORE STORAGE (RESIDENT GEOLOGIST)

HOLE NO.	DIP	DEPTH DRILLED (FT.)	FOOTAGE STORED	TOT. FOOTAGE STORED	FOOTAGE COOPAK SERIES	FOOTAGE KEEWATIM
B2	45°	836	197-836	639	0-613	613-836 (Rhyolite)
B3	60°	827	0-827	827	0-769	769-827 (Rhyolite)
B4	40°	377	0-377	377	0-377	NIL
B5	40°	484	0-484	484	0-484	NIL
B6	45°	1032	0-1032	1032	0-981	981-1032 (Rhyolite Breccia)
B7	45°	1089	500-1089	589	0-1008	1008-1089 (Rhyolite Breccia + KDa)
B8	37°	1467	500-1467	967	0-1467	NIL
B9	45°	957	400-957	557	0-896	896-957 - Black chert - rhyolite breccia
		TOTAL DRILL → 6872'	TOT. STORED → 5472'			

Drill program N.W. of Corbat between A. Suseginoq + Sharpe Lake

S.L. 1050.0

DUE NORTH

95.0' FAULT GOUGE

254.5' FAULT GOUGE

3-WHITE CAL. STRS.
WHITE CAL. STRS.-BLESS

$\frac{1}{2}$ " PINK CAL.
1" WHITE CAL.-PYR.
1.0' MASSIVE SULPHIDES - CPY.-PYRR.-PBS.

BASAL CONGLOMERATE ?

S.L. 481.0

569.0'

805.0'

ARMSHER RESOURCES INC.

SECTION: D. D. H. NO. B-1

SCALE: 1 INCH = 100 FEET

SW 1/4, S 1/2, Lot 5 CONC 1

DIAMOND DRILL RECORD Bucke TWP

PROPERTY CLAIM # 789172, Bucke TWP

HOLE NO. B1

SHEET NUMBER 1
 LATITUDE 426' North of #3 Post
 DEPARTURE 450' East of #3 Post
 ELEVATION 420' (circa) 1050'

SECTION FROM _____ TO _____
 DATUM _____
 BEARING N(45°) - 0°
 DIP COLLAR (-47°) 650' (-46°)

STARTED Nov 21/86
 COMPLETED Nov. 28/86
 ULTIMATE DEPTH 805'
 PROPOSED DEPTH 700'

DEPTH FEET		GEOLOGY	DEPTH		ECONOMIC	SAMPLE NO.	WIDTH OF SAMPLE	SILVER GOLD'S	SLUDGE GOLD'S
FROM	TO		FROM	TO					
0.0	14.0	Casing Huronan seds.	0.0	14.0	Casing				
14.0	40.0	Conglomerate green matrix red granite pebbles 1/2" to 2"	65.3	65.5	2-1/4" cal. str. (60°) galka				
* 40.0	73.0	sparse pebbles	93.5	95.0	grey green fault gouge mud				
73.0	95.0	green mottled grit alternate beds of congl.	120.5	120.6	1/4" x line calc. (45°) + brown mud gouge				
95.0	238.0	grey wacke odd small pebble	254.5	254.7	fault gouge				
238.0	272.0	congl + brown qtzite	282.0		1/4" white cal. str. (60°)				
			292.5		3 cal. threads (60°)				
272.0	315.0	congl. sparse pebbles	* 382.2	382.9	3 white cal. str. (60°)	A1	0.7'	0.22	
* 315	386.0	congl. coarse pebbles	* 385.2	385.6	white cal. str. + blobs all k's	A2	0.4'	nil	

DUE SOUTH

S.L. 1030.0

1" PINK CAL. - PYR. - ZN.
2" ORANGE-WHITE APLITE
NO WATER RETURN 400.0'

CONTACT - 597.0'
7" CAL. - QTZ.

430.0'

S.L. 624.0

2" WHITE QTZ. - PYR.

COBALT SERIES
KEEWATIN

836.0'

591.0'

S.L. 469.0

ARMSHER RESOURCES INC.

SECTION: D. D. H. NO. B-2

SCALE: 1 INCH = 100 FEET

SW 1/4, S 1/2 Lots, Conc I

DIAMOND DRILL RECORD BUCKE TWP

PROPERTY CLAIM # 789172, Bucke Twp HOLE NO. B2

SHEET NUMBER 1 SECTION FROM _____ TO _____ STARTED Dec Nov 28/86
 LATITUDE 426' North of #3 Post DATUM _____ COMPLETED Nov 29/86
 DEPARTURE 450' East of #3 Post BEARING due South (A3-186°) ULTIMATE DEPTH 205.0
 ELEVATION 1120' (Approx) 1050' DIP 45° PROPOSED DEPTH 200.0

DEPTH FEET	GEOLOGY	DEPTH	ECONOMIC	SAMPLE NO.	WIDTH OF SAMPLE	GOLD %	SLUDGE GOLD %
FROM TO		FROM TO					
0.0 24.0	casing	24.0 84.2	fault gouge yellow mud				
24.0 43.0	Huronian Sed's conglomerate						
43.0 60.0	greyswacke						
60.0 78.0	greyswacke, odd pebble						
78.0 96.0	"						
96.0 114.0	conglomerate						
114.0 150.0	congl. coarse some banded brown g'tzite C45°						
150.0 168.0	slate greyswacke						
168.0 187.0	sparse pebbles with chloritic spots						
187.0 205.0	greywacke, odd pebble Hole stopped						

TESTS.
 CORNER - 47°
 650' - 46°

~~END OF HOLE 205.0~~

DIAMOND DRILL RECORD

PROPERTY CLAIM # 789172 SW 1/4 - 51 - 1075 - COY 1

HOLE NO. B. 2 (deepening)

SHEET NUMBER 11

BUCKLE TWP.

SECTION FROM _____ TO _____

STARTED OCT 26 / 87

LATITUDE 426' NORTH OF #3 POST

DATUM _____

COMPLETED OCT 29 / 87

DEPARTURE 430' EAST OF #3 POST

BEARING 180° DUE SOUTH.

ULTIMATE DEPTH 197.0 - 836.0

ELEVATION 1050.0 (CIRCA)

DIP -45°

PROPOSED DEPTH 800.0

DEPTH FEET		GEOLOGY	DEPTH		ECONOMIC	SAMPLE NO.	WIDTH OF SAMPLE	GOLD g	SLUDGE GOLD g
FROM	TO		FROM	TO					
0.0	197.0	PREVIOUSLY DRILLED NOV. 1986							
		COBBLE SPARS							
197.0		CONCL. SPARSE PEARLS							
261.3	262.7	FRACTURED PEARLS							
271.7	274.0	WELL PEARLED SOME PYR. PDS.							
315.6	360.0	VERY WELL PEARLED	350.1	358.4	1" PINK CAL. PYR. ZN KLS. (45°)	A6	0.3'	0.15	
360.0	439.0	SPARSE PEARLS							
439.0	444.0	BROWN QTRZ.	381.1	384.3	2" ORANGE-WHITE.				
444.0	511.0	LARGE SPARSE PEARLS.	531.2	532.5	WHITE (CAL.) 90° (70°) JEWELRY QTRZ, CAL. QTRZ.				
511.1	540.0	BADLY BROKEN CORE, SOME CAVE, PEARLS.	400.0	400.0	NO WATER RETURN				
		SCARCE.	573.7	573.7	1/4" CAL. SL. PYR. ZN, 40° (LOST WATER RETURN)				
540.0	597.0	COARSE PEARLS	602.2	602.7	CAL. QTRZ, USIN BARREN	A.7	0.7'	tr.	
597.0	613.0	KIEHWATIN LAVA	605.1	605.15	1/2" CRAY CAL. 85° BARREN				

S.L. 1050.0

DUE NORTH

120.0' FAULT - GOUGE

S.L. 387.0

390.0'

COBALT SERIES
KEEWATIN

1" WHITE CAL.
DTZ. PEBBLES - SULPHIDES
CONTACT - 769.0'

S.L. 334.0

ARMSHER RESOURCES INC.

413.5

827.0'

SECTION: D.D.H. NO. B-3

SCALE: 1 INCH = 100 FEET

DIAMOND DRILL RECORD

PROPERTY (Claim # 789172) SW 1/4, S 1/2, Lot 5, CON-1

HOLE NO. B3

BUCKLE TWP

SHEET NUMBER 1

SECTION FROM _____ TO _____

STARTED Oct 20/87

LATITUDE 426' North of #3 Post

DATUM _____

COMPLETED Oct 23/87

DEPARTURE 450' East of #3 Post

BEARING 30° (due north)

ULTIMATE DEPTH 827.0

ELEVATION 1050' (circa)

DIP 60° P. cellar 62° P. 600'

PROPOSED DEPTH _____

DEPTH FEET		GEOLOGY	DEPTH		ECONOMIC	SAMPLE NO.	WIDTH OF SAMPLE	GOLD %	SLUDGE GOLD %
From	To		From	To					
0.0	12.0	COBALT SERIES casing	119.5	120.0	fault gouge, mud				
12.0	29.0	congl. coarse	185.0	-	1/4" white col. str (45°)				
29.0	48.0	greywacke, shaly	247.3	247.4	grt. fine pyr.				
48.0	122.5	" odd pebble	248.1	248.3	col. threads, hem, (40°)				
122.5	145.0	" " "	292.0	293.0	col. threads (40°)				
145.0	157.5	congl.	305.0	-	3" grey mud + breccia				
157.0	237.0	greywacke old pebble	317.0	325.0	col. threads all LS				
237.0	245.0	congl. coarse	366.0	366.7	fault gouge + mud				
245.0	320.0	greywacke old pebble	454.5	455.0	1/2" white col, 1/2" core				
320.0	368.0	congl.	490.6	493.0	col. threads (50°)				
368.0	405.0	congl. very coarse large boulders, pebbles	518.0	-	sp. black col.				
			538.6	538.7	recessed col + breccia				
405.0	572.0	congl. odd small pebble	556.5	-	" " "				
			595.7	-	1/4" col str (60°)				
572.0	619.0	congl. coarse, many small pebbles	596.3	596.4	1/2" white col, quartz, pyr.				
		(CONT. page 2)	606.0	616.0	broken core, mud breccia, col.				
			616.0	616.2	1/2" white col, U, 1/4" (30°)				
					(CONT. page 2)				

DIAMOND DRILL RECORD

PROPERTY CLAIM #789172 HOLE NO. B3

SHEET NUMBER 2 SECTION FROM _____ TO _____ STARTED _____
 LATITUDE _____ DATUM _____ COMPLETED Oct 23/87
 DEPARTURE _____ BEARING _____ ULTIMATE DEPTH 827.0
 ELEVATION _____ DIP (100°) PROPOSED DEPTH 900.0

DEPTH FEET		GEOLOGY	DEPTH		ECONOMIC	SAMPLE NO.	WIDTH OF SAMPLE	SILVER	GOLD SLUDGE GOLD \$	Cu
FROM	TO		FROM	TO						
619.0	759.1	Congl. odd pebble	725.0	725.4	1/4" white col. pyr (30°)					
759.1	769.0	Congl. coarse csts pebbles + sulphides	741.5	741.7	1/4" col sty. (30°)					
		diss + massive (Basal congloniz)	743.6	743.4	1/2" col " pyr. (30°)					
			753.3	-	1/2" white col (80°)	A1	0.2			
			754.5		pyr + galena, chalc					
769.0	827.0	KIEWATON ARCHAIC	759.0	769.0	1/2" col, galena, pyr. (80°)	A2	0.2			
		Rhyolite, cal + phoritic threads	766.3	766.7	diss. + unagg. blobs of pyrite					
		Ph. 80° dissem mass. patches of sulphides	767.5	767.9	98% pebbles + sulphides	A3	0.4			ACID TEST
			769.1	769.5	"	A4	0.4			AT 600'
			550.0	650.0	"	A5	0.4			TESTED - 66°-30'
					sludge samples	550	560			CORRECTED TO 61°-15'
						560	570			
						570	580			
						590	600			
						600	610			
						610	620			
						620	630			
						630	640			
						640	650			

HOLE STOPPED @ 827.0'

TEM. PTG. CO. LTD. NEW LISKEARD

DRILLED BY BARON DIAMOND DRILLING CO

SIGNED J. Pennington PEM

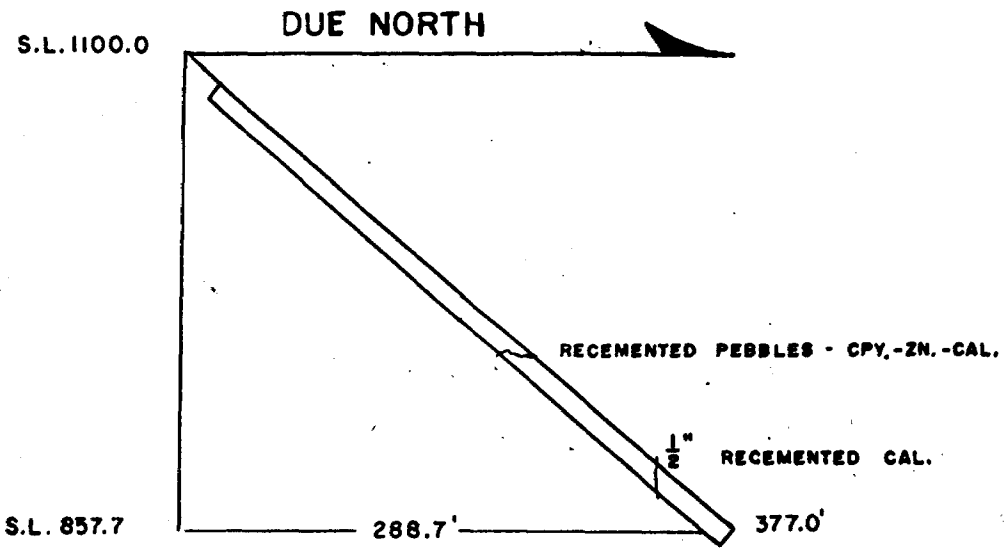

ARMSHER RESOURCES INC.

SECTION: D.D.H. NO. B-4

SCALE: 1 INCH = 100 FEET

DIAMOND DRILL RECORD

PROPERTY (CLAIM # 789172) SW $\frac{1}{4}$ -5 $\frac{1}{2}$ LOTS CON 1

HOLE NO. B.4

SHEET NUMBER 1

BUCKE TWP.

SECTION FROM _____ TO _____

STARTED OCT. 29 - 1987

LATITUDE 696' NORTH OF #3 POST

DATUM _____

COMPLETED Nov. 3 - 1987

DEPARTURE 450' EAST OF #3 POST

BEARING 00° (DUE NORTH)

ULTIMATE DEPTH 377.0'

ELEVATION 1100' (CIRCA)

DIP -40°

PROPOSED DEPTH 400.0'

DEPTH FEET		GEOLOGY	DEPTH		ECONOMIC	SAMPLE NO.	WIDTH OF SAMPLE	SILVER GOLD	SLUDGE GOLD
From	To	COBALT SERIES	From	To					
0.0	22.0	CASING							
22.0	149.0	COBALT CONCL.	74.6	74.7	$\frac{1}{4}$ " CAL STR. N.V.M. 55°				
		WELL PABBLED	92.6	-	$\frac{1}{8}$ " WHITE CAL. N.V.M. 50°				
			148.8	148.9	$\frac{1}{8}$ " PINK CAL. N.V.M. 45°				
149.0	377.0	SPARSE PABBLES							
		GRIT IN SOME	171.1	172.0	FINE CAL. THREAD LENGTH				
		SHORT SECTIONS			OF CORE N.V.M.				
		BROWN QUARTZITE	172.5	172.6	$\frac{1}{8}$ " WHITE CAL. N.V.M. 50°				
		SECTIONS	241.3	241.4	RESEMENTED PABBLES	A.9	0.1		
					DISS. CPY, CAL. ZN.				
			261.5	261.8	CAL. STRS. 50°				
			327.0	327.1	$\frac{1}{2}$ " CAL. RESEMENTED	A.10	0.1		
					N.V.M. 50°				
		HOLE STOPPED @	377.0						

S.L. 1110.0

DUE NORTH

80.0-82.0 FAULT - LOST WATER

2- $\frac{1}{2}$ " CAL. STRS. CPY.

$\frac{1}{2}$ " QTZ. STR. CPY.

$\frac{1}{2}$ " PINK CAL. CPY. - PBS.

S.L. 799.0

370.0'

484.0'

ARMSHER RESOURCES INC.

SECTION: D.D.H. NO. B-5

SCALE: 1 INCH = 100 FEET

DIAMOND DRILL RECORD

PROPERTY (Claim #789172) SW¹/₄-54-Lot 5- Con 1

HOLE NO. B. 5

SHEET NUMBER 1

BOCKE TWP.

SECTION FROM _____ TO _____

STARTED Nov. 6 - 1987

LATITUDE 275' W. OF #2 POST

DATUM _____

COMPLETED Nov. 13 1987

DEPARTURE 900' N. OF #2 POST

BEARING DUE NORTH

ULTIMATE DEPTH 484.0'

ELEVATION 1110' (CIRCA)

DIP -40°

PROPOSED DEPTH 500.0'

DEPTH FEET	GEOLOGY	DEPTH.		ECONOMIC	SAMPLE NO.	WIDTH OF SAMPLE	PG.	SLUDGE GOLD
FROM TO	COBBLE SERIES	FROM	TO					
0.0 - 19.0	CASING							
19.0 - 110.0	MIXED BEDS	80.	82	BROKEN UP - FAULT ZONE.				
	QITE. CONCL.			LIT WATER				
	SOME GOOD SIZED PEBBLES.	116.5	118.3	CHL. THREADS AND VEINETS. 45°				
110.0 - 117.0	BROWNISH QITE.	117.4	117.6	2 - 1/2" CHL. 45° - CPY.	A. 11	0.2		
117.0 - 125.0	CONCL.	117.8	118.2	4 - 1/2" QTX. VEINS; 45°	A. 12	0.4		
125.0 - 127.0	BROWNISH QITE.	126.4	128.9	10 - 1/4" CHL. OR APLITE STRS. 45°				
127.0 - 224.0	CONCL. SPARSE PEBBLES.	147.0	147.3	1/2" QTX. STR. 45° CPY.				
224.0 - 252.0	CONCL. COARSE	152.0	165.0	CHL. OR. CHLORITE THREADS				
252.0 - 296.0	CONCL. SPARSE PEBBLES.	182.1	-	1/4" PINK CHL. 50°				
		309.7	-	1/2" PINK CHL. 45°, CPY-PBS				
296.0 - 304.0	CONCL. COARSE							
304.0 - 347.0	CONCL. SPARSE PEBBLES.							
347.0 - 398.0	CONCL. WELL PEBBLED SOME VERY BIG.							
398.0 - 407.0	CONCL. SPARSE PEBBLES							

DIAMOND DRILL RECORD

PROPERTY (Claim # 759172) SW 1/4 - 54 - 1075 - 2N.1

HOLE NO. B.5

BUCKE TWP.

SHEET NUMBER II

SECTION FROM _____ TO _____

STARTED Nov. 6 - 1987

LATITUDE 275' W. OF # 2 POST

DATUM _____

COMPLETED Nov. 13 - 1987

DEPARTURE 900' N. OF # 2 POST.

BEARING DUE NORTH

ULTIMATE DEPTH 484.0'

ELEVATION 110' (CIRCA)

DIP -40°

PROPOSED DEPTH 500.0'

DEPTH FEET		GEOLOGY	DEPTH		ECONOMIC	SAMPLE NO.	WIDTH OF SAMPLE	TO	SLUDGE GOLD
FROM	TO		FROM	TO					
		COBBLE SERIES							
		FINE DISS. GR.							
407.0	416.0	CRITTY - SMALL							
		SCATTERED PEBBLES							
		DISS. GR.							
416.0	484.0	CONCL. MORE							
		PEBBLES, FINE DISS. GR.							
END OF HOLE 484.0'									
					CORE DIAMETER				
					(1 7/16")				

DUE SOUTH

S.L. 1025.0

6" PINK CAL. CPY-PBS
1/2" WHITE CAL. CPY-PBS
CONTACT-981.0

COBALT

SERIES
KEEWATIN

1032.0'

687.0

S.L. 338.0

729.7

S.L. 298.0

ARMSHER RESOURCES INC.

SECTION: D.D.H. NO. B-6

SCALE: 1 INCH = 100 FEET

DIAMOND DRILL RECORD

PROPERTY CLAIM # 895593 S.E. 1/4 - 34 - Lot 4 - Cont

HOLE NO. B. 6

SHEET NUMBER 1

BUCKE TWP.
SECTION FROM _____ TO _____

STARTED Nov. 16 - 1987

LATITUDE 49° N. OF #2 POST

DATUM _____

COMPLETED Dec. 8 - 1987

DEPARTURE 590' W. OF #2 POST

BEARING DUE SOUTH.

ULTIMATE DEPTH 1032.0

ELEVATION 1025' (CIRCA)

DIP -45°

PROPOSED DEPTH 1500'

DEPTH FEET	GEOLOGY	DEPTH		ECONOMIC	SAMPLE NO.	WIDTH OF SAMPLE	PC	SLUDGE GOLD
From To		From	To					
0.0 - 12.0	CASING							
12.0 - 63.7	CONCH. WELL PERFORATED FINE DISS. PYR.							
63.7 - 66.3	BRICE CONG.							
66.3 - 74.3	SANDSTONE FINE DISS. PYR.	121.2	-	1" CAL. 45° - DARK CRY.				
74.3 - 78.0	CONCH. WELL PERFORATED	130.3	-	1" CAL. 97K. 45° N.V.M.				
78.0 - 82.4	BROWN SANDSTONE	162.7	-	1" CAL. STR. 50° N.V.M.				
82.4 - 86.5	CONCH.							
86.5 - 129.0	BROWN SANDSTONE	183.4	183.5	1/2" QTZ - 55° - N.V.M.				
	BEDS OF VARYING THICKNESS. CONG.	195.7	-	1/8" CAL. 70° - N.V.M.				
	+ SANDSTONE	196.8	196.9	1/2" QTZ - CAL. 50° SH. CRY.				
		200.2	-	1/2" QTZ - 40° - N.V.M.				
129.0 - 183.7	CONCH. WELL PERFORATED.	202.4	-	CAL. THREAD; 55° - N.V.M.				
		247.3	-	1/8" QTZ - 50° SPARK CRY.				
183.7 - 369.0	CONCH. + SANDSTONE							
	BEDS OF VARYING THICKNESS.	290.5	-	1/4" CAL. 45° - N.V.M.				
		299.0	299.5	SEVERAL CAL. THREADS ON SLIPS. 65° - N.V.M.				
		347.3	-	HOURLINE CAL. STR. 45° - N.V.M.				

[Signature]

DIAMOND DRILL RECORD

PROPERTY CLAIM # 895593 - 5E 1/4 - 54 - LOT 4 - CON 1

HOLE NO. B.6

SHEET NUMBER II

BUCKE TWP.

SECTION FROM _____ TO _____

STARTED NOV. 16 - 1987

LATITUDE 490' N. OF #2 POST

DATUM _____

COMPLETED DEC. 8 - 1987

DEPARTURE 590' W. OF #2 POST

BEARING DUE SOUTH.

ULTIMATE DEPTH 1032.0'

ELEVATION 1025' (CIRCA)

DIP - 45°

PROPOSED DEPTH 1500'

DEPTH FEET		GEOLOGY	DEPTH		ECONOMIC	SAMPLE NO.	WIDTH OF SAMPLE	66	SLUDGE GOLD
FROM	TO		FROM	TO					
369	400	CONG. W/TH IRREGULAR	376	386	SEVERAL FINE HIRLINE CAL. ON SLIPS. 65°				
400	423.3	IRREG. - SPARSE	436	-	1" CAL. STR. 20° - N.V.M.				
423.3	426	BROWN SANDSTONE	464	467	SEVERAL HIRLINE CAL.				
426	428	CONG. IRREG. SPARSE			ON SLIPS. 30-50 N.V.M.				
428	430	BROWN SANDSTONE	488	498	SCATTERED CAL. THREADS				
430	725.5	CONG. IRREG. VERY SPARSE.	553.9	-	1" CAL. THREAD 55° N.V.M.				
		SOME SHORT	554.7	-	1/6" CAL. THREAD 60° N.V.M.				
		SANDSTONE SECTIONS	564.8	-	1/16" CAL. THREAD - 55° N.V.M.				
		IRREG. IRREG.	565.6	566.2	SERIES OF FINE CAL. STR.				
		NUMEROUS FROM 523.			TOOK OUT OF BOX.				
		ON A LOT OF	610.3	611.0	SEVERAL CAL. THREADS				
		BROWN CORE. 560-600	621.5	-	IRREG; SPLASH OF CAL.				
		Solid 630 - ON	628.4	628.1	1/8" - 1/4" CAL. STR. 10° - N.V.M.				
			683	683.2	1/4" CAL. STR. 50° N.V.M.				
725.5	730.3	BANDDED SLATE	696.6	696.7	1/4" CAL. 40° " " "				
		PIEDS S&T CORE	706.6	706.7	1/4" CAL. 50° " " "				
730.3	981.0	CONG. FEN IRREG.	713.7	-	1/8" CAL. STR. 45° " " "				

TEM. PTG. CO. LTD. NEW LISKEARD

DRILLED BY BARRON DIAMOND DRILLING

SIGNED

[Handwritten Signature]

DIAMOND DRILL RECORD

PROPERTY CLAIM # 8955 93 - 504 - 5 1/2 - 1074 - CONT

HOLE NO. B. 6

SHEET NUMBER III

SECTION FROM TO

STARTED Nov. 16 - 1987

LATITUDE 490' N. OF #2 POST

DATUM

COMPLETED Dec. 8 - 1987

DEPARTURE 590' W. OF #2 POST

BEARING DUE SOUTH.

ULTIMATE DEPTH 1032.0'

ELEVATION 1025' (CIRCA)

DIP -45°

PROPOSED DEPTH 1500'

DEPTH FEET		GEOLOGY	DEPTH		ECONOMIC	SAMPLE NO.	WIDTH OF SAMPLE	15 INCHES	15 GOLD
FROM	TO		FROM	TO					
730.3	981.0	CONCL. FEW BUBBLES	745.4	745.5	HORIZ. CAL. 45° N.V.M.				
		811.7-813 - FRACTURED	798.7	-	1/8" ERATIC CAL. STR. "				
		833-835 "	821.5	805.2	1/8" CAL. STR. MET IN				
		828.5-830 "			CENTER OF CORE N.V.M.				
		839-852 "	814.0	814.4	1/8" CAL. STR. 30° FLECKS PYR.				
		857-861 "	904.5	-	1/8" CAL. STR. 50° N.V.M.				
		864-866 "	917.5	918.0	BROKEN CORE ROSTY	A.13	0.5'		
		WELL PEARLED	920.8	921.3	GROUND "	A.14	0.5'		
		FROM 857-981.0	930.8	931.3	0.5' PINK. CAL. 60° - GROUND	A.15	0.5'		
		3mm QTZ PEARLED	943.8	943.9	1/2" WHITE CAL. 60° - SPY - POS?				
		917.5-918.0 BROKEN W/	944.1	944.2	1/4" " " 60° N.V.M.				
		920.8-921.3 GROUND "	944.6	944.7	1/2" " " 60° - SPY.				
			944.8	944.9	1/4" " " 60° N.V.M.				
981.0	1032.0	KERWATIN	949.6	949.7	1/2" " " 70° N.V.M.				N70-630 450 SL
CONTACT		KAYGITE BRECCIA	966.3	-	1/4" ERATIC WHITE CAL. N.V.M.				
6934 VERT.		983.5-984.9 ANDESITE							
		984.9-989.5 A. BRECCIA	985.2	985.5	COMBINED SAMPLE.	A.16	0.6'		
		988.5-986.7 ANDESITE	990.3	990.6	WELL FRACTURED				
		986.7-987.9 BRECCIA							
		987.9-989.2 ANDESITE							

TEM. PTG. CO. LTD. NEW LISKEARD

DRILLED BY

BARSON DIAMOND DRILLING

SIGNED

J. Newkome

190°

S.L. 1025.0

1" PINK CAL. CPY.
 5" PINK CAL. PBS.
 1.5" PINK CAL. PBS.
 CONTACT 1008.0'
 COBALT SERIES
 KEEWATIN
 FAULT - 952.0'

S.L. 350.0

S.L. 295.3

1089.5'

729.7'

ARMSHER RESOURCES INC.

SECTION: D. D.H. NO. B-7

SCALE: 1 INCH = 100 FEET

DIAMOND DRILL RECORD

PROPERTY CLAIM # 895593 SE 1/4 - 5 1/2 - LOT 4 - CON 1
HUCKE. TWP.

HOLE NO. B. 7

SHEET NUMBER 1 SECTION FROM _____ TO _____ STARTED DEC 9 - 1987
 LATITUDE 49° N. OF #2 POST. DATUM _____ COMPLETED MAR 6 - 1988
 DEPARTURE 590' W. OF #2 POST. BEARING 190° AST. ULTIMATE DEPTH 1089.5'
 ELEVATION 1025' (CIRCA) DIP - 45° PROPOSED DEPTH 1200'

DEPTH FEET		GEOLOGY	DEPTH		ECONOMIC	SAMPLE NO.	WIDTH OF SAMPLE	AC. GOLD	SLUDGE GOLD
From	To		From	To					
0.0	12.0	CASING							
12.0	100.8	CONCRETE	56.0		1/2" CEMENT 30°				
		560-511 SANDSTONE	67.1		2- 1/2" QTZ. CAL STR. 45°				
		PEBBLES	148.0		CHLORITE SPOTTING				
		511-514 SANDSTONE	188.0		1/2" QTZ. STR. 45°				
		514-522.5 CONG.	549.4	-	2" QTZ. INCLUSION				
		SANDSTONE PEBBLES	532.0	-	1" " "				
		522.5-525.5 SANDSTONE	552.3	-	1/4" QTZ. PINK CAL. 30° N.V.M.				
		525.5-547. CONG.	565.1	565.3	SEVERAL PINK & WHITE				
		SPARSE PEBBLES			CAL. STRS. 40° SI. 1/2 BS.				
		547-551. CONG.	569.3	-	1/2" PINK CAL. & QTZ. 50° N.V.M.				
		LOTS OF PEBBLES	584.5	-	1/2" " " " 30° CRY.				
		551-555. CONG. SANDSTONE	647.3	647.9	GREY GNEISSIC SECTION 45°				
		555-568.7. LOTS OF	730.1	-	1/2" PINK CAL. 50° FINE PYR.				
		PEBBLES	799.9	-	1/4" CAL. STR. 60° N.V.M.				
		568.7-577. CONG. SANDSTONE	809.1	-	1/4" " " 40° " " "				
		577. CONG. SANDSTONE	813	836	SCATTERED HAIRLINE				
		CHLORITE SPOTTING			CAL. STRS. VARIOUS DIPS				
		WALL PEBBLES	932.6	952.8	FAULT. (BLOCK IN BOX)				

[Handwritten Signature]

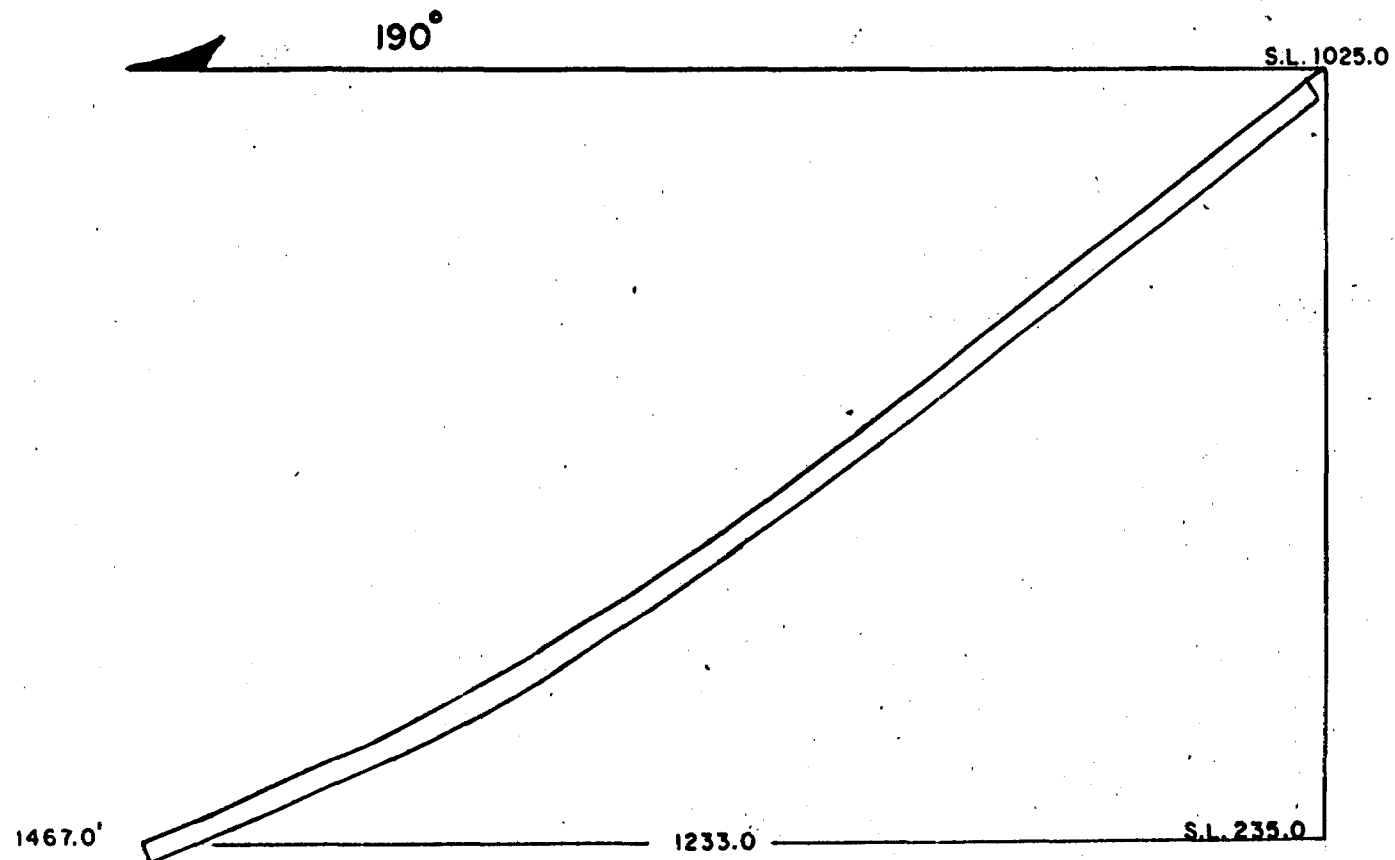

ARMŞHER RESOURCES INC.

SECTION: D.D.H. NO. B-8

SCALE: 1 INCH = 200 FEET

DIAMOND DRILL RECORD

PROPERTY CLAIM # 895593 SE 1/4 - 35 - 1074 - Con 1

HOLE NO. B. 8

SHEET NUMBER I

BUCKE TWP.

SECTION FROM _____ TO _____

STARTED JAN. 6 - 1988

LATITUDE 49° 0' N. OF # 2 POST

DATUM _____

COMPLETED JAN. 22 - 1988

DEPARTURE 590' W. OF # 2 POST

BEARING 190°

ULTIMATE DEPTH 1467.0'

ELEVATION 1025' (CIRCA)

DIP ~~57°~~ - 37°

PROPOSED DEPTH _____

DEPTH FEET		GEOLOGY	DEPTH		ECONOMIC	SAMPLE NO.	WIDTH OF SAMPLE	GR	SLUDGE GOLD
FROM	TO		FROM	TO					
0.0	12.0	COBALT SERIES							
			79.2	-	1" WHITE CAL. 40° N.V.M.				
12.0	1467.0	CONG. 12.0 - 14.5	83.2	-	1/4" " " 45° " " "				
		14.5 - 15.8 SANDSTONE	102.0	102.2	1/2" AND 3/4" QTR. SOME CAL.				
		15.8 MC CONG. AND			30" IN SANDSTONE SL. CAP.				
		NUMEROUS SCATTERED SANDSTONE BEDS.	213.1	-	1/4" WHITE CAL. 70° N.V.M.				
		CONG. WELL PEBBLED	220.5		1/2" QTR-CAL. 40° N.V.M.				
		146-156 SANDSTONE	448	450	FAULT - SOME COUPE.				
		156-201 CONG. WELL PEBBLED.							
		201-203 SANDSTONE.							
		203-206 CONG.							
		206-208 SANDSTONE							
		208-220 CONG.							
		220-540 CONG.							
		SPARSE PEBBLES;							
		SHORT SANDSTONE SECTIONS.							

[Handwritten Signature]

DIAMOND DRILL RECORD

PROPERTY CHAIN # 895593 Sec 4-5 1/2 - Lot 4 - Cont. 1

HOLE NO. R. 8

SHEET NUMBER II

BUCKE TWP.

SECTION FROM _____ TO _____

STARTED JAN - 6 - 1988

LATITUDE 49° N. OF #2 POST

DATUM _____

COMPLETED JAN - 22 - 1988

DEPARTURE 590' W. OF #2 POST

BEARING 190°

ULTIMATE DEPTH 1467.0'

ELEVATION 1025' (CIRCA)

DIP -37°

PROPOSED DEPTH _____

DEPTH FEET		GEOLOGY	DEPTH		ECONOMIC	SAMPLE NO.	WIDTH OF SAMPLE	GOLD	SLUDGE GOLD
FROM	TO		FROM	TO					
		COBBLE SERIES							
		A FEW CLARITE	628.7	-	FINE PINK CAL. STR. 70° N.V.M.				
		SPOTS - (MINOR)	629.1	-	1/4" PINK CAL. 25° N.V.M.				
		581-583.6 SANDSTONE	631.0	631.2	1/4" to 1/2" WHITE CAL. & QTZ.				
		583.6-595 CONG.			30° N.V.M.				
		SPARSE PEBBLES	643.2	-	1/2" CAL. WHITE; 80° " " "				
		595-695 CONG.	673.2	-	SEVERAL PINK CAL.				
		VERY WELL			INCLUSIONS IN MATRIX				
		PEBBLED SOME	708	716	BROKEN CORE.				
		CHRONIC SPOTTING	802		1/4" WHITE CAL. 45° N.V.M.				
		1" CEMENTAT. 694.0							
		695-726 - CONG.							
		Very FEW PEBBLES.							
		708-716 BROKEN CORE							
		726-770 CONG.							
		MORE PEBBLES.							
		SCATTERED CLARITE							
		SPOTTING.							
		770-946 - CONG							
		WELL PEBBLED							

DIAMOND DRILL RECORD

PROPERTY CLAIM #895593 54-52-1074-CON1 HOLE NO. B. 8

SHEET NUMBER III SECTION FROM _____ TO _____ STARTED JAN 6 - 1988
 LATITUDE 490' N. OF #2 POST DATUM _____ COMPLETED JAN-22 - 1988
 DEPARTURE 590' W. OF #2 POST BEARING 190° ULTIMATE DEPTH 1467.0
 ELEVATION 1025' (CIRCA) DIP 37° PROPOSED DEPTH _____

DEPTH FEET		GEOLOGY	DEPTH		ECONOMIC	SAMPLE NO.	WIDTH OF SAMPLE	NO. GOLD'S	SLUDGE GOLD'S
FROM	TO	CO. RAT SERIES	FROM	TO					
			884.8	886.3	RED GRANITE BOULDER				
	887.5	CONG. SCATTERED	960.8	-	1/8" WHITE CAL. 75° N.V.M.				
		PR & CHARCOALS	992.1	993.2	TESTES, HAIRLINE WHITE				
	946	CHAROTIC SPOTTING			CAL. STRS. 30-50° N.V.M.				
			1079.6	-	FINE HAIRLINE CAL. STRS.				
		946-1176 JEWEL	1082.	-	45° + 60° N.V.M.				
		CHAROTIC SPOTTING	1109.6	-	1/4" WHITE CAL. 50° N.V.M.				
		FEW PEBBLES	1131.6	-	1/4" ALSO A FINE WHITE CAL.				
		1176-1262 WELL			STR. 2" ON EITHER SIDE.				
		PEBBLED - CHAROTIC	1152.	-	1/8" WHITE CAL. 45° N.V.M.				
		1262 - HEAVY	1168	-	1/4" " " 45° " "				
		PEBBLED, WELL	1217	-	3/4" PINK CAL. 80° N.V.M.				
		CHAROTIC IN	1238.7	-	1/4" WHITE CAL. 50° " "				
		PLACES.	1250.	1251.5	WELL MINERALIZED HOARDER.				
					CR. OR PEARLITE;				
			1287.5	-	HAIRLINE CAL. STR. 50° N.V.M.				
			1289.1	-	1/8" CAL. STR. 30° N.V.M.				

DUE SOUTH

S.L. 1080.0

896.0 CONTACT

S.L. 425.0

957.0

COBALT SERIES
KEEWATIN

664.0

S.L. 370.0

ARMSHER RESOURCES INC.

SECTION: D.D.H. NO. B-9

SCALE: 1 INCH = 100 FEET

DIAMOND DRILL RECORD

PROPERTY Section # 893393-5E4-56-1074-CON1
BUCKE TWP.HOLE NO. B. 9SHEET NUMBER 1

SECTION FROM _____ TO _____

STARTED Jan-26-1988LATITUDE 300' N. OF #2 POST

DATUM _____

COMPLETED FEB-4-1988DEPARTURE 235' W. OF #2 POSTBEARING 180°ULTIMATE DEPTH 957.0'ELEVATION 1090' (CIRCA)DIP -45°

PROPOSED DEPTH _____

DEPTH FEET		GEOLOGY	DEPTH		ECONOMIC	SAMPLE NO.	WIDTH OF SAMPLE	REMARKS	SLUDGE GOLD
FROM	TO		FROM	TO					
0.0	12.0	CASING	"	"	1/2" WHITE CH. 30°				
12.0	896.0	CONG. & GREYSLACK SOME RED SANDSTONE SL. CHLORITE AT 312 HANDING 30° 279-281-BROKEN CORE 391.7-393.7 SANDSTONE 393.7-473 CONG. FEW PEBBLES 473-487.4 LOTS OF PEBBLES. 487.4-544 CONG FEW PEBBLES 544-668 CONG MORE PEBBLES. SOME LONG CORES 668-831 CONG. VERY FEW PEBBLES SOME CHLORITE SPOTTING	473.1	-	1/2" WHITE CH. 75° N.V.M. 1/4 " " 85° SL. 23°				
			504	515	FRAGMENTED - RUST ON SLIPS - SOME CH. TO				
			633.2		1/4" WHITE CH. NO FLECK CH.				
			650.7	652.2	CORRE? BROKEN - ROUNDED PIECES OF CORE.				

TEM. PTG. CO. LTD. NEW LISKEARD

DRILLED BY BARRON DIAMOND DRILLING

SIGNED

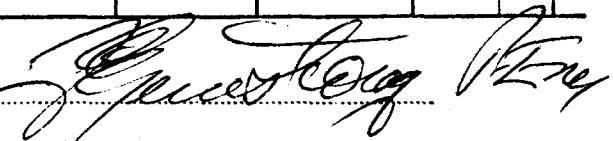

DIAMOND DRILL RECORD

PROPERTY CLAIM # 895593 - SE 1/4 - 5 1/2 - LOT 4 - CON 1

HOLE NO. B. 9

SHEET NUMBER II

SECTION FROM _____ TO _____

STARTED JAN - 26 - 1988

LATITUDE 320' N. OF # 2 POST

DATUM _____

COMPLETED FEB - 4 - 1988

DEPARTURE 235' W. OF # 2 POST

BEARING 180°

ULTIMATE DEPTH 957.0

ELEVATION 1090' (CIRCA)

DIP -45°

PROPOSED DEPTH _____

DEPTH FEET		GEOLOGY	DEPTH		ECONOMIC	SAMPLE NO.	WIDTH OF SAMPLE	AC	SLUDGE GOLD
FROM	TO	COBBLE SERIES	FROM	TO					
		831-896 - CONG.	712	-	1/2" WHITE CRYST. 110° N.V.M.				
		WELL FRAGMENTED.	722.2	-	1/8" " " " 45° " " "				
		SOME CHLORITE.	724.4	-	1/8" " " " 60° " " "				
			727.1	-	1/8" " " " 15° " " "				
896.0	957.0	896.0 - 918.0 KEEWATIN LAVA.	751.5	-	1/8" " " " 75° " " "				
		SOME GRAY	767	-	1/8" " " " 50° " " "				
		TURNED TO BLACK							
		WELL FRAGMENTED	866.5	868.3	BED OF FINE GRIT				
		918-920 - QTZ.			FINE - PYR - PYR - SPY?				
		BRECCIA WELL	875.2	-	1/2" WHITE CAL. 80° N.V.M.				
		FRAGMENTED.						ACID TEST.	
		920-938 BLACK.						DIP AT COLLAR	-45°
		CHERT WELL				837.0		TEST. ETCHED -	53°
		FRAGMENTED.						(CORRECTED) -	(49° 30')
		938-957			END OF HOLE	957.0			
		QTZ BRECCIA.							
		WELL FRAGMENTED.							

63.5193

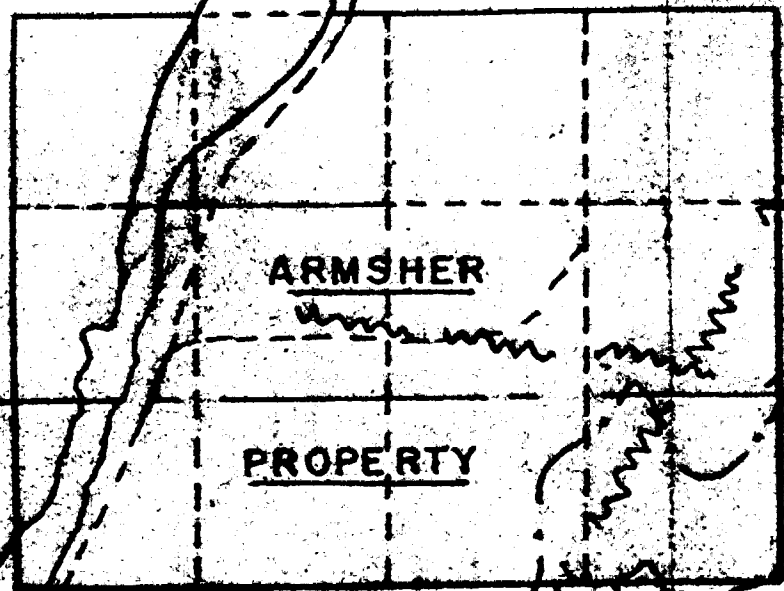

ARMSHER
PROPERTY

TWP. OF BUCKE
TWP. OF COLEMAN

NO. 64 FAULT

SHARP
LAKE

SASAGINAGA
LAKE

TOWN
OF
COBALT

NO. 11 HIGHWAY

TWP. ROAD

TRAIL

CLEAR
LAKE

COBALT LAKE FAULT

LOCATION MAP

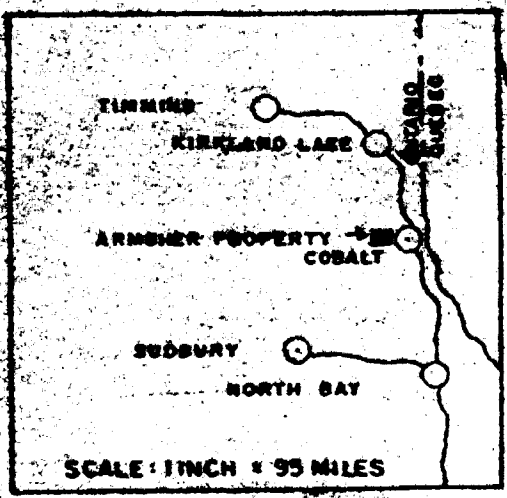

LOCATION MAP
ARMSHER PROPERTY
COBALT AREA

SCALE - 1 INCH = 95 MILES

DATE - DEC 1964

GEOLOGY:
HURONIAN SEDS. Hc9
KEEWATIN COMPLEX K

Hc9 K

NO. 11B. HIGHWAY

K Hc9
O.N.R.



OM 87-6 - L-227

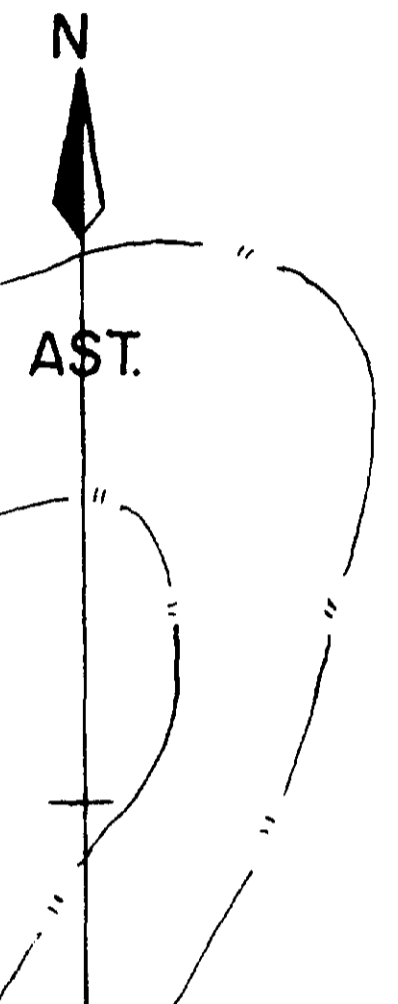
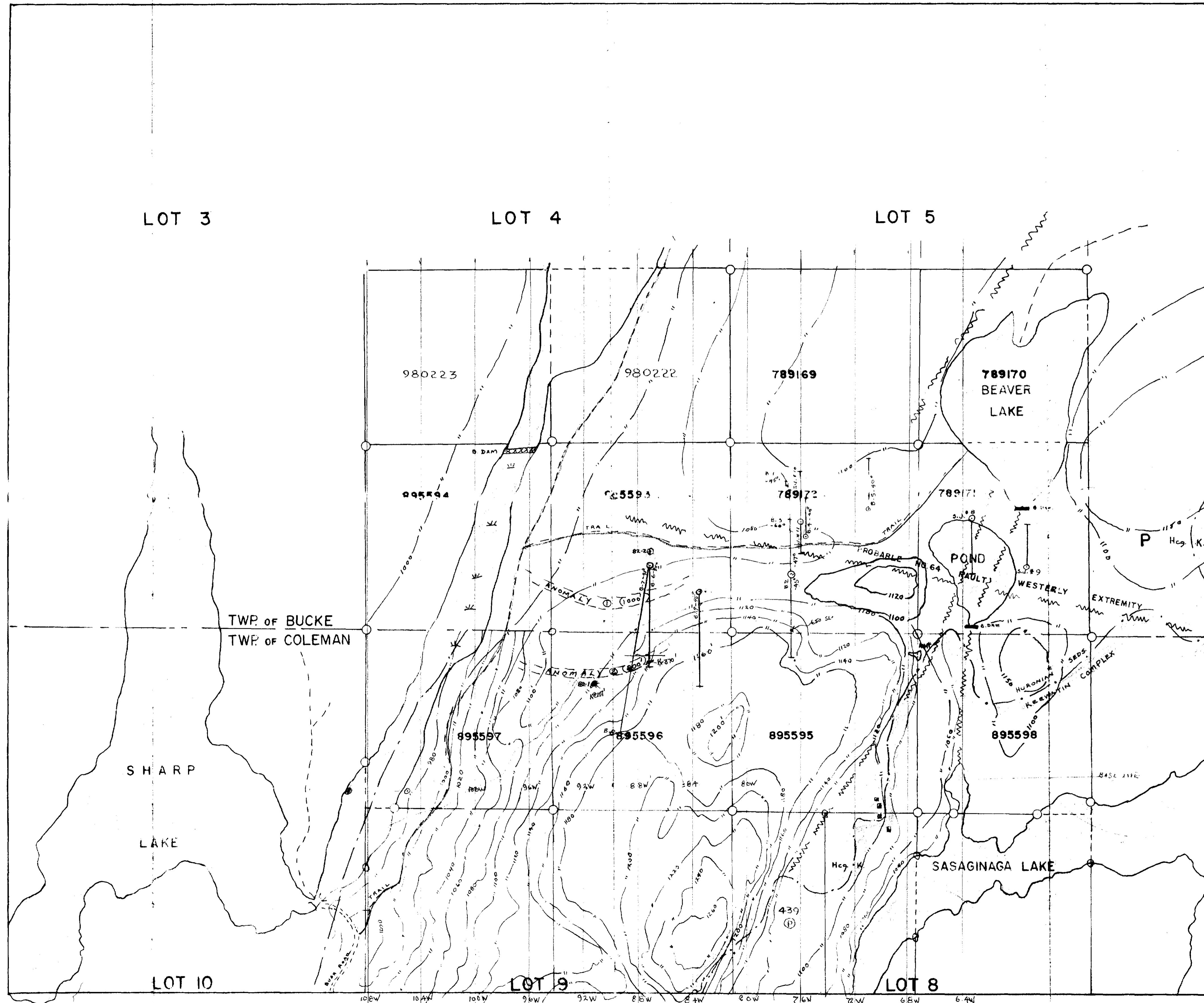

SCALE: 1 INCH = 400 FEET

**ARMSHER
PROPERTY
MAP**

LEGEND

- HURONIAN
- [Hc2] FLAT LYING CONGLOMERATE AND SLATE REDS
- ARCHEAN
- [K.] KEEWATIN - COMPLEX OF BANDED TUFFS AND INTERFLOW SEDIMENTS - STEEPLY DIPPING
- [A] ANOMALY - REGISTERED BY O.G.S. FIELD PARTY



63.5193

DM87-6-C-227

