

DIAMOND DRILLING



31M05NE0021 48 BUCKE

010

Township: Bucke

Report No: 48

WORK PERFORMED FOR: James E. Armstrong

RECORDED HOLDER: SAME AS ABOVE [x]

: OTHER [ ]

<u>CLAIM NO.</u>	<u>HOLE NO.</u>	<u>FOOTAGE</u>	<u>DATE</u>	<u>NOTE</u>
S 789172	B1	805'	Nov/86	(1)
	B2	205'	Nov/86	(1)
		<u>1010'</u>		

NOTES: (1) #125-86 (filed in May/87)

04050101

SW 1/4, S 1/2, Lot 5 CONC I

# DIAMOND DRILL RECORD Bucke TWP

PROPERTY CLAIM # 789172, Bucke TWP

HOLE NO. B<sub>1</sub>

SHEET NUMBER 1  
 LATITUDE 426' North of #3 Post  
 DEPARTURE 450' East of #3 Post  
 ELEVATION 1120' (circa)

SECTION FROM \_\_\_\_\_ TO \_\_\_\_\_  
 DATUM \_\_\_\_\_  
 BEARING N(85°) - 0°  
 DIP COLLAR (-47°) 650' (-46°)

STARTED Nov 21/86  
 COMPLETED Nov 22/86  
 ULTIMATE DEPTH 805'  
 PROPOSED DEPTH 700'

DEPTH FEET		GEOLOGY	DEPTH		ECONOMIC	SAMPLE NO.	WIDTH OF SAMPLE	SILVER	SLUDGE GOLD
FROM	TO		FROM	TO					
0.0	14.0	Casing	0.0	14.0	Casing				
		Huronian sed.							
14.0	40.0	Conglomerite green matrix red granite pebbles 1/2" to 2"	65.3	65.5	2-1/4" col. str. (60°) galena				
40.0	73.0	sparse pebbles	93.5	95.0	grey green fault gouge mud				
73.0	95.0	green mottled grit alternate beds of congl.	120.5	120.6	1/4" x line calc. (45°) + brown mud gouge				
95.0	238.0	grey wacke add small pebble	254.5	254.7	fault gouge				
238.0	272.0	congl + brown qtzite	282.0		1/4" white col. str. (60°)				
			292.5		3 col. threads (60°)				
272.0	315.0	congl. sparse pebbles	382.2	382.9	3 white col. str. (60°)	A <sub>1</sub>	0.7'	0.22	
315	386.0	congl. coarse pebbles	385.2	385.6	white col. str. + blobs all & s	A <sub>2</sub>	0.4'	nil	

SUDBURY  
MINING DIV.  
**RECEIVED**  
DEC - 1 1986  
A.M. 7 8 9 10 11 12 P.M. 1 2 3 4 5 6

CITIZEN & COMPANY  
RECEIVED  
DEC 1 1986

(CONT. ON SHEET 2)

Drilled by Brown Diamond Drilling

*[Signature]*

# DIAMOND DRILL RECORD

PROPERTY Claim # 789 172, Burke Twp

HOLE NO. B#

SHEET NUMBER 2

SECTION FROM \_\_\_\_\_ TO \_\_\_\_\_

STARTED Nov 21/86

LATITUDE \_\_\_\_\_

DATUM \_\_\_\_\_

COMPLETED Nov 28/86

DEPARTURE \_\_\_\_\_

BEARING \_\_\_\_\_

ULTIMATE DEPTH 805'

ELEVATION \_\_\_\_\_

DIP \_\_\_\_\_

PROPOSED DEPTH 700'

DEPTH FEET		GEOLOGY	ECONOMIC		SAMPLE NO.	WIDTH OF SAMPLE	SILVER GOLD'S	COPPER SILVER GOLD'S	CERUIT	HD	VD
FROM	To		FROM	To							
386	436.0	congl. sparse pebbles	417.0	418.0							
			421.0	423.0							
436	586	Congl. many granite etc pebbles	431.6	431.7							
586	624	congl. sparse pebbles, some chloritic spotting	439.5	440.0							
	751										
751	769	congl. large boulders upto 2' diam, grey + red granite	440.5	442.0	A5	0.5'	7/1				
	805	(possible basal bed?)	442.0	444.0	A3	1.5'	0.21				
					A4	2.0'	1/1				
			446.8	467.1	A6	0.3'	1.01	0.09	0.06	HD	
			467.1	467.4	A7	0.3'	0.83	1.15	0.05	VD	
			467.4	467.8							
<u>805'</u>	<u>Hole stopped</u>		650'								
			805'								

SW $\frac{1}{4}$ , S $\frac{1}{2}$  Lots, conc I

# DIAMOND DRILL RECORD

BUCKE TWP

PROPERTY CLAIM #78972, Bucke Twp HOLE NO. B2

SHEET NUMBER 1 SECTION FROM \_\_\_\_\_ TO \_\_\_\_\_ STARTED Dec Nov 28/86  
 LATITUDE 426' North of #3 Post DATUM \_\_\_\_\_ COMPLETED Nov 29/86  
 DEPARTURE 450' East of #3 Post BEARING due South (A3-186°) ULTIMATE DEPTH 205.0  
 ELEVATION 1120' (approx) DIP 45° PROPOSED DEPTH 200.0

DEPTH FEET		GEOLOGY	DEPTH		ECONOMIC	SAMPLE NO.	WIDTH OF SAMPLE	GOLD \$	SLUDGE GOLD \$
FROM	TO		FROM	TO					
0.0	24.0	casing	84.0	84.2	fault gouge yellow mud				
24.0	43.0	Huronian Seds conglomerate							
43.0	60.0	greywacke							
60.0	78.0	greywacke, odd pebble							
78.0	96.0	"							
96.0	114.0	conglomerate							
114.0	150.0	congl. coarse some banded brown qtzite @ 45°							
150.0	168.0	slate greywacke							
	187.0	sparse pebbles some chloritic spots							
187.0	205.0	greywacke, odd pebbles							
	205.0	Hole stopped							

ONTARIO GEOLOGICAL SURVEY  
 REGISTRATION FILES  
 REGISTRATION OFFICE  
 DEC 1 1986  
 RECEIVED

SUDBURY  
 MINING DIV.  
**RECEIVED**  
 DEC - 1 1986  
 P.M.  
 7 8 9 10 11 12 1 2 3 4 5 6

Drilled By Barron Diamond Drilling

*[Signature]*

South

NORTH →

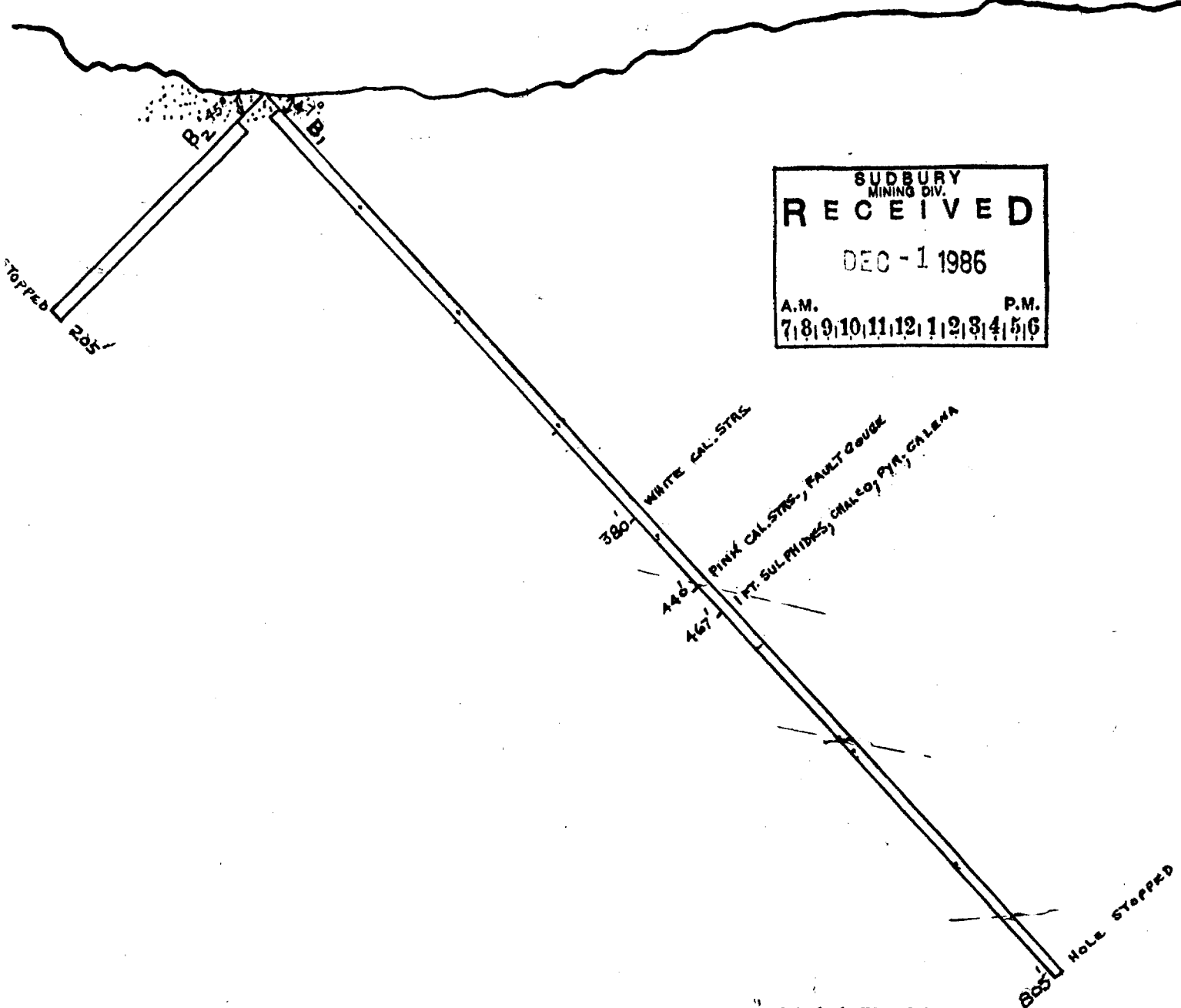

SUDBURY  
MINING DIV.  
**RECEIVED**  
DEC - 1 1985  
A.M. P.M.  
7|8|9|10|11|12|1|2|3|4|5|6

ARMSHER PROPERTY - BUCKE & COLEMAN TWPS.

N-S SECTION THROUGH HOLES B-1 & B2

SCALE: 1" = 100'

CLAIM NO. 789172

NOV 28/86

*J. Jewellery - P. Eng.*

APP "B"

#86-125



31M0SNE0021 48 BUCKE

900

ONTARIO

THE MINING ACT REPORT OF WORK

required for each type of work to be recorded.

To the Recorder of SUDBURY Mining Division

I, James F. ARMSTRONG B 23298 name of Recorded Holder Miner's Licence

P.O. Box 197, 16 Ruby St. COBALT Ontario Post Office Address

do hereby report the performance of 1000 days of Diamond Drilling type of work

not before reported to be applied on the following contiguous claims

Table with columns: Claim No., Days, Claim No., Days, Claim No., Days. Includes handwritten entries like 789169, 200, 789170, 200, 789171, 200, 789172, 200, 895593, 210.

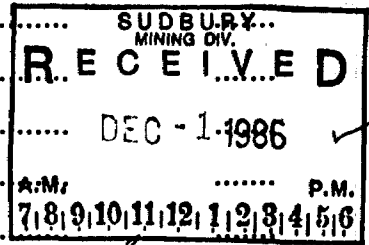
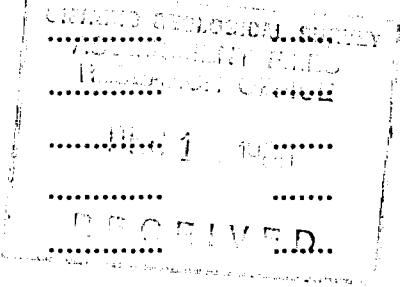

All the work was performed on Mining Claim 789172 (In the case of geological and/or geophysical survey (s) where more than 18 claims are involved attach a schedule)

READ CAREFULLY: THE FOLLOWING INFORMATION IS REQUIRED BY THE MINING RECORDER.

For Manual Work, Stripping or Opening up of Mines, Sinking Shafts or Other Actual Mining Operations - Names and addresses of the men who performed the work and the dates and hours of their employment.

X For Diamond and other Core Drilling - Footage, No. and angle of holes and diameter of core. Name and address of owner or operator of drill. Dates when drilling was done. Signed core log and sketch in duplicate.

For Compressed Air or Other Power Driven or Mechanical Equipment Type of drill or equipment. Names and addresses of men engaged in operating equipment and the dates and hours of their employment.

For Power Stripping - Type of equipment. Name and address of owner or operator. Amount expended. Dates on which work was done. Proof of actual cost must be submitted within 30 days of recording.

With each of the above types of work sketches are required to show the location and extent of the work in relation to the nearest claim post. In the case of diamond or other core drilling the sketch must be submitted in duplicate.

For Geophysical, Geological, Geochemical Surveys and Expenditure Credits - the name of author of report. Covering dates of survey (linecutting & office). Type of instrument used. Total amount of expenditure. Technical reports, maps, expenditure breakdown, receipts must be filed in duplicate with the Minister within 60 days of recording.

For Land Survey - the name and address of Ontario Land surveyor.

The Required Information is as Follows: (Attach a list if this space is insufficient)

Work Assignment

1. 789172 = 810 Balance = 3190

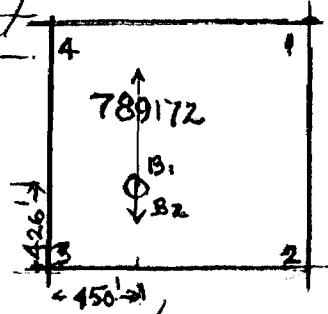

D.D. Hole # B1, due north, dip - (-47°) - 805' - BQ D.D. Hole # B2 " south, dip - (-45°) - 205' - BQ Barron Diamond Drilling

Date Nov 25/86

Signature of Recorded Holder or Agent

The Mining Act Certificate Verifying Report of Work

I, James F. Armstrong P.O. Box 197, COBALT Ontario (Post Office Address)

hereby certify:

- 1. That I have a personal and intimate knowledge of the facts set forth in the report of work annexed here-to, having performed the work or witnessed same during and/or after its completion. 2. That the annexed report is true.

Dated Nov 25 19 86

Signature

THE PENALTY FOR MAKING A FALSE STATEMENT IN THIS REPORT AND/OR CERTIFICATE IS \$500. OR SIX MONTHS IMPRISONMENT OR BOTH

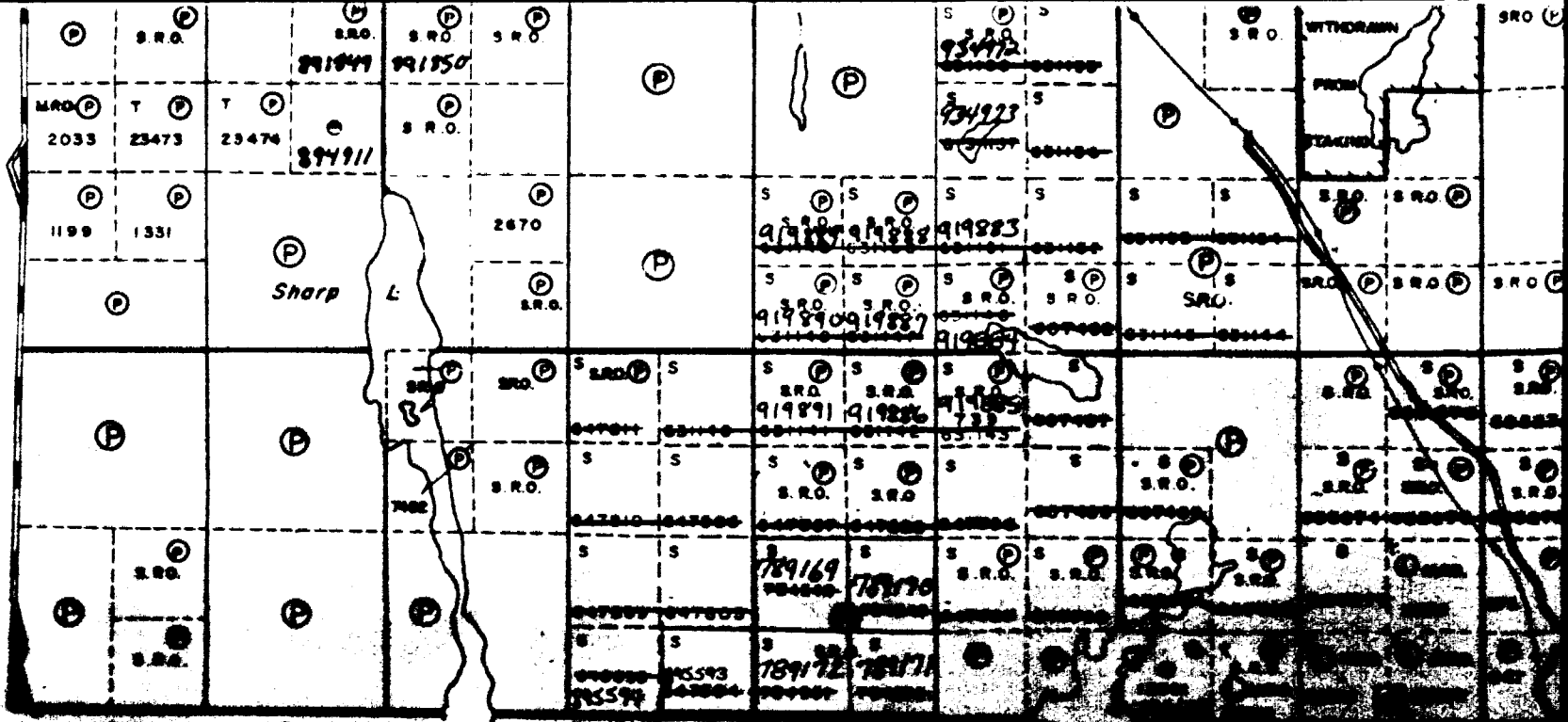

BUCKE TWP. (M. 432)  
 CONC. I. LOTS 4 & 5 (S 1/2)

Coleman Twp. (M. 454)

J.R. VON K.

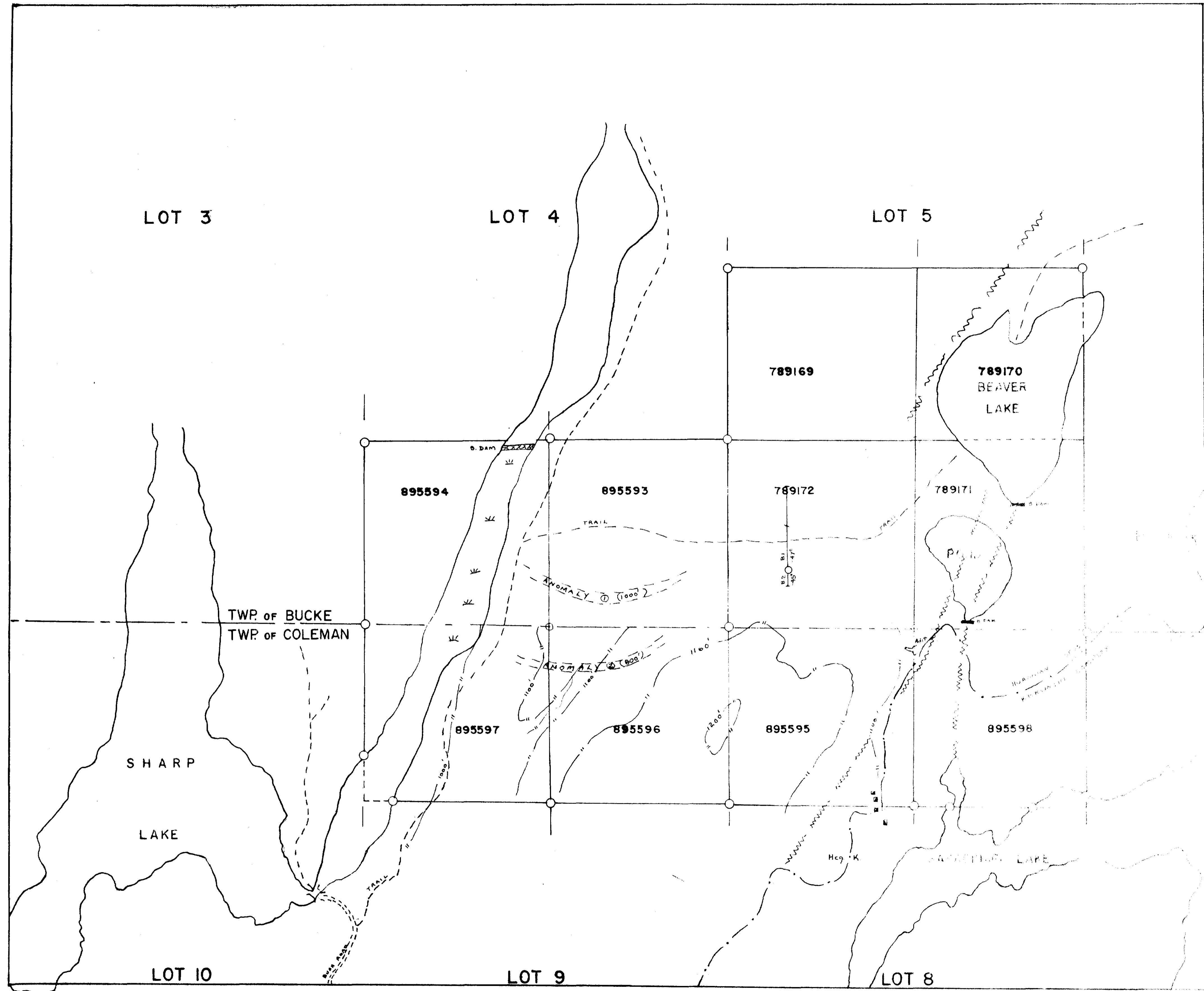

SUDBURY  
MINING DIV.  
**RECEIVED**  
DEC - 1 1986  
A.M. 7:8, 9:10, 11:12, 1:2, 3:4, 5:6 P.M.

N  
↑  
AST.

Appendix "A"  
Plan showing location of  
diamond drill hole Brand B2  
on claim #789172, Bucke Twp  
for assessment work return  
Nov 28/86

*[Handwritten signature]*

