



31M05NE0028 51 BUCKE

010

DIAMOND DRILLING

TOWNSHIP: BUCKE TWP.

REPORT NO: 51

WORK PERFORMED FOR: Armstrong James E.

RECORDED HOLDER: Same as Above [xx]  
: Other [ ]

<u>Claim No.</u>	<u>Hole No.</u>	<u>Footage</u>	<u>Date</u>	<u>Note</u>
789172	B2	<sup>1 2</sup> 836'	Oct/87	(1)
	B3	827'	Oct/87	(1)
	B4	377'	Oct-Nov/87	(1)
		<u>2040</u>		

NOTES: (1) #438-87, filed in April/88

# DIAMOND DRILL RECORD

PROPERTY CLAIM # 789172 SW 1/4 - 34 - 1075 - 041 HOLE NO. B. 2 (deepening)  
BUCKLE TWP.  
 SHEET NUMBER 1 SECTION FROM \_\_\_\_\_ TO \_\_\_\_\_ STARTED OCT 26 / 87  
 LATITUDE 426' NORTH OF #3 POST DATUM \_\_\_\_\_ COMPLETED OCT 29 / 87  
 DEPARTURE 430' EAST OF #3 POST BEARING 180° DUE SOUTH. ULTIMATE DEPTH 197.0 - 836.0  
 ELEVATION 1050.0 (CIRCA) DIP -45° PROPOSED DEPTH 800.0

DEPTH FEET		GEOLOGY	DEPTH		ECONOMIC	SAMPLE NO.	WIDTH OF SAMPLE	GOLD g	SLUDGE GOLD g
FROM	TO		FROM	TO					
0.0	197.0	PREVIOUSLY DRILLED NOV. 1986							
		<u>COBALT SERIES</u>							
197.0		CONGL. SPARSE PEBBLES							
261.3	262.7	FRACTURED PEBBLES							
271.7	274.0	WELL PEASED SOME PYR. PRS.							
315.6	360.0	VERY WELL PEASED	350.1	358.4	1" PINK CAL. PYR, ZN	A6	0.3'	0.15	
360.0	439.0	SPARSE PEBBLES			XLS. (45°)				
439.0	444.0	BROWN QTZ.	381.1	388.3	2" ORANGE-WHITE.				
444.0	511.0	CONGL. SPARSE PEBBLES.	531.2	532.5	APLITE (CAL.) 90° JAVANAL QTZ, CAL. STR.				
511.1	540.0	BADLY BROKEN CORE, SOME CAVE, PEBBLES.	595.7	595.9	70° 1/4" CAL. SL. PYR, ZN, 40° (LOST WATER RETURN)				
		SCARCE.	602.2	602.9	CAL, QTZ, VEIN BARREN	A.7	0.7'	TV.	
590.0	597.0	COARSE PEBBLES							
597.0	613.0	KIEFERTIN LAVA	605.1	605.15	1/2" GRAY CAL. 85° BARREN				

ONTARIO GEOLOGICAL SURVEY  
 ASSESSMENT FILE  
 NOV 17 1987  
 RECEIVED

# DIAMOND DRILL RECORD

PROPERTY CLAIM # 789172-5W<sup>1</sup>/<sub>2</sub>-5<sup>1</sup>/<sub>2</sub>-10T5-CON 1 HOLE NO. B.2

SHEET NUMBER 11

SECTION FROM \_\_\_\_\_ TO \_\_\_\_\_

STARTED OCT. 26/87

LATITUDE 426' NORTH OF #3 POST.

DATUM \_\_\_\_\_

COMPLETED OCT 29/87

DEPARTURE 450' EAST OF #3 POST.

BEARING 180° DUE SOUTH.

ULTIMATE DEPTH 197.0 - 836.0

ELEVATION 1050.0 (CIRCA)

DIP -45°

PROPOSED DEPTH 800.0

DEPTH FEET		GEOLOGY	DEPTH		ECONOMIC	SAMPLE NO.	WIDTH OF SAMPLE	GOLD %	SLUDGE GOLD %
FROM	TO								
		<u>KEEWATIN</u>	<u>601.8</u>	<u>-</u>	<u>1/2" WHITE CAL. 85° BARREN</u>				
<u>613.0</u>	<u>622.0</u>	<u>KEEWATIN</u> <u>ACID LAVA</u>							
<u>622.0</u>	<u>639.0</u>	<u>KEEWATIN</u>	<u>636.6</u>	<u>636.8</u>	<u>1/2" WHITE CAL (20°)</u>				
		<u>COARSE, ICHEOUS</u>	<u>639.6</u>	<u>639.7</u>	<u>1/2" " " (40) N.V.M.</u>				
		<u>ANDESITE</u>	<u>672.1</u>	<u>672.4</u>	<u>2" WHITE STR. PR. 20°</u>	<u>A.8</u>	<u>0.3'</u>	<u>0.22</u>	
<u>639.0</u>	<u>836.0</u>	<u>KEEWATIN, ACID</u> <u>DARK, RHYOLITIC</u> <u>WITH COARSE</u> <u>ANDESITE, MANY</u> <u>CALCITE THREADS</u> <u>AND VEINLETS</u> <u>10° TO 20°</u>							
					<u>END OF HOLE 836.0'</u>				

# DIAMOND DRILL RECORD

PROPERTY (claim # 789/172) SW 1/4, S 1/2, Lot 5, Con. I

HOLE NO. B3

SHEET NUMBER 1 SECTION FROM \_\_\_\_\_ TO \_\_\_\_\_

STARTED Oct 20/87

LATITUDE 426' North of #3 Post DATUM \_\_\_\_\_

COMPLETED Oct 23/87

DEPARTURE 450' East of #3 Post BEARING 30° (due north)

ULTIMATE DEPTH 827.0

ELEVATION 1050' (circa) DIP 60° collar 62° @ 600'

PROPOSED DEPTH \_\_\_\_\_

DEPTH FEET		GEOLOGY	DEPTH		ECONOMIC	SAMPLE NO.	WIDTH OF SAMPLE	GOLD \$	SLUDGE GOLD \$
FROM	TO		FROM	TO					
6.0	12.0	COBALT SERIES casing	119.5	120.0	fault gouge, mud				
12.0	29.0	congl. coarse	188.0	-	1/4 white cal. str (45°)				
29.0	48.0	greywacke, stony	247.3	247.4	grt. fine pyr.				
48.0	122.5	" odd pebble	248.1	248.3	sol. threads, hem, (40°)				
122.5	145.0	" " "	292.0	293.0	cal. threads (40°)				
145.0	157.5	congl.	305.0	-	3" grey mud + breccia				
157.0	237.0	greywacke old pebble	317.0	325.0	cal. threads all L S				
237.0	245.0	congl. coarse	366.0	366.7	fault gouge + mud				
245.0	320.0	greywacke old pebble	454.5	455.0	1/2" white cal, ll to core				
320.0	368.0	congl.	490.6	493.0	cal. threads (50°)				
368.0	405.0	congl. very coarse large boulders, pebbles	518.0	-	splack cal.				
			538.6	538.7	reccemented cal + breccia				
405.0	572.0	congl. odd small pebble	556.5	-	" " "				
			595.7	-	1/4" cal str (60°)				
572.0	619.0	congl. coarse, many small pebbles	596.3	596.4	1/2" white cal + qtz, pyr.				
		(CONT. PAGE 2)	606.0	606.0	breccia core, mud breccia, cal.				
			606.0	606.2	1/2" white cal, U, pyr (30°)				
					(CONT. PAGE 2)				

ONTARIO GEOLOGICAL SURVEY  
ASSESSMENT FILES  
RESEARCH OFFICE  
NOV 17 1987  
RECEIVED

# DIAMOND DRILL RECORD

PROPERTY CLAIM #789172 HOLE NO. B3

SHEET NUMBER 2 SECTION FROM \_\_\_\_\_ TO \_\_\_\_\_ STARTED \_\_\_\_\_  
 LATITUDE \_\_\_\_\_ DATUM \_\_\_\_\_ COMPLETED Oct 23/87  
 DEPARTURE \_\_\_\_\_ BEARING \_\_\_\_\_ ULTIMATE DEPTH 827.0  
 ELEVATION \_\_\_\_\_ DIP (60°) PROPOSED DEPTH 900.0

DEPTH FEET		GEOLOGY	DEPTH		ECONOMIC	SAMPLE NO.	WIDTH OF SAMPLE	SILVER GOLD	GOLD SLUDGE GOLD	Cu
FROM	TO		FROM	TO						
619.0	759.1	congl. odd pebble	725.0	725.4	1/4" white cal. pyr (30°)					
759.1	769.0	congl. coarse gtz pebbles + sulphides	741.5	741.7	1/4" cal sty. (60°)					
		diss + massive (Basal conglatz)	743.6	743.4	1/2" cal " pyr. (50°)					
			753.3	-	1/2" white cal (80°)	A1	0.2			
			754.5		pyr + galena, chalc					
769.0	827.0	<u>KIEWATIN</u> <u>ARCHAIC</u> Rhyolite, cal + chlorite threads @ 50°, dissem thinness. patches of sulphides	759.6	769.0	diss. + mass. blobs of pyrite	A2	0.2			
			766.3	766.7	98% pebbles + sulphides	A3	0.4			
			767.5	767.4	"	A4	0.4			
			769.1	769.5	"	A5	0.4			
			550.0	650.0	Sludge Samples	550	560			
						560	570			
						570	580			
						590	600			
						600	610			
						610	620			
						620	630			
						630	640			
						640	650			
HOLE STOPPED @ 827.0'										

TEM. PTG. CO. LTD. NEW LISKEARD

DRILLED BY BARON DIAMOND DRILLING CO

SIGNED J. Pennington PER

# DIAMOND DRILL RECORD

PROPERTY (Claim #789172) SW $\frac{1}{4}$ -SW $\frac{1}{4}$  LOTS CON 1 HOLE NO. B.4

SHEET NUMBER 1 SECTION FROM \_\_\_\_\_ TO \_\_\_\_\_ STARTED OCT. 29 - 1987  
 LATITUDE 696' NORTH OF #3 POST DATUM \_\_\_\_\_ COMPLETED NOV. 3 - 1987  
 DEPARTURE 450' EAST OF #3 POST BEARING 00° (DUE NORTH) ULTIMATE DEPTH 377.0'  
 ELEVATION 1100' (CIRCA) DIP -40° PROPOSED DEPTH 400.0'

DEPTH FEET		GEOLOGY	DEPTH		ECONOMIC	SAMPLE NO.	WIDTH OF SAMPLE	SILVER	SLUDGE GOLD
FROM	TO		FROM	TO					
0.0	22.0	CASING							
22.0	149.0	CORAL CONCL. WELL PABBLED	74.6	74.7	$\frac{1}{4}$ " CAL + GTR. N.V.M. 55°				
			92.6	-	$\frac{1}{8}$ " WHITE CAL. N.V.M. 50°				
			148.8	148.9	$\frac{1}{8}$ " PINK CAL. N.V.M. 45°				
149.0	377.0	SPARSE PEBBLES GRIT IN SOME SHORT SECTIONS BROWN QUARTZITE SECTIONS.	171.1	172.0	FINE CAL. THREAD LENGTH OF CORE N.V.M.				
			172.5	172.6	$\frac{1}{8}$ " WHITE CAL. N.V.M. 50°				
			241.3	241.4	RECEMENTED PABBLES DISS. CPY, CAL. ZN.	A.9	0.1		
			261.5	261.8	CAL. STRS. 50°				
			327.0	327.1	$\frac{1}{2}$ " CAL. RECEMENTED N.V.M. 50°	A.10	0.1		
		HOLE STOPPED @ 377.0'							

MINARIO GEOLOGICAL SURVEY  
 ASSESSMENT FILES  
 RESEARCH OFFICE  
 NOV 17 1987  
 RECEIVED

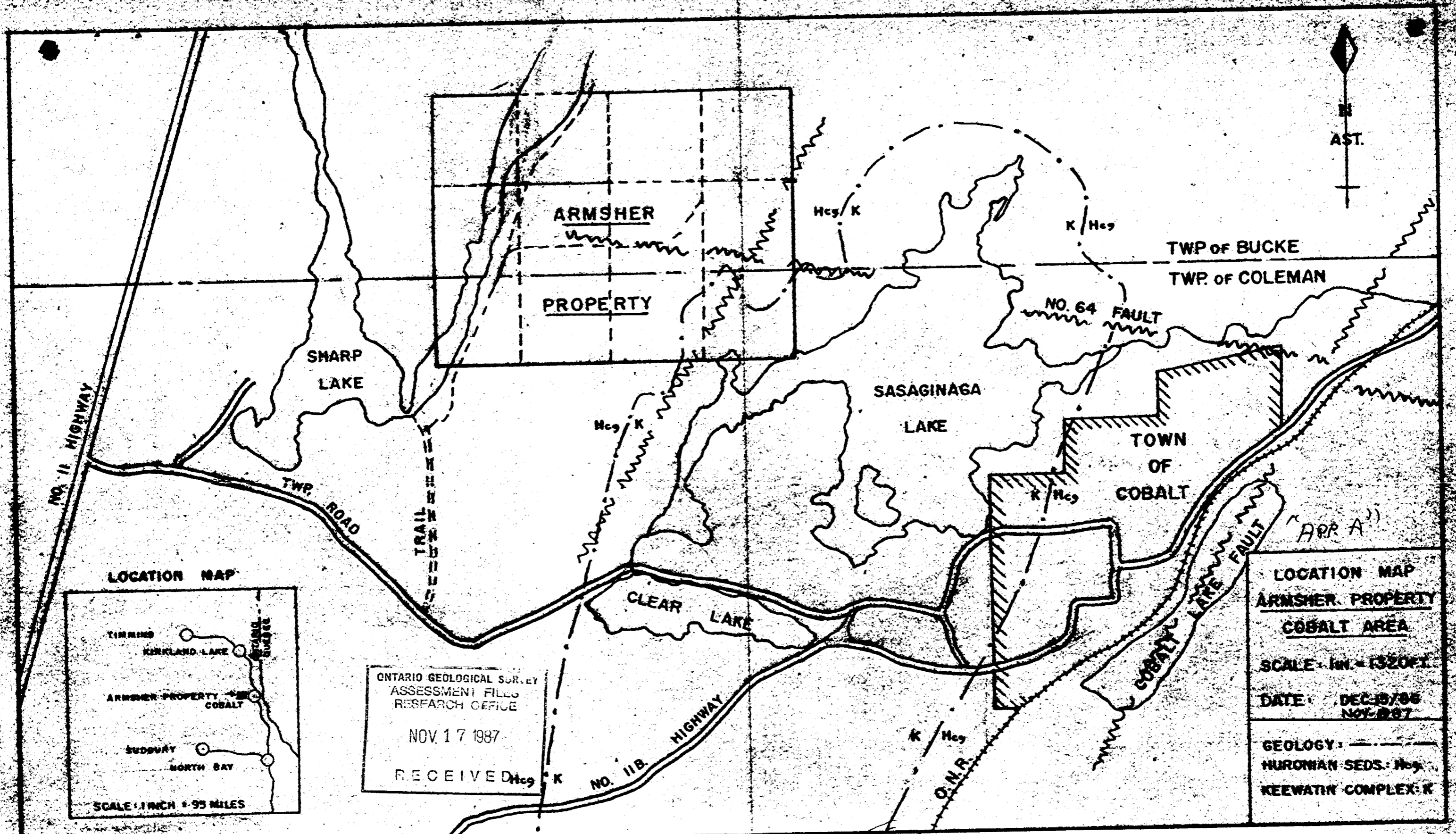

ARMSHER

PROPERTY

SHARP LAKE

SASAGINAGA LAKE

CLEAR LAKE

TOWN OF COBALT

TWP. OF BUCKE  
TWP. OF COLEMAN

NO. 64 FAULT

COBALT LAKE FAULT  
"APP A"

NO. 11 HIGHWAY

TWP. ROAD

TRAIL

NO. 11B HIGHWAY

C.N.R.

LOCATION MAP

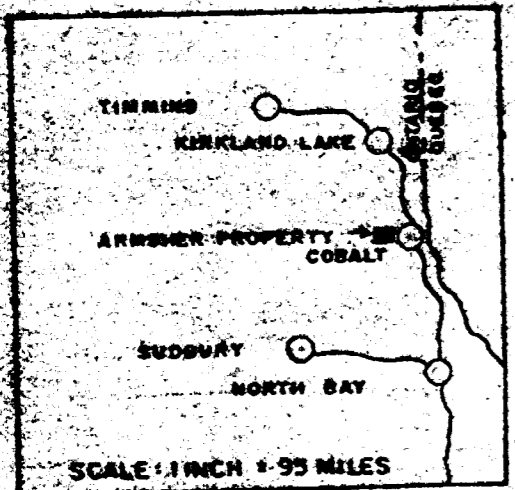

ONTARIO GEOLOGICAL SURVEY  
ASSESSMENT FILES  
RESEARCH OFFICE  
NOV. 17 1987  
RECEIVED

LOCATION MAP  
ARMSHER PROPERTY  
COBALT AREA  
SCALE: 1 IN. = 1320 FT.  
DATE: DEC. 15/86  
NOV. 1987  
GEOLOGY:  
HURONIAN SEDS.: Hcg  
KEEWATIN COMPLEX: K

RE ASSESSMENT WORK FOR J.E. ARMSTRONG CLAIMS

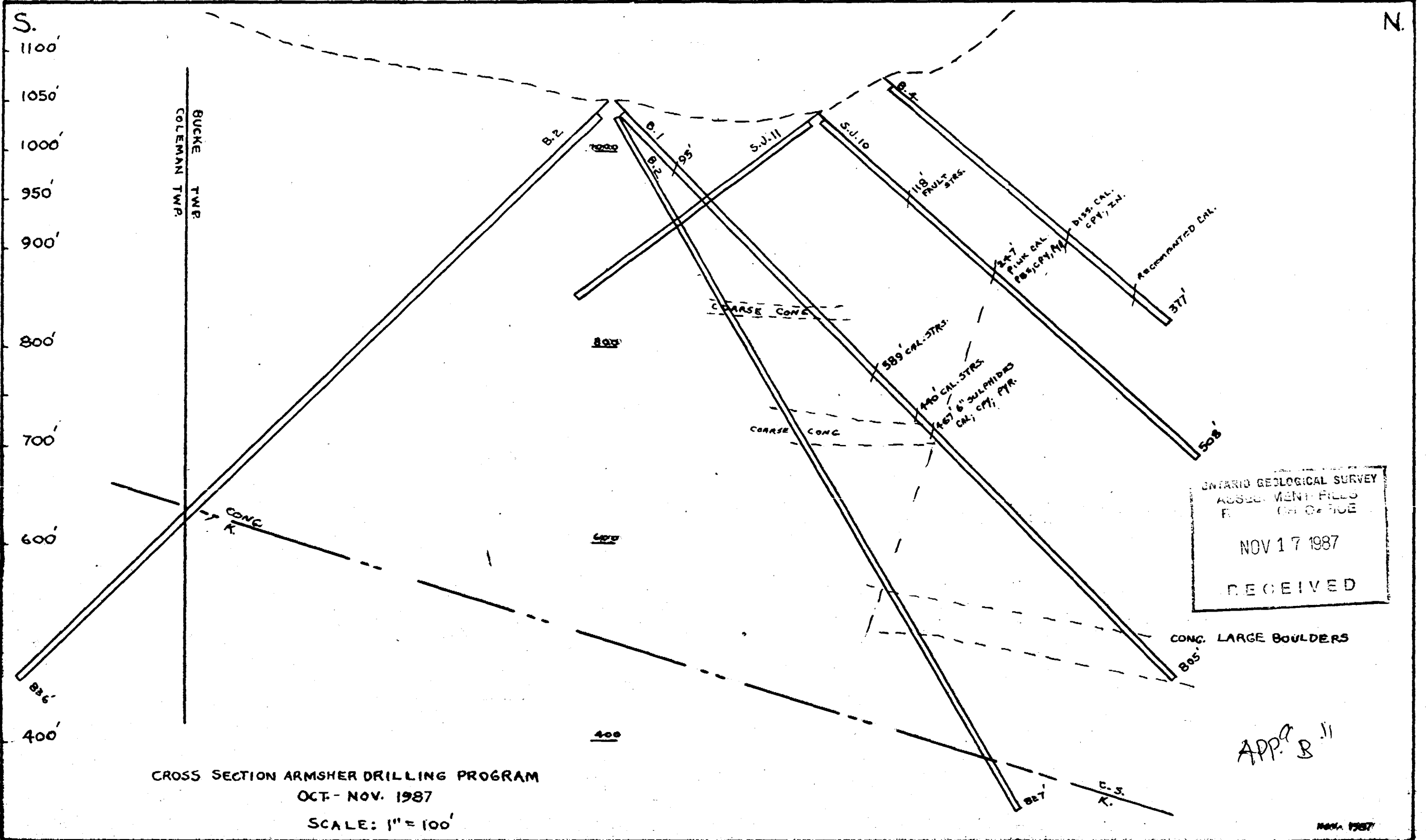

ONTARIO GEOLOGICAL SURVEY  
 ASSESSMENT FILES  
 F. 100 OF 100  
 NOV 17 1987  
 RECEIVED

CROSS SECTION ARMSHER DRILLING PROGRAM  
 OCT - NOV. 1987  
 SCALE: 1" = 100'

APP. B.11



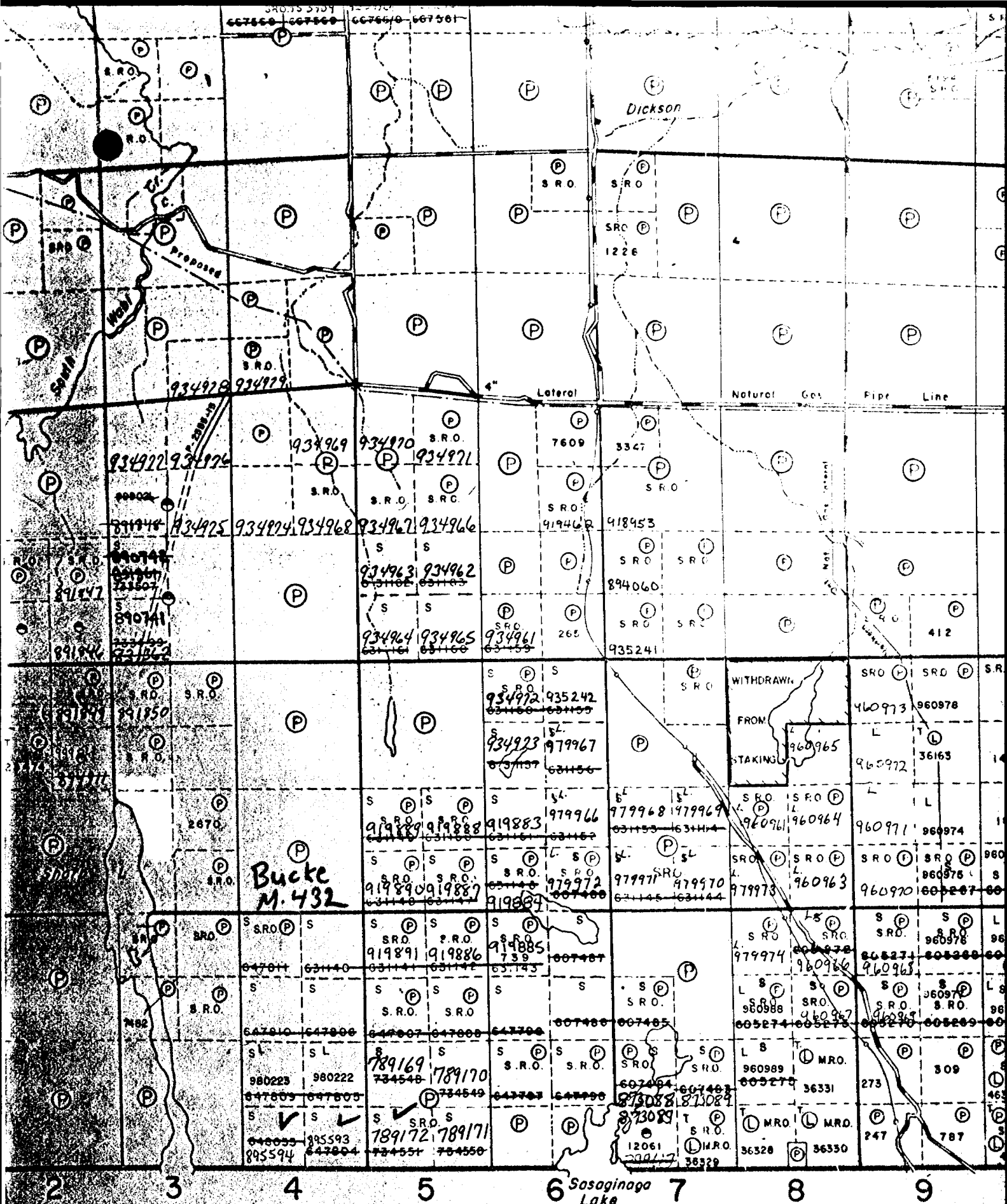

ONTARIO GEOLOGICAL SURVEY  
 ASSIGNMENT FIELD  
 OFFICE  
 NOV 17 1987

# Coleman Twp. (M.454)





Ministry of Northern Development and Mines

Assess. Wkb. Report of Work 438/87



31M05NE0028 51 BUCKE

900

Bucke Twp., Coleman

Mining /

Name and Postal Address of Recorded Holder  
**ARMSTRONG & JAMES E.**  
**Box 197 COBALT ONT. P0S-1K0**

Summary of Work Performance and Distribution of Credits

Total Work Days Cr. claimed <b>1400</b>	Mining Claim			Work Days Cr.	Mining Claim			Work Days Cr.	Mining Claim			Work Days Cr.
	Prefix	Number	Work Days Cr.		Prefix	Number	Work Days Cr.		Prefix	Number	Work Days Cr.	
for Performance of the following work. (Check one only) <input type="checkbox"/> Manual Work <input type="checkbox"/> Shaft Sinking Drifting or other Lateral Work. <input type="checkbox"/> Compressed Air, other Power driven or mechanical equip. <input type="checkbox"/> Power Stripping <input checked="" type="checkbox"/> Diamond or other Core drilling <b>BX</b> <input type="checkbox"/> Land Survey		895593	200		789172	200.0						
		895594	200									
		895595	200									
		895596	200									
		895597	200									
		895598	200									
		90822	200									
	90823	200										

All the work was performed on Mining Claim(s): **# ~~789172~~ 789172**

Required Information eg: type of equipment, Names, Addresses, etc. (See Table Below)

D.D. HOLE # B2 (deepening 197.0 - 836.0) - 639.0 feet  
 D.D. Hole # B3 (0.0 - 827.0) - 827.0 "  
 D.D. Hole # B4 (0.0 - 377.0) - 377.0 "  
**TOTAL DRILLED 1843.0 feet**

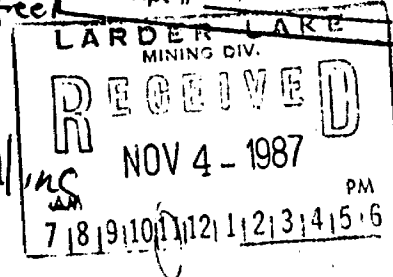
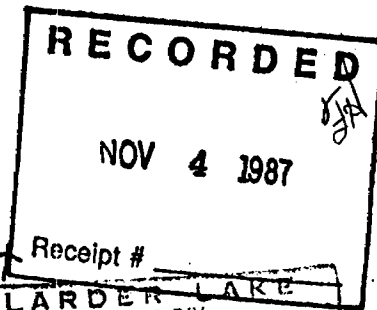

Drilling by Barron Diamond Drilling  
 1001 INDUSTRIAL DR. HAILEY BURY ONT  
 P0S-1K0

NOV 17 1987

Date of Report: **NOV 4/87**  
 Recorded Holder or Agent (Signature): **B23298**

Certification Verifying Report of Work

I hereby certify that I have a personal and intimate knowledge of the facts set forth in the Report of Work annexed hereto, having performed the work or witnessed same during and/or after its completion and the annexed report is true.

Name and Postal Address of Person Certifying

**JAMES E. ARMSTRONG P. Eng**

Date Certified

**NOV 4/87**

Certified by (Signature)

*[Signature]*

Table of Information/Attachments Required by the Mining Recorder

Type of Work	Specific information per type	Other information (Common to 2 or more types)	Attachments
Manual Work	Nil	Names and addresses of men who performed manual work/operated equipment, together with dates and hours of employment.	Work Sketch: these are required to show the location and extent of work in relation to the nearest claim post.
Shaft Sinking, Drifting or other Lateral Work			
Compressed air, other power driven or mechanical equip.	Type of equipment	Names and addresses of owner or operator together with dates when drilling/stripping done.	PLAN SECTION APPENDIX Work Sketch (as above) in duplicate
Power Stripping	Type of equipment and amount expended. Note: Proof of actual cost must be submitted within 30 days of recording.		
Diamond or other core drilling <b>BOX</b>	Signed core log showing: footage, diameter of core, number and angles of holes.		
Land Survey	Name and address of Ontario land surveyor.	Nil	Nil

LOT 3

LOT 4

LOT 5



SCALE: 1 INCH = 400 FEET

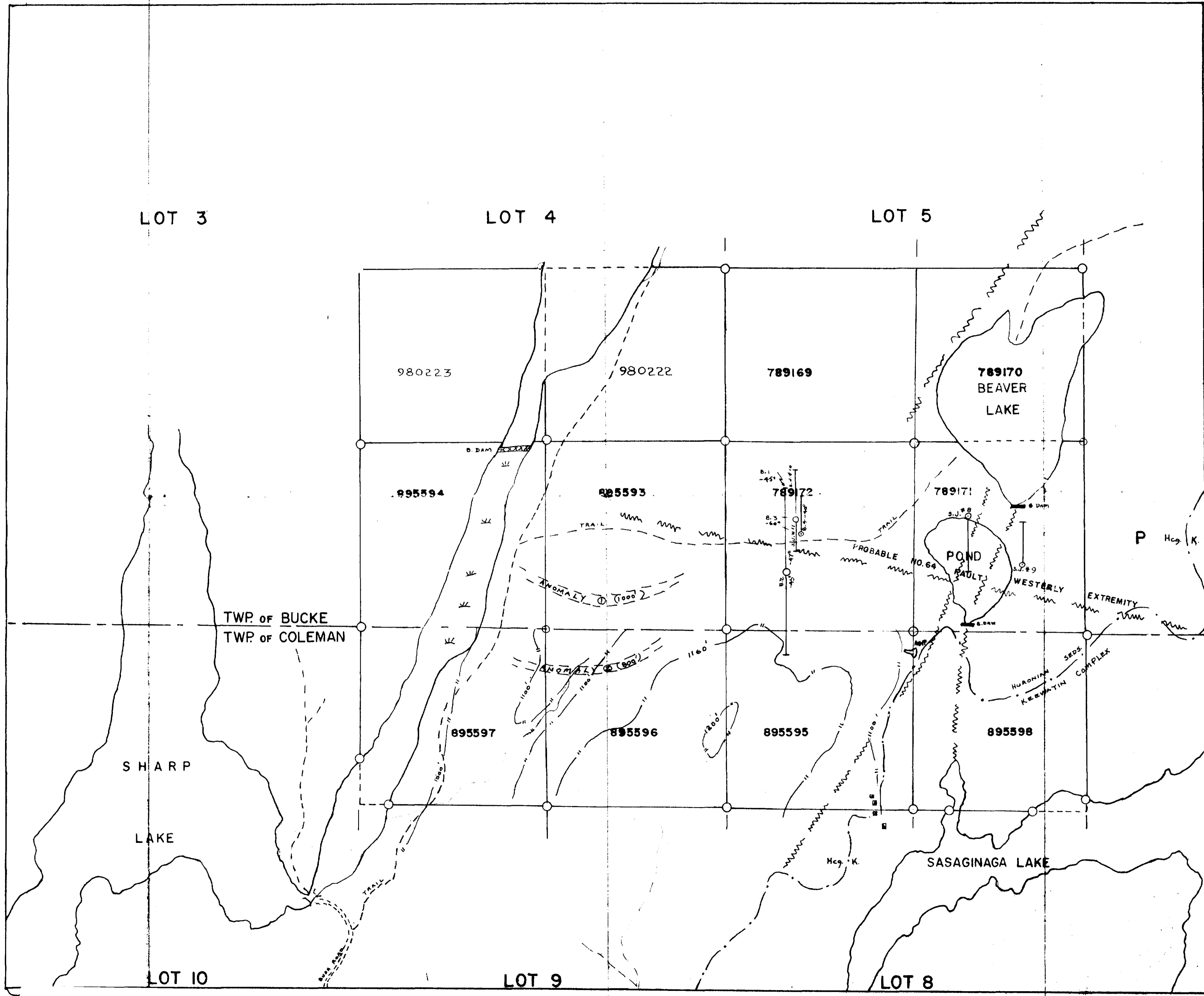

APPENDIX "c"

ARMSHER PROPERTY MAP

LEGEND

- HURONIAN
- [Hcg] FLAT LYING CONGLOMERATE AND SLATE BEDS
- ARCHEAN
- [K.] KEEWATIN - COMPLEX OF BANDED TUFFS AND INTERFLOW SEDIMENTS - STEEPLY DIPPING
- [Anomaly symbol] ANOMALY - REGISTERED BY O.G.S. FIELD PARTY

NOV 17 1987 RECEIVED

