



Diamond Drill

31M05NE0122 39 LORRAIN

010

Township of LORRAIN

Report N<sup>o</sup>: 39

Work performed by: R.C. McAllister

| Claim N <sup>o</sup> | Hole N <sup>o</sup> | Footage | Date   | Note |
|----------------------|---------------------|---------|--------|------|
| S 398702             | 45-74-1             | 28'     | Nov/74 | (1)  |

Notes: (1) 6/75

COLEMAN TWP. (M. 454)

X

XI

XII

XI MILL

BUCKE TWP. (M. 432)

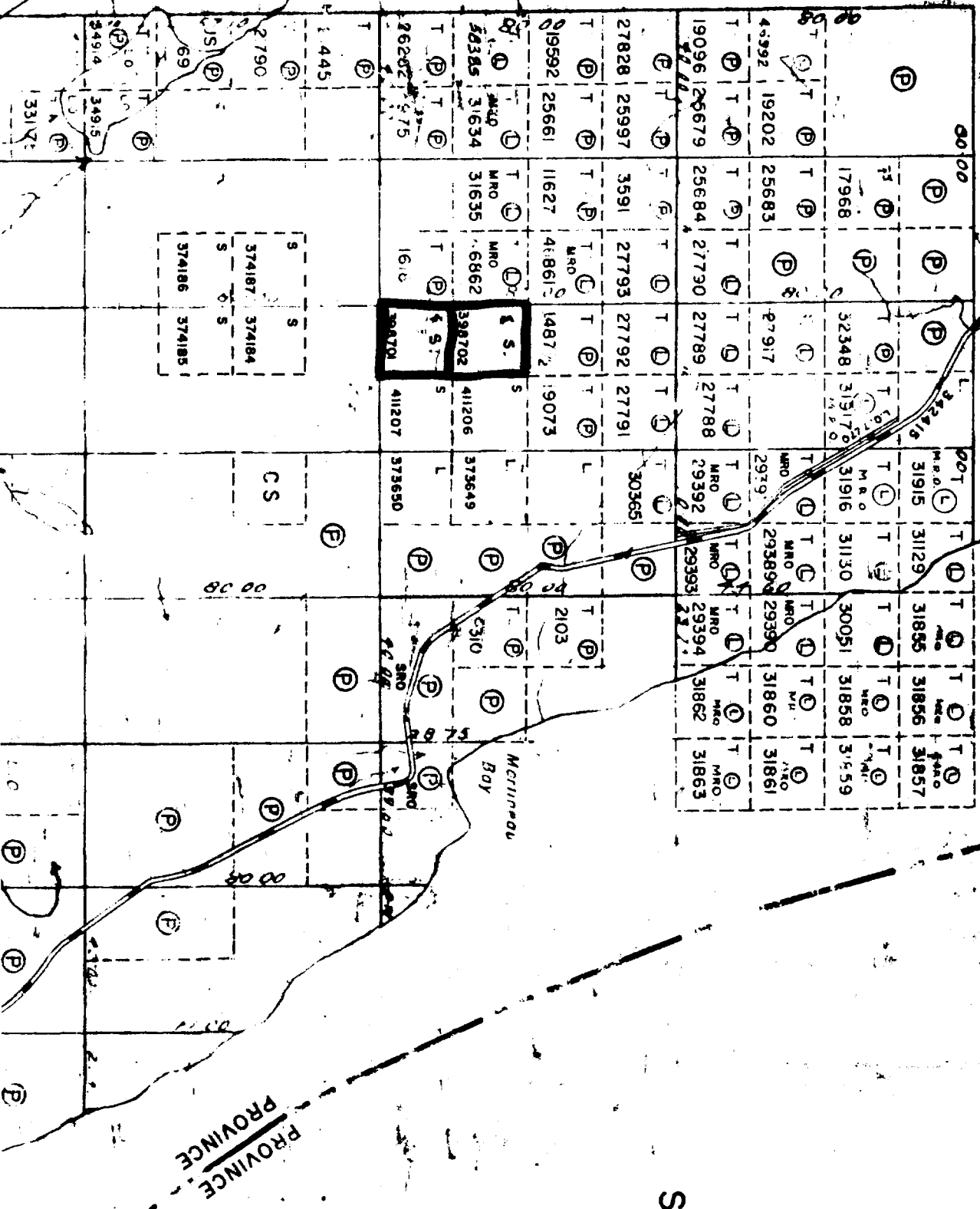

# LORRAIN

TWP. OF

DISTRICT OF  
TIMISKAMING

SUDBURY  
MINING DIVISION

SCALE: 1 INCH = 40 CHAINS

Timiskaming

# 6-75 LORRAIN Twp.

CLAIM 398702 LORRAIN TWP.  
D.H. 45-74-1

"A" CORE 1.03"

NOVEMBER 6, 7, 8, 9 & 10, 1974  
BOYLES X-RAY DRILL  
ALTON MCKNIGHT

E 332  
N 200 FROM 3-398702

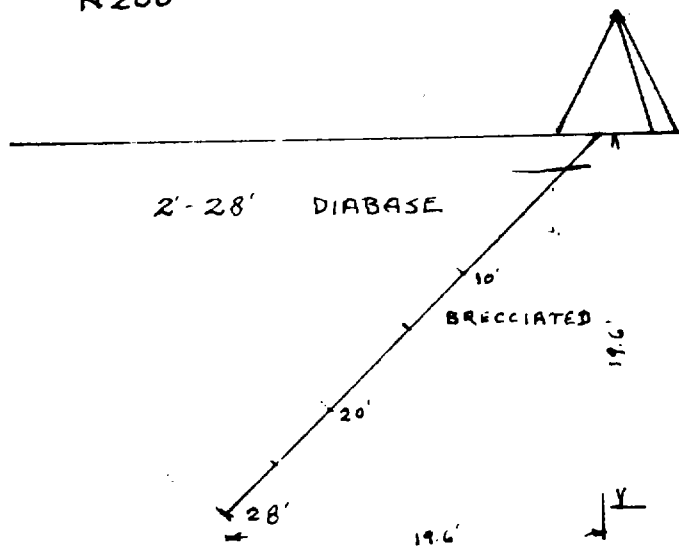

SCALE 1" = 10'

*Douglas Burton*

DEC 20, 1974.  
67-45-74

**Company** W. C. McAllister

# Drill Hole Log

*LORRAINTWP.*

45 - 74 - 1

**Dip Tests**

At 0 Ft. -45°  
 At \_\_\_\_\_ Ft. \_\_\_\_\_  
 At \_\_\_\_\_ Ft. \_\_\_\_\_  
 At \_\_\_\_\_ Ft. \_\_\_\_\_  
 At \_\_\_\_\_ Ft. \_\_\_\_\_  
 At \_\_\_\_\_ Ft. \_\_\_\_\_

Property BIG FISSURE Claim 398702  
 At E332 N200 from 3-398702  
 Claim No. 398702  
 Working Place surface  
 Baseline Footage E332  
 Baseline Offset N200  
 Date Started Nov. 6th, 1974  
 Date Completed Nov. 10th, 1974

Hole Number \_\_\_\_\_  
 Dip -45°  
 Length 28 feet  
 Bearing 270° (west)  
 Elev. Collar surface  
 Horiz. Trace 19.6  
 Vert. Trace 19.6  
 Date Logged Nov. 17th, 1974

| FROM | TO | DESCRIPTION                              | SAMPLE NUMBER |
|------|----|--|---------------|
|      |    |  |               |
| 0    | 2  | Overburden - clay                        |               |
| 2    | 28 | diabase coarse grain                     |               |
|      |    | 14' some brecciation                     |               |
|      |    | <del>24-28 brecciated some calcite</del> |               |
|      | 28 | END OF HOLE                              |               |
|      |    |  |               |
|      |    |  |               |
|      |    |  |               |
|      |    |  |               |
|      |    |  |               |
|      |    |  |               |
|      |    |  |               |
|      |    |  |               |
|      |    |  |               |
|      |    |  |               |
|      |    |  |               |
|      |    |  |               |
|      |    |  |               |
|      |    |  |               |
|      |    |  |               |
|      |    |  |               |
|      |    |  |               |
|      |    |  |               |
|      |    |  |               |
|      |    |  |               |
|      |    | END OF HOLE                              |               |

Logged by *Langley Burton*

BACKHOE TRENCHES 618 FEET  
AVER. DEPTH 4 FT.  
AVER WIDTH 6 FT

590 CU YDS  
\$475.00 (1974)

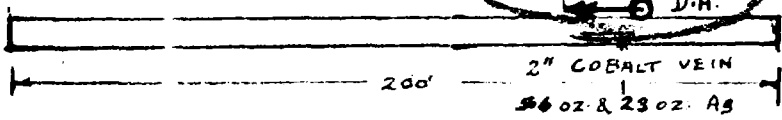
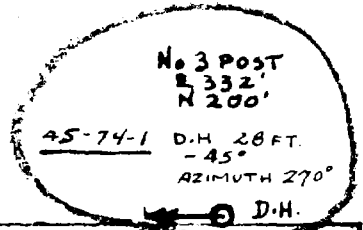

200'  
50'  
320'

3-398702

4-398701

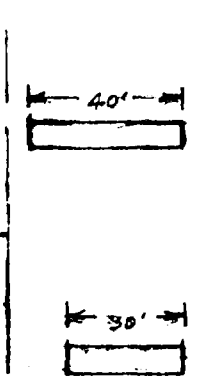
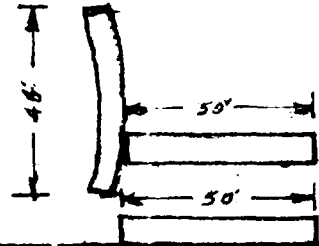

260 FT

320

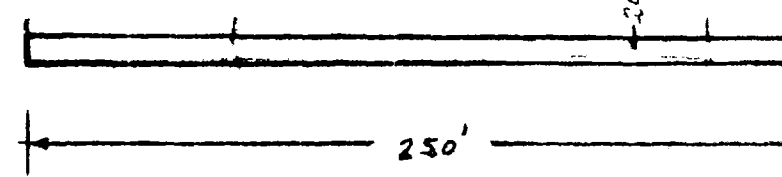

SCALE 1" = 50'  
RATIO 1:600

BIG & LITTLE FISSURE  
LORRAIN TOWNSHIP, ONTARIO  
LOT 3 CONC II W 1/2 OF S 1/2

*Douglas Furston*

NOVEMBER, 1974

67-45-74



|                        |
|------------------------|
| 398702<br>DRILL 7 DAYS |
| 398701                 |

*OK*  
Jan 15, 1975