



31M05NE0148 63.4172 COLEMAN

010

REPORT
ON THE
SILVER CENTURY EXPLORATIONS LTD
GROUP OF PROPERTIES
COBALT ONTARIO

FOR
MINISTRY OF NATURAL RESOURCES
O.M.E.P. ADMINISTRATION
PROGRAM - MARCH 1982 - March 1983

COBALT, ONTARIO
28 NOVEMBER 1983

JAMES E. ARMSTRONG, B.SC. P. ENG

TABLE OF C



31M05NE0148 63.4172 COLEMAN

010C

INTRODUCTION	PAGE 1
SUMMARY	PAGE 1
EXPLORATION PROGRAM OBJECTIVES	PAGE 1
PROGRAM RESULTS	PAGE 1 - 2
PROGRAM DESCRIPTION	PAGE 2 - 3
PROPERTY DESCRIPTION	PAGE 3 - 4
HISTORY	PAGE 5 - 6 - 7
REGIONAL GEOLOGY	PAGE 7
LOCAL GEOLOGY	PAGE 8
UNDERGROUND WORKINGS	PAGE 9
EXPLORATION POTENTIAL	PAGE 9
EXPLORATION APPROACH (1981 - 1982)	PAGE 10
EXPLORATION RESULTS (1981 - 1982)	PAGE 10 - 11

APPENDICES

- APPENDIX "A" - showing Silver Century claim holdings outlined in orange.
- surface geology
 - upper contact workings on Nova Scotia claim
 - lower contact workings on King Edward claim
 - 1090' level, 1500' crosscut outlined in orange
 - surface drill holes P1 and P2 (orange)
 - scale 1" = 400'
- APPENDIX "B" - underground diamond drill holes
- significant diamond drill holes
 - significant calcite veins located
 - general geology established
 - scale 1" = 100'
- APPENDIX "C" - showing exploration development crosscut and drifts at 1090' level in orange.
- rehabilitation of Rix stope area, manways and travel ways.
 - scale 1" = 100'
- APPENDIX "D" - showing exploration program carried out at west end of exploration and development crosscut
- diamond drill program now continuing
 - detailed geology veins and intersections
 - scale 1" = 20'
- APPENDIX "E" - diamond drill hole logs for underground holes S.C. #40 to S.C. #66 surface holes P1 and P2.

INTRODUCTION

The following report contains a description of the exploration program carried out by Silver Century Explorations Ltd on their Cobalt Area properties between March 31 1982 and April 1 1983. The report also includes a general description, geology and history of the properties.

SUMMARY

The program has opened up to exploration, a previously totally unexplored zone in the Cobalt Camp. The occurrence of silver and Cobalt in this zone could not be determined by any other reasonable approach. As to whether or not this zone carries silver in large commercial quantities, will only be determined by future exploration and development. Certainly the assistance of the Ontario Mineral Exploration Program has been of great assistance in this venture.

EXPLORATION PROGRAM OBJECTIVES

1. To drive an exploration crosscut south west from existing workings, in favourable geology, to a point 1200' below the productive upper contact workings and from that point to explore and develop encouraging veins and mineralization encountered in the crosscut and subsequent drilling.

It was geologically conjectured that veins, developed under the western arm of Peterson Lake at the lower diabase contact, could continue on down east to the Nova Scotia claims and that veins under the Nova Scotia and Peterson Lake claims could again be silver productive at or near this lower contact, lying approximately 1200 feet below the old workings.

2. The second portion of the program, basically diamond drilling, was to locate additional veins, determine vein patterns, test established veins at different horizons and establish critical geological contacts and formations

Program Results

- a) Generally the program was very successful in establishing the occurrence of silver and cobalt in this previously inaccessible and unexplored zone (Appendix "B")

Program Results continued

- i) Eleven major veins were encountered in the crosscut.
- ii) Silver and cobalt were encountered in the first diamond drill hole drilled from the crosscut base. Hole #59 intersected 106.7 ounces silver over 0.2 feet and further supplementary drilling has located further values. (Appendix "D")
- iii) As the crosscut was turned west, a narrow cobalt vein was encountered and followed for about 200 feet. This vein carried silver at various points particularly where it encountered cross veins (Appendix "D")
- iv) The supplementary diamond drill program back east at the Rix system, picked up a vein branching north east from the main system. Hole #57 assayed 154.7 ozs silver over 0.5 feet. Slashing and drifting four rounds reached this new zone and silver can be observed spread over the whole drift heading face. There are now three separate drift headings stopped when they were considered in ore.

PROGRAM DESCRIPTION

Following the decision in April by Ontario Hydro, to not re-open their compressed air plant, Silver Century proceeded to purchase and install compressed air capacity of 1600 cfm. The electrical sub-station was increased to 750 HP and a 125 HP hoist motor installed. Auxiliary ventilation fans and duct work were completed to the west heading.

By mid September, the proposed 1500' exploration crosscut drive, south-west to Peterson Lake, got underway. This crosscut was completed in March and a diamond drill station established to explore the favourable ground further west out under Peterson Lake.

In addition to the crosscut drive, considerable rehabilitation of the 1090' level and the Rix stope system was carried out.

While Silver Century was delayed by the lack of compressed air, two exploration holes were drilled from surface in the Peterson Lake area and , although a very strong calcite quartz vein zone was encountered, the silver values were low and further drilling

was deferred in favour of exploring this zone from the underground heading, when it reaches this area.

Development Crosscut

All work was contracted out; the contractor Vinarn Construction supplied all labour, mobile equipment, jack legs, mucking machines, motors, muck cars and powder etc. Silver Century supplied hoisting plant, electrical power compressed air, track, pipe, vent tubing etc. The contractor was paid \$250.00 per foot advance. The 7X6.5' heading was advanced on a two shift basis employing 5 men per shift which covered miners, trammers, hoistmen, deckmen and supervision. 8 foot rounds were mucked out, drilled and blasted per shift.

Diamond Drilling both surface and underground was carried by Barron Diamond Drilling at basically \$8.50 per foot underground and \$12.50 per foot surface.

The following is a summary of the program during the period:

a) Exploration and Development Headings

Crosscutting	1633.5 feet
Drifting	45.0 "
Man days employed	2,122 days

b) Diamond Drilling

Surface	2152.0 feet
Underground	4858 3220.0 "
Man days employed	171 days

PROPERTY DESCRIPTION

The property holdings include the assembly of two major groups of former silver producing properties:

- a) The Peterson Lake and Nova Scotia property group.
- b) The King Edward group of properties.

These two groups are contiguous to each other and are located approximately 1/2 mile south east of the Town of Cobalt in lots 2, 3, 4, 5 and 6 in concessions VI and VII of the Township of Coleman.

The total property holdings embrace approximately 468.4 acres and are surrounded by other former major silver producing mines.

The following are the more specific descriptions of the holdings:

a) PETERSON LAKE AND NOVA SCOTIA GROUP: (257.5 acres) five parcels.

This group covers the Peterson Lake Mine lying below the waters of Cart and Peterson Lake together with the Nova Scotia Mining claim.

Parcel 15217 SST - being the land covered by water and islands of Peterson and Cart Lakes, also designated as Mining Location SV 476, containing approximately 195 acres.

Parcel 15216 SST - being a strip of land 33 feet wide adjacent to the water's edge of Peterson and Cart Lakes, containing approximately 18.5 acres.

Parcel 2714 NND - being the SW part of the N half of lot 3, Cqn. 5, known locally as the Nova Scotia, containing approximately 29 acres.

Parcel 5301 SST - a roughly triangular tract lying between Peterson Lake on the west and the western boundary of the Nova Scotia, together with the southern extension of that boundary to the east, containing approximately 13.5 acres.

Parcel 5334 SST - being a strip of land 33 feet wide providing continuity between Parcel 15216 SST to the northwest and Parcel 5301 SST to the southeast, containing approximately 1.5 acres.

The properties are almost completely surrounded by Claims RL 404, 405, 406, 407 and 408 presently owned by Agnico-Eagle Mines Limited. These properties were formerly owned by Nipissing Mines Limited, one of the most productive silver mines in the Cobalt area.

b) KING EDWARD GROUP (210.9 acres) five parcels

This group included the former silver producing mines; the Silver Cliff, Victoria, King Edward and Watts.

<u>PARCEL NUMBER</u>	<u>CLAIM NO.</u>	<u>ACREAGE</u>
4199 NND	PT. Bro. Lot 3 Con. 6 Webb claim	28.00
8593	NW Pt. Lot 2 Con. 5 King Edward	40.00
	NE Pt. Lot 3 Con. and	40.00
	NW Pt. Lot 3 Con. 5 Victoria Groups	29.00
1878 NND	PT. of Lot 3 Con. 6 Silver Cliff	22.00
5004 NND	Claim Lot 3 Con. 6 Group C.R.I.	11.90

MINING LEASE

100694	T. 45331 SE Part of N Pt. of broken Lot 3 - in Conc. V, Mining rights only 21 years from July 1, 1965	210.90
--------	--	--------

This group is bounded by other silver producers namely on the north by the Colonial and Violet Mines, on the east by the Cross Lake O'Brien Mines (Deer Horn) and on the south by the Campell Crawford and Farah properties.

Both of these property groups are well serviced by good township roads. The Ontario Hydro 12,000 volt electric and hydraulic compressed air service lines, traverse portions of the properties.

There are no serviceable structures or building remaining on the property groups.

HISTORY

a) PETERSON LAKE GROUP

About 1906, the mining rights, under navigable water, were thrown open to development in Ontario. Peterson Lake Silver and Cobalt Mines Limited, acquired the ground under Cart and Peterson Lake. Peterson leased out this ground in several small packages to a myriad

of different operators. These lessees sank shafts at the former high water mark and carried out much un-coordinated lateral work, all with some degree of success and silver production.

From 1912 to 1917, the Peterson Lake Company operated combined leases under the west part of Peterson Lake and the Gould and Seneca Superior operated the leases under Cart Lake.

From 1923 to 1925, Mining Corporation operated the whole property in a small way.

The Nova Scotia claim was operated from 1906 to 1912. Intermittent leasing was carried out from 1920 to 1954.

Up to the end of 1930, the Peterson Lake and Nova Scotia properties produced a total of about 7.5 million ounces of silver.

In 1935, these two properties were acquired by Trinova Cobalt and Silver Mines Limited and the workings under Cart Lake were leased to Car Pete Lease in 1952. The Cart Lake workings were dewatered and examined without much success.

In 1962, Silvertown Mines Limited leased the Properties from Trinova and carried out explorations and obtained some silver production. In 1969, this operation was suspended. This last work was confined to the west arm of Peterson Lake.

b) KING EDWARD GROUP

Silver was discovered on these claims in 1905 and they were intensively developed from 1907 to 1910 by numerous shallow shafts, adits and stopes within 150 feet of surface. Small mills or concentrators operated on the Silver Cliff and King Edward properties. From this work and some subsequent small leases, 1,205,056 ounces of silver were recovered. This work was all done at the upper diabase contact and the silver occurred mostly in diabase.

In 1916, National Mines deepened a winze to 860 feet below the 140 foot adit level of the King Edward. Lateral exploration was carried out on the 840 foot level, close to the lower diabase contact but this work was apparently unsuccessful.

On 1961, Rix Athabasca Uranium Mines optioned the King Edward Group. They were successful in locating a silver zone about 1,100 feet south west of the winze (shaft).

Rix deepened the winze an additional 250 feet to the 1,090 foot level, drove a crosscut west to the silver zone and developed it.

In 1964, Rix reported recovery of 686,580 ounces of silver for a gross value of \$868,456 (1.27 per ounce). This silver occurrence, so far developed was all in Keewatin rock, just below the lower diabase contact.

In January 1965, Rix dropped the option and removed all their equipment.

The King Edward group is presently owned by Langis Silver and Cobalt Mines Limited and is under lease to Armex Limited.

Recorder Production Summary - King Edward Group - 1,891,636 ozs of silver
- Peterson Lake Group - 7,500,000 ozs of silver

Total Recorder Production - - - - - 9,391,636 oz of silver

REGIONAL GEOLOGY

The cobalt-silver area is underlain by late Precambrian Huronian (Cobalt Series Sediments). These sediments, gently dipping to nearly horizontal, (conglomerates, arkose, greywacke and quartzites) rest upon older rocks consisting of Temiskaming sediments, Algoman or Laurentian granite and gneiss, and Keewatin Lava and tuffs. These are all cut by a quartz diabase sill of Keweenawan age, called Nipissing diabase. The Nipissing diabase is the youngest Precambrian rock of the region with the exception of some post-Keweenawan olivine and quartz diabase dikes.

All the silver-cobalt occurrences in the Temiskaming area, whether economic or otherwise, show a genetic connection either directly or indirectly with Nipissing diabase, even when, as has frequently been the case, this formation is not the host rock of the deposits. Ore occurrences are definitely related to contacts between the diabase and intruded rocks. A second feature of the utmost importance is the pre-existing faults which limit or control ore deposition. Commercial deposits of cobalt and silver mineral are as a rule confined to a zone within 300 feet from the diabase contact and measured at right angles to it.

LOCAL GEOLOGY

The Peterson Lake Group properties are completely overlain by the Nipissing diabase sill. It is with the lower contact of this sill, that the economics of this property must be considered.

Near the west boundary of the property, the lower contact occurs in contact with the rocks of the cobalt series sediments, on surface. This contact continues down eastward at a dip of from 15 to 20 degrees. At a point, yet to be determined but at a point at least 1200 feet east of the west boundary, the cobalt series feathers out and the diabase comes in contact with the underlying Keewatin complex formation.

When the cobalt sediments are present as a lense between the diabase and the basement Keewatin rocks, most of the silver located, occurs in the cobalt sediments. Where the diabase and Keewatin rocks are in direct contact, the silver occurs in both the diabase and Keewatin rocks are in direct contact, the silver occurs in both the diabase and Keewatin rocks.

The basic unexplored portion of the properties, occurs under the east arm of Peterson Lake, the Nova Scotia and the King Edward properties down where the lower diabase contact occurs at an estimated depth of from 500 to 1150 feet below surface.

Small Keewatin remnants occur at the upper diabase contact on the Nova Scotia and King Edward properties.

In regard to the underlying Keewatin formation. It is worthy to note that steeply dipping cherty iron formations are often found to underly the silver bearing veins of the cobalt series and are often the host rocks in the Keewatin occurrences. These cherty formations have a general east-west strike when observed on the Nipissing claims on the west shore of Peterson Lake.

Although the productive veins on the properties have both north south and east west strikes, especially in the Cobalt series, the general trend of the silver zone is east-west and raking down following the lower diabase contact.

UNDERGROUND WORKINGS - Peterson Lake Group

a) As previously mentioned due to the original subdivision of the property, there are a great many shallow shafts, stopes and lateral workings scattered over the west part of the property but which are of no great importance in this appraisal. The main workings to be considered are those extending from No. 2 shaft Peterson Lake.

No. 8 shaft is situated on the middle of the west shore of Peterson Lake. This shaft and winze extends down to the 300' level. From the 200' level an incline (decline) shaft extends down to the 300' level horizon.

The deepening of this decline was the last work carried out by Silvertown Mines in 1969 and although this was a reasonable planned approach, the last part of the decline (22) reportedly dug deeply into the underlying Keewatin and there were no further funds available to continue.

b) King Edward Group

The main adit on the King Edward group, was driven into the cliff face about 140 feet below the top of the hill.

There are many small shaft, stopes and other workings above this adit level but they have been repeatedly explored and are of no immediate relevance to this report.

From the main adit #1 winze (Main shaft), extends 1130 feet with main levels at 840' and 1090 foot horizons below the adit. Crosscuts each of about 1100 feet, extend south west to the "Rix" vein system, on both levels, The Rix veins system has been developed by a series of interconnecting raises and stopes.

EXPLORATION POTENTIAL

Generally speaking, all of the potential silver bearing zones under Cart Lake and two thirds of the zone lying under the west arm or lobe of Peterson Lake, have been explored and developed as have the upper contact zones of the Nova Scotia and King Edward properties.

There is unquestionably some low grade, wall rock silver that

could be mined at present silver prices but for the most part, the rich heart of these zones has been removed.

There still remains a large unexplored potential for the occurrence of silver and cobalt at the lower diabase contact starting at a point adjacent to the east shore of the west lobe of Peterson Lake, the Nova Scotia claim and the King Edward Group of claims.

The locus of this potential zone varies from 350 feet below surface in the west to about 1200 feet below surface on the King Edward claim.

EXPLORATION APPROACH (1981 - 1982)

The basic approach to explore these properties has been to rehabilitate equip and dewater the King Edward shaft workings and to carry a program of exploration from these workings down near the lower diabase contact.

The rehabilitation program has consisted of installing a 200 K.W. power service line, substation and electric service right into the headframe, and electric hoisting and pumping plants installed. The shaft has been dewatered and repaired down to the bottom or 1090 foot level and permanent pumping stations established. A limited change house for a crew of up to 20 men was also completed.

Diamond drill exploration got under way on March 10 1981 with two initial objectives in mind:

a) To probe the Rix vein structure, with relatively short holes, for possible silver ore extensions on this structure.

b) To explore the zone to the west principally under the Nova Scotia and Peterson Lake for new veins and more accurately define the position of the critical geological contact on these properties.

EXPLORATION RESULTS (1981 - 1982)

As of January 15 1982, 45 diamond drill holes had been completed for a total drilled footage of 10,831 feet.

Two long relatively flat holes were drilled to the south west N. 30 for 1511.0 feet and N. 34 for 1290.0 feet. Hole N. 30 intersected calcite veins at footages 240, 270, 348, 818 and 950. No visible silver was observed at this geological horizon. Hole N. 30 entered the overlying diabase at 550 feet and remained in diabase to the end of the hole.

The balance of 42 holes were directed at the Rix vein structure and veins adjacent to or parallel to this structure. Silver values were encountered in 22 of these holes.

The results from this drilling outlined two main silver zones. Zone A lies between the north and south stoping on the Rix structure. Zone B lies offset to the north east and separate from the Rix Structure. Veins in this B zone strike north and north east.

In order to provide an evaluation as to grade and tonnage of these silver zones, a program of underground exploration and development, will still be necessary.

Yours truly,

COBALT, ONTARIO
28 November 1983

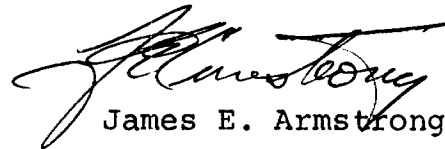

James E. Armstrong, B.Sc P.Eng
Consulting Mining Engineer

DIAMOND DRILL RECORD

SILVER CENTURY EXPLORATIONS LTD.

PROPERTY _____

HOLE NO. J.C. 40

SHELT NUMBER I

SECTION FROM _____ TO _____

STARTED AUG. 9 - 1982

LATITUDE N. 8243.0

DATUM _____

COMPLETED AUG. 16 - 1982

DEPARTURE E. 10 750.0

BEARING 180°

ULTIMATE DEPTH 179.0'

ELEVATION 1290' LEVEL

DIP +40°

PROPOSED DEPTH 200.0'

DEPTH FEET	GEOLOGY	FROM	TO	ECONOMIC	SAMPLE NO.	WIDTH OF SAMPLE	Ag. GRS	SLUDGE GOLD Ag.			
0 - 179.0	KREEVATIN LAVA	7.0	241.0	1/2" - 2" CAL. 11% CORN. - CHALCO PBS - PYR. MINS.							
0-44	ANDESITE	9.9	10.1	90% CAL. CHALCO; PBS, PYR	6	0.2'	5.89	HOR. DIST.	VERT. DIST		
44.0-44.3	HEAVY SULPHIDES - 70% Zn PYR.	124.0	124.4	WALL ROCK, HEAVY SHEARINGS, 60° STREAKS CAL, CHALCO, CO. CRYSTALS	7	0.4'	4.02	94.98	79.70		
44.3-55	ANDESITE	124.4	124.75	MASSIVE CO. VEIN, 60° CHALCO, NO CAL	8	0.35'	26.80				
55-67	BRECCIA	124.75	125.0	WALL ROCK, SHEARINGS, 60° CO CRYSTALS	9	0.25'	5.29	15.75	9.5-14		
67-123	LAVAS							12.3	1.0		
123-179	BRECCIA	129.2	129.5	SHEARED WALL ROCK, CHALCO SPALLS, SOME CAL - 60°	10	0.3'	1.28				
129.5	SHORT SECTION										
129.5-129.7	LAVA - SHORT	129.5	129.7	3" WHITE CAL, 50° CO. PBS. SPY	11	0.2'	2.44				
129.7-130.0	SHEARED SECTIONS	129.7	130.0	WALL ROCK, SCATTERED CO. CRYSTALS	12	0.3'	1.23				
138.0-138.6		138.0	138.6	INTERFLOW SULPHIDE BANDS 20° - PYR. - ZN.							
154.3-154.5		154.3	154.5	2" GREY MOTTLED CAL. ZN, CHALCO, PYR.	13	0.2'	0.30				
HOR. DISTANCE -		137.12'									
VERT. DISTANCE -		115.05'									
				END OF HOLE. 179.0'							

DIAMOND DRILL RECORD

SILVER CENTURY EXPLORATIONS LTD.

PROPERTY _____

HOLE NO. 5.C.41

SHEET NUMBER I

SECTION FROM _____ TO _____

STARTED Aug. 16 - 1982

LATITUDE N. 3243.0

DATUM _____

COMPLETED Aug. 19 - 1982

DEPARTURE E. 10,750.0

BEARING 130°

ULTIMATE DEPTH 172.0

ELEVATION 1090' LEVEL

DIP +23°

PROPOSED DEPTH 160.0

DEPTH FEET	GEOLOGY	From	To	Economic.	SAMPLE NO.	WIDTH OF SAMPLE	% Gold	SLUDGE GOLD		
0.0 - 172.0	KEEWATIN LAJAS HD BRECCIA.	21.9	22.1	1/2" WHITE CHAL. 45°						
	SCATTERED PIROPHOTITE AND CHALCO. MINERALIZATION	125.8	125.9	3/4" WHITE CHAL. 60° CHALCO. PARR.	14	0.1	2.68	115.79	49.15	HOR VERT
		126.6	-	1/2" MASSIVE PARR. 60° - 51. CHALCO						
				END OF HOLE. 172.0'						
				HORIZONTAL DISTANCE						158.32'
				VERTICAL DISTANCE						67.20'

TEM. PTG. CO. LTD. NEW LISKEARD

DRILLED BY Bryan Diamond Drilling

SIGNED [Signature]

DIAMOND DRILL RECORD

SILVER CENTURY EXPLORATIONS LTD.

PROPERTY _____

HOLE NO. S.C. 42

SHEET NUMBER I

SECTION FROM _____ TO _____

STARTED Aug. 19 1982

LATITUDE N. 3243.0

DATUM _____

COMPLETED Aug. 24 1982

DEPARTURE E. 10750.0

BEARING 205°

ULTIMATE DEPTH 144.0'

ELEVATION 1090' Level (2-05 DR)

DIP +40°

PROPOSED DEPTH 160.0'

DEPTH FEET	GEOLOGY	FROM	TO	ECONOMIC	SAMPLE NO.	WIDTH OF SAMPLE	GOLD \$	SLUDGE GOLD \$	
0.0 - 144.0	KABWATIN								
	lava and breccia	37.4	37.6	1/4" CAL (30°) Zn, Pb					
		52.4	53.9	1/2" WHITE CAL (10° to 11°) Zn, Pb					
		111.5	111.7	BROWN ALTERATION STREAKS AND CRYSTALS. Co. white rock	16	0.2'	0.74		
		* 111.7	111.8	1" WHITE CAL (60°) CHALCO	17	0.1'	0.26		
		111.8	112.0	BROWN ALTERATION, Zn, Pb Co. (60°) white rock	18	0.2'	0.24		
		117.2	117.6	SULPHIDES, CHALCO, Pb PYRR, Zn (50°)	115	0.4'	18.72		
				END OF HOLE - 144.0'					

HORIZ. DISTANCE - + 110.3'
VERT. DISTANCE - + 92.56'

TEM. PYG. CO. LTD. NEW LISKEARD

DRILLED BY Barron Diamond Drilling

SIGNED [Signature]

DIAMOND DRILL RECORD
SILVER CENTURY EXPLORATIONS LTD.

PROPERTY _____

HOLE NO. J.C.43

SHEET NUMBER 1

SECTION FROM _____ TO _____

STARTED AUG. 24 - 1982

LATITUDE N. 8264.0

DATUM _____

COMPLETED AUG. 27 - 1982

DEPARTURE E. 10 690.0

BEARING 205°

ULTIMATE DEPTH 131.0 FT.

ELEVATION 1090' LEVEL (2-05 X.C.)

DIP +45°

PROPOSED DEPTH 140.0 FT.

DEPTH FEET	GEOLOGY	FROM	TO	ECONOMIC	SAMPLE NO.	WIDTH OF SAMPLE	AG. COL. S.	SLUDGE COL. S.	AG.		
0.0 - 46.0	KEEWATIN										
	LAVAS AND BRECCIAS.	112.8	113.4	BANDDED PYRRHOTITE 6°							
	SOME SCATTERED PYRRHOTITE.	117.7	117.8	MASSIVE PYRRHOTITE. CARICO-FLAKE AG.	19	0.1	11-18	83.08	83.08	HOR. VERT.	
96.0 - 113.5	DARK VOLCANICS SOME RHYOLITE										
113.5 - 131.0	GREEN KEEWATIN										
				END OF HOLE. 131.0 FT.							
HORIZONTAL DISTANCE - 92.63 FT.											
VERTICAL DISTANCE - 92.63 FT.											

TEM. PTG. CO. LTD., NEW LISKEARD

DRILLED BY BARRON DIAMOND DRILLING. SIGNED [Signature]

DIAMOND DRILL RECORD

SILVER CENTURY EXPLORATIONS LTD.

21044

PROPERTY _____

HOLE NO. S.C. 44

SHEET NUMBER 1

SECTION FROM _____ TO _____

STARTED SEPT. 1 - 1982

LATITUDE N. 8264.0

DATUM _____

COMPLETED SEPT. 9 - 1982

DEPARTURE E. 10690.0

BEARING 275°

ULTIMATE DEPTH 231.0'

ELEVATION 1090' LEVEL (205 X C)

DIP +45°

PROPOSED DEPTH 200.0'

DEPTH FEET	GEOLOGY	FROM	TO	ECONOMIC	SAMPLE NO.	WIDTH OF SAMPLE	GOLD'S	SLUDGE	GOLD'S	SLUDGE
0.0 - 231.0	KEEWATIN	18.0	19.0	SPLASHES QTZ-CAL.						
	BRECCIA			CHALCO, PYRROTE.						
	AND LAVAS	25.0	-	CONSIDERABLE CHALCO.						
	SCATTERED	76.4	76.6	ZN-CHALCO.						
	CHALCO AND	93.0	93.4	1/2" CAL. 60° HEAVY						
	PYRROTE			CHALCO, ZN, PYRITE.						
	IN BLIEBS	98.4	98.4	MASSIVE AND DISS.						
	AND SEAMS			PYR. CHALCO, IRREGULAR						
		114	-	COB OF PYR.						
		133	-	2" CHALCO, SHEARING 30°						
		136.8	-	2" " " 40°						
		139	-	2" " " 50°						
		* 162.7	163.1	MASSIVE ZN, Pb, CAL.	20	0.2'	1.174			
				10° to 60° BROWN ALTERATION						
		205.8	206.9	ORANGE ALTERATION						
				ZONE, PYR., PYR. CHALCO.						
				ORANGE FELDSPAR.						
	HORIZONTAL DISTANCE - 163.34									
	VERTICAL DISTANCE - 163.34									
				END OF HOLE	231.0'					

DIAMOND DRILL RECORD

SILVER CENTURY EXPLORATIONS LTD.

PROPERTY _____

HOLE NO. J.C. 45

SHEET NUMBER I

SECTION FROM _____ TO _____

STARTED SEPT. 9 - 1982

LATITUDE N. 8268.0

DATUM _____

COMPLETED SEPT. 17 - 1982

DEPARTURE E. 10690.0

BEARING 250°

ULTIMATE DEPTH 200.0 FT.

ELEVATION 1090' LEVEL (205XC)

DIP +45°

PROPOSED DEPTH 200.0 FT.

DEPTH FEET	GEOLOGY	FROM	TO	ECONOMIC	SAMPLE NO.	WIDTH OF SAMPLE	GOLD %	SLUDGE		
0.0 - 95.0	KEEWATIN * BRECCIA WITH SCATTERED SULPHIDES PIRR-PR.	67.9	68.2	1" HARD WHITE CAL. 60° CHARCO. PIRR. BRECCIA ALTERATION IN WALL.			116	75		
		106.0	-	1/2" HARD WHITE CAL. CHARCO-ZN - 70°					HOR	VERT
		106.7	106.9	HEAVY SULPHIDES - PIRR.						
95.0 - 200.0	KEEWATIN * LAVAS	157.2	157.3	MASSIVE SULPHIDES - CHARCO Pb, Zn, SOME CAL. 60°	21	0.1'	5.74	111.15	111.15	
		* 158.7	159.4	1" WHITE CAL. 20° 1/2 AG.	22	0.7'	1.02	112.43	112.43	
	166.2 - 200.0 K. LAVAS CALORITE THREADS, BANDING; INTERLACED	173.3	173.5	CHARCO - CO. BEIGE WALL ROCK ALTERATION. 1/2" ROSE COLORED CAL. 50° CHARCO - PIR.						
		* 181.0	181.1	1" WHITE CAL. 60° FINE MMS.	23	0.1'	1.91	112.95	112.95	
HORIZONTAL DISTANCE - 141.42 FT.										
VERTICAL DISTANCE - 141.42 FT.										
				END OF HOLE.		200.0'				

DIAMOND DRILL RECORD

PROPERTY SILVER CENTURY EXPLORATIONS LTD. HOLE NO. S.C. 46

SHEET NUMBER 1 SECTION FROM _____ TO _____ STARTED SEPT. 18 - 1982
 LATITUDE N. 3197.5 DATUM _____ COMPLETED SEPT. - 24 - 1982
 DEPARTURE E. 10 30.0 BEARING 270° ULTIMATE DEPTH 221.0 FT.
 ELEVATION 1090' LEVEL (206 DR.) DIP +40 PROPOSED DEPTH 220.0 FT.

DEPTH FEET	GEOLOGY	FROM	TO	ECONOMIC	SAMPLE NO.	WIDTH OF SAMPLE	GOLDS AG.	SLUDGE GOLDS		
0.0 - 221.0	KEEWATIN	2.8	2.9	1/2" WHITE CAL. 45° - ZN.						
	LAVA AND BRECCIA	40.0	40.6	SPHERULES CHARLITE, Pb.						
	SCATTERED	69.8	69.9	1/2" GR. CAL. 30° Pb, ZN, CHALCO						
	PYRRHOTITE AND PYRITE	93.6	93.7	VIS. AG. IN WALLROCK	24	0.1'	171.4	71.70		60.16
	MINERALIZATION	93.7	94.1	WHITE CAL. 80° (SILICO)	25	0.4'	25.4			
		94.1	94.4	DARK WALLROCK - CHALCO	26	0.3'	39.4			
		94.4	94.5	3/4" WATERY CAL. 60° CHALCO	27	0.1'	30.9	72.39		60.74
		142.6	142.7	WHITE CAL. 60° - PYRR.						
		144.1	144.2	1/2" GRAY CAL. 50° - ZN, PYR.						
		152.6	152.8	1/2" GRAY CAL. 60° CHALCO, PYRR						
				RANGE WARRANOCA ALTERATION						
		156.0	156.15	1" GRAY & PINK CAL. 20° CHALCO						
		158.6	-	1/2" GRAY CAL. STR. 50° Pb.						
		160.6	160.7	1/2" IRR. WHITE CAL. 50°						
HORIZONTAL DIST.	169.39	178.3	178.45	3/4" WHITE AND PINK CAL.	28	0.15'	24.03	136.58		114.60
VERTICAL DIST.	142.05			50° CO. AG. CHALCO						
		208.4	208.5	1" DARK CAL. 80° - CHALCO	29	0.1'	0.48			
		210.2	210.3	3/4" MESSINE CO. 50° ST. CAL.	30	0.1'	6.08	161.02		135.11
				END OF HOLE.						
										221.0

Silver Century Explorations Ltd.

[Signature]

DIAMOND DRILL RECORD

SILVER CENTURY EXPLORATIONS LTD.

PROPERTY _____

HOLE NO. J.C. 47

SHEET NUMBER 1

SECTION FROM _____ TO _____

STARTED SEPT. 24 - 1982

LATITUDE N. 81° 57' 2"

DATUM _____

COMPLETED SEPT. 28 - 1982

DEPARTURE E. 10 ^{14.0} 3 ~~3.0~~

BEARING 270°

ULTIMATE DEPTH 138.0

ELEVATION 1090 LEVEL (206 DR.)

DIP +25°

PROPOSED DEPTH 130.0

DEPTH FEET	GEOLOGY	FROM	TO	ECONOMIC	SAMPLE NO.	WIDTH OF SAMPLE	GOLDS AG	SLUDGE GOLD \$	GRV	GRV
0.0 - 138.0	KEEWATIN LAVA AND BRECCIA	22.4	22.6	1/4" CH. STR. 30° V. P.C.	31	0.2'	5.44	20.39	9.50	
		27.2	27.6	MASSIVE CHALCO. PYR.	32	0.4	8.98	24.65	11.49	
	SCATTERED MINERALIZATION	79.2	79.7	1" ORANGE AND WHITE CH. 10° - Pb.-CHALCO.	33	0.5'	2.08	71.77	33.47	
		95.4	95.7	HEAVY ZN.						
		100.6	101.6	VEIN PYR. // TO CORE.						
		116.3	116.5	1 1/2" PINK CH. 45° CHALCO, Pb, PYR.	34	0.2'	20.26	115.10	44.15	
		136.8	137.6	BANDED SULPHIDES PYR.-ZN.						
HORIZONTAL DISTANCE - 125.07 FT. VERTICAL DISTANCE - 58.32 FT.										

TEM. PTG. CO. LTD. NEW LISKEARD

DRILLED BY BARRON Diamond Drilling

SIGNED _____

DIAMOND DRILL RECORD

SILVER CENTURY EXPLORATIONS LTD.

(21470)

PROPERTY _____ HOLE NO. 5.C.48

SHEET NUMBER 1 SECTION FROM _____ TO _____ STARTED SEPT. 29 - 1982
 LATITUDE N. 81° 25' DATUM _____ COMPLETED OCT. 5 - 1982
 DEPARTURE E. 108° 55' BEARING 255° ULTIMATE DEPTH 214.0'
 ELEVATION 1090' LEVEL. (206 DR.) DIP +40° PROPOSED DEPTH 200.0'

DEPTH FEET	Geology	FROM	TO	ECONOMIC	SAMPLE NO.	WIDTH OF SAMPLE	GOLD-4 AG	SLUDGE GOLD-8 AG		
0.0 - 214.0	KEBUATIN	48.1	48.3	1/2" PINK CAL-30°-PYRR						
	BRECCIA AND	102.1	102.2	4-5" CAL-CHARCO-PYRR, V.S. NO.	35	0.1'	2.28	78.21	65.62	
	LAVA	118.2	118.4	BEIGE WAILROCK FINE CO.	36	0.2'	0.16	20.54	75.97	
		* 118.4	118.8	4" MASSIVE Co. 60°-SL. CAL.	37	0.4'	1.38	70.69	16.10	
	GROUND CORE	118.8	118.9	WAILROCK, BLACK SLTY	38	0.1'	0.70	91.02	76.36	
	102.1 - 102.2			BANDED - FINE CO.						
		123	-	1/2" WHITE CAL-50°						
		* 138.5	139.1	3" WHITE CAL-30°-PYRR	39	0.6'	4.99	106.07	87.52	
				CHARCO.						
		* 158.0	158.1	1" PINK + WHITE CAL-30°	40	0.1'	5.68	120.83	101.56	
				CHARCO. Pb. PYRR.						
		176.8	177.9	DISS. CO. BEIGE WAILROCK	41	1.1'	1.16	58.45	113.54	
		* 177.9	178.2	1" MASSIVE Co-30° SL. CAL	42	0.3'	2.70	136.27	104.85	
				CHARCO						
		178.2	178.6	DISS. CO. BEIGE WAILROCK	43	0.4'	0.41	36.53	114.54	
	HORIZONTAL DISTANCE -	163.93								
	VERTICAL DISTANCE -	137.05								
		END OF HOLE. 214.0'								

DIAMOND DRILL RECORD

SILVER CENTURY EXPLORATIONS LTD.

PROPERTY _____

HOLE NO. J.C. 49

SHEET NUMBER I

SECTION FROM _____ TO _____

STARTED OCT. 5 - 1982

LATITUDE N. 81° 47.5'

DATUM _____

COMPLETED OCT. 13 - 1982

DEPARTURE E. 10° 28.0'

BEARING 240°

ULTIMATE DEPTH 214.0'

ELEVATION 1090' LEVEL (206 DR.)

DIP +40°

PROPOSED DEPTH 210.0'

DEPTH FEET	GEOLOGY	FROM	TO	ECONOMIC	SAMPLE NO.	WIDTH OF SAMPLE	GOLD'S RES.	SLUDGE GOLD'S RES.		
0.0 - 214.0	KEEWATIN	14.6		BANDED PYRITITE						
	LAUAS AND			75°						
	PERECIUS.	26.35	26.55	IRREG. CAL. WHITE, SOME GRIND.						
		57.6	57.75	BANDED SULPHIDES 50°						
		* 64.1	-	1/2" CHALCO-PINK, 45° N.E. N.E.					41.20	
		64.25	68.0	PURR. DISSMINATED AND						
				FERROS. FERATIC						
		122.5	122.6	1/7" WHITE CAL. 80°, CO. CRYSTALS						
				CHALCO-ZN.						
		122.6	123.3	DISS, BANDED SULPHIDES						
		128.8	129.3	MASSIVE PYR.						
		* 167.0	167.2	1/4" CAL & CO. - 40°				127.92	147.34	
		167.2	168.2	WHITE. CRA. STRS. VARIOUS						
				ANGLES - CO. CRYSTALS						
		168.3	168.7	1 1/2" HARD PINK CAL. 30°				129.33	108.83	
				SL. PYR.						
HORIZONTAL DISTANCE - 163.93										
VERTICAL DISTANCE - 137.55										
END OF HOLE. 214.0										

DIAMOND DRILL RECORD

PROPERTY SILVER CENTURY EXPLORATIONS LTD. HOLE NO. 5.0 50

SHEET NUMBER I SECTION FROM _____ TO _____ STARTED Oct. 13 - 1982
 LATITUDE N. 3197.5' DATUM _____ COMPLETED Oct. 18 - 1982
 DEPARTURE E. 10828.0 BEARING 180° ULTIMATE DEPTH 151.0'
 ELEVATION 1096. LEVEL (206XC07) DIP 74.5° PROPOSED DEPTH 120.0'

DEPTH FEET	LITHOLOGY	FROM	TO	ECONOMIC	SAMPLE NO.	WIDTH OF SAMPLE	GOLD GRAMS	SLUDGE GAMS		
0.0 - 131.0	HEAVY LAVA 5' BRECCIA	26.4	26	5" WHITE CAL. CHARCO.						
		36.0	36.2	BAND OF SULPHIDES						
	SCATTERED PYRROPHITIC AND PYRITE	56.5	56.7	1" CAL. 30° MASSIVE						
	MINERALIZATION	148.0	149.1	BANDED QUARTZ. 30° BEIGE	117	1.1'	1.09	104.65	104.65	
				ALTERATION IN WALLROCK. DISS. CO. PYR. CHARCO				70	70	
								105.42	105.42	
HORIZONTAL DISTANCE - 106.77'										
VERTICAL DISTANCE - 106.77'										
				END OF HOLE. 151.0'						

DRILLED BY Brown Diamond Drilling

[Signature]

J.C. 51

DIAMOND DRILL RECORD

SILVER CENTURY EXPLORATIONS LTD.

PROPERTY _____

HOLE NO. S.C. 51

SHEET NUMBER 1

SECTION FROM _____ TO _____

STARTED OCT. 20 - 1982

LATITUDE N. 8070.0

DATUM _____

COMPLETED OCT. 22 - 1982

DEPARTURE E. 10879.0

BEARING 051°

ULTIMATE DEPTH 115.0

ELEVATION 1070' LEVEL (207 X 07)

DIP +45°

PROPOSED DEPTH 100.0

DEPTH FEET	GEOLOGY	FROM	TO	ECONOMIC	SAMPLE NO.	WIDTH OF SAMPLE	COGS AC.	SLUDGE COLDS		
0.0 - 115.0	KEEWATIN LAVA AND BRECCIA.	10.6	-	2" MOTTLED CAL. IRREGULAR; SPHERULIN						
		23.2	23.4	MOTTLED PINK CAL. 80° QZ. CHALCO. SP.						
		60.8	61.0	1/4" CAL. 80° BEIGE WALL ROCK						
		73.7	73.9	BRAD. OF PYROPHOSPHATE 60°					HOR.	VERT.
		83.9	84.2	3/4" PINK CAL. VEIN 25° - CHALCO.	4.8	0.3'	3.96	59.32	59.32	
								76	76	
								59.53	59.53	
HORIZONTAL DISTANCE - 81.31 FEET										
VERTICAL DISTANCE - 81.31 FEET										
				END OF HOLE 115.0						

Ben D. Day *Stu*

DIAMOND DRILL RECORD

PROPERTY SILVER CENTURY EXPLORATIONS LTD.

HOLE NO. J.C. 32

SHEET NUMBER I

SECTION FROM _____ TO _____

STARTED Oct 23 1982

LATITUDE N. 8101.0

DATUM _____

COMPLETED Oct 26 1982

DEPARTURE E. 10832.0

BEARING 107°

ULTIMATE DEPTH 104.0 FT.

ELEVATION 1070' LEVEL (307XCUT)

DIP +40°

PROPOSED DEPTH 100.0 FT.

DEPTH FEET	GEOLOGY	FROM	TO	ECONOMIC	SAMPLE NO.	WIDTH OF SAMPLE	GOLD Pg.	SLUDGE CONTENT Pg.		
0.0 - 104.0	KEEWATIN LAMP AND BRECCIA.	67.7	69.3	QZ-CAL VEIN STRUCTURE 60° PRR						
		69.3	69.5	CHALCO, ZN-PRR 1/2" WHITE CAL, 30°						
		74.1	74.3	3/4" WHITE CAL. CHALCO PRR. 40°						
		104	-	IRREGULAR CAL-SZ. CHALCO, PRR.						
HORIZONTAL DISTANCE - 79.66 FEET										
VERTICAL DISTANCE - 66.84 FEET										
				END OF HOLE	104.0 FT.					

DIAMOND DRILL RECORD

SILVER CENTURY EXPLORATIONS LTD.

PROPERTY _____

HOLE NO. S.C. 53

SHEET NUMBER I

SECTION FROM _____ TO _____

STARTED OCT. 28 1982

LATITUDE N. 85° 86.0

DATUM _____

COMPLETED NOV. 3 1982

DEPARTURE E. 10573.0

BEARING 095°

ULTIMATE DEPTH 205.0 FT.

ELEVATION 1090' LEVEL (204 DR.)

DIP +32°

PROPOSED DEPTH 200.0 FT.

DEPTH FEET	GEOLOGY	FROM	TO	ECONOMIC	SAMPLE NO.	WIDTH OF SAMPLE	GROSS AC.	SLUDGE GOLD STG.			
0.0 - 205.0	KEEWATIN LAVA	8.2	8.4	2 CAL. THREADS PYRR.							
		109.9	110.2	1/2" ORANGE CAL. PYRR. CHALCO; 38°							
		149.0	149.3	MASSIVE PYRR. CHALCO. BAND, 60°				1.2	1.0		
		155.9	156.3	HARD SILICEOUS VEINTA° CO	49	0.4	27.20	12.29	12.64		
	(GENERAL →)	158.4	160.4	DISS. & MASSIVE CO.							
		159.7	159.9	0.2' MASSIVE CO.	50	0.2'	0.83	115.43	11.53		
		159.9	160.3	0.4' WHITE CAL + MASSIVE CO. 70°	51	0.4'	1.64	115.43	11.53		
HORIZONTAL DISTANCE - 173.87 FEET											
VERTICAL DISTANCE - 108.63 FEET				END OF HOLE		205.0 FT.					

DIAMOND DRILL RECORD

PROPERTY

SILVER CENTURY EXPLORATIONS LTD.

HOLE NO. 5.C.54.

SHEET NUMBER I

SECTION FROM _____ TO _____

STARTED Nov. 3 - 1982

LATITUDE N. 85 61.0

DATUM _____

COMPLETED Nov. 8 - 1982.

DEPARTURE E. 10602.0

BEARING 095°

ULTIMATE DEPTH 162.0 FT.

ELEVATION 1090' LEVEL (204 DR.)

DIP +32°

PROPOSED DEPTH 150.0 FT.

DEPTH FEET	GEOLOGY	FROM	TO	ECONOMIC	SAMPLZ NO.	WIDTH OF SAMPLE	GORE	SLUDGE GORE	
0.0 - 3.0	HERNIATIN LAVA	55.6	55.8	1/2" PYROPHITE 60°					
3.0 - 15.0	HERNIATIN ANDRESITE	56.9	57.1	BRKEN CAL. LENSE WALLROCK, PYRITE.					
15.0 - 162.0	HERNIATIN LAVA	58.3							
		135.1	135.3	SPARKLES CARBON. CO. CRYSTALS	52	0.2'	3.89	114.57	71.59
		135.8	136.1	WHITE CAR. VEIN 70° MASSIVE. CO. LENSE WALLROCK.	53	0.3'	2.22	115.16	71.76
HORIZONTAL DISTANCE - 137.38 FT.									
VERTICAL DISTANCE - 25.84 FT.									
				END OF HOLE - 162.0 FT.					

Barry D. Dunning

DIAMOND DRILL RECORD

PROPERTY **SILVER CENTURY EXPLORATIONS LTD.**

HOLE NO. SC 55

SHEET NUMBER T

SECTION FROM _____ TO _____

STARTED Nov. 8 - 1982

LATITUDE N. 85° 29.0

DATUM _____

COMPLETED Nov. 12 - 1982

DEPARTURE E. 10 627.5'

BEARING 100°

ULTIMATE DEPTH 136.0 FT

ELEVATION 1596' LEVEL. (204 DR.)

DIP +40°

PROPOSED DEPTH 100.0 FT

DEPTH FEET	GEOLOGY	FROM	TO	ECONOMIC	SAMPLE NO.	WIDTH OF SAMPLE	GROSS WT. G.	SLUDGE GROSS WT. G.		
0.0 - 136.0	HEMATHIN LAVA & BRECCIA	7.0	7.3	ORANGE-APLITIC CAL. 50° CHALCO, PYR.						
		99.6	100.4	REDDISH WEARROCK. DISS. CO.				None	VENT	
		99.9	100.3	WHITE CAL. VEIN 60° Co. B, CHALCO.	54	0.4'	0.57	76.52	(4.2)	
		101.4	101.7	MASSIVE CHALCO SPLASHES						
		* 102.0	102.3	CHALCO SPLASHES FLECK Bl or R.?	55	0.3'	6.87	72.13	65.1	
		102.6	103.2	MASSIVE CHALCO & PYR.	56	0.7'	10.26	79.59	65.95	
		* 127.2	127.5	3" ORANGE-BROWN CAL VEIN 1" DARK GREY CAL. CHALCO, CO PYR. 60°						
		127.2	127.4	3" ORANGE-BROWN CAL. CO, CHALCO, PYR. 60°	57	0.2'	2.29	97.44	11.76	
		127.4	127.5	1" DARK GREY CAL. CO Co. CHALCO, PYR.	58	0.1'	1.34	97.59	91.87	
HORIZONTAL DISTANCE - 104.18										
VERTICAL DISTANCE - 87.44										
END OF HOLE										
						136.0 FT.				

DIAMOND DRILLING LOG

SILVER CENTURY EXPLORATIONS LTD.

PROPERTY _____

HOLE NO. J.C. 56

SHEET NUMBER I

SECTION FROM _____ TO _____

STARTED Nov. 12 - 1982

LATITUDE N. 8529.0

DATUM _____

COMPLETED Nov. 15 - 1982

DEPARTURE E. 10627.5

BEARING 100°

ULTIMATE DEPTH 124.0 FT.

ELEVATION 1090' LEVEL (204 DR)

DIP 72°

PROPOSED DEPTH 100.0 FT.

DEPTH FEET	GEOLOGY	FROM	TO	ECONOMIC	SAMPLE NO.	WIDTH OF SAMPLE	GEMS	SLUDGE		
<u>0.0 - 075.0</u>							<u>HC.</u>	<u>HC.</u>		
<u>98.0</u>	<u>KEEWATIN BRECCIA</u>	<u>98.7</u>	<u>98.75</u>	<u>1/2" WHITE CAR. VEIN 90° - CARCO. PLS.</u>						
<u>98.0 - 124.0</u>	<u>KEEWATIN ANDRESITE</u>									
<u>HORIZONTAL DISTANCE - 116.52 FEET.</u>										
<u>VERTICAL DISTANCE - 42.41 FEET</u>										
				<u>END OF HOLE 124.0 FT.</u>						

Barry D. ...

DIAMOND DRILL RECORD

SILVER CENTURY EXPLORATIONS LTD.

PROPERTY _____

HOLE NO. J.C. 57

SHEET NUMBER I

SECTION FROM _____ TO _____

STARTED Nov. 16 - 1982

LATITUDE N. 3479.0

DATUM _____

COMPLETED Nov. 18 - 1982

DEPARTURE E. 18661.0

BEARING 090°

ULTIMATE DEPTH 123.0

ELEVATION 1090' LEVEL (204 DR.)

DIP +40°

PROPOSED DEPTH 125.0'

DEPTH FEET	GEOLOGY	FROM	TO	ECONOMIC	SAMPLE NO.	WIDTH OF SAMPLE	GOLD \$	SLUDGE GCS \$	VERT.
0.0 - 71.0	KEEWATIN BRACCA	3.1	3.2	IRREGULAR WHITE CAL. $\frac{3}{4}$ " - PYR. 80°			75	210	
		25.5	27.1	CO. MINERALIZATION					
71.0 - 123.0	KEEWATIN X KARR	25.5	25.7	BEIGE WALK ROCK CO.	62	0.4"	17.61	19.52	16.27
		25.7	26.5	6" WHITE CAL. CO. 60°	63	0.6"	3.69	0	0
		26.5	27.0	BEIGE WALK ROCK CO.	64	0.5"	154.65	20.32	0.33
		105.5	105.85	VEIN ZONE: GR, CO, PYR. CHALCO					
		105.7	105.8	VEIN - GRANGE CAL. 80° CO, PYR, CHALCO	65	0.1"	4.10	90.97	67.94
				END OF HOLE 123.0 FT.					
HORIZONTAL DISTANCE - 94.22 FEET									
VERTICAL DISTANCE - 79.36 FEET									

DIAMOND DRILL RECORD

PROPERTY SILVER CENTURY EXPLORATIONS LTD HOLE NO. 5.C. 28

SHEET NUMBER I SECTION FROM _____ TO _____ STARTED Nov. 19 - 1982
 LATITUDE N. 8479.0 DATUM _____ COMPLETED Nov. 19 - 1982
 DEPARTURE E. 10661.0 BEARING 090° ULTIMATE DEPTH 43.0 FT.
 ELEVATION 1096' level. (204 DR.) DIP FLAT. PROPOSED DEPTH 500 FT.

DEPTH FEET	GEOLOGY	FROM	TO	ECONOMIC	SAMPLE NO.	WIDTH OF SAMPLE	GOLD %	SLUDGE GOLD %		
0.0 - 43.0	KEEWATIN BRECCIA.	22.5	23.3	BANDED SILICEOUS ORANGE CH. MATERIAL						
		23.0	23.3	VEIN, PINK CH. 60° BRECCIATED, CHALCO PYR. CO	66	0.3	1.68			
		28.0		JAPANESE CH. ZN.						
HORIZONTAL DISTANCE - 43.0 FEET										
VERTICAL DISTANCE - 0.0 FEET										
				END OF HOLE		43.0				

DRILLED BY Bureau Diamond Drilling



DIAMOND DRILL RECORD

SILVER CENTURY EXPLORATIONS LTD.

PROPERTY _____

HOLE NO. 5.C.59

SHEET NUMBER I

SECTION FROM _____ TO _____

STARTED FEB. 4 - 1983

LATITUDE N 7250.0

DATUM _____

COMPLETED FEB. 9 - 1983

DEPARTURE E. 10298.0

BEARING 202°

ULTIMATE DEPTH 169.0

ELEVATION 1070 L. 209 X CUT. EL. 797.0'

DIP FLAT

PROPOSED DEPTH 150.0'

DEPTH FEET	GEOLOGY	From	To	ECONOMIC	SAMPLE NO.	WIDTH OF SAMPLE	AG GOLD	SLUDGE GOLD		
0.0 - 59.0	TRAMPROPHYRE	48.65	49.2	WHITE QTZ; PINKISH ZONE, 45° FINE CHALCO						
59.0 - 169	KEEWATIN LAVA AND TUFF.	43.6	49.0	Pbs. (Gold) str.	630	0.4'	1.19			
	(Flows w/ large pillow struct.)	154.3	154.7	WALL ROCK FINE MINS.	68	0.4'	2.81			
		154.7	154.9	Co. Vein; 1/2" AG, 45° WR alt to lighter grey	69	0.2'	106.70			
		154.9	155.4	WALL ROCK CHALCO Co. CH.	70	0.5'	35.76			
		155.35	-	1/4" CHAL. STR. 80° +K po. exp.						
END OF HOLE - 169.0'										

DIAMOND DRILL RECORD

SILVER CENTURY EXPLORATIONS LTD.

210.60

PROPERTY _____

HOLE NO. 5. C 60

SHEET NUMBER _____

SECTION FROM _____ TO _____

STARTED FEB. 9 - 1983

LATITUDE N. 7250.6

DATUM _____

COMPLETED FEB. 11 - 1983

DEPARTURE E. 11298.6

BEARING 199°

ULTIMATE DEPTH 244.0

ELEVATION 1096.1 - 209 ACUT
EL. 1970

DIP FLAT

PROPOSED DEPTH 175.0

DEPTH FEET	Geology	FROM	TO	ECONOMIC	SAMPLE NO.	WIDTH OF SAMPLE	GOLD - g	SLUDGE GOLD - g		
0.0 - 32.3 (60.5)	LAMPROPHYRE.	33.4	-	IRREG. BLEN. QTZ.						
	→	32.3	32.6	3" WHITE CAL. JAME CHALCO 15° 3"	131	0.5	1.56			
32.0 - 244.0	KERUATIN	60.6		IRREG. SILICEOUS FINKISH.						
	LAVA & TUFF	72.6	72.9	1" QTZ. CAL. PYR. BRUCE	132	0.3	1.66			
	SOME BRECCIA			MATERIAL - 30° -						
	SECTIONS.	156.1	}	2 - 1/2" SILICEOUS 60°						
		156.5								
		157.1		3/4" QTZ. REDDISH MATERIAL						
				IRREG.						
		157.2	157.65	1 1/2" 2" CAL. 60° CHALCO	75	0.15'	7.84			
		232.3	232.4	1" PYR. SEMI. 90°						
				END OF HOLE - 244.0'						
	STOPPED HOLE AT 182.0' FEB. 11 - EXTENDED TO 244.0' MAR. 14 & 15									

[Handwritten Signature]

DIAMOND DRILL RECORD

SILVER CENTURY EXPLORATIONS LTD.

(3-4-01)

PROPERTY _____

HOLE NO. J.C. 61

SHEET NUMBER 1

SECTION FROM _____ TO _____

STARTED FEB. 11 - 83

LATITUDE N. 7250.0

DATUM _____

COMPLETED FEB. 18 - 83

DEPARTURE E. 10298.0

BEARING 202°

ULTIMATE DEPTH 251.0

ELEVATION 1090 h. - 209 X CUT
EL. 797.0'

DIP +35°

PROPOSED DEPTH 250.0

DEPTH FEET	GEOLOGY	FROM	TO	ECONOMIC	SAMPLE NO.	WIDTH OF SAMPLE	GOLD-AG.	SLUDGE GOLD-AG.	
0.0 - 32.3	LIMPHOPHYRE.								VERT
		87.2	87.5	2" GREY CAL. 30° SL. CHANCO	80	0.3'	0.25		
32.3 - 140.2	KEEWATIN								
	KAUA TUFF *	88.0	-	1/2" CAL. 30° - V. AG. CHANCO	81	0.1'	14.96	72.08	50.47
		92.3	92.5	1 1/2" - 2" CAL. AND HARD BINK.	83	0.2'	1.80		
140.2 - 251.0	N. PISSING			FERRUGINOUS? SL. ZN. PIR. CHANCO					
	DIABASE			45°					
	FINE TO MEDIUM	93.2	-	1/4" CAL. SL. PIR. 45°					
977.0 SL	GRAINED	95.7	96.0	MOTTLED CAL. 25° ZN.					
		109.5	110.5	FERRATIC CAL. & BROWN MATERIAL - FLINT					
		111.5	111.6	CAL. CHANCO. PIR. PIR.	82	0.1'	0.50		
				ZN-MORE CAL. AT BOTTOM					
HORIZONTAL DISTANCE - 205.6'									
VERTICAL DISTANCE - 143.96'		117.9	-	1/2" FERRATIC CAL. SL. CHANCO					
		132.3	-	1/2" CAL. 50° FINE PIR. CHANCO.					
		198.0	-	1/4" WHITE CAL. PIR. 10°					
				END OF HOLE.					
				251.0'					

Brian David Dallas

DIAMOND DRILL RECORD

SILVER CENTURY EXPLORATIONS LTD.

PROPERTY _____

HOLE NO. J.C. 62

SHEET NUMBER I

SECTION FROM _____ TO _____

STARTED FEB. 22 - 83

LATITUDE N. 7250.0

DATUM _____

COMPLETED MAR. 3 - 83

DEPARTURE E. 10298.0

BEARING 219°

ULTIMATE DEPTH 412.0'

ELEVATION 1440' h. 209xcut Ek. 777.0

DIP FLAT.

PROPOSED DEPTH 400.0'

DEPTH FEET	GEOLOGY	From	To	ECONOMIC.	SAMPLE NO.	WIDTH OF SAMPLE	GRASS	SLUDGE		
0.0 - 56.5	LAMPROPHYRE	119.2	119.8	HIGHLY ALTERED, BRECCIATED SL. PYR. SL. CO.			16.0	136		
56.5 - 112.0	HEAVY TUFF	120.9	121.3	1/2" CAL. CO. AG ON SLIP 35°	91	0.4'	12.51			
		121.3	121.8	WALL ROCK - SINCEROUS CO. AG ON SLIPS, 60° - SL. SPY.	92	0.5'	30.77			
		121.8	122.8	WALL ROCK - VS. AG ON SLIPS	93	1.0'	16.64			
		122.8	123.8	" " VS. AG " "	94	1.0'	76.96			
		123.8	124.5	" " VS. AG " "	95	0.7'	71.62			
		124.5	124.7	1/2" DARK GREY - HARD SL. CAL. PYR. CO. SPY. 45°	88	0.2'	128.73			
		124.7	125.1	DISS. CO. FINE CAL. SL. SPY. FRESH AG.	89	0.4'	83.64			
		126.25	126.55	FRAGS - CO.						
		137.5	-	1/4" ERRATIC CAL.						
		142.7	-	1/2" YELLOW & WHITE CAL. 90° SL. SPY - PYR.						
		163.0	-	1/2" CAL - PYR, SPY. 90°						
		166.0	166.4	HIGHLY ALTERED;						
		168.2		1/2" WHITE CAL. & SEVERAL STRS. SL. PYR. THEN 3" BRICE MATERIAL						

125.97010
 1.2

Barry Diamond Drilling

DIAMOND DRILL RECORD

SILVER CENTURY EXPLORATIONS LTD.

PROPERTY _____

HOLE NO. S.C. 62

SHEET NUMBER I

SECTION FROM _____ TO _____

STARTED FEB. 22 - 83

LATITUDE N. 725° 0.0

DATUM _____

COMPLETED MAR. 3 - - 83

DEPARTURE SE. 10298.0

BEARING 219°

ULTIMATE DEPTH 412.0

ELEVATION 1090' h. 209 X CUT.
EL-797'

DIP FLAT

PROPOSED DEPTH 400.0'

DEPTH FEET	Geology	From	To	ECONOMIC	SAMPLE NO.	WIDTH OF SAMPLE	GRMS G.A.	SLUDGE GOLD'S TONS
		188.4	189.6	1" WHITE CAL. 45° A				
		188.4	189.2	FR. FLECKS. SPY.		0.3		
		188.8	-	2" WHITE CAL. 20° SL. SPY. Pbs				
				4" PINK SILICEOUS FALLOWS				
		225.7	-	EGGATIC CAL; PIR. PIR.				
		234.5	235.5	HIGHLY ALTERED; PLANTIC CAL. 1"; BLACK PY. SPY.				
				SL. Pbs. SEMI-4 BLACK PIR. (234)				
		256.4	256.6	2" HARD WHITE CAL. 85° SL. Pbs, PIR. CHALCO ON BOT SIDES	90	0.2'	0.81	
		266.8	266.9	1" DARK GREEN MATERIAL SL. CAL. 80° - CHALCO 24, PIR.				
		288.6	-	HAIPLINE CAL. 90°				
		290.4	-	1" CAL. 80°				
		313.5	313.65	ALTERED, 70° SL. PIR.				
		330.4	330.6	2" HIGHLY ALTERED, SL. CAL. 24, PIR. - SPY SEMI 80°				
		X 338.2	338.5	2" HARD PINK SILICEOUS 1" CAL IN CENTER 60° SPY - Co.	96	0.3'	13.73	

DIAMOND DRILL RECORD

PROPERTY **SILVER CENTURY EXPLORATIONS LTD.**

HOLE NO. 5.C.62

SHEET NUMBER III

SECTION FROM _____ TO _____

STARTED FEB. 22 - 85

LATITUDE N. 725.0.0

DATUM _____

COMPLETED MAR. 3 - 85

DEPARTURE E. 10298.0

BEARING 219°

ULTIMATE DEPTH 412.0

ELEVATION 1490' L. 209 X.COT.

DIP FLAT

PROPOSED DEPTH 400.0

DEPTH FEET	GEOLOGY	FROM	TO	ECONOMIC	SAMPLE NO.	WIDTH OF SAMPLE	GOLD G	SLUDGE G
		313.6	343.8	3/4" - 1" REDDISH HARD FERTILE SOIL 45° - CHALCO - P.L.			AC	AC
	385.4 - 386.0			HIGHLY ALTERED LIGHT COLORED.				
	394.5 - 399.0			HIGHLY ALTERED.				
				END OF HOLE	412.0 FT.			

Brandy D. ...

DIAMOND DRILL RECORD

SILVER CENTURY EXPLOSIONS LTD.

21103

SUCALL 70.3.0.58

PROPERTY _____

HOLE NO. 5.2.63

SHEET NUMBER I

SECTION FROM _____ TO _____

STARTED MARCH 5 - 83

LATITUDE N. 84 27.5

DATUM _____

COMPLETED MARCH 7 83

DEPARTURE E. 10 684.0

BEARING ~~090~~ 090°

ULTIMATE DEPTH 140.0'

ELEVATION 1090.1. SLASH. IN 204 DR.

DIP FLAT

PROPOSED DEPTH 120.0'

DEPTH FEET	GEOLOGY	FROM	TO	ECONOMIC.	SAMPLE NO.	WIDTH OF SAMPLE	GOLD %	SLUDGE %		
0.0 - 140.0	KREWATIN LAVA & TUFF TO 65.0 FT.	10.6	10.8	ERRATIC PYRR. FAIRLY MASSIVE						
		13.0	13.5	ALMOST MASSIVE PYRR.						
65.0 - 140.0	FINE TO MEDIUM CRINED BASIC INTRUSIVE.	58.6	58.7	SL. CHALCO. 1" TO 1 1/2" SILICEOUS MATERIAL, 60° SL PYRR CHALCO.						
		73.1	73.2	1" DARK. CAL. 35° CHALCO, ZN, PYRR, PbS.						
		89.1		1/2" HARD YELLOWISH CAL. 10% ZN, PYRR.						
				END OF HOLE 140.0'						

Handwritten signatures and initials

DIAMOND DRILL RECORD

SILVER CENTURY EXPLORATIONS LTD.

(S.C. 64)

PROPERTY _____

HOLE NO. S.C. 64

SHEET NUMBER I

SECTION FROM _____ TO _____

STARTED MAR. 9 - 1983

LATITUDE N. 8529.0

DATUM _____

COMPLETED AUG. 11 - 1983

DEPARTURE E. 10627.5

BEARING 100°

ULTIMATE DEPTH 146.0

ELEVATION 1070' ABOVE 204' X CUT

DIP FLAT

PROPOSED DEPTH 170.0 FT.

DEPTH FEET	GEOLOGY	FROM	TO	ECONOMIC	SAMPLE NO.	WIDTH OF SAMPLE	GOLD \$ AG.	SLUDGE GOLDS AG.		
0.0 - 108.0	KREWATIN BRECCIA SCATTERED 1/4" FIND	24.8	25.8	ERRATIC - PINK HARD FELDSPAR 5/8" DIA. CHALCO						
		136.1	137.3	CAL. STYRE BREKS. 136.8-137.2. 97		0.1'	0.66			
108.0 - 146.0	BRAIN INTRUSIVE? WITH SHORT BRECCIATED SECTIONS.			2" WHITE CAL. IN CENTER. 30° - 5/8" ZN PDS CHALCO. FLECKS CO. - AG?						
				END OF HOLE.		146.0 FT.				

DIAMOND DRILL RECORD

SILVER CENTURY EXPLORATIONS LTD.

PROPERTY _____

HOLE NO. 5865

SHEET NUMBER 7

SECTION FROM _____ TO _____

STARTED MARCH 15 - 1983

LATITUDE N. 7250.0

DATUM _____

COMPLETED MARCH 24 - 1983

DEPARTURE E. 10298.0

BEARING 180°

ULTIMATE DEPTH 369.0

ELEVATION 1090' L. 209 KCOT
EL. 797.0'

DIP FLAT

PROPOSED DEPTH 300.0 Plus

DEPTH FEET	GEOLOGY	FROM	TO	ECONOMIC	SAMPLE NO.	WIDTH OF SAMPLE	GOLD \$/T	SLUDGE GOLD \$/T
0.0 - 61.3	LAMPROPHYRE	26.8	-	ERRATIC BLEB - CAL				
		68.0	69.3	REDDISH ERRATIC				
61.3 - 369.0	KEOWATIN			SECTION - FEASIBLE!				
	LAVA TUFF	70.9	-	3/4" ERRATIC CAL. WHITE.				
		82.4	83.0	1" HARD PINK SILICEOUS				
				30° SOME CAL. BS. SP. SIC	98	0.6"	1.32	
				TYPE, ZN.				
		136.4	136.7	HARD WHITE CAL - FEASIBLE				
				15° WHITE, SP. AN, SP. 20°				
		137.2	137.3	SL. SHEARING, 60° SOME CAL				
		138.5	138.6	ERRATIC CHARCO. PERR.				
		167.4	167.8	BRECCATED SHEAR ZONE				
				CAL. PUR. CHARCO. 167.1-167.5	99	0.7	0.31	
		179.2	-	ERRATIC 1/2" CAL. WHITE				
		183.1	183.6	BRECCATED ZONE WITH				
				1" HARD WHITE CAL. SL. CHARCO				
				TYPE.				
		185.9	186.2	3/4" PINK SILICEOUS MATERIAL				
				FOLLOWED BY 1/2" - 2" WHITE				
				CAL. 55° SL. PUR. CHARCO				
		186.0	186.4	IN CAL. 25° SP. #129		0.4	0.31	

Boggs & ...

DIAMOND DRILL RECORD

SILVER CENTURY EXPLORATIONS LTD.

PROPERTY _____

HOLE NO. 5-C 65

SHEET NUMBER II

SECTION FROM _____ TO _____

STARTED MARCH 15 - 1983

LATITUDE N. 7253.0

DATUM _____

COMPLETED MARCH 24 - 1983

DEPARTURE E. 10298.0

BEARING 180°

ULTIMATE DEPTH 369.0

ELEVATION 1090' L. 209' X CUT EL. 797.0

DIP FLAT.

PROPOSED DEPTH 300. Plus

DEPTH FEET	GEOLOGY	FROM	TO	ECONOMIC	SAMPLE NO.	WIDTH OF SAMPLE	GOLD'S AC.	SLUDGE GOLD'S AC.
0 - 218.6	GRAVEL IN SAND	218.6	227.4	SOME BANNED SECTIONS				
218.6 - 369.0	SAND TO F			UP TO 5" ALTERATION				
				SL. PYR - CHALCO				
		264.4	-	1"-2" ALTERED SECTION				
				SS				
		303.2	306.0	QZ - RED FELDSPAR?				
				SOME YELLOWISH				
				MATERIAL - 15" SOME				
				Py. Py.				
		334.0	-	1/2" WHITE CHL. 5"				
				SL. PYR. CHALCO				
		366.8	367.3	6" QZ, 45° SOME				
				Py. ZN. CHALCO				
				END OF HOLE.				
					369.0			

Beccan Diamond Drilling

DIAMOND DRILL RECORD

SILVER CENTURY EXPLORATIONS LTD.

3.0.66

PROPERTY _____

HOLE NO. 3.0.66

SHEET NUMBER II

SECTION FROM _____ TO _____

STARTED MARCH 25 - 1983

LATITUDE N. 7122.0

DATUM _____

COMPLETED MARCH 30 - 1983

DEPARTURE E. 9965.0

BEARING 120°

ULTIMATE DEPTH 120.0

ELEVATION 1072' A. 209 X CUT.

DIP 745°

PROPOSED DEPTH 110.0

DEPTH FEET	GEOLOGY	FROM	TO	ECONOMIC	SAMPLE NO.	WIDTH OF SAMPLE	GOLD'S	SLUDGE		
0.0 - 11.8	KEEWATIN LAVA AND TUFF.	25.6	25.9	SHEPHERD - 35° S. zone SILICEOUS MATERIAL SYRR. ZN.						
	ALTERED AND BRECCIATED	37.4	38.3	DORGE COLORED CHL. STMS CHASCO, P. ZN. 51. CO. 55°	66-1	38.2-38.8	0.75			
		60.1	60.6	mostly Qtz. 25° 51. 45° CHASCO.						1" zone of Cal. strigosa w/ blebs of Co & Cp; 2" zone altered brown-gray (50)
11.8 - 120.0	DIABASE	61.3	61.8	Mostly Qtz. 45° Same SYRR. CHASCO. 51. CO. (61.7)						
		66.0	66.5	11.2" MASSIVE. 80. 70°	100	0.5'	10.76	46.00	46.00	
		66.5	67.5	SCATTERED STMS AND	101	1.0'	0.05			
		67.5	68.5	ALBA. CO. SOME CHASCO	102	1.0'	0.03			
		68.5	69.5	PINK COLORED SILICEOUS	103	1.0'	TRACE			
		69.5	70.2		104	0.7'	0.01			
		81.6	82.0	A FEW PLEBS. CO. CHASCO	105	0.2'	0.46			
				FLAKE AS 81.6-81.9 SAMPLE.						
		104.2	104.7	1/2" CAL. GRIN, 15° CO. CHASCO						
		105.6	-	1/4" WHITE CAL. CHASCO. 45°						
				END OF HOLE 120.0 FT.						

Not
K. CONTACT-NOR. 33.43'
VERT + 23.4'

HORIZONTAL DISTANCE - 84.85 FT.
VERTICAL DISTANCE - 84.85 FT.

PETERSON LAKE

DIAMOND DRILL RECORD

SILVER CENTURY EXPLORATIONS LTD.

PROPERTY
EAST ARM, WEST SHORE

HOLE NO. P. 1

SHEET NUMBER 1

SECTION FROM C TO 600

STARTED JUNE 19 - 1982

LATITUDE 7530.0 N

DATUM _____

COMPLETED July 7 - 1982

DEPARTURE 8370.0 E

BEARING 190°

ULTIMATE DEPTH 1206.0' FT

ELEVATION SURFACE 964.6' SIA. (Collar)

DIP -50°

PROPOSED DEPTH 1100.0 FT

DEPTH FEET	GEOLOGY	FROM	TO	ECONOMIC	SAMPLE NO.	WIDTH OF SAMPLE	AL - OX. - GOLD %	AG. SLUDGE - GOLD %
0 - 16.0	CASING	45.6	48.8	ALGALIC - FINE GRAINED - HEMISPHERIC				
		77.3	-	1/2" PINK CAL. 45° - HEM.				
16.0 - 331.0	H. PISSING	77.5	-	1/2" " " 45°				
	DIABASE	79.1	79.2	1" PINK AND WHITE CAL. 45° HEM.				
		91.6	92.6	SERIES OF FINE CAL. STRS UP				
				To 1/4" HEM.				
		94.8	97.0	FRAGMENTED, FINE CAL. STRS HEM.				
331.0 - 580.0	KARSTIC LAVA	139.3	140.3	NUMEROUS CAL. STRS + SPATHS				
	WITH BLACK COBALT	149.6	149.7	1" WHITE CAL. 45°				
	INCLUSIONS	151.3	151.4	1" " " "				
		200.8	200.95	1 1/2" QTZ. 35° PLATE				
		201.4	201.5	1" " 30° BRANCHED LOOKING				
		220.0	-	1/4" CAL. 45°				
		231	233	PALE, BRANCHED, SILICEOUS STRS.				
		316.3	-	1/4" WHITE CAL. 45°				
		328.3	328.6	SEVERAL QTZ. STRS. 45°				
		331.8	-	1/4" GREY CAL. 45°				
		349.6	-	1/4" WHITE CAL. 45°				
		354.4	-	1/4" " " "				
		431.8	-	1/4" " " CALSITE - 45°				
		598.2	599.3	FAULT - COARSE - FRACTURED.				

DIAMOND DRILL RECORD

SILVER CENTURY EXPLORATIONS LTD.

PETERSON LAKE

PROPERTY

HOLE NO. P.1

EAST 1/4 M. WEST 3/4 SEC

SHEET NUMBER 11

SECTION FROM 600 TO _____

STARTED JUNE 19 - 1982

LATITUDE N. 75°30.0

DATUM _____

COMPLETED July - 7 - 1982

DEPARTURE E. 8270.0

BEARING 190°

ULTIMATE DEPTH 1266.0

ELEVATION SURFACE: 961.0 S.L. (COKAR)

DIP -50°

PROPOSED DEPTH 1105.0

DEPTH FEET	Geology	From	To	ECONOMIC	SAMPLE NO.	WIDTH OF SAMPLE	NO. OF CORES	SLUDGE SAMPLES	
		607.8	607.9	1" CHL. 30° SERPENTINE					
		622.4	622.5	1" " 30° QTR. SERPENTINE				SLUDGE SAMPLES	
		642.4	644.4	CHL. STRS. + THREADS	1	10.0'	0.01		642.0 - 650.0
	X	644.4	646.0	COURSE WHITE QTR. 30.02 CHL. 45°	2	10.0'	0.07		650.0 - 660.0
					3	10.0'	0.02		660.0 - 670.0
	X	646.5	646.7	2" PINK CHL. 45°	4	10.0'	0.02		670.0 - 680.0
	X	652.2	652.4	2" GREY CHL. 45° (PY SPLASHES)					
		662.2	662.5	3" QTR. CHALCITE, 45°					
		667.1	667.2	1" QTR. CHL. 45° SERPENTINIZED					
				45°					
		671.0	671.3	3" SERPENTINE QTR, 45°					
				HEAVY AGGREGATION					
		808.8	808.9	3/4" QTR. CHL. 60° S.L. CHALCO					
		837.0	839.0	A FEW CHL. + CHALCITE THREADS					
	X	842.0	842.1	1/2" MASSIVE CHALCO. - 70°					
		842.3	842.4	1" " " FRASER					
880.0 - 938.0	CONGLOMERATE	857.2	857.4	SPLASHES CHALCO, RED FRASER					
	EITHER KEOWATH OR	923.5	923.7	CHL. THREADS CHALCO					
	TUNDRA PINS, SCATTERED			HEMATITE					
	PEBBLES AND	929.2	929.4	CHALCO SPLASHES					

[Signature]

PATERSON LAKE.
 EAST ARM WEST SHORE

DIAMOND DRILL RECORD

SILVER CENTURY EXPLORATIONS LTD.

111

PROPERTY

HOLE NO. P. 1.

SHEET NUMBER II SECTION FROM _____ TO _____ STARTED June 19 - 1982

LATITUDE N. 7530.0 DATUM _____ COMPLETED July 7 - 1982

DEPARTURE E. 8370.0 BEARING 190° ULTIMATE DEPTH 1266.0

ELEVATION SURFACE 964.0 S.I. (CORNER) DIP -50° PROPOSED DEPTH 1100.0

DEPTH FEET	LITHOLOGY	FROM	TO	ECONOMIC	SAMPLE NO.	WIDTH OF SAMPLE	% G.O.L.D.	SLUDGE G.O.L.D.
	ANGULAR CHASTIC INCLUSIONS	953.2	957.0	CAL. CHLORITE STRS. CHANGE COLORED ALTERATION				
		992.0	995.2	WHITE CAL. IRREGULAR SILICITE				
937.0 - 1033.0	KIAWAHUA LAVA AND AMPHOPHYRE	995.8	995.9	1/2" PINK CAL. 80° FINE PIR.				
	DIKES, SOME PEBBLE INCLUSIONS	1061.4	1061.5	GRY. CAL. STRS. 1/4" DIA. CHANGE COLORED ALTERATION				
		1073.7	1075.8	1/2" GRAY CAL. 80°				ACID TESTS
1033.0 - 1206.0	AMPHOPHYRE	1121.4	1121.5	1" GRAY CAL. 70° PIR.	5'	0.1	2.68	320' - 51'-36"
	SCATTERED CAL STRS. OCCASIONAL PEBBLE INCLUSION CAL. THREADS.	1157.8	1185.0	3/4" DARK CAL. 30° SL. PIR. CHLORITE.				300' " 57'-36" " 57'-36" 1000' " 51'-36" " 49'-36"
HOR. DIST.	755.0 FT.							
VERT. DIST.	940.0 FT.			END OF HOLE	1206.0'			

TEM. PTG. CO. LTD. NEW LISKEARD

DRILLED BY BERRAN DIAMOND DRILLING

[Signature]

PETERSON LAKE
EAST ARM, WEST SHORE
PROPERTY

DIAMOND DRILL RECORD

SILVER CENTURY EXPLORATIONS LTD.

HOLE NO. P.2

SHEET NUMBER 1

SECTION FROM _____ TO _____

STARTED July 8 - 1982

LATITUDE 7677.0 N

DATUM _____

COMPLETED July 21 - 1982

DEPARTURE 8400.0 E.

BEARING 190°

ULTIMATE DEPTH 946.0'

ELEVATION 971.0 S.L.

DIP -52°

PROPOSED DEPTH 900.0'

DEPTH FEET	GEOLOGY	From	To	ECONOMIC	SAMPLE NO.	WIDTH OF SAMPLE	NO. OF CORES	SLUDGE
0.0 - 20.0	CASING							
		33.5	33.6	3/4" CAL. 60° SL. PYR.				
20.0 - 770.0	ADMISSING DIABASE	56.1	56.3	WHITE CAL. 60° WATER				
	(26-73) COARSE			WORN. PYR.				
	(73-97) BLEACHED & ALTERED	81.4	81.6	1/2" WHITE CAL. 20°				
		112.5	112.6	3/4" CAL. 60° - HEM. PYR.				
	(97-) COARSE	115.0	119.0	ALTERED SECTION; CAL. STRS. & SPLASHES				
		116.5	116.7	1/2" CAL. 30° - PYR. HEM.				
		116.9	117.1	1/2" CAL. 30° - HEM.				
		206.0	206.2	GROUND WHITE CAL. HEM.				
		230.0	232.0	BLEACHED AND ALTERED SECTION; RECEMENTED BRECCIA, CAL, QTZ.				
		237.4	237.5	1/2" CAL. CALORITE, 45°				
		282.3	282.4	1/2" CAL. QTZ, 45°				
		X 283.5	283.7	1" PINK CAL; 45°				
		284.6	284.7	1/2" GREY CAL; QTZ, 45°				
		332.7	332.8	1/2" CAL-QTZ. 50°				
		X 333.1	333.3	1" PINK CAL. SL. COY. 50°				
		333.9	334.2	2 1/2" PINK CAL. QTZ. 45°				

[Signature]

DIAMOND DRILL RECORD

SILVER CENTURY EXPLORATIONS LTD.

PETERSON LAKE

PROPERTY

HOLE NO. 12

EAST ARM, WEST SHORE

SHEET NUMBER 11

SECTION FROM _____ TO _____

STARTED July 8 - 1982

LATITUDE N. 7677.0

DATUM _____

COMPLETED July 21 - 1982

DEPARTURE E. 9400.0

BEARING 190°

ULTIMATE DEPTH 946.0'

ELEVATION 971.0 S.L.

DIP -52°

PROPOSED DEPTH 900.0'

DEPTH FEET	GEOLOGY	FROM	TO	ECONOMIC	SAMPLE NO.	WIDTH OF SAMPLE	GR. GOLD \$ CT.	SLUDGE GOLD \$ CT. 20-52
		334.3	334.5	3/4" PINK CAL-QTZ - 45°				
		335.2	335.4	1/2" CAL-QTZ - 30°				
		335.5	335.6	1/2" CAL-QTZ - 45°				
		337.0	337.2	3/4" BANDED CAL-HEM - 45°				
		389.7	-	1/4" CAL-QTZ-STP. 30°				
		389.8	390.0	1/2" CAL-QTZ - 30°				
		466.5	466.6	CAL-CHLORITE THREADS 30°				
		508.0	508.6	MUD, ASBESTOS, FAULT MATERIAL				
		518.8	519.1	GREY MUD, SLICKENSIDES				
		554.9	555.0	1/2" Grey Cal. 45°				
		572.0	575.6	ALTERED ZONE, CHLORITE CAL. SPLASHES, SK. PR.				
		618.5	618.6	1/2" BANDED CAL. 30°				
		626.3	628.0	WHITE-QTZ. SPLASHES. PINK CAL. 40°				
		628.0	628.3	CRUSHED CAL. CHIPS				
		629.0	629.1	2-1/4" PINK CAL. SIPS. 60°				
		629.3	629.4	1" PINK CAL. 70°				
		629.8	629.85	1/2" " CAL. 80°				
		630.0	630.15	1/2" " CAL. 60°				

Barry Diamond Drilling

DIAMOND DRILL RECORD

SILVER CENTURY EXPLORATIONS LTD.

PETERSON LAKE PROPERTY
EAST ARM - WEST SHORE

HOLE NO. P.2

SHEET NUMBER III SECTION FROM _____ TO _____ STARTED July 8 - 1982
 LATITUDE N. 7677.0 DATUM _____ COMPLETED July 21 - 1982
 DEPARTURE E. 8400.0 BEARING 190° ULTIMATE DEPTH 946.0'
 ELEVATION 971.0 S.L. DIP -52° PROPOSED DEPTH 900.0

DEPTH FEET	GEOLOGY	FROM	TO	ECONOMIC	SAMPLE NO.	WIDTH OF SAMPLE	NO. OZ. GOLD	SLUDGE LOSS %
		630.3	630.4	$\frac{3}{4}$ " WHITE CAL. 60°				
		630.7	-	SPLASH. PINK CAL.				
		631.5	631.6	2- $\frac{1}{2}$ " PINK CAL. VEINS 60°				
		631.9	-	$\frac{1}{2}$ " PINK CAL. 60°				
		636.8	637.2	CAL + QTZ. 30° ASBESTOS				
				ROSE QTZ.?				
770.0 - 772.8	SLATES	X 841.7	841.9	SPLASH CHALKO. PIR.				
		863.1	863.3	FAULT GOUGE. 45°				
772.8 - 946.0	LAMPROPHYRE	886.5	-	$\frac{1}{2}$ " WHITE CAL. 90°				
	WITH SCATTERED	892.0	-	$\frac{1}{2}$ " ORANGE CAL. 45°				
	PEBBLES AND	898.5	898.7	2-ORANGE + WHITE CAL.				
	IRREGULAR CHASTIC CHASTIC			STRS. 45° + 60°				
	FRAGMENTS	909.4	909.65	VUGGY WHITE CAL.				
				30° - HEMATITE.				
							ACID TESTS	
				END OF HOLE. 946.0			500' ETCHED 57'-30" CORRECTED TO 50'-30"	
							800' ETCHED 60'-00" CORRECTED TO 53'-00"	
HOR. DIST.	585.0'							
VERT. DIST.	745.0'							



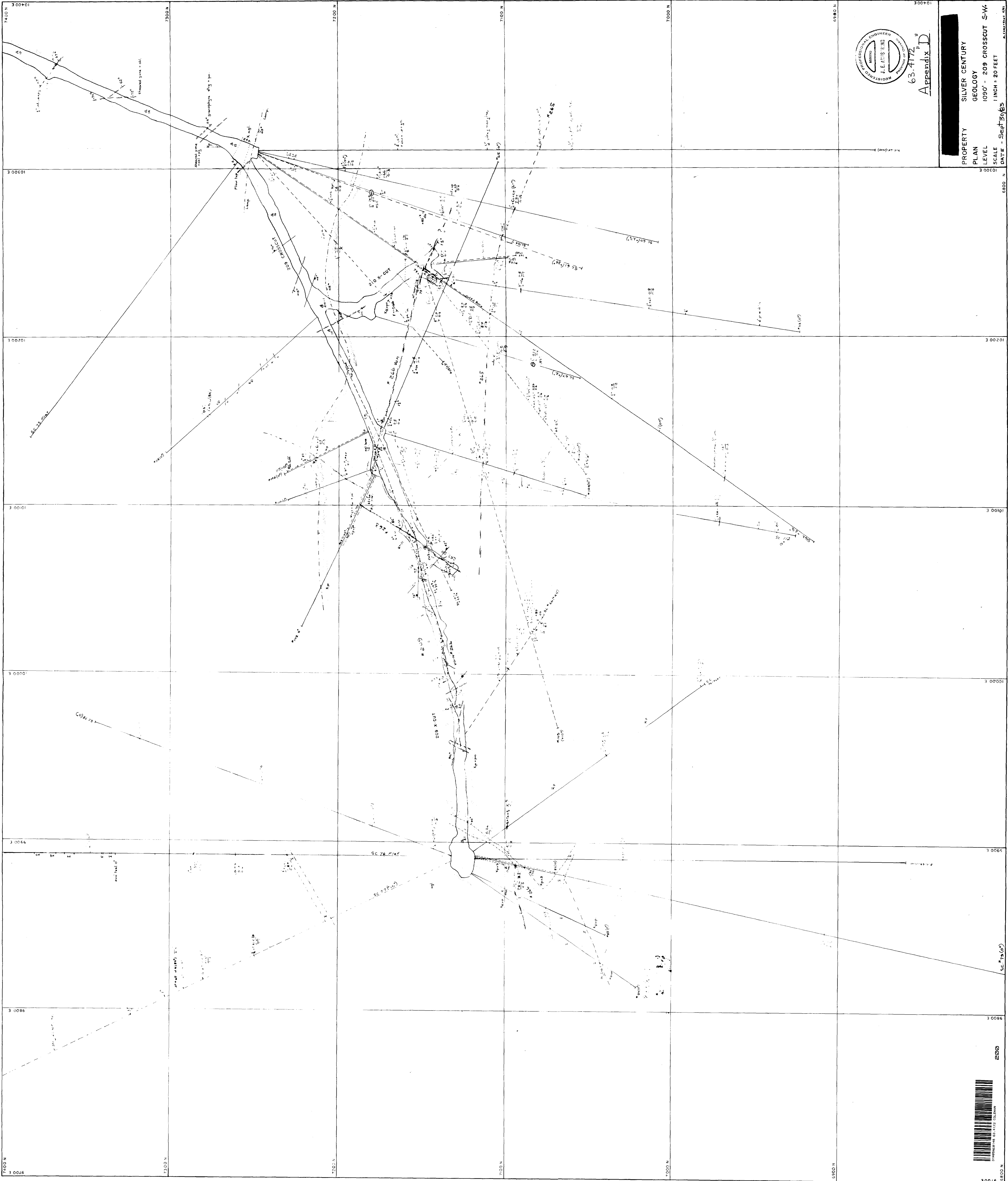

63.4772
Appendix D

PROPERTY: SILVER CENTURY
 GEOLOGY: GEOLOGY
 PLAN: 1050' - 208 CROSSCUT SW
 LEVEL: LEVEL
 SCALE: 1 INCH = 20 FEET
 DATE: Sept 30, 2008



2008

9700

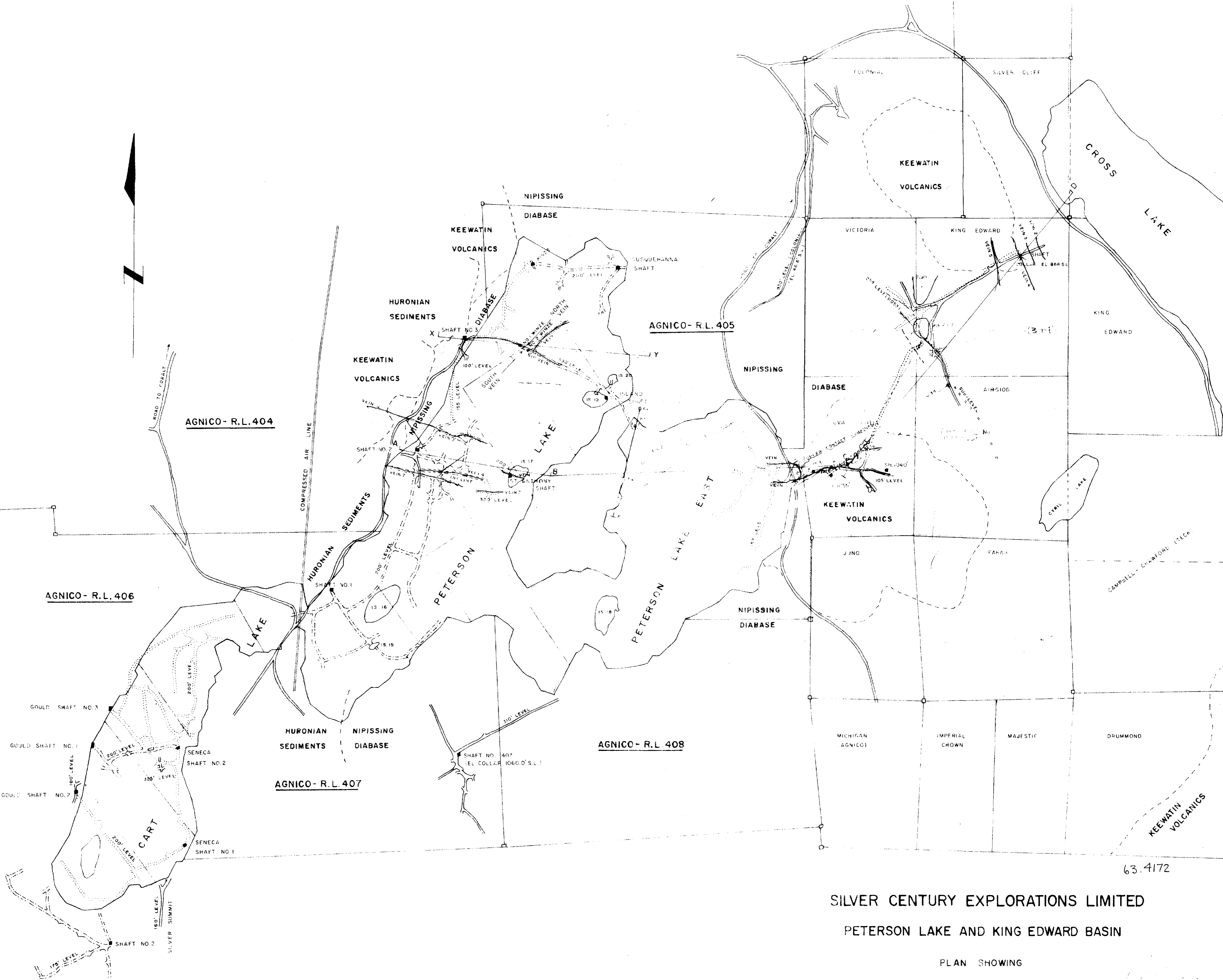
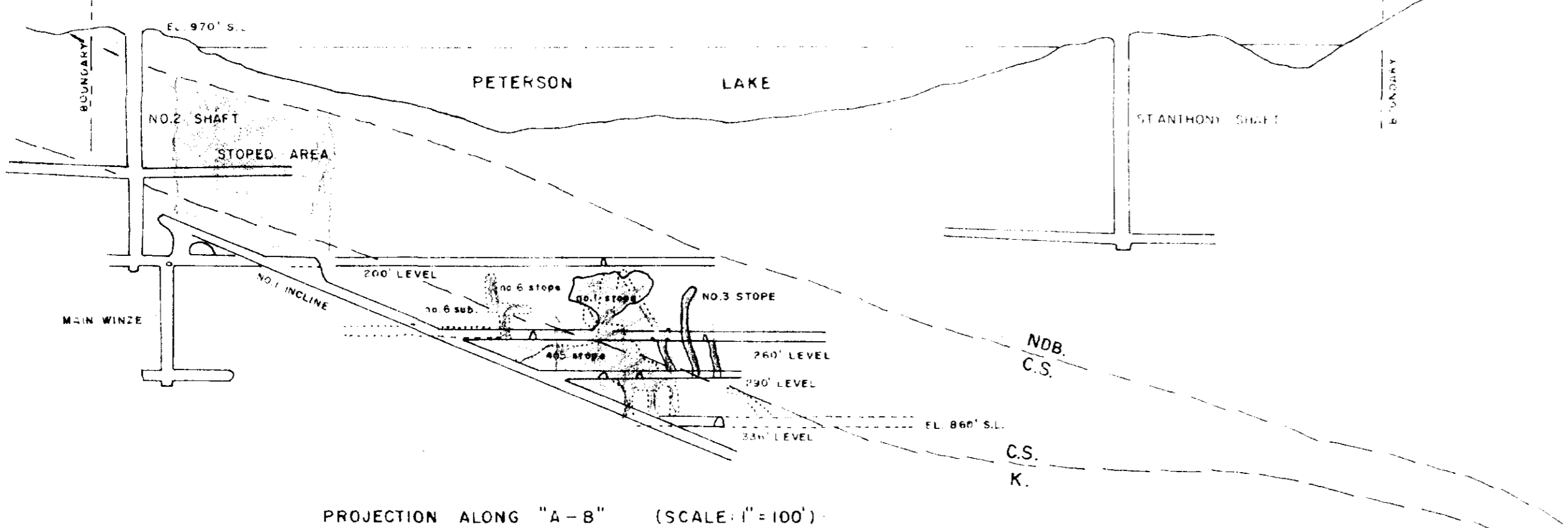

SILVER CENTURY EXPLORATIONS LIMITED
 PETERSON LAKE AND KING EDWARD BASIN

PLAN SHOWING
 UNDERGROUND WORKINGS
 AND
 SURFACE GEOLOGY
 AND
 ADJACENT PROPERTIES

Appendix "A"

SCALE: 1 INCH = 400 FEET



210

Traced by M.A. 10/78

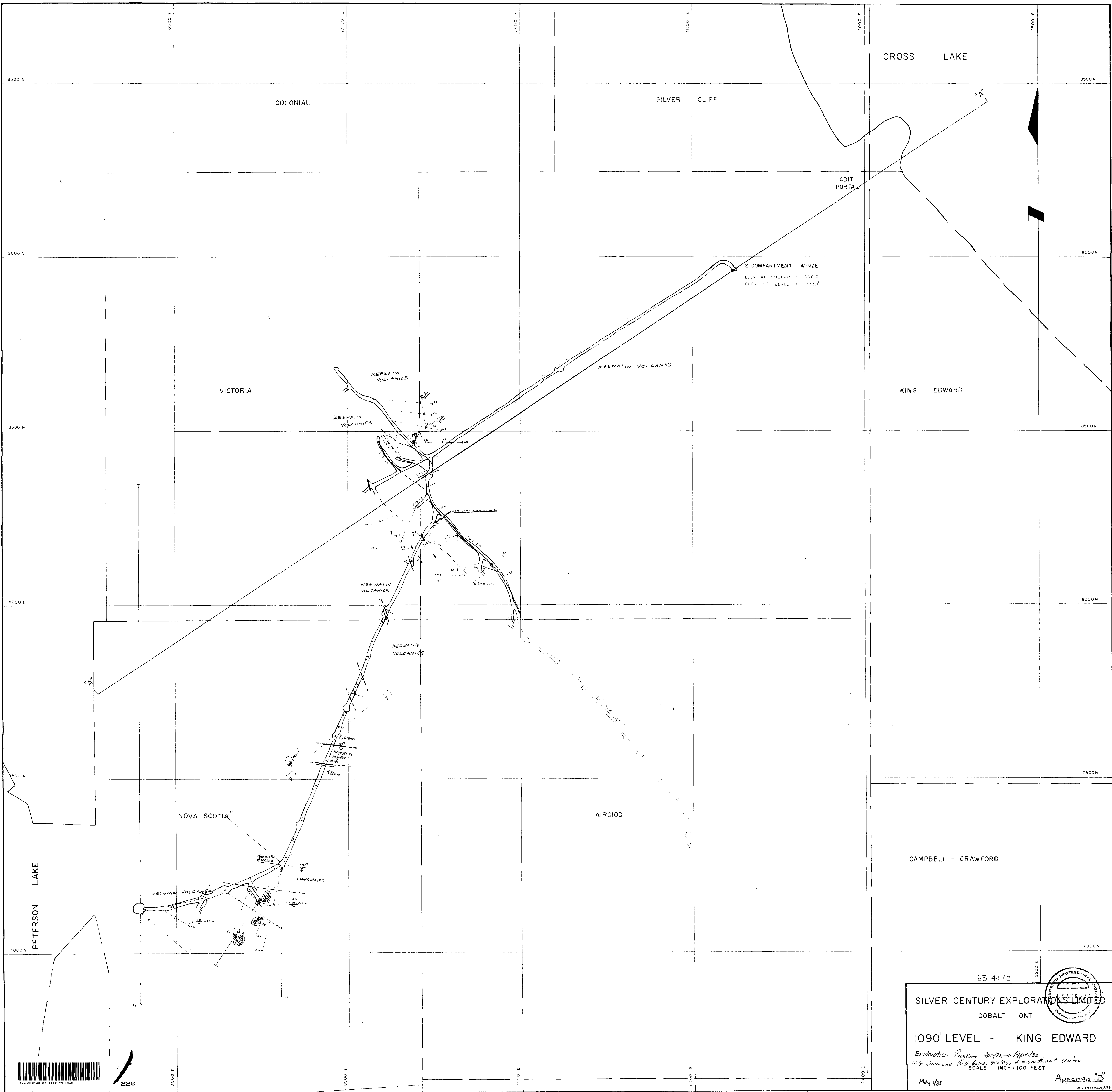

63.4172

SILVER CENTURY EXPLORATIONS LIMITED
 COBALT ONT

1090' LEVEL - KING EDWARD

Exploration Program April 22 - April 22
 U.S. Diamond Drill Data, 3rd 200' Section Series
 SCALE: 1 INCH = 100 FEET

May 1/83



Appendix B



220

0000 E

0050 E

11200 E

11500 E

12500 E

12500 E

7000 N

7500 N

8000 N

8500 N

9000 N

9500 N

10000 E

10500 E

11000 E

11500 E

12000 E

12500 E

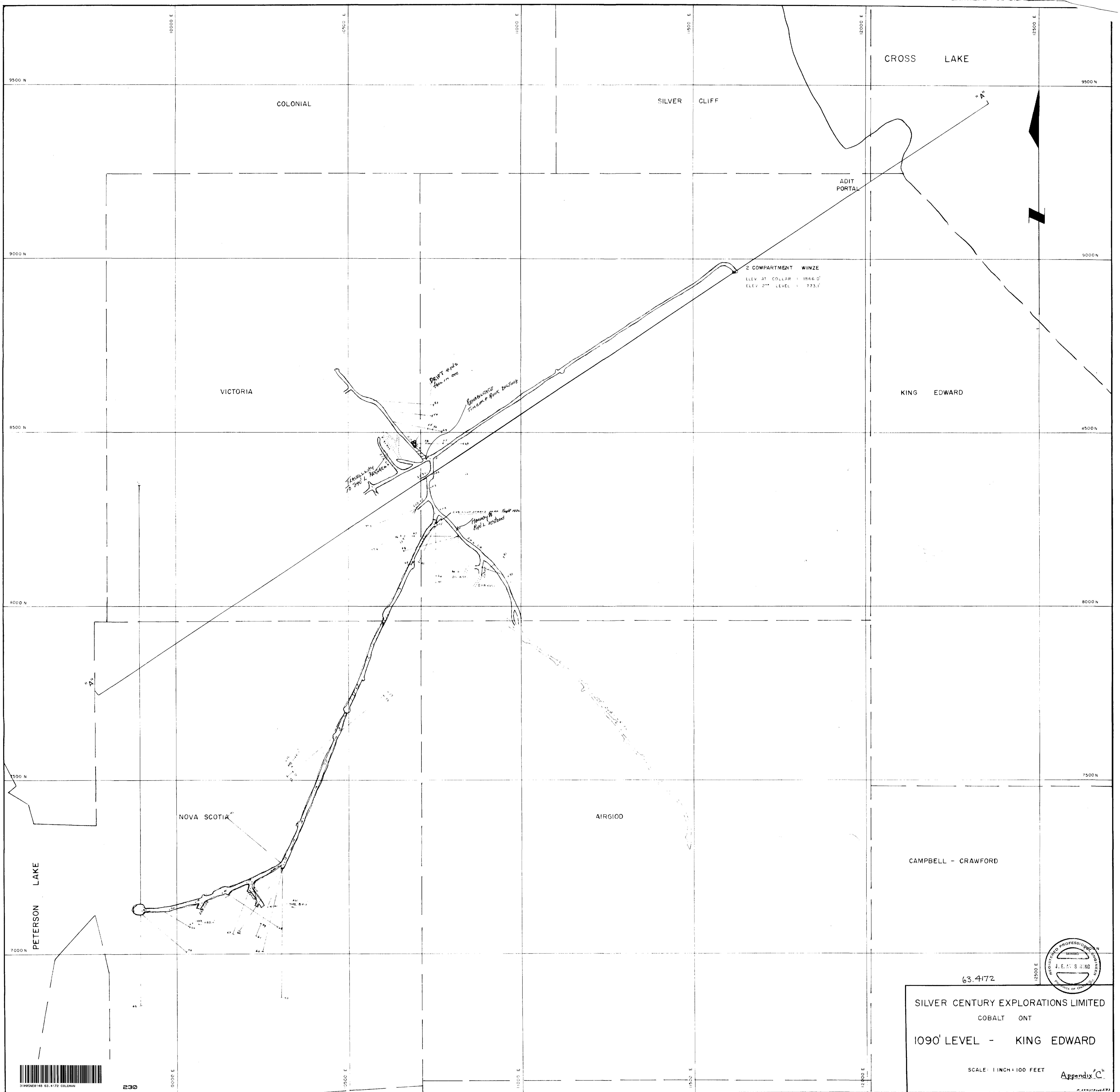

63.4172

SILVER CENTURY EXPLORATIONS LIMITED
 COBALT ONT
 1090' LEVEL - KING EDWARD

SCALE: 1 INCH = 100 FEET

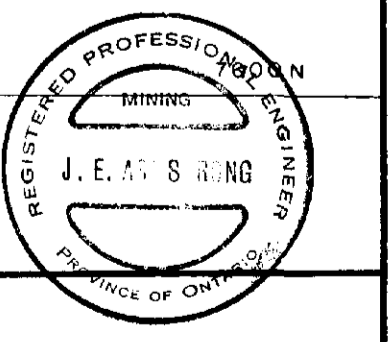

Appendix C

