



31M05NE9710 2.15180 BUCKE

010

ASSESSMENT REPORT
FOR
GEOLOGICAL SURVEY
ON
CLAIMS L119115, L119116, L1179117,
L1179118 AND L1179119,
BUCKE TOWNSHIP

by

David P. Money, M.Sc., P. Eng.
Project Geologist
Falconbridge Limited (Exploration)
1977 McKenzie Road, R. R. #2
Chelmsford, Ontario
POM 1L0

Anal.
2.14919

October 8, 1993

2.15180



31M05NE9710 2.15180 BUCKE

010C

TABLE OF CONTENTS

| | |
|---------------------------------------|---|
| LOCATION AND ACCESS | 1 |
| PROPERTY | 1 |
| EXPLORATION HISTORY | 1 |
| 1993 PROGRAM | 1 |
| GEOLOGY | 3 |
| Regional Geology | 3 |
| Property Geology | 3 |
| Table of Units with Description | 3 |
| Structural Geology | 4 |
| Alteration | 4 |
| Mineralization | 4 |
| Anomalies | 4 |
| RECOMMENDATIONS | 4 |
| REFERENCES | 5 |

LIST OF ILLUSTRATIONS

- Figure 1 First Brook Claim Block "E" Location Map
- Figure 2 Geology and Sample Locations

LOCATION AND ACCESS

The nine unit First Brook Project claim block "E" is located in Concession II, lots 13 and 14 of Bucke Township. The claims are centred about 1.5 kilometres east-northeast of North Cobalt. The claims can be reached by a dirt road from Haileybury to the old cemetery, or by boat on Lake Timiskaming. (Figure 1)

PROPERTY

The claim block consists of claims L1179115, L1179116, L1179117, L1179118 and L1179119, which are owned by Falconbridge Limited, Suite 1200, 95 Wellington Street West, Toronto, Ontario, M5J 2V4

EXPLORATION HISTORY

Mapping by Thomson (1963) indicated that five exploration pits occur on the property. No record of these workings can be found in assessment files; however, descriptions of some of the workings may be found in Thomson (1960). Thomson (1960) reported that E. L. MacVeigh drilled seven x-ray diamond drill holes with an aggregate length of 49 m in 1954. The claims were staked for Falconbridge Limited in 1991 as a result of a compilation program in the Cobalt area.

1993 PROGRAM

The 1993 program was conducted and supervised by the author. It was as follows:

| | | |
|---------------------------|---|---|
| July 21 - ½ day | - | mobilization from Chelmsford to Cobalt |
| July 23 - ½ day | - | surface title searches, meet with the Millards and gave them the notice of intent |
| August 1 | - | met with Jim Grant and gave him the notice of intent |
| August 2, 3, & 4 - 3 days | - | geological mapping and sampling on claims |
| August 7 - ½ day | - | assessment file research |
| August 20 - 1 day | - | geological mapping and sampling |
| August 30 - ½ day | - | demobilization from Cobalt to Chelmsford |
| October 1, 4 & 8 - 2 days | - | report writing, preparation and drafting of map |

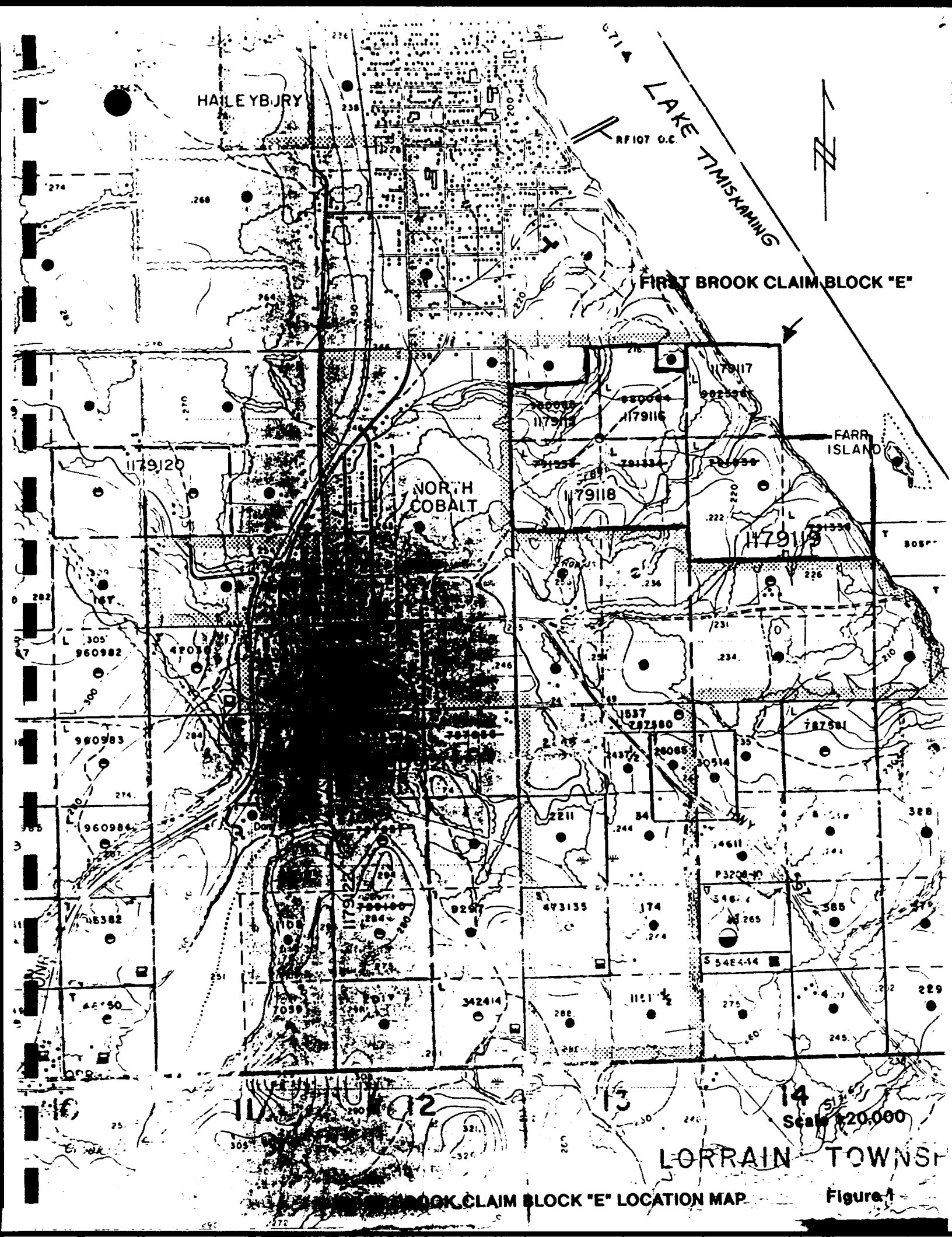

HAILEYBURY

LAKE TIMISKAMING

FIRST BROOK CLAIM BLOCK "E"

NORTH COBALT

FARR ISLAND

LORRAIN TOWNSHIP

Scale 1:20,000

FIRST BROOK CLAIM BLOCK "E" LOCATION MAP

Figure 1

GEOLOGY

Regional Geology

The main geological units in the Cobalt area are sediments of the Huronian Supergroup, Nipissing Diabase sills and inliers of Archean metavolcanics and metasediments. The claims are wholly underlain by Archean metavolcanics and metasediments.

Property Geology

Table of Units with Descriptions

Feldspar - (Quartz) Porphyry (Map Units 8 & 9)

- massive grey to pink intrusive exposed in two locations in Farr Creek
- contains 20% 1 to 7 mm long plagioclase laths and rarely contains quartz or amphibole phenocrysts
- locally is fractured with chlorite and/or quartz fracture fillings

Gabbro (Map Unit 7)

- medium to dark green in colour
- exposed as knobs in the southwest part of the property
- fine grained to medium grained equigranular rock comprised of amphibole and feldspar with 1 to 2 % fine grained leucoxene
- minor epidote filled fractures

Chert (Unit 5)

- light grey thin siliceous chert beds are exposed in a trench in the southeast part of the property
- bedding orientation could not be determined in the poor exposure

Mafic Volcanics (Basalt to Andesite, Map Units 2 and 3)

- exposed as ridges and in creeks
- varies from massive flows to pillowed flows
- grey to light green in colour
- fine grained groundmass with rare amphibole and/or feldspar phenocrysts

Structural Geology

No faults or folds were observed during the mapping of the property. Thomson (1963) mapped both easterly and westerly top directions in the pillowed basalts; however, I did not find any good facing directions in my mapping. No conclusive bedding orientation could be determined from the chert outcrop.

Alteration

Quartz, chlorite, calcite and epidote occur in fractures. They form a minor constituent of the rocks and no zones of moderate to strong alteration were observed.

Mineralization

Pyrite was the only sulphide observed. It is disseminated in quantities up to 1% (see Figure 2) in the volcanics and chert and comprises 3% of a quartz vein in the southeast of the property.

Anomalies

Fieldwork by Falconbridge in numerous greenstone belts has determined threshold values for analytical results. Using these thresholds there are nine samples with anomalous copper contents (> 100 ppm) and one with anomalous zinc contents (> 150 ppm). These anomalies may represent the distal signature of volcanogenic massive sulphides.

RECOMMENDATIONS

The property merits coverage by a ground EM survey. A grid should be cut, surveyed by a ground EM survey, such as max-min, and any anomalies detected should be investigated by a geologist.

David P. Money

REFERENCES

Thomson, R. (1960). Preliminary Report on Bucke Township, District of Timiskaming, Description of Mining Properties. Ontario Department of Mines Report P.R. 1960-2.

Thomson, R. (1963). Cobalt Silver Area, Northern Sheet. Ontario Department of Mines Map 2050, 1:12,000.

APPENDIX I - Expenditures

| Description | Details | Cost | Total |
|---------------------|---|---|------------|
| Salaries | D. Money, Project Geologist N. Wiebe, Junior Assistant | 8 days @ \$264.25/day 6 days @ \$100/day | \$2,714.00 |
| Analytical Costs | X-Ray Assay | Report 23864 | \$861.00 |
| | X-Ray Assay | Report 24040 | \$175.50 |
| Room & Board | | 12 days @ \$30/day | \$360.00 |
| Truck Rental | | 6 days @ \$30/day | \$180.00 |
| | | TOTAL | \$4,290.50 |

Invoice No.: 025746

XRAL

X-Ray Assay Laboratories

A Division of SGS Canada Inc.

1885 Leslie St.
Don Mills
Ontario M3B 3J4
Canada
Tel: (416) 445-5755
Fax: (416) 445-4152
Telex: 09-986947

**PLEASE NOTE NEW
REMITTANCE ADDRESS**

PO Box 9581
Station "A"
Toronto, Ontario
M5W 2K3

Invoice To:

FALCONBRIDGE LIMITED
ATTN: DAVE MONEY
1977 MCKENZIE ROAD
GENERAL DELIVERY RR#2
CHELMSFORD, ONTARIO P0M 1L0

Submitted To:

FALCONBRIDGE LIMITED
ATTN: JAMIE CECCHETTO
1977 MCKENZIE ROAD
GENERAL DELIVERY RR#2
CHELMSFORD, ONTARIO P0M 1L0

Invoice Date: 23-Aug-93
Work Order No.: 15672
Date Submitted: 9-Aug-93
Report No.: 23864
Customer No.: 233-3/18442
Your P.O. No.:
Your Project No.: FIRSTBROOK-E 6-270

OK-LL

| QUANTITY | DESCRIPTION METHOD | CODE NUMBER | UNIT COST | AMOUNT |
|--|--------------------|-------------|-----------|----------|
| 40 | WHOLE ROCK PACKAGE | 4 510 0 0 | 18.50 | 740.00 ✓ |
| 1 | ASSAY PACKAGE | 410 0 0 0 | 11.00 | 11.00 ✓ |
| 41 | SAMPLE PREPARATION | 1 0 0 0 0 | 2.50 | 102.50 ✓ |
| 1 | FLOPPY - 3.5" | 15 0 0 0 0 | 7.50 | 7.50 ✓ |
| GST REG NO. R105082572 APPLIED TO \$861.00 | | | | 60.27 |

| | | | |
|-----------------------------|-------------|------------|--------------------|
| FALCONBRIDGE LIMITED | | | |
| VOUCHER NUMBER | 25746 | | VENDOR NUMBER 2019 |
| ACCOUNT | COST CENTRE | AMOUNT | CR X |
| 1161211610181 | 11612110 | 861.00 | |
| 1131211010151 | GST | | |
| DUE DATE | | CURRENCY | |
| APPROVED | CODED | EXT & ADDS | APAY |
| | | | CHECKED |

| | | | |
|------------------|------------------|--------------------------|-----------------|
| SHIPPING CHARGES | CUSTOM BROKERAGE | TELEX/FAX | MINIMUM CHARGES |
| OTHER | | SURCHARGE - RUSH SERVICE | |

TERMS NET 30 DAYS, 1.5% PER MONTH INTEREST ON ACCOUNTS OVER 30 DAYS

ORIGINAL INVOICE



Member of the SGS Group (Société Générale de Surveillance)

TOTAL IN >

CDN FUNDS \$ 921.27 ✓

XRAL

X-Ray Assay Laboratories
A Division of SGS Canada Inc.

1885 Leslie St.
Don Mills
Ontario M3B 3J4
Canada
Tel: (416) 445-5755
Fax: (416) 445-4152
Telex: 09-986947

Invoice To:

FALCONBRIDGE LIMITED
ATTN: JAMIE CECCHETTO
1977 MCKENZIE ROAD
GENERAL DELIVERY RR#2
CHELMSFORD, ONTARIO P0M 1L0

Invoice Date: 14-Sep-93
Work Order No.: 15860
Date Submitted: 24-Aug-93
Report No.: 24040
Customer No.: 233-3/18442
Your P.O. No.:
Your Project No.: FIRST BROOK E 6-270

Submitted To:

FALCONBRIDGE LIMITED
ATTN: JAMIE CECCHETTO
1977 MCKENZIE ROAD
GENERAL DELIVERY RR#2
CHELMSFORD, ONTARIO P0M 1L0

O.K.-LL.

| QUANTITY | DESCRIPTION METHOD | CODE NUMBER | UNIT COST | AMOUNT |
|--|--------------------|-------------|-----------|----------|
| 8 | WHOLE ROCK PACKAGE | 4 610 00 | 18.50 | 148.00 ✓ |
| 2 | SAMPLE PREPARATION | 1 000 00 | 2.50 | 20.00 ✓ |
| 1 | FLOPPY - 3.5" | 15 000 00 | 7.50 | 7.50 ✓ |
| GST REG NO. R105082572 APPLIED TO \$175.50 | | | | 12.28 |
| <p style="text-align: center;">25977</p> <p style="text-align: center;">601608/006270 = \$175.50</p> <p style="text-align: center;">GST = \$12.28</p> <p style="text-align: center;">1/1 JKC ^{OCT 4 93}</p> | | | | |
| <p>2019</p> | | | | |
| <p>SHIPPING CHARGES</p> | | | | |
| <p>CUSTOM BROKERAGE</p> | | | | |
| <p>TELEX/FAX</p> | | | | |
| <p>MINIMUM CHARGES</p> | | | | |
| <p>OTHER</p> | | | | |
| <p>TERMS NET 30 DAYS, 1.5% PER MONTH INTEREST ON ACCOUNTS OVER 30 DAYS</p> | | | | |
| <p>SURCHARGE - RUSH SERVICE</p> | | | | |

ORIGINAL INVOICE

TOTAL IN >

CDN FUNDS \$ 187.78



Member of the SGS Group (Société Générale de Surveillance)

APPENDIX II - Analytical Results



X-RAY ASSAY LABORATORIES

A DIVISION OF SGS CANADA INC.

1885 LESLIE STREET • DON MILLS, ONTARIO M3B 3J4 • CANADA
TEL: (416)445-5755 TELEX: 06-986947 FAX: (416)445-4152

CERTIFICATE OF ANALYSIS

REPORT 23864

TO: FALCONBRIDGE LIMITED
ATTN: DAVE MONEY
1977 MCKENZIE ROAD
GENERAL DELIVERY RR#2
CHELMSFORD, ONTARIO POM 1L0

CUSTOMER No. 233

DATE SUBMITTED
9-Aug-93

REF. FILE 15672-M5

Total Pages 3

41 ROCKS Proj. FIRSTBROOK-E 6-270

| | METHOD | DETECTION LIMIT |
|-----------|--------|-----------------|
| AU PPB | FAAA | 5. |
| WRMAJ % | XRF-F | .01 |
| CO PPM | ICP | 1. |
| NI PPM | ICP | 1. |
| CU PPM | ICP | .5 |
| ZN PPM | ICP | .5 |
| WRMIN PPM | XRF-F | 10. |
| AG PPM | ICP | .1 |
| PB PPM | ICP | 2. |

DATE 23-Aug-93

CERTIFIED BY 

per Jean H.L. Opdebeeck, General Manager

| SAMPLE | NI PPM | CU PPM | AG PPM | CO PPM | AU PPB | ZN PPM | PB PPM |
|-----------|--------|--------|--------|--------|--------|--------|--------|
| SA04880 | 93 | 99.9 | <.1 | 28 | 14 | 64.2 | -- |
| SA04881 | 262 | 2.5 | .2 | 41 | 19 | 144 | -- |
| SA04882 | 67 | 9.6 | <.1 | 29 | 14 | 86.5 | -- |
| SA04883 | 44 | 2.8 | <.1 | 14 | 17 | 50.7 | -- |
| SA04884 | 43 | 88.6 | .5 | 20 | 19 | 52.6 | -- |
| SA04885 | 51 | 127 | <.1 | 27 | 14 | 51.1 | -- |
| SA04886 | 70 | 16.5 | .4 | 26 | 15 | 58.6 | -- |
| SA04887 | 63 | 13.8 | .2 | 25 | 11 | 49.6 | -- |
| SA04888 | 84 | 81.0 | <.1 | 36 | 16 | 55.3 | -- |
| SA04889 | 85 | 85.4 | <.1 | 39 | 15 | 68.7 | -- |
| SA04890 | 34 | 37.0 | <.1 | 17 | 18 | 37.1 | -- |
| SA04891 | 46 | 73.4 | <.1 | 41 | 19 | 95.4 | -- |
| SA04892 | 40 | 70.0 | .2 | 33 | 16 | 48.9 | -- |
| SA04893 | 39 | 86.9 | <.1 | 34 | 19 | 70.7 | -- |
| SA04894 | 49 | 56.7 | .3 | 37 | 18 | 54.8 | -- |
| SA04895 | 67 | 70.5 | .4 | 25 | 14 | 33.8 | -- |
| SA04896 | 71 | 136 | <.1 | 35 | 12 | 49.0 | -- |
| SA04897 | 30 | 43.4 | <.1 | -- | 12 | 61.5 | <2 |
| SA04898 | 6 | 12.9 | <.1 | 3 | 12 | 11.3 | -- |
| SA04899 | 17 | 3.5 | <.1 | 10 | 15 | 25.0 | -- |
| SA04900 | 93 | 67.4 | <.1 | 28 | 16 | 58.4 | -- |
| SA15331 | 70 | 24.8 | <.1 | 27 | 17 | 54.1 | -- |
| SA15332 | 43 | 26.0 | <.1 | 15 | 18 | 22.8 | -- |
| SA15333 | 54 | 59.4 | 1.1 | 19 | 12 | 243 | -- |
| SA15334 | 30 | 187 | .5 | 13 | 11 | 30.6 | -- |
| SA16785 | 57 | 73.7 | .3 | 36 | 14 | 151 | -- |
| SA16786 | 86 | 88.5 | .1 | 42 | 13 | 51.6 | -- |
| SA16787 | 95 | 80.0 | <.1 | 41 | 18 | 62.0 | -- |
| SA16788 | 100 | 42.0 | <.1 | 42 | 11 | 79.1 | -- |
| SA16789 | 87 | 40.6 | <.1 | 38 | 19 | 89.5 | -- |
| SA16790 | 64 | 45.8 | <.1 | 29 | 13 | 45.9 | -- |
| SA16791 | 15 | 3.8 | .2 | 7 | 14 | 18.7 | -- |
| SA16792 | 102 | 120 | .2 | 52 | 15 | 118 | -- |
| SA16793 | 108 | 117 | <.1 | 52 | 11 | 72.0 | -- |
| SA16794 | 94 | 131 | <.1 | 45 | 13 | 88.6 | -- |
| SA16795 | 11 | 4.9 | <.1 | 6 | 14 | 17.5 | -- |
| SA16796 | 12 | 7.5 | <.1 | 8 | 13 | 25.4 | -- |
| SA16797 | 91 | 259 | .7 | 49 | 72 | 45.6 | -- |
| SA16798 | 87 | 17.6 | <.1 | 31 | 13 | 62.6 | -- |
| SA16799 | 69 | 28.0 | <.1 | 25 | 36 | 41.0 | -- |
| SA16800 | 92 | 59.2 | .1 | 31 | 20 | 57.4 | -- |
| D SA04880 | 89 | 93.8 | .2 | 26 | 19 | 61.5 | -- |
| D SA04892 | 39 | 66.4 | .2 | 31 | 16 | 47.0 | -- |
| D SA15334 | 30 | 184 | .4 | 13 | 17 | 31.0 | -- |
| D SA16796 | 14 | 8.0 | <.1 | 8 | 18 | 26.7 | -- |

D - QUALITY CONTROL DUPLICATE

| SAMPLE \ % | SiO2 | Al2O3 | CaO | MgO | Na2O | K2O | Fe2O3 | MnO | TiO2 | P2O5 | CR2O3 | LOI | SUM |
|------------|------|-------|------|------|------|------|-------|-----|------|------|-------|------|-------|
| SA04880 | 47.3 | 14.4 | 10.2 | 7.82 | 2.06 | .51 | 12.1 | .20 | .874 | .08 | .04 | 4.30 | 99.9 |
| SA04881 | 46.4 | 12.1 | 5.55 | 14.8 | 2.43 | .35 | 11.6 | .27 | .629 | .28 | .20 | 5.10 | 99.7 |
| SA04882 | 49.0 | 15.3 | 5.78 | 5.69 | 3.36 | 1.77 | 14.2 | .32 | 1.26 | .11 | .02 | 3.20 | 100.2 |
| SA04883 | 52.4 | 13.8 | 6.36 | 5.80 | 4.06 | .79 | 12.1 | .32 | .945 | .08 | .02 | 2.60 | 99.3 |
| SA04884 | 49.6 | 13.2 | 7.79 | 5.94 | 2.90 | 1.16 | 15.2 | .38 | .968 | .08 | .02 | 2.75 | 100.1 |
| SA04885 | 50.5 | 13.5 | 6.77 | 6.36 | 3.57 | .65 | 14.3 | .22 | 1.14 | .10 | .02 | 2.70 | 99.9 |
| SA04886 | 45.6 | 13.1 | 9.65 | 6.42 | 1.79 | .26 | 16.2 | .33 | 1.05 | .09 | .03 | 5.50 | 100.0 |
| SA04887 | 48.7 | 13.8 | 8.13 | 4.52 | 3.01 | 1.10 | 14.6 | .49 | 1.02 | .09 | .02 | 4.90 | 100.5 |
| SA04888 | 47.5 | 14.2 | 9.49 | 4.75 | 2.66 | .31 | 13.6 | .33 | 1.05 | .09 | .03 | 6.25 | 100.3 |
| SA04889 | 46.5 | 13.6 | 8.00 | 3.74 | 1.95 | .88 | 14.8 | .44 | 1.02 | .08 | .01 | 8.70 | 99.7 |
| SA04890 | 53.5 | 15.0 | 6.08 | 4.78 | 4.10 | .79 | 10.9 | .22 | 1.45 | .12 | .02 | 2.20 | 99.2 |
| SA04891 | 48.0 | 13.9 | 8.18 | 3.94 | 3.57 | .18 | 12.5 | .25 | 1.35 | .12 | .01 | 8.25 | 100.3 |
| SA04892 | 52.9 | 14.2 | 9.95 | 3.76 | 1.72 | .24 | 12.9 | .23 | 1.33 | .12 | .03 | 2.65 | 100.1 |
| SA04893 | 50.0 | 14.0 | 7.62 | 5.27 | 2.88 | .21 | 14.3 | .29 | 1.36 | .12 | <.01 | 3.70 | 99.8 |
| SA04894 | 49.9 | 15.4 | 8.59 | 3.58 | 2.25 | .63 | 13.7 | .26 | 1.55 | .14 | .02 | 4.30 | 100.4 |
| SA04895 | 48.4 | 15.4 | 8.98 | 6.57 | 2.82 | .69 | 13.0 | .22 | .991 | .09 | .03 | 2.45 | 99.7 |
| SA04896 | 49.8 | 15.4 | 9.43 | 5.72 | 2.40 | .50 | 11.3 | .21 | 1.12 | .09 | .04 | 2.55 | 98.6 |
| SA04898 | 63.5 | 16.7 | .73 | 1.64 | 1.08 | 7.66 | 4.04 | .05 | .341 | .14 | .01 | 3.60 | 99.8 |
| SA04899 | 68.6 | 16.2 | .44 | 1.44 | 4.85 | 3.07 | 2.78 | .03 | .282 | .17 | .02 | 1.90 | 99.9 |
| SA04900 | 55.2 | 13.9 | 3.01 | 5.07 | 2.09 | 1.08 | 12.8 | .29 | 1.11 | .11 | .03 | 4.85 | 99.6 |
| SA15331 | 48.7 | 14.6 | 8.39 | 7.87 | 2.12 | .67 | 12.8 | .20 | .967 | .09 | .03 | 3.20 | 99.7 |
| SA15332 | 48.0 | 13.8 | 12.0 | 6.32 | 1.73 | 1.09 | 13.7 | .26 | .985 | .09 | .04 | 2.15 | 100.2 |
| SA15333 | 47.3 | 14.7 | 10.5 | 5.53 | 2.65 | .35 | 14.3 | .32 | 1.08 | .10 | .04 | 2.35 | 99.2 |
| SA15334 | 47.0 | 11.9 | 12.4 | 5.73 | .92 | 1.73 | 15.7 | .61 | .876 | .09 | .03 | 2.10 | 99.1 |
| SA16785 | 51.6 | 14.8 | 5.61 | 6.57 | 4.25 | .53 | 10.7 | .25 | 1.09 | .09 | .03 | 4.40 | 99.9 |
| SA16786 | 51.5 | 15.3 | 4.92 | 6.17 | 2.84 | 1.26 | 11.7 | .27 | 1.10 | .11 | .03 | 4.55 | 99.8 |
| SA16787 | 50.9 | 14.9 | 7.30 | 3.61 | 3.28 | .99 | 11.1 | .27 | 1.09 | .10 | .02 | 6.60 | 100.2 |
| SA16788 | 55.5 | 14.1 | 3.04 | 5.05 | 2.09 | 1.08 | 13.1 | .30 | 1.12 | .11 | .03 | 4.65 | 100.2 |
| SA16789 | 47.2 | 13.2 | 8.05 | 4.50 | 2.04 | .47 | 14.7 | .36 | .984 | .08 | .02 | 8.60 | 100.2 |
| SA16790 | 49.6 | 14.9 | 5.08 | 5.42 | 4.35 | .17 | 15.6 | .23 | 1.17 | .10 | .03 | 2.50 | 99.2 |
| SA16791 | 65.4 | 14.8 | 1.57 | 1.70 | 4.31 | 3.85 | 2.69 | .03 | .270 | .16 | .02 | 3.55 | 98.5 |
| SA16792 | 48.0 | 14.8 | 3.22 | 7.13 | 2.43 | 2.41 | 12.5 | .26 | 1.09 | .10 | .02 | 8.20 | 100.2 |
| SA16793 | 46.7 | 15.2 | 6.69 | 5.38 | 1.57 | 1.86 | 13.1 | .29 | 1.10 | .10 | .03 | 6.20 | 98.3 |
| SA16794 | 54.3 | 14.3 | 5.37 | 4.66 | 2.20 | .78 | 12.6 | .26 | 1.04 | .08 | .03 | 4.35 | 100.0 |
| SA16795 | 71.3 | 14.3 | .33 | 1.86 | 1.97 | 5.01 | 3.14 | .04 | .249 | .16 | .02 | 2.05 | 100.6 |
| SA16796 | 66.9 | 15.4 | 1.34 | 1.67 | 5.04 | 3.38 | 2.63 | .03 | .273 | .16 | .03 | 3.15 | 100.2 |
| SA16797 | 51.2 | 14.7 | 6.26 | 5.07 | 4.22 | .40 | 10.9 | .25 | .985 | .09 | .03 | 4.80 | 98.9 |
| SA16798 | 48.3 | 14.4 | 7.13 | 7.98 | 1.63 | .80 | 13.8 | .42 | 1.01 | .09 | .04 | 3.45 | 99.1 |
| SA16799 | 49.1 | 14.7 | 7.62 | 5.60 | 4.38 | .24 | 12.0 | .24 | 1.07 | .09 | .03 | 4.40 | 99.5 |
| SA16800 | 46.2 | 15.9 | 8.09 | 7.28 | 2.47 | .48 | 15.3 | .25 | 1.18 | .10 | .04 | 3.00 | 100.3 |
| D SA04880 | 46.8 | 14.4 | 10.1 | 7.81 | 2.07 | .50 | 12.1 | .20 | .869 | .08 | .04 | 4.45 | 99.4 |
| D SA04893 | 49.9 | 14.0 | 7.59 | 5.24 | 2.87 | .22 | 14.2 | .29 | 1.35 | .12 | <.01 | 3.70 | 99.5 |
| D SA16788 | 55.8 | 14.1 | 3.02 | 5.12 | 2.09 | 1.07 | 13.1 | .30 | 1.12 | .11 | .03 | 4.85 | 100.7 |

D - QUALITY CONTROL DUPLICATE

XRF W.R.A. SUMS INCLUDE ALL ELEMENTS DETERMINED. FOR SUMMATION, ELEMENTS ARE CALCULATED AS OXIDES

| SAMPLE \ PPM | RB | Y | ZR | BA |
|--------------|-----|-----|-----|------|
| SA04880 | <10 | 24 | 52 | 151 |
| SA04881 | <10 | <10 | 70 | 156 |
| SA04882 | 48 | 17 | 75 | 1340 |
| SA04883 | <10 | 23 | 51 | 374 |
| SA04884 | 10 | 17 | 58 | 520 |
| SA04885 | 11 | 21 | 68 | 275 |
| SA04886 | <10 | 18 | 55 | 93 |
| SA04887 | 24 | 13 | 61 | 586 |
| SA04888 | 11 | 15 | 51 | 130 |
| SA04889 | 22 | <10 | 61 | 121 |
| SA04890 | 30 | 19 | 89 | 275 |
| SA04891 | 26 | 15 | 86 | 60 |
| SA04892 | <10 | 31 | 89 | 104 |
| SA04893 | 13 | 19 | 87 | 107 |
| SA04894 | <10 | 17 | 101 | 212 |
| SA04895 | 27 | <10 | 55 | 159 |
| SA04896 | 12 | 24 | 59 | 167 |
| SA04898 | 289 | <10 | 169 | 2110 |
| SA04899 | 86 | <10 | 124 | 1020 |
| SA04900 | <10 | 11 | 57 | 159 |
| SA15331 | 19 | 14 | 71 | 112 |
| SA15332 | 21 | 21 | 52 | 183 |
| SA15333 | <10 | <10 | 50 | 109 |
| SA15334 | 30 | <10 | 48 | 343 |
| SA16785 | 15 | <10 | 66 | 113 |
| SA16786 | 14 | 26 | 61 | 167 |
| SA16787 | 33 | 28 | 56 | 324 |
| SA16788 | 13 | <10 | 68 | 151 |
| SA16789 | <10 | <10 | 53 | 112 |
| SA16790 | <10 | 21 | 65 | 117 |
| SA16791 | 89 | <10 | 117 | 1260 |
| SA16792 | 22 | <10 | 57 | 485 |
| SA16793 | 41 | <10 | 65 | 302 |
| SA16794 | 17 | 11 | 51 | 331 |
| SA16795 | 158 | 18 | 110 | 1200 |
| SA16796 | 79 | <10 | 125 | 1270 |
| SA16797 | <10 | 19 | 59 | 118 |
| SA16798 | 48 | <10 | 54 | 233 |
| SA16799 | 15 | 31 | 71 | 96 |
| SA16800 | 18 | 17 | 63 | 123 |
| D SA04880 | <10 | 38 | 30 | 160 |
| D SA04893 | <10 | 16 | 92 | 123 |
| D SA16788 | 21 | 12 | 73 | 170 |

D - QUALITY CONTROL DUPLICATE

XRAL

X-RAY ASSAY LABORATORIES

A DIVISION OF SGS CANADA INC.

1885 LESLIE STREET
TEL: (416)445-5755

DON MILLS, ONTARIO M3B 3J4
TELEX: 06-986947

CANADA
FAX: (416)445-4152

CERTIFICATE OF ANALYSIS REPORT 24040

TO: FALCONBRIDGE LIMITED
ATTN: JAMIE CECCHETTO
1977 MCKENZIE ROAD
GENERAL DELIVERY RR#2
CHELMSFORD, ONTARIO POM 1L0

CUSTOMER No. 233

DATE SUBMITTED
24-Aug-93

REF. FILE 15860-D3

Total Pages 3

8 ROCKS Proj. FIRST BROOK E 6-270

| | METHOD | DETECTION LIMIT |
|-----------|--------|-----------------|
| AU PPB | FAAA | 5. |
| WRMAJ % | XRF-F | .01 |
| CO PPM | ICP | 1. |
| NI PPM | ICP | 1. |
| CU PPM | ICP | .5 |
| ZN PPM | ICP | .5 |
| WRMIN PPM | XRF-F | 10. |
| AG PPM | ICP | .1 |

DATE 14-Sep-93

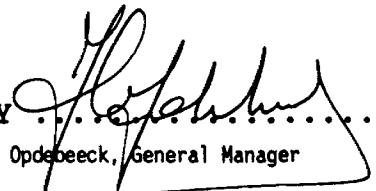
CERTIFIED BY 
Jean H.L. Opdebeeck, General Manager

| SAMPLE | AU PPB | CO PPM | NI PPM | CU PPM | ZN PPM | AG PPM |
|-----------|--------|--------|--------|--------|--------|--------|
| SA22951 | 20 | 52 | 57 | 257 | 147 | <.1 |
| SA22952 | 24 | 55 | 49 | 87.6 | 74.6 | <.1 |
| SA22953 | 10 | 48 | 101 | 86.7 | 75.6 | <.1 |
| SA22954 | 14 | 48 | 109 | 137 | 62.0 | <.1 |
| SA22955 | 12 | 30 | 62 | 54.4 | 44.2 | <.1 |
| SA22956 | 10 | 6 | 10 | 10.4 | 9.4 | .1 |
| SA22957 | 8 | 42 | 47 | 70.8 | 57.1 | <.1 |
| SA22958 | 18 | 52 | 51 | 85.4 | 144 | <.1 |
| D SA22951 | 18 | 53 | 61 | 264 | 150 | <.1 |

D - QUALITY CONTROL DUPLICATE

| SAMPLE \ % | SiO2 | Al2O3 | CaO | MgO | Na2O | K2O | Fe2O3 | MnO | TiO2 | P2O5 | Cr2O3 | LOI | SUM |
|------------|------|-------|------|------|------|------|-------|-----|------|------|-------|------|------|
| SA22951 | 56.8 | 14.5 | 6.48 | 3.40 | 4.64 | .55 | 7.28 | .14 | 1.30 | .11 | .01 | 4.10 | 99.3 |
| SA22952 | 53.3 | 14.5 | 8.20 | 3.90 | 1.86 | .35 | 12.4 | .24 | 1.37 | .12 | .01 | 3.30 | 99.6 |
| SA22953 | 47.8 | 16.4 | 7.46 | 6.18 | 2.77 | .95 | 11.4 | .28 | 1.17 | .10 | .04 | 4.75 | 99.3 |
| SA22954 | 50.6 | 16.5 | 6.43 | 6.58 | 2.43 | 1.70 | 10.2 | .22 | 1.16 | .10 | .04 | 3.45 | 99.5 |
| SA22955 | 48.9 | 15.6 | 8.03 | 5.88 | 3.63 | .71 | 11.6 | .23 | 1.19 | .10 | .04 | 3.10 | 99.0 |
| SA22956 | 74.9 | 12.7 | .32 | .94 | 2.49 | 3.16 | 2.44 | .04 | .186 | .06 | .02 | 2.10 | 99.5 |
| SA22957 | 56.4 | 14.0 | 6.12 | 3.53 | 3.53 | .99 | 10.4 | .21 | 1.30 | .11 | .01 | 2.95 | 99.6 |
| SA22958 | 51.3 | 14.4 | 7.74 | 3.51 | 3.98 | .36 | 11.4 | .24 | 1.38 | .12 | .01 | 4.55 | 99.0 |
| D SA22951 | 56.6 | 14.5 | 6.50 | 3.43 | 4.65 | .55 | 7.29 | .14 | 1.29 | .11 | .01 | 4.15 | 99.3 |

D - QUALITY CONTROL DUPLICATE

XRF W.R.A. SUMS INCLUDE ALL ELEMENTS DETERMINED. FOR SUMMATION, ELEMENTS ARE CALCULATED AS OXIDES

| SAMPLE \ PPM | RB | Y | ZR | BA |
|--------------|-----|-----|-----|-----|
| SA22951 | 20 | 29 | 67 | 121 |
| SA22952 | 10 | 11 | 90 | 183 |
| SA22953 | 36 | 22 | 71 | 217 |
| SA22954 | 46 | <10 | 56 | 603 |
| SA22955 | 24 | <10 | 62 | 131 |
| SA22956 | 135 | <10 | 107 | 976 |
| SA22957 | 25 | 22 | 85 | 458 |
| SA22958 | <10 | 22 | 88 | 156 |
| D SA22951 | 19 | 25 | 67 | 131 |

D - QUALITY CONTROL DUPLICATE

APPENDIX III - Statement of Qualifications

STATEMENT OF QUALIFICATIONS

I, David P. Money, of Sudbury, Ontario certify that:

1. I am a Project Geologist employed by Falconbridge Limited (Exploration), R. R. #2, 1977 McKenzie Road, Chelmsford, Ontario, P0M 1L0
2. I have been employed by Falconbridge as a geologist for six years.
3. I graduated from the University of Toronto in 1987 with a B. A. Sc. in Geological Engineering and from Queen's University in 1992 with an M. Sc. in Mineral Exploration.
4. I am a licensed Professional Engineer in the Province of Ontario.
5. I conducted the geological survey described in this report.

Dated at Chelmsford, Ontario this 14th day of October, 1993.

David P. Money

David P. Money, P. Eng.





31M05NE9710 2.15180 BUCKE

900

Ministry of
Northern Development
and Mines

Ministère du
Développement du Nord
et des Mines

Geoscience Approvals Section
933 Ramsey Lake Road
6th Floor
Sudbury, Ontario
P3E 6B5

Telephone: (705) 670-5853
Fax: (705) 670-5863

January 18, 1994

Our File: 2.15180
Transaction #: W9380.00261

Mining Recorder
Ministry of Northern
Development and Mines
4 Government Road East
Kirkland Lake, Ontario
P2N 1A2

Dear Sir/Madam:

**Subject: APPROVAL OF ASSESSMENT WORK CREDITS ON MINING CLAIMS
L1179115 ET AL IN BUCKE TOWNSHIP**

The assessment work credits for Geology filed under Section 12 of the Mining Act Regulations have been approved as outlined in the original submission.

The approval date is January 17, 1994.

If you have any questions regarding this correspondence, please contact Lucille Jerome at (705) 670-5855.

Yours sincerely,

Ron C. Gashinski
Senior Manager, Mining Lands
Mines and Minerals Division

LJ/ljs

cc: Resident Geologist
Cobalt, Ontario

✓ Assessment Files Library
Toronto, Ontario



Ontario

Ministry of
Northern Development
and MinesReport of Work Conducted
After Recording Claim

Mining Act

Transaction Number

W9380.00261

Personal information collected on this form is obtained under the authority of the Mining Act. This information will be used for correspondence. Questions about this collection should be directed to the Provincial Manager, Mining Lands, Ministry of Northern Development and Mines, Fourth Floor, 150 Cedar Street, Sudbury, Ontario, P3E 6A5, telephone (705) 670-7264.

- Instructions:
- Please type or print and submit in duplicate.
 - Refer to the Mining Act and Regulations for requirements of filing assessment work or consult the Mining Recorder.
 - A separate copy of this form must be completed for each Work Group.
 - Technical reports and maps must accompany this form in duplicate.
 - A sketch, showing the claims the work is assigned to, must accompany this form.

2.15180

| | | | |
|---------------------|---|-----------------|-----------------|
| Recorded Holder(s) | Falconbridge Limited | Client No. | 130679 |
| Address | Suite 1200, 95 Wellington St. W. Toronto, ON M5J2W4 | Telephone No. | (416) 956-5757 |
| Mining Division | Larder Lake | Township/Area | Bucke |
| | | M or G Plan No. | G-3413 |
| Date Work Performed | From: July 21, 1993 | To: | October 8, 1993 |

Work Performed (Check One Work Group Only)

| Work Group | Type |
|--|---------|
| <input checked="" type="checkbox"/> Geotechnical Survey | Geology |
| <input type="checkbox"/> Physical Work, including Drilling | |
| <input type="checkbox"/> Rehabilitation | |
| <input type="checkbox"/> Other Authorized Work | |
| <input type="checkbox"/> Assays | |
| <input type="checkbox"/> Assignment from Reserve | |

Total Assessment Work Claimed on the Attached Statement of Costs \$ 4243.50

Note: The Minister may reject for assessment work credit all or part of the assessment work submitted if the recorded holder cannot verify expenditures claimed in the statement of costs within 30 days of a request for verification.

Persons and Survey Company Who Performed the Work (Give Name and Address of Author of Report)

| Name | Address |
|---|---|
| David P. Money Falconbridge Ltd. (Exploration) | RR#2, 1977 McKenzie Road Chelmsford, Ontario P0M 1L0 |
| | |
| | |
| | |

(attach a schedule if necessary)

Certification of Beneficial Interest * See Note No. 1 on reverse side

| | | |
|--|------------------|--------------------------------------|
| I certify that at the time the work was performed, the claims covered in this work report were recorded in the current holder's name or held under a beneficial interest by the current recorded holder. | Date | Recorded Holder or Agent (Signature) |
| | October 14, 1993 | David P. Money David P. Money |

Certification of Work Report

| | | |
|---|------------------|----------------------------------|
| I certify that I have a personal knowledge of the facts set forth in this Work report, having performed the work or witnessed same during and/or after its completion and annexed report is true. | | |
| Name and Address of Person Certifying | | |
| David P. Money, Project Geologist, Falconbridge Ltd. (Exploration) RR#2, 1977 McKenzie Road, Chelmsford, ON P0M 1L0 | | |
| Telephone No. | Date | Certified By (Signature) |
| (705) 855-0311 | October 14, 1993 | David P. Money David P. Money |

For Office Use Only

| | | | |
|--------------------------|---------------------------------|-----------------|-------------------|
| Total Value Cr. Recorded | Date Recorded | Mining Recorder | Received Stamp |
| \$ 4244 | OCTOBER 19/93 | | |
| | Deemed Approval Date | Date Approved | |
| | JANUARY 17/94 | | |
| | Date Notice for Amendments Sent | | |
| | | | 93 OCT 19 AM 9 21 |

[illegible]

5 skins - 9 units

| Value of Assessment Work Done on this Claim | Value Applied to the Claim |
|--|-------------------------------------|
| \$ 400.00 | \$ 400.00 |
| \$ 400.00 | \$ 400.00 |
| \$ 1200.00 | \$ 800.00 |
| \$ 1844.50 | \$ 2244.50 |
| \$ 400.00 | \$ 400.00 |
| | |
| | |
| | |
| | |
| | |
| | |
| | |
| | |
| | |
| 4244.50 | 4244.50 |

Total Value Work Done

**Total Value
Work Applied**

[illegible]**Total Assigned From****Total Reserves**

Credits you are claiming in this report may be cut back. In order to minimize the adverse effects of such deletions, please indicate from which claims you wish to prioritize the deletion of credits. Please mark (✓) one of the following:

1. ☐ Credits are to be cut back starting with the claim listed last, working backwards.
2. ☐ Credits are to be cut back equally over all claims contained in this report of work.
3. ☐ Credits are to be cut back as prioritized on the attached appendix.

In the event that you have not specified your choice of priority, option one will be implemented.

Note 1: Examples of beneficial interest are unrecorded transfers, option agreements, memorandum of agreements, etc., with respect to the mining claims.

Note 2: If work has been performed on patented or leased land, please complete the following:

I certify that the recorded holder had a beneficial interest in the patented or leased land at the time the work was performed

Signature _____

Date



Ministry of
Northern Development
and Mines

Ministère du
Développement du Nord
et des mines

Statement of Costs
for Assessment Credit

État des coûts aux fins
du crédit d'évaluation

Mining Act/Loi sur les mines

Transaction No./N° de transaction

W9380.00261

Personal information collected on this form is obtained under the authority of the Mining Act. This information will be used to maintain a record and ongoing status of the mining claim(s). Questions about this collection should be directed to the Provincial Manager, Minings Lands, Ministry of Northern Development and Mines, 4th Floor, 159 Cedar Street, Sudbury, Ontario P3E 6A5, telephone (705) 670-7264.

Les renseignements personnels contenus dans la présente formule sont recueillis en vertu de la Loi sur les mines et serviront à tenir à jour un registre des concessions minières. Adresser toute question sur la collecte de ces renseignements au chef provincial des terrains miniers, ministère du Développement du Nord et des Mines, 159, rue Cedar, 4^e étage, Sudbury (Ontario) P3E 6A5, téléphone (705) 670-7264.

1. Direct Costs/Coûts directs

| Type | Description | Amount Montant | Totals Total global |
|---|---|-------------------|------------------------|
| Wages Salaires | Labour Main-d'oeuvre | 2349.75 | |
| | Field Supervision Supervision sur le terrain | | 2349.75 |
| Contractor's and Consultant's Fees Droits de l'entrepreneur et de l'expert- conseil | Type Analyses (XRAL) | 1036.50 | |
| | | | |
| | | | 1036.50 |
| Supplies Used Fournitures utilisées | Type | | |
| | | | |
| | | | |
| Equipment Rental Location de matériel | Type Truck Rental | 150.00 | |
| | | | |
| | | | 150.00 |
| Total Direct Costs Total des coûts directs | | | 3536.25 |

2. Indirect Costs/Coûts indirects

** Note: When claiming Rehabilitation work Indirect costs are not allowable as assessment work.
Pour le remboursement des travaux de réhabilitation, les coûts indirects ne sont pas admissibles en tant que travaux d'évaluation.

| Type | Description | Amount Montant | Totals Total global |
|---|---|-------------------|------------------------|
| Transportation Transport | Type Truck (1 day) | 30.00 | |
| | | | |
| | | | |
| | | | 30.00 |
| Food and Lodging Nourriture et hébergement | | 360.00 | 360.00 |
| Mobilization and Demobilization Mobilisation et démobilisation | Wages D. Money 1 Day N. Wiebe 1 Day | 364.25 | 364.25 |
| | | | |
| Sub Total of Indirect Costs Total partiel des coûts indirects | | | 754.25 |
| Amount Allowable (not greater than 20% of Direct Costs) Montant admissible (n'excédant pas 20 % des coûts directs) | | | 707.25 |
| Total Value of Assessment Credit (Total of Direct and Allowable Indirect costs) | | | 4243.50 |
| Valeur totale du crédit d'évaluation (Total des coûts directs et indirects admissibles) | | | |

Note: The recorded holder will be required to verify expenditures claimed in this statement of costs within 30 days of a request for verification. If verification is not made, the Minister may reject for assessment work all or part of the assessment work submitted.

Note : Le titulaire enregistré sera tenu de vérifier les dépenses demandées dans le présent état des coûts dans les 30 jours suivant une demande à cet effet. Si la vérification n'est pas effectuée, le ministre peut rejeter tout ou une partie des travaux d'évaluation présentés.

Filing Discounts

- Work filed within two years of completion is claimed at 100% of the above Total Value of Assessment Credit.
- Work filed three, four or five years after completion is claimed at 50% of the above Total Value of Assessment Credit. See calculations below:

| | |
|----------------------------------|--------------------------|
| Total Value of Assessment Credit | Total Assessment Claimed |
| x 0.50 = | |

Remises pour dépôt

- Les travaux déposés dans les deux ans suivant leur achèvement sont remboursés à 100 % de la valeur totale susmentionnée du crédit d'évaluation.
- Les travaux déposés trois, quatre ou cinq ans après leur achèvement sont remboursés à 50 % de la valeur totale du crédit d'évaluation susmentionné. Voir les calculs ci-dessous.

| | |
|--------------------------------------|----------------------------|
| Valeur totale du crédit d'évaluation | Evaluation totale demandée |
| x 0,50 = | |

Certification Verifying Statement of Costs

I hereby certify:
that the amounts shown are as accurate as possible and these costs were incurred while conducting assessment work on the lands shown on the accompanying Report of Work form.

that as Project Geologist I am authorized
(Recorded Holder, Agent, Position in Company)

to make this certification

Attestation de l'état des coûts

J'atteste par la présente :
que les montants indiqués sont le plus exact possible et que ces dépenses ont été engagées pour effectuer les travaux d'évaluation sur les terrains indiqués dans la formule de rapport de travail ci-joint.

Et qu'à titre de _____ je suis autorisé
(titulaire enregistré, représentant, poste occupé dans la compagnie)

à faire cette attestation.

| | |
|---|--------------------|
| Signature <u>David P. Money</u> <u>David P. Money</u> | Date Oct. 14/93 |
|---|--------------------|

2671

RF107 O.C.

BUCKE TWP.

1:20,000

FARR ISLAND

LORRAIN TOWNSHIP

13

14

15

Creek

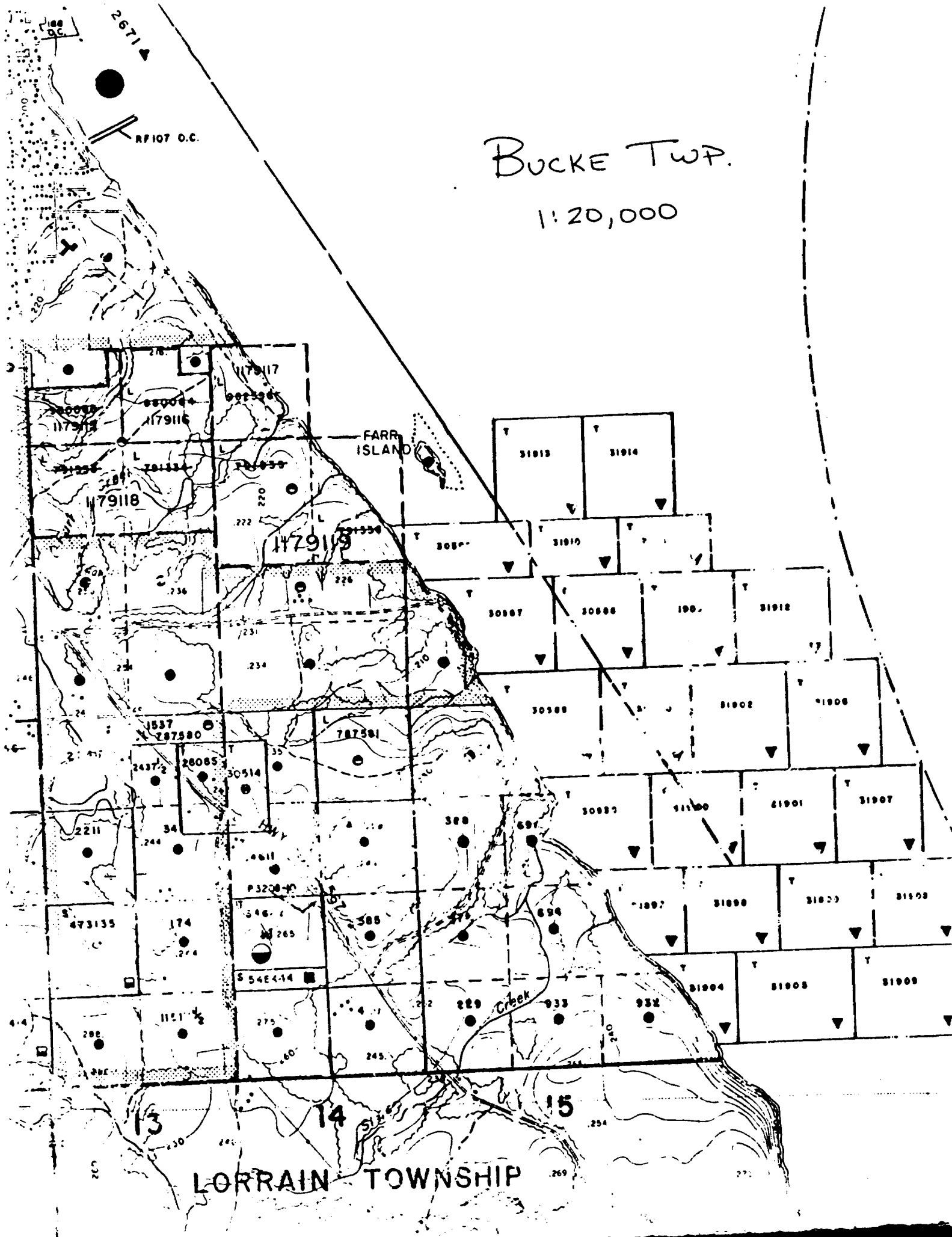

INDEX TO LAND DISPOSITION

PLAN
G - 3413
TOWNSHIP
BUCKE
GEOLOGY PERENCE COBALT RESIDENT GEOLOGIST

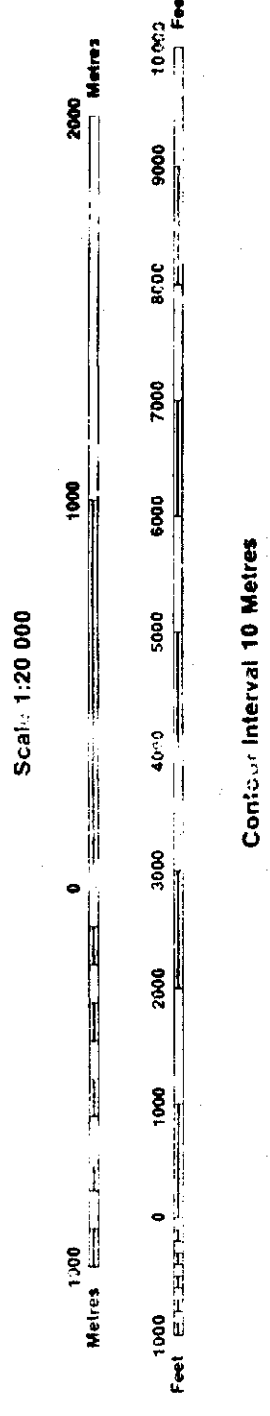

AREAS WITHDRAWN FROM DISPOSITION
MRO - Mining Rights Only
SRO - Surface Rights Only
M + S - Mining and Surface Rights

Description Order No. Date Disposition File

SYMBOLS

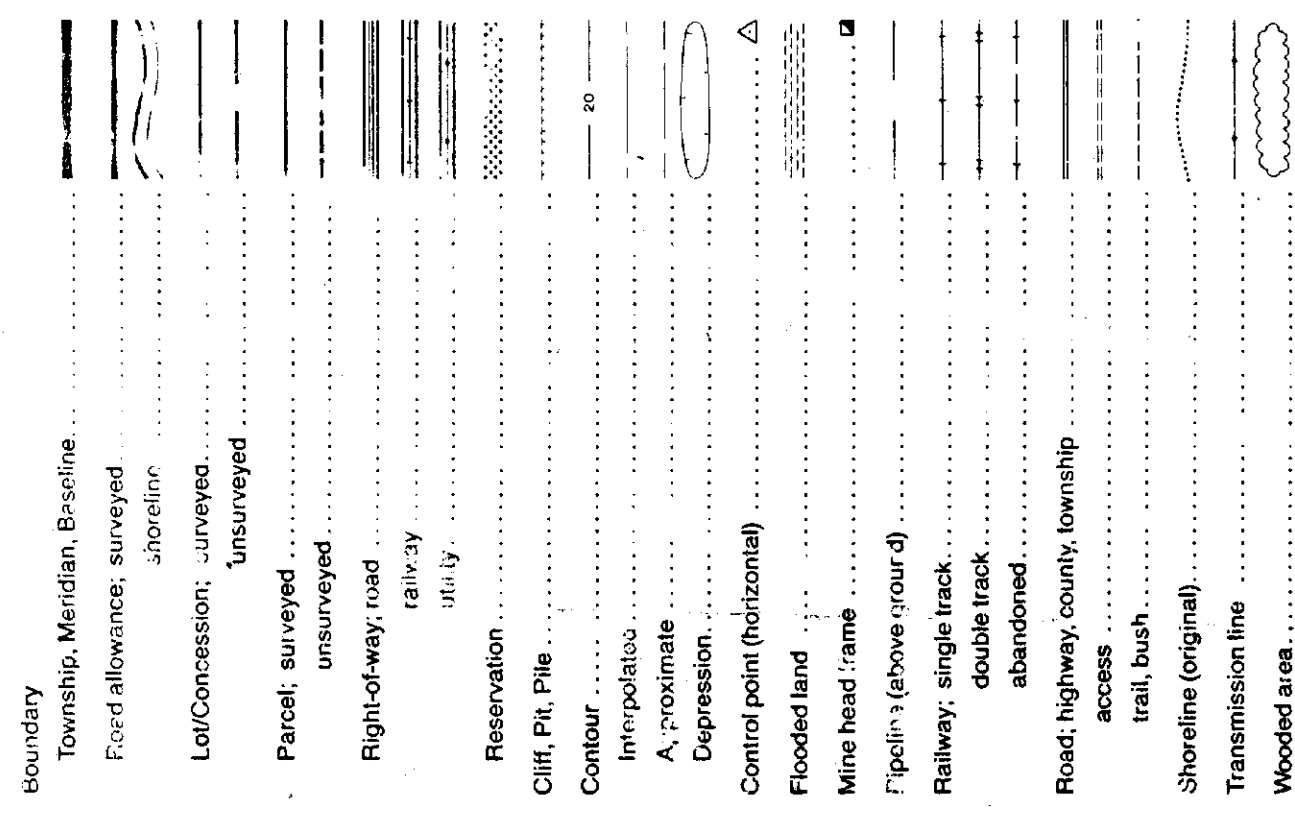

DISPOSITION OF CROWN LANDS

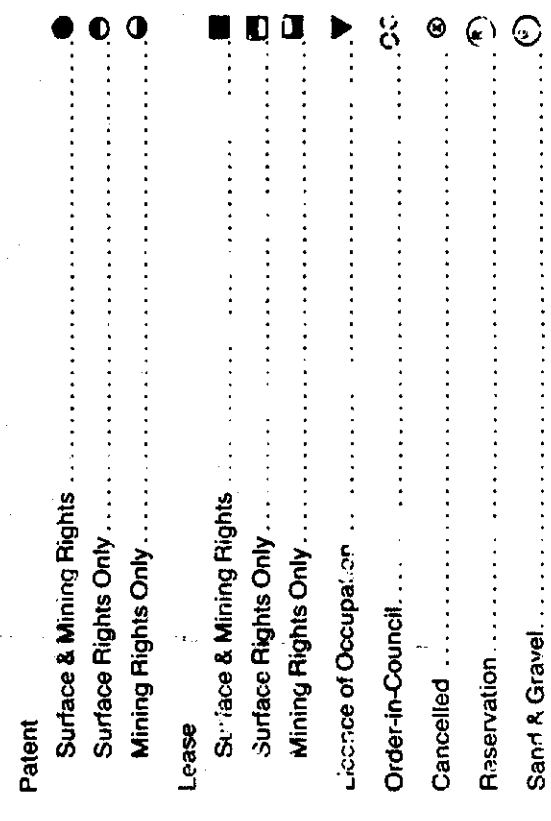

NOTES

FLOODING... ELEVATION 195' ABOVE ST. LEVEL IN LAKE...
NORTH HALL LOT 6 CON 2, SUBJECT TO BATHURST CONTINGENT, OF...
STAKES OF MINES CLAIMS WITHIN TOWNSHIP SHOWN THIS...
ONLY WITHIN CONCENT OF THE MINER.

Surface Rights withdrawn under Sec. 36
The Mining Act R.S.C. 1960, Chapter NO. W-21 (1960)
From Canada Patent Right of Key and Buffer
Zone approximately 4023 meters or 132 ft. on
either side of centre line of right of way

DATE OF ISSUE

OCT 19 1983

MINING RECORDER'S OFFICE

THE INFORMATION THAT
HAS BEEN COMPILED
FROM VARIOUS SOURCES
IS GUARANTEED TO BE
WORTH TO STATE MIN-
ING CLAIMS AND THE MIN-
ING RECORD, MINISTRY OF
NORTHERN DEVELOPMENT
AND MINES, CANADA, ON
THE STATUS OF THE
LANDS SHOWN HEREON.

CIRCULATED APRIL 27/88

Map base and land disposition drafted by: [Name] and [Name]
Branch, Ministry of Natural Resources

200

