



REPORT ON D.D..

BENNER PROPERTY - COBALI AREA

OPAP - File No. OP 90002

D.D.E. RB 90-1 was started June 28 and completed at a depth of 527.0' on July 5th - 1990. (See location map)

The purpose of the drill hole was to test a geological structure under MacLaren lake for silver values.

The location and attitude of the drill hole was arrived at by correlating results of previous exploration (Diamond Drilling & Geophysical).

The target, Ideally, was the intersection of an easterly striking EM-16 anomaly with Huronian conglomerates, in an area where the conglomerates rest on the upper contact of the Nipissing Diabase sill.

Hole RB 90-1, after encountering 72.0' of overburden, cut 430.0' of Huronian sediments (320.0' of greywacke & 118.0' of conglomerates.) before entering Keewatin lavas at 510.0'. The hole was stopped at 527.0'.

Strong spotted chloritic alteration occurs in the conglomerates.

Scattered mineralization, chalcopyrite and a bluish mineral, extends for over 50' in the bottom part of the conglomerate bed and extends into the Keewatin lavas. The bluish mineral has not been identified as yet, but does not contain silver..

The strong chloritic alteration in the conglomerates suggests that the Nipissing diabase contact could be very close.

There was no positive sign of the EM-16 conductor.

The results obtained from this drill hole are encouraging, and certainly add to the worth of the property.

Further drilling is warranted but will be best carried out from the frozen surface of MacLaren lake.

Leo Owsiki, Resident Geologist, assisted greatly in carrying out this project..

The drill core is stored at the Department of Mines core Library under the care of Leo Owsiki.

*Ralph I. Benner*  
Ralph I. Benner, P. Eng.

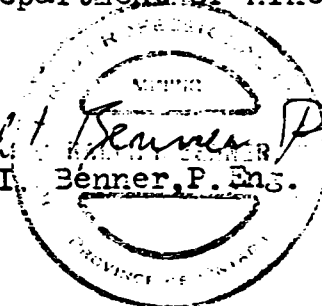



LOT 9

LOT 8

Ⓛ  
789084

FIRSTBROOK TWP.

D.D.H. RB-90-1

Conc.1

COLEMAN TWP.

MCLAREN LAKE

789085

LOCATION - DRILL HOLE RB 90-1

Scale One Inch = Four Hundred feet

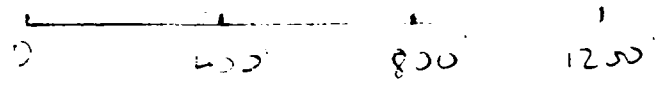

*Ralph I. Renner, Eng*

RIB JLY '90

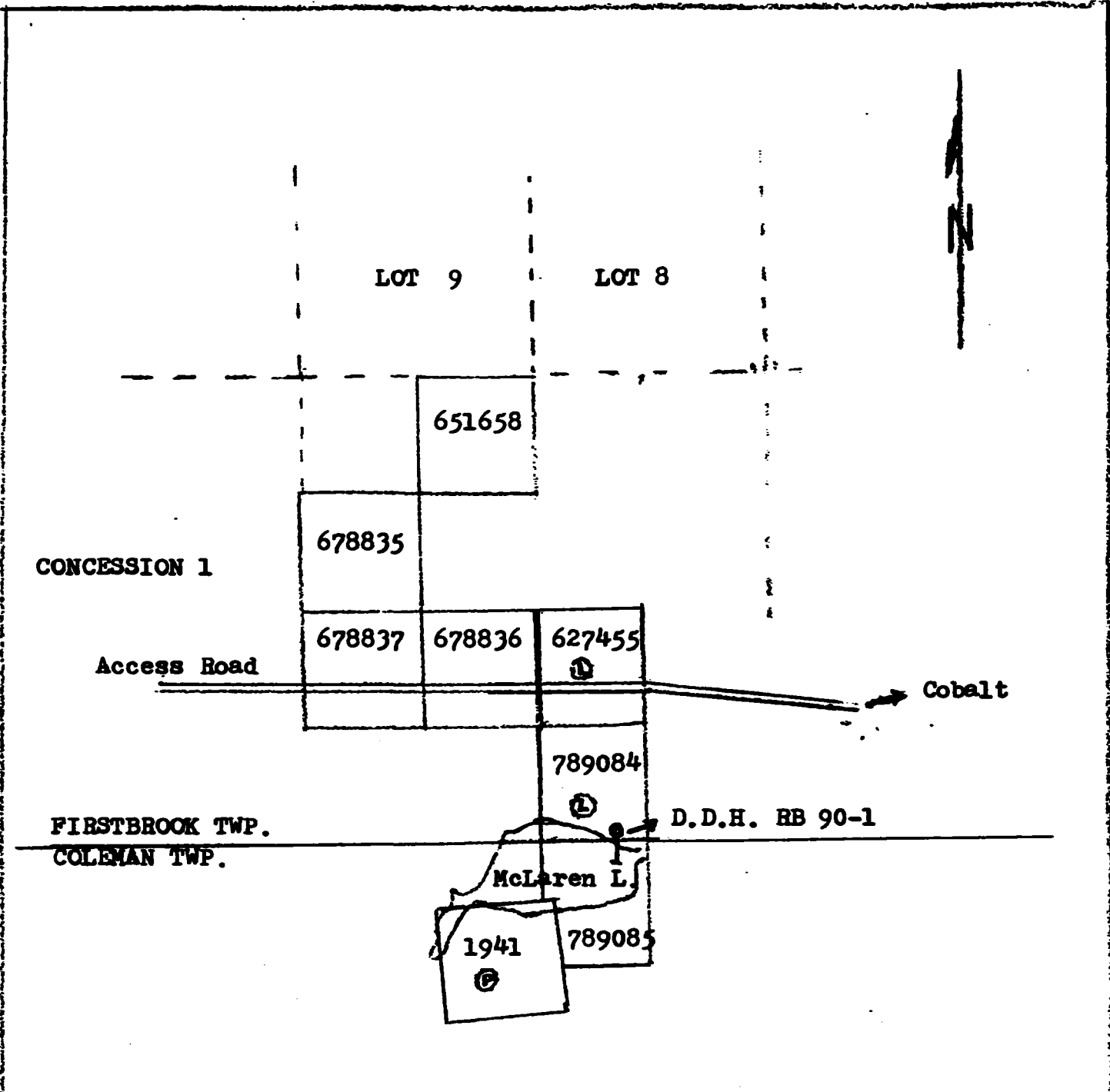

SKETCH SHOWING LOCATION OF BENNER CLAIMS  
 FIRSTBROOK AND COLEMAN TOWNSHIPS  
 LARDER LAKE MINING DIVISION  
 RE WORK RECORDING, AUGUST 1994

Scale: 1" = 1650'

*Ralph L. Benner P. Eng*

RIB Aug. 1944

180°

45°

MacLaren Lake

overburden

Section - D.D.H. RB 90-1

527.0°

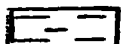

Huronian Greywacke

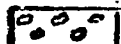

Huronian Conglomerates



Keewatin Lavas

SCALE: 1 inch = fifty feet

*Ralph L. Beemer P. Eng*

R.L.B. JULY '90







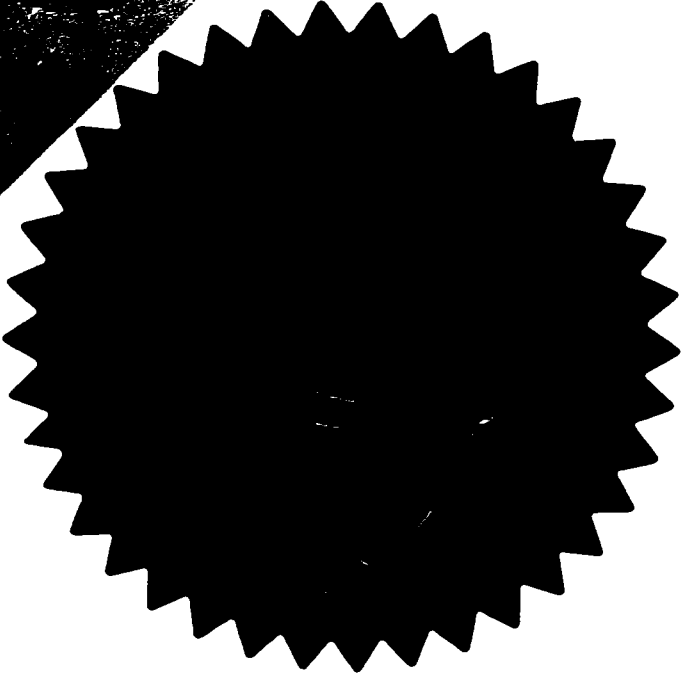

*R. H. G. G.*

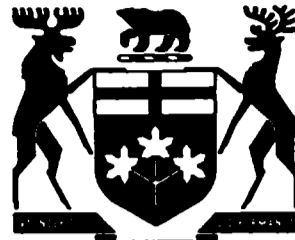

Ontario

## Province of Ontario

**Elizabeth the Second, by the  
Grace of God of the United Kingdom,  
Canada and Her other Realms and  
Territories Queen, Head of the  
Commonwealth, Defender of the Faith.**

**To all to whom these Presents shall  
Come, Greeting:**

KNOW YE that under the MINING ACT and the regulations and subject to the limitations thereof, and in consideration of the rents, conditions and provisions hereinafter reserved and contained, WE, hereinafter referred to as the "Lessor", by these Presents do demise and lease unto

**RALPH ISSAC BENNER, hereinafter called the  
"Lessee", his heirs, executors, administrators  
and assigns.**

the mines, ores, minerals and mining rights in, upon and under ALL those Parcels or Tracts of Land more particularly described in the attached Schedule, hereinafter referred to as the "premises".

Together with all and singular the easements, advantages and appurtenances, which are now or at any time during the term hereby granted, may be held, occupied or enjoyed therewith for the purpose of mining upon and under the said lands; and also with full power, subject to the reservations hereinafter contained, to the said Lessee and his contractors, agents and workmen to dig, sink, drive, bore, make and use excavations, pits, shafts, levels, drifts, tunnels, wells, water-courses and other works for winning, raising and removing the mines, ores and minerals in or on or under the said lands.

TO HAVE and TO HOLD the said demised premises for and during the term of twenty-one years, commencing on the first day of August one thousand nine hundred and eighty-eight and from thenceforth next ensuing and fully to be complete and ended.



SCHEDULE

All those parcels or tracts of land and land under water in the Township of Firstbrook, in the Territorial District of Timiskaming and Province of Ontario, containing 568.25 acres, be the same more or less, being composed of those parts of the said township more particularly described as follows:

FIRSTLY:

Mining claims S 612757, S 627454, S 627455, S 627456, S627457, S 627609, S 789082 and S 789084, containing 326 acres, be the same more or less, being composed of Lot 8, Concession I, in the said township.

SECONDLY:

Mining claims S 612754, S 612755, S 612756, S 627453, S 647695, S 647696, containing 242.25 acres, be the same more or less, being composed of the south three-quarters of Lot 7, Concession I, in the said township.

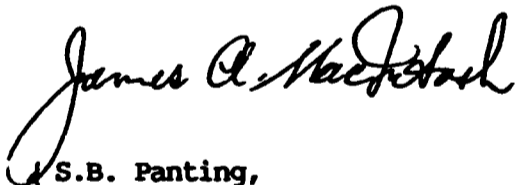

S.B. Panting,  
Surveyor General

23-Jun-1988

- MINING RIGHTS ONLY

JAM/s4



**Report of Work Conducted  
After Recording Claim**

Mining Act

Transaction Number  
**W9480.00412**

Personal information collected on this form is obtained under the authority of this collection should be directed to the Provincial Manager, Mining Lands, Sudbury, Ontario, P3E 6A5, telephone (705) 670-7264.

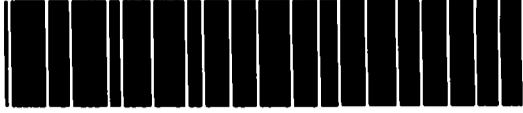

31M05NW0033 W9480.00412 FIRSTBROOK

900

- Instructions:
- Please type or print and submit in duplicate
  - Refer to the Mining Act and Regulations for Recorder.
  - A separate copy of this form must be completed for each Work Group.
  - Technical reports and maps must accompany this form in duplicate.
  - A sketch, showing the claims the work is assigned to, must accompany this form.

Recorded Holder(s) <b>RALPH I. BENNER</b>		Client No. <b>213 345</b>
Address <b>8 LOMOND DR. APT. 1707, TORONTO, ONT. M8X2W3</b>		Telephone No. <b>416-231-5975</b>
Mining Division <b>LARDER LAKE</b>	Township/Area <b>FIRSTBROOK-COLEMAN</b>	M or G Plan No. <b>G 3427</b>
Date Work Performed	From: <b>JUNE 27, 1990</b>	To: <b>JULY 5, 1990</b>

Work Performed (Check One Work Group Only)

Work Group	Type
Geotechnical Survey	
Physical Work, Including Drilling	<b>DIAMOND DRILLING</b>
Rehabilitation	
Other Authorized Work	
Assays	
Assignment from Reserve	

Total Assessment Work Claimed on the Attached Statement of Costs \$ **5118.**

Note: The Minister may reject for assessment work credit all or part of the assessment work submitted if the recorded holder cannot verify expenditures claimed in the statement of costs within 30 days of a request for verification.

Persons and Survey Company Who Performed the Work (Give Name and Address of Author of Report)

Name	Address
<b>BARRON DIAMOND DRILLING CO.</b>	<b>P.O. BOX 606, HAILEYBURY, ONT. P0T1K0</b>
<b>RALPH BENNER, GEOL.</b>	<b>8 LOMOND DR, APT 1707, TORONTO, ONT. M8X2W3</b>

(attach a schedule if necessary)

Certification of Beneficial Interest \* See Note No. 1 on reverse side

I certify that at the time the work was performed, the claims covered in this work report were recorded in the current holder's name or held under a beneficial interest by the current recorded holder.	Date <b>AUG. 17, 1994</b>	Recorded Holder or Agent (Signature) <b>Ralph I. Benner</b>
--	------------------------------	--

Certification of Work Report

I certify that I have a personal knowledge of the facts set forth in this Work report, having performed the work or witnessed same during and/or after its completion and annexed report is true.		
Name and Address of Person Certifying <b>RALPH I. BENNER, 8 LOMOND DR, APT 1707, TORONTO, ONT. M8X2W3</b>		
Telephone No. <b>416-231-5975</b>	Date <b>AUG. 17, 1994</b>	Certified By (Signature) <b>Ralph I. Benner</b>

For Office Use Only

Total Value Cr. Recorded <b>\$4000.</b> <b>Reserve \$1118.00</b>	Date Recorded <b>Aug. 23/94</b>	Mining Recorder <b>ACTING Randy Stahl</b>	Received Stamp <b>RECEIVED LARDER LAKE MINING DIVISION AUG 23 1994</b>
	Deemed Approval Date <b>Nov. 21/94</b>	Date Approved <b>Sept 27/94.</b>	
	Date Notice for Amendments Sent		



Ministry of  
Northern Development  
and Mines

Ministère du  
Développement du Nord  
et des mines

**Statement of Costs  
for Assessment Credit**

**État des coûts aux fins  
du crédit d'évaluation**

**Mining Act/Loi sur les mines**

Transaction No./N° de transaction

**W9480.00412**

Personal information collected on this form is obtained under the authority of the Mining Act. This information will be used to maintain a record and ongoing status of the mining claim(s). Questions about this collection should be directed to the Provincial Manager, Minings Lands, Ministry of Northern Development and Mines, 4th Floor, 159 Cedar Street, Sudbury, Ontario P3E 6A5, telephone (705) 670-7264.

Les renseignements personnels contenus dans la présente formule sont recueillis en vertu de la Loi sur les mines et serviront à tenir à jour un registre des concessions minières. Adresser toute question sur la collecte de ces renseignements au chef provincial des terrains miniers, ministère du Développement du Nord et des Mines, 159, rue Cedar, 4<sup>e</sup> étage, Sudbury (Ontario) P3E 6A5, téléphone (705) 670-7264.

**1. Direct Costs/Coûts directs**

Type	Description	Amount Montant	Totals Total global
Wages Salaires	Labour Main-d'oeuvre		
	Field Supervision Supervision sur le terrain		\$ 1900.00
Contractor's and Consultant's Fees Droits de l'entrepreneur et de l'expert- conseil	Type		\$ 7280.00
Supplies Used Fournitures utilisées	Type		
Equipment Rental Location de matériel	Type		
<b>Total Direct Costs Total des coûts directs</b>			<b>9180.00</b>

**2. Indirect Costs/Coûts indirects**

\*\* Note: When claiming Rehabilitation work Indirect costs are not allowable as assessment work.  
Pour le remboursement des travaux de réhabilitation, les coûts indirects ne sont pas admissibles en tant que travaux d'évaluation.

Type	Description	Amount Montant	Totals Total global
Transportation Transport	Type CTR	\$ 255.00	
	850 km @ .30		
			255.00
Food and Lodging Nourriture et hébergement			800.00
Mobilization and Demobilization Mobilisation et démobilisation			900.00
<b>Sub Total of Indirect Costs Total partiel des coûts indirects</b>			<b>1055.00</b>
Amount Allowable (not greater than 20% of Direct Costs) Montant admissible (n'excédant pas 20 % des coûts directs)			
<b>Total Value of Assessment Credit (Total of Direct and Allowable indirect costs)</b>			<b>10,235.00</b>
Valeur totale du crédit d'évaluation (Total des coûts directs et indirects admissibles)			<b>10,235.00</b>
			<b>50% of 10,235.00 = 5118.00</b>

Note: The recorded holder will be required to verify expenditures claimed in this statement of costs within 30 days of a request for verification. If verification is not made, the Minister may reject for assessment work all or part of the assessment work submitted.

Note : Le titulaire enregistré sera tenu de vérifier les dépenses demandées dans le présent état des coûts dans les 30 jours suivant une demande à cet effet. Si la vérification n'est pas effectuée, le ministre peut rejeter tout ou une partie des travaux d'évaluation présentés.

**Filing Discounts**

1. Work filed within two years of completion is claimed at 100% of the above Total Value of Assessment Credit.
2. Work filed three, four or five years after completion is claimed at 50% of the above Total Value of Assessment Credit. See calculations below:

Total Value of Assessment Credit	Total Assessment Claimed
	x 0.50 =

**Remises pour dépôt**

1. Les travaux déposés dans les deux ans suivant leur achèvement sont remboursés à 100 % de la valeur totale susmentionnée du crédit d'évaluation.
2. Les travaux déposés trois, quatre ou cinq ans après leur achèvement sont remboursés à 50 % de la valeur totale du crédit d'évaluation susmentionné. Voir les calculs ci-dessous.

Valeur totale du crédit d'évaluation	Évaluation totale demandée
	x 0,50 =

**Certification Verifying Statement of Costs**

I hereby certify:  
that the amounts shown are as accurate as possible and these costs were incurred while conducting assessment work on the lands shown on the accompanying Report of Work form.

that as RECORDED HOLDER I am authorized  
(Recorded Holder, Agent, Position in Company)

to make this certification

**Attestation de l'état des coûts**

J'atteste par la présente :  
que les montants indiqués sont le plus exact possible et que ces dépenses ont été engagées pour effectuer les travaux d'évaluation sur les terrains indiqués dans la formule de rapport de travail ci-joint.

Et qu'à titre de \_\_\_\_\_ je suis autorisé  
(titulaire enregistré, représentant, poste occupé dans la compagnie)

à faire cette attestation.

Signature Ralph I. Benner Date Aug 17, 1994

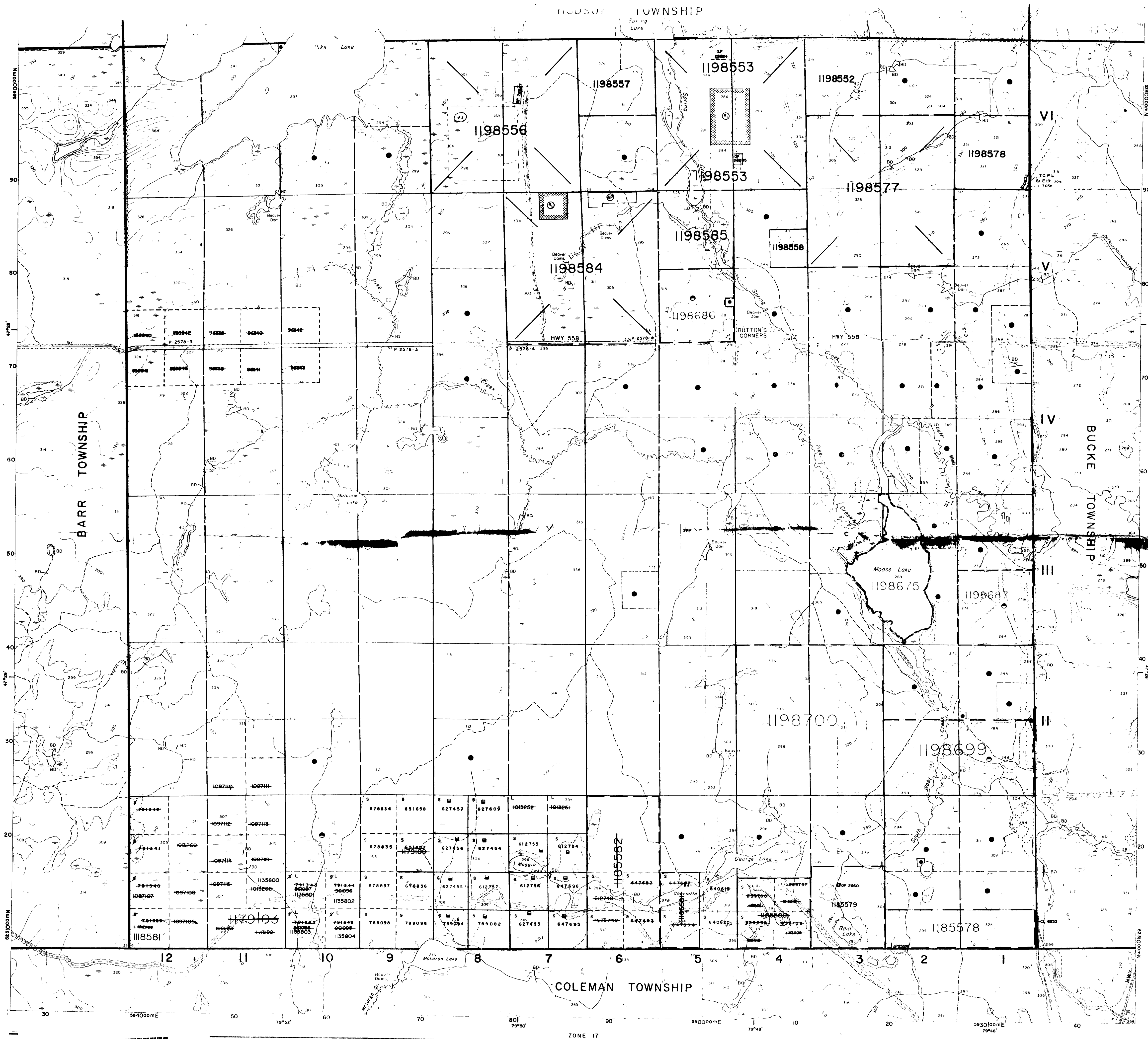

**INDEX TO LAND DISPOSITION**

PLAN  
G-3427  
TOWNSHIP  
**FIRSTBROOK**

M.N.H. ADMINISTRATIVE DISTRICT  
**TEMAGAMI**  
MINING DIVISION  
**LARDER LAKE**  
LAND TITLES/REGISTRY DIVISION  
**TIMISKAMING**

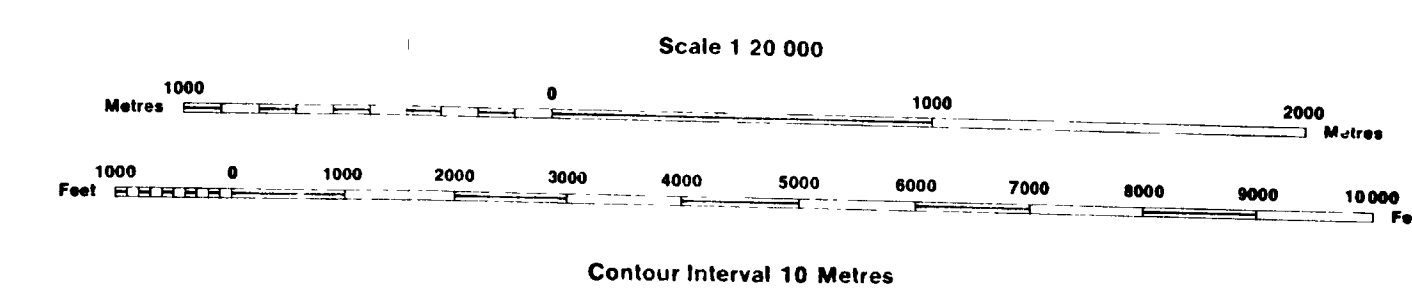

**AREAS WITHDRAWN FROM DISPOSITION**

Description	Order No	Date	Disposition	File
W 2/86	W 2/86	15/1/86	S.R.O.	7298 Vol. 18
R-2 SEC 36/80	W-19/88 NR		S.A.O.	188540

**SYMBOLS**

- Boundary
  - Township, Meridian, Baseline
  - Road allowance, surveyed
  - shoreline
  - Lot/Concession, surveyed
  - unsurveyed
  - Parcel, surveyed
  - unsurveyed
  - Right-of-way, road
  - railway
  - utility
- Reservation
- Cliff, Pit, Pile
- Contour
- Interpolated
- Depression
- Control point (horizontal)
- Flooded land
- Mine head frame
- Pipeline (above ground)
- Railway, single track
- double track
- abandoned
- Road, highway, county, township
- access
- trail, bush
- Shoreline (original)
- Transmission line
- Wooded area

**DATE OF ISSUE**

SEP 27 1984

LARDER LAKE  
MINING RECORDS

**DISPOSITION OF CROWN LANDS**

- Patent
  - Surface & Mining Rights
  - Surface Rights Only
  - Mining Rights Only
- Lease
  - Surface & Mining Rights
  - Surface Rights Only
  - Mining Rights Only
- Licence of Occupation
- Order-in-Council
- Cancelled
- Reservation
- Sand & Gravel
- AGGREGATE PERMITS

**NOTICE OF FORESTRY ACTIVITY**

THIS TOWNSHIP / AREA FALLS WITHIN THE  
LARDER LAKE MANAGEMENT UNIT  
AND MAY BE SUBJECT TO FORESTRY OPERATIONS.  
THE MINING ACT FORESTER FOR THIS AREA CAN BE  
CONTACTED AT: P.O. BOX 38  
LAKE SHORE DRIVE  
TEMAGAMI, ONT.  
POB 2HO  
705 569 3622

THE INFORMATION THAT  
APPEARS ON THIS MAP  
HAS BEEN COMPILED  
FROM VARIOUS SOURCES  
AND ACCURACY IS NOT  
GUARANTEED. THOSE  
WISHING TO STAKE MIN-  
ING CLAIMS SHOULD CON-  
SULT WITH THE MINING  
RECORDS, MINISTRY OF  
NORTHERN DEVELOP-  
MENT AND MINES FOR AD-  
DITIONAL INFORMATION  
ON THE STATUS OF THE  
LANDS SHOWN HEREON

CIRCULATED MAY 3/88

Map base and land disposition on drafting by Surveys and Mapping Branch, Ministry of Natural Resources.

The disposition of land, location of lot fabric and parcel boundaries on this index was compiled for administrative purposes only.



FIRSTBROOK TWP.

G-3427