

DIAMOND DRILLING



31M05SE0004 44 LORRAIN

010

TOWNSHIP: Lorrain

REPORT No.: 44

WORK PERFORMED BY: Oscar L. Giroux

<u>CLAIM No.</u>	<u>HOLE No.</u>	<u>FOOTAGE</u>	<u>DATE</u>	<u>NOTE</u>
S 625847	GQR 85-1	205'	June/85	(1)
	GQR 85-2	205'	June/85	(1)

NOTES: (1) #51-85

# BUCKE TWP.

COLEMAN TWP.

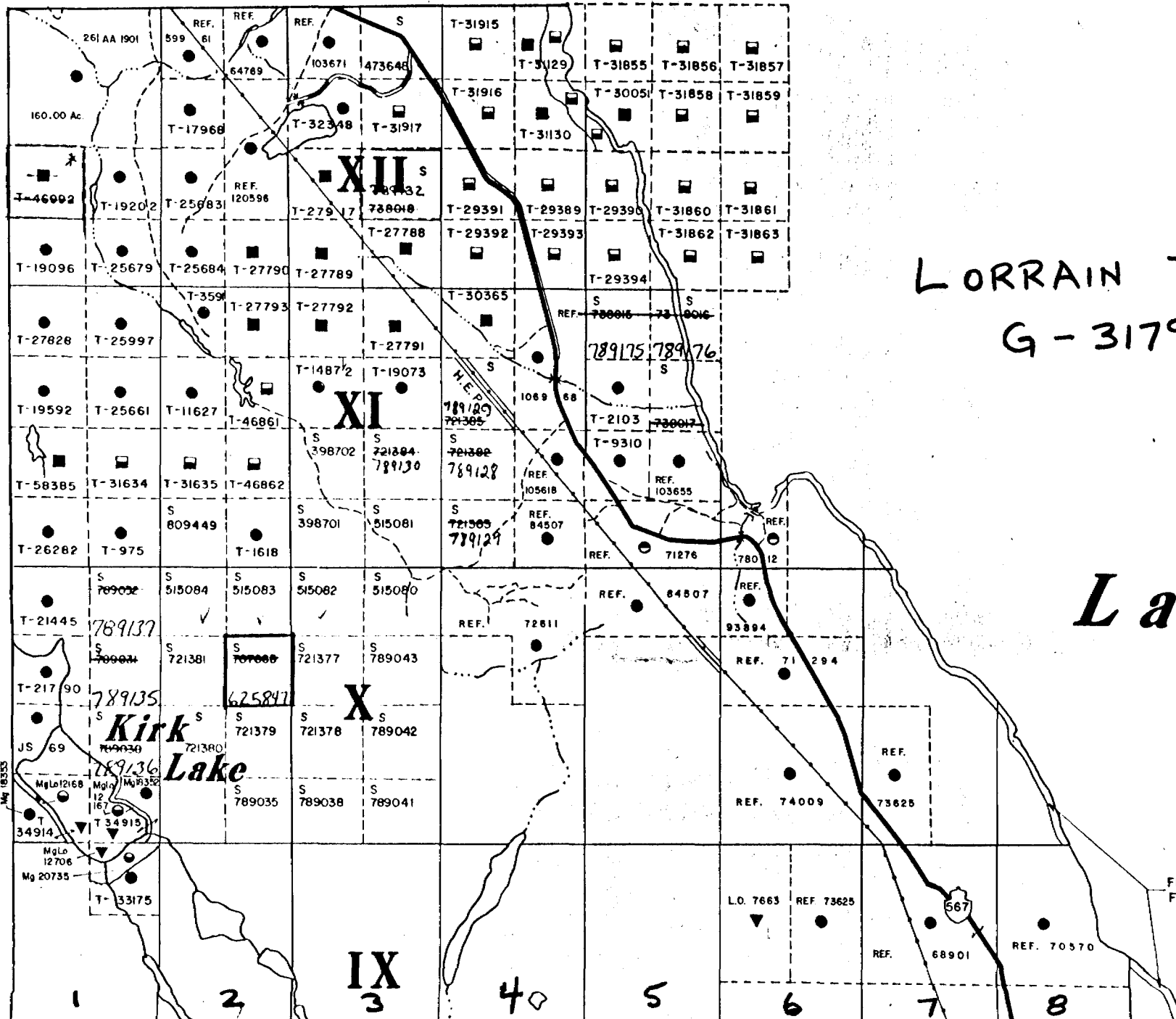

LORRAIN TOWNSHIP  
G-3179

Lake

FLOODING  
File: 135387

CLAIM 515083

#4 Post

#1 Post

HIGHWAY  
 RECEIVED  
 JUN 20 1985  
 7:10 PM  
 121379

CLAIM 72137

C. 721381

S 625847

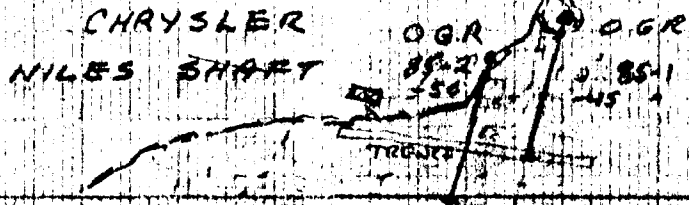

#3 Post

#2 Post

CLAIM 721379

GOR RESOURCES LTD  
 COBALT, ONTARIO  
 DRILL HOLE LOCATION  
 LORRAIN TOWNSHIP  
 SCALE 1" = 200'  
 DRAWN BY HAMMORE  
 DATE JUNE 14, 1985

MADE IN U.S.A.

Township: LORRAIN TWP

COBALT, ONTARIO

Claim No. 5 625847

SHEET No. ①  
 Started June 5/85  
 Finished June 7/85  
 Depth 265.0'

Reference #2 Post 5625847  
 Co-Ords N 192'  
 W 200'  
 Elevation 1020

HOLE No GQR 85-1  
 Bearing S 12° W  
 Dip -45° @ Collar @

From	To	DESCRIPTION	SAMPLES			ASSAYS
			No.	From	To	
0	11	Casing				
11.0	205	Nipissing Diabase Sill: medium grey medium grained, numerous chlorite and sericitic slips trend 30° core, occasional pink aplitic alteration				
14.25		numerous oxidized fractures, rusty some plated with fresh calcite				
11.4		1/8 cal str 10° core				
11.8		rusty cal fractures 60°				
12.2		oxidized bed planes, fract 45° core				
14.1		coarse grained pinkish diabase				
16.4		oxidized calcite slip 40° core				
19.0		cal chl slip 10° core slickenside				
19.9		1/8-1/4 cal 50° " in grey				
20.2		1/16 cal slip 45° " py min				
21.1		cal chl " 30° " " "				
21.4		" " " 30° " " "				
22.0		" " " 30° " " "				
23.7		cal hair 20° " "				
26-40		coarse grained Diabase				
33.5		chl slip 11° core				
34.2		1/16 Pink aplite str 30° "				
40.0		Pink alteration above slip 20° core				
42.0		3/8 Pink str 20° core				
43.5		1/8-1/4 chl cal shear 40° core				
43-45		series chl slips 30° "				
58.2		1/8 cal chl shear 20° "				
59.8		2 (1/32) cal str 60-45° "				

SUDBURY MINING DIV  
**RECEIVED**  
 JUN 20 1985  
 A.M. P.M.  
 7 8 9 10 11 12 1 2 3 4 5 6

TPC - NL

Drilled by Berron Hurling

Core Size AQ

Logged by H.A. Moore

Township: .....

Claim No. ....

SHEET No. 2

Reference .....

HOLE No. GQR 85-1

Started .....

Co-Ords N .....

Bearing .....

Finished .....

E .....

Dip @ Collar @ .....

Depth .....

Elevation .....

From	To	DESCRIPTION	SAMPLES			ASSAYS
			No.	From	To	
		65.4 series chl slip 45° core				
		69.2 chl slip 10° "				
		71.2 oxidized cal slip 40° "				
		75.0 Pinkish alteration zone, pitted wuggy fracture 20° core				
		82-85 series chl slips 7°-45° core				
		83.8 1/8 chl shear 15° core slickenside				
		93-95 chl slips 11° "				
		101.6 1/4 calcite pyrite chl shear 45° core				
		105-135 numerous chl. slips trend 60° core				
		108.3 chl slip 20° core slickenside				
		119.2 1/2-3/4 grey cal pta 20° core pyrite grey min walls look good	119.0	120.0		
		125.5 1/16 chl slip 5° core				
		132.5 " " 20° " fresh cal				
		135.6 " " 5° " "				
		139.8 " " 30° " "				
		146.5 cal chl slip 40° "				
		150.2 " " 40° "				
		156.0 cal chl " 45° "				
		157.4 " " " 15° "				
		169-171.5 series chl trend 30° x 1/4 core possible weak F.2, slickenside				
		176.4 cal chl slip 40° core				
		180-182 " " 20° " "				
		190.9 " " " 30° " plated slip				
		192.6 1/8 cal chl " 30° " "				
		196-200 series chl slip 20° " possible weak F.2				
		205 END OF HOLE				

TPC - NL

Drilled by Berron Hurling

Core Size A Q

Logged by Ma Mear

Township: Lorrain

COBALT, ONTARIO

Claim No. 5625847

SHEET No. (1)  
 Started June, 1985  
 Finished June 11, 1985  
 Depth 205

Reference ←  
 Co-Ords N N 142 #2 Post  
 E W 280 E 625847  
 Elevation 1020

HOLE No. GQR 85-2  
 Bearing S 10° W  
 Dip -50 @ Collar @

From	To	DESCRIPTION	SAMPLES			ASSAYS
			No.	From	To	
0	11.0	Casing				
11.0	135.0	Tipisung, Kibbana Sill: - medium gray, coarse grained abundant sericitic, pentashapetic inflection some hypsthene				
	10-15	medium ch slip 40° core trend				
	18-20	" " 45° " fresh ch				
	20-30	" white ch slip 40° core				
	22.3	1/8" ch slip 50° core				
	22.6	1/32" " " 30°				
	24.3	1/4" ch slip 60° core well				
	24.8	magnetite nodules core				
	35.3	ch slip 20° core slickenside				
	37-7	" " 20° " "				
	47.5	1/2" ch slip 40°				
	48.8	ch slip 40° core fresh				
	49.5	ch slip 30° " "				
	55.7	ch slip 50° " "				
	59.1	rusty ch slip 30° " "				
	61.0	ch slip 50° " "				
	68.4	ch slip 45° " "				
	70.5	1/4" ch slip 30° " NUM				
	79.5	rusty ch slip 45° " "				
	80.2	1/16" ch slip core with rusty ch slip 50° core				
	90.6	ch slip 40° core				
	91.0	" " 40°				
	97.0	1/8" ch slip 30° core				

SUDBURY MINING DIV.  
**RECEIVED**  
 JUN 20 1985  
 A.M. P.M.  
 7 8 9 10 11 12 1 2 3 4 5 6

TPC - NL

Drilled by .....

Core Size .....

Logged by .....

Township: .....

COBALT, ONTARIO

Claim No. S 625 847

SHEET No. (2)  
Started .....  
Finished .....  
Depth .....

Reference .....  
Co-Ords N .....  
E .....  
Elevation .....

HOLE No. ....  
Bearing .....  
Dip ..... @ Collar ..... @ .....

From	To	DESCRIPTION	SAMPLES			ASSAYS
			No.	From	To	
		101.0 3/4 cal igneous str 50' core or py				
		102.2 1/16 " " " 30'				
		103.3 cal chl slip 40'				
		104-106 fine gr section with adularia content				
		104.0 chl slip red center contact 30' core grey mica on chl slip				
		105.2 2" cal box zone 50' core pyrite py mica		104.5	105.5	
		106.1 1/4 block cal str core chl slip 5' core				
		107.4 1" contact pyrite grey pink cal box 60' core				
		108.0 cal slip 50' core				
		120.7 1/4 chl shear 30' grey leach				
		122.0 slip 5' core				
		124.5 1/32 chl mud slip 15' core pink				
		131.0 1/2-3/8 massive shear 15' " shakerade				
		131.5 chl slip 10' "				
		133.5 1/2 cal & grey str 60' core good grey				
135-	205.0	Diabase - amphibole greenish				
		134.5 1/8 apatite str 45' "				
		136.0 1/8 cal str 45' " pyrite				
		139.0 1/16 " " 40' "				
		139.9 3/4 " " pink 45' " some greyed some wallrock alteration				
		142.0 chl slip 15' core				
		143-8 " " 30' "				

TPC - NL

Drilled by .....

Core Size .....

Logged by .....

Township: .....

Claim No. ....

SHEET No. (3) Reference ..... HOLE No. ....  
 Started ..... Co-Ords N ..... Bearing .....  
 Finished ..... E ..... Dip ..... @ Collar ..... @ .....  
 Depth ..... Elevation .....

From	To	DESCRIPTION	SAMPLES			ASSAYS
			No.	From	To	
		148.0 chl slip 15° core shales				
		152.0 " " 15° " "				
		150.9 3/4 cut argillite 35° core				
1536	157	153.6 chl slip 20° " argillite				
		159.0 " 30 & 50° core possible block 15.2				
		159.0 " some fresh cut				
		159.0 " chl slip 90° core				
		160.3 1/2 block & white cut 40° core				
		165.6 " heavy wellcut cut				
		165.6 " 1/2 cut sh 50° core py - spy - ma				
		166.3 cut slip 30° core				
		167.0 cut chl slip 45° " wellcut cut				
		167.4 mud slip & chl 40° core				
		168.0 chl slip 60° " "				
		169.3 " 40° " "				
		169.5 - 171.0 transition cut & chl slip 5° core		169.5	171.0	
		171.0 1/4 - 5/8 cut 1/2 core spy - ma				
		172.3 cut chl 40° core				
		173.2 chl slips 35° core				
		174.5 1/8 cut sh 15° " "				
		179.4 1/8 cut chl slip 40° " "				
		183.3 1/4 cut argillite 40° " "				
		184.8 cut slip 20° " "				
		185.1 1/2 block cut sh 30° " " py - spy - ma		184.7	185.2	
		189.2 1/16 cut & spy 20° " "				
		190.7 1/32 " 30° " "				
		191.5 cut - run 20 & 30° core				
		191.9 1/4 block cut sh 70° core some flash		191.6	192.2	

TPC - NL

Drilled by

194.4 heavy well cut slip 30° core  
 196.3 1/16 mud & chl 30° core  
 203.0 1/2 cut chl b.c. 15° core

Logged by

205.0 EVIDENCE Note





Ministry of  
Natural  
Resources

Report  
of Work

W.P.S. of S.  
LORRAIN T  
C.M.-S  
The Mini



31M05SE0004 44 LORRAIN

900

Name and Postal Address of Recorded Holder Oscar J. Giroux. 2-Pyrite st. S. Cobalt Ont, P.O. BOX 185	Prospector's Licence No. K 18868
---	-------------------------------------

Summary of Work Performance and Distribution of Credits

Total Work Days Cr. claimed 401	Mining Claim			Mining Claim			Mining Claim		
	Prefix	Number	Work Days Cr.	Prefix	Number	Work Days Cr.	Prefix	Number	Work Days Cr.
for Performance of the following work. (Check one only)	S	515082	95						
		515083	95						
		515084	95						
		625847	116						
<input type="checkbox"/> Manual Work									
<input type="checkbox"/> Shaft Sinking Drifting or other Lateral Work.									
<input type="checkbox"/> Compressed Air, other Power driven or mechanical equip.									
<input type="checkbox"/> Power Stripping									
<input checked="" type="checkbox"/> Diamond or other Core drilling diamond									
<input type="checkbox"/> Land Survey									
				Total Footage Credits Applied				410	
				BALANCE				9	

All the work was performed on Mining Claim(s): S. 625847

Required Information eg: type of equipment, Names, Addresses, etc. (See Table Below)

D. DRILL, CAN, LONGYEAR #P 38. A.Q. CORE.

DIAMOND DRILLING COMPANY, BARRON DRILLING INC, 368 LITTLE ST, HAILEYBURY ONT. BOX 606.

DRILLERS.  
runner- Regean Pigeon, 386 little st. Haileybury Ont.  
helper - Andy Gauthire Earleton Ont.

DRILLING STARTED JUNE 6th TO BE COMPLETED BY JUNE 11th 1985.

SUDBURY MINING DIV.  
**RECEIVED**  
JUN 13 1985  
A.M. P.M.  
7 8 9 10 11 12 1 2 3 4 5 6

WORK ASSIGNMENT:  
S-625847 = 294,  
BALANCE = 3706

Date of Report JUNE 8th 1985.	Recorded Holder or Agent (Signature) <i>Oscar J. Giroux</i>
----------------------------------	--

Certification Verifying Report of Work

I hereby certify that I have a personal and intimate knowledge of the facts set forth in the Report of Work annexed hereto, having performed the work or witnessed same during and/or after its completion and the annexed report is true.

Name and Postal Address of Person HUGH A. MOORE P. ENG. 38 WILKINGTON STREET NEW LISKEARD ONT.	Date Certified JUNE 8th 1985.	Certified by (Signature) <i>Hugh A. Moore</i>
---	----------------------------------	--

Table of Information/Attachments Required by the Mining Recorder

Type of Work	Specific Information per type	Other Information (Common to 2 or more types)	Attachments
Manual Work	RECEIVED NIL	Names and addresses of men who performed manual work/operated equipment, together with dates and hours of employment.	Work Sketch: these are required to show the location and extent of work in relation to the nearest claim post.
Shaft Sinking, Drifting or other Lateral Work			
Compressed air, other power driven or mechanical equip.	Type of equipment DIAMOND DRILL LONGYEAR 38	Names and addresses of owner or operator together with dates when drilling/stripping done.	To Follow - plus logs
Power Stripping	Type of equipment and amount expended. Note: Proof of actual cost must be submitted within 30 days of recording.		
Diamond or other core drilling (Diamond)	Signed core log showing; footage, diameter of core, number and angles of holes.	NIL	Work Sketch (as above) in duplicate
Land Survey	Name and address of Ontario land surveyor.		