



31M05SE0048 39 GILLIES LIMIT

010

GILLIES LIMIT (N. PT.) TOWNSHIP REPORT #39

This file contains work performed by Watt-Armstrong on claim:

T. 48456

Hole #1; 119' Oct., 1962

Hole #2; 121.5' Oct., 1962

240.5'

Company ARMSTRONG - WYATT CAMP

Drill Hole Log

Dip Tests

At Ft.
 At Ft.
 At Ft.
 At Ft.
 At Ft.
 At Ft.

Property.....
 At.....
 Claim No. T-98436
 Working Place LOCATED AT 306'
 Baseline Footage ON LINE 196' FROM
 Baseline Offset #1 Post T-98436
 Date Started OCT. 16 - 62
 Date Completed OCT. 20 - 62

Hole Number 1
 Dip -47°
 Length 119 FEET
 Bearing 340° TRUE
 Elev. Collar.....
 Horiz. Trace.....
 Vert. Trace.....
 Date Logged OCT. 20 - 62

FROM	TO	DESCRIPTION	SAMPLE NUMBER	ASSAY
0	119	HEAVY DISEASE		
0	1	CORNER		
1	72	FROM 10' TO 100' FROM CORNER DISEASE SOME REMAINS OF SLIPS TO 12.5' AT 22.0' - 25.0' SLIP ABOVE TO CORE FINE CRISTE SOME PYRITE AT 28.0' - 30.0' DISEASE - CHALCITE - FINE PYRITE FROM 38.0' - 39.0' SLIPS - FINE PYRITE, HEMATITE ON SLIPS AT 46.0' 1/2" PYRITE. FROM 71' TO 72.5' LOST CORE.		
72.5	119	CORNER DISEASE TO THE DIAGONAL DISEASE. 72.5' - 74.5' LOST CORE AT 80.0' FINE CRISTE STRINGER, HEMATITE ON SLIP. AT 82.8' 1/2" PYRITE AND HEMATITE FROM 101.2' TO 102.5' LOST CORE FROM 102.5' TO 108' " " FROM 108' TO 112' " " FROM 112' TO 119' " " FROM 119' TO 119' FEET		
		END OF HOLE 119'		

Logged by Maurice Armstrong

Drill Hole Log

Dip Tests

At Ft.
 At Ft.
ONT. DEPT. MINES
 At Ft.
 At OCT 29 1962
 At Ft.
AGGREGATE GEOLOGIST
CORAL, ONTARIO

Property
 At
 Claim No. 7-98956
 Working Place LOCATED AT 305.5'
 Baseline Footage BY LINE 196° FROM
 Baseline Offset #1.657 - 7.98956
 Date Started OCT. 20 - 1962
 Date Completed OCT. 25 - 1962

Hole Number 2.
 Dip -- 46°
 Length 121.5'
 Bearing 351° TRUE
 Elev. Collar
 Horiz. Trace
 Vert. Trace
 Date Logged OCT. 25 - 1962

FROM	TO	DESCRIPTION	SAMPLE NUMBER	ASSAY
0	121.5	MISSING DIABASE		
0	1.1	CHALCITE		
		AT 10.5 - 1" TO 3/4" PINK CALCITE; QUARTZ; EPIDOTE		
		SOME REDDISH COLORED DIABASE 12.5 - 25'		
		AT 21.5 LINE CALCITE STRINGER		
		" 22.0 1/2" APLITE		
		" 32.2 - 3" VERY COARSE LIGHT COLORED DIABASE.		
		FROM 33.2 - 34.2 FRACTURED; SOME BRECCIATION, CALCITE; APLITE, TALC ON SLIPS		
		" 36.0 TO 37.8 LOST CORE		
		AT 49.1 - 1/4" CALCITE STRINGER - CHALCITE		
		FROM 43.1 TO 45.9 BADLY FRACTURED - FEO ON SLIPS		
		" 47.8 TO 48.9 - LOST CORE		
		AT 48.9 - 1/2" PINK CALCITE - HEMATITE		
		FROM 50.1 TO 51.0 - LOST CORE		
		" 53.8 TO 55.0 LOST CORE		
		" 61.6 TO 62.1 LOST CORE		
		FROM 62.1 TO 62.5 - 2" APLITE - 1/8" PINK CALCITE		
		FROM 63.9 TO 65.5 - 68.4 TO 69.4 - 72.2 TO 72.5 LOST CORE		
		FROM 72.9 TO 76.5 - 77.5 TO 77.8 - 82.4 TO 83.0 LOST CORE		
		FROM 86.5 TO 87.9 - 92.0 TO 92.4 - 93.0 TO 94.3 LOST CORE		
		FROM 100.7 TO 101.3 - 112.5 TO 114.7 - 115.0 TO 116.4 - 116.8 TO 117.2 LOST CORE		
		AT 109.0 - 3/4" APLITE?		
		AT 119.0 1/4" APLITE - PYRITE.		
		BADLY FRACTURED AND FULL OF SLIPS FROM ABOUT 70.0'		
		END OF HOLE 121.5'		

Logged by Martin Armstrong

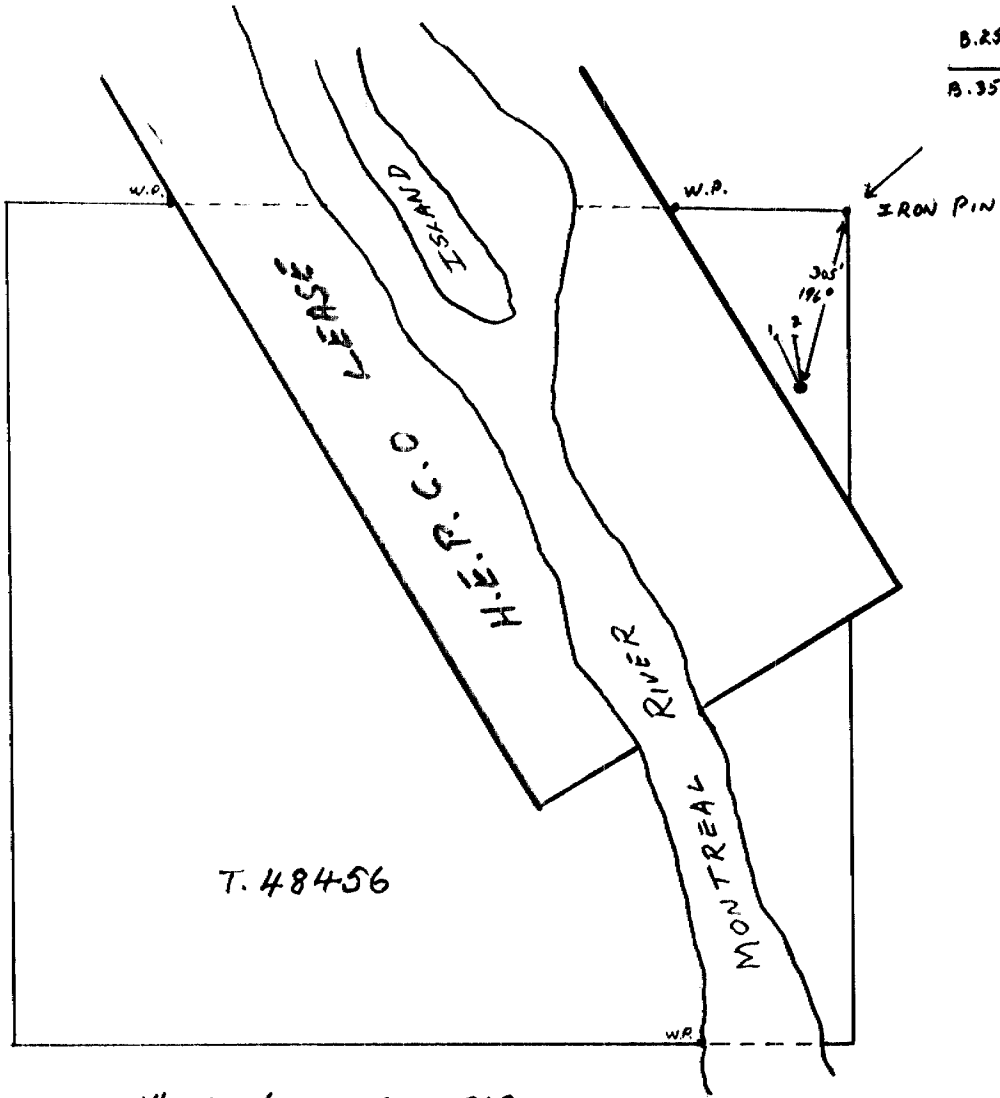

B.25	B.24
B.35	B.34

1" = 300' OCT 1962