



31M05SE0102 36 COLEMAN

010

Diamond Drilling

Township of COLEMAN

Report N^o 36

Work performed by: R.C. McAllister & D. Burton

Claim N ^o	Hole N ^o	Footage	Date	Note
L 373429	95-2	526.0'	Oct/77	(1)

Notes:

(1) #98-77

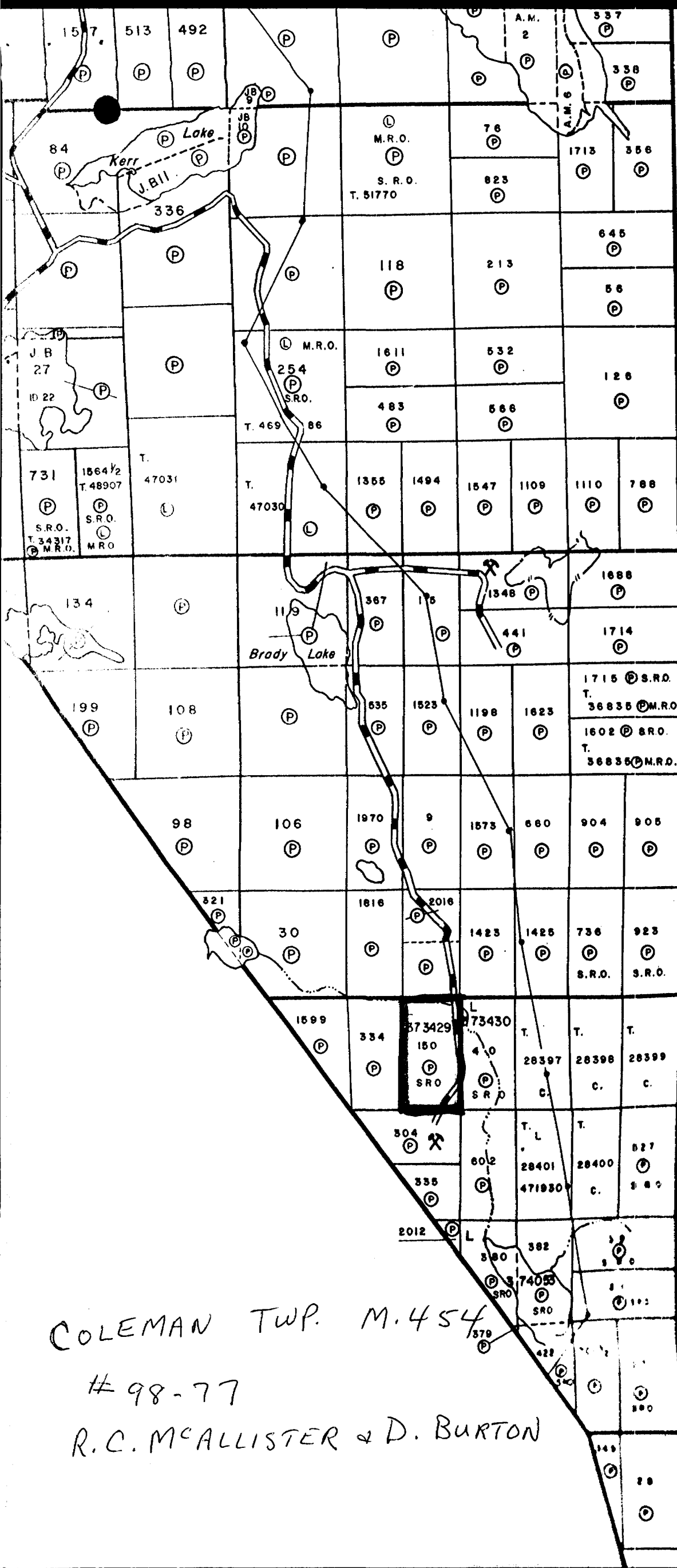

IV
Lorrain Twp. (M-536)

III

II

COLEMAN TWP. M. 454
98-77
R.C. McALLISTER & D. BURTON

COLEMAN

LOT 2

LOT 1

IBSEN POND

OPHIR SUBC. 2 CONC. 3
CONC. 2 CONC. 3



CONC. 2 CONC. 3
LORRAIN

TRACES FROM CLAIM MAP M454

GILLIES LIMIT

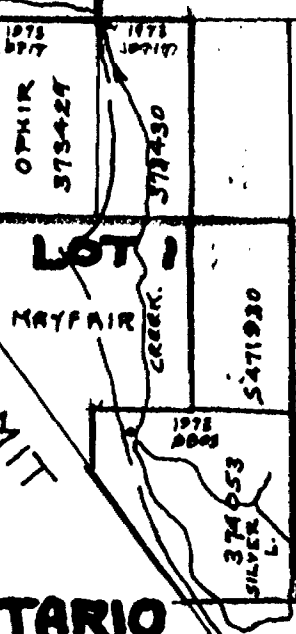

**PLAN
SHOWING
LOCATION OF
CLAIM GROUP
COLEMAN TWP., ONTARIO**

SCALE 4" = 1 MILE
1" = 1320'
RATIO 1 : 15840

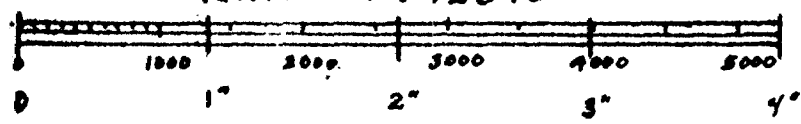

Douglas Burton

OPHIR
73-95-D

JUNE, 1914
NOV. 1917

Company McAllister Staking

73-95

Drill Hole Log

Dip Tests

At _____ Ft. _____
 At _____ Ft. _____
 At _____ Ft. _____
 At _____ Ft. _____
 At _____ Ft. _____
 At 450' Ft. -45°

Property OPHIR CLAIMS
 At Lot 1 Con 2 Coleman
 Claim No. 1373429
 Working Place surface
 Baseline Footage N710
 Baseline Offset E005 feet
 Date Started Oct. 30, 1977
 Date Completed Nov. 7th, 1977

Hole Number 95-2
 Dip Minus 50°
 Length 516 feet
 Bearing 88°
 Elev. Collar about 1140' asl
 Horiz. Trace 348
 Vert. Trace 392'
 Date Logged Nov 20th, 1977

FROM	TO	DESCRIPTION			SAMPLE NUMBER
0	5	casing bit core 41 mm (1 5/8) "A" core 27mm 1 1/16"			
5	526	fine-grained grey andositic lava, occasional pillows no sediments fairly hard (1 bit for 60 feet) no magh min- erals narrow calcite veins roughly horiz and vertical			
	5-75 85-89	Some scattered chalcopyr and some pyr in pillow filling fine-grained lamprophyre dike			
	127.6-129.5 403-404	Fault, some gouge mostly breccia some pyr. slick green gouge parallel to hole			
	303-309 326-330 332-347	grey dike " " " "			
	438.5 -485	Red aplite dikes (1" -438.5) (1" -441.0) (1" -445.0) (14" -456.0-457.2) (12" - 457.5-458.5) (24" -460.5-462.5) (1" -485)			
	457	temporarily lost water, but with 10 feet of careful drilling the leak stopped without cementing			
	169-176	banded calc & brecciated some galena, sphal & Chalco	1"	22.84	ozs Ag 8423B
	218	1" calcite 10% cobaltite some pyr & chalco each side	1"	9.98	ozs Ag 8421B
	250.4	1" calcite 10% cobaltite some pyr each side	1"	7.07	oz Ag 8422B
	526	END OF HOLE			
		END OF HOLE			

Logged by Douglas Burton
Douglas Burton
 Douglas Burton.

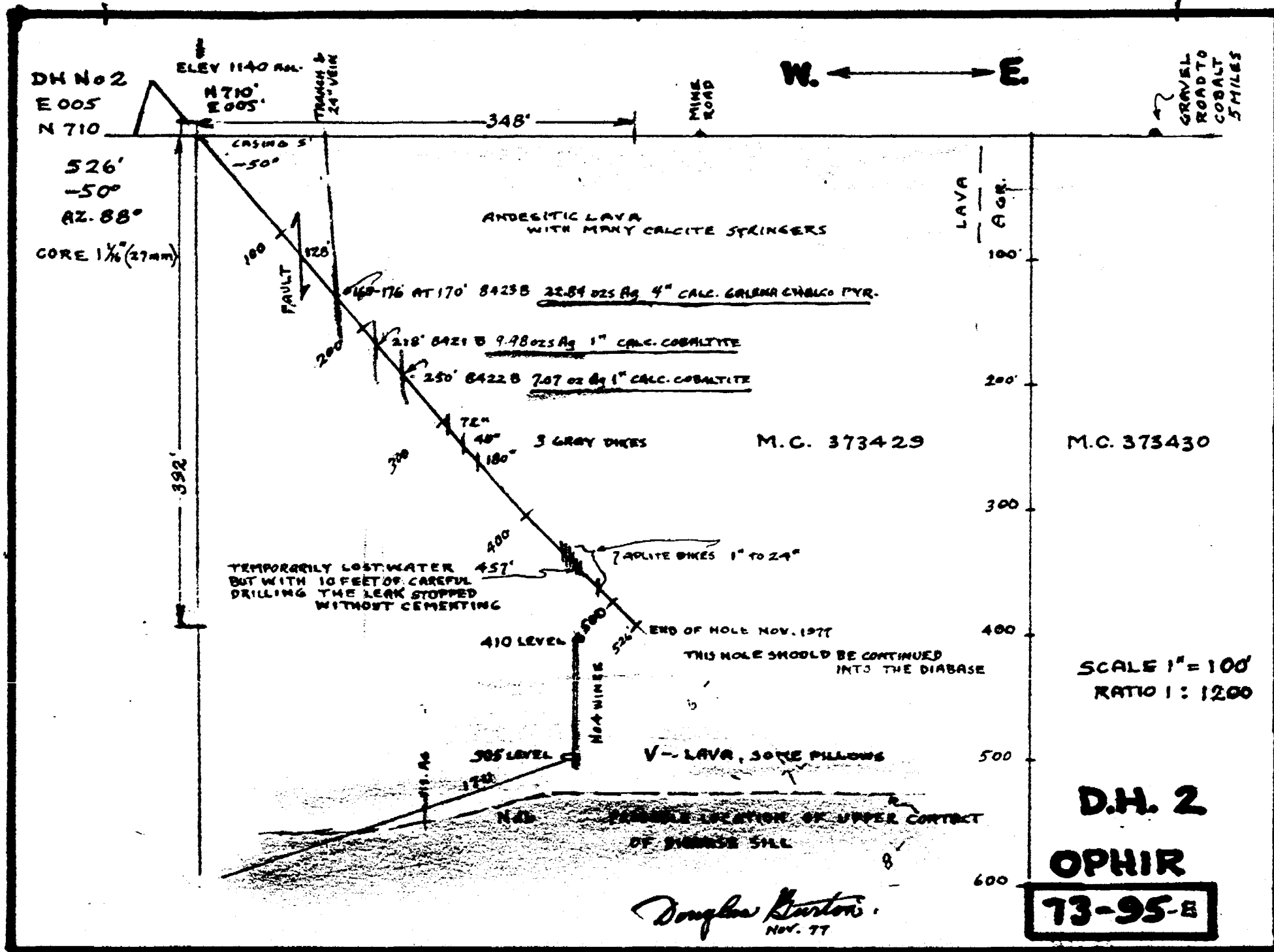

DH No 2
E 005
N 710

ELEV 1140 AN.
N 710
E 005

W. ← → E.

GRAVEL
ROAD TO
ROBALT
COBALT
5 MILES

526'
-50°
AZ. 88°
CORE 1 1/8" (27mm)

392'

CASING 5'
-50°

348'

MINE
ROAD

ANDESITIC LAVA
WITH MANY CALCITE SPRINGERS

LAVA
FAC.

100
125
FAULT

176 AT 170' 8423B 22.84 OZS Ag 4" CALC. GALENA CHALCO PYR.

218' 8421 B 9.98 OZS Ag 1" CALC. COBALTE

250' 8422 B 7.07 OZ Ag 1" CALC. COBALTE

3 GRAY DIKES

M.C. 373429

M.C. 373430

TEMPORARILY LOST WATER
BUT WITH 10 FEET OF CAREFUL
DRILLING THE LEAK STOPPED
WITHOUT CEMENTING

410 LEVEL

7 DOLomite DIKES 1" TO 2 1/4"

END OF HOLE NOV. 1977

THIS HOLE SHOULD BE CONTINUED
INTO THE DIABASE

385 LEVEL

V-LAVA, SOME PILLOWS

N 45

POSSIBLE LOCATION OF UPPER CONTACT
OF DIABASE SILL

D.H. 2

OPHIR

73-95-E

Douglas Stanton
Nov. 77

AND PLAN

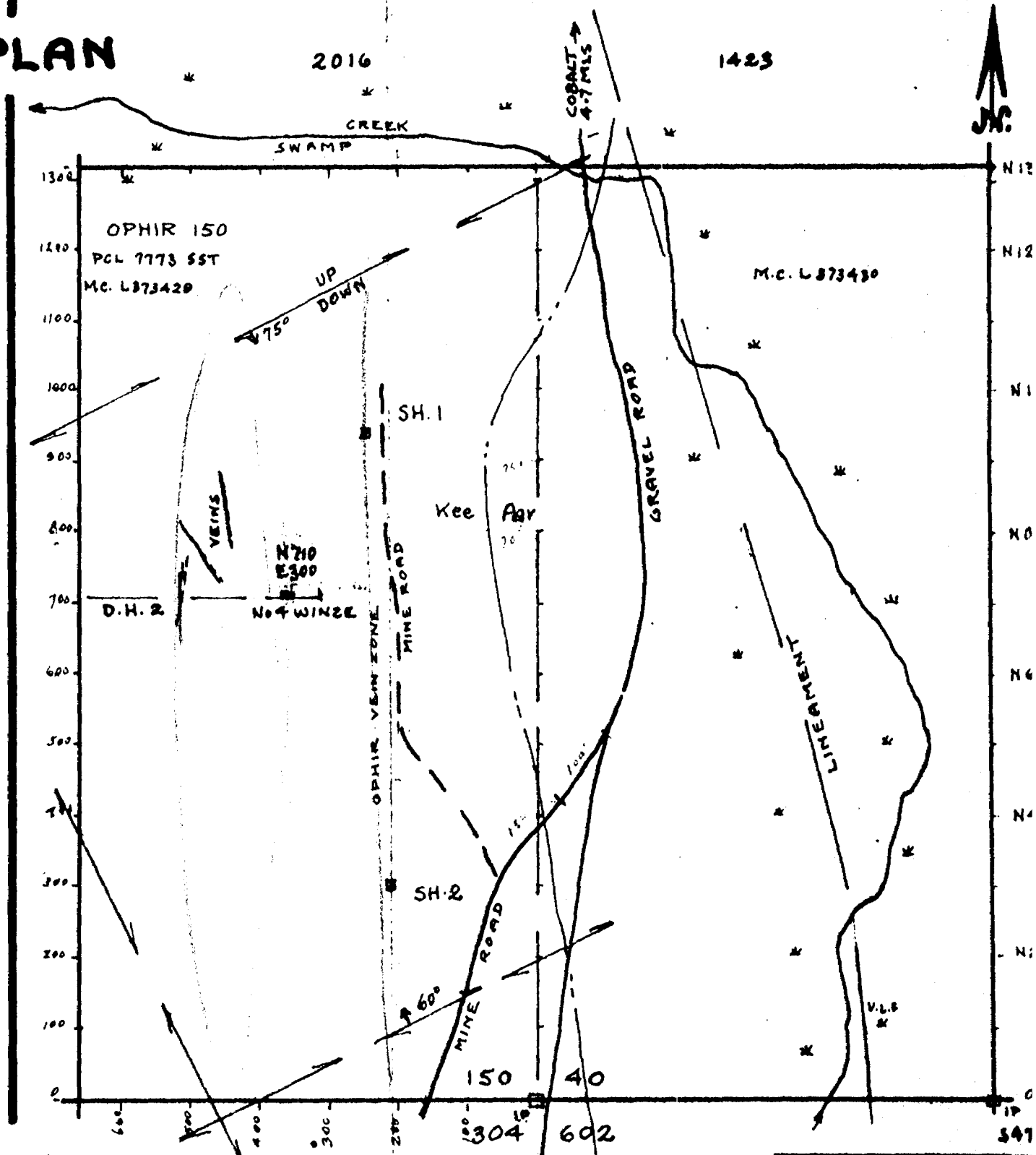

Douglas Burton

MAYPAIR

73-95-2

NOVEMBER, 1973

OPHIR SECTION

SCALE 1" = 200'

LONGITUDINAL SECTION ALONG OPHIR VEIN SYSTEM

PROJECTION
FACING WEST

S. ← N.

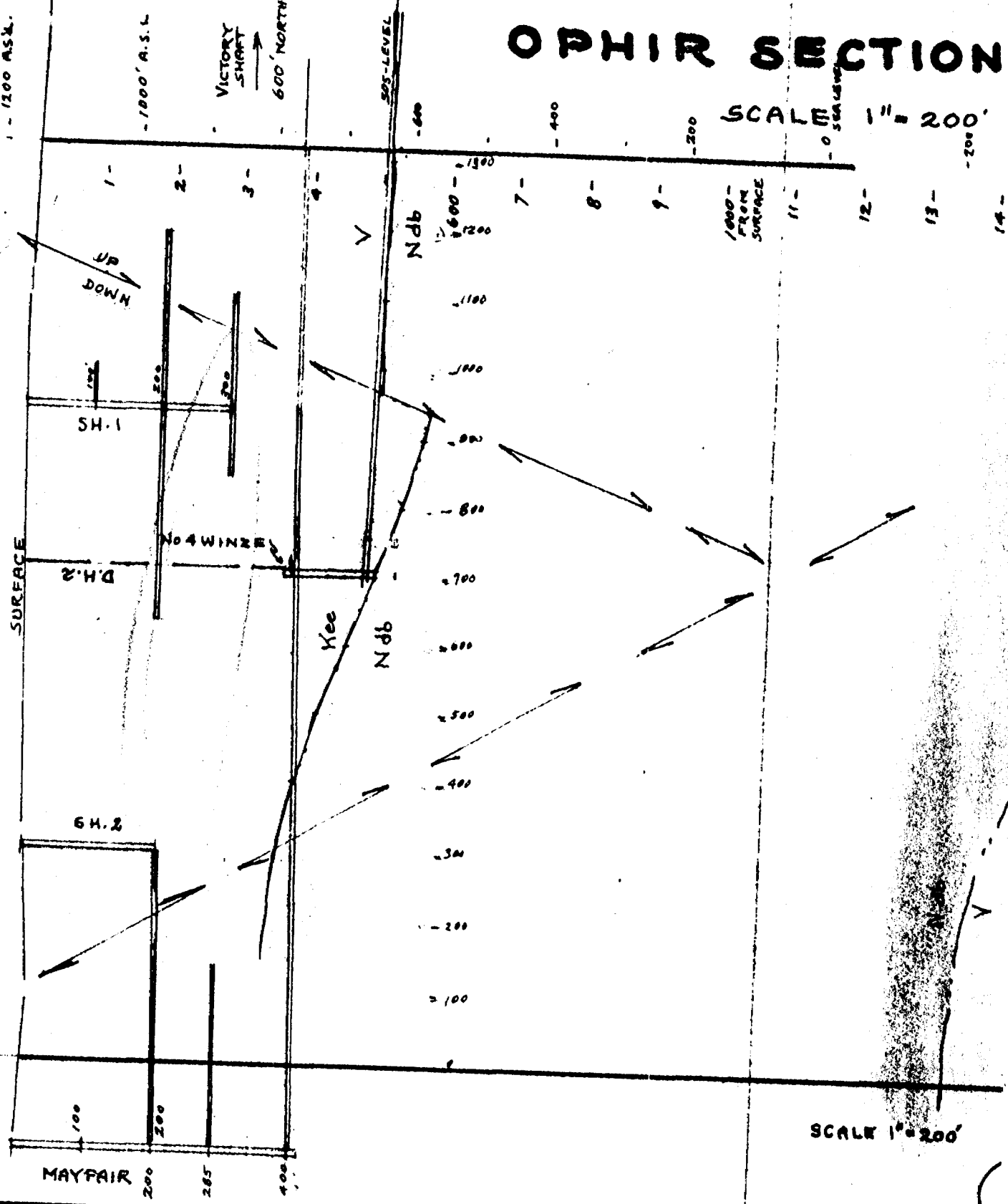

SCALE 1" = 200'