

31M12SW0007 2.8865 LUNDY

010

0M85-8-C-95

Lundy Township

Addendum to Report

During the period from June 1, 1985 to September 20, 1985 eight diamond drill holes (some 4004 feet of drilling) were initiated. All holes were drilled by N. Morrisette Diamond Drilling Ltd. obtaining B.Q. (1 7/16 inch diameter) core. All drill holes were placed in claim No. 767004. A base map at a scale of 1"=50' has been included to show exact locations. Sludge was recovered for analysis and Tro-pari tests were taken in order to obtain exact information on variations in dip and azimuth.

Drill core from these holes is presently stored in core racks on the drill site location (claim No. 767004). On request from the Resident Geologist for Cobalt, core from two drill holes was moved to the Montreal River for removal to the Cobalt core library. Vandalism destroyed the core before it could be removed. The holes involved were DDH-L-85-6 and DDH-L-85-7.

George W. Hill

Geologist

KEY MAP 3
LOCATION OF CLAIMS, SOUTH WEST
QUARTER, LUNDY TWP
DISTRICT OF TEMISKAMING

GRACE
LAKE

LUNDY
LAKE

LUNDY TWP

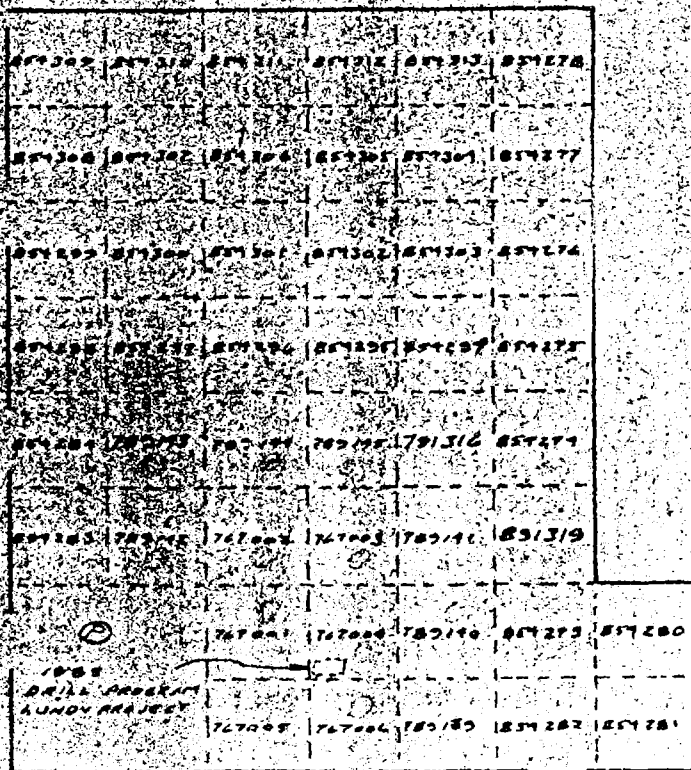

SILVERSIDE RES. INC.
LUNDY PROJECT
CLAIM GROUP LUNDY TWP
DISTRICT OF
TEMISKAMING
SCALE: 1" = 10 CHAINS OR 1" = 2640'
DRAWN BY: W.D.P.

12 11 10 9 8 7
RANGE TWO



31M12SW0007 2.8865 LUNDY

020

LUNDY TOWNSHIP

RECEIVED

FEB 05 1986

MINING LANDS SECTION

SUMMARY

From June 1, 1985 to September 20, 1985 a mineral exploration program was conducted on the Silverside Resources Inc. Lundy Township property. The survey was commissioned and funded by Silverside Resources Inc. There were two phases to the program. The first was a surface lithological mapping and lithogeochemical sampling program. This was carried out under this writer's direction by Mr. Randolph Clark, a senior student at Laurentian University in Sudbury. The aim of the project was to define structures known to exist from work done in the very early 1900's and to discover any new potential gold or silver bearing structures which might exist in outcrop.

Mapping revealed several interesting cobalt bearing structures on surface. Old workings had been sunk in the diabase without going through into the Firstbrook argillite below. Anomalous values in both gold and silver were obtained from the structures on which the working was emplaced.

Phase two of the program entailed an initial 2500 feet of diamond drilling. This was extended to 4000 feet after the first two drill holes. A total of 4004 feet of diamond drilling was done in all, spread fairly even over eight diamond drill holes. Results for the program are recorded in the diamond drill logs included with this report. The most promising intersection was a quarter inch vein which carried some 25 oz/ton silver over 0.2 feet. Several interesting although not economic intersections were encountered.

INTRODUCTION:

Silverside Resources Inc. is the present owner of some 46 unpatented mining claims in Lundy Township, District of Temiskaning near the town of New Liskeard, Ontario. During the period between June 1, 1985 and September 20, 1985, Silverside Resources Inc. entered into an exploration program for precious metals aimed primarily at silver. This involved detailed mapping of the original thirteen claims and sampling of any mineralized structures encountered. Four thousand four feet of B.Q. size diamond drilling was done on the targets encountered.

The following report describes the property and relates lithology, structure and mineralization encountered. It also relates the property to mineral occurrences on nearby claims. Recommendations for further exploration programmes are made. The report is based essentially on 1) data collected during the 1985 exploration programme 2) maps and reports published by the O.G.S. and O.D.M. 3) records of programmes carried out during the early 1900's on the property and 4) personal conversations with the resident geologist for the Cobalt area.

PROPERTY AND LOCATION:

Silverside Resources Inc. has the mineral rights to a property which comprises 1840 acres in the Township of Lundy, District of Temiskaming. Claim numbers and descriptions are shown on the accompanying claim map^{None} of the claims are patented although sufficient work has been applied for to bring 12 claims to lease.

ACCESSIBILITY AND FACILITIES:

The property is close to the well established Cobalt camp so all facilities are available for a mining operation, including custom milling. Silverside Resources Inc. has done some research in this area for their Lorrain Township property.

The Claims are accessible from highway 11 by road and boat. The Mowatts Landing road proceeds about ten miles East from the Haileybury turnoff. The property is about three miles north of Mowatts Landing via the Montreal river.

HISTORY:

This property is located in an area close to both the Gowganda and Cobalt camps. The history of both camps is well known and well documented. Three quarters of a billion ounces of silver have been taken out of the Cobalt camp alone.

The vicinity of the property has also been explored during the early 1900's. Auld Township immediately east of Lundy contains the Triangle Silver Claims a past silver ^{producer} ~~production~~ under the name of Kenabeek Silver Mines and Silver Sill Mining Co. Several other mineral occurrences are also recorded to exist in Auld Township.

During this general period several cobalt and copper bearing veins were discovered in Lundy Twp. Exploration pits and at least one small exploration shaft were sunk on these occurrences.

In the early 1980's the resident geologist for the Cobalt region conducted a lithogeochemical survey over all of Lundy Twp. A number of silver, gold, cobalt and copper anomalies were reported. The Silverside Resources Inc. property is located on a prominent anomaly which is also the site of some early exploration pits and a small shaft.

GENERAL GEOLOGY:

The geology of the area has been well mapped and documented in various reports and maps published by the Ontario Department of Mines. The following information has been gleaned from these sources and from the results of the 1985 mapping of the Silverside property.

The oldest exposed rock in the township is the sedimentary rock of the Huronian Supergroup, Cobalt Group. On the bottom is the Coleman member of the Gowganda Formation overlain by Firstbrook siltstones and argillites. Above that lies the Lorrain Formation, arkose and quartzite. These are overlain in turn by the Nipissing Diabase sill, where it has not weathered away. See table 1 for more detail. All of these units appear to be dipping gently to the south east or to the north west in various parts of the township.

TABLE 1

Table of Lithologic Units

PROTEROZOIC

Olivine diabase, diabase

INTRUSIVE CONTACT

Nipissing Diabase

Rhythmically layered and granophyric

Varied textured (irregular, coarse-grained pockets in a finer grained matrix of similar composition)

Pyroxene diabase (medium grained, massive rock characterized by brown, weathered pyroxenes)

Quartz diabase (dense, black (augite), medium grained, massive)

INTRUSIVE CONTACT

HURONIAN SUPERGROUP

COBALT GROUP

Lorrain Formation

Arkose (coarse grained, purple; thickly bedded; characterized by hematitic and sericitic alteration)

Quartzite (medium grained; weathers pink and white; mixture of fine and coarse grain sands in thicker beds)

The base of this unit grades into fine-grained, grey sandstone characterized by red, felsic clots aligned along bedding planes.

Gowganda Formation

Firstbrook Member

Siltstone (maroon, massive, local interbeds of thinly laminated argillite)

Laminated Argillite (alternating maroon, pink and green laminae; less than 5 cm thick, quartz and silt rich zones common)

Coleman Member

Grey Argillite (very fine grained laminae < 0.5 mm thick slaty cleavage)

Siltstone (fine grained, grey/maroon characterized by thinly phyllitic laminae and dropstones at base)

Pebbly Wacke/Conglomerate (pebbles and cobbles comprise 2 to 35%; a siliceous matrix of rock flour)

Green Argillite (thinly laminated; extensive small scale slump folding)

STRUCTURAL GEOLOGY:

The axis of a fold runs roughly south westerly across the south east corner of Lundy Twp. forming an antiformal structure. Two prominent sets of lineaments are apparent. In the northwestern part of the township, northwest-trending lineaments are accompanied by parallel sets of closely spaced joints which seem to intensify toward the lineaments.

A second set of lineaments and parallel joints trend north and dominate the north central part of the township. These have some control over the occurrence of the outline of Lorrain Formation quartzites in this area. A third, poorly developed, set of lineaments trends west.

PROPERTY GEOLOGY:

Most of the western portion of the property is overlain by diabase. The transition from varied textured diabase to quartz diabase is quite apparent and mapable. Coleman member argillite and siltstone outcrop on the eastern portion of the property. A small wedge of Lorrain quartzite outcrops at the north eastern corner of the property. These units all appear to dip gently to the north west.

There appears from mapping and late drilling to be a slight doming of the diabase in the south central portion of the property. Major fractures sets trend north east and north west on the property.

ECONOMIC GEOLOGY:

The general information on the area has been mentioned in the section; "history". Detailed mapping of the original thirteen claims revealed two areas which contained veins carrying erythrite and chalcopyrite. Further assaying revealed anomalous values in both silver and gold. Both areas are the sights of exploration pits from the early 1900's.

Both of these are located near the dome in the diabase. Generally, in the Cobalt camp at least, this is a favourable structure for silver mineralization.

Eight diamond drill holes totaling 4004 feet were emplaced to test the more favorable of the two structures during the 1985 programme. Several low silver values were obtained along with one, one quarter inch vein running twenty five ounces per ton silver. Most of the sulphide intersections contain anomalous gold values ranging from 5ppb to 250 ppb gold. The veins in question apparently have a north easterly strike and are sub-vertical. More detailed information can be obtained from the enclosed drill hole sections, logs and surface plans.

OVERBURDEN AND RELIEF:

The geography of the area is dominated by two ridges having a maximum relief of about seventy feet. Between them is a small creek and swamp occupying the central part of the property. On the east a much larger marsh takes the form of a series of marshy fields dammed by beaver and separated by alder swamp.

Overburden varies from nil on the ridges to an estimated one hundred feet in the area of the swamp.

CONCLUSIONS AND RECOMMENDATIONS

From the data collected during the 1985 exploration programme the following conclusions may be drawn:

- 1) The Lundy Township property is in a favourable area for silver and gold mineralization due to its location relative to past silver producing areas.
- 2) Lithogeochemical evidence indicates anomalous gold silver and copper values in the area of the Silverside Resources Inc. property.
- 3) Structural information obtained during the 1985 programme indicates favourable structures for silver mineralization.

4) The presence of gold and especially silver in anomalous amounts is confirmed by the results of the 1985 drilling.

It is recommended from the previous conclusions that:

1) A further exploration programme be carried out on the Silverside Resources Inc. property both to investigate the areas already discovered and to look for new mineralized areas. This should include the following:

a) A surface mapping and exploration programme on the recently acquired and unexplored claims.

b) A V.L.F., E.M. survey to further delineate the major structures on the property. Followed by an E.M. survey on appropriate areas to detect mineralization.

c) Diamond drilling where and if warranted.

CERTIFICATE

I, George W. R. Hill, of 491 Russell Street, Haileybury, Ontario, hereby certify that:

1. I am and have been employed since 1983 as a geologist with Silverside Resources Inc. with Head Offices at Suite 1101, 10 King Street East, Toronto, Ontario M5C 1C3.
2. I am a graduate of Queen's University, Kingston, Ontario, with a Bachelor of Science (1982) degree in Geology.
3. I am a member in good standing with the Canadian Institute of Mining, and a Director of the local Branch (Haileybury) of the Canadian Institute of Mining.
4. This report is based on work done on the Lundy Township property during 1985.

Haileybury, Ontario
December, 1985

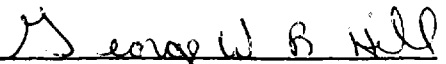
George W. R. Hill

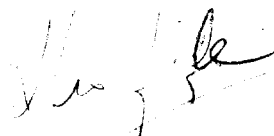

KEY MAP 1
LOCATION IN NORTH EASTERN ONTARIO

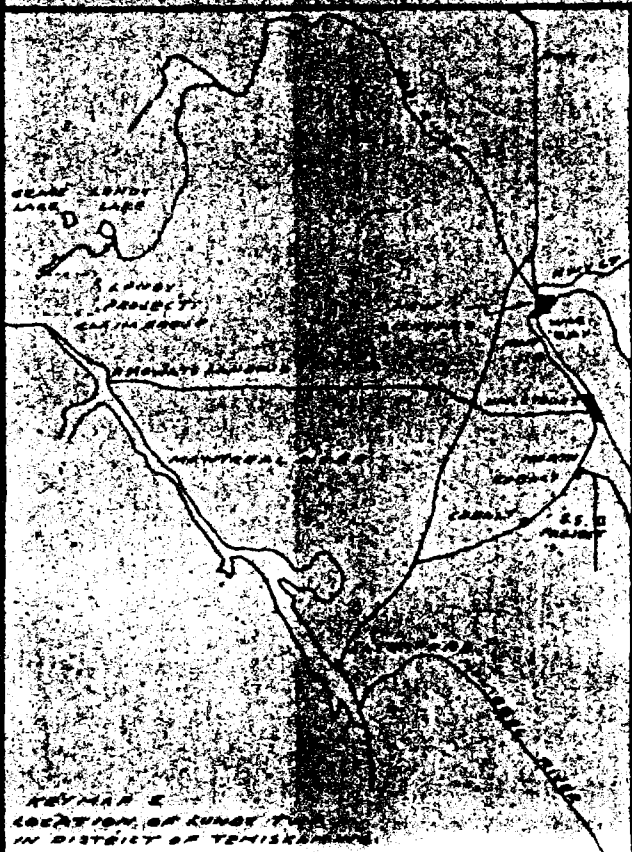
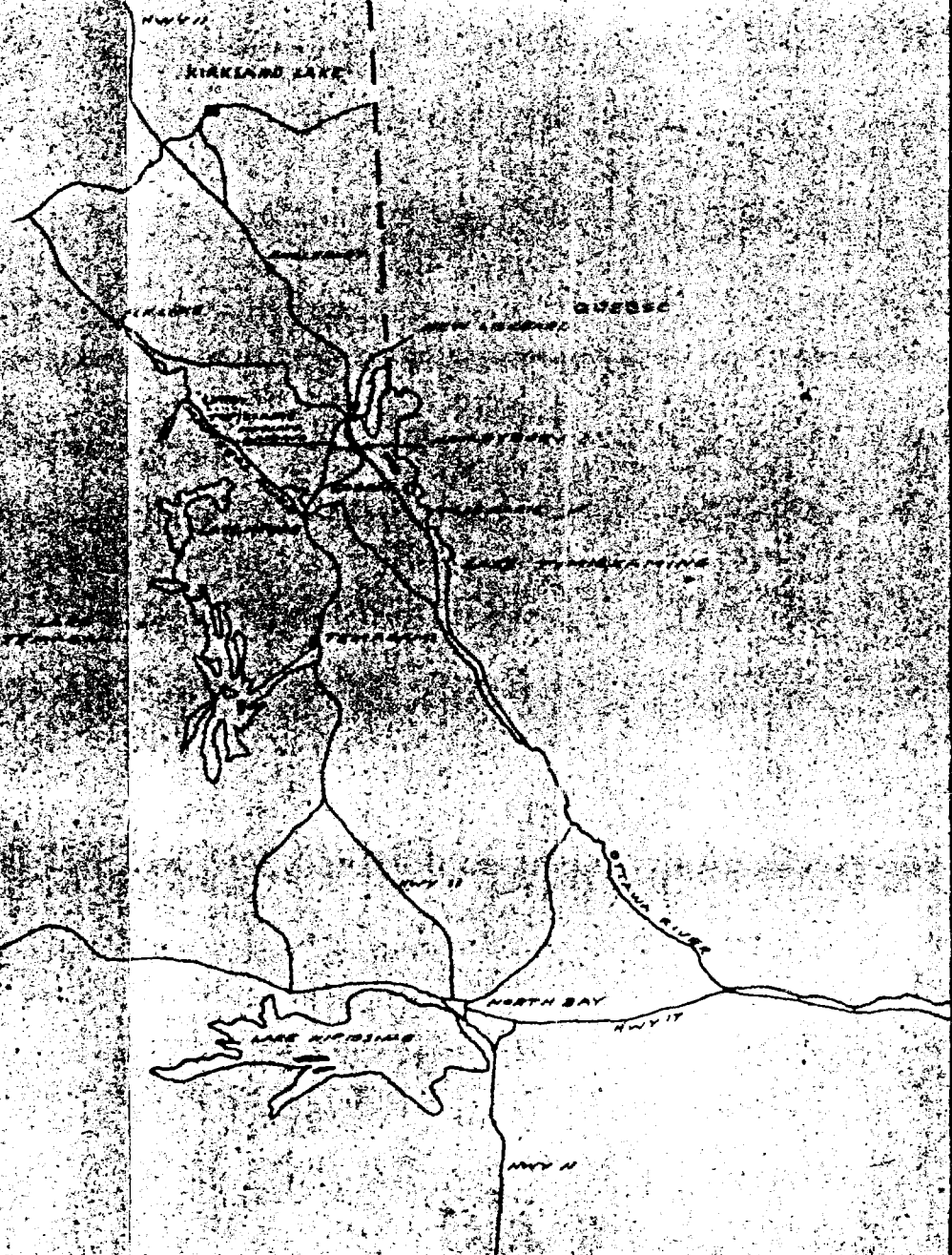

KEY MAP 2
LOCATION OF LUNDY CLAIM GROUP
IN DISTRICT OF TEMISKAMING

SILVERSIDE RESOURCES INC.
KEY MAP TO LUNDY CLAIM GROUP
LONG. $\approx 80^{\circ}$ LAT. $\approx 47.6^{\circ}$

KEY MAP 3
 LOCATION OF CLAIMS SOUTH WEST
 QUARTER, LUNDY TWP
 DISTRICT OF TEMISKAMING

GRACE
 LAKE

LUNDY
 LAKE

II

III

LUNDY TWP

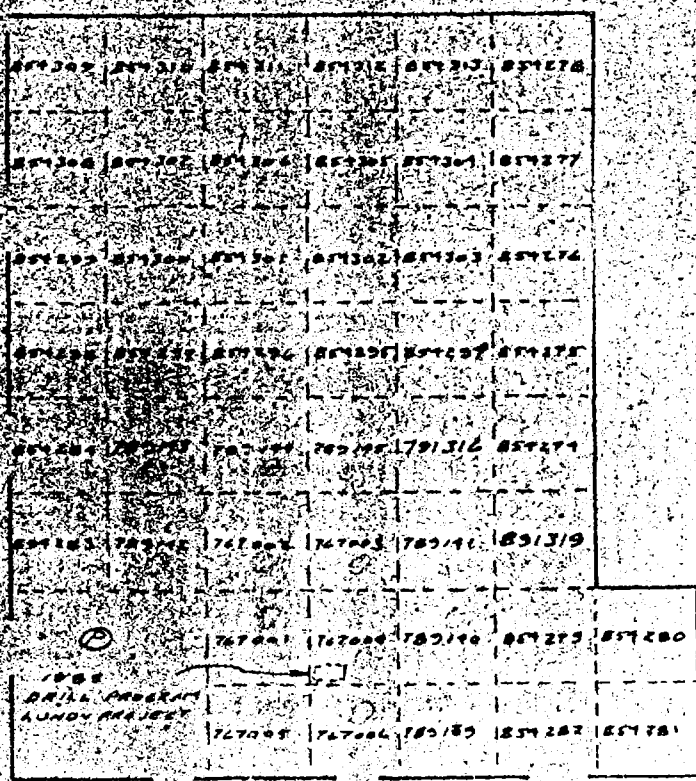

SILVERSIDE RES. INC.
 LUNDY PROJECT
 CLAIM GROUP LUNDY TWP
 DISTRICT OF
 TEMISKAMING
 SCALE 1" = 40 CHAINS
 DRAWN BY W.D.P.

1000
 DRILL PROGRAM
 LUNDY PROJECT

12

11

10

9

8

7

BARR TWP

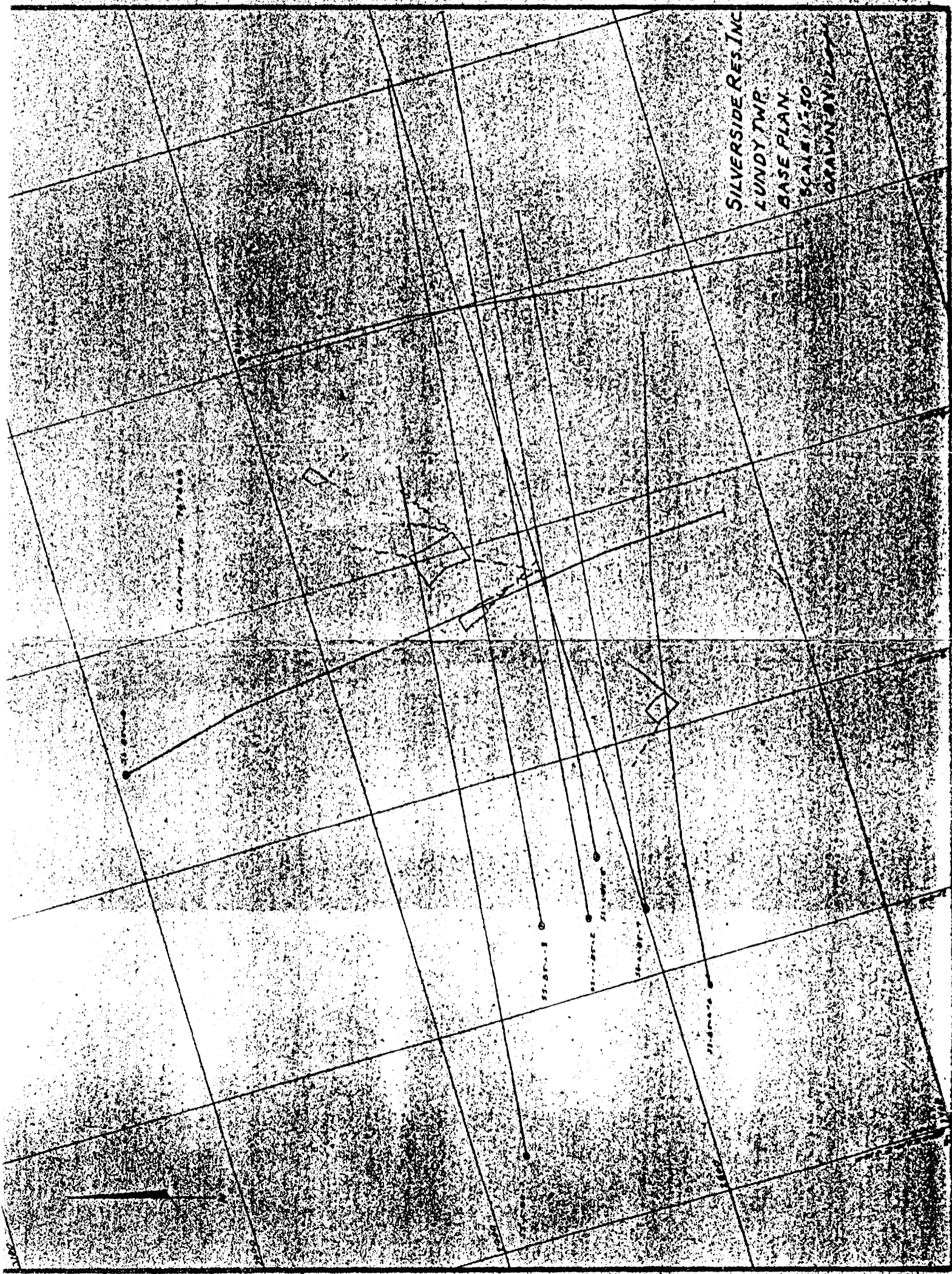

SILVER SIDE RES. INC.
LUNDY TWP.
BASE PLAN
SCALE 1/4" = 1'-0"
DRAWN BY [unclear]

ROAD

11-00-1

11-00-2

11-00-3

11-00-4

11-00-5



Ministry of
Natural
Resources

Report of Work
(Geophysical, Geological,
Geochemical and Expenditures)



31M12SW0007 2.8865 LUNDY

File No. S. 767001 *Jun 30*

30
reversed
to list
in the
entered
columns.

900

Type of Survey(s) Geological - litho-geochemical	LUNDY (M.538)
Claim Holder(s) Silverside Resources Inc.	Prospector's Licence No. T-1067
Address Suite 1101 - 10 King St. E Toronto Ont. MSC 1C3	
Survey Company	Date of Survey (from & to) Day Mo. Yr. Day Mo. Yr. 01 06 85 01 08 85 Total Miles of line Cut 3.13 mi
Name and Address of Author (of Geo-Technical report) George W. Hill P.O. Box 180 491 Russell St. Haileybury Ont.	

Credits Requested per Each Claim in Columns at right

Mining Claims Traversed (List in numerical sequence)

Special Provisions	Geophysical	Days per Claim
For first survey: Enter 40 days. (This includes line cutting)	- Electromagnetic	
	- Magnetometer	
For each additional survey: using the same grid: Enter 20 days (for each)	- Radiometric	
	- Other	
	Geological	40
	Geochemical	

Man Days	Geophysical	Days per Claim
Complete reverse side and enter total(s) here	- Electromagnetic	
	- Magnetometer	
	- Radiometric	
	- Other	
	Geological	
	Geochemical	

Airborne Credits	Geophysical	Days per Claim
Note: Special provisions credits do not apply to Airborne Surveys.	Electromagnetic	
	Magnetometer	
	Radiometric	

Mining Claim		Expend. Days Cr.	Mining Claim		Expend. Days Cr.
Prefix	Number		Prefix	Number	
S	767002	40			
	767001	40			
	767003	40			
	767004	40			
	767005	40			
	767006	40			
	789139	40			
	789140	40			
	789141	40			
	789142	40			
	789143	40			
	789144	40			
	789145	40			

RECEIVED
DEC 12 1985
MINING LANDS SECTION

SUDBURY MINING DIV.
RECEIVED
DEC 11 1985
A.M. P.M.
7|8|9|10|11|12|1|2|3|4|5|6

SUDBURY MINING DIV.
RECEIVED
first
NOV 22 1985
A.M. P.M.
7|8|9|10|11|12|1|2|3|4|5|6

Total number of mining claims covered by this report of work.

13

Expenditures (excludes power stripping)

Type of Work Performed

Performed on Claim(s)

Calculation of Expenditure Days Credits

Total Expenditures \div 15 = Total Days Credits

Instructions
Total Days Credits may be apportioned at the claim holder's choice. Enter number of days credits per claim selected in columns at right.

Date **20-11-85** Recorded Holder or Agent (Signature) **George W. Hill**

For Office Use Only

Total Days Cr. Recorded **520** Date Recorded **Dec. 11 / 1985** Mining Recorder **V.C. Miller**

Date Approved as Recorded **26.2.27** Branch Officer **[Signature]**

Certification Verifying Report of Work

I hereby certify that I have a personal and intimate knowledge of the facts set forth in the Report of Work annexed hereto, having performed the work or witnessed same during and/or after its completion and the annexed report is true.

Name and Postal Address of Person Certifying
George Hill - P.O. Box 180, Haileybury Ontario

Date Certified **20-11-85** Certified by (Signature) **George W Hill**



SILVERSIDE RESOURCES INC.

Suite 1101, 10 King Street East,
Toronto, Ontario M5C 1C3
(416) 366-8058

January 31, 1986

Ministry of Northern Development and Mines
Land Management Branch
Mining Lands Section
Whitney Block, 6th Floor
Queen's Park, Toronto
M7A 1W3

ATTENTION: MR. ARTHUR BARR

RE: WORK REPORT 129, LUNDY TOWNSHIP

Dear Mr. Barr:

As per our telephone conversation today, enclosed please find one copy of our Lundy Township Geological Report, with maps, by our Geologist, George Hill.

As I mentioned, a copy of this report was erroneously sent to Mr. Vic Miller in Sudbury. I spoke with him this morning and he advised me that he is sending on this report to Mr. Smith in your office today, so that you will have two copies.

My apologies for the mix-up.

Yours very truly,

Laurie E. Hellens
Treasurer

SEND
TO

Supervisor - Mining Lands Section
 Mineral Management Branch (MMR)

S. 767001

Rome Lease Whiskey Blk Tanks

FROM

Mining Records

Sulbury Mining Division

19860131

SUBJECT

Work Report # 85-129 Coalbridge Laundry Temp. S. 767001 ETL.

Record Holder: Steamwell Resources Inc.

Here is a submission from Mr. George W. Hill to cover the above noted Mining Claims.

Diamond Drill Logs were also analyzed did you (Mining Lands Section) request them? (See # 85-130 FID 2.83RD) ~~attached to~~

J.E. Wall

yours vsm

FID 05 1000

Sulbury

MINING LANDS SECTION

REPLY

REPLY FROM

REPLY DATE

Mining Lands Section

File No 2.8865

Control Sheet

TYPE OF SURVEY GEOPHYSICAL
 GEOLOGICAL
 GEOCHEMICAL
 EXPENDITURE

MINING LANDS COMMENTS:

_____ <Lundy> _____

Lpd
L.D.

Davis K.

Signature of Assessor

Feb. 25/86

Date

February 14, 1986

File: 2.8865

Silverside Resources Inc
Suite 1101
10 King Street East
Toronto, Ontario
M5C 1C3

Dear Sirs:

RE: Geological Survey submitted on
Mining Claims S 767001, et al,
in Lundy Township

Enclosed are the plans (in duplicate) for the above-mentioned survey. In order to complete your submission, please indicate the claim lines, claim numbers, and traverse lines. The nature of the overburden should be shown in areas of little or no outcrop.

When returning this material, please quote file 2.8865.

For further information, please contact Dennis Kinvig at (416) 965-4888.

Yours sincerely,

S.E. Yundt, Director
Land Management Branch

Mining Lands Section
Whitney Block, 6th Floor
Queen's Park
Toronto, Ontario
M7A 1W3

Telephone: (416) 965-4888

DK/mc

cc: Mining Recorder
Sudbury, Ontario
#85-129

George W. Hill
P.O. Box 180
491 Russell Street
Halleybury, Ontario
POJ 1K0

Encl.

*Sent to
Sudbury*

February 3, 1986

Report of Work 129

Silverside Resources Inc
Suite 1101
10 King Street East
Toronto, Ontario
M5C 1C3

Dear Sirs:

RE: Mining Claims S 767002, et al,
in Lundy Township

I have not received the reports and maps (in duplicate)
for the Geological Survey on the above-mentioned claims.

As the assessment "Report of Work" was recorded by the
Mining Recorder on December 11, 1985 the 60 day period
allowed by Section 77 of the Mining Act for the submission
of the technical reports and maps to this office will
expire on February 9, 1986.

If the material is not submitted to this office by February 9,
1986 I will have no alternative but to instruct the Mining
Recorder to delete the work credits from the claim record
sheets.

For further information, please contact Mr. Arthur Barr at
(416)965-4888.

Yours sincerely,

S.E. Yundt, Director
Land Management Branch

Mining Lands Section
Whitney Block, 6th Floor
Queen's Park
Toronto, Ontario
M7A 1W3

Telephone: (416) 965-4888

AB/mc

cc: George W. Hill
P.O. Box 180
491 Russell Street
Haileybury, Ontario
POJ 1K0

Mining Recorder
Sudbury, Ontario

Encl.

HENWOOD TWP.

OF
LUNDY

DISTRICT OF TIMISKAMING

SUDBURY
MINING DIVISION

SCALE: 1 INCH TO 40 CHAINS

AULD TWP.

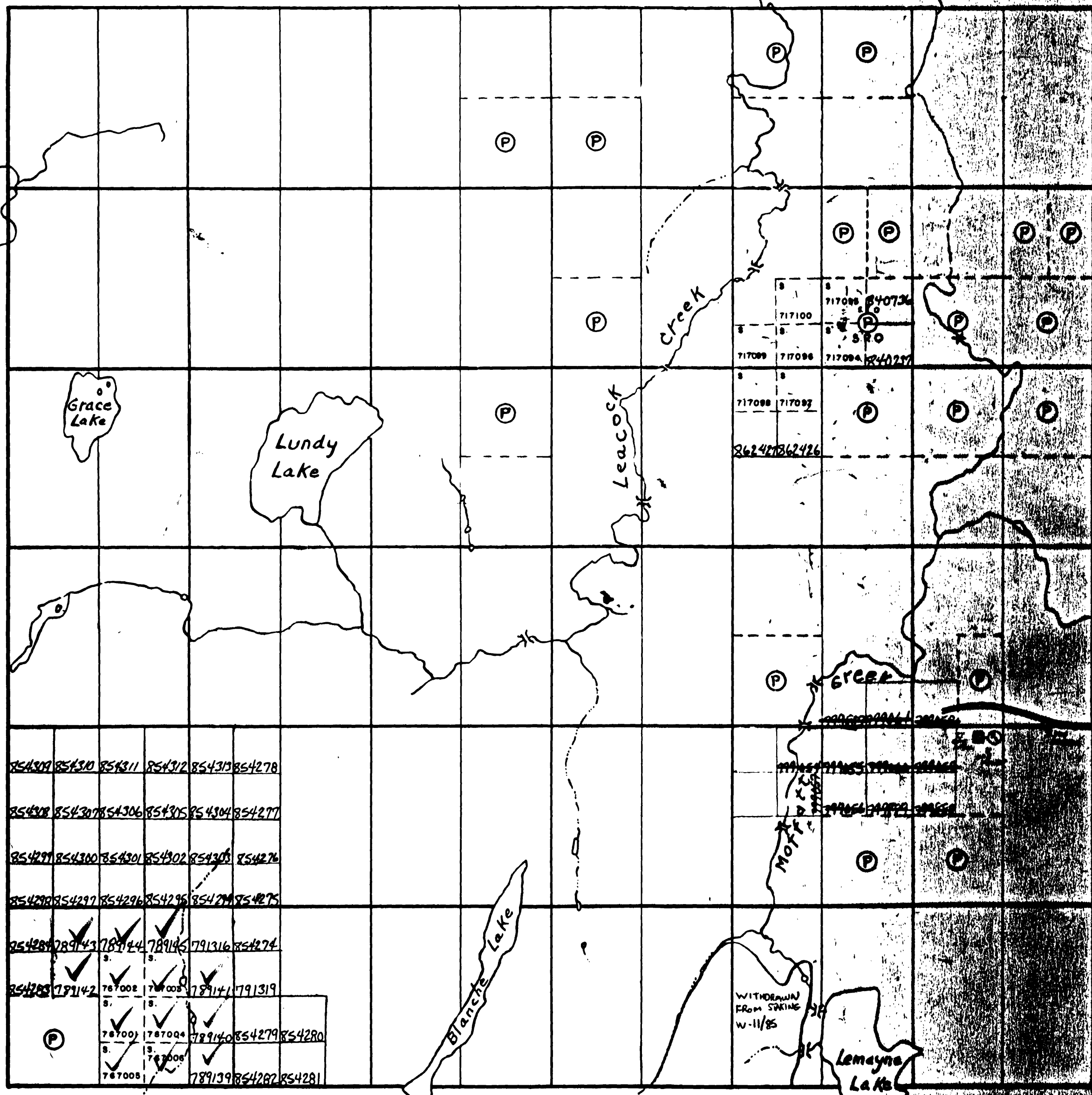

854309	854310	854311	854312	854313	854278
854318	854319	854306	854305	854304	854277
854299	854300	854301	854302	854303	854276
854290	854297	854296	854295	854294	854275
854281	854282	854283	854284	854285	854274
854286	854287	854288	854289	854290	854273
854291	854292	854293	854294	854295	854272
854296	854297	854298	854299	854300	854271
854301	854302	854303	854304	854305	854270
854306	854307	854308	854309	854310	854269
854311	854312	854313	854314	854315	854268
854316	854317	854318	854319	854320	854267
854321	854322	854323	854324	854325	854266
854326	854327	854328	854329	854330	854265
854331	854332	854333	854334	854335	854264
854336	854337	854338	854339	854340	854263
854341	854342	854343	854344	854345	854262
854346	854347	854348	854349	854350	854261
854351	854352	854353	854354	854355	854260
854356	854357	854358	854359	854360	854259
854361	854362	854363	854364	854365	854258
854366	854367	854368	854369	854370	854257
854371	854372	854373	854374	854375	854256
854376	854377	854378	854379	854380	854255
854381	854382	854383	854384	854385	854254
854386	854387	854388	854389	854390	854253
854391	854392	854393	854394	854395	854252
854396	854397	854398	854399	854400	854251

BARR TWP.

VI
V
IV
III
II
I

HUDSON TWP.

LEGEND

PATENTED LAND	Ⓟ
CROWN LAND SALE	C.S.
LICENCE OF OCCUPATION	L.O.
LOCATED LANDS	Loc.
IMPROVED ROADS	———
ROADS	———
RAILWAYS	——+——
POWER TRANSMISSION LINE	———
LEASES	Ⓞ
MINING RIGHTS ONLY	M.R.O.
SURFACE RIGHTS ONLY	S.R.O.
CANCELLED	C.

NOTES

LANDS MARKED THUS - Ⓞ O.F.B.™
RESERVED FOR ONT. FORESTRY BRANCH
FOR CABIN, TOWER & RESERVE SITES.
400' Surface Rights Reservation around
all Lakes and Rivers.

AREA WITHDRAWN FROM DISPOSITION

M.R.O. - MINING RIGHTS ONLY	Ⓞ		
S.R.O. - SURFACE RIGHTS ONLY	Ⓞ		
M.R.O. & S.R.O. - MINING AND SURFACE RIGHTS	Ⓞ		
Order No.	Date	Disposition	File
201. 96/80	W. 2/81	29/2/82	S.R.O. 108848

PLAN No. - M-538

ONTARIO
MINISTRY OF NATURAL RESOURCES
SURVEYS AND MAPPING BRANCH



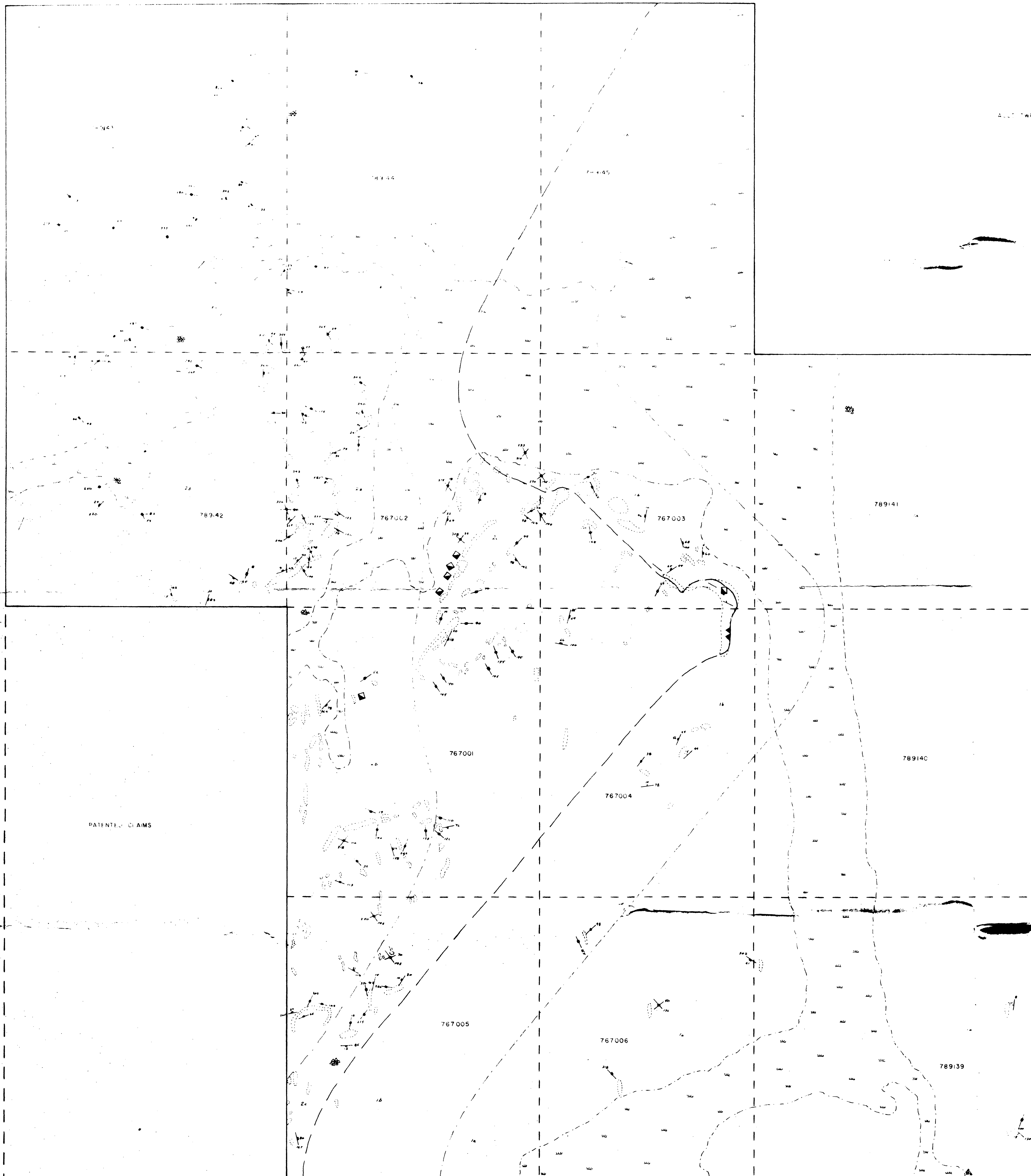

LEGEND

PRECAMBRIAN

- EARLY PROTEROZOIC
 MAFIC INTRUSIVE ROCK
 NIPISING DIABASE
- 2 2a VARIED TEXTURED DIABASE
 2b HYPERSTHENE DIABASE
 2c QUARTZ DIABASE

HURONIAN SUPERGROUP

- COBALT GROUP
 GOWGANDA FORMATION
 FIRSTBROOK MEMBER
- 1 1a THINLY LAMINATED GREY TO BLACK ARGILLITE
 1b CONTACT METAMORPHOSED GREEN PELITIC SEDIMENTS

SYMBOLS

- OUTCROP
- ∕∕ JOINTING (INCLINED & VERTICAL)
- ∕∕ VEINS (INCLINED & HORIZONTAL)
- PIT
- ∕∕ BEDDING (INCLINED & HORIZONTAL)
- GEOLOGICAL CONTACT (OBS)
- GEOLOGICAL CONTACT (OBS)
- ⊠ BOULDER LAG
- ⊠ ADIT
- SWAMP
- TRANSITIONAL CONTACT
- - - CLAIM LINES

SILVERSIDE RES. INC.
 LUNDY CLAIM GROUP

SURFACE GEOLOGY

SCALE = 1" = 200'



0785-95
 2: 8865 (dup)

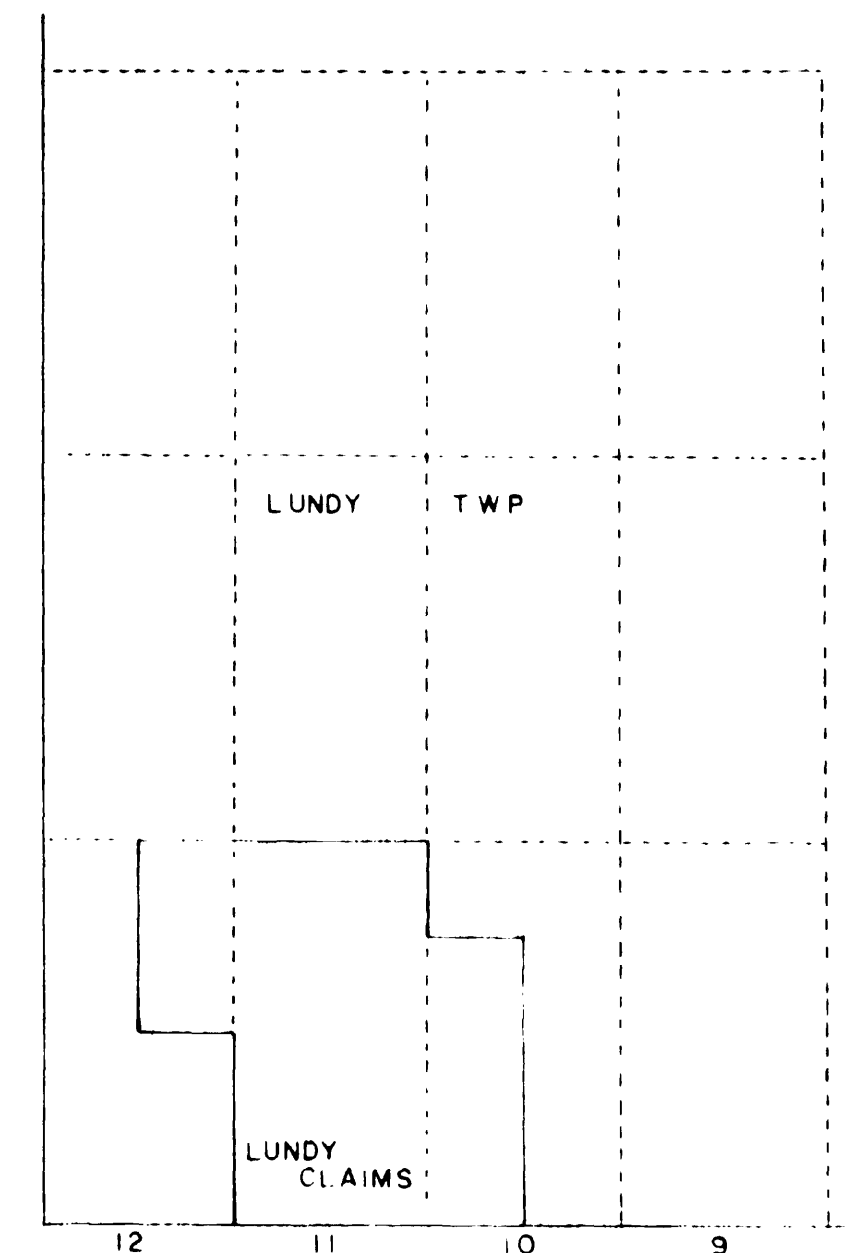
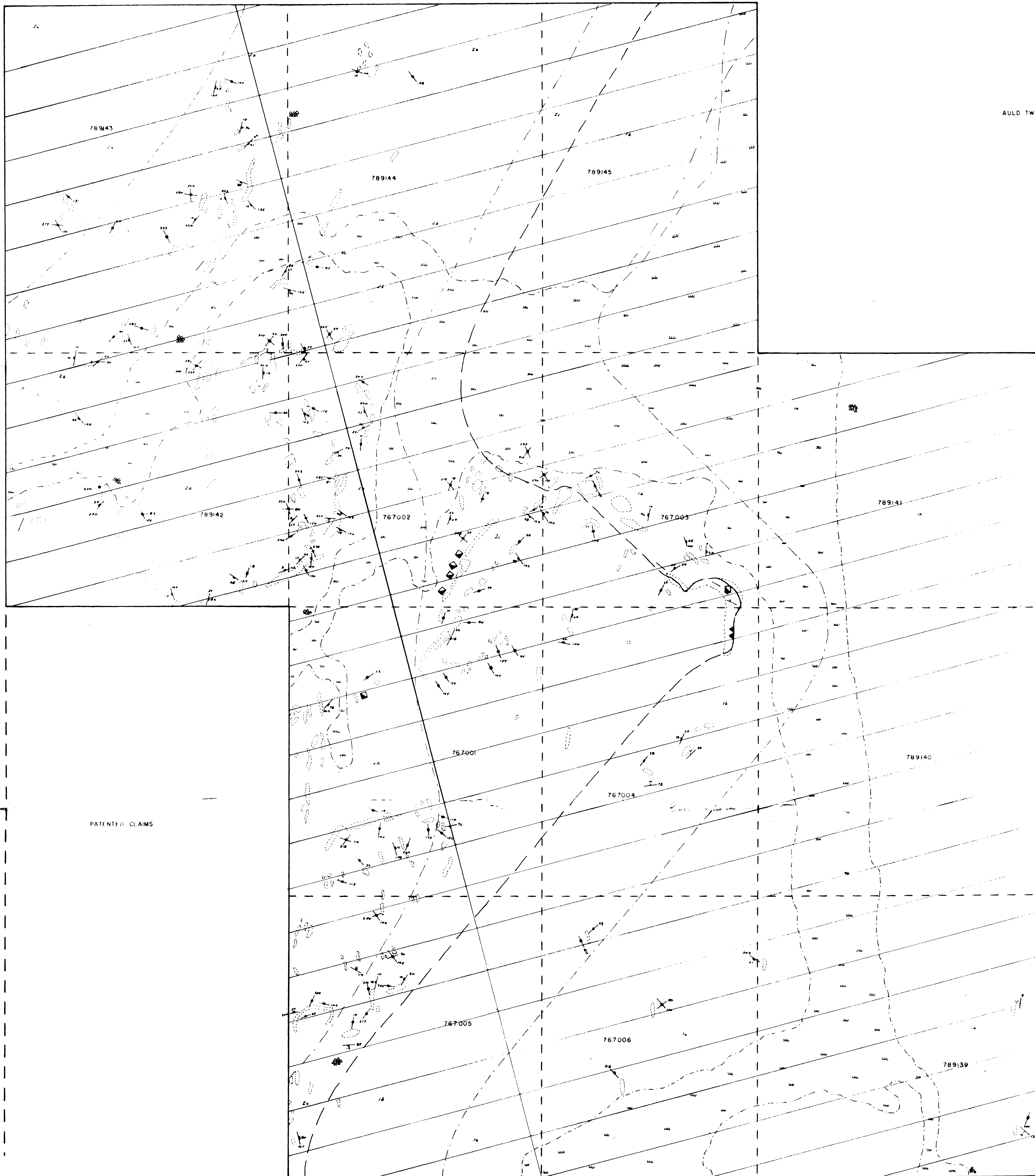

LEGEND

PRECAMBRIAN

EARLY PROTEROZOIC
 MAFIC INTRUSIVE ROCK
 NIPISSING DIABASE

2 2a VARIED TEXTURED DIABASE
 2b HYPERSTHENE DIABASE
 2c QUARTZ DIABASE

HURONIAN SUPERGROUP

COHALT GROUP
 GOWGANDA FORMATION
 FIRSTBROOK MEMBER

1 1a THINLY LAMINATED GREY TO BLACK ARGILLITE
 1b CONTACT METAMORPHOSED GREEN PELTIC SEDIMENTS

SYMBOLS

- OUTCROP
- /// JOINTING (INCLINED & VERTICAL)
- /// VEINS (INCLINED & HORIZONTAL)
- PIT
- /// BEDDING (INCLINED & HORIZONTAL)
- GEOLOGICAL CONTACT (OBS)
- GEOLOGICAL CONTACT (OBS)
- ⊞ BOULDER LAG
- ▲ ADIT
- SWAMP
- TRANSITIONAL CONTACT
- - - CLAIM LINES
- CUT LINES OF TRAVERSE 200' INTERVALS

SILVERSIDE RES. INC.
 LUNDY CLAIM GROUP

SURFACE GEOLOGY

SCALE = 1" = 200'

