

765, BOUL. QUÉBEC  
C.P. 428  
ROUYN-NORANDA, P.Q.  
J9X 5C4

Dessin et Reproduction  
Jalonnement de Claims  
Coupage de Lignes  
Levés Géophysiques  
Levés Géologiques  
Programmes d'Exploration  
Vente d'articles  
d'exploration minière

Drafting and Reproduction Services  
Claim Staking  
Line Cutting  
Geophysical Surveys  
Geological Surveys  
Exploration Programmes  
Sales of mining  
exploration articles

SUDBURY CONTACT MINES LTD.

GEOPHYSICAL SURVEYS

LUNDY TWP. PROPERTY

February 1995

2.17034

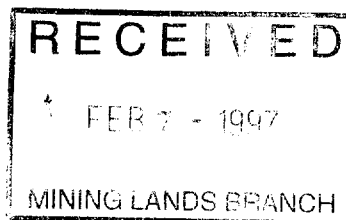

31M12SW0013 2.17034 LUNDY

TABLE OF CONTENTS

I - INTRODUCTION	P 1
II - PROPERTY	P 1
III - LOCATION & ACCESSIBILITY	P 2
IV - GEOPHYSICAL SURVEYS	P 2
V - CONCLUSION & RECOMMENDATIONS	P 6

MAPS & SKETCHES

1 - Index & Claim map	1:50 000
2 - Location Map	1:50 000
3 - Location Map	1:100 000



31M12SW0013 2.17034 LUNDY

010C

I - INTRODUCTION:

At the request of SUDBURY CONTACT MINES LTD.,  
geophysical surveys were undertaken, during the month  
of February, 1995, by Exploration Services Reg'd.,  
on parts of the "Lundy Twp." claim group.

Magnetometer surveys were carried out on 3 small  
grids to evaluate local aeromagnetic anomalies.  
V L F electromagnetic surveys were also carried out  
to obtain complementary information.

II - PROPERTY:

The "Lundy Twp." property consists of a block of  
4 claims located in the eastern part of Lundy Twp.  
These are described as follows:

<u>Claim #</u>	<u>Units</u>	<u>Coverage</u>
1202721	16	S 1/2 C IV      lots 3 & 4 N 1/2 C III      lots 3 & 4
1202722	16	S 1/2 C IV      lots 1 & 2 N 1/2 C III      lots 1 & 2
1202723	06	S 1/2 C III      lot 3 + W 1/2 lot 2
1202724	04	S 1/2 C III      lot 1

### III - LOCATION & ACCESSIBILITY:

The "Lundy Twp." claim group is located in the eastern area of Lundy Twp. at an approximate distance of 8 Km west of the town of New Liskeard, Ontario.

From New Liskeard, the claim area may be reached by travelling westward along highway 65 for a distance of 5 Km, then along an access road to the Twin Lakes area and up to the Lundy-Hudson township boundary, an additional travelling distance of 4 Km.

### IV - GEOPHYSICAL SURVEYS:

#### A) Magnetometer Surveys:

The surveys were carried out using an Exploranium G 816 Proton magnetometer with readings at every 12.5 m intervals.

The contoured data were plotted on a map at the scale of 1:2 500 and also on a coloured map at the scale of 1:5 000.

#### B) V L F Electromagnetic Surveys:

The surveys were carried out using a Geonics' EM-16 V L F unit tuned to the NAA station (24.0 KHz)

Readings were taken at every 12.5 meter intervals and the profiled data of the In-phase and out-of-phase components plotted on a map at the scale of 1:2 500.

GRID I:

GRID I consists of a 600 meter long east-west trending base line with cross lines spaced at every 100 meter intervals; these extend to the north for a distance of 400 m and to the south for a distance of 200 m for a total line coverage of 4.2 Km.

a) Magnetometer Survey:

The magnetometer survey has outlined a 300 meter long two-lobed, oval shaped negative anomaly in the central part of the grid.

This magnetic pattern is probably caused by a small mafic intrusive.

b) Electromagnetic Survey:

The V L F survey has outlined a northwest trending conductor which intercepts line 4E at 75 m south and line 1E at 100 m north. Its strongest response has been observed on line 2E.

Topographical features are the probable causes of this conductor.

GRID II:

GRID II consists of a 500 m long east-west trending base line with cross lines spaced at every 100 m intervals. The cross lines extend to the north for a distance of 300 m and to the south, also, for a distance of 300 m for a total line coverage of 4.0 Km

a) Magnetometer Survey:

A cluster of 3 very small magnetic anomalies outlined by the 750 gamma contour interval has been observed in the central part of the grid.

The combined effect of these small anomalies is the probable cause of the aeromagnetic anomaly of the area.

b) Electromagnetic Survey:

The V L F survey has failed to outline the presence of conductors on this grid.

GRID III:

GRID III consists of a 700 meter long east-west trending base line with cross lines at every 100 m intervals; these extend to the north and south for a length of 250 m for a total grid coverage of 4.2 Km.

a) Magnetometer Survey:

The 750 gamma contour interval outlines a 300 meter long oval-shaped magnetic anomaly.

This magnetic pattern is probably caused by a small mafic intrusive.

b) Electromagnetic Survey:

A very weak conductor has been outlined by the V L F survey trending in an SE-NW direction bordering the northern edge of the magnetic anomaly.

This conductor may be caused by local differences in physiography.

IV - CONCLUSIONS & RECOMMENDATIONS:

The magnetometer surveys have outlined an oval-shaped magnetic feature on grids # 1 and # 3. These small anomalies are probably caused by mafic intrusives.

The V L F electromagnetic surveys have outlined a conductor on grid # 1 and on grid # 3. These are probably caused by physiographical features.

It is recommended that reverse circulation drilling be implemented to assess the magnetic targets.

Respectfully submitted:

E. Chartré:  Feb. 25, 1995.



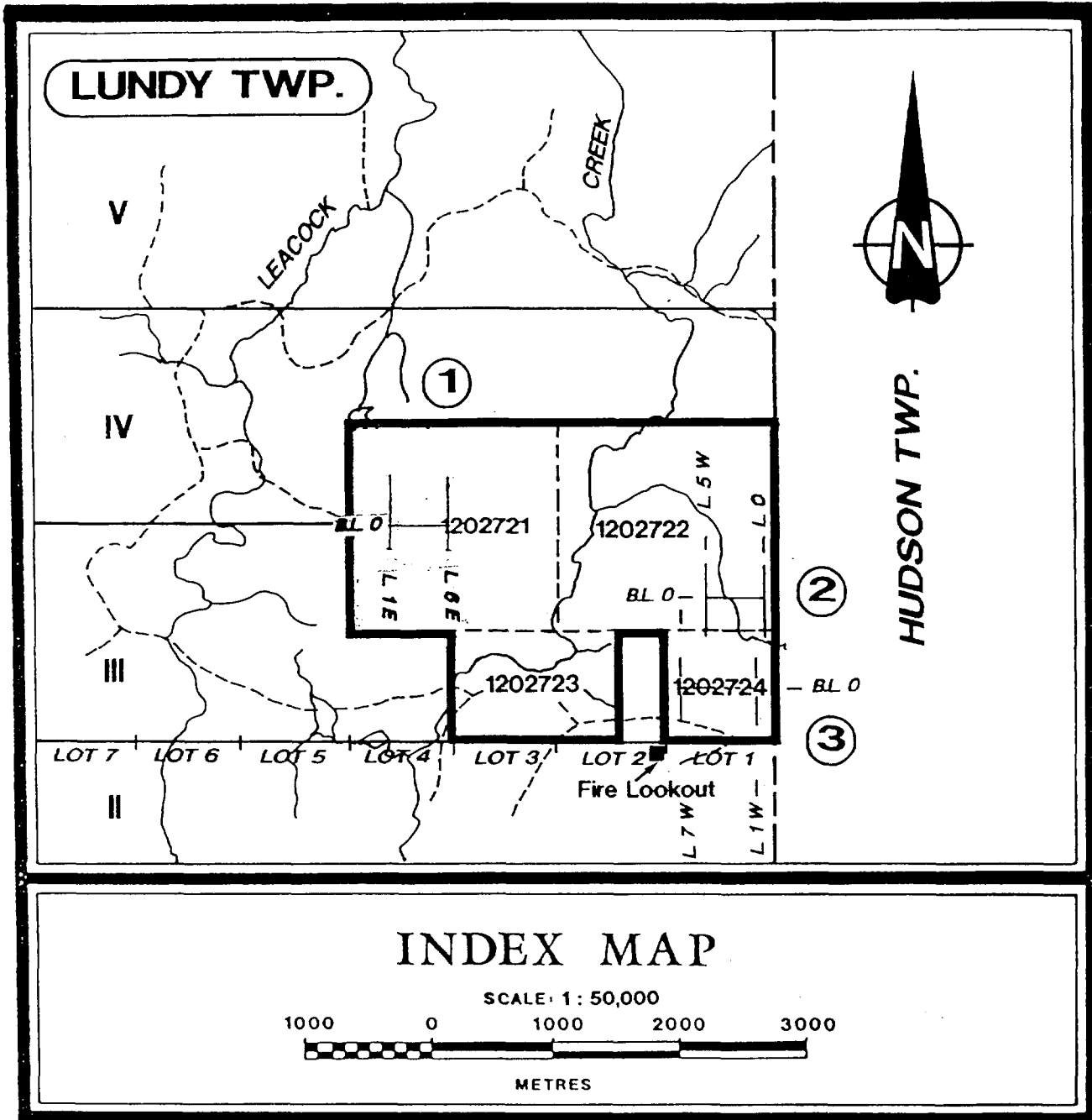

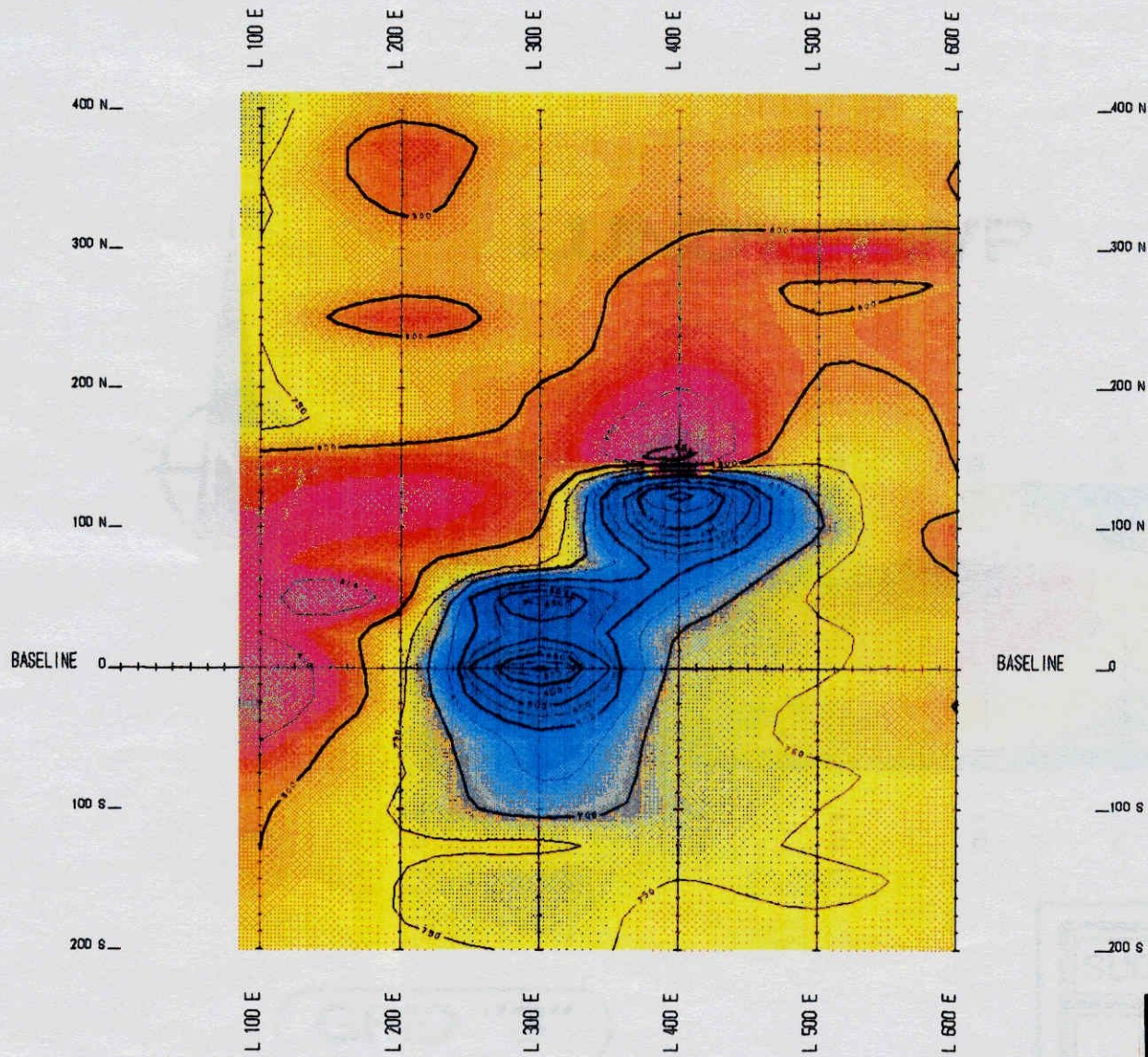

**LUNDY TWP.**

**GRID "1"**

<b>SUDBURY CONTACT MINES LTD.</b>	
<b>MAGNETOMETER SURVEY</b>	
<b>- LUNDY TWP. -</b>	
<b>FEB./95</b>	<b>1: 5,000</b>



# LUNDY TWP.



**GRID "2"**

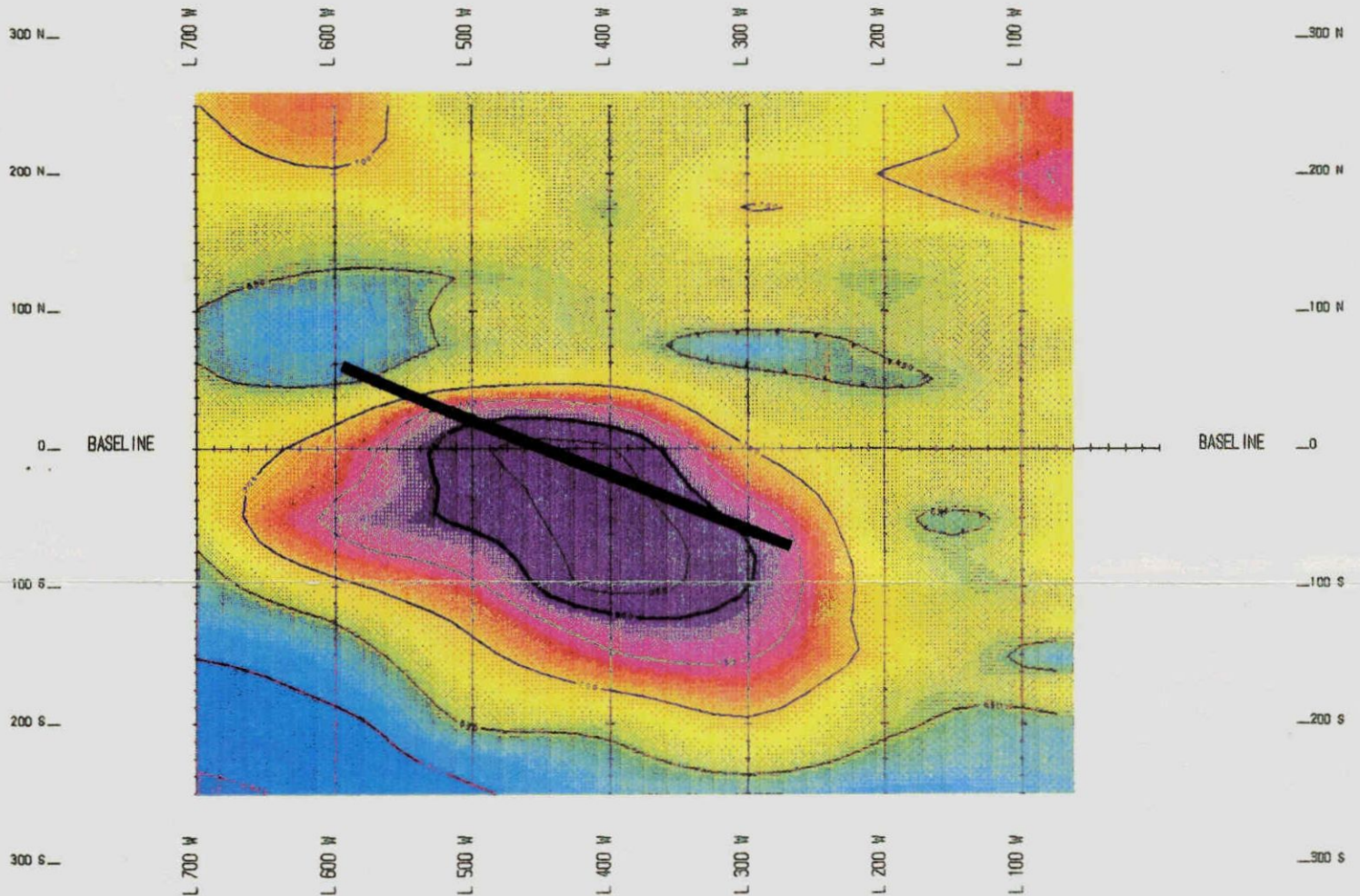
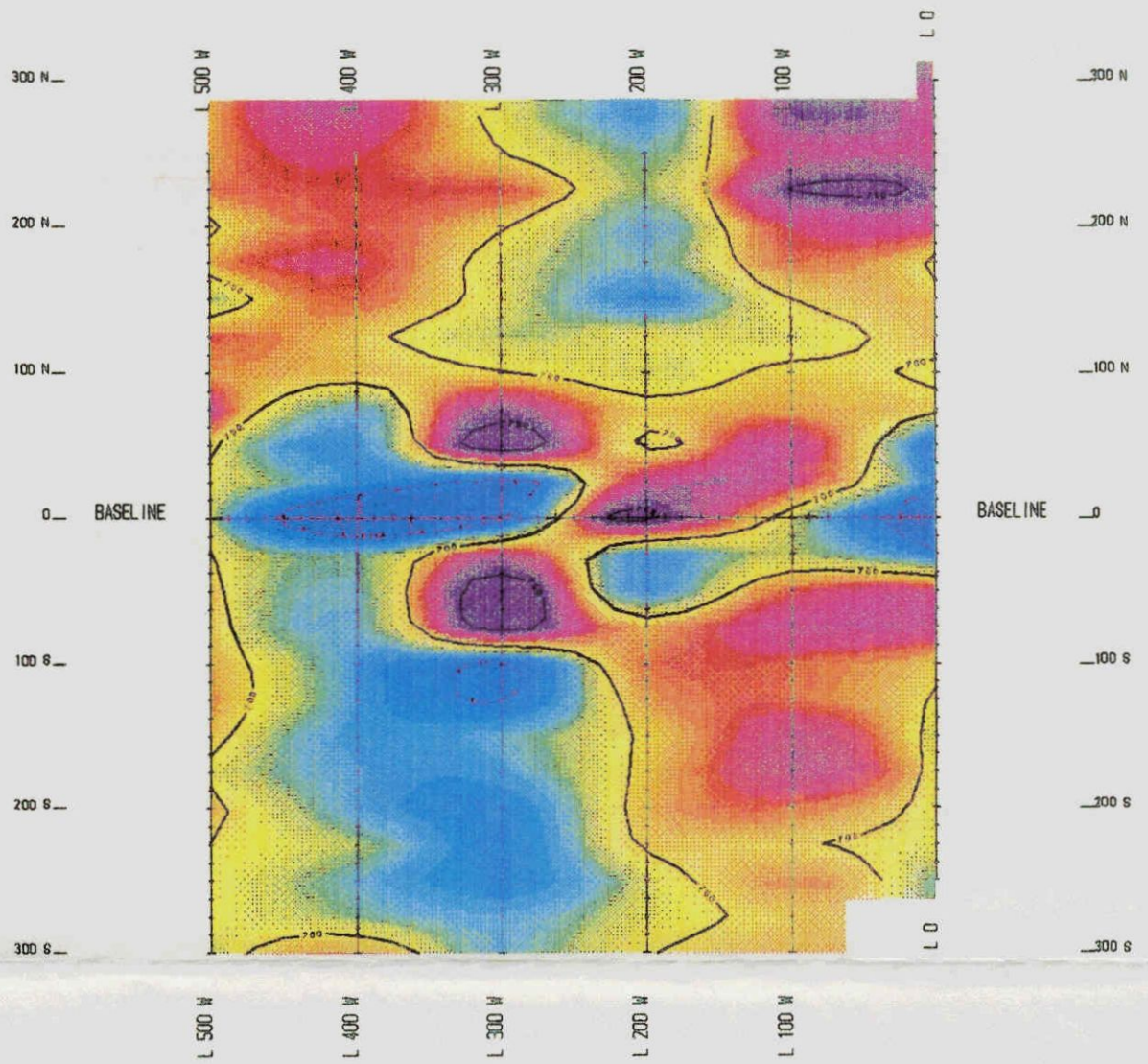

**GRID "3"**

**SUDBURY CONTACT MINES LTD.**

**MAGNETOMETER SURVEY**

**- LUNDY TWP.-**

**FEB./95**

**1:5,000**



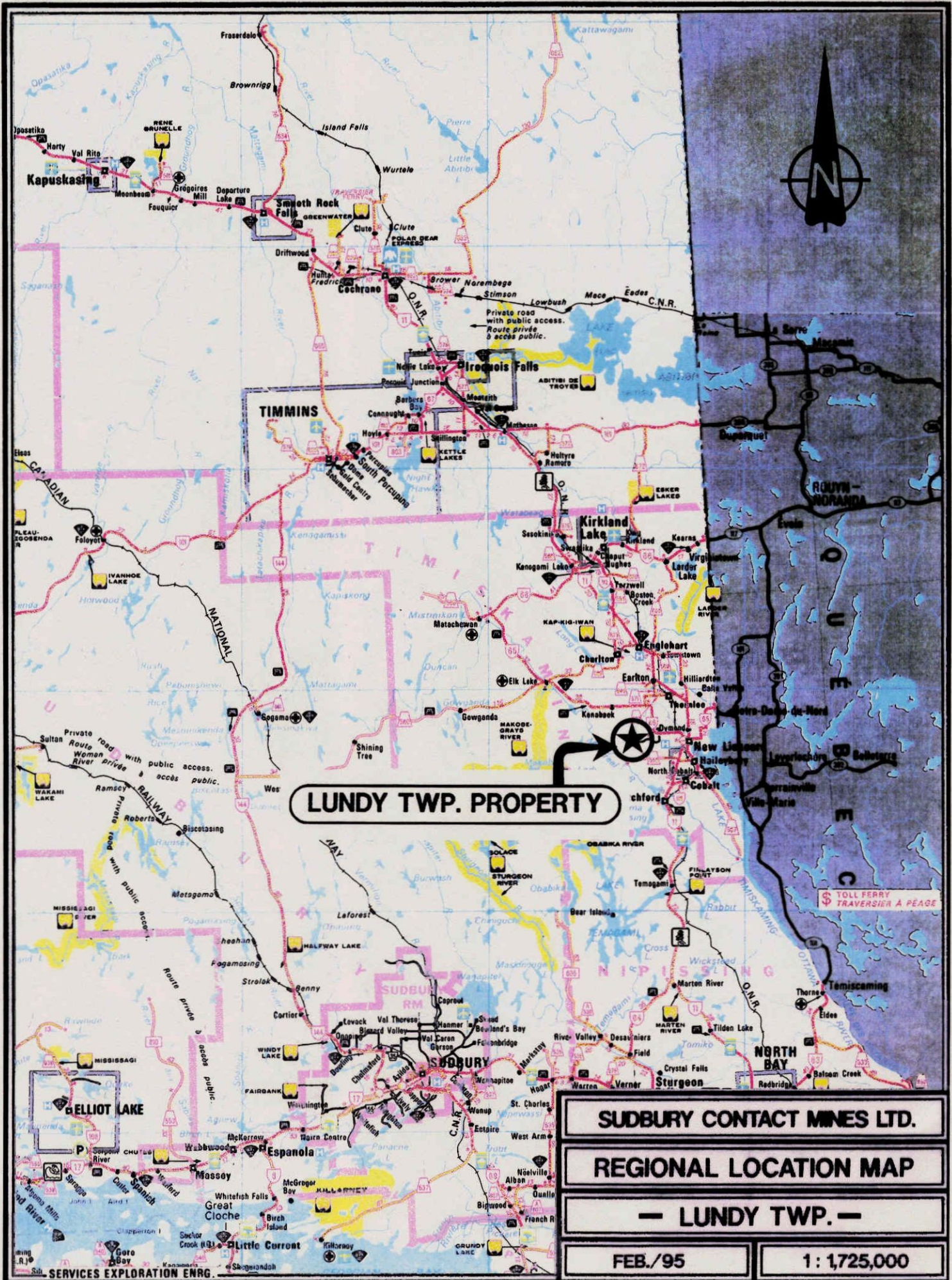

**LUNDY TWP. PROPERTY**

**SUDBURY CONTACT MINES LTD.**

**REGIONAL LOCATION MAP**

**- LUNDY TWP. -**

**FEB./95**

**1:1,725,000**



TOLL FERRY  
TRAVERSIER A PEAGE



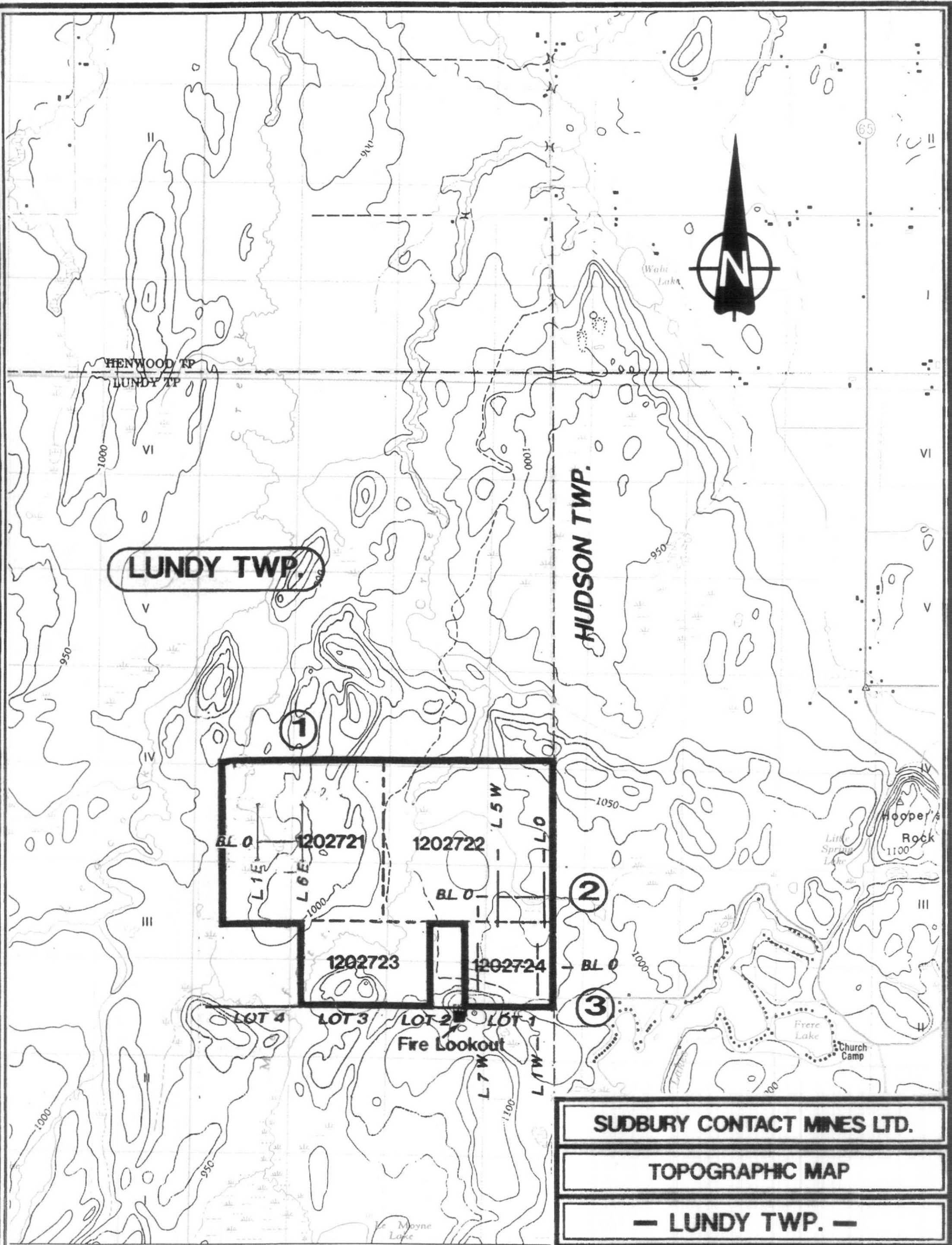

**LUNDY TWP.**

**HUDSON TWP.**

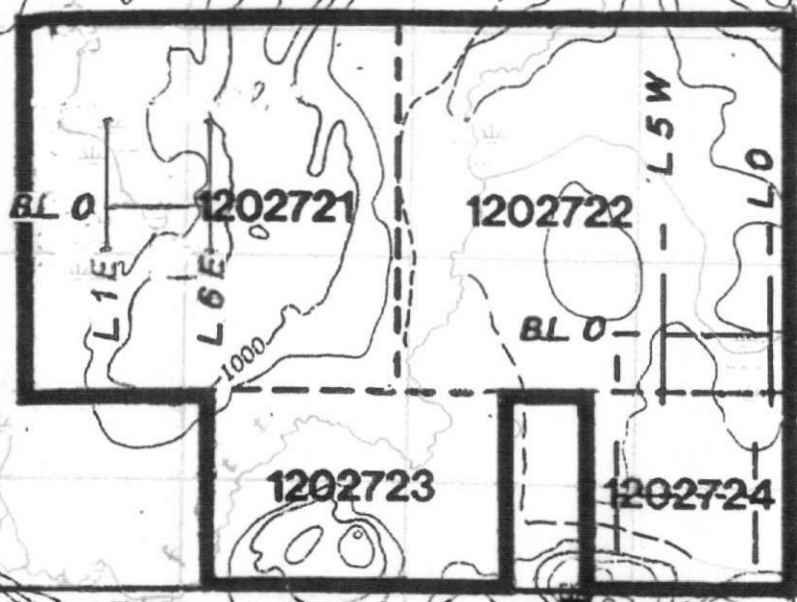

**2**

**3**

**SUDBURY CONTACT MINES LTD.**

**TOPOGRAPHIC MAP**

**— LUNDY TWP. —**

**FEB./95**

**1: 50,000**





**GRID "1"**

**RECEIVED**  
FEB 7 - 1997  
MINING LANDS BRANCH

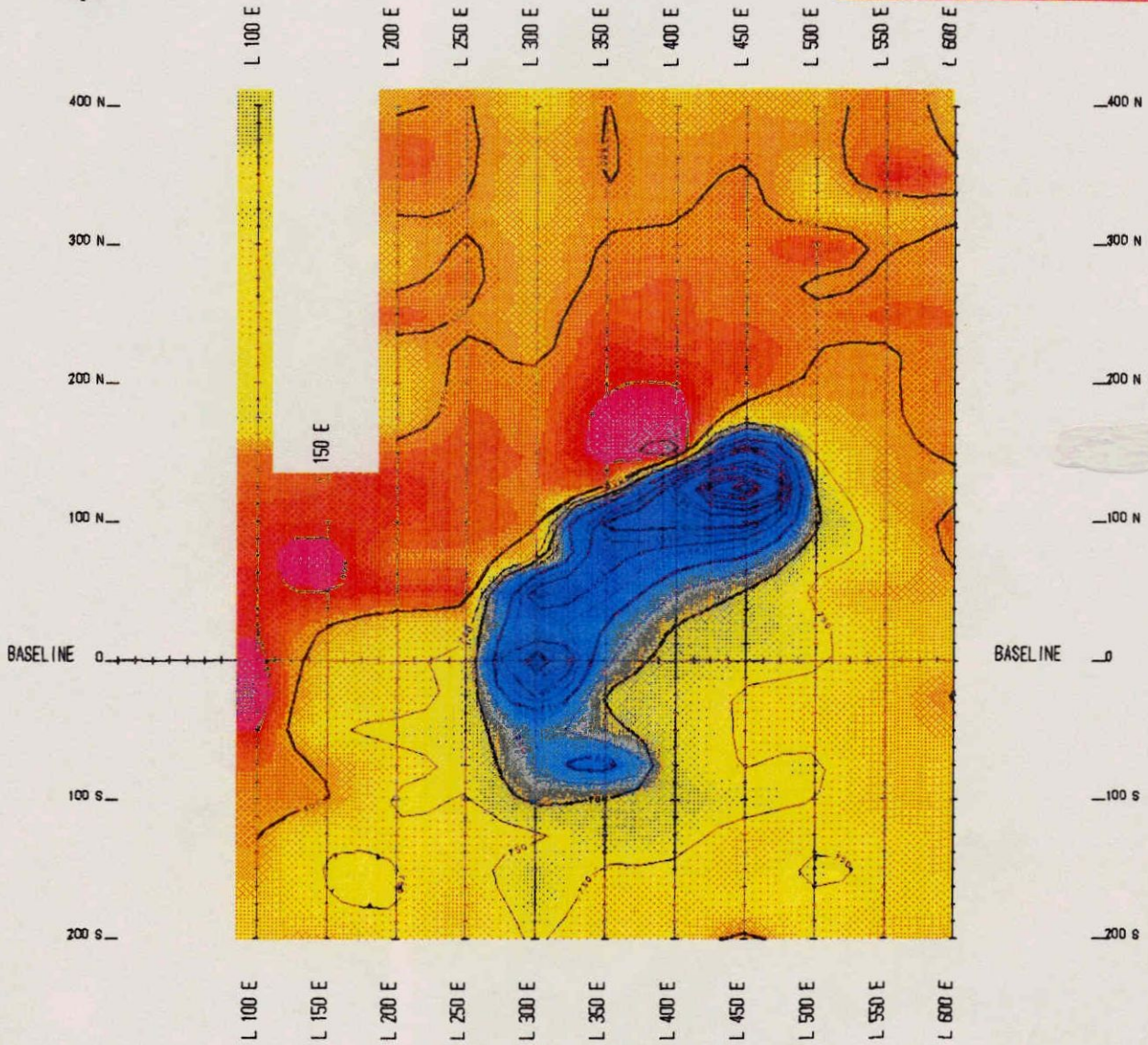

**LUNDY TWP.**

**SUDBURY CONTACT MINES LTD.**

**MAGNETOMETER SURVEY**

**- LUNDY TWP. -**

April /95

1 : 5,000

## **Addendum**

In April of 1995 an additional 2.7 km of line was cut on grid 95 - 1 at the 50 metre interval (150E, 250E, 350E, 450E, and 550E ). A magnetic survey was then conducted on these lines in order to further define the flattened circular magnetic low anomaly.

Please refer to additional maps;

1:5000	Colour Magnetic Contour (report)
1:2500	Magnetic Contour (map pouch)



Ministry of Northern Development and Mines

### Declaration of Assessment Work Performed on Mining Land

Mining Act, Subsections 65(2) and 66(3), R.S.O. 1990

Transaction Number (office use) <b>W9780.00082</b>
Assessment Files Research Imaging

*GAO*

Personal information collected on this form is obtained under the authority of subsections 65(2) and 66(3) of the Mining Act. Under section 8 of the Mining Act, the information is a public record. This information will be used to review the assessment work and correspond with the mining land holder. Questions about 933 Ramsey Lake of Northern Development and Mines, 6th Floor.



31M12SW0013 2.17034 LUNDY

Instructions:

aim, use form 0240.

900

**2.17034**

**1. Recorded holder(s) (Attach a list if necessary)**

Name <b>SUDBURY CONTACT MINES LTD</b>	Client Number <b>198617</b>
Address <b>#2302-401 BAY ST.</b>	Telephone Number <b>416-947-1212</b>
<b>TORONTO, ONTARIO, M5H 2Y4</b>	Fax Number <b>416-367-4681</b>
Name	Client Number
Address	Telephone Number
	Fax Number

**2. Type of work performed: Check (✓) and report on only ONE of the following groups for this declaration.**

- Geotechnical: prospecting, surveys, assays and work under section 18 (regs)       Physical: drilling, stripping, trenching and associated assays       Rehabilitation

Work Type <b>Line cutting, Ground Magnetic and VLF Electromagnetic Surveying</b>	Office Use
	Commodity
	Total \$ Value of Work Claimed <b>7,358</b>
Dates Work Performed From <b>15 02 95</b> To <b>15 04 95</b>	NTS Reference
Global Positioning System Data (if available)	Mining Division <b>Larder Lake</b>
Township/Area <b>LUNDY TWP.</b>	Resident Geologist District <b>Cobalt</b>
M or G-Plan Number <b>G-3439</b>	

- Please remember to:
- obtain a work permit from the Ministry of Natural Resources as required;
  - provide proper notice to surface rights holders before starting work;
  - complete and attach a Statement of Costs, form 0212;
  - provide a map showing contiguous mining lands that are linked for assigning work;
  - include two copies of your technical report.

**3. Person or companies who prepared the technical report (Attach a list if necessary)**

Name <b>E. CHARTRE, SERVICES EXPLORATION ENR,</b>	Telephone Number <b>819-797-0853</b>
Address <b>765, BOUL. QUÉBEC, C.P. 425, ROUYN-NORANDA, P.Q. J9A 5K4</b>	Fax Number <b>819-797-1848</b>
Name	Telephone Number
Address	Fax Number
Name <b>Received Larder Lake Mining Division Feb. 5 1997 H.C.J.</b>	Telephone Number
Address	Fax Number



**4. Certification by Recorded Holder or Agent**

I, DAVID W. CHRISTIE, do hereby certify that I have personal knowledge of the facts set forth in this Declaration of Assessment Work having caused the work to be performed or witnessed the same during or after its completion and, to the best of my knowledge, the annexed report is true.

Signature of Recorded Holder or Agent <i>David Christie</i>	Date <b>Jan 30/97</b>
Agent's Address <b>#1401-141 Adelaide St. W., Tor. Ont., M5H 3L5</b>	Telephone Number <b>416-364-2895</b>
	Fax Number <b>416-364-5384</b>



5. Work to be recorded and distributed. Work can only be assigned to claims that are contiguous (adjoining) to the mining land where work was performed, at the time work was performed. A map showing the contiguous link must accompany this form.

W9790.00082

Mining Claim Number. Or if work was done on other eligible mining land, show in this column the location number indicated on the claim map.		Number of Claim Units. For other mining land, list hectares.	Value of work performed on this claim or other mining land.	Value of work applied to this claim.	Value of work assigned to other mining claims.	Bank. Value of work to be distributed at a future date.
eg	TB 7827	16 ha	\$26,825	N/A	\$24,000	\$2,825
eg	1234567	12	0	\$24,000	0	0
eg	1234568	2	\$8,892	\$4,000	0	\$4,892
1	1202721	16 units	3362	0	0	3362
2	1202722	16 units	1949	0	0	1949
3	1202724	4 units	2047	0	0	2047
4						
5						
6						
7						
8						
9						
10						
11						
12						
13						
14						
15						
Column Totals			7358	0	0	7358

I, DAVID W. CHRISTIE, do hereby certify that the above work credits are eligible under subsection 7 (1) of the Assessment Work Regulation 6/96 for assignment to contiguous claims or for application to the claim where the work was done.

Signature of Recorded Holder or Agent Authorized in Writing: [Signature] Date: Jun 30 1997

6. Instructions for cutting back credits that are not approved.

Some of the credits claimed in this declaration may be cut back. Please check (✓) in the boxes below to show how you wish to prioritize the deletion of credits:

- 1. Credits are to be cut back from the Bank first, followed by option 2 or 3 or 4 as indicated.
- 2. Credits are to be cut back starting with the claims listed last, working backwards; or
- 3. Credits are to be cut back equally over all claims listed in this declaration; or
- 4. Credits are to be cut back as prioritized on the attached appendix or as follows described

**RECEIVED**  
FEB 7 - 1997  
MINING LANDS BRANCH

Note: If you have not indicated how your credits are to be deleted, credits will be cut back from the Bank first, followed by option number 2 if necessary.

For Office Use Only

Received Stamp	Deemed Approved Date <u>May 6 1997</u>	Date Notification Sent
	Date Approved <u>[Signature]</u>	Total Value of Credit Approved
	Approved for Recording by Mining Recorder (Signature) <u>[Signature]</u>	

11:02



Ministry of  
Northern Development  
and Mines

Ministère du  
Développement du Nord  
et des mines

**Statement of Costs  
for Assessment Credit**

**État des coûts aux fins  
du crédit d'évaluation**

Mining Act/Loi sur les mines

Transaction No./N° de transaction

W9780.00082

Personal information collected on this form is obtained under the authority of the Mining Act. This information will be used to maintain a record and ongoing status of the mining claim(s). Questions about this collection should be directed to the Provincial Manager, Minings Lands, Ministry of Northern Development and Mines, 4th Floor, 159 Cedar Street, Sudbury, Ontario P3E 6A5, telephone (705) 670-7264.

Les renseignements personnels contenus dans la présente formule sont recueillis en vertu de la Loi sur les mines et serviront à tenir à jour un registre des concessions minières. Adresser toute question sur la collecte de ces renseignements au chef provincial des terrains miniers, ministère du Développement du Nord et des Mines, 159, rue Cedar, 4<sup>e</sup> étage, Sudbury (Ontario) P3E 6A5, Téléphone (705) 670-7264.

**1. Direct Costs/Coûts directs**

Type	Description	Amount Montant	Totals Total global
Wages Salaires	Labour Main-d'oeuvre		
	Field Supervision Supervision sur le terrain	941.00	
Contractor's and Consultant's Fees Droits de l'entrepreneur et de l'expert- conseil	Type Management & Administration	716.46	
	Geophysicist Linecutting	6000.00	
			7357.46
Supplies Used Fournitures utilisées	Type		
Equipment Rental Location de matériel	Type		
<b>Total Direct Costs Total des coûts directs</b>			<b>7357.46</b>

**2. Indirect Costs/Coûts indirects**

\*\* Note: When claiming Rehabilitation work Indirect costs are not allowable as assessment work.  
Pour le remboursement des travaux de réhabilitation, les coûts indirects ne sont pas admissibles en tant que travaux d'évaluation.

Type	Description	Amount Montant	Totals Total global
Transportation Transport	Type		
		2.17034	
Food and Lodging Nourriture et hébergement			
Mobilization and Démobilisation Mobilisation et démobilisation			
<b>Sub Total of Indirect Costs Total partiel des coûts indirects</b>			
Amount Allowable (not greater than 20% of Direct Costs) Montant admissible (n'excédant pas 20 % des coûts directs)			
Total Value of Assessment Credit (Total of Direct and Allowable indirect costs)		Valeur totale du crédit d'évaluation (Total des coûts directs et indirects admissibles)	

**RECEIVED**  
 FEB 7 - 1997  
 MINING LANDS BRANCH

Note: The recorded holder will be required to verify expenditures claimed in this statement of costs within 30 days of a request for verification. If verification is not made, the Minister may reject for assessment work all or part of the assessment work submitted.

Note : Le titulaire enregistré sera tenu de vérifier les dépenses demandées dans le présent état des coûts dans les 30 jours suivant une demande à cet effet. Si la vérification n'est pas effectuée, le ministre peut rejeter tout ou une partie des travaux d'évaluation présentés.

**Filing Discounts**

1. Work filed within two years of completion is claimed at 100% of the above Total Value of Assessment Credit.
2. Work filed three, four or five years after completion is claimed at 50% of the above Total Value of Assessment Credit. See calculations below:

**Remises pour dépôt**

1. Les travaux déposés dans les deux ans suivant leur achèvement sont remboursés à 100 % de la valeur totale susmentionnée du crédit d'évaluation.
2. Les travaux déposés trois, quatre ou cinq ans après leur achèvement sont remboursés à 50 % de la valeur totale du crédit d'évaluation susmentionné. Voir les calculs ci-dessous.

Total Value of Assessment Credit	Total Assessment Claimed
	x 0.50 =

Valeur totale du crédit d'évaluation	Evaluation totale demandée
	x 0.50 =

**Certification Verifying Statement of Costs**

I hereby certify:  
that the amounts shown are as accurate as possible and these costs were incurred while conducting assessment work on the lands shown on the accompanying Report of Work form.

**Attestation de l'état des coûts**

J'atteste par la présente :  
que les montants indiqués sont le plus exact possible et que ces dépenses ont été engagées pour effectuer les travaux d'évaluation sur les terrains indiqués dans la formule de rapport de travail ci-joint.

that as PROJECT GEOLOGIST I am authorized  
(Recorded Holder, Agent, Position in Company)

Et qu'à titre de \_\_\_\_\_ je suis autorisé  
(titulaire enregistré, représentant, poste occupé dans la compagnie)

to make this certification

à faire cette attestation.

Signature [Signature] Date Jan 24 97



April 2, 1997

Roy Spooner  
Mining Recorder  
4 Government Road East  
Kirkland Lake, ON  
P2N 1A2

Geoscience Assessment Office  
933 Ramsey Lake Road  
6th Floor  
Sudbury, Ontario  
P3E 6B5

Telephone: (705) 670-5853  
Fax: (705) 670-5863

Dear Sir or Madam:

Submission Number: 2.17034

**Status**

**Subject: Transaction Number(s):** W9780.00082 Deemed Approval

---

We have reviewed your Assessment Work submission with the above noted Transaction Number(s). The attached summary page(s) indicate the results of the review. WE RECOMMEND YOU READ THIS SUMMARY FOR THE DETAILS PERTAINING TO YOUR ASSESSMENT WORK.

If the status for a transaction is a 45 Day Notice, the summary will outline the reasons for the notice, and any steps you can take to remedy deficiencies. The 90-day deemed approval provision, subsection 6(7) of the Assessment Work Regulation, will no longer be in effect for assessment work which has received a 45 Day Notice.

Please note any revisions must be submitted in DUPLICATE to the Geoscience Assessment Office, by the response date on the summary.

NOTE: This correspondence may affect the status of your mining lands. Please contact the Mining Recorder to determine the available options and the status of your claims.

If you have any questions regarding this correspondence, please contact Bruce Gates by e-mail at gates\_b@torv05.ndm.gov.on.ca or by telephone at (705) 670-5856.

Yours sincerely,

A handwritten signature in black ink, appearing to read "Ron C. Gashinski".

ORIGINAL SIGNED BY  
Ron C. Gashinski  
Senior Manager, Mining Lands Section  
Mines and Minerals Division

# Work Report Assessment Results

---

**Submission Number:** 2.17034

**Date Correspondence Sent:** April 02, 1997

**Assessor:** Bruce Gates

---

<b>Transaction Number</b>	<b>First Claim Number</b>	<b>Township(s) / Area(s)</b>	<b>Status</b>	<b>Approval Date</b>
W9780.00082	1202721	LUNDY	Deemed Approval	April 01, 1997

**Section:**

14 Geophysical MAG

14 Geophysical VLF

**Correspondence to:**

Mining Recorder  
Kirkland Lake, ON

Resident Geologist  
Cobalt, ON

Assessment Files Library  
Sudbury, ON

**Recorded Holder(s) and/or Agent(s):**

David W. Christie  
TORONTO, ONTARIO, CANADA

SUDBURY CONTACT MINES LIMITED  
TORONTO, Ontario

Statement of Expenditures  
Sudbury Contact Mines Ltd.  
Project #216 - Montreal River "A"  
Ground Geophysical Surveys  
Feb., March 1995

Project Geologist	266.00
Contract Geologist	675.00
Line Cutting & Geophysical Surveys	6000.00
Administration / Management	416.46
	<hr/>
	7357.46

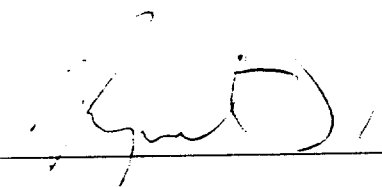
Certified By:   
Raymond J. Knowles, B.Sc.

**2.17034**

Date:

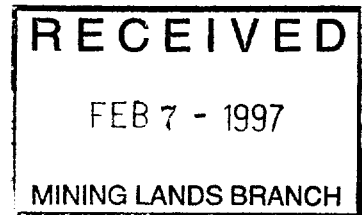

Project #216 - Ground Mag & VLF/EM  
Allocation of Expenditures

Claim #	Staking Date	100m spacing		50m spacing		Total Cost
		Survey Date	Survey Cost	Survey Date	Survey Cost	
1202721	94/12/13	95/02/15	2047	95/04/01	1315	3362
1202722	94/12/18	95/02/15	1949	-----	-----	1949
1202724	94/12/13	95/02/15	2047	-----	-----	2047

2.17034

RECEIVED  
FEB 7 - 1997  
MINING LANDS BRANCH





INDEX TO LAND DISPOSITION

PLAN  
G-3439  
TOWNSHIP  
LUNDY

M.N.R. ADMINISTRATIVE DISTRICT  
TEMAGAMI  
JANUARY 1997  
LARDER LAKE  
LAND TITLES & SURVEY DIVISION  
TIMISKAMING

DATE OF ISSUE

FEB 6 1997

LARDER LAKE  
MINING RECORDER'S OFFICE

RECEIVED

FEB 7 - 1997  
MINING LANDS BRANCH

Scale 1:20 000

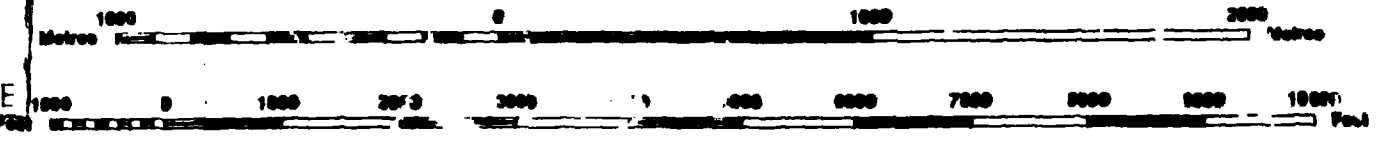

Contour Interval 10 Metres

AREAS WITHDRAWN FROM DISPOSITION

Order No.	Date	Disposition	File
SEC 36/80	W.2/85	25/2/88	S.R.1.
SEC 36/80	W.2/85	25/2/88	S.R.1.
SEC 36/80	W.2/85	25/2/88	S.R.1.
ORDER NO. L-18/86	NER OPENS	W.11/85	NER

SYMBOLS

Boundary	.....
Township, Meridian, E. line	.....
Road allowance, surveyed	.....
shoreline	.....
Lot/Concession, surveyed	.....
unsurveyed	.....
Parcel, surveyed	.....
unsurveyed	.....
Right-of-way, road	.....
railway	.....
utility	.....
Reservation	.....
Cliff, Pt, Pile	.....
Contour	.....
Interpreted	.....
Approximate	.....
Depression	.....
Contr. point (v. l. zonal)	.....
Flood, land	.....
Mine lead from	.....
Pipe rd (above ground)	.....
Rd way: single track	.....
double track	.....
and/or	.....
Road, highway, county, township	.....
access	.....
trail, bush	.....
Shoreline (original)	.....
Transmission line	.....
Wooded area	.....

DISPOSITION OF CROWN LANDS

Patent	.....
Surface & Mining Rights	.....
Surface Rights Only	.....
Mining Rights Only	.....
Lease	.....
Surface & Mining Rights	.....
Surface Rights Only	.....
Mining Rights Only	.....
License of Occupation	.....
Order-in-Council	.....
Cancelled	.....
Reservation	.....
Sand & Gravel	.....

THIS TOWNSHIP FALLS WITHIN THE TEMAGAMI COMPREHENSIVE PLANNING AREA. SPECIAL WORKING CONDITIONS MAY APPLY TO EXPLORATION ACTIVITIES. FOR MORE DETAILS PLEASE CONTACT: DISTRICT MANAGER, NORTH BAY DISTRICT, MINISTRY, NATURAL RESOURCES

NOTICE OF FORESTRY ACTIVITY

THIS TOWNSHIP / AREA FALLS WITHIN THE LATCHFORD MANAGEMENT UNIT AND MAY BE SUBJECT TO FORESTRY OPERATIONS. THE MNR UNIT FORESTER FOR THIS AREA CAN BE CONTACTED AT: P.O. BOX 38, LAKE SHORE DRIVE, TEMAGAMI, ONT. P0H 2H0, 705-569-3622

CIRCULATED APRIL 19/88 ARCHIVED APRIL 3, 1995

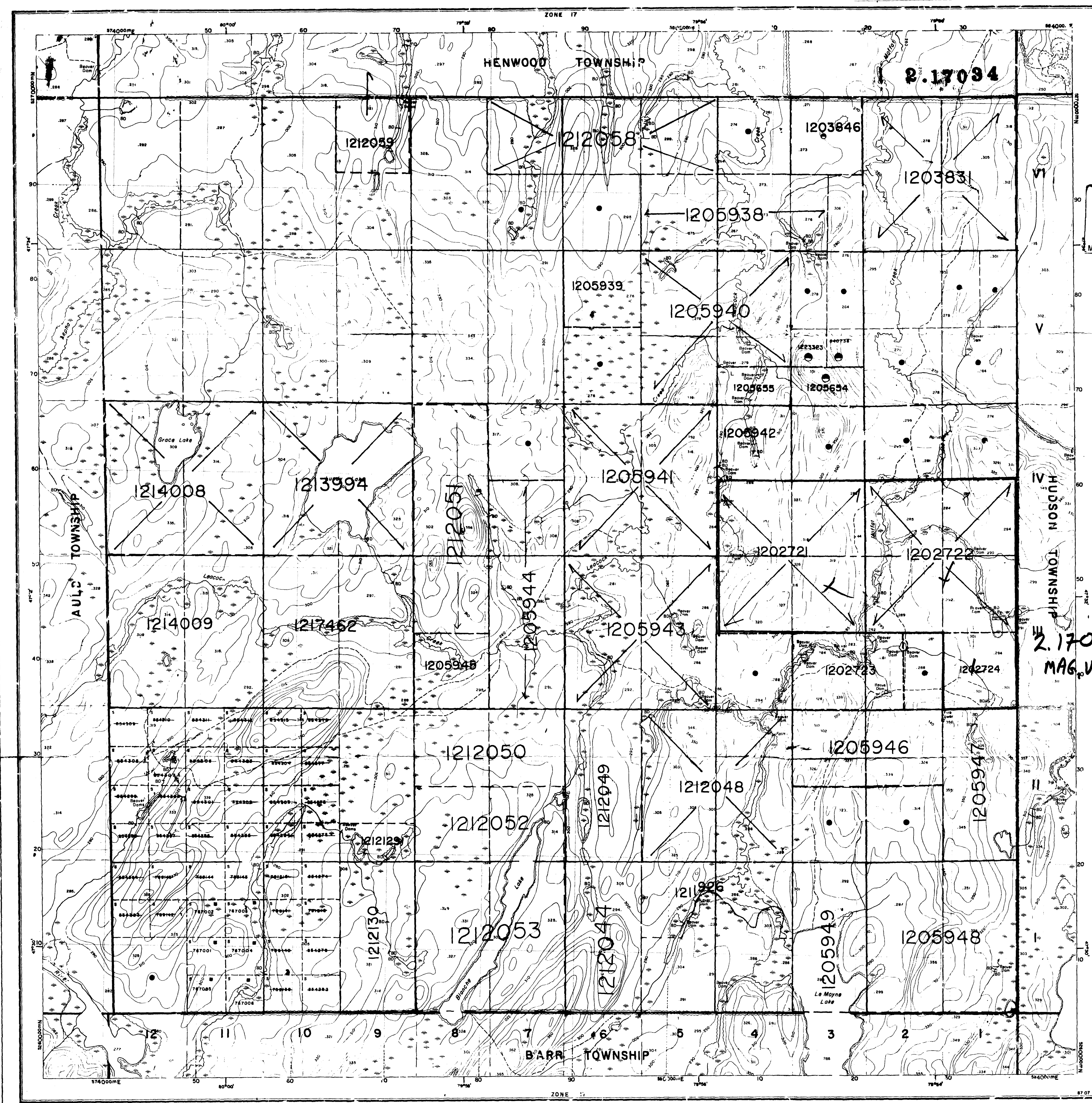

2.17034  
MAG. V. 6 F



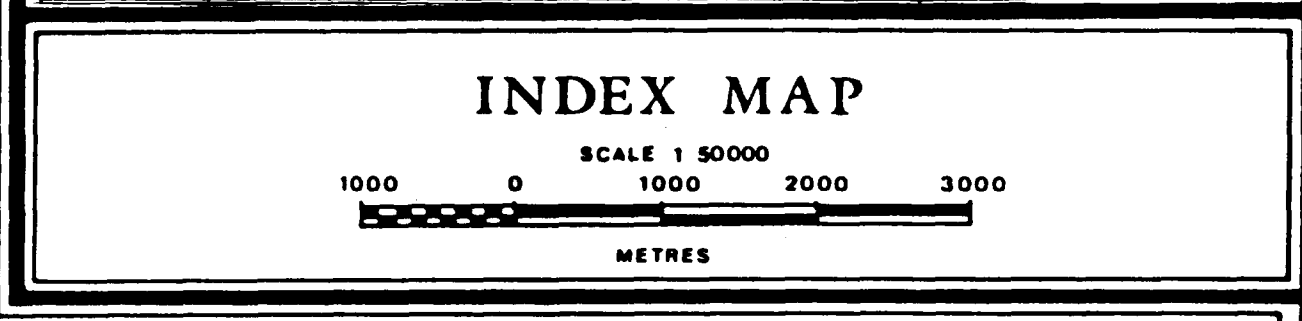
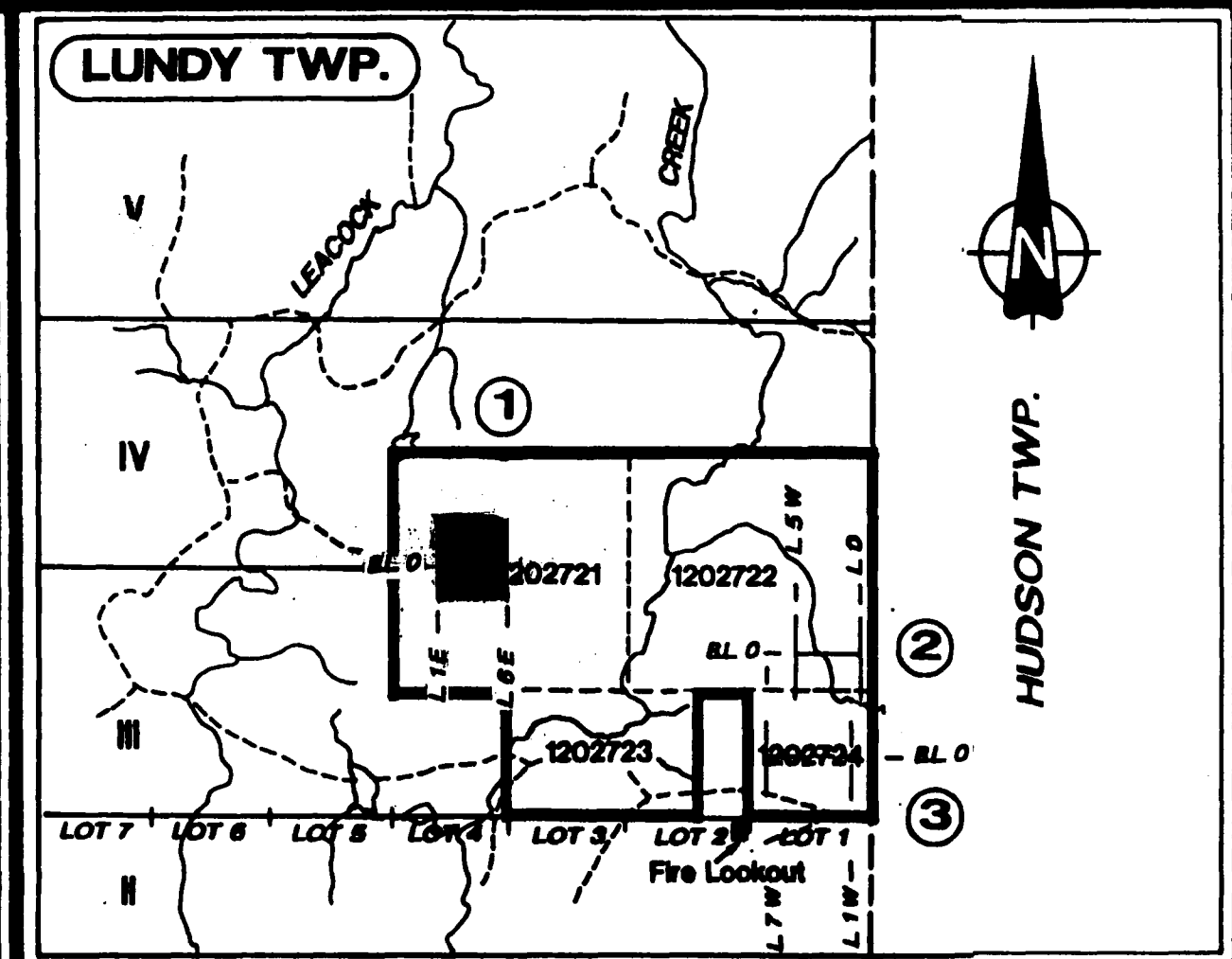
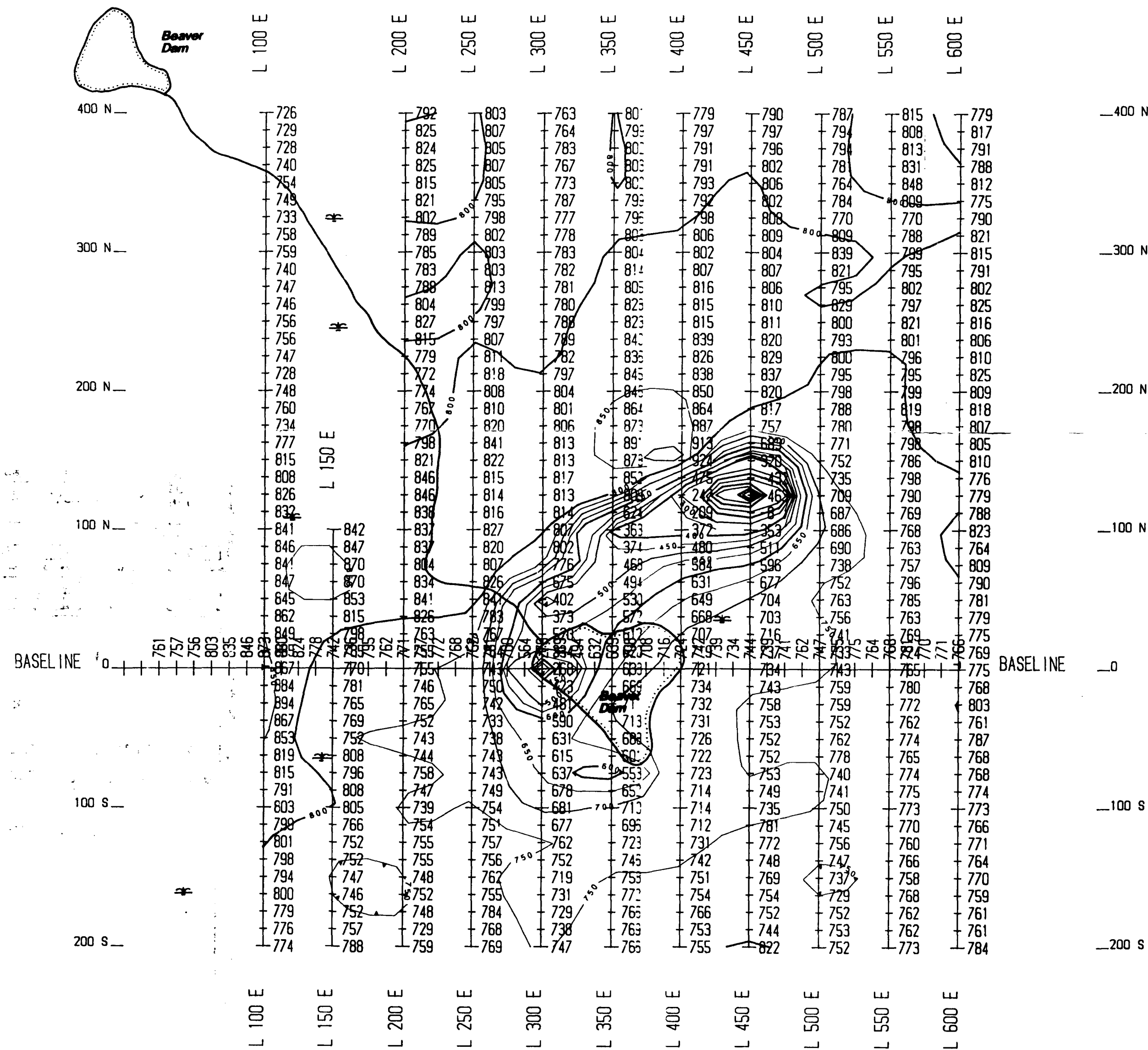
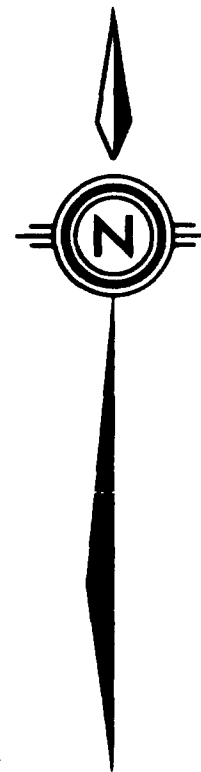

**GRID "1"**

RECEIVED  
 APR 7 - 1997  
 MINING LANDS BRANCH

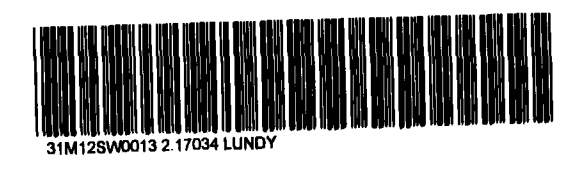

210

50 Metre Line Spacing  
 ALL READINGS IN RANGE OF 57,000 GAMMAS

<b>MAGNETOMETER SURVEY</b>	
FOR	
<b>SUDBURY CONTACT MINES LTD.</b>	
PROJECT: <b>LUNDY TWP. GRID 1</b>	
Instrument: PROTON G-816	SURVEYED BY: <b>R. CRAIG</b> DATE: April 1995
TWR: <b>LUNDY</b>	DRAWN BY: <b>S. Sigouin</b> SCALE: 1:2,500
SERVICES EXPLORATION SERVICES ENRG. REG'D.	



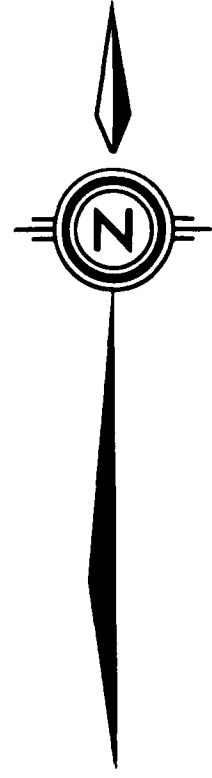

GRID "2"

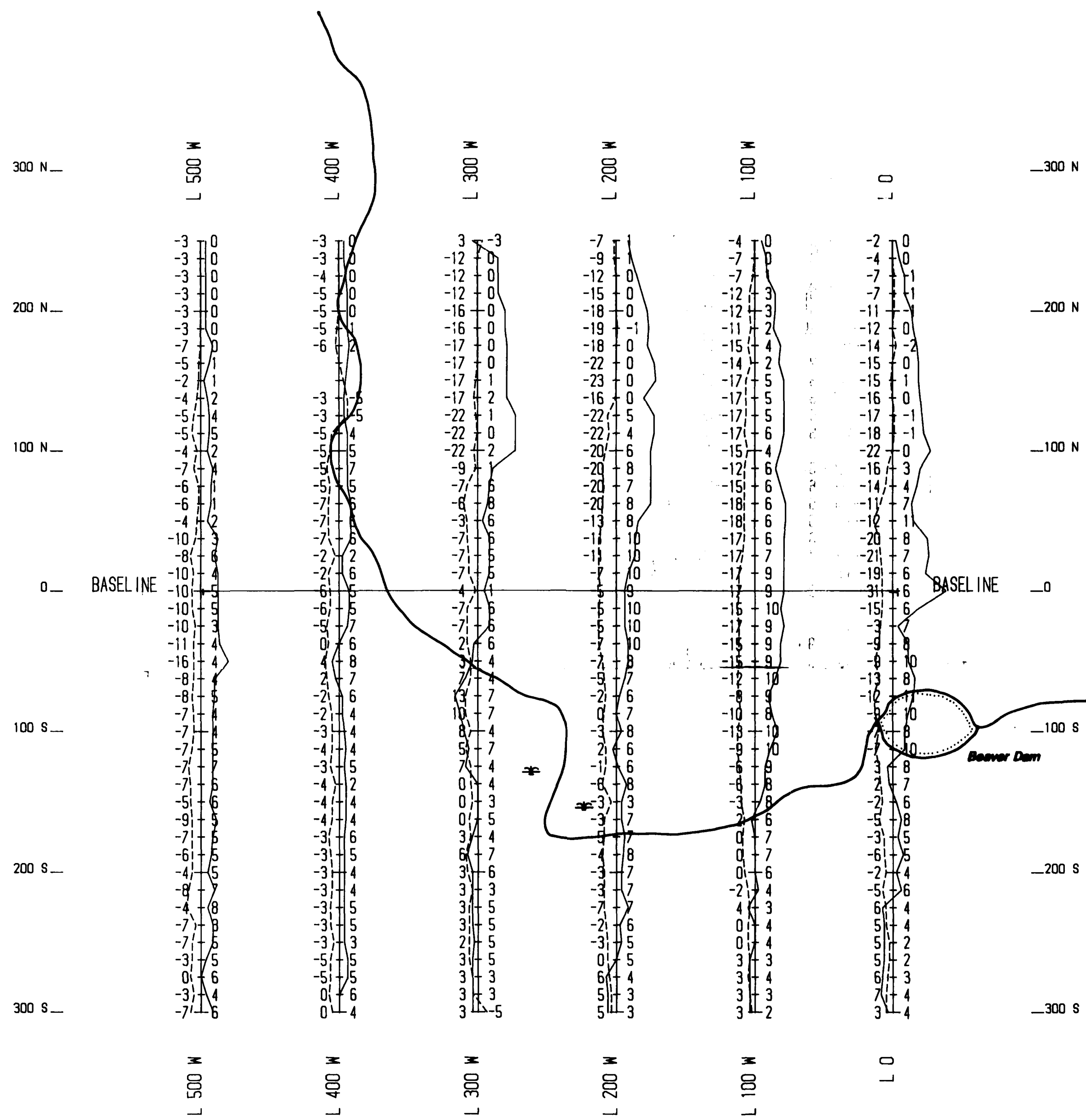

GRID "3"

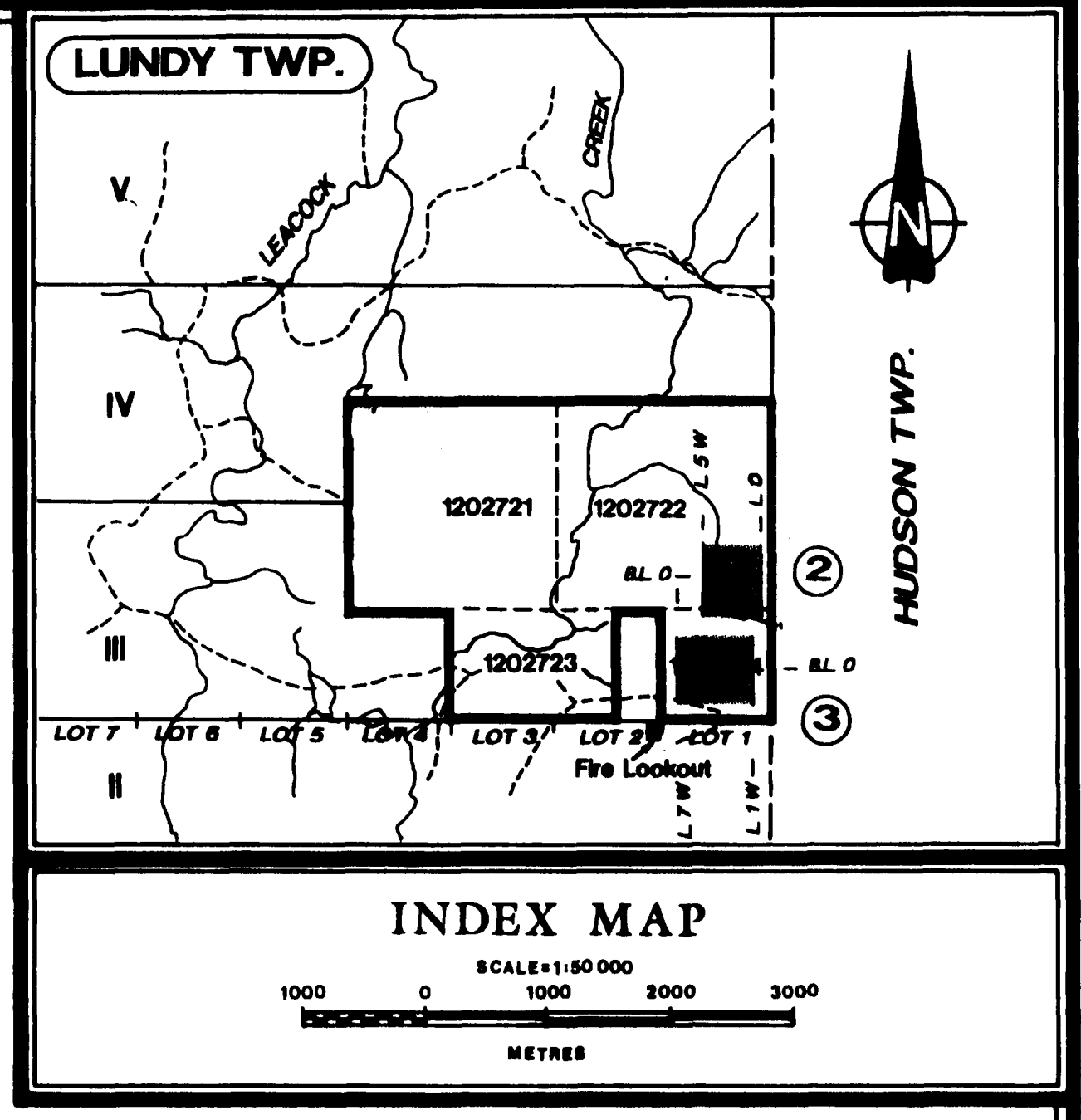
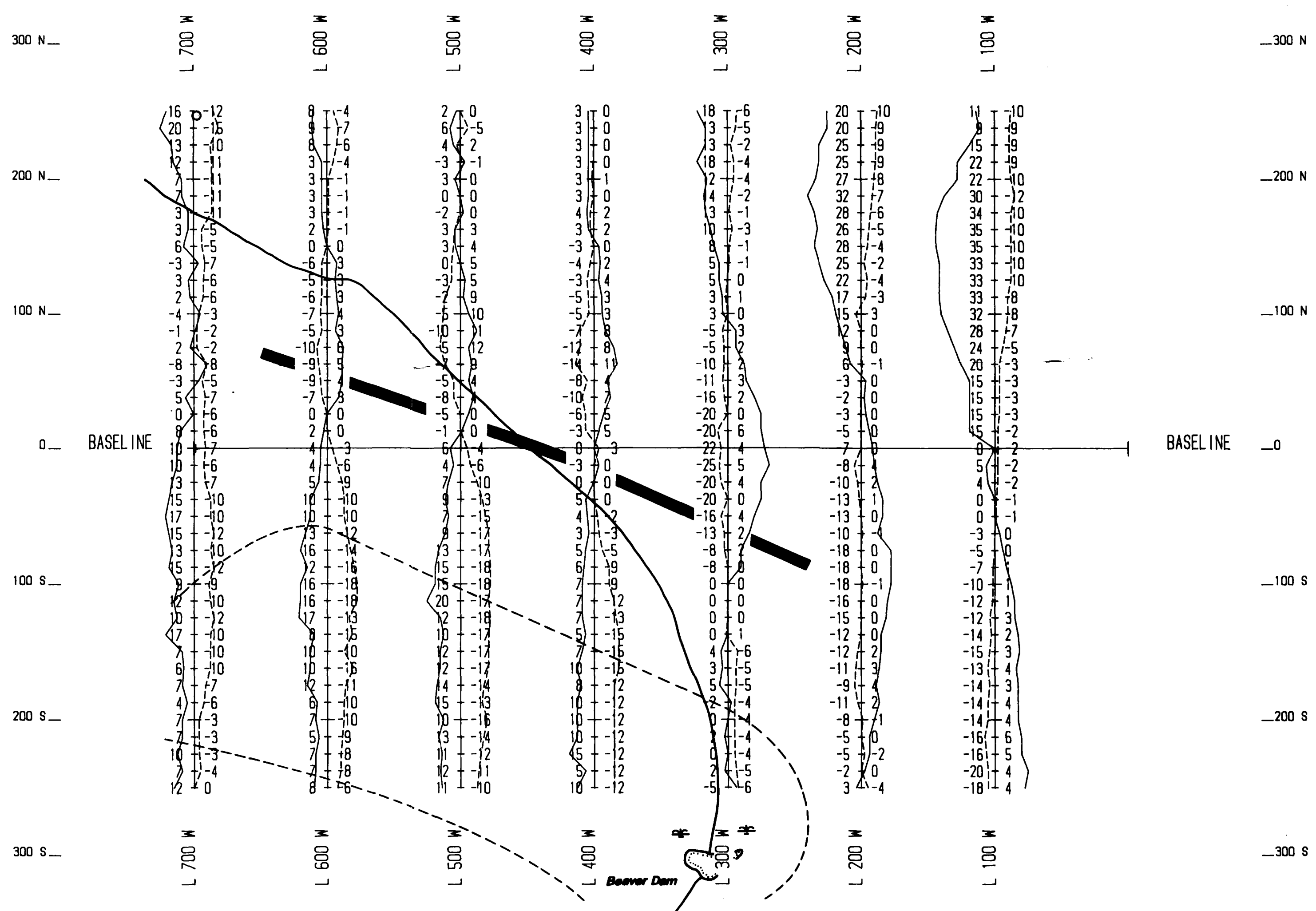

LUNDY TWP.

2.17034

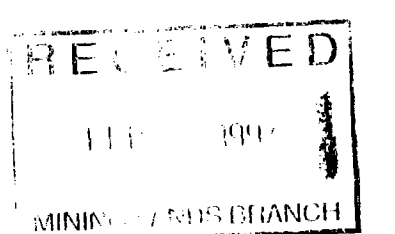

220

STATION: N.A.A.	<b>ELECTROMAGNETIC SURVEY</b>
FREQUENCY: 24.0KHZ	
IP: _____	FOR
O.P.: _____	<b>SUDBURY CONTACT MINES LTD.</b>
Scale: 1:2500	
IP: O.P. _____	PROJECT: <b>LUNDY TWP. area 2.17034</b>
+ -	
Instrument: GEONICS EM-16	SURVEYED BY: R. CRAIG DATE: FEB/95
Twp: LUNDY	DRAWN BY: S. Brown SCALE: 1:2500
	SERVICES EXPLORATION SERVICES ENRG. REG'D

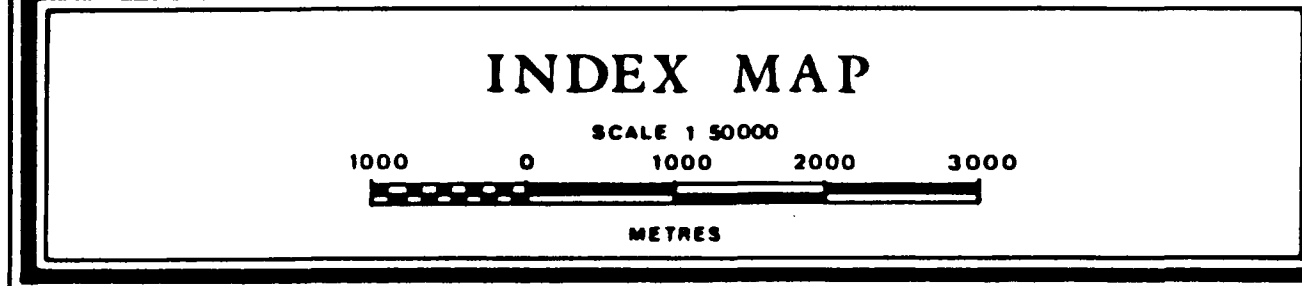
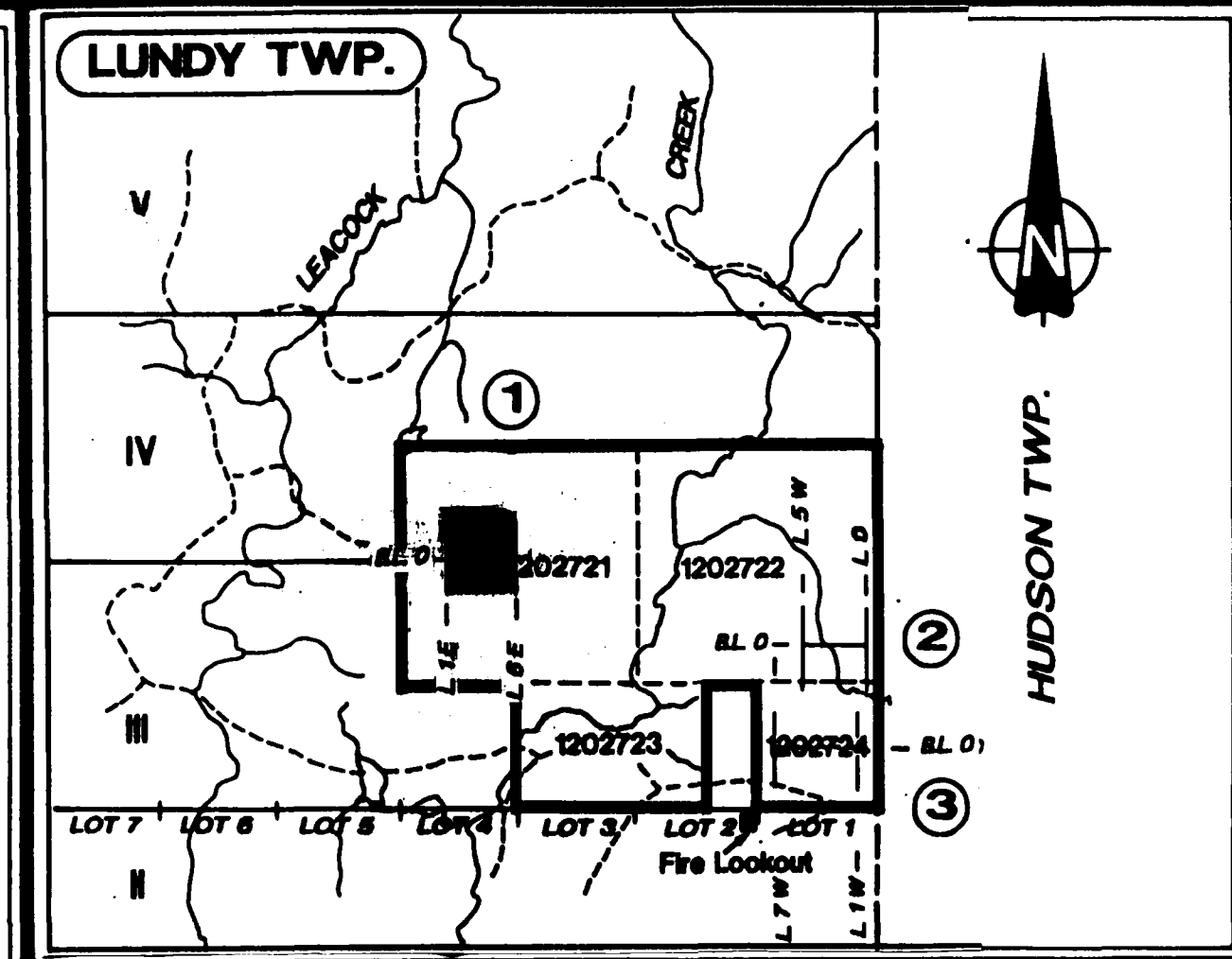
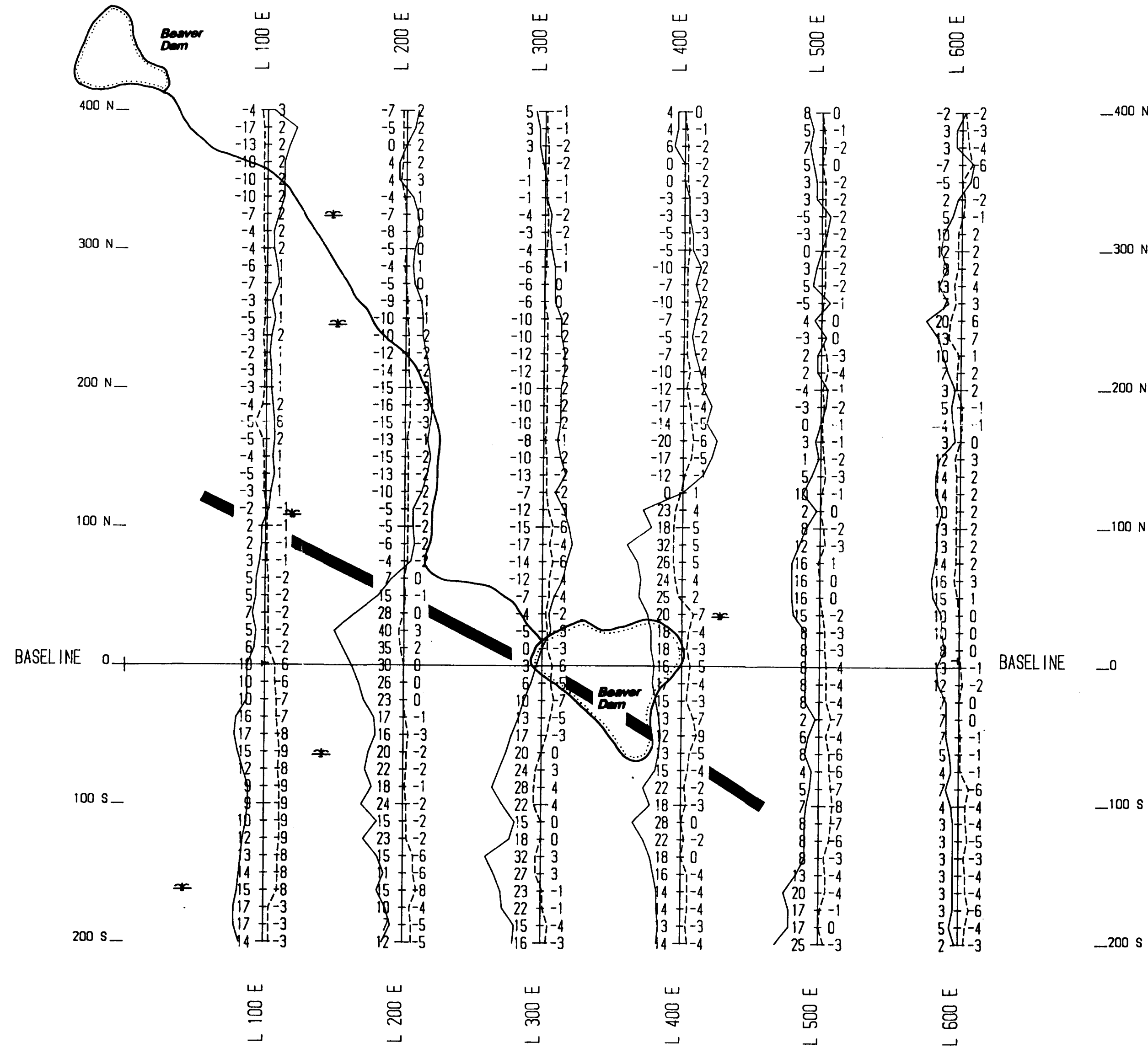
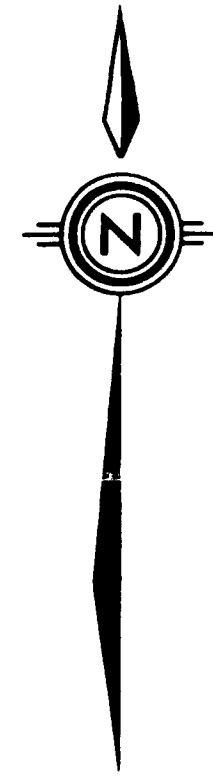

RECEIVED  
 2.17034  
 11/17/1997  
 MINING LANDS BRANCH

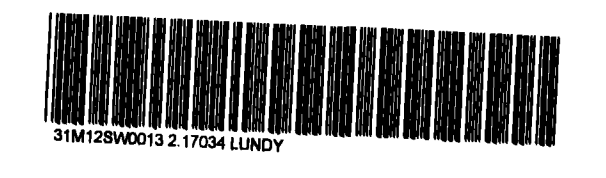

STATION <u>N.A.A.</u> FREQUENCY <u>24.0KHZ</u> I.P. <u>---</u> O.P. <u>---</u> 1cm: <u>20</u> % I.P. O.P. + -	<b>ELECTROMAGNETIC SURVEY</b> FOR <b>SUDBURY CONTACT MINES LTD.</b>
PROJECT: <u>LUNDY TWP. GRID 1</u>	
Instrument: <u>GEONICS EM-16</u>	SURVEYED BY: <u>R. CRAIG</u> DATE: <u>FEB/95</u>
TWP <u>LUNDY</u>	DRAWN BY: <u>S. Siquin</u> SCALE: <u>1:2,500</u>
	SERVICES EXPLORATION SERVICES ENRG. REGD.

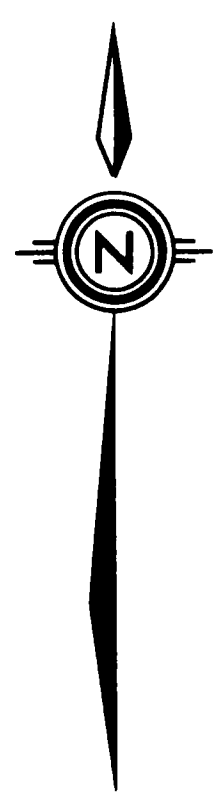
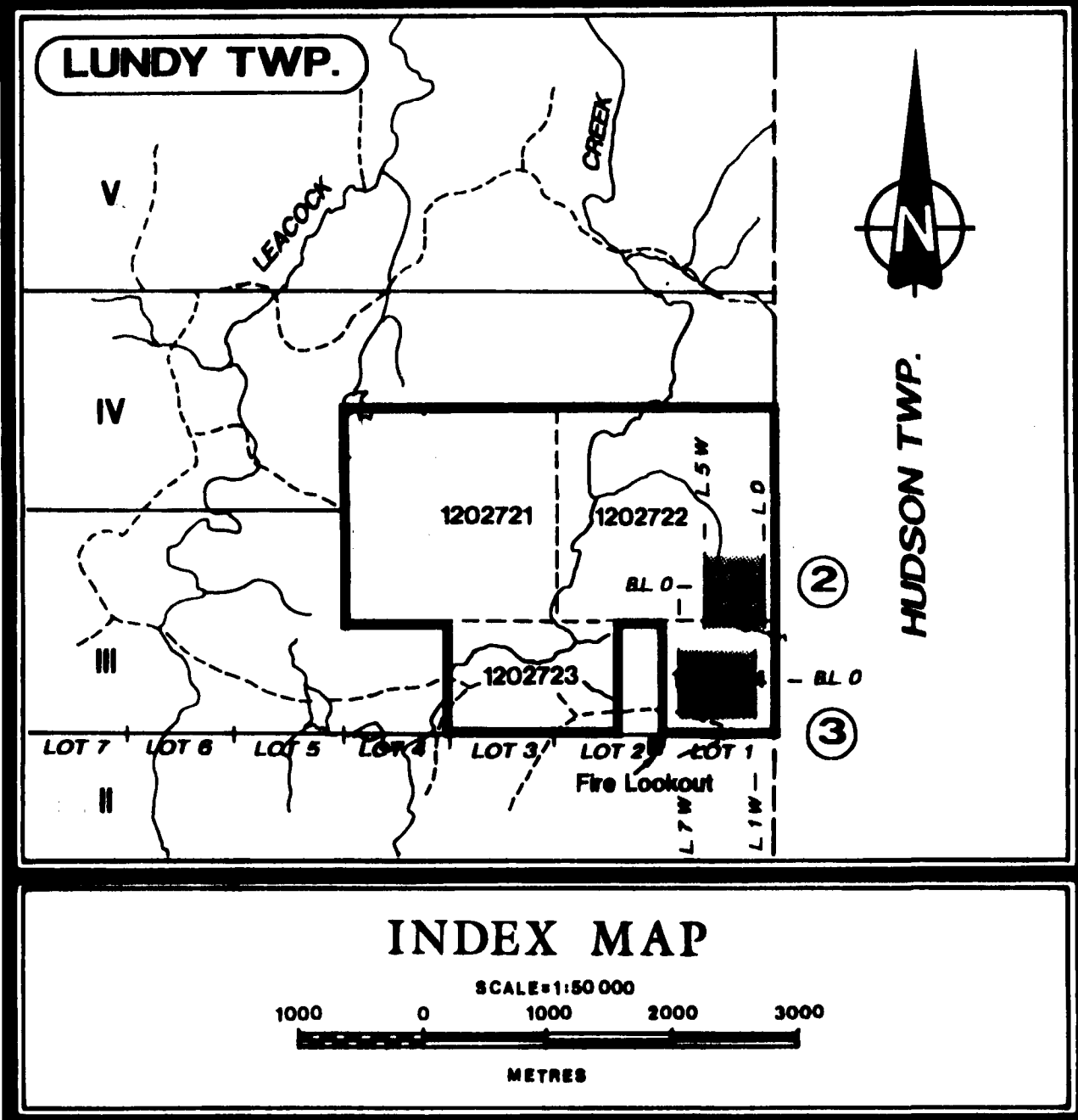

**GRID "2"**

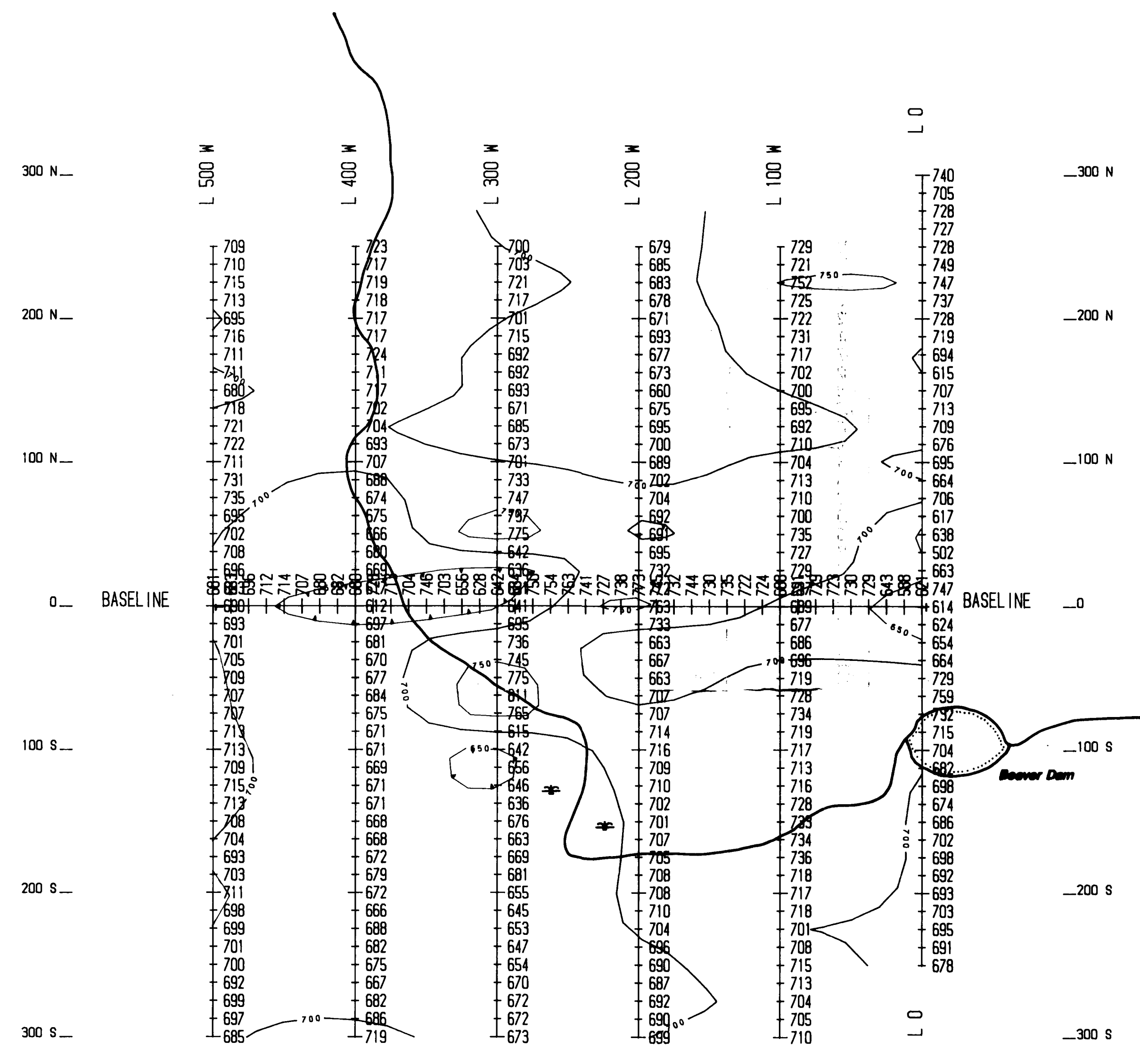

**LUNDY TWP.**

**GRID "3"**

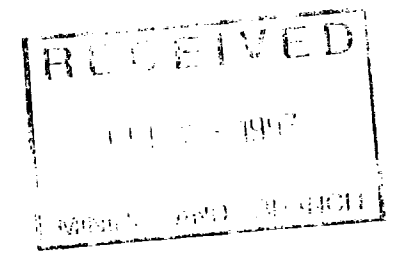
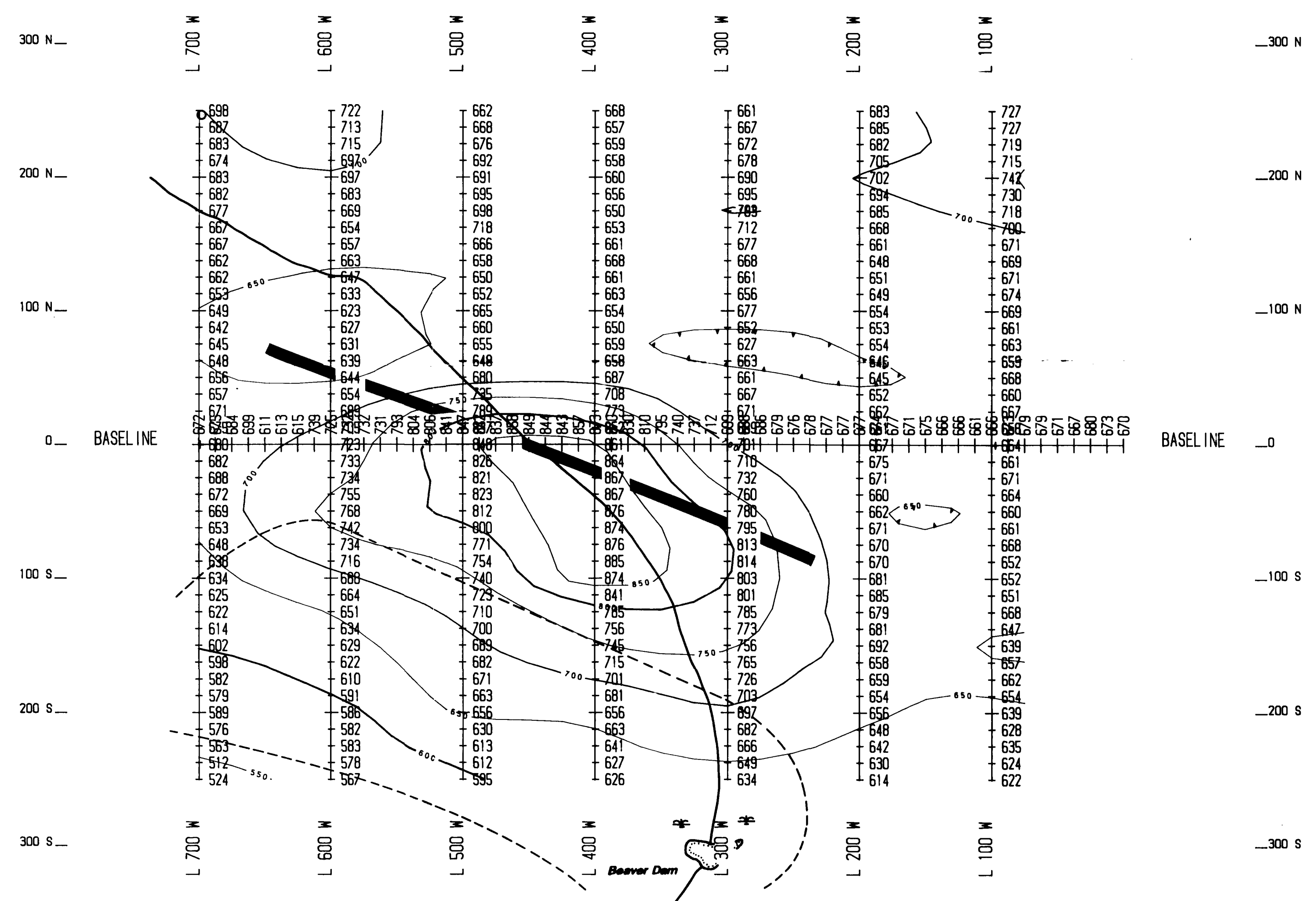

2.17034

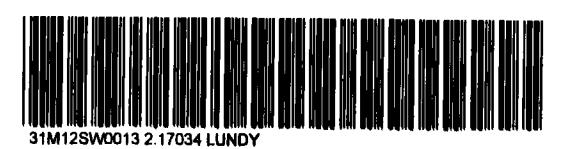

ALL READINGS IN RANGE OF 57,000 GAMMAS

<b>MAGNETOMETER SURVEY</b>	
FOR	
<b>SUDBURY CONTACT MINES LTD.</b>	
PROJECT: <b>LUNDY TWP. GRIDS "2" &amp; "3"</b>	
Instrument: <b>PROTON 9-818</b>	SURVEYED BY: <b>R. CRAG</b> DATE: <b>FEB/95</b>
TWP. <b>LUNDY</b>	DRAWN BY: <b>S. Smith</b> SCALE: <b>1:2500</b>
SERVICES EXPLORATION SERVICES ENRG. REG'D	

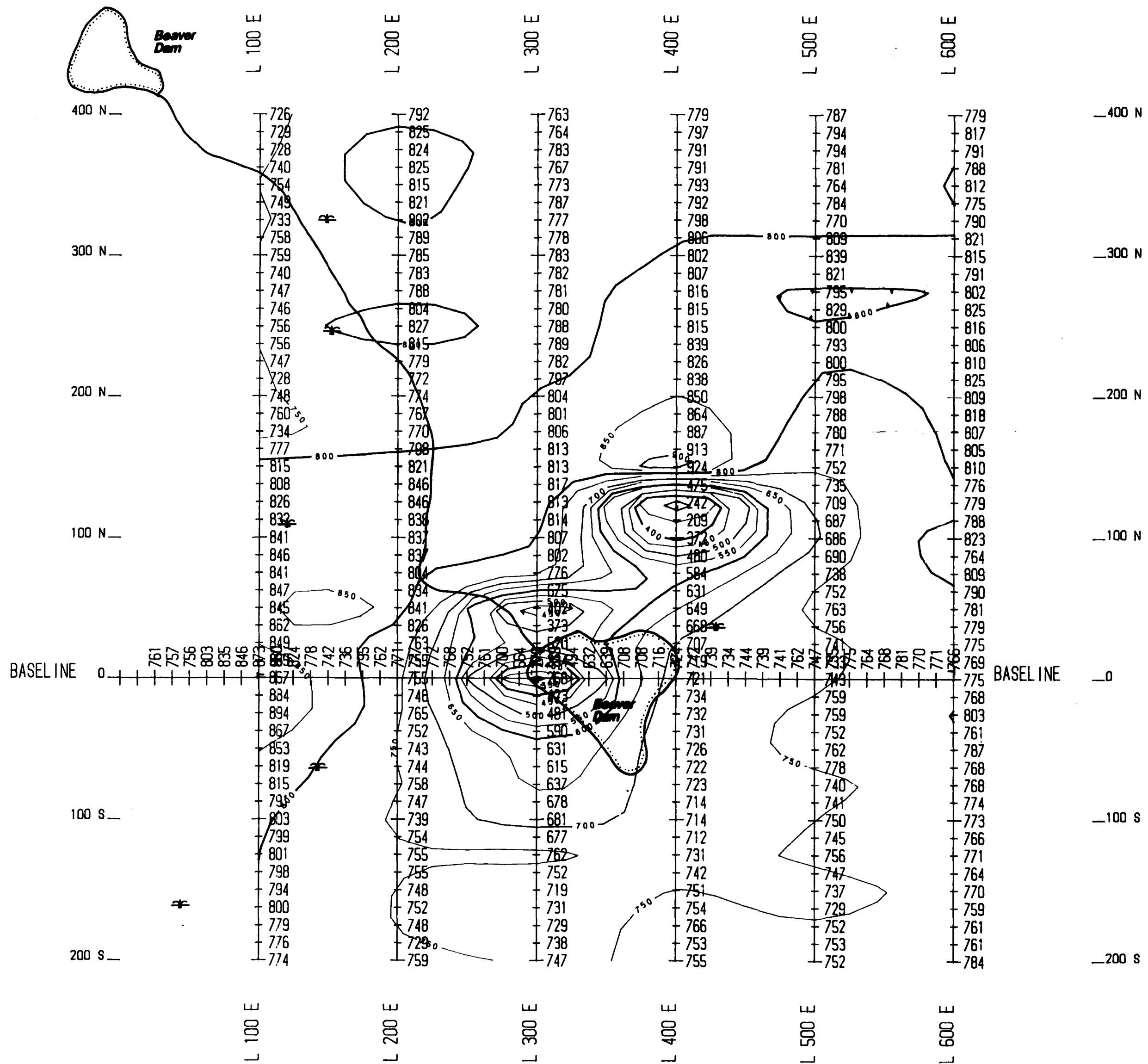
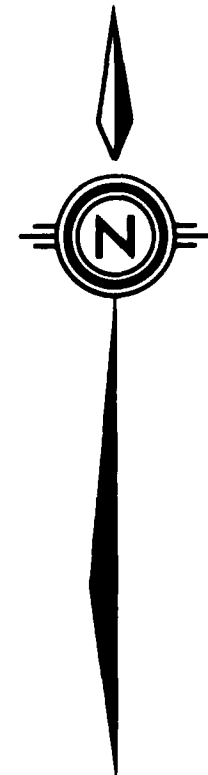

**GRID "1"**

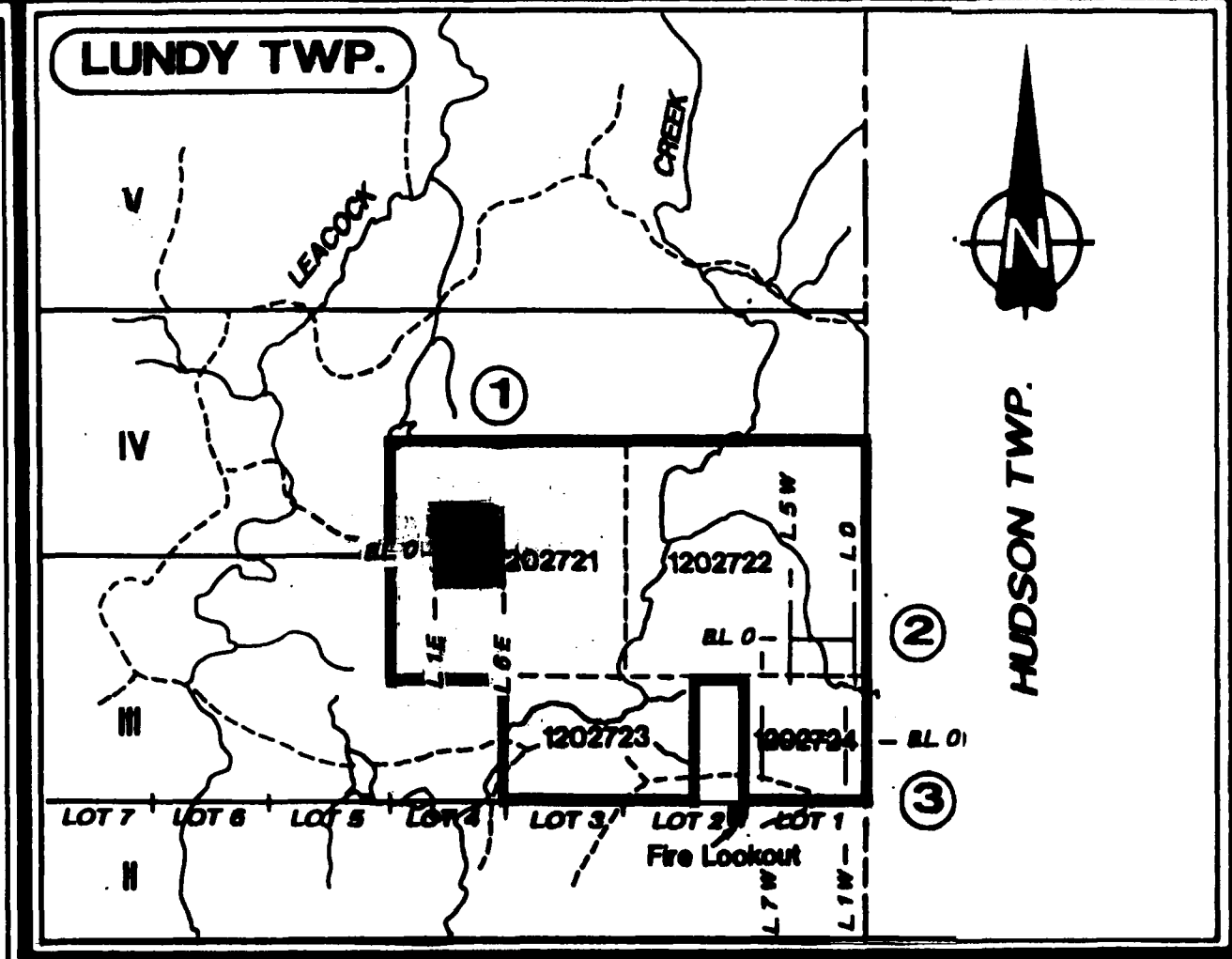

**INDEX MAP**



**2.17034**

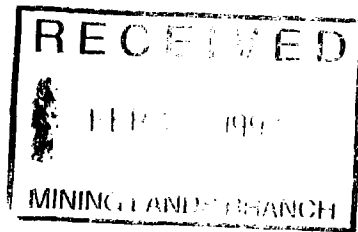

250

ALL READINGS IN RANGE OF 57,000 GAMMAS

<b>MAGNETOMETER SURVEY</b>	
FOR	
<b>SUDBURY CONTACT MINES LTD.</b>	
PROJECT: <b>LUNDY TWP. GRID 1</b>	
Instrument: <b>PROTON G-816</b>	SURVEYED BY: <b>G. CRAB</b> DATE: <b>FEB/97</b>
	DRAWN BY: <b>S. Smith</b> SCALE: <b>1:2,500</b>
<b>SERVICES EXPLORATION SERVICES ENRG. REG'D.</b>	