

WORK REPORT CLAIM GROUP 1200675

MULLIGAN TOWNSHIP LARDER LAKE MINING DIVISION



31M13NE0017 2.16071 MULLIGAN

010

2.16071

CONTENTS:

4 PAGE REPORT



31M13NE0017 2.16071 MULLIGAN

010C

PORTION OF MULLIGAN TWP. CLAIM MAP M - 373

MAP SHOWING GEOLOGY OF 1200675

TOTAL FIELD MAGNETIC READINGS AND PROFILES



JUNE 1995

1.

WORK REPORT CLAIM GROUP 11200675 MULLIGAN TOWNSHIP:

ACCESS TO THE PROPERTY IS VIA HWY# 11 ABOUT 6 KM. SOUTH OF ENGLEHART. FROM HERE PAVED ROAD # 569 TRAVELS DUE EAST FOR 9.5 KM. WHERE IT TURNS SOUTH. CONTINUE EASTWARD FROM THIS TURN FOR 3 KM. TO THE NEXT TOWNSHIP CROSSROAD AND TURN NORTH FOR 1 KM. AT WHICH POINT TURN EAST AGAIN FOR  $\frac{1}{2}$  KM WHICH IS THE ENTRY POINT INTO THE NORTHWEST CORNER OF PENSE TOWNSHIP. THE ROAD BECOMES A FOREST ACCESS ROAD HERE AND IS NOT ALWAYS WELL MAINTAINED. CONTINUE NORTHWARD FOR ANOTHER 8 KM. TO SKEETON CREEK. AN OLD RUTTED LOGGING TRAIL MEANDERS EAST FROM HERE FOR SOME 3 KM. AND LEADS TO THE PROPERTY. SOME SWAMP HOLES ARE NOT NAVIGABLE BY ATV.

GENERAL GEOLOGY

MOST OF MULLIGAN TOWNSHIP IS UNDERLAIN BY HURONIAN META-SEDIMENTS CONSISTING OF SILTSTONE, GRAYWACKE AND TO A LESSER EXTENT CONGLOMERATE. THESE ROCKS ARE IN UNCONFORMABLE CONTACT WITH A LOWER GRANITE MASSIF, OF THE PONTIAC SERIES.

ECONOMICALLY THE AREA APPEARS UNCONDUCTIVE TO METALLIFEROUS DEPOSITS, ALTHOUGH THE GRAYWACKE DOES HAVE SECONDARY MINOR PYRITE AND CHALCOPYRITE. IN THE SOUTHWEST CORNER OF THE TOWNSHIP PROMINENT NIPISSING DIABASE INTRUSIONS OCCUR, BUT DO NOT DEVELOP ANY KNOWN SILVER OCCURRENCES.

WORK PERFORMED FOR THIS REPORT

PRIOR TO ANY GEOPHYSICS OR GEOLOGIC MAPPING THE CLAIM GROUP'S BOUNDARY WERE RE-ESTABLISHED BY LINE CUTTING AND CHAINING. IN ALL 3.85 KM. OF LINE WERE CUT. THESE LINES WERE THEN MAGGED AND MAPPED.

THE MAPPING AND SAMPLING TOOK 5 DAYS. THIS WAS FOLLOWED BY A MAG SURVEY USING A GEOMETRICS PROTON MAGNETOMETER, MODEL G 816/826 READING TOTAL FIELD OVER A RANGE OF 20,000 TO 90,000 GAMMAS

WITH A SENSITIVITY OF +/- 1 GAMMA (NT). 1375 METRES OF LINE WERE READ. THIS INVOLVED 800 METRES ALONG THE NORTH BOUNDARY, 375 METRES ALONG THE SOUTH BOUNDARY PLUS A NORTHWARD JOG OF 200 METERS, FROM CHAINAGE POINT OF 900 METRES EAST, ALONG THIS SOUTH BOUNDARY. EIGHT SAMPLES WERE SENT OUT FOR ASSAY, THREE OF WHICH WERE SOIL OR SAND, THE REMAINDER WERE ROCK.

SPECIFICS OF THE GEOLOGY:

UNITS 1, 2 AND 3 ARE RELATED QUARTZITES BUT WITH VARYING MAFIC CONTENT

UNIT 4 IS AN UNDIFFERENTIATED GRAYWACKE, OCCASSIONALLY WITH WEAK BEDDING. AT CHAINAGE 115 METRES SOUTH OF POST 4, A SMALL SCARP SHOWS THE CONTACT BETWEEN THE GRAYWACKE AND THE CONGLOMERATE, SEPARATED BY TWO 5 CM. BANDS OF PINK QUARTZITE. BUT THIS SEEMS TO BE A VERY LOCALIZED PHENOMENON. IN ALL CASES THE CONGLOMERATE IS THE UPPER MEMBER OF THE SEDIMENTARY SERIES.

UNIT 5 SHOWS A VARIETY OF SMALL SHARDS AND ANGULAR FRAGMENTS.

UNIT 6 A SLATY ARGILLITE IS THINLY LAMELLAR AND HORIZONTALLY BEDDED.

UNIT 7 IS A HARD FINE GRAINED SILTSTONE WHICH PRODUCES A RINGING SOUND IN MANY INSTANCES WHEN HIT WITH A HAMMER.

UNITS 8, 9 AND 10 ARE UNUSUAL FOR THIS AREA AND SO HAVE BEEN INCLUDED FOR INTEREST ONLY. NO. 8 IS A LARGE GLACIAL ERRATIC MEASURING ABOUT 2 METRES IN EACH DIRECTION AND PERCHED DIRECTLY ON A GRAYWACKE OUTCROP. THE ROCK IS A f.g. DACITE, PALE GREEN IN COLOUR SOMEWHAT BRECCIATED WITH CALCITE SEAMS, CONTAINING PATCHY SECTIONS OF PYRITE. ONE MINERALIZED SAMPLE WAS SENT OUT FOR ASSAY. THE EXTERIOR SURFACE APPEARS UNGLACIATED AS THOUGH IT WERE

RAFTED TO ITS PRESENT SITE. NO. 9 IS A ROUNDED BOULDER OF HB. DIORITE. NO. 10 IS A FLAT SLAB OF DARK, CHLORITE-CARBONATE SCHIST SIMILAR TO AN UNUSUAL OUTCROP LOCATED AT ABOUT 500N + 200 E, MEASURED FROM OUR EASTERN BOUNDARY LINE, ALTHOUGH THIS COORDINATE IS OFF OUR PROPERTY. THESE ERRATICS ARE MENTIONED BECAUSE ALL OTHER BOULDERS SEEN WERE HURONIAN OR GRANITE.

UNIT 11 IS A FERRUGINOUS SILTSTONE WITH RUSTY FRACTURES, AND BECOMING LIMONITIC AT THE WATER TABLE. SOME FRACTURES SHOW MINOR CALCITE HEALING. THE OUTCROP STRIKES NORTHWEST AT 330°, THE FRACTURES ARE AT RIGHT ANGLES.

UNIT 12 IS AN INCOMPETENT ROCK PROBABLY THE LEACHED LIMONITIC EQUIVALENT OF UNIT 11. IT CAN ONLY BE SEEN AFTER REMOVING THE OVERBURDEN IN THE WET GROUND WHERE THE MAGNETIC<sup>HIGH</sup> OCCURS. THE MAGNETIC HIGH WHICH APPEARS TO ORIGINATE FROM A DYKE, MAINTAINS A CONSISTENT DISTANCE OF ABOUT 3 METRES WEST OF UNIT 11. SEVERAL SAMPLES WERE TAKEN HERE FOR ASSAY.

UNIT 13 IS A CONGLOMERATE, SOMETIMES WITH VERY LARGE ROUNDED BOULDERS AT ITS BASE, GRADING UPWARDS TO COBBLES AND ANGULAR BLOCKS, TO PEBBLES NEAR ITS TOP. THE MATRIX IS A COARSE BLACK GRAYWACKE TYPE OF CEMENT, MAKING IT QUITE DISTINCT FROM THE CONGLOMERATES IN THE COBALT AREA.

UNIT 14 IS A SOFT FRIABLE GREENISH GREY SHALE, THINLY VARVED, CALCAREOUS, WITH FRAGMENTALS THAT MAY BE DUE TO CROSS RIPPLE MARKS. WHERE SHOWN ON OUR MAP THERE IS A SCARP, THE LOWER 3 METRES OF WHICH IS SHALE, THEN 2 METRES OF GRAYWACKE, TOPPED BY 2 METRES AND MORE OF CONGLOMERATE

UNIT 15 IS THE BASEMENT GRANITE FORMING AN UNCONFORMITY WITH THE HURONIAN. THIS UNIT IS EXPOSED IN THE NORTHEAST OF THE CLAIM GROUP AND AGAIN IN THE NORTHWEST CORNER.

IT SHOULD BE NOTED THAT WE HAVE 3 CONTIGUOUS CLAIM GROUPS SHOWING THIS GRANITE. THE 4 CLAIM GROUP, 1150621 TO THE NORTH, HAS ITS SOUTHERN  $\frac{1}{2}$  UNDERLAIN BY GRANITE. THE CENTRAL 4 CLAIM GROUP 1186542, IS ENTIRELY UNDERLAIN BY GRANITE, AND THE SOUTHERN 6 CLAIM GROUP 1200675, WHICH WE ARE DISCUSSING HAS ITS NORTHERN  $\frac{1}{8}$  UNDERLAIN BY GRANITE.

THE GRANITE VARIES FROM A MEDIUM GRAINED PINK WITH OCCASIONAL XENOLITHIC BLOCKS TO A SOMEWHAT MORE MAFIC PHASE. TO THE EAST THE GRANITE IS PORPHYRITIC WITH FELDSPAR PHENOCRYSTS.

#### GEOPHYSICS:

PORTIONS OF THE NORTH AND SOUTH BOUNDARIES WERE MAGGED USING A PROTON MAGNETOMETER. WE WERE TRYING TO SHOW THE MAGNETIC PROFILE, AND STRIKE, AND CONTINUITY OF THE ANOMALY. THIS DYKE APPEARS TO BE THE EXTENSION FO THE ANOMALY THAT SHOWS UP ON OUR NORTHERN GROUP 1150621 WHERE WE OBTAINED A GOLD ASSAY OF 0.088 OZ. THIS DYKE CROSSED OUR NORTH BOUNDARY AT 415 M EAST OF POST #4, 1200675, EXHIBITING A MAGNETIC WIDTH OF ABOUT 75 METRES. IT EXITED OUR SOUTH BOUNDARY AT A CHAINAGE OF ABOUT 965 M EAST OF OUR POST #3.

FROM THIS SOUTH BOUNDARY LINE WE CHAINED NORTH FOR 158 M TOWARDS A SMALL OUTCROP KNOLL AND LOCATED THE MAG HIGH AT THIS LOCATION ABOUT 3 METRES WEST OF THE OUTCROP IN FLAT LOW GROUND. SEE OUR DESCRIPTION OF UNITS 11 AND 12 ABOVE.

#### RECOMMENDATIONS

SHOULD EITHER THE ROCK, SOIL OR SAND SAMPLES SENT OUT FOR ASSAY PROVE INTERESTING, EM. GEOPHYSICS AND TRENCHING IS REQUIRED.

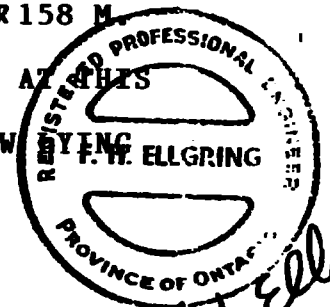



201001

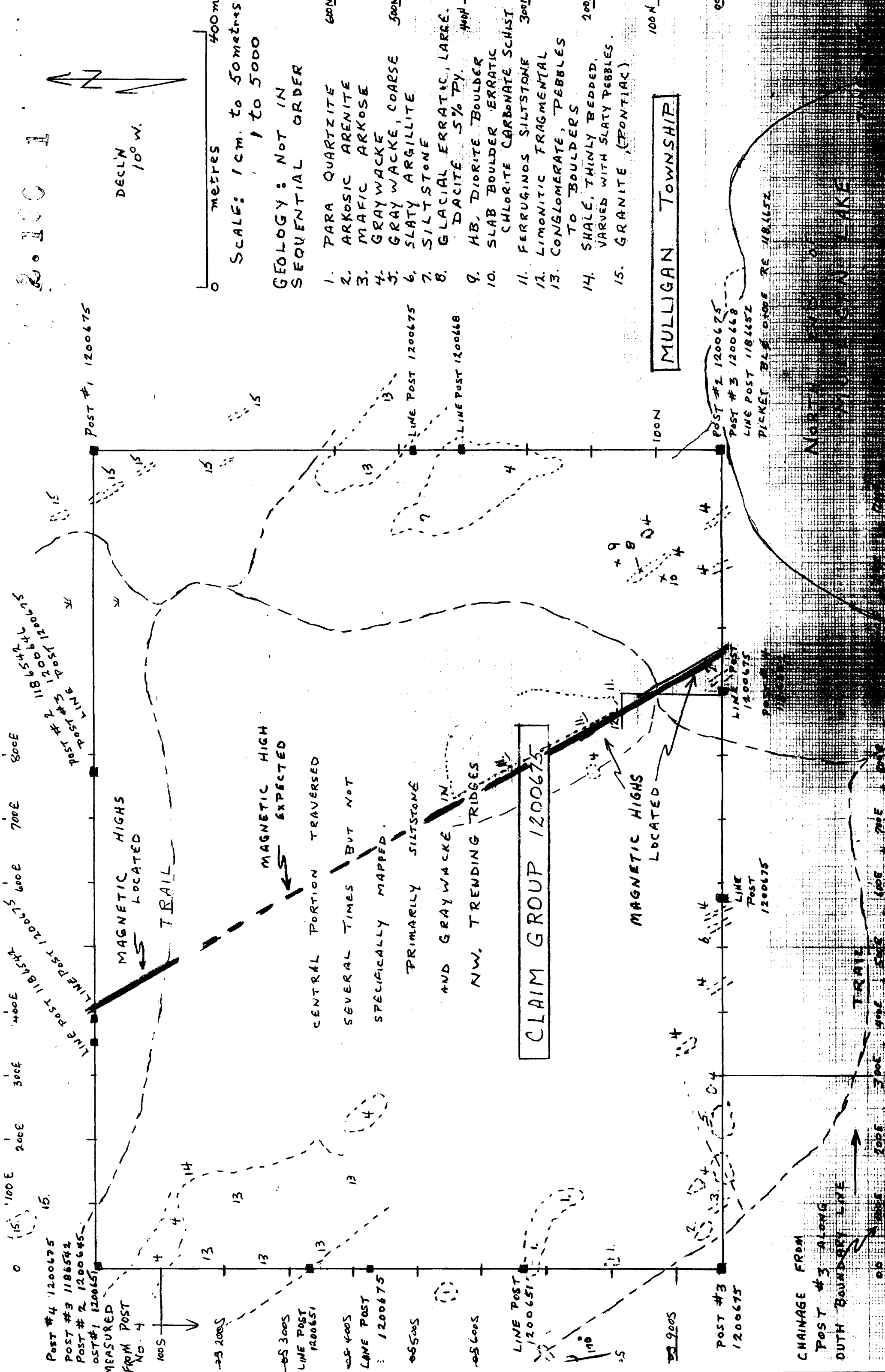

Post #4 1200675  
 Post #3 1186542  
 Post #2 1200645  
 Post #1 1200651

MEASURED FROM POST No. 4

LINE POST 1200651  
 LINE POST 1200675  
 LINE POST 1200651  
 LINE POST 1200675  
 LINE POST 1200651  
 LINE POST 1200675  
 LINE POST 1200651  
 LINE POST 1200675

MAGNETIC HIGHS LOCATED

TRAIL

MAGNETIC HIGH EXPECTED

CENTRAL PORTION TRAVERSED SEVERAL TIMES BUT NOT SPECIFICALLY MAPPED.

CLAIM GROUP 1200675

PRIMARYLY SILTSTONE AND GRAYWACKE IN NW. TRENDING RIDGES

MAGNETIC HIGHS LOCATED

CHANGE FROM POST #3 ALONG BOUNDARY LINE

DECLIN 10° W.

400m. metres

SCALE: 1cm. to 50metres

GEOLOGY: NOT IN SEQUENTIAL ORDER

1. PARA QUARTZITE 600N
2. ARKOSIC ARENITE
3. MAFIC ARKOSE
4. GRAYWACKE
5. GRAYWACKE, COARSE 500N
6. SLATY ARGILLITE
7. SILTSTONE
8. GLACIAL ERRATIC, LARRE. DACITE 5% PY. 400N
9. HB, DIORITE BOULDER
10. SLAB BOULDER ERRATIC CHLORITE CARBONATE SCHIST 300N
11. FERRUGINOS SILTSTONE
12. LIMONITIC FRAGMENTAL
13. CONGLOMERATE, PEBBLES TO BOULDERS
14. SHALE, THINLY BEDDED, VARVED WITH SLATY PEBBLES. 200N
15. GRANITE (PONTIAC)

MULLIGAN TOWNSHIP

PICKET BLG. ORORE RE 1181152

NORTH WESTERN OF MULLIGAN LAKE

CHANGE FROM POST #3 ALONG BOUNDARY LINE

AVERAGE DISTANCE IN METRES FROM CLAIM POST #1 1200675

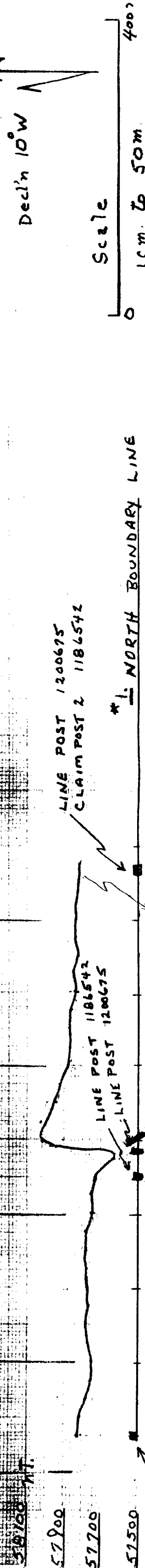

**MAGNETIC SURVEY**

**TOTAL FIELD IN nT.**  
1 cm. to 200 nT.

- \* 1. PART OF NORTH BOUNDARY LINE
- \* 2. PART OF SOUTH BOUNDARY LINE
- \* 3. PLUS SMALL NORTHWARD EXTENSION OF THE SOUTH BOUNDARY LINE AT STN. 900E TO COVER OUTCROP

LOCATION AND STRIKE OF LINEAR DYKE LIKE MAGNETIC ANOMALY, SHOWN IN RED

INTERLINE SPACING NOT TO SCALE.

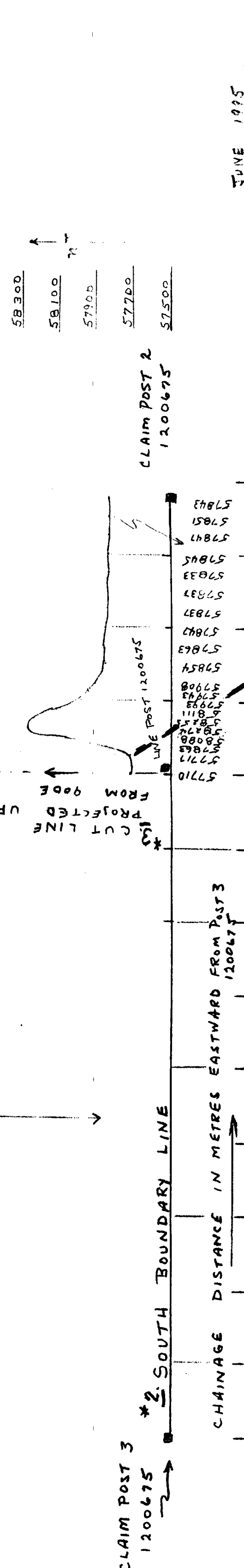
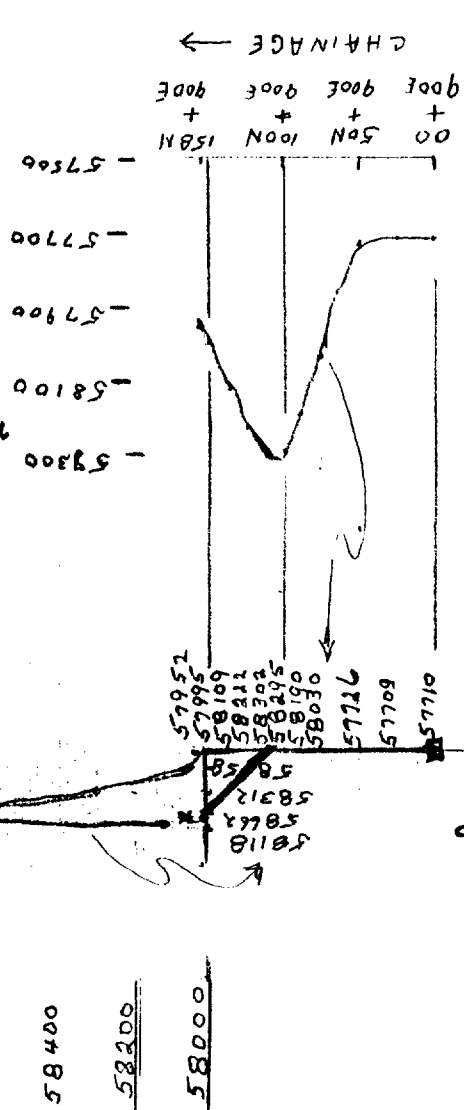





# Report of Work Conducted After Recording Claim

Transaction Number  
**DOCUMENT W 9580-00474**

Ontario

## Mining Act

Personal information collected on this form is obtained under the authority of the Mining Act. This information will be used for correspondence. Questions about this collection should be directed to the Provincial Manager, Mining Lands, Ministry of Northern Development and Mines, Fourth Floor, 159 Cedar Street, Sudbury, Ontario, P3E 6A5, telephone (705) 670-7264.

2-1-0-1

- Instructions:**
- Please type or print and submit in duplicate.
  - Refer to the Mining Act and Regulations Recorder.
  - A separate copy of this form must be co
  - Technical reports and maps must accom
  - A sketch, showing the claims the work is



31M13NE0017 2.16071 MULLIGAN

900

Recorded Holder(s) <b>FRED H. ELLGRING</b>	Client No. <b>129312</b>
Address <b>P.O. Box 1272 HAILEYBURY ON POJIKO</b>	Telephone No. <b>705 672 9274</b>
Mining Division <b>LARDER LAKE</b>	Township/Area <b>MULLIGAN TWP.</b>
	M or G Plan No. <b>M-373</b>
Date Work Performed From: <b>MAY 27</b>	To: <b>JUNE 9 1995</b>

**Work Performed (Check One Work Group Only)**

Work Group	Type
<input checked="" type="checkbox"/> Geotechnical Survey	<b>LINE CUT, GEOLOGY, GEOPHYSICS, REPORT</b>
<input type="checkbox"/> Physical Work, including Drilling	
<input type="checkbox"/> Rehabilitation	
<input type="checkbox"/> Other Authorized Work	
<input type="checkbox"/> Assays	
<input type="checkbox"/> Assignment from Reserve	

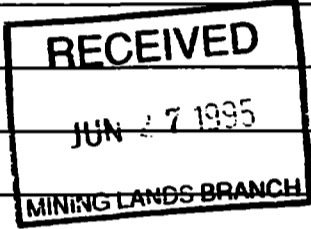

Total Assessment Work Claimed on the Attached Statement of Costs \$ 4125.<sup>00</sup>

**Note:** The Minister may reject for assessment work credit all or part of the assessment work submitted if the recorded holder cannot verify expenditures claimed in the statement of costs within 30 days of a request for verification.

**Persons and Survey Company Who Performed the Work (Give Name and Address of Author of Report)**

Name	Address
<b>FRED ELLGRING P. ENG (AUTHOR)</b>	<b>Box 1272 HAILEYBURY ON POJIKO</b>
<b>DON BOUZANE</b>	<b>212 JAGAL ST. HAILEYBURY ON. POJIKO</b>

(attach a schedule if necessary)

**Certification of Beneficial Interest \* See Note No. 1 on reverse side**

I certify that at the time the work was performed, the claims covered in this work report were recorded in the current holder's name or held under a beneficial interest by the current recorded holder.	Date <b>18 June 95</b>	Recorded Holder or Agent (Signature) <b>Fred H. Ellgring</b>
--	---------------------------	---

**Certification of Work Report**

I certify that I have a personal knowledge of the facts set forth in this Work report, having performed the work or witnessed same during and/or after its completion and annexed report is true.		
Name and Address of Person Certifying <b>FRED H. ELLGRING Box 1272 HAILEYBURY POJIKO</b>		
Telephone No. <b>705 672 9274</b>	Date <b>18 June 1995</b>	Certified By (Signature) <b>F. H. Ellgring</b>

**For Office Use Only**

Total Value Cr. Recorded <b>4125</b>	Date Recorded <b>95 June 23</b>	Mining Recorder <b>[Signature]</b>	Received Stamp <b>RECEIVED 95 JUN 23 PM 1 26 MINING DIVISION</b>
	Deemed Approval Date <b>95 Sept 21</b>	Date Approved <b>[Signature]</b>	
	Date Notice for Amendments Sent		



Statement of Costs for Assessment Credit

État des coûts aux fins du crédit d'évaluation

Mining Act/Loi sur les mines

DOCUMENT No. Transaction No./N° de transaction  
W 9580 00474

Personal information collected on this form is obtained under the authority of the Mining Act. This information will be used to maintain a record and ongoing status of the mining claim(s). Questions about this collection should be directed to the Provincial Manager, Minings Lands, Ministry of Northern Development and Mines, 4th Floor, 159 Cedar Street, Sudbury, Ontario P3E 6A5, telephone (705) 670-7264.

Les renseignements personnels contenus dans la présente formule sont recueillis en vertu de la Loi sur les mines et serviront à tenir à jour un registre des concessions minières. Adresser toute question sur la collecte de ces renseignements au chef provincial des terrains miniers, ministère du Développement du Nord et des Mines, 159, rue Cedar, 4<sup>e</sup> étage, Sudbury (Ontario) P3E 6A5, téléphone (705) 670-7264.

1. Direct Costs/Coûts directs

Type	Description	Amount Montant	Totals Total global
Wages Salaires	Labour Main-d'oeuvre	500	
	Field Supervision Supervision sur le terrain		500
Contractor's and Consultant's Fees Droits de l'entrepreneur et de l'expert-conseil	Type line Cut etc.	1140	
	Geology + Map Report	1455	
		750	3345
Supplies Used Fournitures utilisées	Type		
Equipment Rental Location de matériel	Type Plugging Tape	10	10
Total Direct Costs Total des coûts directs			3855

2. Indirect Costs/Coûts indirects

Note: When claiming Rehabilitation work indirect costs are not allowable as assessment work. Pour le remboursement des travaux de réhabilitation, les coûts indirects ne sont pas admissibles en tant que travaux d'évaluation.

Type	Description	Amount Montant	Totals Total global
Transportation Transport	Type Truck + ATV	200	
			200
Food and Lodging Nourriture et hébergement	meals	70	70
Mobilization and Demobilization Mobilisation et démoblisation			
Sub Total of Indirect Costs Total partiel des coûts indirects			270
Amount Allowable (not greater than 20% of Direct Costs) Montant admissible (n'excedant pas 20 % des coûts directs)			825
Total Value of Assessment Credit (Total of Direct and Allowable indirect costs) Valeur totale du crédit d'évaluation (Total des coûts directs et indirects admissibles)			4125

3855 + 270 = 4125.00

Note: The recorded holder will be required to verify expenditures claimed in this statement of costs within 30 days of a request for verification. If verification is not made, the Minister may reject for assessment work all or part of the assessment work submitted.

Note: Le titulaire enregistré sera tenu de vérifier les dépenses demandées dans le présent état des coûts dans les 30 jours suivant une demande à cet effet. Si la vérification n'est pas effectuée, le ministre peut rejeter tout ou une partie des travaux d'évaluation présentés.

Filing Discounts

- Work filed within two years of completion is claimed at 100% of the above Total Value of Assessment Credit.
- Work filed three, four or five years after completion is claimed at 50% of the above Total Value of Assessment Credit. See calculations below:

Total Value of Assessment Credit	Total Assessment Claimed
	x 0.50 =

Remises pour dépôt

- Les travaux déposés dans les deux ans suivant leur achèvement sont remboursés à 100 % de la valeur totale susmentionnée du crédit d'évaluation.
- Les travaux déposés trois, quatre ou cinq ans après leur achèvement sont remboursés à 50 % de la valeur totale du crédit d'évaluation susmentionné. Voir les calculs ci-dessous.

Valeur totale du crédit d'évaluation	Evaluation totale demandée
	x 0,50 =

Certification Verifying Statement of Costs

I hereby certify: that the amounts shown are as accurate as possible and these costs were incurred while conducting assessment work on the lands shown on the accompanying Report of Work form.

that as FRED H. ELLGRING I am authorized (Recorded Holder, Agent, Position in Company)

to make this certification

Attestation de l'état des coûts

J'atteste par la présente: que les montants indiqués sont le plus exact possible et que ces dépenses ont été engagées pour effectuer les travaux d'évaluation sur les terrains indiqués dans la formule de rapport de travail ci-joint.

Et qu'à titre de \_\_\_\_\_ je suis autorisé (titulaire enregistré, représentant, poste occupé dans la compagnie)

à faire cette attestation.

Signature: F. H. Ellgring Date: 18 June '93

Ministry of  
Northern Development  
and Mines

Ministère du  
Développement du Nord  
et des Mines

Geoscience Approvals Section  
933 Ramsey Lake Road  
6th Floor  
Sudbury, Ontario  
P3E 6B5

Telephone: (705) 670-5853  
Fax: (705) 670-5863

August 4, 1995

Our File: 2.16071  
Transaction #: W9580.00474

Mining Recorder  
Ministry of Northern Development & Mines  
4 Government Road East  
Kirkland Lake, Ontario  
P2N 1A2

Dear Mr. Spooner:

**Subject: APPROVAL OF ASSESSMENT WORK CREDITS ON MINING CLAIM  
1200675 IN MULLIGAN TOWNSHIP**

---

Assessment credits have been approved as outlined on the report of work form. The credits have been approved under Section 12 (Geology) and Section 14 (Geophysical) of the Mining Act Regulations.

The approval date is July 25, 1995.

If you have any questions regarding this correspondence, please contact Steven Beneteau at (705) 670-5858.

Yours sincerely,



Ron C. Gashinski  
Senior Manager, Mining Lands Section  
Mining and Land Management Branch  
Mines and Minerals Division

*SBB* SBB/yr

cc: Assessment Files Library  
✓ Sudbury, Ontario

Resident Geologist  
Kirkland Lake, Ontario

M-373

THE TOWNSHIP OF  
OF  
**MULLIGAN**  
DISTRICT OF  
TIMISKAMING  
LARDER LAKE  
MINING DIVISION  
SCALE 1-INCH=40 CHAINS

LEGEND

- PATENTED LAND (P)
- CROWN LAND SALE (CS)
- LEASES (L)
- LOCATED LAND (Loc.)
- LICENSE OF OCCUPATION (LO)
- ROADS (---)
- IMPROVED ROADS (---)
- RAILWAYS (---)
- POWER LINES (---)
- KING'S HIGHWAY (---)
- MINES (X)
- MARSH OR MUSKEG (c)
- CANCELLED (c)
- PATENTED SRO (c)

NOTES

400' Surface rights reservation around all lakes and rivers

DATE OF ISSUE  
JUN 23 1995  
LARDER LAKE  
MINING RECORDER'S OFFICE

PLAN NO. - M-373

ONTARIO # 34  
MINISTRY OF NATURAL RESOURCES  
SURVEYS AND MAPPING BRANCH

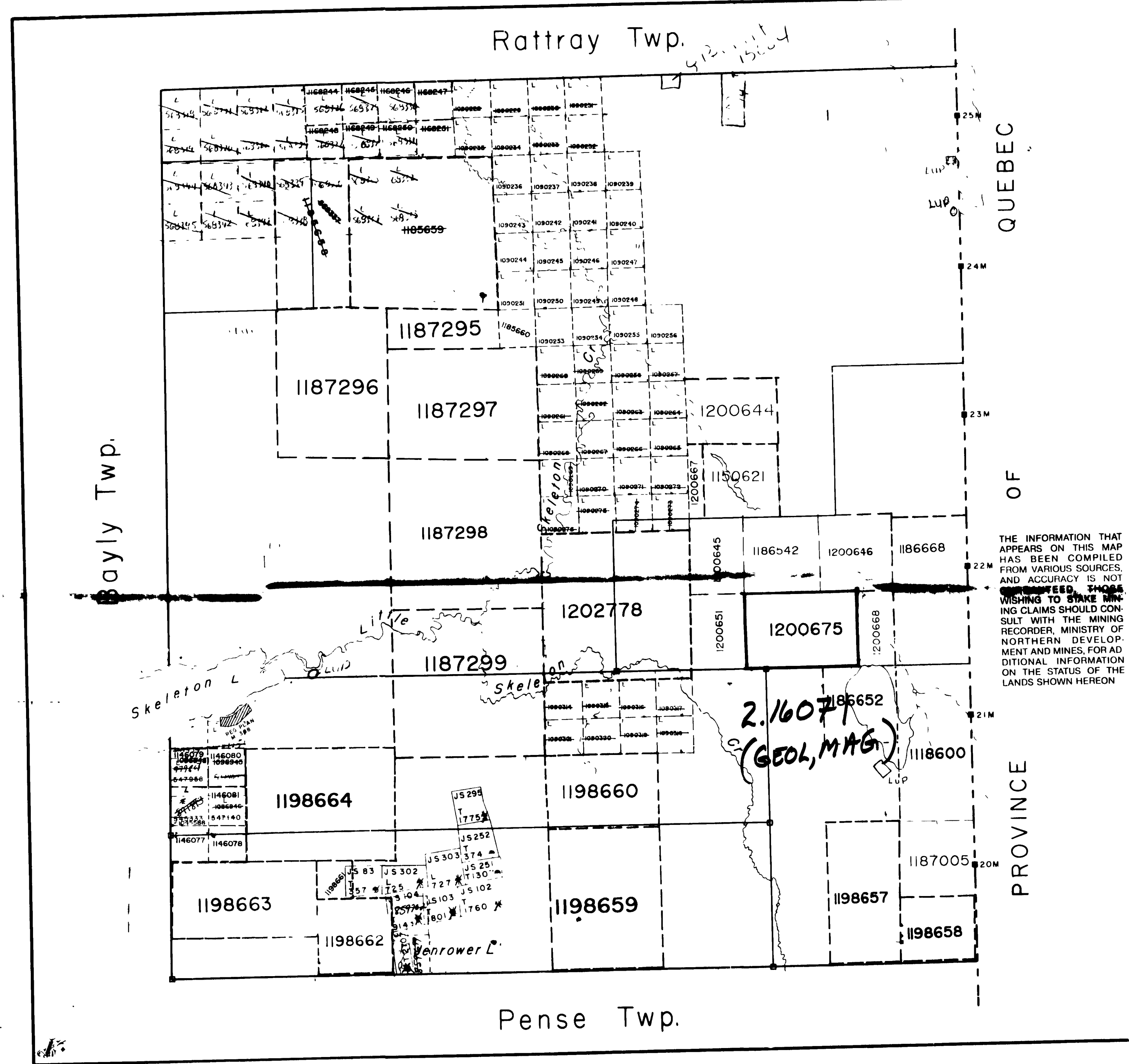

THE INFORMATION THAT APPEARS ON THIS MAP HAS BEEN COMPILED FROM VARIOUS SOURCES, AND ACCURACY IS NOT GUARANTEED. THOSE WISHING TO STAKE MINING CLAIMS SHOULD CONSULT WITH THE MINING RECORDER, MINISTRY OF NORTHERN DEVELOPMENT AND MINES, FOR ADDITIONAL INFORMATION ON THE STATUS OF THE LANDS SHOWN HEREON

2

MULLIGAN TWP

M-373

