

Moose Crossing Farm



31M13NW0050 2.11818 CATHARINE

010

Mining Lands Section  
3rd Floor,  
880 Bay Street,  
Toronto  
Ont. M5S 1Z8.

RECEIVED

JAN 30 1989

MINING LANDS SECTION

ONT.  
POK 120.  
Jan 19th 1989.

RE. Data for Assaying on Mining  
Claims 919832  
919833  
919827. in the township  
of Catherine.

File: 2 11818.

Sir,

Please find enclosed the Assay results  
from the diamond drill core samples (in duplicate)  
Hoping that this will complete the  
application for assessment work on the  
above claims.

Yours truly,

R V J L

R. HILL PROPERTY, CATHERINE TWP., ONTARIO. NTS 32 D 4  
 Sample series collected for assay from diamond drill  
 hole Gold Moose #1

SAMPLE NUMBER	FROM	TO	Gold in PPB	Oz./ton
FX219941	3.5ft	7.0ft	10	
FX219942	7.0ft	9.0ft	0	
FX219943	9.0ft	12.0ft	0	
FX219944	12.0ft	14.0ft	0	
FX219945	14.0ft	16.0ft	0	
FX219946	16.0ft	17.3ft	0	
FX219947	17.3ft	19.0ft	0	
FX219948	19.0ft	21.5ft	0	
FX219949	21.5ft	23.0ft	0	
FX219950	23.0ft	25.0ft	0	
FX219951	25.0ft	26.3ft	0	
FX219952	26.3ft	27.3ft	0	
FX219953	27.3ft	28.4ft	0	
FX219954	28.4ft	29.6ft	0	
FX219955	29.6ft	31.0ft	0	
FX219956	31.0ft	31.6ft	5	
FX219957	31.6ft	33.0ft	0	
FX219958	33.0ft	33.8ft	270	0.008
FX219959	33.8ft	35.0ft	0	
FX219960	35.0ft	35.8ft	0	
FX219961	35.8ft	36.7ft	220	0.006
FX219962	36.7ft	38.0ft	5	
FX219963	38.0ft	39.0ft	0	
FX219964	39.0ft	40.0ft	0	
FX219965	40.0ft	41.1ft	0	
FX219966	41.1ft	41.9ft	0	
FX219967	41.9ft	43.0ft	0	
FX219968	43.0ft	44.0ft	40	
FX219969	44.0ft	44.3ft	5	
FX219970	44.3ft	45.1ft	10	
FX219971	45.1ft	46.2ft	95	
FX219972	46.2ft	47.3ft	10	
FX219973	47.3ft	48.2ft	5	
FX219974	48.2ft	48.9ft	30	
FX219975	48.9ft	50.0ft	480	0.014
FX219976	50.0ft	51.0ft	85	
FX219977	51.0ft	52.0ft	20	
FX219978	52.0ft	53.0ft	0	
FX219979	53.0ft	54.0ft	0	
FX219980	54.0ft	55.0ft	60	
FX219981	55.0ft	56.0ft	205	0.006
FX219982	56.0ft	57.0ft	20	
FX219983	57.0ft	58.0ft	0	
FX219984	58.0ft	59.0ft	10	
FX219985	59.0ft	60.0ft	675	0.020
FX219986	60.0ft	61.0ft	625	0.018
FX219987	61.0ft	62.0ft	80	
FX219988	62.0ft	63.0ft	0	
FX219989	63.0ft	64.0ft	0	
FX219990	64.0ft	65.0ft	0	
FX219991	65.0ft	66.0ft	10	
FX219992	66.0ft	67.0ft	5	
FX219993	67.0ft	68.0ft	0	
FX219994	68.0ft	69.0ft	35	
FX219995	69.0ft	70.0ft	185	0.005

FX219996	70.0ft	71.0ft	605	0.018
FX219997	71.0ft	72.0ft	175	0.005
FX219998	72.0ft	73.0ft	0	
FX219999	73.0ft	74.0ft	0	
FX220000	74.0ft	75.0ft	0	
FX252854	75.0ft	76.0ft	10	
FX252855	76.0ft	77.0ft	5	
FX252856	77.0ft	78.0ft	0	
FX252857	78.0ft	79.0ft	0	
FX252858	79.0ft	80.0ft	0	
FX252859	80.0ft	81.0ft	0	
FX252860	81.0ft	82.0ft	0	
FX252861	82.0ft	83.4ft	0	
FX252862	83.4ft	84.5ft	0	
FX252863	84.5ft	85.6ft	45	
FX252864	85.6ft	86.6ft	15	
FX252865	86.6ft	88.0ft	0	
FX252866	88.0ft	89.5ft	0	
FX252867	89.5ft	91.0ft	0	
FX252868	91.0ft	92.0ft	0	
FX252869	92.0ft	94.1ft	0	
FX252870	94.1ft	98.0ft	5	
FX252871	98.0ft	100.0ft	5	
FX252872	100.0ft	102.0ft	0	
FX252873	102.0ft	104.0ft	0	

DAYS	STRIPPING TRENCHING AND PROSPECTING			HOURS WORK
3	MIKE PRENTICE	18/4/87 - 19/4/87	26/4/87	30
3	RON FOWKE	18/4/87 - 19/4/87	26/4/87	30
7	ROLAND HILL	18/4/87 T.	2/5/87	70
2	DAN PETERS	26/4/87 - 2/5/87		20
1	FRANK PLOEGER	25 <sup>th</sup> /4/87		8
TOTAL 16				TOTAL 158 HOURS
				CREDITS 26

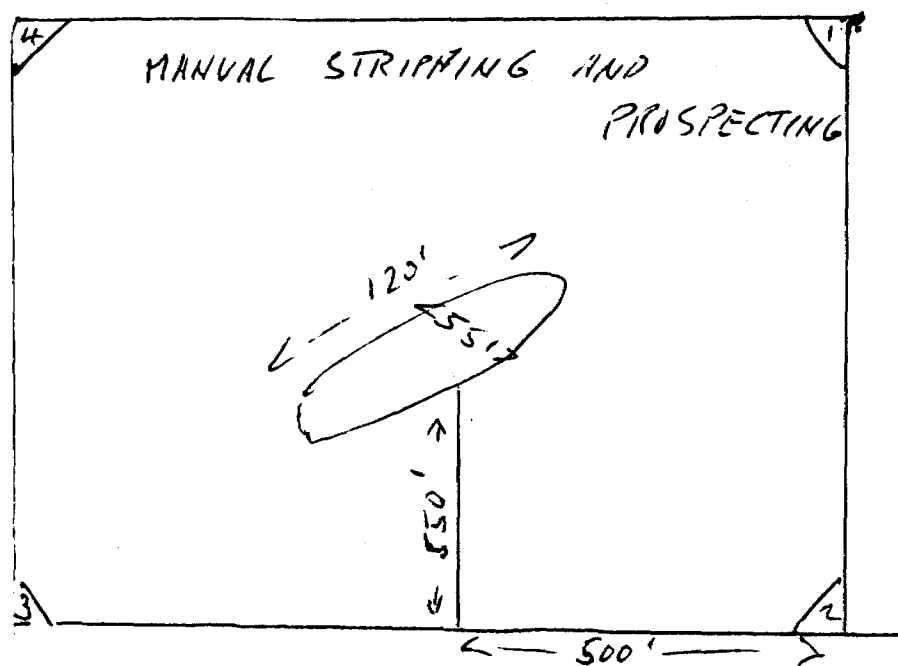

CATHERINE TOWNSHIP  
 LOT 10 SE. CORNER OF S HALF  
 CON 5



Ministry of Northern Development and Mines

Report of Work

(Geophysical, Geological, Geochemical and Exploration)

DOCUMENT No. **W8808-506**



31M13NW0050 2.11818 CATHARINE

900

*Law Management*

Mining Act

Type of Survey(s) **Roll Assays** Township or Area **CATHERINE**

Claim Holder(s) **ROLAND HILL** Prospector's Licence No. **K19108**

Address **MOOSE CROSSING FARM, LARDER LAKE, ONT. POK 110**

Survey Company **INCO** Date of Survey (from & to) **7. 12 87** Total Miles of line Cut \_\_\_\_\_

Name and Address of Author (of Geo-Technical report) **A.R. WIEBE, INCO LIMITED GRASS CREEK, ONT. POK 110**

Credits Requested per Each Claim in Columns at right

Special Provisions	Geophysical	Days per Claim
For first survey: Enter 40 days. (This includes line cutting)	Electromagnetic	
	Magnetometer	
	Radiometric	
For each additional survey: using the same grid: Enter 20 days (for each)	Other	
	Geological	
	Geochemical	
Man Days	Geophysical	Days per Claim
Complete reverse side and enter total(s) here	Electromagnetic	
	Magnetometer	
	Radiometric	
	Other	
	Geological	
	Geochemical	
Airborne	Geophysical	Days per Claim
Note: Special provisions credits do not apply to Airborne Surveys.	Electromagnetic	
	Magnetometer	
	Radiometric	

ONTARIO GEOLOGICAL SURVEY ASSESSMENT FILES OFFICE  
FEB 13 1989

RECEIVED

Mining Claims Traversed (List in numerical sequence)

Mining Claim			Mining Claim		
Prefix	Number	Expend. Days Cr.	Prefix	Number	Expend. Days Cr.
L	919832	11			
	919833	25			
	919827	25			

RECEIVED

NOV 17 1988

MINING LANDS SECTION

LARDER LAKE

RECEIVED

NOV 2 1988

AM 12:00 NOV 2 1988

Total number of mining claims covered by this report of work. **3**

Expenditures (excludes power stripping)

Type of Work Performed **SAMPLE ASSAY**

Performed on Claim(s) **919832**

Calculation of Expenditure Days Credits

Total Expenditures **\$ 920** + **15** = **61 1/2** Total Days Credits

Instructions  
Total Days Credits may be apportioned at the claim holder's choice. Enter number of days credits per claim selected in columns at right.

For Office Use Only

Total Days Cr. Date Recorded **61 1/2 Nov. 2/88** Mining Recorder **[Signature]**

Date Approved or Accepted **Jan 89** Branch **[Signature]**

Date **Nov 2<sup>nd</sup> /88** Recorder Holder's Signature **[Signature]**

Certification Verifying Report of Work

I hereby certify that I have a personal and intimate knowledge of the facts set forth in the Report of Work annexed hereto, having performed the work or witnessed same during and/or after its completion and the annexed report is true.

Name and Postal Address of Person Certifying **ROLAND V. HILL, MOOSE CROSSING FARM, LARDER LAKE, ONT. POK 110**

Date Certified **Nov. 2/88** Certified by (Signature) **[Signature]**



Name and Postal Address of Recorded Holder: **ROLAND V HILL**  
**MOOSE CROSSING FARM LARDER LAKE OUT POK-110**

Prospector's Licence No. **K19108**

Summary of Work Performance and Distribution of Credits

Total Work Days Cr. claimed	Mining Claim			Work Days Cr.	Mining Claim			Work Days Cr.	Mining Claim			Work Days Cr.
	Prefix	Number	Work Days Cr.		Prefix	Number	Work Days Cr.		Prefix	Number	Work Days Cr.	
<b>26</b>	<b>L</b>	<b>919832</b>	<b>16</b>									
for Performance of the following work. (Check one only)	<input checked="" type="checkbox"/>	<b>919833</b>	<b>5</b>									
	<input type="checkbox"/>	<b>919827</b>	<b>5</b>									
	<input type="checkbox"/>											

for Performance of the following work. (Check one only)

- Manual Work
- Shaft Sinking Drifting or other Lateral Work.
- Compressed Air, other Power driven or mechanical equip.
- Power Stripping
- Diamond or other Core drilling
- Land Survey

All the work was performed on Mining Claim(s): **919832 CATHERINE TOWNSHIP SE CORNER OF S HALF LOT 10 CON 5**

Required Information eg: type of equipment, Names, Addresses, etc. (See Table Below)

		HOURS	DAYS
12-4-87	ROLAND V HILL MOOSE CROSSING FARM, HWY 16, LARDER LAKE, ONT. POK-110	70	7
18-4-87	MIKE PRENTICE 66 GRIERSON RD, KIRKLAND LAKE, ONT.	30	3
18-4-87	RON EDVKE 38 RAND E, KIRKLAND LAKE, ONT.	30	3
26-4-87	DEAN PETERS KIRKLAND LAKE ONT.	20	2
25-4-87	FRANK PLEBER 71-9 <sup>th</sup> AVE LARDER LAKE ONT.	5	1
<b>TOTAL</b>		<b>158</b>	<b>15</b>

**WORK STRIPPING TRENCHING AND PROSPECTING**

LARDER LAKE  
MINING DIV.  
NOV 2 1988  
11:45 AM

L 919832

N  
↑

**CREDITS 26 DAYS**

Date of Report: **NOV 1<sup>st</sup> / 1988**  
 Recorded Holder or Agent (Signature): *[Signature]*

Certification Verifying Report of Work

I hereby certify that I have a personal and intimate knowledge of the facts set forth in the Report of Work annexed hereto, having performed the work or witnessed same during and/or after its completion and the annexed report is true.

Name and Postal Address of Person Certifying: **ROLAND V. HILL, LARDER LAKE, ONT. POK-110**

Date Certified: **NOV 2/88**  
 Certified by (Signature): *[Signature]*

Table of Information/Attachments Required by the Mining Recorder

Type of Work	Specific information per type	Other information (Common to 2 or more types)	Attachments
Manual Work	Nil	Names and addresses of men who performed manual work/operated equipment, together with dates and hours of employment.	Work Sketch: these are required to show the location and extent of work in relation to the nearest claim post.
Shaft Sinking, Drifting or other Lateral Work			
Compressed air, other power driven or mechanical equip.	Type of equipment	Names and addresses of owner or operator together with dates when drilling/stripping done.	
Power Stripping	Type of equipment and amount expended. Note: Proof of actual cost must be submitted within 30 days of recording.		
Diamond or other core drilling	Signed core log showing; footage, diameter of core, number and angles of holes.	Nil	Work Sketch (as above) in duplicate
Land Survey	Name and address of Ontario land surveyor.		Nil

Moose Crossing Farm,  
Hwy 66,  
Larder Lake.

Ont. POK 110.

Nov. 8th 1988.

Mr Arthur Barr,  
Land Management Branch,  
Ministry of Northern Dev of Mines,  
6th Floor,  
Witney Block Room 6610,  
99 Wellesley Street West,  
Queen's Park  
Toronto. Ont. M7A 1W3.

RECEIVED

NOV 15 1988

MINING LANDS SECTION

Dear Sir,

Please find enclosed the following:

Report of Work (2 copies)  
Record of Assays (2 copies)  
Samples of drill core on claims 919832,  
919833 and 919827 in Catherine  
Township Larder Lake Mining Division.

Yours Truly.



# INCO

Field Exploration

December 7, 1987

To Whom It May Concern:

Charges for preparation and analyses of samples FX 219941 to FX 220000 incl. and FX 252854 to FX 252873 incl. are:

80 samples @ \$7.50 for gold assay	- \$600.00
80 samples @ \$4.00 for preparation	- \$320.00
	<hr/>
Total	\$920.00



A. A. Wiebe  
Supt. Assay Stations



R. HILLS PROPERTY, CATHERINE TWP., ONTARIO. NTS 32 D 4  
Sample series collected for assay from diamond drill  
hole Gold Moose #1

SAMPLE NUMBER	FROM	TO
FX219941	3.5ft	7.0ft
FX219942	7.0ft	9.0ft
FX219943	9.0ft	12.0ft
FX219944	12.0ft	14.0ft
FX219945	14.0ft	16.0ft
FX219946	16.0ft	17.3ft
FX219947	17.3ft	19.0ft
FX219948	19.0ft	21.5ft
FX219949	21.5ft	23.0ft
FX219950	23.0ft	25.0ft
FX219951	25.0ft	26.3ft
FX219952	26.3ft	27.3ft
FX219953	27.3ft	28.4ft
FX219954	28.4ft	29.6ft
FX219955	29.6ft	31.0ft
FX219956	31.0ft	31.6ft
FX219957	31.6ft	33.0ft
FX219958	33.0ft	33.8ft
FX219959	33.8ft	35.0ft
FX219960	35.0ft	35.8ft
FX219961	35.8ft	36.7ft
FX219962	36.7ft	38.0ft
FX219963	38.0ft	39.0ft
FX219964	39.0ft	40.0ft
FX219965	40.0ft	41.1ft
FX219966	41.1ft	41.9ft
FX219967	41.9ft	43.0ft
FX219968	43.0ft	44.0ft
FX219969	44.0ft	44.3ft
FX219970	44.3ft	45.1ft
FX219971	45.1ft	46.2ft
FX219972	46.2ft	47.3ft
FX219973	47.3ft	48.2ft
FX219974	48.2ft	48.9ft
FX219975	48.9ft	50.0ft
FX219976	50.0ft	51.0ft
FX219977	51.0ft	52.0ft
FX219978	52.0ft	53.0ft
FX219979	53.0ft	54.0ft
FX219980	54.0ft	55.0ft
FX219981	55.0ft	56.0ft
FX219982	56.0ft	57.0ft
FX219983	57.0ft	58.0ft
FX219984	58.0ft	59.0ft
FX219985	59.0ft	60.0ft
FX219986	60.0ft	61.0ft
FX219987	61.0ft	62.0ft
FX219988	62.0ft	63.0ft
FX219989	63.0ft	64.0ft
FX219990	64.0ft	65.0ft
FX219991	65.0ft	66.0ft
FX219992	66.0ft	67.0ft
FX219993	67.0ft	68.0ft
FX219994	68.0ft	69.0ft
FX219995	69.0ft	70.0ft

FX219996	70.0ft	71.0ft
FX219997	71.0ft	72.0ft
FX219998	72.0ft	73.0ft
FX219999	73.0ft	74.0ft
FX220000	74.0ft	75.0ft
FX252854	75.0ft	76.0ft
FX252855	76.0ft	77.0ft
FX252856	77.0ft	78.0ft
FX252857	78.0ft	79.0ft
FX252858	79.0ft	80.0ft
FX252859	80.0ft	81.0ft
FX252860	81.0ft	82.0ft
FX252861	82.0ft	83.4ft
FX252862	83.4ft	84.5ft
FX252863	84.5ft	85.6ft
FX252864	85.6ft	86.6ft
FX252865	86.6ft	88.0ft
FX252866	88.0ft	89.5ft
FX252867	89.5ft	91.0ft
FX252868	91.0ft	92.0ft
FX252869	92.0ft	94.1ft
FX252870	94.1ft	98.0ft
FX252871	98.0ft	100.0ft
FX252872	100.0ft	102.0ft
FX252873	102.0ft	104.0ft

McELROY TP

NOTES

400' surface right reservation along the shores of all lakes and rivers.

AREAS WITHDRAWN FROM DISPOSITION

- M.R.O. - MINING RIGHTS ONLY
- S.R.O. - SURFACE RIGHTS ONLY
- M.+S. - MINING AND SURFACE RIGHTS

Description Order No. Date Disposition File

NOTICE OF FORESTRY ACTIVITY

THIS TOWNSHIP / AREA FALLS WITHIN THE \_\_\_\_\_  
 TIMISKAMING MANAGEMENT UNIT  
 AND MAY BE SUBJECT TO FORESTRY OPERATIONS.  
 THE MNR UNIT FORESTER FOR THIS AREA CAN BE  
 CONTACTED AT: P.O. BOX 129  
 SWASTIKA, ONT.  
 POK ITO  
 705-642-3222

LEGEND

- PATENTED LAND
- PATENTED FOR SURFACE RIGHTS ONLY
- LEASE
- LICENSE OF OCCUPATION
- CROWN LAND SALES
- LOCATED LAND
- CANCELLED
- MINING RIGHTS ONLY
- SURFACE RIGHTS ONLY
- HIGHWAY & ROUTE NO.
- ROADS
- TRAILS
- RAILWAYS
- POWER LINES
- MARSH OR MUSKEG
- MINES

\*used only with summer resort locations or when space is limited

TOWNSHIP OF

CATHARINE

DISTRICT OF  
TIMISKAMING

LARDER LAKE

MINING DIVISION 10100505

SCALE: 1 INCH = 40 CHAINS (1/2 MILE)

DR. \_\_\_\_\_ PLAN NO. G-3615  
 DATE JULY 1986

Ministry of Natural Resources  
 Ministry of Northern Development and Mines

Ontario  
 DATE OF ISSUE

PACAUD TP.

SKEAD TP.

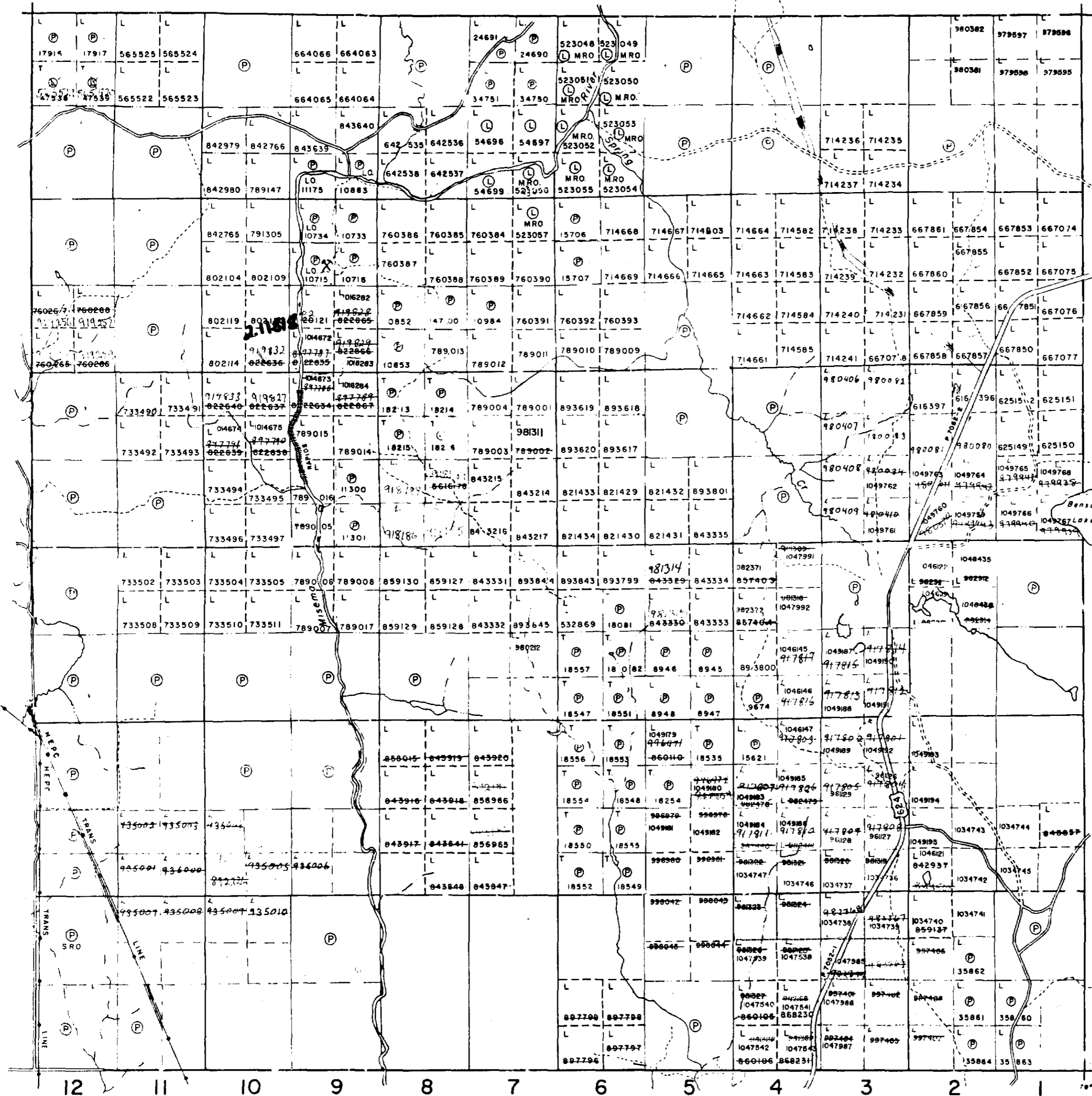

31M13NW0050 2.11818 CATHARINE

WARTER TP.