



31M13NW0060 36 CATHARINE

010

DIAMOND DRILLING

TOWNSHIP: CATHARINE TWP.

REPORT NO:36

WORK PERFORMED FOR: Rolland Hill

RECORDED HOLDER: Same as Above [xx]
: Other []

<u>Claim No.</u>	<u>Hole No.</u>	<u>Footage</u>	<u>Date</u>	<u>Note</u>
L 919832	GM.1	104	Sept/87	(1)

NOTES: (1) #426-87, filed in April/88.

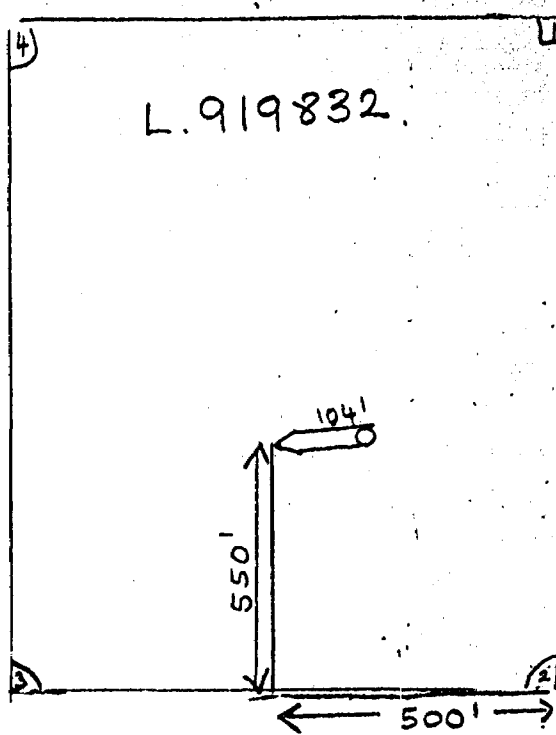

Sketch map of diamond drill

location on claim L.919832.

Catherine Township.

Lot 10 Con 5. SE Corner of
S half.

McELROY TP

PACAUD TR.

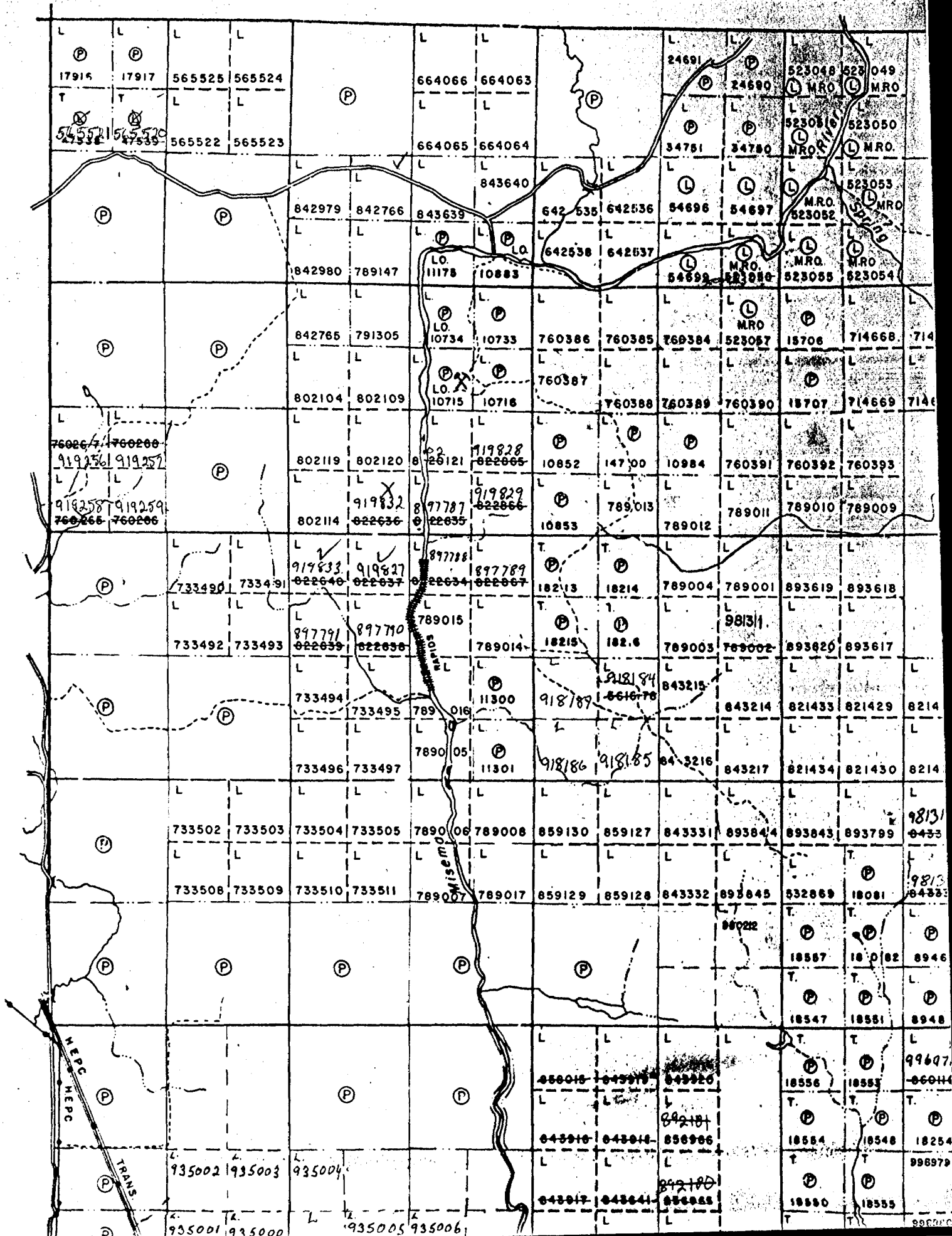

426



31M13NW0060 36 CATHARINE

900

Catharine Twp. Mining Act
Name and Postal Address of Recorded Holder

ROLAND V. HILL

MOOSE CROSSING FARM HWY 66 LARDER LAKE

Summary of Work Performance and Distribution of Credits

Total Work Days Cr. claimed	Mining Claim			Work Days Cr.	Mining Claim			Work Days Cr.
	Prefix	Number	Work Days Cr.		Prefix	Number	Work Days Cr.	
104		919832	44					
		919833	30					
		919827	30					
Performance of the following work. (Check one only)								
<input type="checkbox"/> Manual Work								
<input type="checkbox"/> Shaft Sinking Drifting or other Lateral Work.								
<input type="checkbox"/> Compressed Air, other Power driven or mechanical equip.								
<input type="checkbox"/> Power Stripping								
<input checked="" type="checkbox"/> Diamond or other Core drilling								
<input type="checkbox"/> Land Survey								

ONTARIO GEOLOGICAL SURVEY
ASSESSMENT FILES
RESEARCH OFFICE
NOV 6 1987
RECEIVED

All the work was performed on Mining Claim(s): 919832 CATHERINE TOWNSHIP.

Required Information eg: type of equipment, Names, Addresses, etc. (See Table Below)

BOYLES DIAMOND DRILL
OWNER/OPERATOR, ROLAND V. HILL
MOOSE CROSSING FARM,
HWY 66,
LARDER LAKE
ONTARIO.
Sept 7th 1987
" 11th 1987
Cme Sme E

LARDER LAKE MINING DIV.
RECEIVED
NOV 3 1987
9:20 AM PM
18 19 10 11 12 1 2 3 4 5 6

RECORDED
NOV 3 1987
Receipt # _____

Date of Report: Nov 3rd 1987
Recorded Holder or Agent (Signature): R V Hill

Certification Verifying Report of Work

I hereby certify that I have a personal and intimate knowledge of the facts set forth in the Report of Work annexed hereto, having performed the work or witnessed same during and/or after its completion and the annexed report is true.

Name and Postal Address of Person Certifying: ROLAND V HILL MOOSE CROSSING FARM

HWY 66 LARDER LAKE ONT Date Certified: Nov 3rd 1987 Certified by (Signature): R V Hill

Table of Information/Attachments Required by the Mining Recorder

Type of Work	Specific information per type	Other information (Common to 2 or more types)	Attachments
Manual Work	Nil	Names and addresses of men who performed manual work/operated equipment, together with dates and hours of employment.	Work Sketch: these are required to show the location and extent of work in relation to the nearest claim post.
Shaft Sinking, Drifting or other Lateral Work			
Compressed air, other power driven or mechanical equip.	Type of equipment	Names and addresses of owner or operator together with dates when drilling/stripping done.	Work Sketch (as above) in duplicate
Power Stripping	Type of equipment and amount expended. Note: Proof of actual cost must be submitted within 30 days of recording.		
Diamond or other core drilling	Signed core log showing; footage, diameter of core, number and angles of holes.	Nil	Nil
Land Survey	Name and address of Ontario land surveyor.		