



SWASTIKA LABORATORIES LIMITED

P.O. BOX 10, SWASTIKA, ONTARIO P0K 1T0
TELEPHONE: (705) 642-3244 FAX: (705) 642-3300
ANALYTICAL CHEMISTS • ASSAYERS • CONSULTANTS

Certificate



31M13NW0062 2.11435 CATHARINE

010

Certificate No. 70979

Date: May 11, 1988

Received May 9, 1988 5 Samples of rock

Submitted by Ferguson Mining Services, Matachewan, Ontario (for Roy Annett)

CATHARINE TWP

SAMPLE NO.	GOLD Oz./ton
8147	Nil (6)
8148	Nil/0.002 (7)
8149	Nil (8)
8150	Nil (9)
8151	Nil (10)

Per
G. Lebel, Manager/dg



ESTABLISHED 1928



SWASTIKA LABORATORIES LIMITED

P.O. BOX 10, SWASTIKA, ONTARIO P0K 1T0
TELEPHONE: (705) 642-3244 FAX: (705) 642-3300
ANALYTICAL CHEMISTS • ASSAYERS • CONSULTANTS

Certificate of Analysis

Certificate No. 70939 Date: May 6, 1988
Received May 5, 1988 5 Samples of Rock
Submitted by Ferguson Mining Services, Matachewan, Ontario.

	SAMPLE NO.	GOLD Oz/ton
①	8142	Nil
②	8143	Nil
③	8144	0.045/0.030
④	8145	Nil
⑤	8146	0.010

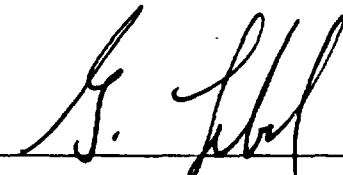
Per 
G. Lebel - Manager /ns



L843216

L843215

~~L843217~~
L843217

L843214

L981311

BOUNDARY LINE

L821433

L893620

L893619

L821434

① 600'

L821429

L893617

L893618

L821430

② 700'
③ 600'

L893799

L821432

L821431

CAR PARK
④
⑤

L891314

Ⓟ

L893801

L843335

L843334

Ⓟ

Ⓟ

B/L

L893799

(P)

18081

26 E

L981314

③ 000
450'

(P)

8946

L981315

L843334

ROAD

(P)

8945

L843333

L982371

~~L893800~~

(P)

9674

L982372

ROAD

L981309

(P)

L981316

L1046145

LOADING

L1046146

(P)

15621

L1046147



Ministry of Northern Development and Mines

Land Management

Report of Work

(Geophysical, Geological, Geochemical and Expenditures)

DOCUMENT No.

W8808-326

Instructions: - Please type or print.

- If number of mining claims traversed exceeds space on this form, attach a list.

Note: - Only days credits calculated in the "Expenditures" section may be entered in the "Expend. Days Cr." columns. - Do not use shaded areas below.

Mining Act

Type of Survey(s) 2.11435 Township or Area CATHARINE TWP

Claim Holder(s) ROY ANNETT Prospector's Licence No. J6257

Address SHINING TREE ONT. POM 2X0

Survey Company _____ Date of Survey (from & to) _____ Total Miles of line Cut _____
 Day | Mo. | Yr. | Day | Mo. | Yr.

Name and Address of Author (of Geo-Technical report) _____

Credits Requested per Each Claim in Columns at right

Special Provisions	Geophysical	Days per Claim
For first survey: Enter 40 days. (This includes line cutting)	- Electromagnetic	
	- Magnetometer	
For each additional survey: using the same grid: Enter 20 days (for each)	- Radiometric	
	- Other	
	Geological	
Man Days Complete reverse side and enter total(s) here	Geochemical	
	Geophysical	Days per Claim
	- Electromagnetic	
Airborne Credits Note: Special provisions credits do not apply to Airborne Surveys.	- Magnetometer	
	- Radiometric	
	Geological	
	Geochemical	

Mining Claims Traversed (List in numerical sequence)

Mining Claim			Expend. Days Cr.	Mining Claim		Expend. Days Cr.
Prefix	Number	Prefix		Number		
L	843335	7.8				

RECEIVED

JUL 26 1988

MINING LANDS SECTION

LARDER ROCK MINING RECEIVED JUL 1 1988 AM

20% of mining claims covered by this report of work.

Expenditures (excludes power stripping)

Type of Work Performed ASSAY

Performed on Claim(s) _____

Calculation of Expenditure Days Credits

Total Expenditures \$ 117.50 ÷ 15 = 7.8 Total Days Credits

Instructions
Total Days Credits may be apportioned at the claim holder's choice. Enter number of days credits per claim selected in columns at right.

For Office Use Only

Total Days Cr. Recorded 7.8 Date Recorded July 11/88 Mining Recorder [Signature]

Date Approved as Recorded See Reversed Statement Branch Director [Signature]

Date JULY 11/88 Recorded Holder or Agent (Signature) R.B. [Signature]

Certification Verifying Report of Work

I hereby certify that I have a personal and intimate knowledge of the facts set forth in the Report of Work annexed hereto, having performed the work or witnessed same during and/or after its completion and the annexed report is true.

Name and Postal Address of Person Certifying _____



Ontario

Ministry of
Northern Development
and Mines

Ministère du
Développement du Nord
et des Mines



31M13NW0062 2.11435 CATHARINE

900

August 11, 1988

Your file: W8808-326

Our file: 2.11435

Mining Recorder
Ministry of Northern Development and Mines
4 Government Road East
Kirkland Lake, Ontario
P2N 1A2

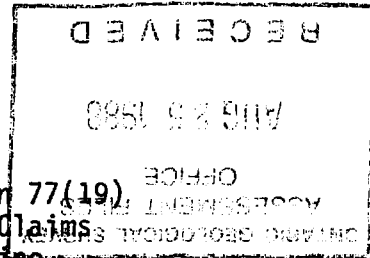

Dear Sir:

Re: Data for Assaying submitted under Section 77(19)
of the Mining Act R.S.O. 1980 on Mining Claims
L 821429 et al in the Township of Catharine

The enclosed statement of assessment work credits for Assaying
has been approved as of the above date.

Please inform the recorded holder of these mining claims and so
indicate on your records.

Yours sincerely,

W.R. Cowan, Manager
Mining Lands Section
Mines & Minerals Division

Whitney Block, Room 6610
Queen's Park
Toronto, Ontario
M7A 1W3

J.S.H.:pl
Enclosure (2)

cc: Resident Geologist
Kirkland Lake, Ontario

Mr. Roy Annett
Shining Tree, Ontario
POM 2X0

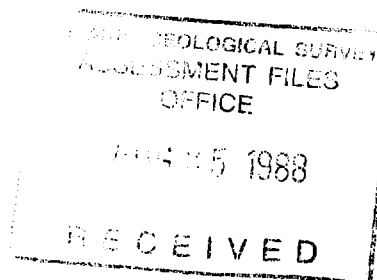



Recorded Holder
Roy Annett

Township ~~XXXXX~~
Catharine

Type of survey and number of Assessment days credit per claim	Mining Claims Assessed
Geophysical Electromagnetic _____ days Magnetometer _____ days Radiometric _____ days Induced polarization _____ days Other _____ days	<p>\$117.50 SPENT ON ASSAYING SAMPLES TAKEN FROM MINING CLAIMS:</p> <p>L 821429-31-34 893617 981314</p>
Section 77 (19) See "Mining Claims Assessed" column Geological _____ days Geochemical _____ days Man days <input type="checkbox"/> Airborne <input type="checkbox"/> Special provision <input type="checkbox"/> Ground <input type="checkbox"/> <input type="checkbox"/> Credits have been reduced because of partial coverage of claims. <input type="checkbox"/> Credits have been reduced because of corrections to work dates and figures of applicant.	

Special credits under section 77 (16) for the following mining claims

No credits have been allowed for the following mining claims

not sufficiently covered by the survey insufficient technical data filed

McELROY TP

NOTES

400' surface rights reservation along the shores of all lakes and rivers.

PACAUD TP

SKEAD TP

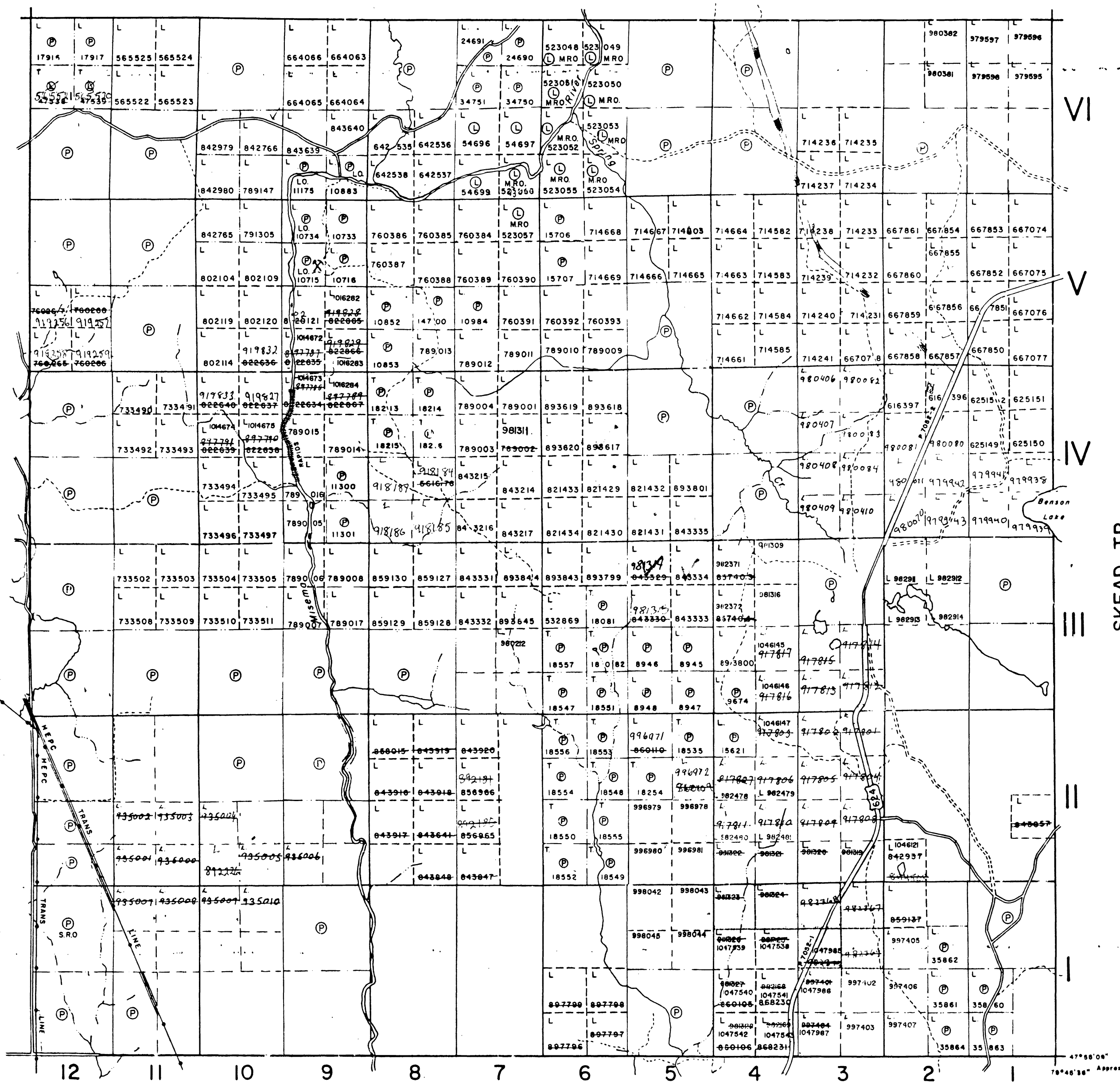

AREAS WITHDRAWN FROM DISPOSITION

- M.R.O. - MINING RIGHTS ONLY
- S.R.O. - SURFACE RIGHTS ONLY
- M.+S. - MINING AND SURFACE RIGHTS

Description	Order No.	Date	Disposition	File

NOTICE OF FORESTRY ACTIVITY

THIS TOWNSHIP / AREA FALLS WITHIN THE _____
TIMISKAMING MANAGEMENT UNIT
AND MAY BE SUBJECT TO FORESTRY OPERATIONS.
THE MNR UNIT FORESTER FOR THIS AREA CAN BE CONTACTED AT:
P.O. BOX 129
SWASTIKA, ONT.
POK 1T0
705 642-3222

LEGEND

- PATENTED LAND (P or P⁺)
- PATENTED FOR SURFACE RIGHTS ONLY (P⁺)
- LEASE (L)
- LICENSE OF OCCUPATION (L.O.)
- CROWN LAND SALES (C.S.)
- LOCATED LAND (Loc.)
- CANCELLED (C.)
- MINING RIGHTS ONLY (M.R.O.)
- SURFACE RIGHTS ONLY (S.R.O.)
- HIGHWAY & ROUTE NO. (17)
- ROADS
- TRAILS
- RAILWAYS
- POWER LINES
- MARSH OR MUSKEG
- MINES

*used only with summer resort locations or when space is limited

TOWNSHIP OF
CATHARINE
DISTRICT OF
TIMISKAMING
LARDER LAKE
MINING DIVISION 05060304
SCALE: 1 INCH = 40 CHAINS (1/2 MILE)

DR. K.I.I.	PLAN NO. G-3615
DATE JULY 1986	

MARTER TP

