

Diamond Drilling



31M13NW0126 15 PACAUD

010

Township of PACAUD

Report N^o 15

Work performed by: Hans Laskowski

Claim N ^o	Hole N ^o	Footage	Date	Note
L 341310	2	209.0	May/76	(1)
	2	240.0	May/77	(2)

Notes:

(1) #112-77

(2) #157-78

Report #15

Marquis Twp.

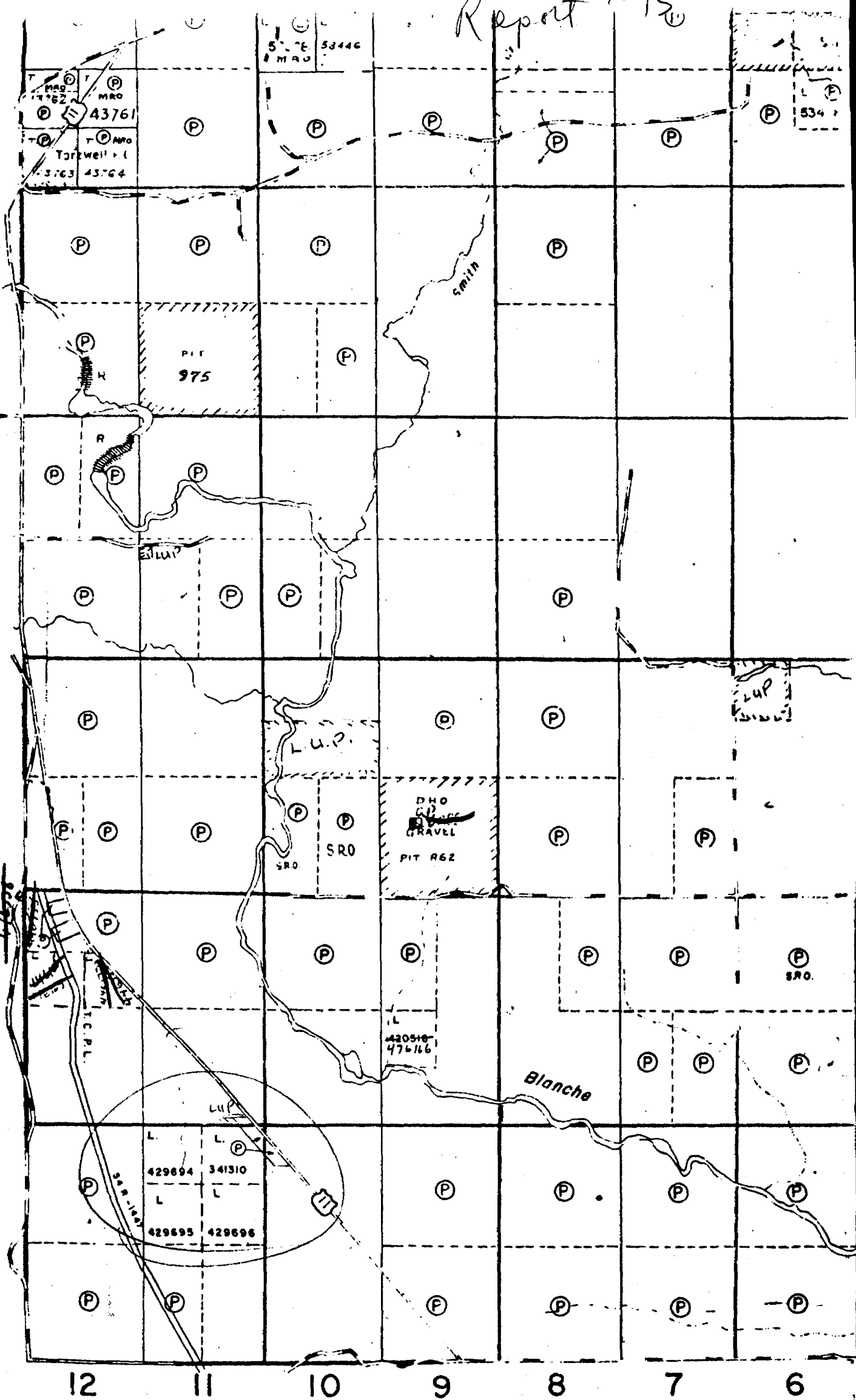

Pacard Twp

M380

#112-77

Hans Lashowski

Chamberlain Twp



THE MINING ACT - DEPARTMENT OF MINES
DIAMOND DRILLING LOG

Start a new page for every new hole, but fill in top portion of form only on first page for each hole.

FILL IN ON EVERY PAGE

MOLE NO. 2 PAGE NO. 1

DRILLING COMPANY OWNER OPERATED		COLLAR ELEVATION	BEARING OF HOLE FROM TRUE NORTH 60° (approx) NW	TOTAL FOOTAGE 209'	DIP OF HOLE AT collar 45°	LOCATION OF HOLE IN RELATION TO A FIXED POINT ON THE CLAIM North East part 600 ft west then 1,000 ft south	MAP REFERENCE NO. M 380	CLAIM NO. L 341310	
DATE HOLE STARTED MAY 5, 1976	DATE COMPLETED JULY 8, 1976	DATE LOGGED AUG 9, 1976	LOGGED BY G.L. LOSSER		ft	L 341310	LOCATION (Tp., Lot, Con. OR Lat. and Long.) PACAUD TWP. LOT 11 CON. I		
EXPLORATION CO., OWNER OR OPTIONEE HANS LASKOWSKI		DATE SUBMITTED	SUBMITTED BY (Signature) H LASKOWSKI		ft		PROPERTY NAME LASKOWSKI		
					ft				

FOOTAGE		ROCK TYPE	DESCRIPTION Colour, grain size, texture, minerals, alteration, etc.	PLANAR FEATURE ANGLE	CORE SPECIMEN FOOTAGE +	YOUR SAMPLE NUMBER	SAMPLE FOOTAGE		SAMPLE LENGTH	ASSAYS +	
FROM	TO						FROM	TO			
0.0	10.0	GRANITE SYENITE	LT PINK GREY GREEN, MEDIUM GRAIN								
10.	20.	" "	" "								
20.	30.	" "	" "								
30.	40.	" "	" "								
40.	48.5	" "	" "								
48.5	49.5	" "	ORANGE RED COARSE QUARTZ, FEW IRON PYRITES								
49.5	55.3	" "	REDDISH GREY GREEN MEDIUM " "								
55.3	61.3	" "	BROWNISH GREY FINE GRAIN " "								
61.3	67.6	GRANITE	LT. GREY GREEN SOME QUARTZ SECTIONS PYRITES								
67.6	81.	ANDESITE?	DARK GREEN, FINE, PYRITES & 1/16" QUARTZITE?								
81	95.4	GRANITE	V. LT. GREEN WITH COARSE QUARTZ SECTIONS								
95.4	96.4	ANDESITE?	DARK GREEN, FINE, PYRITES & 1/16" QUARTZITE?								
96.4	105.	GRANITE	V. LT. GREEN WITH COARSE QUARTZ SECTIONS								
105	125.	GRANITE	" " " " " "								
125	134.6	GRANITE	ORANGE GREEN COARSE QUARTZ SECTIONS SMALL PYRITES								
134.6	144.	ANDESITE?	DARK GREEN, FINE, PYRITES & 1/16" QUARTZITE								
144	150.	GRANITE	REDDISH ORANGE COARSE								
150	160.	" "	GREY GREEN, MEDIUM FEW PYRITES								
160	180.	" "	REDDISH GREY, MEDIUM " "								
180	190.	" "	" "								
190	205.5	" "	FLESH COLOUR QUARTZ SECTION, COARSE								
205.5	206.	" "	" " QUARTZ SECTION								
206	209.	GRANITE	REDDISH, MEDIUM								

+ For features such as foliation, bedding, schistosity, measured from the long axis of the core.

+ Additional credit available. See Assessment Work Regulations.



THE MINING ACT - DEPARTMENT OF MINES
DIAMOND DRILLING LOG

Start a new page for every new hole, but fill in top portion of form only on first page for each hole.

FILL IN ON EVERY PAGE

HOLE NO. 2 PAGE 2
CLAIM NO. L-3410

DRILLING COMPANY <i>Hans & Fred Koskowski</i>		COLLAR ELEVATION	BEARING OF HOLE FROM TRUE NORTH <i>20° 5'</i>	TOTAL FOOTAGE <i>240'</i>	DIP OF HOLE AT COLLAR <i>45°</i>	LOCATION OF HOLE IN RELATION TO A FIXED POINT ON THE CLAIM <i>Approx 300' from SW post of claim number 341310</i>	MAP REFERENCE NO.	CLAIM NO. <i>L-3410</i>
DATE HOLE STARTED <i>May 1977</i>	DATE COMPLETED <i>Sep 30/77</i>	DATE LOGGED <i>OCT 25/77</i>	LOGGED BY			LOCATION (Tp., Lot, Con. OR Lat. and Long.) <i>Pacaud Tp., Con 1, lot 11</i>		
EXPLORATION CO., OWNER OR OPTIONEE <i>Hans Koskowski</i>		DATE SUBMITTED <i>Nov 1/77</i>	SUBMITTED BY (Signature)				PROPERTY NAME <i>Koskowski, Hans</i>	

FOOTAGE		ROCK TYPE	DESCRIPTION Colour, grain size, texture, minerals, alteration, etc.	PLANAR FEATURE ANGLE	CORE SPECIMEN FOOTAGE +	YOUR SAMPLE NUMBER	SAMPLE FOOTAGE		SAMPLE LENGTH	ASSAYS +	
FROM	TO						FROM	TO			
120	122	Grey granite	Cut by pink feldspar and quartz patches.								
122	124	Grey granite									
124	129	Pink granite	5" of grey granite, some coarse grained pink feldspar and white quartz.								
129	130	Quartz vein	4" wide and blue coloured has chalcopryrite bleb.								
130	130.5	Grey granite									
130.5	131	Pink feldspar	Whitish quartz.								
131	132	Grey granite	4% disseminated chalcopryrite.								
132	135	Pink granite									
135	146	Grey granite	4% disseminated pyrite, and white quartz vein 6 mm wide with few chalcopryrite blebs. 142 to 142.5' has 3% disseminated blebs chalcopryrite.								
146	148	Pink granite	Cut by quartz veins.								
148	151	Grey granite									
151	154	Pink granite									
154	160	Red granite	Hematite stained, cut by quartz veins. Red granite has little pyrite, one cube being 1 cm square, and cut by many brown-rust-coated fractures.								
160	168	Pink granite									
168	169	Diorite	With 4% pyrite. Greenish (olive drab) minerals enveloped in white, some white feldspar phenocrysts 3 mm long.								
169	198	Pink granite	3% chlorite.								
198	205	Red granite	5% chlorite.								
205	212	Pink granite									
212	237	Red & pink granite	Few specks of specular hematite, along maroon-stained fractures.								
237	240		Lost core.								

* For features such as ...

+ Additional credit available. See Assessment Work Regu

850' South of
No 11 Post
260' East
Drill hole 25° SW
45° angle

