

DIAMOND DRILLING



31M13NW0134 15 MARTER

010

TOWNSHIP: Marter

REPORT No.: 15

WORK PERFORMED BY: Terry Gold Explorations Inc.

<u>CLAIM No.</u>	<u>HOLE No.</u>	<u>FOOTAGE</u>	<u>DATE</u>	<u>NOTE</u>
L 555547	TM 81-1	480.0	Feb/81	(1) (2)
	TM 81-2	279.0	Feb/81	(1) (2)
	TM 81-3	278.0	Feb/81	(1) (2)
		<hr/>		
		1037'		

NOTES: (1) #118-81  
(2) Submitted under O.M.E.P. → #OM18-PE15-C-80



# HARPER Consulting Services Inc.



H. Grant Harper P. Eng., President  
Consulting Engineer & Geologist

314 Hendon Avenue  
Willowdale, Ontario M2M 1B2  
(416) 225-7412

March 18, 1981.

Officers and Directors,  
Terry Gold Explorations Inc.,  
Suite 806,  
88 University Ave.,  
Toronto.

Summary Report: 1981 drill program;  
Marter Twp. property

Gentlemen,

Herewith is a Summary Report on the results of 3 diamond drill holes totalling 1037 linear feet of BQ core drilled on your Marter Township copper-gold prospect.

DDH TM80-1 tested the green carbonate - quartz vein zone that is partially exposed along the east bank of the Blanche River. The work done in the 1950's had not tested under the Blanche River consequently hole TM80-1 was collared on the west side of the river and thus intersected all of the rocks underlying the river bed.

The rocks intersected were highly altered lavas now in the form of talcy green carbonate and chlorite rocks cut by numerous bull quartz veins. The best assay occurred under the Blanche River where 0.3 feet of core assayed 0.08 ounces of gold per ton. Elsewhere, low gold values were encountered. The rocks of the area are highly folded, contorted, sheared, and altered.

Drill holes TM80-2 and TM80-3 tested the area of the timbered shaft and trenches. This zone was re-discovered subsequent to the surveys and there is no record of it in the government records. It lies on the northward extension of a strong VLF conductor.

DDH TM80-2 was drilled directly under the timbered shaft. No significant amounts of mineralization were recognized in

this drill hole but at the anticipated favourable horizon a felspar porphyry dike was intersected and this may have displaced the mineralized zone along the trace of the two structures. The best assay result was 0.023 ounces of gold across 2.4 feet of core. This mineralization occurs about 50 feet east of the shaft collar.

DDH TM80-3 located 75 feet south of DDH TM80-2 intersected 9.8 feet of mineralization consisting of quartz veins and bands of massive pyrite up to 8 inches in length. Low gold values occurred with this mineralization.

#### Conclusion and Recommendations

DDH TM80-1 tested the River Zone and was one of three holes planned to do so. The others were not drilled due to rig moving difficulties caused by the rough terrain and winter conditions. The results to date warrant drilling the two planned holes.

The best gold occurrences located in the drilling lie west of the River Showing and east of the Shaft Showing. Between the collars of holes TM80-1 and TM80-2 is some 300 feet of untested ground which should be drill tested.

The two holes under the Shaft Zone lie at the north limit of a strong VLF conductor. This conductor should be drill tested elsewhere along its strike.

Yours truly,

*H. G. Harper.*

Correction:

DDH numbers 80 should read 81

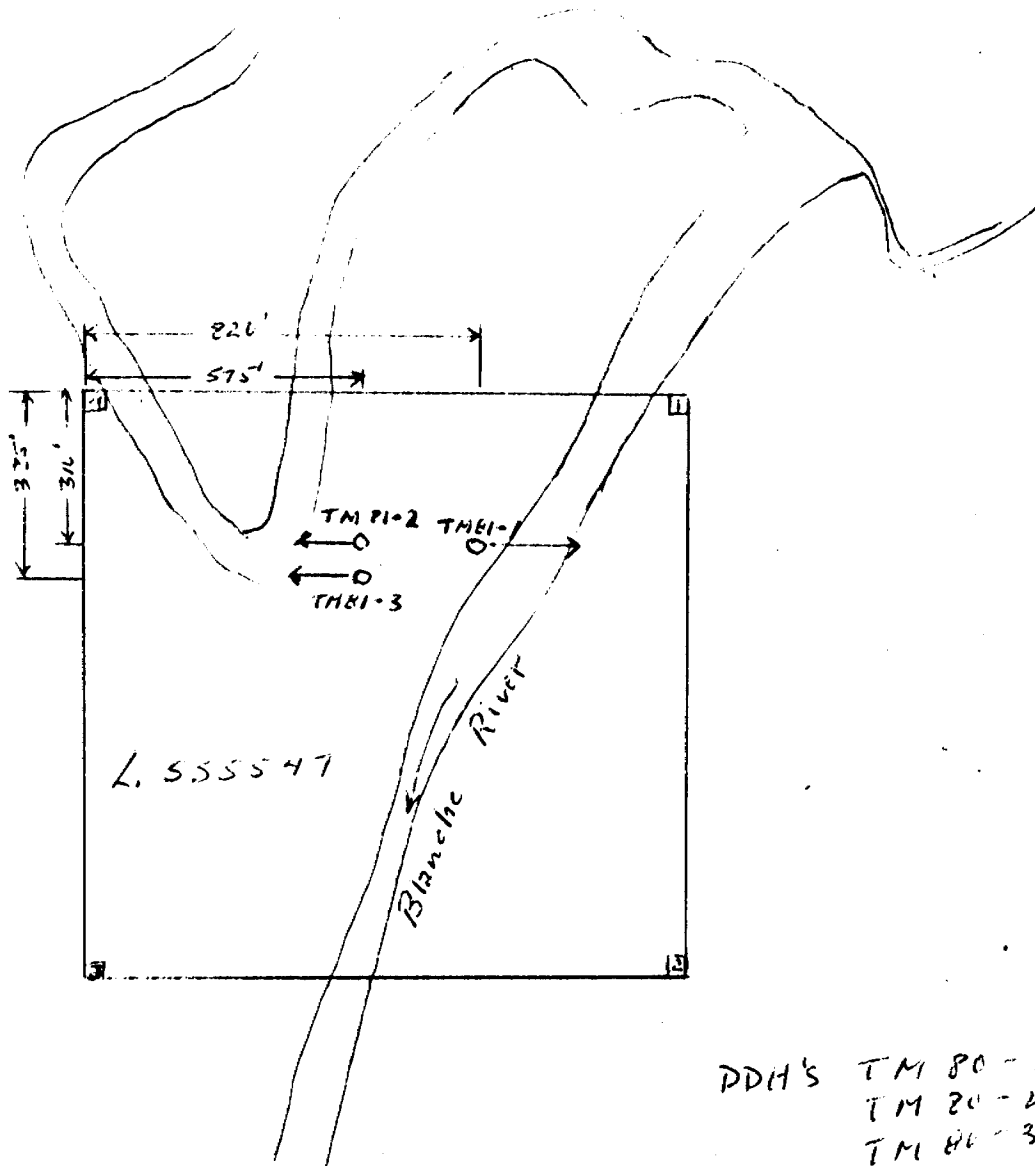

DDH'S TM 80-1 - 55' - 430'  
TM 80-2 - 55' - 274'  
TM 80-3 - 55' - 278'  
1037'

Terry Gold Explorations Inc.  
Marter Top Property  
1" = 400'

#118-81

THE TOWNSHIP  
OF 14543

# MARTER

May 30/80  
DISTRICT OF  
TIMISKAMING

LARDER LAKE  
MINING DIVISION

SCALE: 1-INCH = 40 CHAINS

## LEGEND

PATENTED LAND	(P)
CROWN LAND SALE	C.S.
LEASES	(L)
LOCATED LAND	Loc.
LICENSE OF OCCUPATION	L.O.
ROADS	— — — — —
IMPROVED ROADS	— — — — —
RAILWAYS	— — — — —
POWER LINES	— — — — —
MARSH OR MUSKEG	— — — — —
WATER POWER LEASE	W.P.L.

## NOTES

400' Surface Rights Reservation around  
all Lakes and Rivers

Mining Claims on N. 1/2 Lot 1 Con 6

SW 1/4	" 2 "	6
NW 1/4	" 2 "	5
N. 1/2	" 1 "	5

will be exclusive of grave! purposes.

Areas withdrawn from staking under Section  
43 of the Mining Act (R.S.O. 1970).

Order No.	File	Date	Disposition
(M)	30852	19/10/71	S.R. & M.R.
(W)	W90/80NR. 31283	25/4/80	S.R.O.

DATE OF ISSUE

MAY 30 1980

SURVEYS AND MAPPING

SAND AND GRAVEL

QUARRY PERMIT

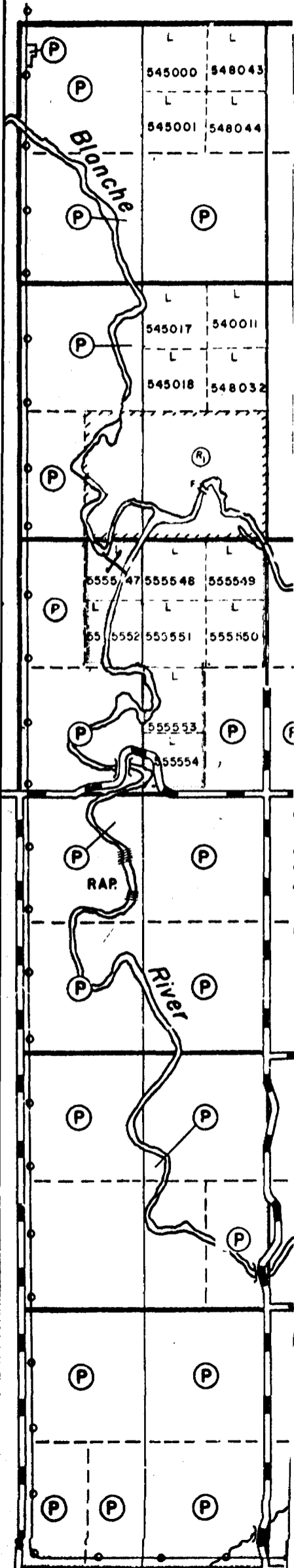

VI

V

IV

III

II

Wendigo

Bayly Twp.



Marter Top Property  
 PROPERTY: Terry Gold Explorations Inc.  
 LATITUDE: L 48+90 N BEARING: East DIP: -55° STARTED: Feb 25/81 COMPLETED: March 1/81 HOLE NO. TM21-1  
 DEPARTURE: 17 100 W V.D. H.D. DRILLED BY: The Markstay Diamond Driller Ltd. SHEET 1 of 2  
 ELEVATION: 10' above river LOCATION: Claim L 555547 - 220' E & 310' S of #4 Post. BQ DEPTH: 480  
 LOGGED BY: Harper

FOOTAGE	DESCRIPTION	SAMPLE FOOTAGES	SAMPLE No.	WIDTH FT.	ASSAY DATA					
					Gr	Ag	Cu	Au	Other	
0-54	Casing									
55	6" Bull quartz + carbonate zone.	54-55	2028	1.0						
74	Breccia Material - green carbonate CA 45									
76	Sheared Zone CA 20°									
97.3	Laves - minor flow - greenish color									
99.5	Bull Quartz +ankerite + minor wall rock.	97.3-99.5	2029	2.2						
101	Lave - green - chl.									
104.1	2 Bull Qtz + ank. veins + intruded wall rock. flow becoming more massive basalts - minor tufts	101-104.1	2030	3.1						
113.6	Qtz Vein + cpy + po	113.3-113.6	2031	0.3	0.08					
121.5	Flows - bright green - carbonated Grey Qtz in chloritic flow	123.5-124.2	2032	0.7	Tr					
124.8	Brecciated flows. - basaltic? Grey Qtz + green flow - no mineral Flow + bull qtz	124.8-126.8 130.-131.8	2033 2034	2.0 1.8	Tr Tr					
162.4	Flow - med f. gr - fairly massive - basalt? Qtz section in sheared zone - weathered	162.4-165'	2035	2.6	Nil					
	Bull Qtz vein	175-176.7	2036	1.7	Nil					
195	Flow rock									
235	Zone of contortion, shearing, folding, bull qtz veinies + cse py - talcy.	195-200 200-205 205-210 210-220	2037 2038 2039 2040	5.0 5.0 5.0 10.0	Nil Nil Nil Tr					

Matter Top Property. PROPERTY: Terry Gold Explorations Inc.

LATITUDE :	BEARING :	DIP :	STARTED :	COMPLETED :	HOLE NO. TM81-1
DEPARTURE :	V.D.	H.D.	DRILLED BY :		Sheet 2 of 2
ELEVATION :	LOCATION :				DEPTH :
					LOGGED BY :

FOOTAGE		SAMPLE FOOTAGES	SAMPLE No.	WIDTH FT.	ASSAY DATA				
					Gr. A				
	strongly graphitic	220 - 225	2041	5.0	.004				
		225 - 230	2042	5.0	NIL				
		230 - 235	2043	5.0	N.L				
245									
255	Veined Section - Bul qtz in green carb flows.	245 - 255	2044	10.0	.005				
268	Flows & Breccia								
	Vein Section + Graphite in shearing	268 - 278	2045	10.0	N.L				
		278 - 281.3	2046	2.5	N.L				
344	Flows - Basalt - variably sheared & carbonated & talc - bul qtz up to 8" + carb - no mineral								
	293 - 298 - several veinlets up to 1" wide								
	VEIN SECTION	344 - 347.3	2047	3.3	.024				
	rock becomes more talc & folded & sheared								
	390 - 405 - talc shear // CA								
	Qtz vein stock work + minor cpy	423.5 - 424.5	2048	1.0	NIL				
	carb. chl flow rocks.								
	VEIN SECTION + py + ankerite - banded.	449 - 454	2049	5.0	.002				
		454 - 459	2050	5.0	TF				
		459 - 464	2051	5.0	NIL				
472	Talc carbonate Flows.								
480	Talc shear Zone.								
	KND OF HOLE								
	Cure stored in Markham, Ont. with drill company.								

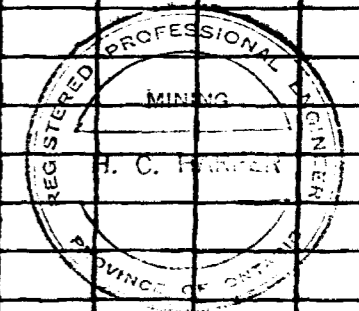

*Handwritten signature/initials*



Marter Top Property  
 PROPERTY: Terry Gold Explorations Inc.  
 LATITUDE: L48+90 N BEARING: West DIP: -55° STARTED: Feb 21/81 COMPLETED: Feb 24/81 HOLE NO. TM81-2  
 DEPARTURE: 19+40 W V.D. H.D. DRILLED BY: Martertop Diamond Driller Ltd DEPTH: 279  
 ELEVATION: 20' above river LOCATION: Claim L 555-47 - 575' E & 310' S of # 4 Post. BQ LOGGED BY: Harper

FOOTAGE	DESCRIPTION	SAMPLE FOOTAGES	SAMPLE No.	WIDTH FT.	ASSAY DATA			
					Gr	Ag	Cu	Au
0-14	Casing							
38	Greenstone - basalt? - variable - CA 75							
39.4	Scott. narrow qtz veins + banded py - pygnetic folding	38-39.4	2003	2.4	.023			
(72.9)	Contacted Flows - orbicular structure							
(73.6)	Quartz Vein - contacted - minor py	72.9-73.6	2004	0.7	.002			
	" " as above.	75.9-77	2005	1.1	NIL			
	Sheeted Qtz & talc zone + py - strong shearing	87.1-90.1	2006	3.0	Tr			
125	Greenstone - basalt? - normal but talc & soft							
133	Feldspar Porphyry							
178	Flows - darker green than lighter CA 15							
181.3	Banded Qtz Vein CA 45°	178-181.3	2007	3.3	.001			
279	Banded Flows - talc, carbonated, variable by 210' CA changed to nearly // CA							
END OF HOLE								
Core stored with Martertop Driller at Martertop Ont.								

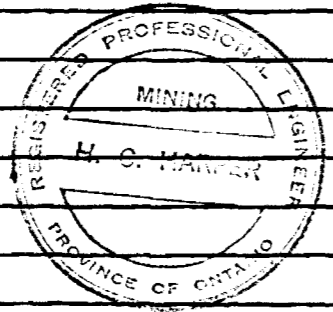

1/27/81

Mantel Twp Property PROPERTY: Terry Gold Explorations Inc. HOLE NO. TM 81-3  
 LATITUDE: L 48+15 N BEARING: West DIP: -55° STARTED: Feb 17/81 COMPLETED: Feb 20/81  
 DEPARTURE: 19+40 W V.D. H.D. DRILLED BY: The Markstay Diamond Drillers Ltd. DEPTH: 278'  
 ELEVATION: 20' above river LOCATION: Claim L 555547 - 575' E + 325' S / # 4 Post BQ LOGGED BY: Harper.

FOOTAGE	DESCRIPTION	SAMPLE FOOTAGES	SAMPLE No.	WIDTH FT.	ASSAY DATA	
					Ges Au	
0-15	Casing					
20.5	Flow - basalt - greenish color (chlorite) CA 45					
23.5	Felspar Porphyry dike - dk brown - less py pot dike + veins at contacts + in walls	20 - 23.8	2052	3.8	NIL	
60.7	Massive Basalt Flow - greenish color (chlorite) f. gr. oval structures? - small pillows? Qtz Vein + py along edge.	57.8 - 58.1	2053	0.3	NIL	
	Qtz Vein - no mineral	60.7 - 61.7	2054	1.0	NIL	
126.5	Flow - banded, greenish color					
135.3	Zone of Mineralization Bands of massive pyrite up to 8" wide Quartz Veins + rock included	126.5 - 128.4	2055	1.9	.002	
		128.4 - 133	2056	4.6	Tr	
		133 - 135.3	2057	2.3	.006	
140	Flow - massive, greenish color					
147.8	Felspar Porphyry - light brown, bleached walls					
149	Qtz Vein - sheared walls - minor py	147.8 - 149	2058	1.2	NIL	
	Basalt Flow - banded - f. gr. CA 15°					
	Qtz Vein - fractured in 2 directions CA 30	184.5 - 186.5	2001	2.0	Tr	
	Basalt Flows 25 above CA 45					
	Qtz Veins - parallel to flow banding - neg mineral	183 - 184.2	2002	1.2	.002	
278	Banded Flows - CA 45 at 255' - CA almost // core.					
	END OF HOLE					
	Core stored with Markstay Drillers at Markstay CRT.					

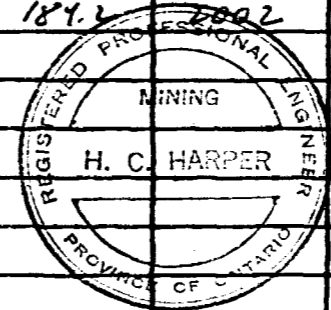

H. C. Harper



railway

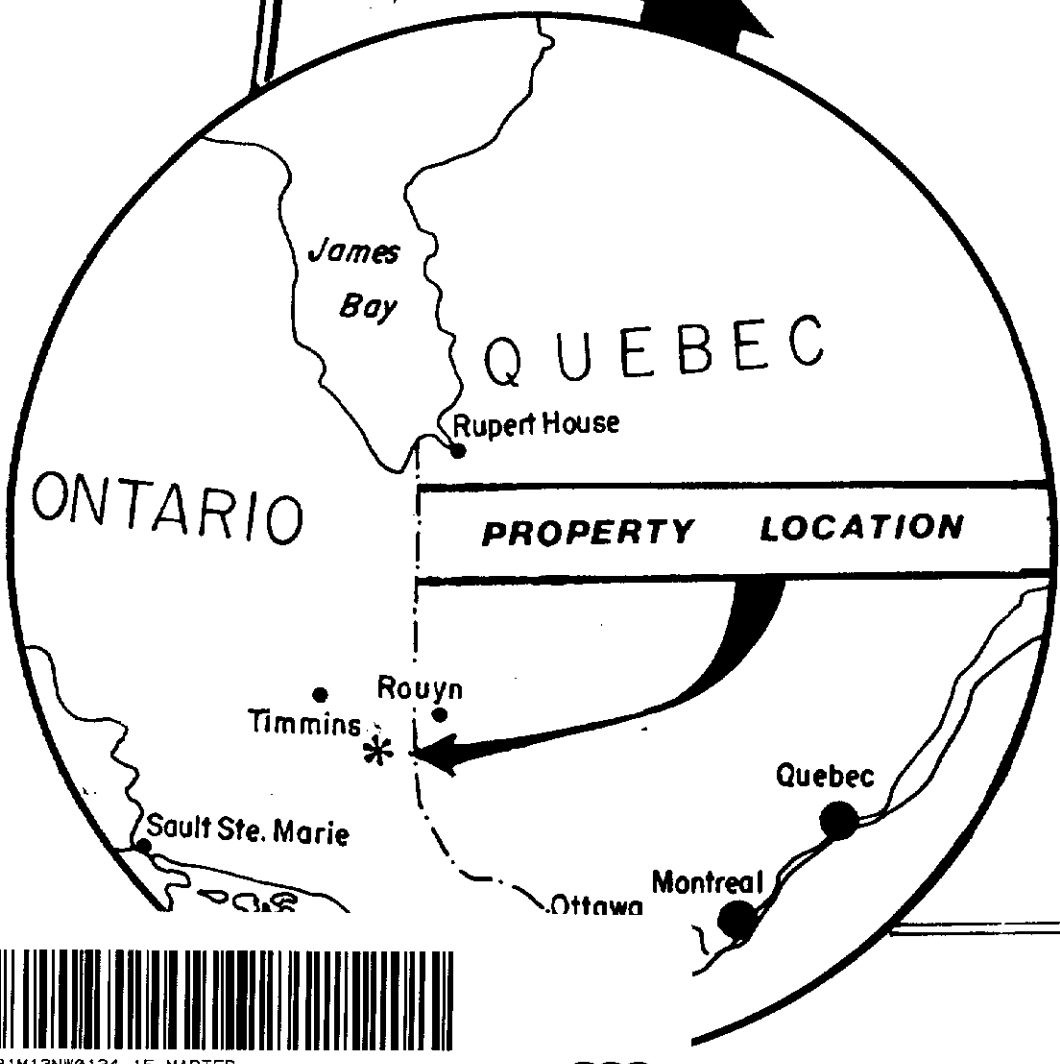
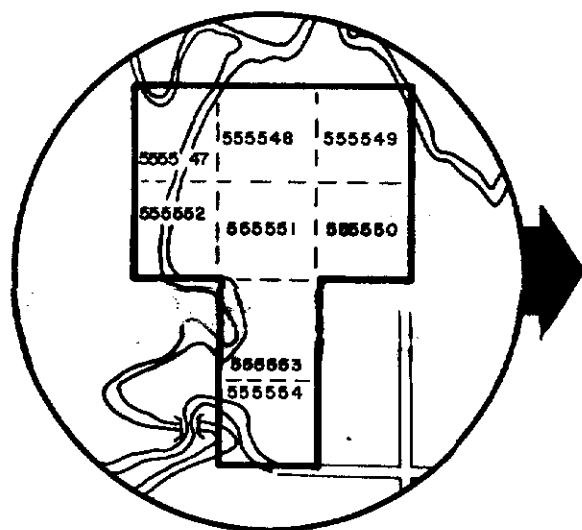

200

C O N C E S S I O N I V

transmission line

road

1 2 L O T 1 1

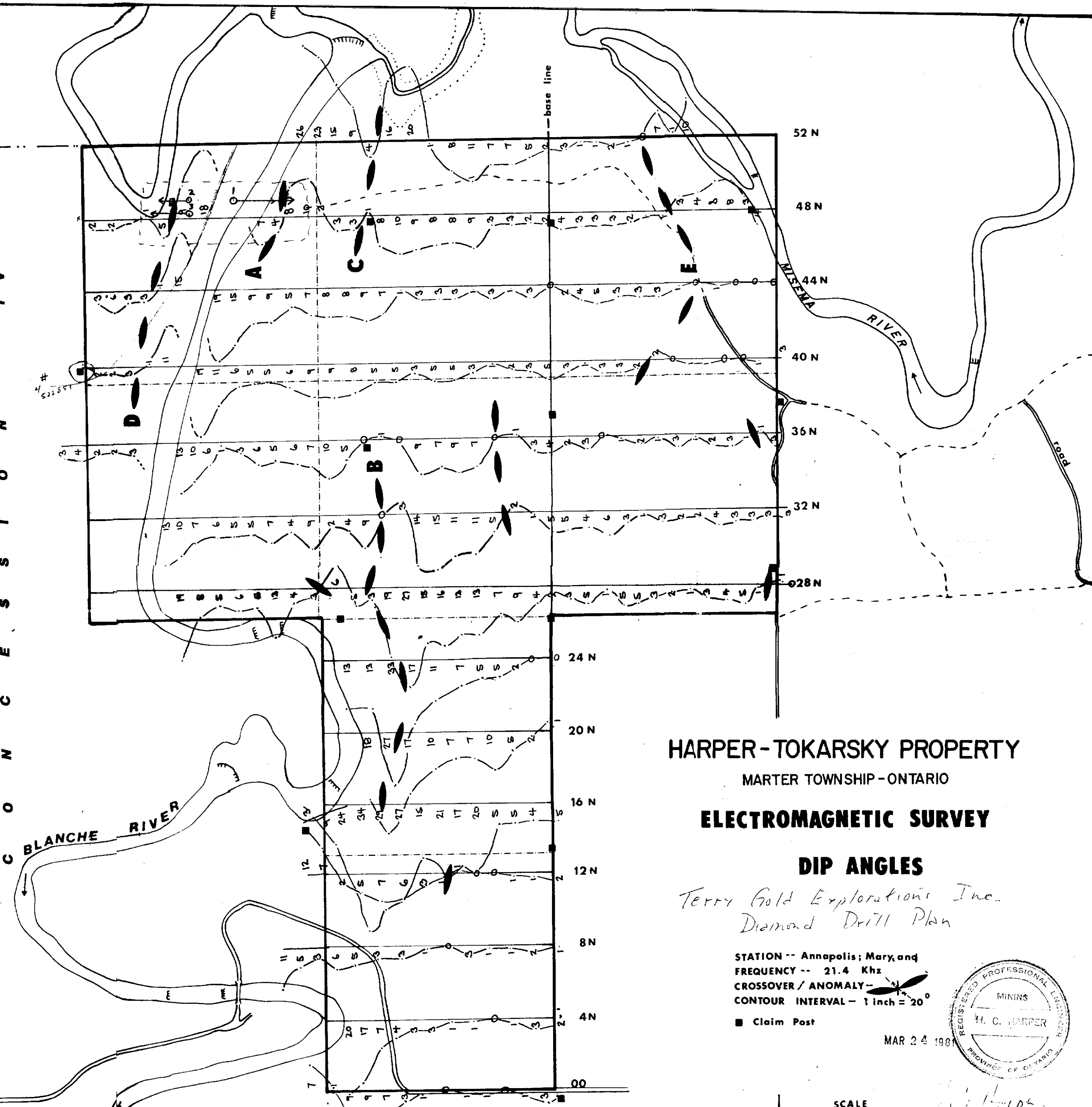

**HARPER-TOKARSKY PROPERTY**  
MARTER TOWNSHIP-ONTARIO  
**ELECTROMAGNETIC SURVEY**

**DIP ANGLES**  
*Terry Gold Explorations Inc.*  
*Diamond Drill Plan*

STATION -- Annapolis; Mary, and  
FREQUENCY -- 21.4 Khz  
CROSSOVER / ANOMALY --   
CONTOUR INTERVAL -- 1 inch = 20'

■ Claim Post

MAR 24 1981

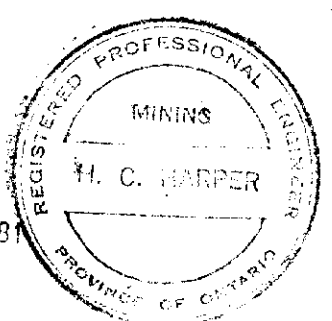

*H. C. Harper*  
*F. S. Archibald*