

(File 582648)

The Mining A



31M13NW5000 W8208-00238 CHAMBERLAIN

010

Type of Survey(s)
 Geological, Electromagnetic, Magnetic, Radiometric

Claim Holder(s)
 Kapuskasing Resources Ltd.

T 1077

Address
 Suite 806 - 88 University Ave, Toronto

Survey Company
 Harper Consulting Services Inc.

Date of Survey (from & to)
 Day | Mo. | Yr. | Day | Mo. | Yr.
 1 | 6 | 82 | 15 | 7 | 82

Total Miles of line Cut
 7.3

Name and Address of Author (of Geo-Technical report)
 H. Grant Harper P. Eng. 314 Hendon Ave, Welland, Ont.

Credits Requested per Each Claim in Columns at right

Mining Claims Traversed (List in numerical sequence)

Special Provisions	Geophysical	Days per Claim
For first survey: Enter 40 days. (This includes line cutting)	- Electromagnetic	20
	- Magnetometer	20
	- Radiometric	20
For each additional survey: using the same grid: Enter 20 days (for each)	- Other	
	Geological	40
	Geochemical	

Man Days	Geophysical	Days per Claim
Complete reverse side and enter total(s) here	- Electromagnetic	
	- Magnetometer	
	- Radiometric	
	- Other	
	Geological	
	Geochemical	

Airborne Credits	Geophysical	Days per Claim
Note: Special provisions credits do not apply to Airborne Surveys.	Electromagnetic	
	Magnetometer	
	Radiometric	

Mining Claim			Mining Claim		
Prefix	Number	Expend. Days Cr.	Prefix	Number	Expend. Days Cr.
L	582648	100			
	582649	100			
	600950	100			
	600951	100			
	600952	100			
	600953	100			

ONTARIO GEOLOGICAL SURVEY
 ASSESSMENT FILES
 RESEARCH OFFICE
 AUG 16 1982
 RECEIVED

LARDER LAKE
 MINING DIV.
 RECEIVED
 JUL 22 1982
 AM 10:01

Expenditures (excludes power stripping)

Type of Work Performed

Performed on Claim(s)

Calculation of Expenditure Days Credits

Total Expenditures ÷ 15 = Total Days Credits

\$ ÷ 15 =

Instructions
 Total Days Credits may be apportioned at the claim holder's choice. Enter number of days credits per claim selected in columns at right.

Date *July 15/82*
 Recorded Holder or Agent (Signature) *H. Grant Harper*

For Office Use Only

Total Days Cr. Recorded *600* | Date Recorded **JUL 22 1982** | Mining Recorder *[Signature]*

Date Approved as Recorded | Branch Director

Total number of mining claims covered by this report of work. **6**

Certification Verifying Report of Work

I hereby certify that I have a personal and intimate knowledge of the facts set forth in the Report of Work annexed hereto, having performed the work or witnessed same during and/or after its completion and the annexed report is true.

Name and Postal Address of Person Certifying
H. Grant Harper P. Eng.

314 Hendon Ave, Welland

Date Certified *July 15/82*

Certified by (Signature) *H. Grant Harper*



31M13NW5000 W8208-00238 CHAMBERLAIN

900

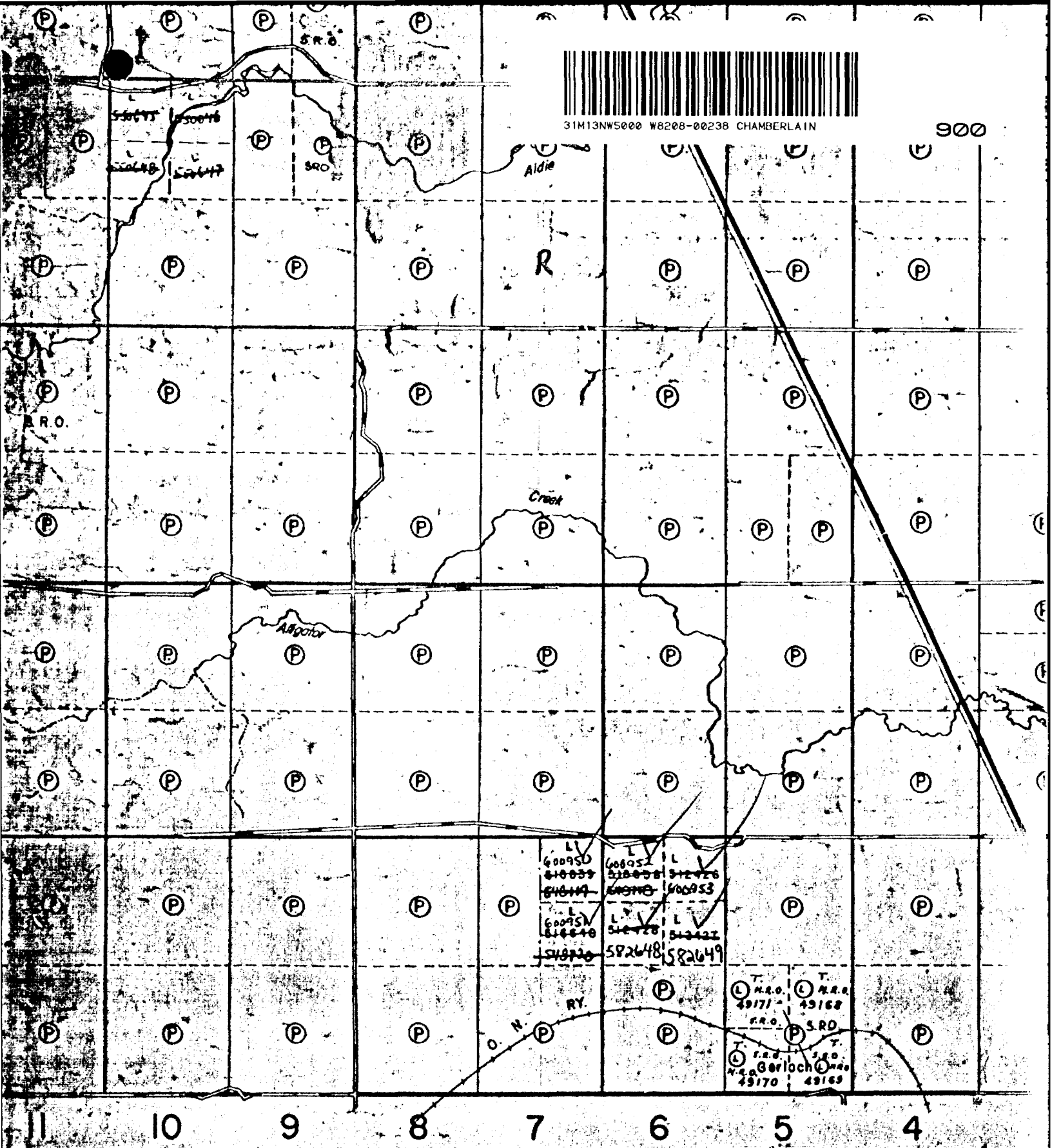

LL 600950	LL 600951	LL 600952
610039	610040	610041
610042	610043	610044
LL 600951	LL 600952	LL 600953
610045	610046	610047
610048	610049	610050

T. M.R.O. 49171	T. M.R.O. 49168
S.R.O.	S.R.O.
T. S.R.O. 49170	T. S.R.O. 49169

Chamberlain
Dack. Twp. Twp. M 446