



31M13SE0020 2.7736 INGRAM

010

Assessment Work Report
on the Geophysical Surveys
for the Ingram Township Project

Claim Nos. 681430
681431
681432
681433
667058
667059
642426

Date: January 26, 1985

Submitted by: David Marek
Agnico-Eagle Mines Ltd.
Cobalt, Ontario

RECEIVED
JAN 30 1985
MINING LANDS SECTION

Introduction:

This report summarizes the data collected from a geophysical survey which was completed on seven claims in Ingram township, during the 1984 field season. It represents further exploration on claims covered by a geochemical and geological survey during 1983 by the author. It is also a prerequisite for submitting geophysical data to acquire work credits.

Property Description:

The geophysical survey was completed from July 23 to July 27, 1984 on seven unpatented mining claims numbering: 681430 to 681433 inclusive, 662058, 662059, and 642426 of Ingram Township, Kirkland Lake District. These claims are held by Mr. Foster Marshall of R. R. #1, Englenart, Ontario, P.O. 110 and optioned by Agnico-Eagle Mines Ltd., Box 140, Cobalt, Ontario, P.O. 100.

Location and Access:

The claims mentioned cover most of lot 9 of concession VI and the SW $\frac{1}{4}$ of the S $\frac{1}{2}$ of lot 10 of concession VI in Ingram township.

Access can be made by taking highway 569 east of Tonstown to the north-south concession roads. The area is covered by partial farm land and a mature pine, birch, spruce, and poplar forest with considerable undergrowth. There are several concession roads and old bush trails which provided good accessibility to the interior of the claims.

INGRAM TWP. PROJECT
AGNICO-EAGLE MINES LTD.

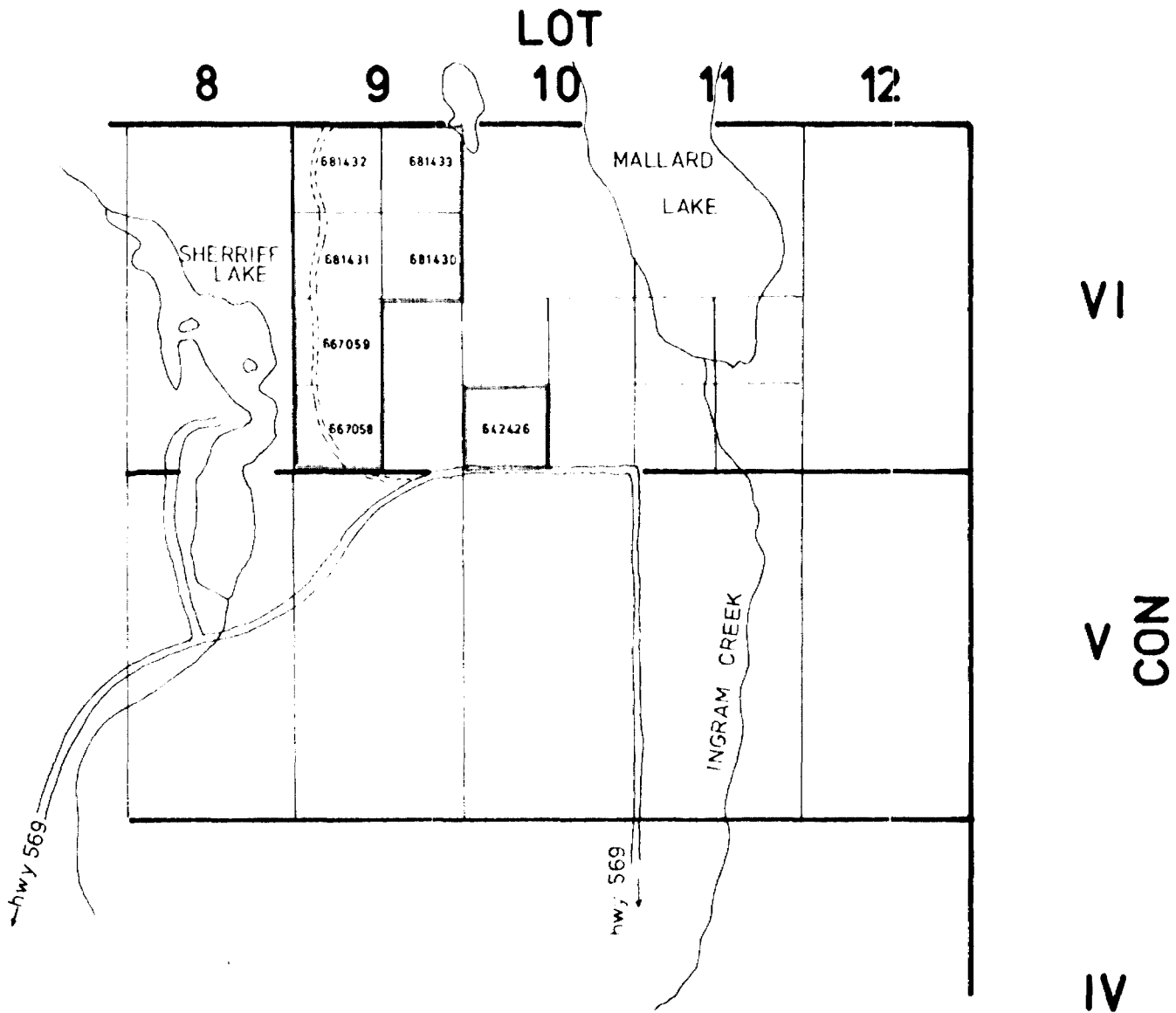

SCALE 1" = 1/2 mile

Procedure:

This geophysical survey complimented a geochemical and geological survey conducted in the previous year. Thus a grid system had already been established and was reused. The geophysical data was obtained by using a WP-3 gradiometer/total field magnetometer by Scintrex. Both gradient and total field values were measured to an accuracy of 0.1 nannotelsa at 50 foot stations, with lines at 400 foot intervals. A total of 900 readings were taken with approximately 130 readings per claim. Control was established by taking several readings at each line intersection with line 40+00 W. Also readings were taken at the intersection of 40+00 W and 0+00 N at the beginning and end of each day so that total field values could be corrected for diurnal drift in the magnetic field. These corrected values were plotted and contoured. The gradient values were recorded with a sensor separation of 1 meter. These values are of primary interest and have also been plotted and contoured (positive values only).

Discussion and Results:

Previous geological surveys and diamond drilling have established the existence of gold and silver bearing veins to the east of these claims, and also field work established a geological contact between the diabase and Huronian sediments. The geophysical survey was conducted in order to pick up an extension of these eastern veins and also to accurately locate the diabase lower contact. The high positive gradient contours outlined the lower contact fairly accurate and also outlined conductors at sites #1, #2, #3. High total field values are also associated with these conductors but not with the lower contact of

the diabase. Because of the presence of a great deal of glacial till smaller conductors or faults are masked to geophysical techniques and thus broad low relief contours generally cover most of the claim group.

Recommendations:

With the conductors at sites #1, #2, and #3 covered with a thick glacial debris other geophysical methods may provide discouraging results, however another geophysical survey should be carried out over a detailed grid pattern over each conductor. VLF surveys of horizontal loop should be able to see through the overburden to provide a better outline of each conductor. Diamond drilling should follow up any more geophysical surveys as long as they show favourable targets and can provide a better estimate of depth and continuity.

Appendix A:

Geophysical Technical Data:

Number of stations: 900
Number of readings: 900
Station interval: 50 ft
Line spacing: 400 ft
Contour interval: 50 gammas (total field)
+5 gammas/meter (gradient)

Magnetic:

Instrument: MP-3 gradiometer/total field magnetometer
Scale constant-Accuracy: 0.1 nannotelsa
Diurnal correction method: several readings at same station over time
interval, corrected graphically.

CERTIFICATE

I, David E. Marek, of 302-576 McCamus Ave., New Liskeard, Ontario, hereby certify that:

- 1) I am and have been employed since March 1983 as a geological engineer by Agnico-Eagle Mines Ltd., Box 140 Cobalt, Ontario.
- 2) I am a graduate of Queen's University, Kingston, Ontario, with a Bachelor of Science (1982) degree in geological engineering.
- 3) I am a member of the Canadian Institute of Mining and Metallurgy.
- 4) That the information in this report and on the following maps is accurate and correct.

Dated: January 20, 1985
Place: New Liskeard, Ontario

Signed:

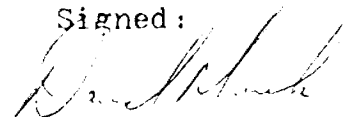

Land
Ministry of Natural Resources
Canada
file 2667058

Report of Work
(Geophysical, Geological,
Geochemical and Expenditures)

Instructions: - Please type or print

Jan 25th
#538

2
Mii



31M13SE0020 2.7736 INGRAM

900

Type of Survey(s) **GEO PHYSICAL**

Claim Holder(s) **FOSTER MARSHALL** Prospector's Licence No. **B23438**

Address **R.R #1 Englehart Ont. P0J 1H0**

Survey Company **Agnico-Eagle Mines Ltd.** Date of Survey (from & to) **23 07 84 03 08 84** Total Miles of line Cut

Name and Address of Author (of Geo-Technical report) **David Marek Agnico-Eagle Mines Ltd. Box 140 Cobalt Ont P0J 1C0**

Credits Requested per Each Claim in Columns at right Mining Claims Traversed (List in numerical sequence)

Special Provisions	Geophysical	Days per Claim
For first survey: Enter 40 days. (This includes line cutting)	- Electromagnetic	
	- Magnetometer	20
For each additional survey: using the same grid: Enter 20 days (for each)	- Radiometric	
	- Other	
	Geological	
	Geochemical	

Man Days	Geophysical	Days per Claim
Complete reverse side and enter total(s) here	- Electromagnetic	
	- Magnetometer	
	- Radiometric	
	- Other	
	Geological	
	Geochemical	

Airborne Credits	Geophysical	Days per Claim
Note: Special provisions credits do not apply to Airborne Surveys.	- Electromagnetic	
	- Magnetometer	
	- Radiometric	

Mining Claim			Mining Claim		
Prefix	Number	Expend. Days Cr.	Prefix	Number	Expend. Days Cr.
L	681430				
	681431				
	681432				
	681433				
	667058				
	667059				
	620297				
	620298				
	642426				

RECEIVED
DEC 11 1984
MINING LANDS SECTION

LARDER LAKE
MINING DIV.
RECEIVED
NOV 1 1984
7 18 19 10 11 12 14 23 1984

Total number of mining claims covered by this report of work. **7**

Expenditures (excludes power stripping)

Type of Work Performed

Performed on Claim(s)

Calculation of Expenditure Days Credits

Total Expenditures \div 15 = Total Days Credits

Instructions
Total Days Credits may be apportioned at the claim holder's choice. Enter number of days credits per claim selected in columns at right.

For Office Use Only

Total Days Cr. Recorded **140** Date Recorded **NOV 26 1984** Mining Recorder

Date Approved as Recorded **See Reversed Statement** Branch Director

Date **Nov 16/84** Recorder/Holder or Agent (Signature) *David Marek*

Certification Verifying Report of Work

I hereby certify that I have a personal and intimate knowledge of the facts set forth in the Report of Work annexed hereto, having performed the work or witnessed same during and/or after its completion and the annexed report is true.

Name and Postal Address of Person Certifying **David Marek Agnico Eagle Mines Ltd. Box 140 Cobalt, Ont.**

Date Certified **Nov 16/84** Certified by (Signature) *David Marek*



The Mining Act

In the matter of mining claims:

L 681430-31-32-33
667058-59
642426

in the Township of Ingram.

On consideration of an application from the recorded holder, Foster Marshall
under Section 77 Subsection 22 of The Mining Act, I hereby order that the time for filing reports and plans in support of
Geophysical (Magnetometer) assessment work recorded on November 26, 1984
be extended until and including January 30, 1985.

1985.02.02

Date

Signature of Director, Land Management Branch

Copies: Foster Marshall
R.R. #1
Englehart, Ontario
POJ 1H0

David Marek
Agnico-Eagle Mines Limited, Box 140
Cobalt, Ontario

Mining Recorder
Kirkland Lake, ONT
#538

File: 2.7736

FILE

AB

R.

1985 03 11

Your File: 538
Our File: 2.7736

Mining Recorder
Ministry of Natural Resources
4 Government Road East
Kirkland Lake, Ontario
P2N 1A2

Dear Sir:

RE: Notice of Intent dated February 12, 1985.
Geophysical (Magnetometer) Survey on Mining
Claims L 681430 et al in the Township of Ingram

The assessment work credits, as listed with the
above-mentioned Notice of Intent, have been approved
as of the above date.

Please inform the recorded holder of these mining
claims and so indicate on your records.

Yours sincerely,

S.E. Yundt
Director
Land Management Branch

Whitney Block, Room 6643
Queen's Park
Toronto, Ontario
M7A 1W3
Phone:(416)965-6918

S. Hurst:sc

cc: Foster Marshall
R.S. #1
Englehart, Ontario
POJ 1H0

cc: Agnico-Eagle Mines Limited
Box 140
Cobalt, Ontario
POJ 1C0
Attn: David Marek

cc: Mr. G.H. Ferguson
Mining & Lands Commissioner
Toronto, Ontario

cc: Resident Geologist
Kirkland Lake, Ontario

Recorded Holder FOSTER MARSHALL
Township or Area INGRAM TOWNSHIP

Type of survey and number of Assessment days credit per claim	Mining Claims Assessed
Geophysical Electromagnetic _____ days Magnetometer <u>20</u> days Radiometric _____ days Induced polarization _____ days Other _____ days Section 77 (19) See "Mining Claims Assessed" column Geological _____ days Geochemical _____ days Man days <input type="checkbox"/> Airborne <input type="checkbox"/> Special provision <input checked="" type="checkbox"/> Ground <input checked="" type="checkbox"/> <input type="checkbox"/> Credits have been reduced because of partial coverage of claims. <input type="checkbox"/> Credits have been reduced because of corrections to work dates and figures of applicant.	L 681430-31-32-33 667058-59

Special credits under section 77 (16) for the following mining claims

10 DAYS CREDIT
L 642426

No credits have been allowed for the following mining claims

not sufficiently covered by the survey Insufficient technical data filed

The Mining Recorder may reduce the above credits if necessary in order that the total number of approved assessment days recorded on each claim does not exceed the maximum allowed as follows: Geophysical — 80; Geological — 40; Geochemical — 40; Section 77 (19)—60:



Feb. 22/85

1985 02 12

Your File: 538
Our File: 2.7736

Mining Recorder
Ministry of Natural Resources
4 Government Road East
Kirkland Lake, Ontario
P2N 1A2

Dear Sir:

Enclosed are two copies of a Notice of Intent with statements listing a reduced rate of assessment work credits to be allowed for a technical survey. Please forward one copy to the recorded holder of the claims and retain the other. In approximately fifteen days from the above date, a final letter of approval of these credits will be sent to you. On receipt of the approval letter, you may then change the work entries on the claim record sheets.

For further information, if required, please contact Mr. R.J. Pichette at 416/965-4888.

Yours sincerely,

S.E. Yundt
Director
Land Management Branch

Whitney Block, Room 6643
Queen's Park
Toronto, Ontario
M7A 1W3

H.J. S. Hurst:mc

Encls.

cc: Foster Marshall
R.R.#1
Englehart, Ontario
POJ 1H0

cc: Mr. G.H. Ferguson
Mining & Lands Commissioner
Toronto, Ontario

cc: Agnico-Eagle Mines Ltd
Box 140
Cobalt, Ontario
POJ 1C0
Attention: David Marek



Ministry of
Natural
Resources

Ontario

Notice of Intent
for Technical Reports

1985 02 12

2.7736/538

An examination of your survey report indicates that the requirements of The Ontario Mining Act have not been fully met to warrant maximum assessment work credits. This notice is merely a warning that you will not be allowed the number of assessment work days credits that you expected and also that in approximately 15 days from the above date, the mining recorder will be authorized to change the entries on his record sheets to agree with the enclosed statement. Please note that until such time as the recorder actually changes the entry on the record sheet, the status of the claim remains unchanged.

If you are of the opinion that these changes by the mining recorder will jeopardize your claims, you may during the next fifteen days apply to the Mining and Lands Commissioner for an extension of time. Abstracts should be sent with your application.

If the reduced rate of credits does not jeopardize the status of the claims then you need not seek relief from the Mining and Lands Commissioner and this Notice of Intent may be disregarded.

If your survey was submitted and assessed under the "Special Provision-Performance and Coverage" method and you are of the opinion that a re-appraisal under the "Man-days" method would result in the approval of a greater number of days credit per claim, you may, within the said fifteen day period, submit assessment work breakdowns listing the employees names, addresses and the dates and hours they worked. The new work breakdowns should be submitted direct to the Land Management Branch, Toronto. The report will be re-assessed and a new statement of credits based on actual days worked will be issued.

LOT 8

LOT 9

LOT 10

LOT 11

BAYLY
INGRAM twp line

35+00 N
31+00 N
27+00 N
23+00 N
19+00 N
15+00 N

BASELINE 0+00 N

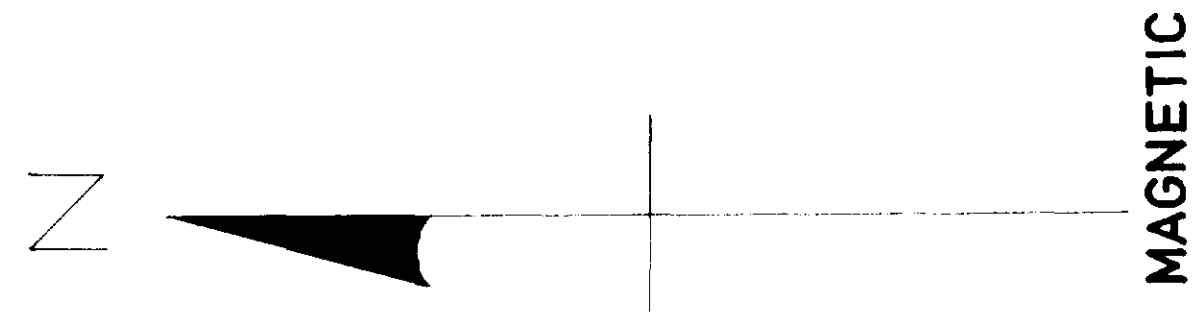
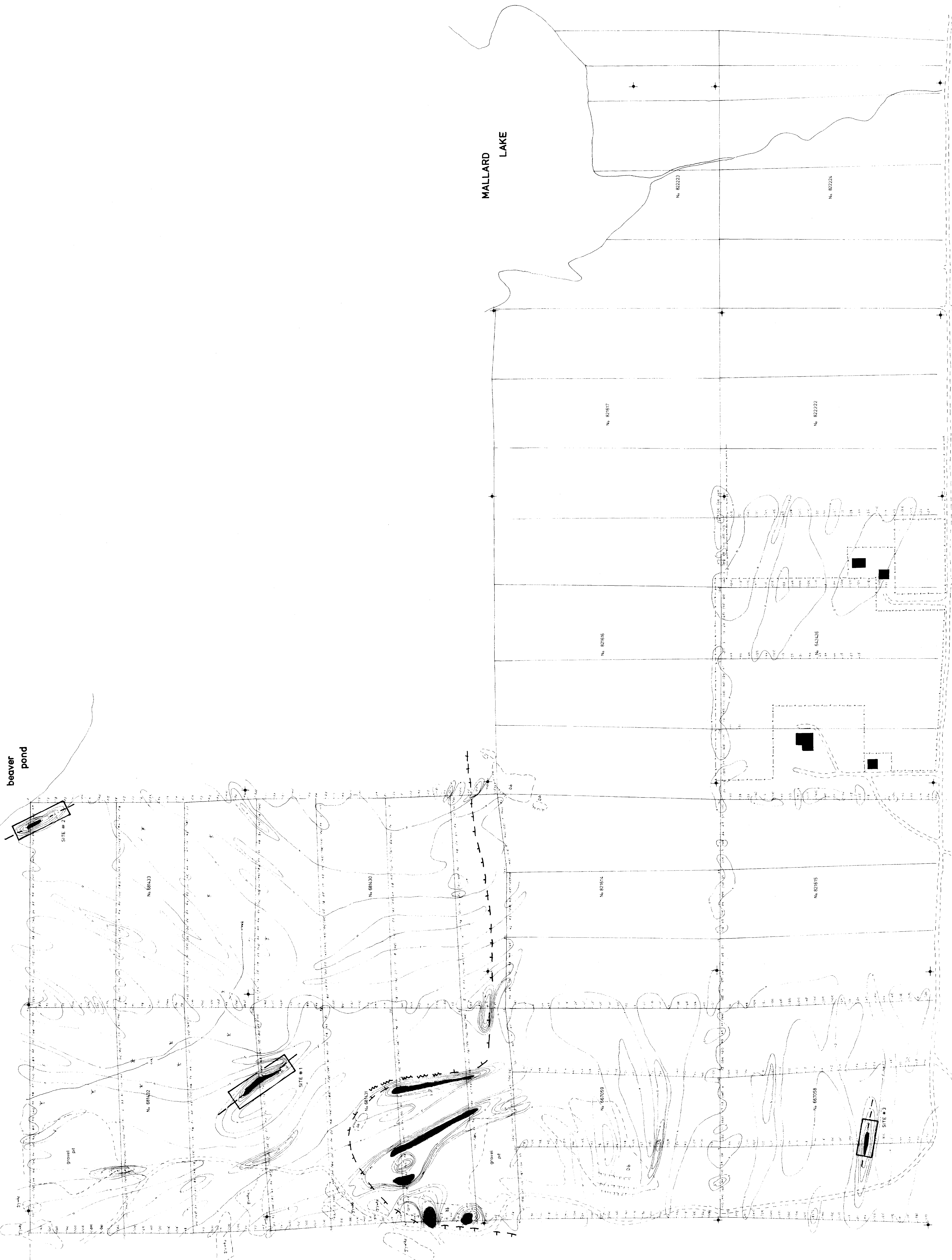

CON. VI

AGNICO-EAGLE MINES LTD.
INGRAM TWP. PROJECT

LEGEND

- MARIC INTRUSIVE ROCK TYPES (INTRUSSING)
 - Diabase
- HURONIAN SEDIMENTS
 - grywa - Colman Member (i.e. conglomerate, graywacke, argillite)
- GEOLOGICAL SYMBOLS
 - claim post
 - bedrock
 - cliff
 - buildings
 - fence
 - swamp
 - road
 - inferred fault
 - bottom contact of fill
 - readings (gammac / magnet)
 - contour interval
 - contour above +25 ft/m
 - conductor

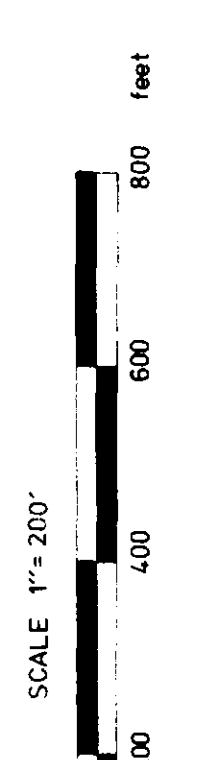

DRAWN BY: *[Signature]*
 DATED: JAN 1985
 1/25

