



31M13SE0026 14 INGRAM

DIAMOND DRILLING

010

TOWNSHIP: INGRAM

REPORT No.: 14

WORK PERFORMED BY: FOSTER MARSHALL

<u>CLAIM No.</u>	<u>HOLE No.</u>	<u>FOOTAGE</u>	<u>DATE</u>	<u>NOTE</u>
L 512008	ML-1-80	535.0	Oct./80	(1)

NOTES: (1) # 406=80

Malden Lake

Sherry Lake

D.T.C.
PIT
1812

L&F
GRAVEL
PIT 58
SUB
54877
REG.
PLAN
M-252

S.R.O. WITHDRAWN FROM
STAKING SEC. 42
OF THE MINING ACT
FILE: 88826

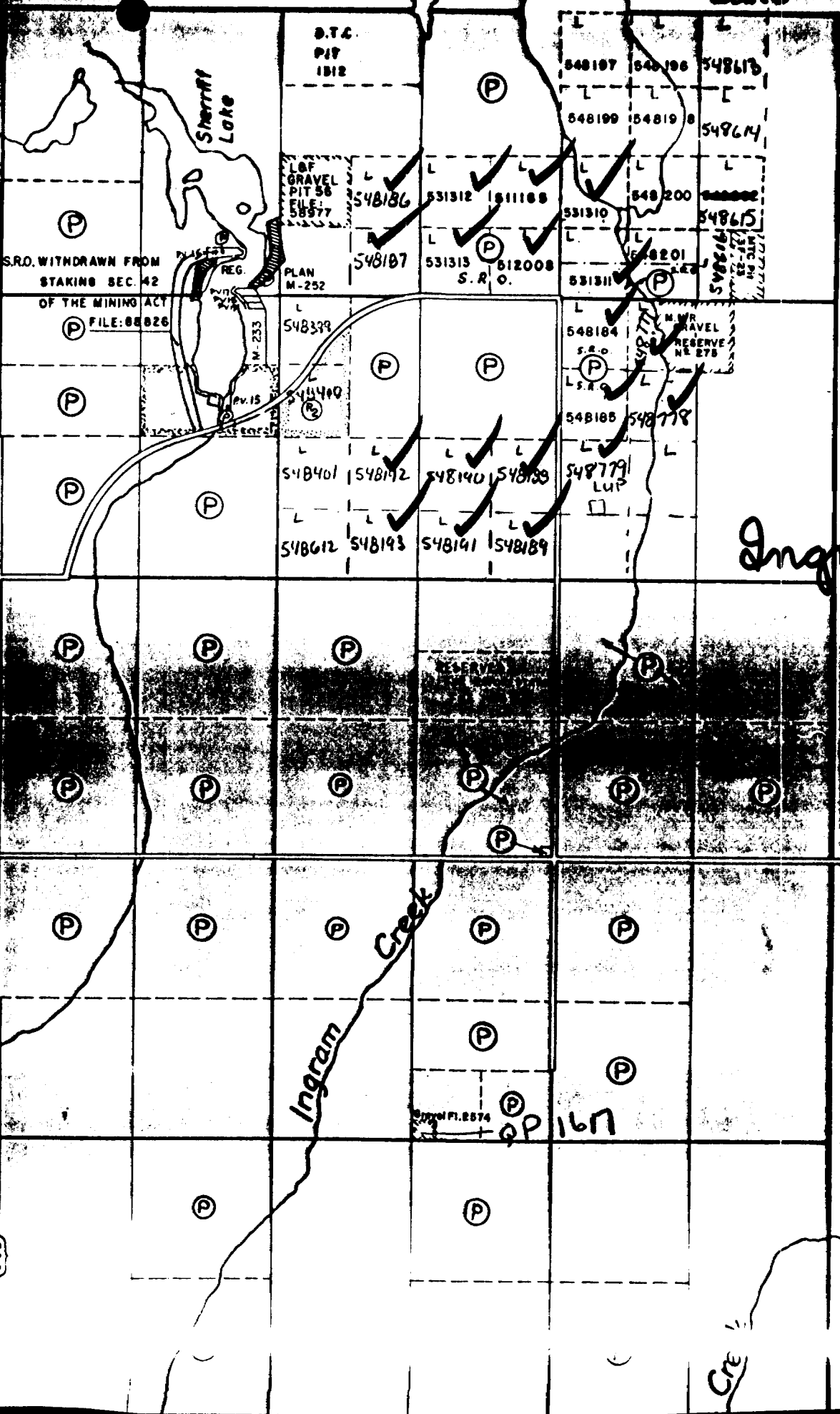

VI

FOSTER MARSHALL

#406-80

Ingram trap
WB11

IV

PENSE

III

II

569

Cree

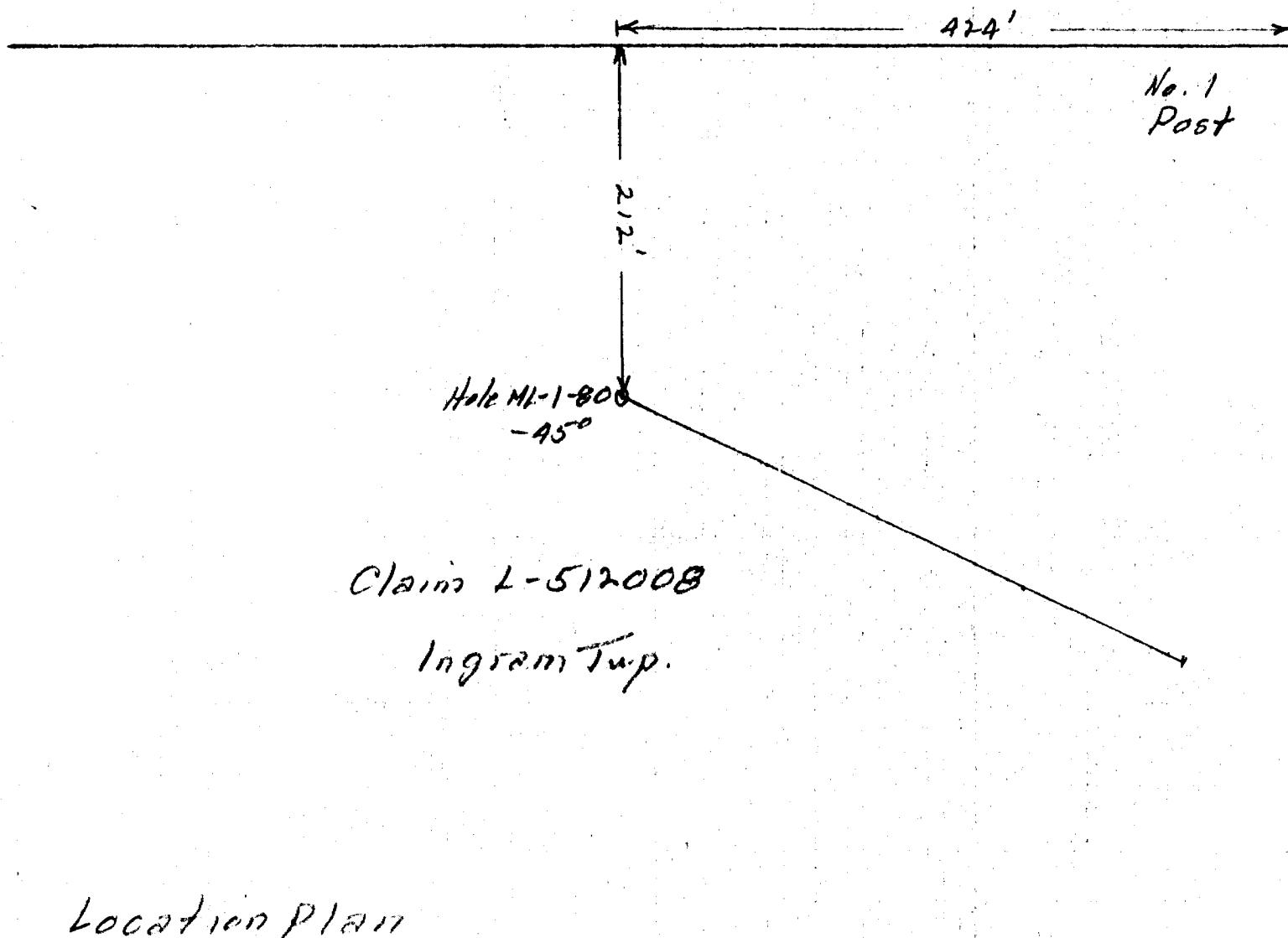

Location Plan

D.D.H. ML-1-80

Claim L-512008

Ingram Trp

Scale: 1 in. = 100 ft.

Nov. 19, 1980

R.O.F

COMPANY Foster Marshall

PROPERTY _____

Township Ingram

Claim No. L - 512008

SHEET No. 1
 Started Oct. 12, 1980
 Finished Oct. 26, 1980
 Depth 535

Reference No. 1 Post
 Location 212' South
424' West
 Elevation _____

HOLE No. ML - 1-80
 Bearing 115° True
 Dip: 45 @ Collar; 47 @ 535'

FROM	TO	DESCRIPTION	SAMPLES			ASSAYS							
			NO	FROM	TO	WIDTH							
		No casing - bedrock setup.											
0.0	366.2	Nipissing Diabase; fine grained at start rapidly increasing to medium grain; grey green in color; marked fracture at 15° often showing weathering.											
		22.1 - 1/2" quartz carbonate at 50°; barren.											
		40.5 - 41.8 - fine grained diabase with 1/2" and 1/4" quartz stringers at 30°; a little galena in the stringers		40.5	41.8	1.3'							
		61.6 - 3/8" quartz carbonate at 60°; a few weathered holes											
		86.7-87.6 - 3/4" quartz carbonate in fine grained diabase; a few small patches of cobalt arsenide along contacts		86.7	87.6	0.9'							
		91.8-93.0 - fracture almost parallel to core; some evidence of movement											
		99.0-100.4 - 3/8" quartz carbonate at 30°; in fine grained diabase; a very little cobalt		99.0	100.4	1.4							

Drilled by Link Drilling Ltd.

Core Size 1 1/16"

Logged by K. F. O'Flaherty

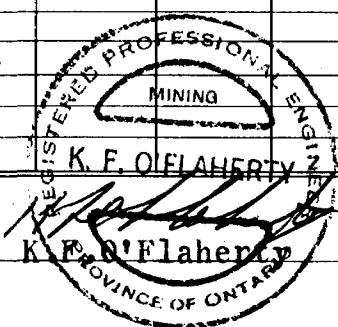

COMPANY Foster Marshall

PROPERTY _____

Township IngramClaim No. L - 512008

FROM	TO	DESCRIPTION	SAMPLES			ASSAYS			
			NO	FROM	TO	WIDTH	Au	Ag	Co
		113.4-113.7 - fine grained diabase with silicified core at 30°; a few specks of chalcopyrite							
		120.6 - 1/8" quartz carbonate at 30°; a few specks of cobalt							
		125.2-125.4 - 1" quartz carbonate at 20°; barren							
		131.2-132.0 - 1 1/2" vuggy quartz carbonate at 50°; well developed low temp quartz crystals in an open water bearing seam; a little cobalt and a very little pyrite		131.2-132.0		0.8'			
		170.2 - 1/4" quartz carbonate at 30°; moderate chalcopyrite and a little cobalt							
		172.0-174.0 - 1/2" calcite in fine grained diabase; a little fine disseminated pyrite and cobalt throughout with a few spacks possible silver	ML-1-80-1	172.0-174.0		2.0'	.005	.07	.019
		198.0-200.7 - fault zone at 60°; quartz cementing epidotized mylonite zone; some oxidation		188.0-190.7		2.7'			
		203.0 - fracture or fault at 20°							
		223.0 - 224.0 - quartz at 40° in sheared walls; some epidote; no visible mineral							
		230.6, 232.1, 242.0 - 1/8" quartz carbonate seams at 30°; a little chalcopyrite							

COMPANY Foster Marshall

PROPERTY _____

Township IngramClaim No. L - 512008

FROM	TO	DESCRIPTION	SAMPLES			ASSAYS							
			NO	FROM	TO	WIDTH							
		283.7 - 1" quartz at 40°; a little chalcopryite											
		290.0 - generally finer grained from this point											
		316.8-317.8 - 1/4" and 3/8" carbonate stringers at 20° in fine grained diabase; a little cobalt and pyrite		316.8-317.8		1.0'							
		244.2, 347.0 - 3/8" quartz stringers at 30°; a little chalcopryite											
		366.2 - sharp contact at 60°; diabase grain reduces to a glass at contact											
366.2-535.0		Greywacke; dark grey in color; very fine grained; finely bedded at 40°; bedding becomes less distinct down hole											
		415.7 - 1/8" at 60° to core and 85° to bedding											
		482.6 - 1/4" calcite at 40°											
		480.0 - bedding fading out											
535.0		END OF HOLE											