



31M13SE0031 12 INGRAM

010

### Diamond Drilling

Township of Ingram

Report No: 12

Work performed by: Tinex Development Exploration Ltd./  
Con-Key Mines Ltd.

Claim No	Hole No	Footage	Date	Note	
T 52709	1	116'		(1)	
	2	107'		(1)	
	3	102'		(1)	
	15	67'	Apr/63		
	16	101.5'	Apr/63		
	T 52711	5	118'	Apr/63	
6		112'	Apr/63		
7		114'	Apr/63		
8		112'	Apr/63		
9		110'	Apr/63		
10		31'	Apr/63		
11		31'	Apr/63		
12		31'	Apr/63		
13		30'	Apr/63		
14		31'	Apr/63		
T 52712		D-1	1000'	July/63	
		D-2	245'	July/63	
		D-3	83'	Aug/63	
		D-4	26.6'	Aug/63	
	19 DDH	2568.1			

#### Notes:

(1) Drilling dates unknown; log is dated April 4, 1963.

T-52709

TINEX DEV. EXPL. LTD.  
INGRAM TWP. PROP.  
LOG OF HOLES 1, 2 & 3.  
APRIL 4 - 1963



HOLE No 1

LOCATION - 415' WEST AND 170' SOUTH OF No 1 POST CLAIM T-52709  
BEARING - N 54° W      DIP - 45°

- 00 - COLLAR
- 6.0 - CASING
- 17.0 - DIABASE - MASSIVE - MED. GRAIN - OCC. RUSTY JOINTS
- 116.0 - GREYWACKE - SILICEOUS - FINE GRAIN - DARK GREY - BEDDING @ 60° - OCCASIONAL SPECKS CHALCOPYRITE

END

LOST CORE  
60 - 62'  
64 - 65'  
75 - 80'  
90 - 94.5'

HOLE No 2

LOCATION - 415' WEST AND 170' SOUTH OF No 1 POST CLAIM T-52709  
BEARING - S 79° W      DIP - 45°

- 00 - COLLAR
- 6.0 - CASING
- 28.0 - DIABASE - MASSIVE - MED. GRAIN - OCC. SPECKS CHALCOPYRITE 26.5' TO 28.0'
- 107.0 - GREYWACKE - SILICEOUS - DARK GREY - FINE GRAINED - BEDDING @ 60° - ONE 1/8" CALCITE VEINLET AT 68' - NO MIN.

END

HOLE No. 3

LOCATION - 415' WEST AND 170' SOUTH OF No 1 POST CLAIM T-52709  
BEARING - N 05° W      DIP 45°

- 00 - COLLAR
- 6.0 - CASING
- 20.8 - DIABASE - MASSIVE - MED. GRAIN - OCC. SPECKS CHALCOPYRITE NEAR CONTACT
- 102.0 - GREYWACKE - SILICEOUS - DARK GREY - FINE GRAIN - OCC. SPECKS CHALCOPYRITE

END

LOST CORE  
57 - 59'  
66 - 69'  
85 - 87'  
92 - 94'

APR 4 - 1963  
G. L. Holbrook



























TINEX DEVELOPMENT EXPLORATION LTD. &  
CON - KEY MINES LTD.  
DETAIL NO. 4 OF DRILLING  
INGRAM TWP.  
 SCALE 1" = 100'

PREPARED FOR G.L. HOLBROOKE

DATE Aug 26/63 SIGNED G.L. Holbrooke

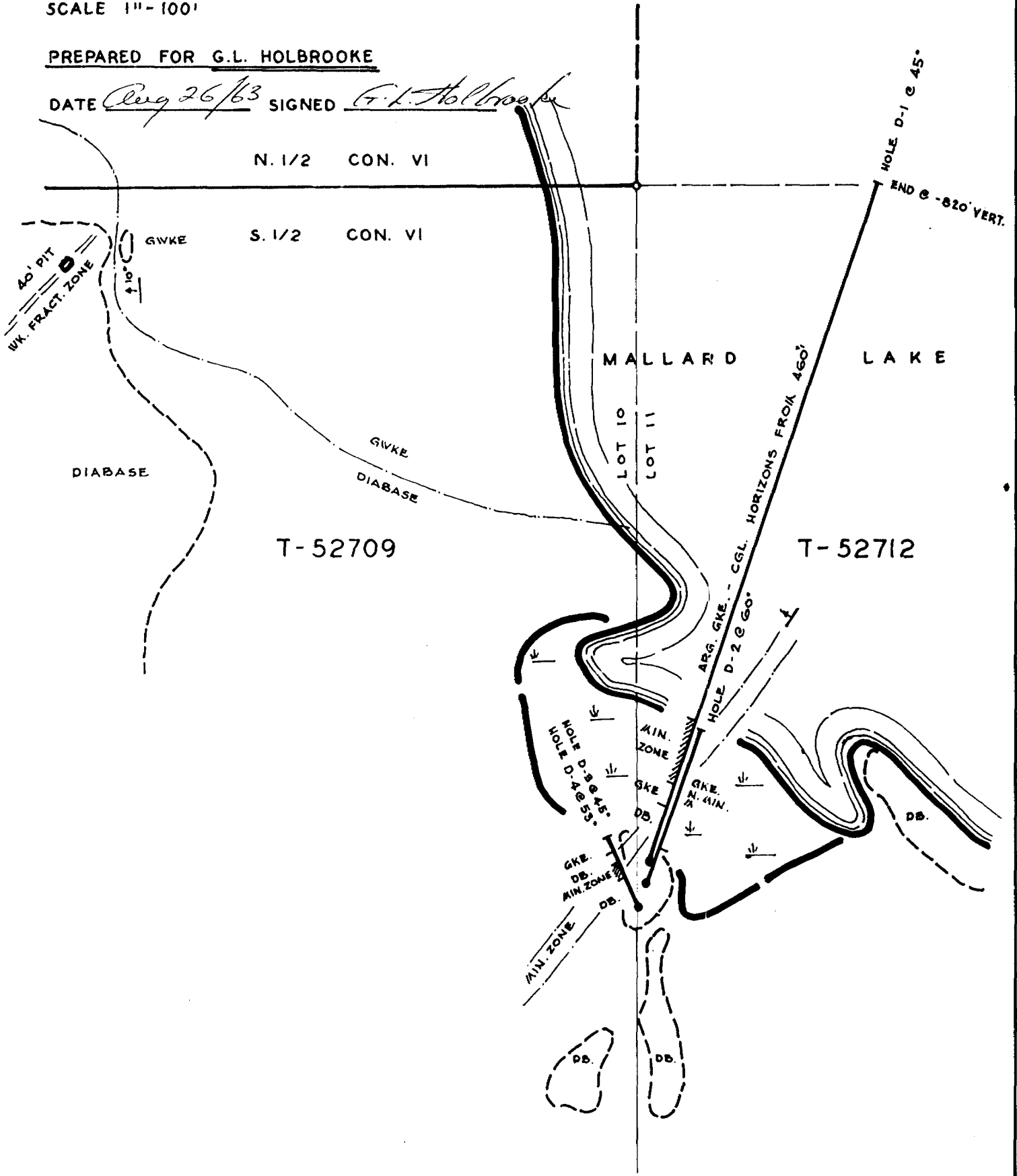

PROPERTY:

Tinex Development Exploration Limited - Ingram Township

HOLE NO.

D-1

LATITUDE:	BEARING: N19°E	DIP: 45°	DRILLED BY: July 10/63	July 29/63	DEPTH: 1,000'
DEPARTURE:	V.D.	H.D.	Continental Diamond Drilling		LOGGED BY: G.S.H.
ELEVATION:	LOCATION: 510' south and 10' east of northwest corner claim 52712 (N1/4, S1/4, Lot 11, Con. VI)				

FOOTAGE	DESCRIPTION	SAMPLE FOOTAGES	SAMPLE No.	WIDTH Ft.	ASSAY DATA				
					g/t Cu	g/t Ag	g/t Au	g/t Pb	g/t Zn
00	Collar								
2.3	Casing								
2.7	Diabase - light grey - medium coarse grained								
5.0	Diabase - chlorite - pyrite seams @ 45°	2.7- 5.0	DI-4	2.3	Nil	0.03	0.02	0.22	Nil
63.0	Diabase - as for 2.3 - contact @ 43° - 1/2" quartz & chalcopyrite @ 30.9	30.8- 30.9	DI-5	0.1	Nil	1.14	3.26	0.54	0.12
68.5	Greywacke - grey - fine grained - bedding @ 40°								
70.0	Greywacke - same - black seams - no mineral	68.5- 70.0	DI-6	1.5	Nil	Nil	0.03	0.31	Nil
78.6	Argillite - dark grey to black - very fine grained - bedding @ 50°								
80.5	Argillite - very weak seams pyrite	78.6- 80.5	DI-7	1.9	Nil	0.04	0.07	0.19	Nil
80.9	Argillite - as for 78.6 - no mineral								
85.0	Argillite - same - thin seams pyrite and chalcopyrite	80.9- 85.0	DI-8	4.1	Nil	0.03	0.22	0.14	0.05
89.0	Argillite - same - thin seams pyrite, chalcopyrite, galena	82.0 85.0- 89.0	DI-9	4.0	Grab cp Nil	0.03	-	-	-
91.0	Argillite - same - no mineral	87.6	DI-2	Grab	cp	0.42	-	-	-
93.5	Argillite - same - 1/2" quartz veinlet + chalcopyrite & galena	91.0- 93.5	DI-1	2.5	Nil	0.03	-	-	-
96.0	Argillite - same - thin seams pyrite - chalcopyrite, galena	95.5- 96.0	DI-10	2.5	Nil	0.04	0.02	0.28	0.02
100.0	Argillite - same - same mineral	96.0-100.0	DI-11	4.0	Nil	0.03	0.03	0.32	0.06
104.8	Argillite - same - no mineral								
105.5	Argillite - same - breccia of thin mineralized seams	104.8-105.5	DI-12	0.7	Nil	Nil	0.03	0.27	0.02
111.0	Argillite - same - no mineral								

*G. S. Hallbrook*



PROPERTY:

Finer Development Exploration Ltd. - Ingram Township Property

HOLE NO. D-1

LATITUDE:	BEARING: N19°E	DIP: 45°	STARTED: July 10/63	COMPLETED: July 29/63
DEPARTURE:	V.D.	H.D.	DRILLED BY: Continental Diamond Drilling	
ELEVATION:	LOCATION: 510' south & 10' east of northwest corner claim 52712 (NWA. S/2,			DEPTH: 1,000'
	Lot 11, Con. VI)			LOGGED BY: G.L.H.

FOOTAGE	DESCRIPTION	SAMPLE FOOTAGES	SAMPLE No.	WIDTH Ft.	ASSAY DATA				
					Au/Oz	Ag/Oz	Cu%	Pb%	Zn%
111.8	Argillite - same - one 1/2" streak chalcopryrite	111.0-111.8	D1-13	0.8	Nil	Nil	0.03	0.22	Nil
113.2	Argillite - same - no mineral								
115.0	Argillite - same - 1/2" streak pyrite + 1/4" chalcopryrite & galena	113.2-115.0	D1-14	1.8	Nil	0.03	0.04	0.24	Tr
120.0	Argillite - same - no mineral - weak disseminated chalcopryrite in 10" sandy band								
120.6	Argillite - sandy horizon - weak disseminated chalcopryrite	120.0-120.6	D1-16	0.6	Nil	0.05	0.30	0.41	Nil
150.0	Argillite - as for 78.6 - narrow seams pyrite, chalcopryrite, galena								
152.5	Argillite - same + silver coating on longitudinal seam	150.0-152.5	D1-23	2.5	Nil	0.03	0.03	0.25	0.05
460.0	Argillite - as for 78.6 - no mineral								
515.0	Conglomerate - occasional granite, sandstone, quartz boulders to 1.1' + in fine argillaceous matrix								
544.0	Argillite - as for 78.6 with occasional rare boulders								
668.0	Greywacke - light grey - fine grained - occasional scattered pebbles becoming more frequent - occasional gritty layers								
693.0	Conglomerate - greenish matrix - granite & quartz pebbles								
800.0	Greywacke - pale green - very fine grained - scattered pebbles becoming less frequent								
878.0	Greywacke - same - no pebbles								

*Handwritten signature/initials*









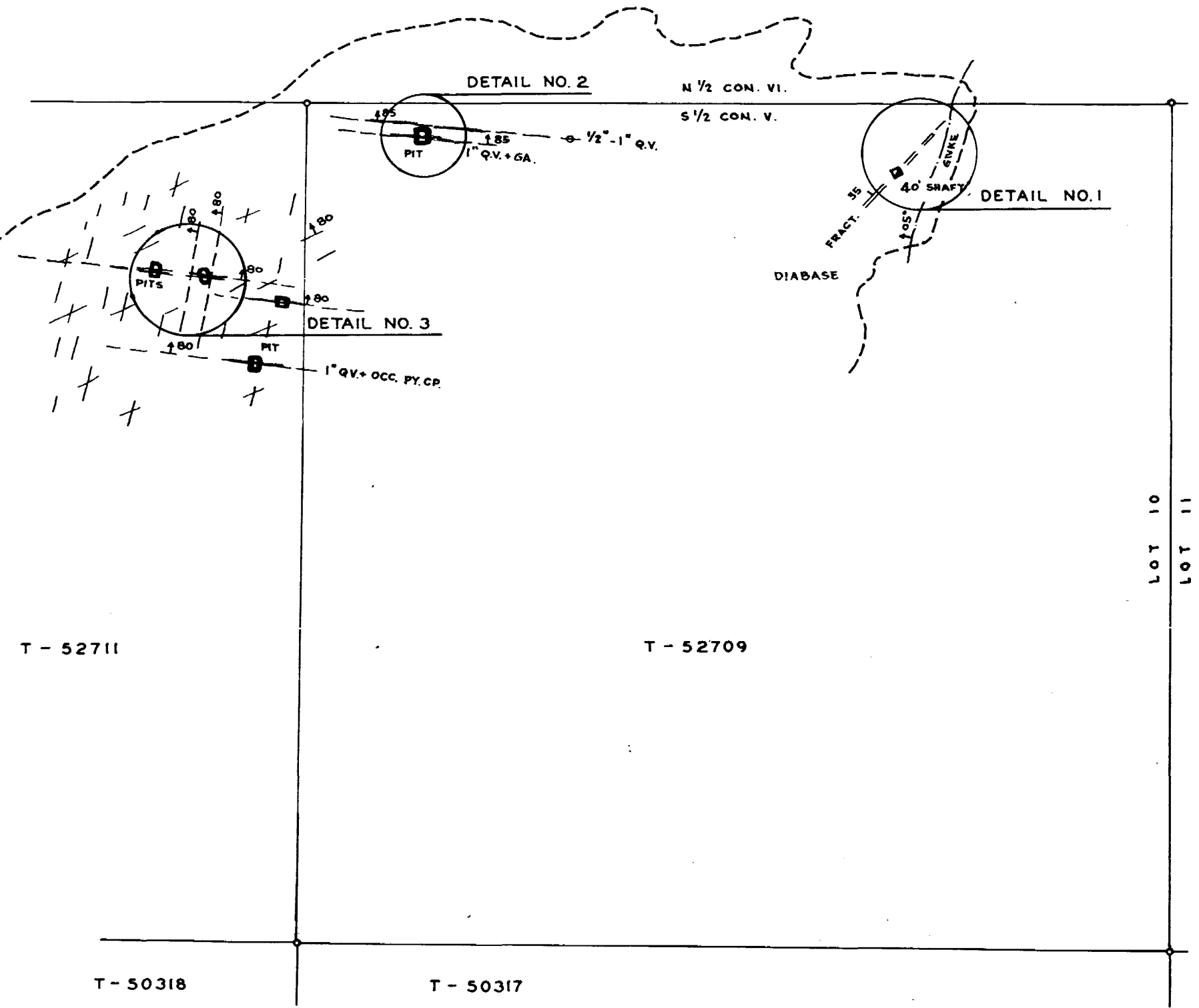

LOCATION OF SHOWINGS DRILLED  
CLAIMS T-52709 & 52711  
 SCALE 1" = 200'

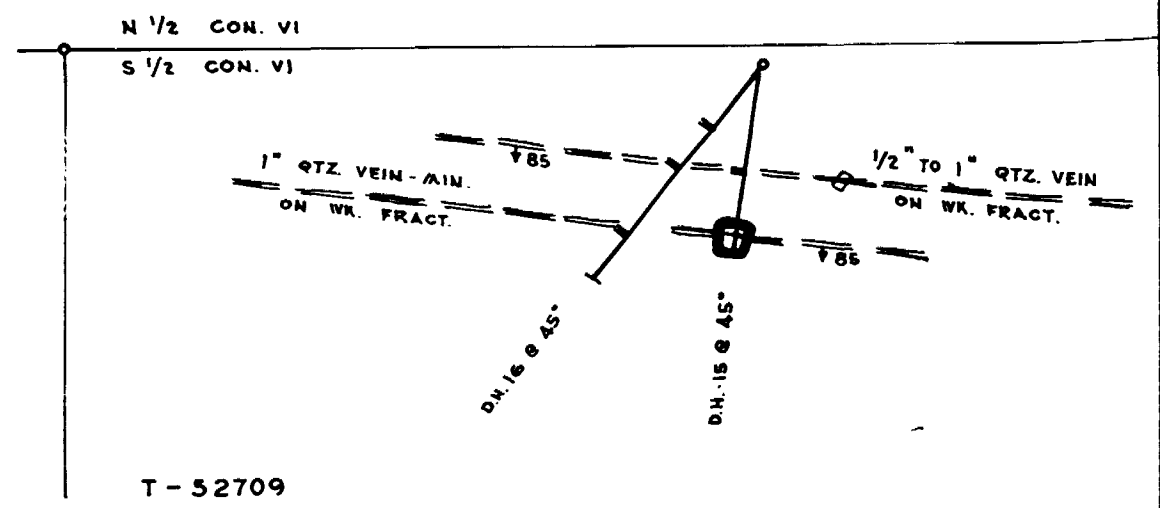

DETAIL NO. 2  
 SCALE 1" = 50'

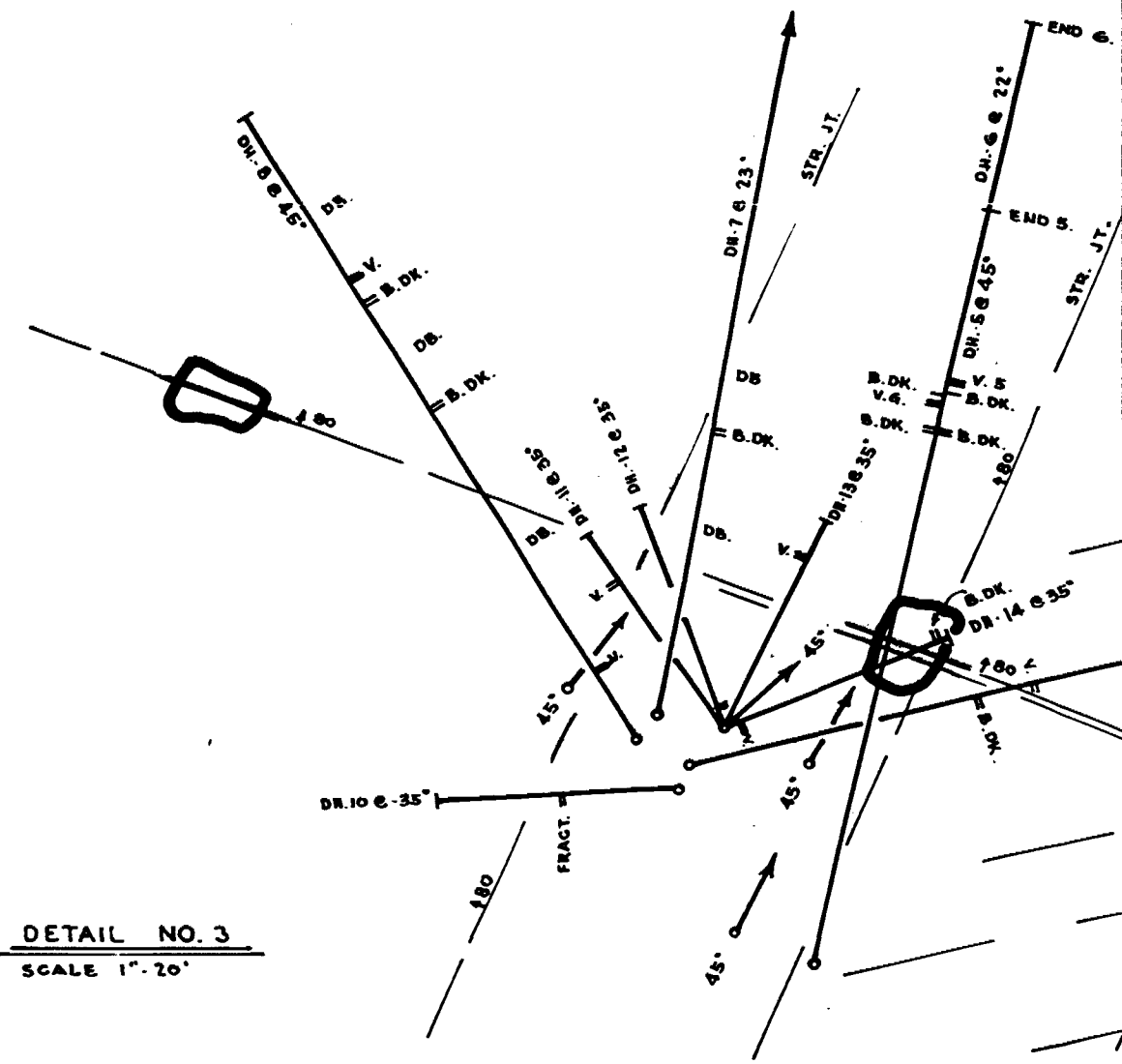

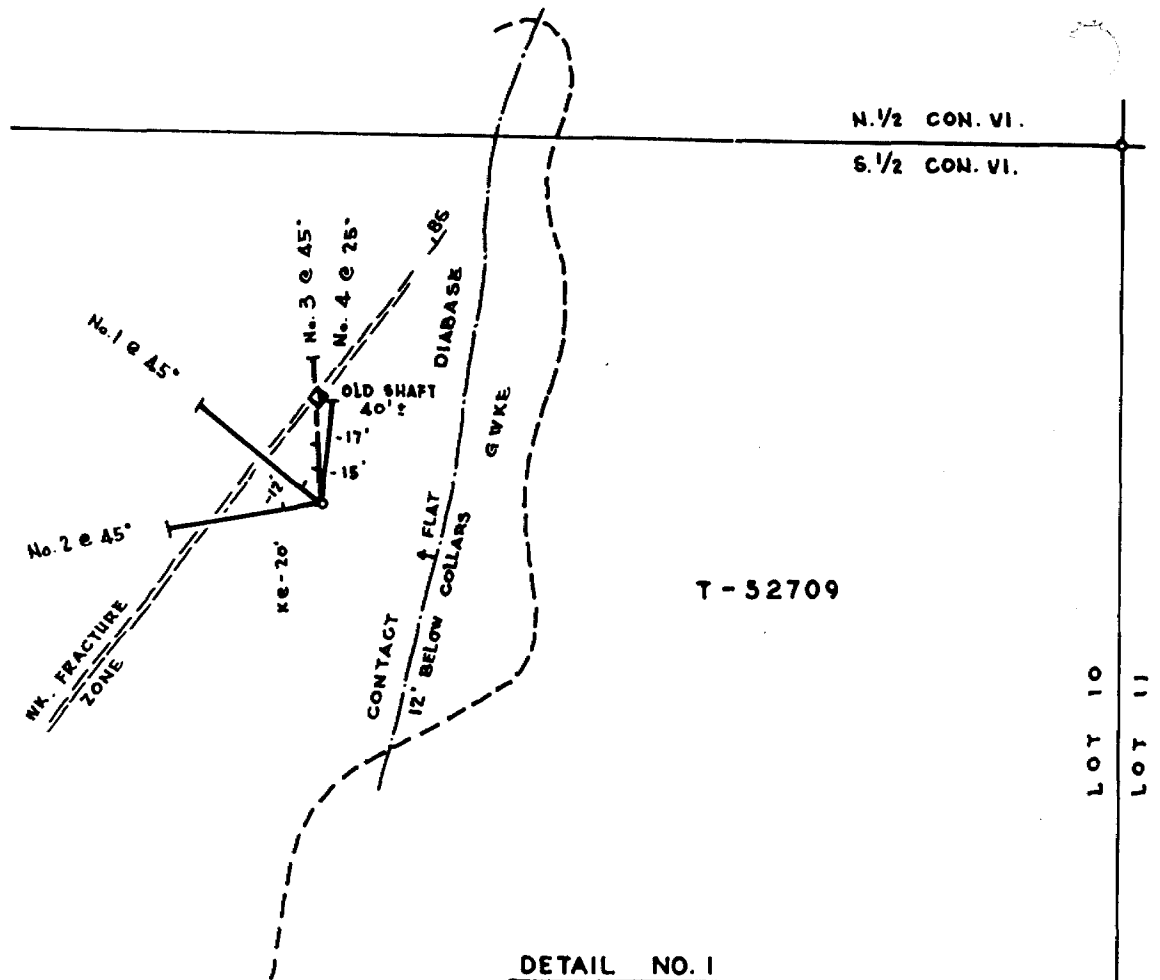

DETAIL NO. 1

SCALE 1" = 100'

TINEX DEVELOPMENT EXPLORATION LTD  
PLANS & DETAIL OF DIAMOND DRILLING  
INGRAM TOWNSHIP PROPERTY

SCALE AS SHOWN

PREPARED FOR G.L. HOLBROOKE

DATE May 1/63 SIGNED G.L. Holbrooke

