



32D04NE0083 2.7337 MCVITTIE

010

REPORT OF GEOLOGICAL MAPPING  
TO DEFINE ZONES OF SULFIDE MINERALIZATION  
EDOMAR RESOURCES INC.  
LARDER LAKE, ONTARIO

This report is the result of ten days field mapping on Claims L525171 to L525179 inclusive. These claims form part of the main contiguous Claim Block that Edomar Resources has staked on either side of the McVittie and McGarry Township boundary. The Claim Group is also known as the former McVittie-Kirkland property. Geological personnel supervised by the writer were on the property between June 5 and June 15, 1984. The purpose of this work is to further define areas of favourable gold mineralization based on structural relationships on this property as part of an ongoing project to evaluate the gold potential of the Claim Block.

The property is situated in the Northern half of McVittie Township adjacent to the Township boundary with McGarry Township. Access to the property is by way of Larder Lake Station Road situated about one mile Northeast of the Village of Larder Lake. From the Larder Lake Station it is about a 2 mile walk East along the railroad track of the Ontario Northern Railway to Highwater Lake. The area of investigation lies immediately to the North of this lake.

## MAPPING

A map was made on a scale of 1"=400 feet using the pre-existing grid which has been laid out for the geophysical program and for previous mapping. The condition of the grid was very poor and many of the pickets had to be re-marked and some of the lines had to have the thick undergrowth removed.

## GEOLOGICAL SETTING

This portion of Edomar's Claim Group was chosen as an area for more detailed mapping as the most salient geological feature of the Claim Group, the Spectacle Lake anticline trends across this area with a North West-South East orientation. This anticlinal feature has been mapped from Beaver House Lake in Gauthier Township to the Kerr-Addison Mine in McGarry Township. In the Eastern portion of Edomar's Claim Group extensive sulfide mineralization has been encountered on the limbs of this structure associated with possible strike orientated faulting. The area mapped consists essentially of Keewatin basic volcanics overlain by the Timiskaming series consisting of basal conglomerate followed by a series of greywacke and arkosic type rocks. These have been intruded by a series of Algonian dikes and syenite porphyries. In the Northern part of the area mapped the Timiskaming conglomerates and greywackes form an Easterly plunging synformal feature. The purpose of the mapping was to define areas of sulfide mineralization in this geological and structural setting.

OBSERVATIONS

The mapping program outlined three (3) areas of disseminated sulfide mineralization in Keewatin and in rocks of Timiskaming age. It appears that all the areas of mineralization are associated with major strike orientated faults on the limbs of the Spectacle Lake-Kerr-Addison anticline. It is also interesting to note that there appears to be a correlation between the magnetic survey and the sulfide mineralized areas. The mineralization appears to be pervasive and is not confined to the zones of shearing. A sample program should be undertaken to monitor the gold content of some of the mineralized zones.

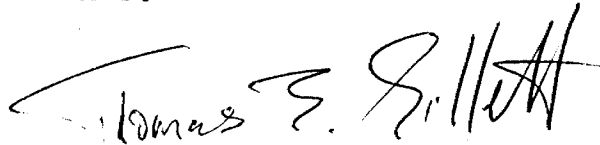

---

Thomas E. Gillett  
Geologist

Marmora, Ontario  
July 25, 1964.

22469



32D04NE0083 2.7337 MCVITTIE

900

Mining Lands Section

File No 2.1337

Control Sheet

TYPE OF SURVEY     GEOPHYSICAL  
                            GEOLOGICAL  
                            GEOCHEMICAL  
                            EXPENDITURE

MINING LANDS COMMENTS:

---

---

---

---

---

---

---

---

---

---

---

---

LD

Doug  
 Signature of Assessor

30/10/84  
 Date

1984 11 29

Your File: 437  
Our File: 2.7337

Mining Recorder  
Ministry of Natural Resources  
4 Government Road East  
Kirkland Lake, Ontario  
P2H 1A2

Dear Sir:

RE: Notice of Intent dated November 9, 1984.  
Geological Survey on Mining Claims L 525171  
et al in the McVittie and McGarry Townships.

---

The assessment work credits, as listed with the  
above-mentioned Notice of Intent, have been approved  
as of the above date.

Please inform the recorded holder of these mining  
claims and so indicate on your records.

Yours sincerely,

S.E. Yundt  
Director  
Land Management Branch

Whitney Block, Room 6643  
Queen's Park  
Toronto, Ontario  
M7A 1W3  
Phone:(416)965-6918

D. Isherwood:sc

cc: Edomar Resources Inc  
Suite 500  
67 Richmond Street West  
Toronto, Ontario  
M5H 1Z5

cc: Mr. G.H. Ferguson  
Mining & Lands Commissioner  
Toronto, Ontario

cc: Resident Geologist  
Kirkland Lake, Ontario

Recorded Holder  
 EDOMAR RESOURCES INC

Township or Area  
 McVITTIE, McGARRY TOWNSHIPS

Type of survey and number of Assessment days credit per claim	Mining Claims Assessed
Geophysical Electromagnetic _____ days Magnetometer _____ days Radiometric _____ days Induced polarization _____ days Other _____ days	
Section 77 (19) See "Mining Claims Assessed" column	
Geological _____ 20 _____ days	L 525171-172 525176 to 179 inclusive
Geochemical _____ days	
Man days <input type="checkbox"/> Airborne <input type="checkbox"/>	
Special provision <input checked="" type="checkbox"/> Ground <input checked="" type="checkbox"/>	
<input type="checkbox"/> Credits have been reduced because of partial coverage of claims.	
<input type="checkbox"/> Credits have been reduced because of corrections to work dates and figures of applicant.	

Special credits under section 77 (16) for the following mining claims

10 DAYS  
 L 525173 to 175 inclusive

No credits have been allowed for the following mining claims

not sufficiently covered by the survey       Insufficient technical data filed

The Mining Recorder may reduce the above credits if necessary in order that the total number of approved assessment days recorded on each claim does not exceed the maximum allowed as follows: Geophysical — 80; Geological — 40; Geochemical — 40; Section 77(19)—60:



*Nov. 26/84*

1984 11 09

Your File: 437...  
Our File: 2.7337

Mining Recorder  
Ministry of Natural Resources  
4 Government Road East  
Kirkland Lake, Ontario  
P2N 1A2

Dear Sir:

Enclosed are two copies of a Notice of Intent with statements listing a reduced rate of assessment work credits to be allowed for a technical survey. Please forward one copy to the recorded holder of the claims and retain the other. In approximately fifteen days from the above date, a final letter of approval of these credits will be sent to you. On receipt of the approval letter, you may then change the work entries on the claim record sheets.

For further information, if required, please contact Mr. R.J. Pichette at 416/965-4888.

Yours sincerely,

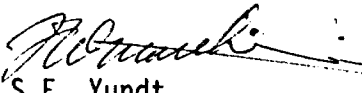
  
S.E. Yundt  
Director  
Land Management Branch

Whitney Block, Room 6643  
Queen's Park  
Toronto, Ontario  
M7A 1W3

*R* D. Isherwood:mc

Encls.

cc: Edomar Resources Inc  
Suite 500  
67 Richmond Street West  
Toronto, Ontario  
M5H 1Z5

cc: Mr. G.H. Ferguson  
Mining & Lands Commissioner  
Toronto, Ontario





Ministry of  
Natural  
Resources

Notice of Intent  
for Technical Reports

1984 11 09

2.7337/437

An examination of your survey report indicates that the requirements of The Ontario Mining Act have not been fully met to warrant maximum assessment work credits. This notice is merely a warning that you will not be allowed the number of assessment work days credits that you expected and also that in approximately 15 days from the above date, the mining recorder will be authorized to change the entries on his record sheets to agree with the enclosed statement. Please note that until such time as the recorder actually changes the entry on the record sheet, the status of the claim remains unchanged.

If you are of the opinion that these changes by the mining recorder will jeopardize your claims, you may during the next fifteen days apply to the Mining and Lands Commissioner for an extension of time. Abstracts should be sent with your application.

If the reduced rate of credits does not jeopardize the status of the claims then you need not seek relief from the Mining and Lands Commissioner and this Notice of Intent may be disregarded.

If your survey was submitted and assessed under the "Special Provision-Performance and Coverage" method and you are of the opinion that a re-appraisal under the "Man-days" method would result in the approval of a greater number of days credit per claim, you may, within the said fifteen day period, submit assessment work breakdowns listing the employees names, addresses and the dates and hours they worked. The new work breakdowns should be submitted direct to the Land Management Branch, Toronto. The report will be re-assessed and a new statement of credits based on actual days worked will be issued.

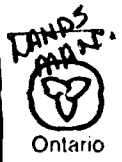

Ministry of  
Natural  
Resources  
Ontario

Report of Work  
(Geophysical, Geological,  
Geochemical and Expenditures)

2-1331

The Mining Act

# 437 Dec. 3

- Instructions: - Please type or print.  
- If number of mining claims traversed exceeds space on this form, attach a list.  
Note: - Only days credits calculated in the "Expenditures" section may be entered in the "Expend. Days Cr." columns.  
- Do not use shaded areas below.

(file L525171)

Type of Survey(s)		Township or Area	
Claim Holder(s)		Prospector's Licence No.	
Address			
Survey Company		Date of Survey (from & to)	
Name and Address of Author (of Geo-Technical report)		Total Miles of line Cut	

Credits Requested per Each Claim in Columns at right		
Special Provisions For first survey: Enter 40 days. (This includes line cutting)  For each additional survey using the same grid: Enter 20 days (for each)	Geophysical	Days per Claim
	Geological	2
Man Days Complete reverse side and enter total(s) here	Geophysical	Days per Claim
	Geological	
Airborne Credits Note: Special provisions credits do not apply to Airborne Surveys.	Electromagnetic	Days per Claim
	Magnetometer	

Mining Claims Traversed (List in numerical sequence)			Mining Claims Traversed (List in numerical sequence)		
Prefix	Mining Claim Number	Expend. Days Cr.	Prefix	Mining Claim Number	Expend. Days Cr.
L	525171				
	525172				
	525173				
	525174				
	525175				
	525176				
	525177				
	525178				
	525179				

RECEIVED  
OCT 22 1984

MINING LANDS SECTION

LARDER LAKE  
MINING DIV.  
RECEIVED  
OCT - 2 1984  
AM 7-8 9-10 11-12 1-2 3-4 5-6 PM

Expenditures (excludes power stripping)	
Type of Work Performed	Performed on Claim(s)
Calculation of Expenditure Days Credits	
Total Expenditures	Total Days Credits
\$	15 =
Instructions Total Days Credits may be apportioned at the claim holder's choice. Enter number of days credits per claim selected in columns at right.	

Total number of mining claims covered by this report of work. 7

For Office Use Only		
Total Days Cr. Recorded	Date Recorded	Mining Recorder
180	OCT 2 1984	
Date Approved as Recorded	Branch Director	
	see revised statement	

Date	Recorded Holder or Agent (Signature)

Certification Verifying Report of Work

I hereby certify that I have a personal and intimate knowledge of the facts set forth in the Report of Work annexed hereto, having performed the work or witnessed same during and/or after its completion and the annexed report is true.

Name and Postal Address of Person Certifying

Date Certified

Certified by (Signature)

The Mining Act

Type of Survey(s) <i>1-GEOLOGICAL</i>	Township or Area <i>McV. Hill + Mc Garry</i>
Claim Holder(s) <i>EDOMAR RESOURCES INC.</i>	Prospector's Licence No. <i>1946</i>
Address <i>Suite 500 67 Richmond St. West Toronto Ontario M5H 1Z5</i>	
Survey Company <i>T.E. Gillett B.Sc.</i>	Date of Survey (from & to) Day   Mo.   Yr.   Day   Mo.   Yr. <i>05   06   94   15   06   94</i>
Name and Address of Author (of Geo-Technical report) <i>T.E. Gillett B.Sc. P. 33 Markham Ontario N0K 2M0</i>	

Credits Requested per Each Claim in Columns at right			Mining Claims Traversed (List in numerical sequence)					
<b>Special Provisions</b>  For first survey: Enter 40 days. (This includes line cutting)  For each additional survey: using the same grid: Enter 20 days (for each)	Geophysical	Days per Claim	Mining Claim Prefix	Mining Claim Number	Expend. Days Cr.	Mining Claim Prefix	Mining Claim Number	Expend. Days Cr.
	- Electromagnetic		<i>L</i>	<i>525171</i>				
	- Magnetometer			<i>525172</i>				
	- Radiometric			<i>525173</i>				
	- Other			<i>525174</i>				
	Geological	<i>20</i>		<i>525175</i>				
	Geochemical			<i>525176</i>				
<b>Man Days</b>  Complete reverse side and enter total(s) here	Geophysical	Days per Claim		<i>525177</i>				
	- Electromagnetic			<i>525178</i>				
	- Magnetometer			<i>525179</i>				
	- Radiometric							
	- Other							
	Geological							
	Geochemical							
<b>Airborne Credits</b>  Note: Special provisions credits do not apply to Airborne Surveys.	Electromagnetic	Days per Claim						
	Magnetometer							
	Radiometric							

**Expenditures (excludes power stripping)**

Type of Work Performed

Performed on Claim(s)

Calculation of Expenditure Days Credits

Total Expenditures \$  ÷  = Total Days Credits

Instructions  
 Total Days Credits may be apportioned at the claim holder's choice. Enter number of days credits per claim selected in columns at right.

**For Office Use Only**

Total Days Cr. Recorded	Date Recorded	Mining Recorder
	Date Approved as Recorded	Branch Director

Date *June 20 94*

Recorded Holder or Agent (Signature)  
*[Signature]*

**Certification Verifying Report of Work**

I hereby certify that I have a personal and intimate knowledge of the facts set forth in the Report of Work annexed hereto, having performed the work or witnessed same during and/or after its completion and the annexed report is true.

Name and Postal Address of Person Certifying  
*[Signature]*

Date Certified *[Signature]*

Certified by (Signature)  
*[Signature]*

Total number of mining claims covered by this report of work. *7*



Ministry of  
Natural  
Resources

Ontario

Land Management Branch  
Mining Division  
Whitney Elm Park  
Toronto, Ontario M7A 1W3

Edomar Resources Inc.  
Suite 500  
67 Richmond Street West  
Toronto, Ontario  
M5H 1Z5.



Ministry of  
Natural  
Resources

Ontario

Land Management Branch  
Mining Division  
Whitney Drive, Queen's Park  
Toronto, Ontario M7A 1W3

Mr. William Puddy  
46 Ridgevalley Crescent  
Islington, Ontario  
M3A 3J6.



Ministry of  
Natural  
Resources

Ontario

Land Management Branch  
Mining Land  
Whitney Block  
Toronto, Ontario M7A 1W3

Thomas E. Gillett  
Geologist  
RR #3  
MARMORA, Ontario  
K0K 2M0.

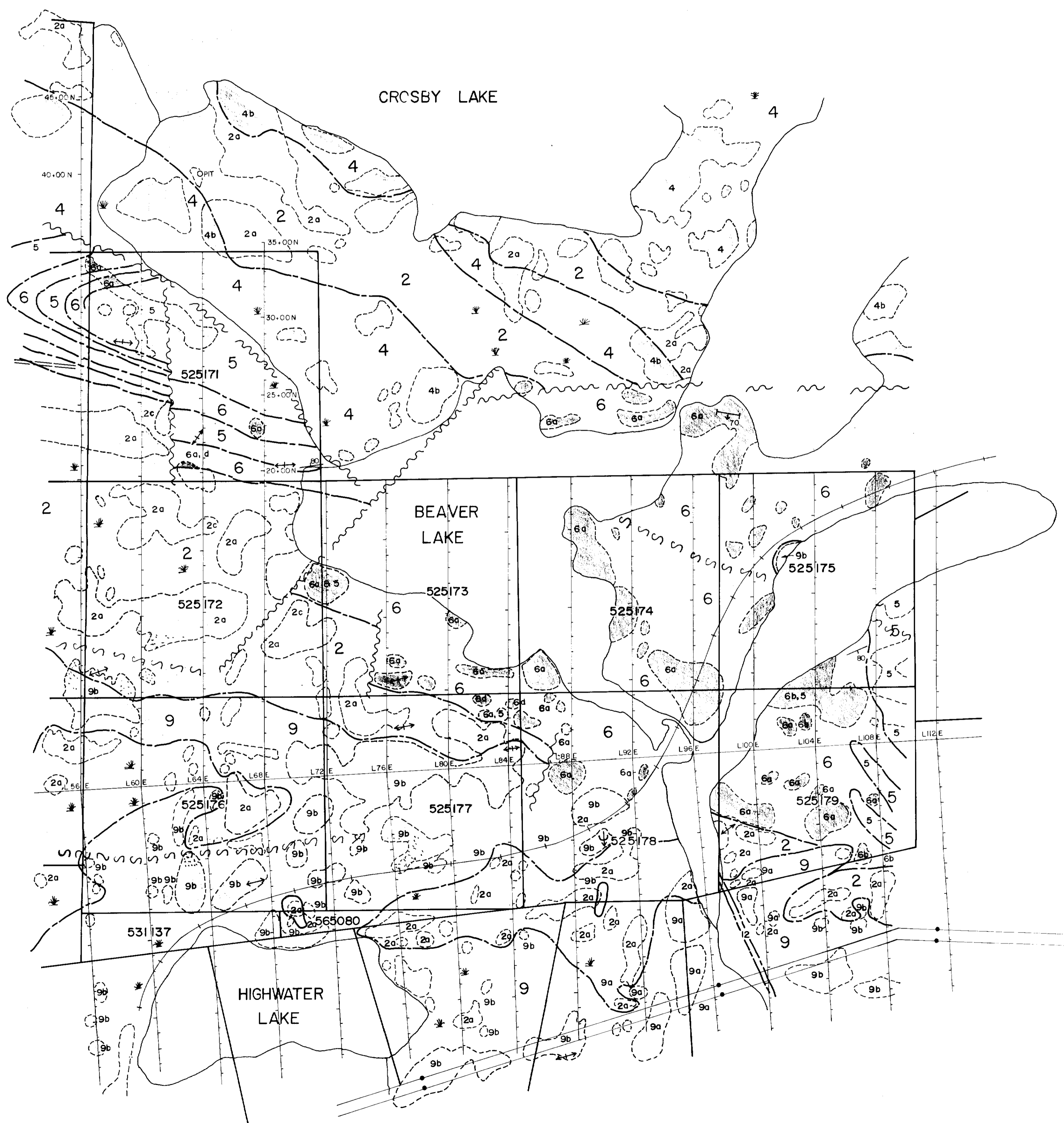

SYMBOLS

- Swamp
- Railway
- Power line
- Road
- Glacial striae
- Geological boundary, defined
- Geological boundary, assumed
- Boundary of rock outcrop
- Strike and dip of beds
- Strike and vertical dip of beds
- Strike and dip of schistosity
- Strike and vertical dip of schistosity
- Direction in which lava flows face, indicated by shape of pillows
- Overturned beds
- Direction in which beds face, indicated by cross bedding
- Shaft
- Adit
- Diamond drill hole, horizontal projection
- Building
- Trench
- OPIT Test pit
- Fault or sheared zone, defined
- Fault or sheared zone, assumed
- Property boundary

GEOLOGICAL LEGEND  
(From O.G.S. Map No. 50b)

- QUATERNARY**
- PLEISTOCENE**
- Clay, sand, gravel.
- PRE-CAMBRIAN**
- KEWEENAWAN or MATACHEWAN**
- Diabase
- INTRUSIVE CONTACT**
- HURONIAN (Cobalt Series)**
- Conglomerate (11a), greywacke (11b)
- GREAT UNCONFORMITY**
- ALGOMAN**
- Carbonated rock or 'dolomite'
- Syenite (9a), syenite porphyry (9b), quartz porphyry (9c), mica syenite and lamprophyre (9d), diorite (9e), granite (9f), quartz syenite (9g).
- INTRUSIVE CONTACT**
- TIMISKAMING**
- Basic lava (8a), spherulitic lava (8b), fragmental lava (8c), agglomerate (8d), tuff (8e), dacite (8f), talc-chlorite schist (8g).
- Trachyte (7a), porphyritic trachyte (7b), trachytic breccia and agglomerate (7c), tuff (7d).
- Greywacke (6a), arkose (6b), quartzite (6c), slate (6d), iron formation (6e).
- Conglomerate with some interbedded arkose and greywacke.
- EROSIONAL UNCONFORMITY**
- POST-KEEWATIN**
- Diorite (4a), gabbro (4b).
- INTRUSIVE CONTACT**
- KEEWATIN**
- Basic volcanics: andesite, basalt, and pillow lava (2a), dioritic lava (2b), fragmental lava (2c), agglomerate (2d), talc-chlorite schist (2e), bedded tuff (2f).
- Acid volcanics: rhyolite and trachite (1a), fragmental lava (1b).
- Partially carbonated lavas, sediments, and intrusives.
- † Sometimes carbonated and intersected by quartz stringers.
- \* Possibly Post-Timiskaming
- Sulfide Mineralization

EDOMAR RESOURCES INC.  
McVittie and McGarry  
Townships  
LARDER LAKE MINING DIVISION, ONTARIO

GENERAL GEOLOGY

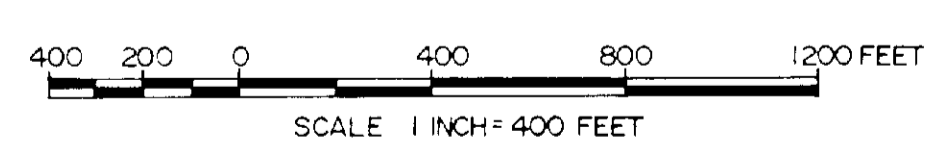

*J. S. G. [Signature]*  
6-30-84

