



32D04NE0106 20 MCVITTIE

010

Diamond Drilling

Township of MCVITTIE

Report No: 20

Work performed by: M. Bustream

Claim No	Hole No	Footage	Date	Note
L 386910	14	102'	May/75	(1)
	15	125'	June/75	(2)
	16	103'	June/75	(2)
	17	102'	July/75	(2)

4 DDH - 432'

(1) #151

(2) #202-75

McVITTE

m370

DISTRICT OF
TIMISKAMING

LARDER LAKE
MINING DIVISION

SCALE: 1-INCH - 40 CHAINS

LEGEND

PATENTED LAND	⊙ or ⊕
CROWN LAND SALE	C.S.
LEASES	Ⓛ
LOCATED LAND	Loc.
LICENSE OF OCCUPATI	L.O.
MINING RIGHTS ONLY	M.R.O.
SURFACE RIGHTS ONLY	S.R.O.
ROADS	———
IMPROVED ROADS	———
KING'S HIGHWAYS	———
RAILWAYS	———
POWER LINES	———
MARSH OR MUSKEG	* *
MINES	⌘
CANCELLED	C.
PATENTED S.R.O.	⊙

#151

NOTES

400' SURFACE RIGHTS RESERVATION ALONG THE
SHORES OF ALL LAKES AND RIVERS.

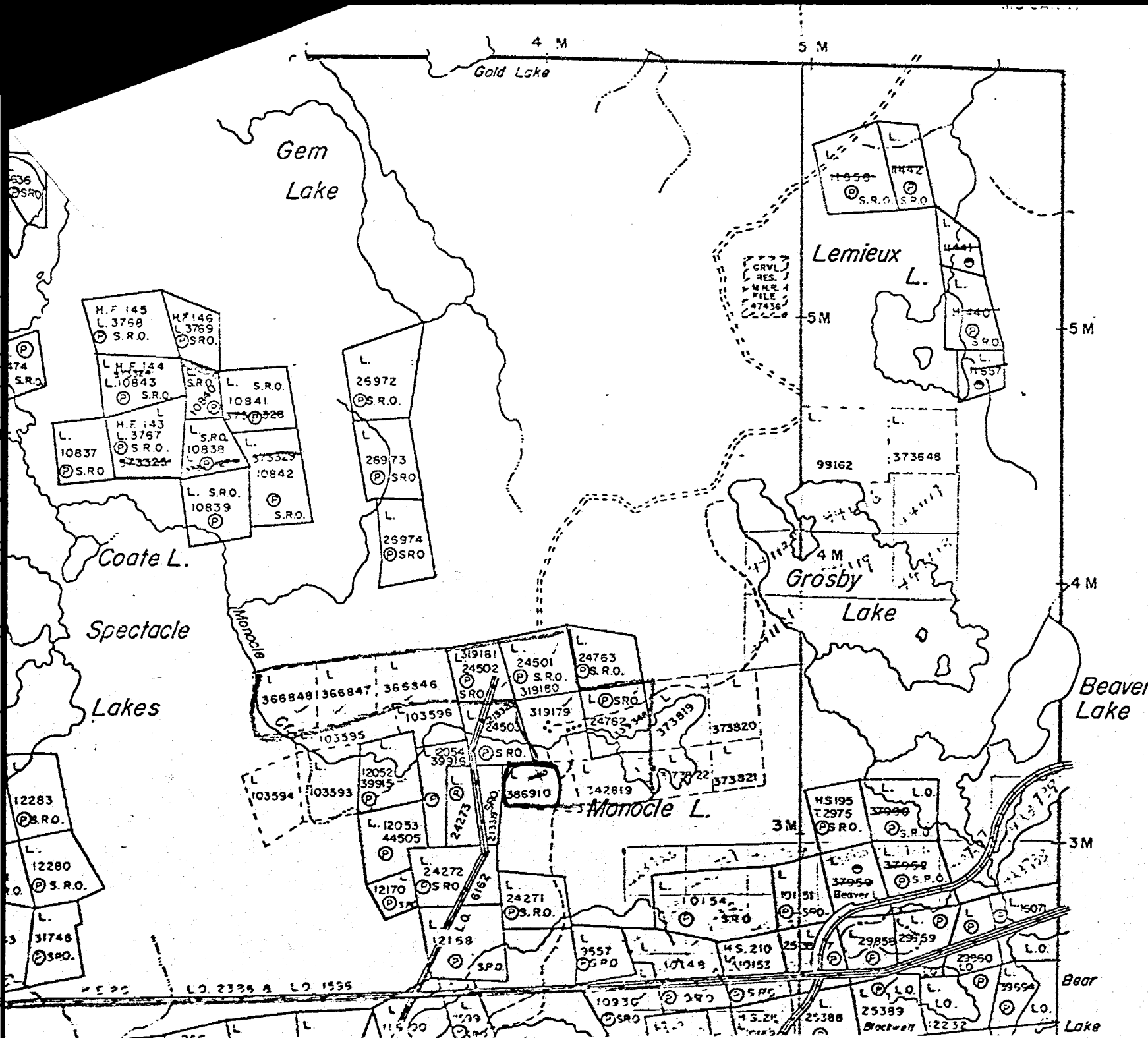

McVittie Tp. (M. 369)

McVITTIE

M370

DISTRICT OF
TIMISKAMING

LARDER LAKE
MINING DIVISION

SCALE: 1-INCH = 40 CHAINS

LEGEND

- PATENTED LAND ● or P
- CROWN LAND SALE C.S.
- LEASES L
- LOCATED LAND Loc.
- LICENSE OF OCCUPATION L.O.
- MINING RIGHTS ONLY M.R.O.
- SURFACE RIGHTS ONLY S.R.O.
- ROADS
- IMPROVED ROADS
- KING'S HIGHWAYS
- RAILWAYS
- POWER LINES
- MARSH OR MUSKEG
- MINES
- CANCELLED
- PATENTED S.R.O. ⊙

McVITTIE TWP
202-75
M. BUSTRAEN

NOTES

400' SURFACE RIGHTS RESERVATION ALONG THE SHORES OF ALL LAKES AND RIVERS.

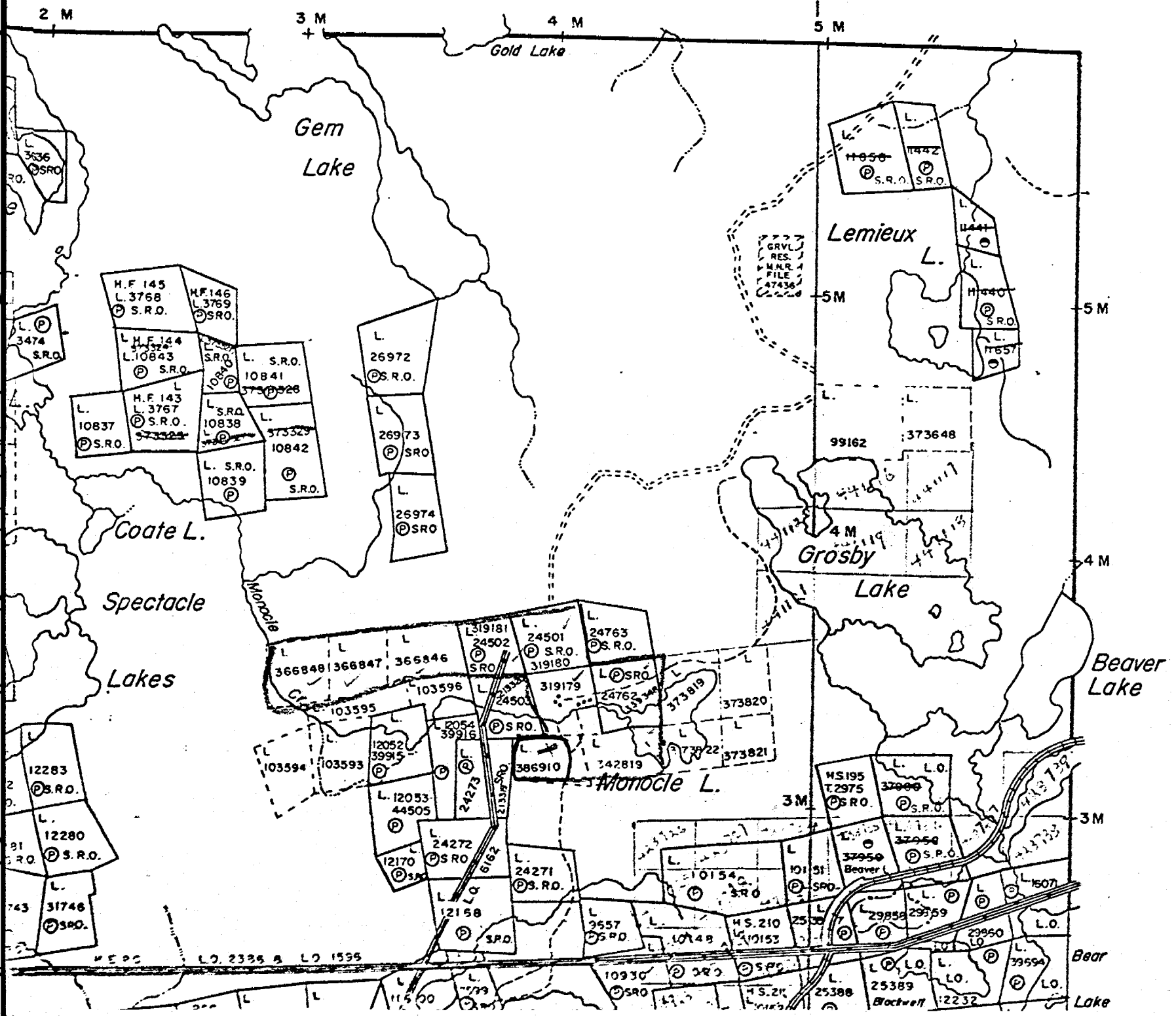

McGarry Tp. (M. 369)

DIAMOND DRILL RECORD

LOGGED BY P. Jeansonne

PROPERTY M. Bustream - McVittie Township, Ontario

D.D.H. No. 14 PAGE 1

LATITUDE _____ BEARING OF HOLE S 10° W STARTED May 19, 1975

CLAIM No. L-333000 386910

DEPARTURE _____ DIP OF HOLE -55° COMPLETED June 2, 1975

DIRECTION AND DISTANCE FROM

ELEVATION _____ DIP TESTS _____ DEPTH 102.0 feet

NE. CLAIM POST

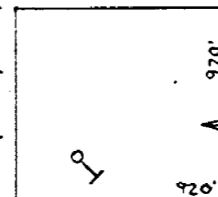

FOOTAGE		DESCRIPTION	SAMPLE No.	FOOTAGE		SAMPLE LENGTH	ASSAY			
FROM	TO			FROM	TO					
0.0	4.0	Casing.								
4.0	23.0	Andesite, massive, green, occasional minor vein less than 1", made of white carbonates, calcite and glassy quartz containing disseminated pyrite and scarce chalcopyrite specks.								
23.0	28.0	Lost core.								
28.0	60.0	Same as above - 4.0 to 23.0'.								
60.0	64.5	Lost core.								
64.5	76.0	Same as above - 4.0 to 23.0'.								
76.0	77.0	White carbonate vein with 2 - 3% pyrite, chalcopyrite specks.								
77.0	102.0	Andesite as above.								
102.0		End of Hole.								

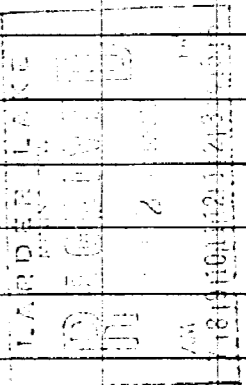

M370

Pierre Jeansonne
Exploration L. Bustream
B. McVittie