

DIAMOND DRILLING



32D04NE0459 22 MCGARRY

010

TOWNSHIP: McGarry

REPORT No.: 22

WORK PERFORMED BY: Noranda Exploration Co. Ltd.

<u>CLAIM No.</u>	<u>HOLE No.</u>	<u>FOOTAGE</u>	<u>DATE</u>	<u>NOTE</u>
L 547094	81 - 1	436.0	June/81	(1)
	81 - 2	401.0	June/81	(1)

2 837'

NOTES: (1) #580-81

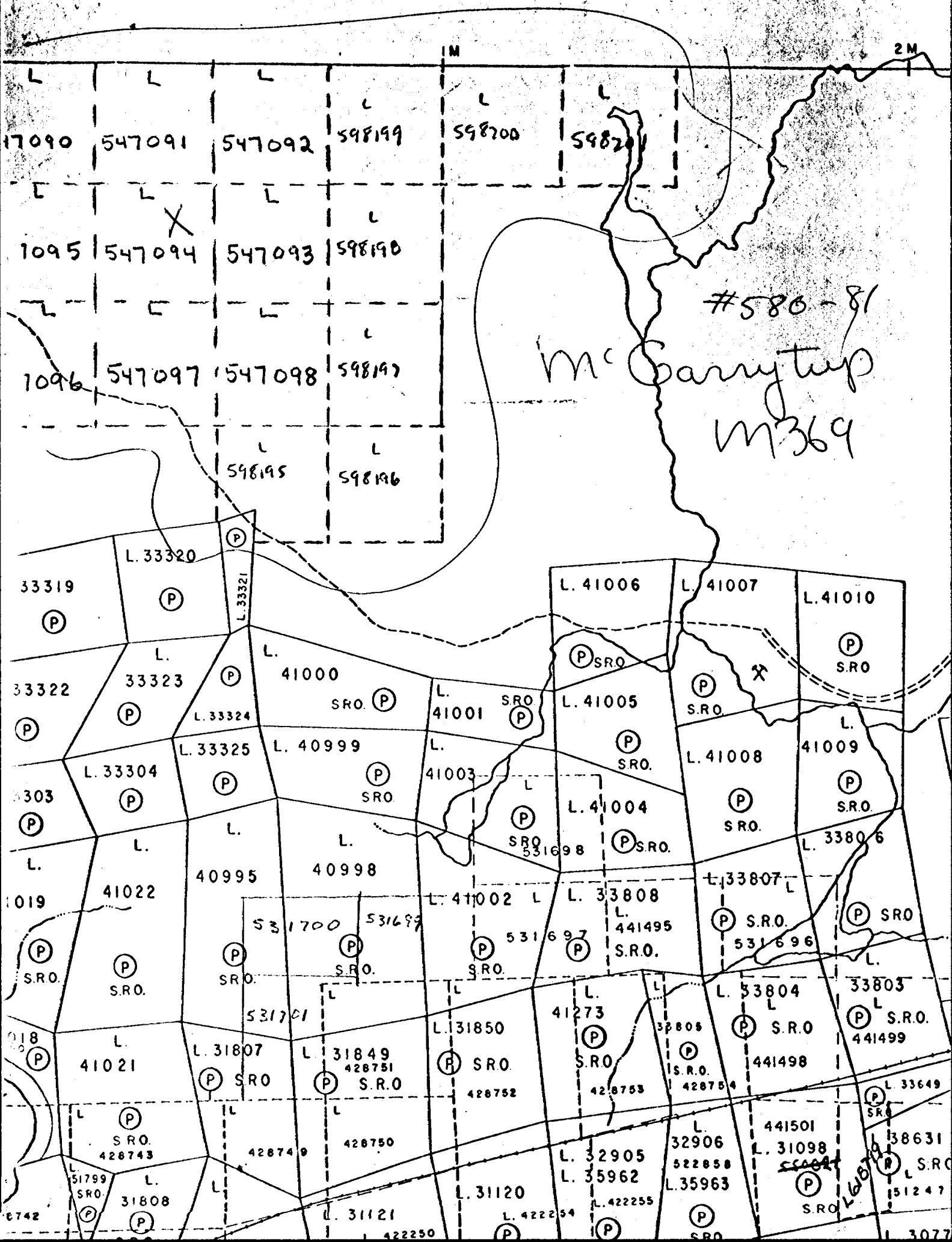

17090 547091 547092 598199 598200 598201
1095 547094 547093 598198
1096 547097 547098 598197
598195 598196

#580-81
McCarrytop
M369

L. 33320
33319
33322
33323
L. 33324
L. 33304
3303
L. 41022
40995
40998
L. 41000
S.R.O.
L. 41001
S.R.O.
L. 41003
S.R.O.
L. 41004
S.R.O.
L. 41005
S.R.O.
L. 41006
S.R.O.
L. 41007
S.R.O.
L. 41010
S.R.O.
L. 41008
S.R.O.
L. 41009
S.R.O.
L. 33806
L. 33807
S.R.O.
L. 33808
L. 44195
S.R.O.
L. 33804
S.R.O.
L. 33803
S.R.O.
L. 44198
L. 44199
L. 33649
L. 32905
L. 35962
L. 422255
L. 31120
L. 422254
L. 31850
S.R.O.
L. 31849
428751
S.R.O.
428752
L. 31807
S.R.O.
L. 31808
S.R.O.
L. 31121
L. 422250
L. 32906
522858
L. 35963
L. 441501
L. 31098
L. 38631
L. 3077

DIAMOND DRILL CORE LOG

LATITUDE 2+00S
 DEPARTURE 1+00E
 ELEVATION surface
 BEARING N30°E
 DIP AT COLLAR -47°

TESTS DEPTH	DIP	MAGNETIC BEARING	CORRECTED BEARING
300'	-53°	_____	_____
_____	_____	_____	_____
_____	_____	_____	_____

PROPERTY McGarry 1-79
 CLAIM NO. L-547094
 HOLE NO. McG 81-1
 CORE SIZE AQ
 STARTED June 16, 1981
 FINISHED June 19, 1981

TOTAL DEPTH OF HOLE 436'

FOOTAGE		DESCRIPTION	SAMPLE NO.	ASSAYS					CORE LENGTH		
FROM	TO			AU OZ	AG OZ	% CU	% ZN	% NI	FROM	TO	ACC. WIDTH
0	12	CASING									
12	13.5	RHYOLITE: dark grey to black, weakly porphyritic; 5-10% white sub- hedral phenocrysts 0.01" to 0.05" long in aphanitic groundmass; a few Qtz and py amygdules (<3%) 0.05-0.1" diameter. - fine chloritic strgs at 30° to core; fine silica-filled fractures at all angles.									
13.5	26.3	DIORITE DIKE: dark green-grey, porphyritic; 40% hornblende and pyroxene phenocrysts in a very fine grained groundmass of feldspar and chloritic ferromagnesium minerals; rare irregular reddish siliceous patches; weakly magnetic, tr py; upper contact at 30° to core axis; lower contact obscured by strong silicification with epidote, minor py and hematite.									

CONTRACTOR BENOIT DIAMOND DRILLING

LOGGED BY *John S. [Signature]*

DIAMOND DRILL CORE LOG

LATITUDE 4+30S
 DEPARTURE 0+75E
 ELEVATION surface
 BEARING N30°E
 DIP AT COLLAR -55°

TESTS DEPTH	DIP	MAGNETIC BEARING	CORRECTED BEARING
350'	-53°	_____	_____
_____	_____	_____	_____
_____	_____	_____	_____

PROPERTY McGarry 1-79
 CLAIM NO. L-547094
 HOLE NO. McG 81-2
 CORE SIZE AQ
 STARTED June 20, 1981
 FINISHED June 22, 1981

TOTAL DEPTH OF HOLE 401'

FOOTAGE		DESCRIPTION	SAMPLE NO.	ASSAYS					CORE LENGTH		
FROM	TO			AU OZ	AG OZ	% CU	% ZN	% NI	FROM	TO	ACC. WIDTH
0	20	CASING									
20	76.4	PORPHYRITIC DIORITE: dark grey, weakly magnetic; 30-40% white feldspar phenocrysts 0.05" to 0.1" long; 20% dark green to black hornblende phenocrysts 0.1" to 0.2" long; tr py; near lower contact are stringers of red-tinted feldspar with epidote in fractures; appears nearly equigranular medium grained in places.									
76.4	180.7	PORPHYRITIC ANDESITE: dark grey-brown, very weakly magnetic; 40-50% hornblende + pyrox. phenocrysts largely altered to chlorite and diorite; 5-10% white feldspar phenocrysts; tr py. 76.4-90 - 3-5% coarse patches of epidote. 103.0-134.3 - altered zone-silicified with moderate biotite alteration; numerous bleached silicified stringers and patches of brown fine grained biotite with 1% py-po; strongest biotite									

CONTRACTOR BENOIT DIAMOND DRILLING

LOGGED BY Peter S. LeBaron
 Peter S. LeBaron

