



32D04NE0482 16 MCGARRY

010

Diamond Drilling

Township of MCGARRY

Report No: 16

Work performed by: Lee Geo-Indicators Limited

Claim No	Hole No	Footage	Date	Note
L 418816	51509	172'	Aug/75	(1)
L 428752	51510	200'	Aug/75	(1)
	51511	198'	Aug/75	(1)
	51512)	90'	Aug/75	(1)
	51513	250'	Sept/75	(1)
L 422254	51514	82'	Sept/75	(1)
	51515	215'	Sept/75	(1)

12 37

Notes:

(1) #243-75



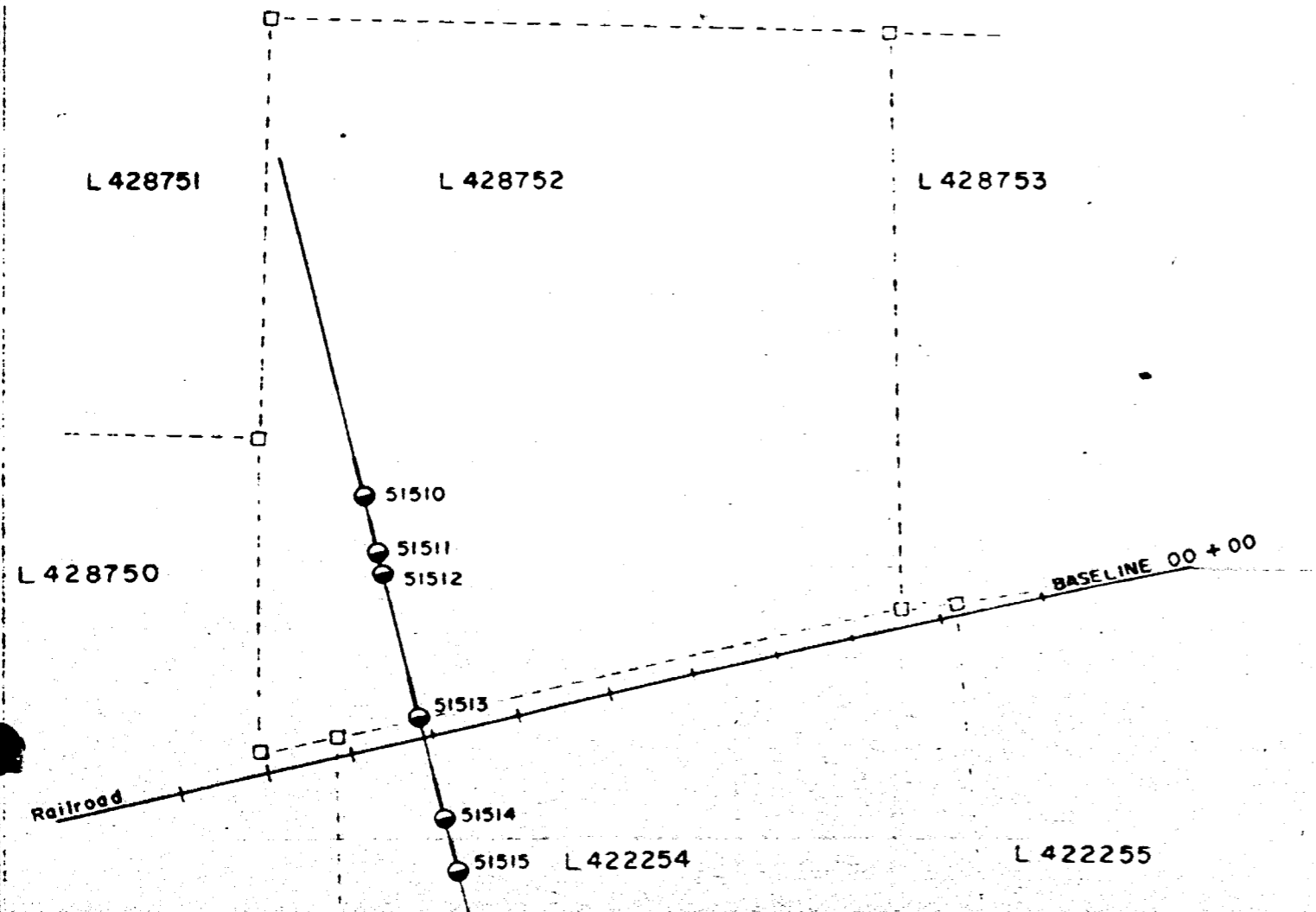

#243-75

MCGARRY TWP.

LEE GEO-INDICATORS LTD.

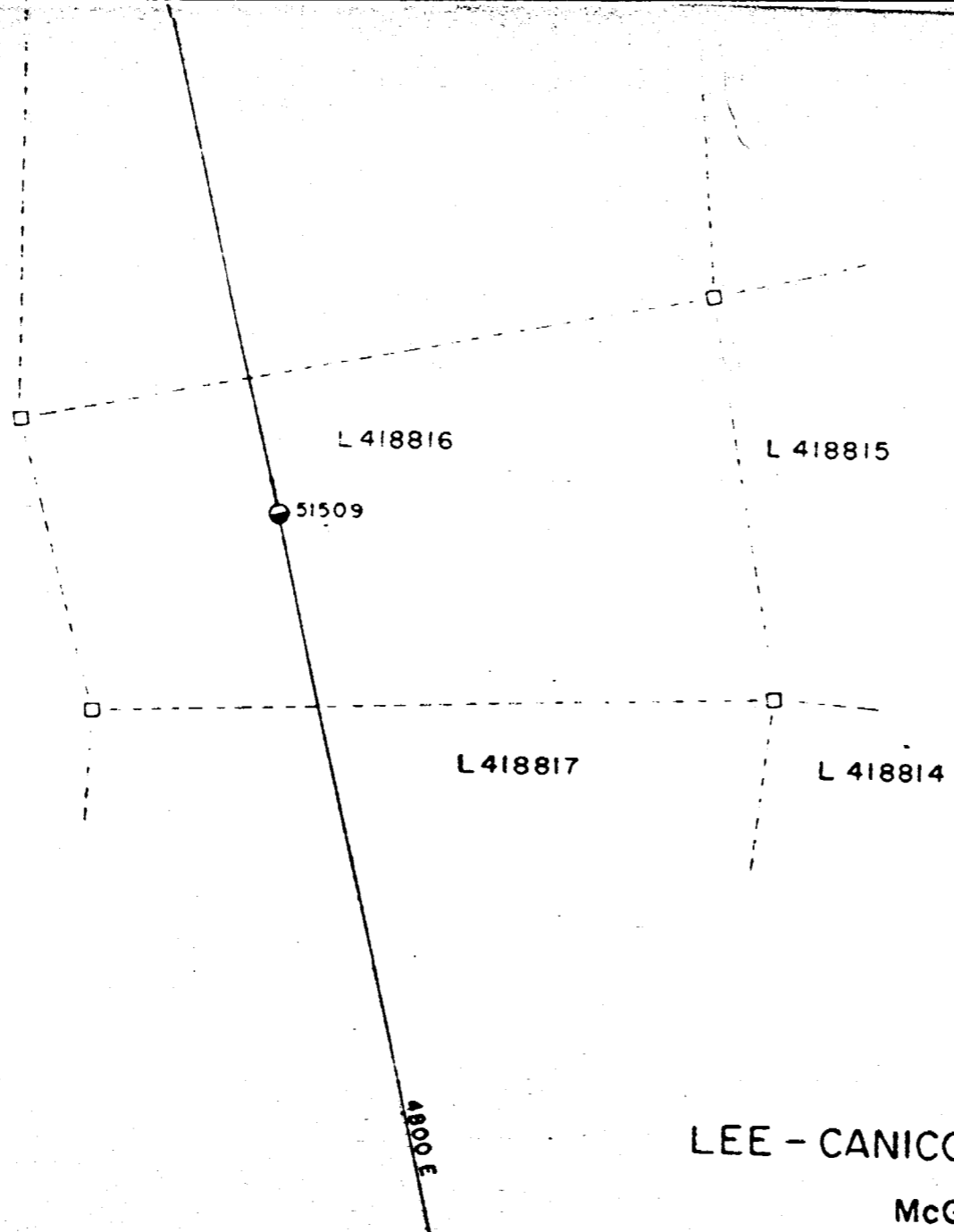

LEE - CANICO - TEXASGULF J.V.

McGARRY TWP

BOREHOLE LOCATION PLAN

Scale 1 inch = 400 feet



020

RECEIVED

3

LAND ADMINISTRATION  
SECTION

LEE - CANICO - TEXASGULF JOINT VENTURE

MCGARRY TOWNSHIP DIAMOND DRILL PROGRAM

AUGUST, SEPTEMBER, 1975



020C

TABLE OF CONTENTS

SUMMARY	1
INTRODUCTION	1
DIAMOND DRILLING	1
GEOLOGY	1
SAMPLING PROCEDURE	2
RESULTS	2
DIAMOND DRILL SUMMARY	Table I
DIAMOND DRILL LOGS FOR 51509	Appendix I
51510	
51511	
51512	
51513	
51514	
51515	
SECTION 4800E	Appendix II
BOREHOLE LOCATION PLAN	Appendix III

#### SUMMARY

Seven (7) holes were drilled during this program for a total of 1207 feet. No significant gold assays were returned.

#### INTRODUCTION

Following investigations by H. A. Lee in McGarry Twp. several basal till and biogeochemical anomalous (Au) zones were located.

A drill program laid out to test these anomalies commenced August 14 and terminated September 10, 1975, utilizing a Canadian Nickel Co. Ltd. Winkie diamond drill.

#### DIAMOND DRILLING

Seven holes were drilled on section 4800E for a combined footage of 1207 feet. Borehole 51514 failed to reach bedrock and was abandoned at 82 feet in overburden. Final depth and co-ordinates of all holes are shown in Table I. Logs for all holes are contained in Appendix I.

#### GEOLOGY

The section investigated between 600N and 17708 consists essentially of interbedded arenites (greywackes) and polymictic conglomerates intruded by feldspar porphyry sills all dipping south at 65°.

B.H. 51513 exhibited some differences in that the greywacke(?) present was sheared, contained a fair amount of chlorite and considerably more quartz veining than the other holes. The best assay value of the program was also recorded from this hole being 0.01 oz. Au/ton over 6.3 feet in feldspar porphyry at the porphyry/greywacke contact.

#### SAMPLING PROCEDURE

All core was sawn in half and sampled in lengths of about 5 feet except where quartz veining occurred. Individual quartz veins to a minimum width of about one inch were taken along with about five inches of wall rock to make up a sample about 6 inches long. This sampling procedure was carried out with the expectation that some of the biogeochemical anomalies might be accurately located.

#### RESULTS

No significant gold values were located. As noted above the best intersection was 0.01 oz. over 6.3 feet from B.H. 51513. All other samples were reported as nil with a very few having values from 0.002 to 0.005 oz's. Au/ton.

*A. Levy*



TABLE I

<u>B.H. No.</u>	<u>Co-ords.</u>	<u>Depth</u>	<u>Claim No.</u>	<u>Remarks</u>
51509	17708/4800E	172	L 418816	
51510	600N/4800E	200	L 428752	
51511	460N/4800E	198	L 428752	
51512	410N/4800E	90	L 428752	
51513	050N/4800E	250	L 428752	
51514	2008/4800E	82	L 422254	Abandoned in overburden
51515	3258/4800E	215	L 422254	

Total: 1207

All core and sample pulps are stored at Copper Cliff.

JP/nk  
September 1975

*J. Terry*

APPENDIX I

BOREHOLE# 51509-0 PROPERTY MCGARRY TWP NTS# 3204E SH# ANOM# DEPTH AZIMUTH BEARING DIP ELEVATION LATITUDE DEPARTURE  
 00172 345 00 167 00 -45 00 5001770 E004800 DATE.....  
 LOGGED BY...J PEPRY STARTED...AUG 16, 1975 COMPLETED...AUG 19, 1975 ASSAY FOR...AU

INCLINATION AND TROPIC TESTS  
 DEPTH AZIMUTH DIP DEPTH AZIMUTH DIP DEPTH AZIMUTH DIP DEPTH AZIMUTH DIP

## COMMENTS

DRLD CANICO WINKIE V SMITH ON CLAIM L418B16 400N & 500E NO 3  
 POST

## SAMPLE ENTRIES

DEPTH	LENGTH	SAMPLE#	MNZN	ROCK	DESCRIPTION	ANG	AU
0000.0	0.0				COLLAR		
0037.0	37.0				CASING		
0040.0	3.0	FX017822	MVVW	CGLM	CLOSELY PACKED SUB ROUNDED OR ROUNDED PEBBLES TO 2 INCHES MATRIX MED GRAINED HIGH PROPORTION QFP PEBBLES WITH FELSIC TO BASIC VOLC PEBBLES OCC QTZ QTE AND JASPER SCATTERED BY IN FRAGS AND MATRIX THIN CARBONATE VEINS THROUGHOUT		0.000
0045.0	5.0	FX017823	MVVW	CGL4	AS TO 40		0.000
0050.0	5.0	FX017824	MVVW	CGLM	AS TO 40		0.000
0055.0	5.0	FX017825	MVVW	CGL1	AS TO 40 WITH PEBBLES TO 4 INCHES		0.000
0060.0	5.0	FX017826	MVVW	CGLM	AS TO 40		0.000
0065.0	5.0	FX017827	MVVW	CGL4	AS TO 40		0.000
0070.0	5.0	FX017828	MVVW	CGL4	AS TO 40 WITH PEBBLES TO 3 INCHES		0.000
0075.0	5.0	FX017829	MVVW	CGLM	AS TO 40		0.000
0080.5	5.5	FX017830	MVVW	CGLM	AS TO 40		0.000
0085.0	4.5	FX017831	MVVW	ARNT	CALC & ARENITE CALC PROBABLY SECONDARY BY MG GPEY SCATT SPKS BY		0.000
0087.5	2.5	FX017832	MVVW	ARNT	AS TO 85 WITH 6 INCH CGLM SECTION AT 86 GRADED INDICATING TOPS UP HOLE		0.000
0095.0	7.5	FX017833	MVVW	FDRP	FELDSPAR PORPH Q CONTACT SHARP ABOUT 55 DEG HIGHLY ALTERED CARBONATE EOL WHITE		0.000
0100.0	5.0	FX017834	MVVW	FDRP	AS TO 95 BUT ALTERATION MORE PROFOUND CED NUMEROUS CARBONATE REFS WITH CH LORITE RIMS		0.005
0105.0	5.0	FX017835	MVVW	FDRP	AS TO 100		0.000
0110.0	5.0	FX017836	MVVW	FDRP	AS TO 95 WITH SOME EPIDOTE VEINS AND ALTERATION		0.000
0115.0	5.0	FX017837	MVVW	ARNT	AS TO 85		0.000
0120.0	5.0	FX017838	MVVW	ARNT	AS TO 85 BUT FINER GRAINED 115-118.5 55		0.000
0125.0	5.0	FX017839	MVVW	ARNT	AS TO 85		0.000
0130.0	5.0	FX017840	MVVW	ARNT	AS TO 85		0.000
0134.5	4.5	FX017841	MVVW	ARNT	AS TO 85 WITH 9 INCH CGLM SECT AT 132		0.000
0140.0	5.5	FX017842	MVVW	CGLM	SUB ANGULAR TO ROUNDED PEBBLES SMALL ER FRAGS TEND TO BE MORE ANGULAR		0.000

DEPTH	LENGTH	SAMPLE#	MNZN	ROCK	DESCRIPTION	ANG	AU
					LESS CLOSELY PACKED AND SMALLER THAN AT 40		
0145.0	5.0	FX017843	MVVW	CGLM	AS TO 140 SCATTERED SPECKS PY		0.000
0150.0	5.0	FX017844	MVVW	CGLM	CONSIDERABLY FEWER PEBBLES THAN AT 140 BUT WITH FAIRLY COARSE MATRIX	45	0.000
0155.0	5.0	FX017845	MVVW	CGLM	AS TO 150		0.000
0160.0	5.0	FX017846	MVVW	CGLM	AS TO 150		0.000
0165.0	5.0	FX017847	MVVW	CGLM	AS TO 150 PEBBLE CONTENT DECREASING		0.000
0172.0	7.0	FX017848	MVVW	ARNT	MG GREY FAIRLY MASS WITH SCATTERED SMALL PEBBLES THROUGHOUT LESS CALC THAN AT 85 FOOT OF HOLE		0.000

FOR THIS HOLE, ASSAYS OF THE FOLLOWING ELEMENTS HAVE BEEN RECEIVED..AU

BOREHOLE SUMMARY  
\*\*\*\*\*

FOOTAGE	MNZN	ROCK
0037.0		
0080.5	MVVW	CGLM
0087.5	MVVW	ARNT
0110.0	MVVW	FDPR
0134.5	MVVW	ARNT
0165.0	MVVW	CGLM
0172.0	MVVW	ARNT

*1.1-2004*

REFERENCE RECORD  
\*\*\*\*\*

CHK'D.....

BOREHOLE# PROPERTY NTS# SH# ANOM# DEPTH AZIMUTH BEARING DIP ELEVATION LATITUDE DEPARTURE  
 51510-0 MCGARRY TWP 3204E 00200 145 00 160 00 -45 00 N000600 E004800 DATE.....  
 LOGGED BY...J PEPPY STARTED...AUG 22, 1975 COMPLETED...AUG 25, 1975 ASSAY FOR...AU

INCLINATION AND APPARAT TESTS  
 DEPTH AZIMUTH DIP DEPTH AZIMUTH DIP DEPTH AZIMUTH DIP DEPTH AZIMUTH DIP

COMMENTS

DRLD CANICO WINKIE V SMITH ON CLAIM L423752 630 N 230 E OF  
 POST NO 3

SAMPLE ENTRIES

DEPTH	LENGTH	SAMPLE#	MINZ	ROCK	DESCRIPTION	ANG	AU
0000.0	0.0				COLLAP		
0004.0	4.0				CASING		
0007.0	3.0	FX017849	MVVW	ARNT	GY MG WITH SCATTERED LARGER GRAINS	80	0.002
0009.0	2.0	FX017850	MVVW	SS	TO 2MM SCATT FINE DISS PY BUFF MG WELL SORTED SCATT PY CONTACT	80	0.002
0015.0	6.0	FX017851	MVVW	FDPR	FAIRLY SHARP LOC FUCHSITE PURPLE COLOURED F TO MG WITH VARIABLE Y ALTERED FELDSPAR PHENOS FDPR BLEAC HED WITH 5MM ANKERITE VEIN AT CONTACT T LOC SECTS WITH STRONG ANKERITE STAINING 10MM QTZ ANKERITE VEIN AT 8		0.000
0020.0	5.0	FX017852	MVVW	FDPR	AS TO 15 WITH LOC HEAVY BLEACHING ALONG SMALL SLIP PLANES		0.000
0025.0	5.0	FX017853	MVVW	FDPR	AS TO 15 WITH LOC BLEACHING HEAVY FROM 23 TO 26		0.000
0030.0	5.0	FX017854	MVVW	FDPR	PURPLE COLOURED F TO MG BECOMING LESS ALTERED THAN AT 15		0.000
0035.0	5.0	FX017855	MVVW	FDPR	AS TO 30		0.000
0040.0	5.0	FX017856	MVVW	FDPR	AS TO 30		0.000
0045.0	5.0	FX017857	MVVW	FDPR	AS TO 30		0.000
0050.0	5.0	FX017858	MVVW	FDPR	AS TO 30		0.000
0055.0	5.0	FX017859	MVVW	FDPR	AS TO 30 ANKERITE STAINING 52 TO 53		0.000
0059.9	4.9	FX017860	MVVW	FDPR	AS TO 30 BLEACHED AT 59 TO CONTACT		0.000
0065.0	5.1	FX017861	MVVW	SS	MG YELLOW TO GREEN 1 FT SECTION OPEN ITE 59.9 TO 61 CLAY SEAMS OR BALLS AT 61.5 & 62 PY RIM AT 61.5	80	0.000
0070.0	5.0	FX017862	MVVW	SS	AS TO 65 1 INCH ANKERITE ALTERATION ZONES AT 66 & 66.5 CROSS REDDING AT 68 LOC CONCS PY ALONG REDDING PLANES	80	0.000
0074.8	4.8	FX017863	MVVW	SS	AS TO 65 ANKERITE ALTERATION AT 71.2 AND 74.5 NAPROW QTZ VEINS AT 73	80	0.000
0080.0	5.2	FX017864	MVVW	ARNT	ARENITE GREY MG FAIRLY MASSIVE FINE DISS PY THROUGHOUT		0.002
0085.0	5.0	FX017865	MVVW	ARNT	AS TO 80		0.000
0090.0	5.0	FX017866	MVVW	ARNT	AS TO 80		0.002
0095.0	5.0	FX017867	MVVW	ARNT	AS TO 80 COARSER GRAINED WITH CONGLO MERATE SECTION 92 TO 94	70	0.000

DEPTH	LENGTH	SAMPLE#	MNZN	ROCK	DESCRIPTION	ANG	AU
0100.0	5.0	FX017868	MVVW	ARNT	AS TO 80 LOC PERPLES	80	0.000
0102.9	2.9	FX017869	MVVW	SS	GREY TO YELLOW MG TO CG LOC PERPLES & QTZ VEINING		0.000
0103.4	0.5	FX017870	MVVW	SS	SS WITH 1 INCH QTZ VEIN & ANKERITE ALTERATION		0.000
0110.0	6.6	FX017871	MVVW	SS	AS TO 80 BECOMING DARKER & MORE ARENACEOUS	70	0.000
0115.0	5.0	FX017872	MVVW	ARNT	MG LIGHT GREY TO GREY WITH OCC CLAY SHARD OR SEAM ROCK LIGHTER COL THAN AT 80		0.002
0120.0	5.0	FX017873	MVVW	ARNT	AS TO 115	80	0.000
0125.0	5.0	FX017874	MVVW	ARNT	AS TO 115		0.000
0130.0	5.0	FX017875	MVVW	ARNT	AS TO 115		0.002
0135.0	5.0	FX017876	MVVW	ARNT	AS TO 115	80	0.000
0140.0	5.0	FX017877	MVVW	ARNT	AS TO 115		0.000
0145.0	5.0	FX017878	MVVW	ARNT	AS TO 115		0.000
0150.0	5.0	FX017879	MVVW	ARNT	AS TO 115 BECOMING DARKER COLOURED		0.000
0155.0	5.0	FX017880	MVVW	ARNT	AS TO 80	70	0.000
0159.0	4.0	FX017881	MVVW	ARNT	AS TO 80 SOMEWHAT COARSER GRAINED		0.000
0159.1	0.1	FX017882	MVVW	ARNT	AS TO 80		0.000
0159.2	0.1	FX017882	MVVW	QTZ	1 INCH QTZ VEIN		0.000
0159.5	0.3	FX017882	MVVW	CGLM			0.000
0164.5	5.0	FX017883	MVVW	CGLM	GY WITH SUB ANGULAR TO ROUND PERPLES COMMONLY LESS THAN 10MM BUT UP TO 80 MM		0.000
0170.0	5.5	FX017884	MVVW	ARNT	AS TO 80 SLIGHTLY LIGHTER & COARSER	80	0.000
0175.0	5.0	FX017885	MVVW	ARNT	AS TO 80		0.000
0180.0	5.0	FX017886	MVVW	ARNT	AS TO 80		0.000
0183.5	3.5	FX017887	MVVW	ARNT	AS TO 80 SLIGHTLY BLEACHED AT CONTACT		0.000
0183.6	0.1	FX017888	MVVW	QTZ	1 INCH QTZ VEIN WITH ANKERITE ALTERATION AT CONTACT		0.000
0184.0	0.4	FX017888	MVVW	FDPR	FG CHILLED & BLEACHED GREY-GREEN		0.000
0190.0	6.0	FX017889	MVVW	FDPR	MG PURPLE WITH FELDS & AMPHIBOLE PHENOS-NARROW QTZ VEINS THROUGHOUT LOC CARBONATE BLENDS CONTACT BLEACHED GREY-PINK TO 185 FELD PHENOS SMALLER THAN AT 15		0.000
0195.0	5.0	FX017890	MVVW	FDPR	AS TO 190		0.000
0200.0	5.0	FX017891	MVVW	FDPR	AS TO 190 FOOT OF HOLE		0.002

FOR THIS HOLE, ASSAYS OF THE FOLLOWING ELEMENTS HAVE BEEN RECEIVED...AU

BOREHOLE SUMMARY

\*\*\*\*\*

FOOTAGE	MNZN	ROCK
0004.0		
0007.0	MVVW	ARNT
0009.0	MVVW	SS
0059.9	MVVW	FDPR

0028	MVVH	SS
0100.0	MVVH	ARNT
0110.0	MVVH	SS
0150.1	MVVH	ARNT
0159.2	MVVH	QTZ
0164.5	MVVH	CGLM
0183.5	MVVH	ARNT
0183.6	MVVH	QTZ
0200.0	MVVH	FDPR

*J. Terry*

001.7	MVVW	CGLM
0086.5	MVVW	ARNT
0131.2	MVVW	FDPR
0150.0	MVVW	APNT
0168.3	MVVW	CGLM
0168.7	MVVW	QTE
0170.0	MVVW	SS
0198.0	MVVW	ARNT

*A. Terry*



BOREHOLE# 51511-0 PROPERTY MCGARRY TWP NTS# 3204E SH# ANOM# DEPTH 00198 AZIMUTH 345 00 BEARING 160 00 DIP -45 00 ELEVATION N000460 LATITUDE E004800 DEPARTURE DATE.....  
 LOGGED BY...J PERRY STARTED...AUG 26, 1975 COMPLETED...AUG 27, 1975 ASSAY FOR...AU

INCLINATION AND TROPARI TESTS  
 DEPTH AZIMUTH DIP DEPTH AZIMUTH DIP DEPTH AZIMUTH DIP DEPTH AZIMUTH DIP

COMMENTS

DRLD CANICO WINKIE VIC SMITH ON CLAIM L428752 500 N 270 E OF  
 POST NO 3

SAMPLE ENTRIES

DEPTH	LENGTH	SAMPLE#	MNZN	ROCK	DESCRIPTION	ANG	AU
0000.0	0.0				COLLAR		
0006.0	6.0				CASING		
0010.0	4.0	FX017892	MVVW	SS	MG GREY TO YELLOW FAIRLY WELL SORTED FINE BANDS PY ALONG BEDDING PLANES AT 8 SLIP PLANES WITH ANKERITE-HEMATITE ALTERATION AT 6 7 & 9 FT FINE DISS PY THROUGHOUT	65	0.000
0015.0	5.0	FX017893	MVVW	SS	AS TO 10 SLIP PLANE ALTN PARALLEL TO CORE FROM 12 TO 15 FT		0.000
0020.8	5.8	FX017894	MVVW	SS	AS TO 10 WITH STRONG ANKERITE-HEMATITE ALTERATION 15 TO 16.5		0.000
0023.5	2.7	FX017895	MVVW	SS	FG YELLOW GREEN NUMEROUS SHORT SECTIONS STAINED V FINE DISS PY	60 65	0.000
0024.0	0.5	FX017896	MVVW	SS	AS TO 23.5 WITH 2 INCH QTZ VEIN SHEAR ZONE		0.000
0029.8	5.8	FX017897	MVVW	SS	AS TO 23.5 BUT SLIGHTLY COARSER GRAINE	60 65	0.002
0035.0	5.2	FX017898	MVVW	ARNT	MG GREY COMPOSITION MUCH MORE HETEROGENIOUS THAN ABOVE FAIRLY MASS BANDING LESS ORVIOUS		0.000
0040.0	5.0	FX017899	MVVW	ARNT	AS TO 35		0.000
0045.0	5.0	FX017900	MVVW	ARNT	AS TO 35		0.000
0050.0	5.0	FX024425	MVVW	ARNT	AS TO 35		0.000
0055.0	5.0	FX024426	MVVW	ARNT	AS TO 35		0.000
0058.5	3.5	FX024427	MVVW	ARNT	AS TO 35		0.000
0062.5	4.0	FX024428	MVVW	CGLM	LIGHT GREY SS MATRIX WITH ZONES PEBBLES & CLAY SHARDS SEPICITIC FINE DISS PY		0.000
0063.5	1.0	FX024429	MVVW	CGLM	AS TO 62.5 WITH PTYGMATIC QTZ CEINS & SPCKS FUCHSITE(C) CHLORITE (O)		0.000
0067.7	4.2	FX024430	MVVW	CGLM	AS TO 62.5		0.000
0075.0	7.3	FX024431	MVVW	ARNT	GY MG TO FG FAIRLY MASS FINER GRAINE D THAN AT 35 SCATT DISS PY		0.000
0080.0	5.0	FX024432	MVVW	ARNT	AS TO 75		0.000
0086.5	6.5	FX024433	MVVW	ARNT	AS TO 75 LOC BLEACHING AT FDPR CONTACT		0.000
0088.0	1.5	FX024434	MVVW	FDPR	GY TO PALE PINK BLEACHED WITH TW) HALF INCH QTZ VEINS AT 87		0.000

DEPTH	LE. IN	SAMPLE#	MNZN	ROCK	DESCRIPTION	AVG	AU
0090.7	2.7	FX024435	MVVW	FDPR	AS TO 88		0.000
0091.2	0.5	FX024436	MVVW	FDPR	WITH HVY QTZ VEINING 50% QTZ SEPICITISED		0.000
0095.0	3.8	FX024437	MVVW	FDPR	PURPLE TO PINK FELDS PHENOS MUCH MORE OBVIOUS THAN ABOVE		0.000
0100.0	5.0	FX024438	MVVW	FDPR	AS TO 95		0.000
0105.0	5.0	FX024439	MVVW	FDPR	AS TO 95		0.000
0110.0	5.0	FX024440	MVVW	FDPR	AS TO 95		0.000
0115.0	5.0	FX024441	MVVW	FDPR	AS TO 95		0.000
0120.0	5.0	FX024442	MVVW	FDPR	AS TO 95		0.000
0125.0	5.0	FX024443	MVVW	FDPR	AS TO 95		0.000
0127.5	2.5	FX024444	MVVW	FDPR	AS TO 95		0.000
0128.5	1.0	FX024445	MVVW	FDPR	QTZ VEINED & LIGHTER COLOURED		0.000
0131.2	2.7	FX024446	MVVW	FDPR	PINK TO PALE GREY STRONGLY BLEACHED FROM 130 TO CONTACT		0.000
0135.0	3.8	FX024447	MVVW	ARNT	MG GREY MASS SCATT BY SOME BANDING RAPE PEARLE	60	0.002
0140.0	5.0	FX024448	MVVW	ARNT	AS TO 135		0.000
0145.0	5.0	FX024449	MVVW	ARNT	AS TO 135		0.000
0150.0	5.0	FX024450	MVVW	ARNT	AS TO 135 INCREASING NO OF PEARLES WITH DEPTH		0.000
0155.0	5.0	FX024451	MVVW	CGLM	GREY POLYMIC TIC PEARLES SUB-ANGULAR TO ROUNDED GRADED UP HOLE FROM 152 TO 150		0.002
0160.0	5.0	FX024452	MVVW	CGLM	MG GY AS TO 155 BUT WITH FEWER PEARL ES OCC CLAY SHARD	70	0.002
0166.0	6.0	FX024453	MVVW	CGLM	AS TO 160		0.000
0169.3	2.3	FX024454	MVVW	CGLM	LIGHTER COLOURED & MORE HOMOGENIUS THAN AT 160		0.000
0168.7	0.4	FX024454	MVVW	QTE	VERY FINE GRAINED YELLOW SHARP CONTA CTS		0.000
0170.0	1.3	FX024454	MVVW	SS	SS & ARENITE INTER BANDED GREY TO LIGHT YELLOW-GREY LOC WELL BANDED	80	0.000
0175.0	5.0	FX024455	MVVW	ARNT	GY MG MASSIVE SCATT DISS PY		0.000
0180.5	5.5	FX024456	MVVW	ARNT	AS TO 175 1/4 INCH QTZ VEIN AT 178		0.000
0181.0	0.5	FX024457	MVVW	ARNT	AS TO 175 WITH 2 INCH QTZ VEIN AND SEPICITE ALTERATION		0.000
0185.0	4.0	FX024458	MVVW	ARNT	AS TO 175		0.000
0190.0	5.0	FX024459	MVVW	ARNT	AS TO 175 CORE BROKEN 185-186		0.000
0195.0	5.0	FX024460	MVVW	ARNT	AS TO 175		0.000
0198.0	3.0	FX024461	MVVW	ARNT	AS TO 175 FOOT OF HOLE		0.000

FOR THIS HOLE, ASSAYS OF THE FOLLOWING ELEMENTS HAVE BEEN RECEIVED..AU

BOREHOLE SUMMARY

\*\*\*\*\*

FOOTAGE	MNZN	ROCK
0006.0		
0029.8	MVVW	SS
0058.5	MVVW	ARNT

BOREHOLE# 51512-0 PROPERTY MCGARRY TWP NTS# 3204E SH# ANOM# DEPTH 00090 AZIMUTH 345 00 BEARING 340 00 DIP -35 00 ELEVATION 000410 DEPARTURE 0004800  
 GRID DATE.....  
 CHECKED.....  
 LOGGED BY....J PERRY STARTED....AUG 28, 1975 COMPLETED....AUG 30, 1975 ASSAY FOR....AU

INCLINATION AND TYPARI TESTS  
 DEPTH AZIMUTH DIP DEPTH AZIMUTH DIP DEPTH AZIMUTH DIP DEPTH AZIMUTH DIP

COMMENTS

DRLD CANICO WINKIE VIC SMITH ON CLAIM L429752 440N 280E OF  
 POS NO 3

SAMPLE ENTRIES

DEPTH	LENGTH	SAMPLE#	MNZN	POCK	DESCRIPTION	ANG	AU
0000.0	0.0				COLLAR		
0009.0	9.0				CASING		
0015.0	6.0	FX024462	MVVW	SS	MG LIGHT GREY-GREEN WITH FLECKS SEPICITE OCC SEAM WITH HEMATITE AND ANKERITE ALTERATION SCATT SPECKS PY FAIRLY WELL SORTED GREEN COLOUR DUE TO CHLORITE	60	0.000
0020.0	5.0	FX024463	MVVW	SS	AS TO 15		0.000
0025.0	5.0	FX024464	MVVW	SS	AS TO 15 WITH LOC NARROW QTZ VEINS		0.000
0030.0	5.0	FX024465	MVVW	SS	AS TO 15		0.000
0032.0	2.0	FX024466	MVVW	SS	AS TO 15 WITH TWO QTZ & QTZ-ANKERITE VEINS AT 31 & 31.7		0.000
0033.7	1.7	FX024467	MVVW	SS	AS TO 15		0.000
0035.0	1.3	FX024467	MVVW	ARNT	MG GREY WITH MORE HETEROGENIOUS COMPOSITION UPPER CONTACT FAIRLY SHARP LOWER MORE GRADATIONAL		0.000
0040.0	5.0	FX024468	MVVW	ARNT	AS TO 35 2 INCH MUDST BAND AT 40.5		0.000
0043.0	3.0	FX024469	MVVW	SS	AS TO 15		0.000
0043.5	0.5	FX024470	MVVW	SS	AS TO 15 WITH 1 INCH QTZ-ANKERITE VEIN		0.000
0050.0	6.5	FX024471	MVVW	MDSN	FG PALE YELLOW-GREEN INTER BANDET WITH SS SECTIONS MUDSTONE IS WELL BANDED 75 OCC BAND PICKED OUT BY CONC OF PY ALONG BEDDING PLANE	75	0.000
0054.0	4.0	FX024472	MVVW	MDSN	AS TO 50		0.000
0060.0	6.0	FX024473	MVVW	ARNT	MG GREY TO DARK GREY GRADATIONAL CONTACT BECOMING DARKER WITH DEPTH INDICATING TOPS UP HOLE SCATT DISS PY		0.000
0065.0	5.0	FX024474	MVVW	ARNT	AS TO 60		0.000
0070.0	5.0	FX024475	MVVW	ARNT	AS TO 60		0.000
0075.0	5.0	FX024476	MVVW	ARNT	AS TO 60 WITH SOME CLAY SHARDS & CLAY BANDS (O)		0.000
0080.0	5.0	FX024477	MVVW	ARNT	AS TO 60 WITH SOME CLAY SHARDS		0.000
0085.0	5.0	FX024478	MVVW	ARNT	AS TO 60		0.002
0090.0	5.0	FX024479	MVVW	CGLM	CONGLOMERATE OR PEBBLY SS MG GREY TO YELLOW WITH LOC CONCS ANGULAR TO ROUNDED PEBBLES UP TO 10MM BUT CCMO		0.005

DEPTH LEN

SAMPLE# MNZN ROCK

DESCRIPTION  
ONLY LESS THAN 5MM FOOT OF HOLE

ANG AU

FOR THIS HOLE, ASSAYS OF THE FOLLOWING ELEMENTS HAVE BEEN RECEIVED..AU

BOREHOLE SUMMARY

\*\*\*\*\*

FOOTAGE	MNZN	ROCK
0009.0		
0033.7	MVVW	SS
0040.0	MVVW	ARNT
0043.5	MVVW	SS
0054.0	MVVW	MDSN
0085.0	MVVW	ARNT
0090.0	MVVW	CGLM

BOREHOLE# 51513-0 MCGARRY  
 PROPERTY MCGARRY  
 NTS# 32D4E  
 SHW ANOMW DEPTH AZIMUTH BEARING DIP ELEVATION LATITUDE DEPARTURE  
 00250 345 00 160 00 -50 00 N000050 E004800  
 LOGGED BY...J PERRY  
 STARTED...SEPT 01, 1975 COMPLETED...SEPT 04, 1975 ASSAY FOR...AU  
 DATE.....

INCLINATION AND PREPARI TESTS  
 DEPTH AZIMUTH DIP DEPTH AZIMUTH DIP DEPTH AZIMUTH DIP DEPTH AZIMUTH DIP

COMMENTS  
 DRLD CANICO WINKIE VIC SMITH ON CLAIM L428752 100N & 350E OF  
 NO 3 POST

SAMPLE ENTRIES									
DEPTH	LENGTH	SAMPLE#	MNZN	ROCK	DESCRIPTION	ANG	AU		
0000.0	0.0				COLLAR				
0008.0	88.0				CASING				
0089.0	1.0	FX015621	MVVW	ARNT	MG DARK GREY SCATT FINE DISS PY		0.000		
					DISSIPLY A BOULDER				
0091.0	2.0	FX015622	MVVW	GWKE	(Q)F TO MG DARK GREY TO BLACK WITH		0.000		
					WHITE QTZ-CARB SPOTS SHEARED & INCH				
					QTZ-CARB VEIN AT 90.5 SCATT SPKS PY				
					POSSIBLY A SHEARED TUFF OR VOLC				
					SINCE FAIR AMOUNT CHLORITE PRESENT				
0092.0	1.0		LC	LC	LC		N/A		
0095.0	3.0	FX015623	MVVW	GWKE	AS TO 91		0.000		
0100.0	5.0	FX015624	MVVW	GWKE	AS TO 91 WITH FAIRLY HEAVY QTZ-CARB		0.000		
					VEINING THROUGHOUT ABOUT 20% VEINING				
0103.5	3.5	FX015625	MVVW	GWKE	AS TO 100 ABOUT 15% VEINING		0.000		
0107.5	6.0	FX015626	MVVW	GWKE	AS TO 91		0.000		
0110.0	0.5	FX015627	MVVW	GWKE	WITH 2 INCH QTZ-CARB VEIN		0.000		
0111.0	1.0	FX015628	MVVW	GWKE	(Q)F TO MG DARK GREY SHEARED		0.000		
0112.0	1.0		LC	LC	LC		N/A		
0115.0	3.0	FX015628	MVVW	GWKE	AS TO 111 LOC PEBBLY SECTS		0.000		
0120.6	5.6	FX015629	MVVW	GWKE	AS TO 111 SOME COMP BANDING & LOC	70	0.000		
					PEBBLY SECTS OCC QTZ-CARB VEIN 3%				
0121.6	1.0		LC	LC	LC		N/A		
0125.0	3.4	FX015630	MVVW	GWKE	AS TO 111		0.000		
0129.0	4.0	FX015631	MVVW	GWKE	F-MG DARK GREY STRONGLY SHEARED WITH		0.000		
					FAIR AMOUNT OF CHLORITE QTZ-CARB				
					VEINS & STREAKS THROUGHOUT OCC SPFK				
					PY				
0130.4	1.4	FX015632	MVVW	QTZ	QTZ-CARB VEIN WHITE TO SLIGHTLY PINK		0.000		
0132.0	1.6	FX015633	MVVW	GWKE	AS TO 129		0.000		
0133.0	1.0		LC	LC	LC		N/A		
0135.0	2.0	FX015633	MVVW	GWKE	AS TO 129		0.000		
0138.7	3.7	FX015634	MVVW	GWKE	AS TO 129		0.000		
0140.3	1.6	FX015635	MVVW	GWKE	AS TO 129 WITH 2 INCH QTZ VEIN		0.000		
0142.0	1.7	FX015636	MVVW	GWKE	AS TO 129		0.000		
0144.2	2.2	FX015637	MVVW	GWKE	AS TO 129 WITH HEAVY QTZ VEINING 25%		0.000		
					QTZ				
0146.6	2.4	FX015638	MVVW	GWKE	AS TO 129 OCC QTZ-CARB VEIN		0.000		
0149.0	2.4	FX015639	MVVW	GWKE	AS TO 129 WITH FAIRLY HEAVY QTZ		0.000		

*J. Perry*

DEPTH	LEN	SAMPLED MNZN	ROCK	DESCRIPTION	ANG	AU
				VEINING PARTIC 147.2-147.7 ABOUT 25% QTZ		
0155.3	6.3	FX015640	MVVW GWKE	GREY TO DARK GREY SHEAPED WITH FAIR AMOUNT QTZ POSS SHEARED PEBBLES		0.000
0161.6	6.3	FX015641	MVVW FDPR	GREY TO BUFF BLEACHED TO ABOUT 10% OCC QTZ VEINS THROUGHOUT DISS PY		0.010
0162.1	0.5	FX015642	MVVW FDPR	AS TO 161.6 WITH 1 INCH QTZ CARB VEIN		0.000
0170.0	7.9	FX015643	MVVW FDPR	FG PINK TO PURPLE WITH ALTERED PHENOS & FAIR AMOUNT SERICITE DISS PY OCC SPK FUCHSITE (0)		0.000
0175.0	5.0	FX015644	MVVW FDPR	AS TO 170		0.000
0180.0	5.0	FX015645	MVVW FDPR	AS TO 170		0.002
0185.0	5.0	FX015646	MVVW FDPR	AS TO 170		0.000
0190.0	5.0	FX015647	MVVW FDPR	AS TO 170		0.000
0195.0	5.0	FX015648	MVVW FDPR	AS TO 170		0.000
0200.0	5.0	FX015649	MVVW FDPR	AS TO 170		0.000
0205.0	5.0	FX015650	MVVW FDPR	AS TO 170		0.000
0210.0	5.0	FX015651	MVVW FDPR	AS TO 170		0.000
0214.9	4.9	FX015652	MVVW FDPR	AS TO 170		0.000
0217.0	2.1	FX015653	MVVW DYKE	DIAB(?) SLIGHTLY SHEARED FG GREEN & SLIGHTLY MAGNETIC		0.000
0225.0	8.0	FX015654	MVVW FDPR	AS TO 170		0.000
0230.0	5.0	FX015655	MVVW FDPR	AS TO 170		0.000
0235.0	5.0	FX015656	MVVW FDPR	AS TO 170		0.000
0240.0	5.0	FX015657	MVVW FDPR	AS TO 170		0.000
0245.0	5.0	FX015658	MVVW FDPR	AS TO 170		0.000
0250.0	5.0	FX015659	MVVW FDPR	AS TO 170 FOOT OF HOLE		0.000

FOR THIS HOLE, ASSAYS OF THE FOLLOWING ELEMENTS HAVE BEEN RECEIVED...AU

BOREHOLE SUMMARY

\*\*\*\*\*

FOOTAGE	MNZN	ROCK
0088.0		ARNT
0089.0	MVVW	GWKE
0091.0	MVVW	LC
0092.0		LC
0111.0	MVVW	GWKE
0112.0		LC
0120.6	MVVW	GWKE
0121.6		LC
0129.0	MVVW	GWKE
0130.4	MVVW	QTZ
0132.0	MVVW	GWKE
0133.0		LC
0155.3	MVVW	GWKE
0214.9	MVVW	FDPR
0217.0	MVVW	DYKE
0250.0	MVVW	FDPR

BOREHOLE RECORD  
\*\*\*\*\*

DATE PROCESSED SEPT 7 1975

BOREHOLE#	PROPERTY	NTS#	SM#	ANOM#	DEPTH	AZIMUTH	FEARING	DIP	ELEVATION	LATITUDE	DEPARTURE	CHK'D.....
51514-0	MCGARRY	32D4E			00082	345 00	360 00	-50 00		S000200	F004800	DATE.....

LOGGED BY....J PERRY      STARTED....SEPT 04, 1975      COMPLETED....SEPT 05, 1975      ASSAY FOR....

INCLINATION AND TROPARI TESTS  
 DEPTH AZIMUTH DIP    DEPTH AZIMUTH DIP    DEPTH AZIMUTH DIP    DEPTH AZIMUTH DIP

COMMENTS

DPLD CANICO WINKIE VIC SMITH ON CLAIM L422254 200S & 240E OF  
 NO 4 POST

SAMPLE ENTRIES

DEPTH	LENGTH	SAMPLE#	MNZN	ROCK	DESCRIPTION	ANG
0000.0	0.0				COLLAR	
0082.0	82.0				CASING ABANDONED IN 08 FOOT OF HOLE	

FOR THIS HOLE, ASSAYS OF THE FOLLOWING ELEMENTS HAVE BEEN RECEIVED..THERE ARE NO ENTRIES IN THIS CATEGORY

BOREHOLE SUMMARY

\*\*\*\*\*

FOOTAGE	MNZN	ROCK
0082.0		

*J. Perry*

DEPTH	LEN	SAMPLE#	MNZN	ROCK	DESCRIPTION	ANG	AU
0165.0	5.0	FX015608	MVVW	CGLM	AS TO 155		0.000
0170.0	5.0	FX015609	MVVW	CGLM	AS TO 155 MUCH LESS PEBBLY		0.000
0175.0	5.0	FX015610	MVVW	CGLM	AS TO 155		0.000
0180.0	5.0	FX015611	MVVW	CGLM	AS TO 155		0.000
0185.0	5.0	FX015612	MVVW	CGLM	AS TO 155 WITH ARNT SECTIONS		0.000
0190.0	5.0	FX015613	MVVW	ARNT	MG DARK GREY MASS WITH LOC PEBBLY SECTIONS		0.000
0193.5	3.5	FX015614	MVVW	ARNT	AS TO 190		0.000
0197.5	4.0	FX015615	MVVW	CGLM	VERY STRONGLY SHEARED LOC SILICIFIED QTZ-CARB VEINED SCATT PY SPKS CP		0.000
0201.5	4.0	FX015616	MVVW	CGLM	DARK GREY SHEARED BUT LESS PRODUCE D THAN AT 197.5 OCC QTZ-CARB VEIN		0.000
0205.0	3.5	FX015617	MVVW	CGLM	AS TO 201.5 WITH 20MM QTZ-CARB VEIN AT 202.7		0.000
0208.3	3.3	FX015618	MVVW	ARNT	MG GREY BECOMING PINKISH AND SLIGHTLY GRANITISED WITH DEPTH RARE SPK CP		0.000
0210.5	2.2	FX015619	MVVW	ARNT	STRONGLY SHEARED DARK GREY WITH QTZ-CARB VEINING		0.000
0212.5	2.0		LC	LC	LC		N/A
0215.0	2.5	FX015620	ARNT	ARNT	(Q)VERY STRONGLY SHEARED BLOCKY QTZ-CARB VEINED SPK BORNITE FOOT OF HOLE		0.000

FOR THIS HOLE, ASSAYS OF THE FOLLOWING ELEMENTS HAVE BEEN RECEIVED..AU

BOREHOLE SUMMARY

\*\*\*\*\*

FOOTAGE	MNZN	ROCK
0015.0		
0050.0	MVVW	CGLM
0062.5	MVVW	ARNT
0087.0	MVVW	CGLM
0150.0	MVVW	ARNT
0185.0	MVVW	CGLM
0193.5	MVVW	ARNT
0205.0	MVVW	CGLM
0210.5	MVVW	ARNT
0212.5		LC
0215.0		ARNT

*f. J. every*



\*\*\*\*\*  
 BOREHOLE# PROPERTY NTS# SH# ANCH# DEPTH AZIMUTH BEARING DIP ELEVATION LATITUDE DEPARTURE CHK'D.....  
 51515-0 MCGARRY 3204E 00215 345 00 360 00 -45 00 S000325 E004800 DATE.....  
 \*\*\*\*\*  
 LOGGED BY....J PERRY STARTED....SEPT 05, 1975 COMPLETED....SEPT 09, 1975 ASSAY FOR....AU  
 \*\*\*\*\*

## INCLINATION AND TROPARI TESTS

DEPTH AZIMUTH DIP DEPTH AZIMUTH DIP DEPTH AZIMUTH DIP DEPTH AZIMUTH DIP  
 \*\*\*\*\*

## COMMENTS

DRLO CANICO WINKIE VIC SMITH ON CLAIM L422254 400S & 300E OF  
 NO 4 POST  
 \*\*\*\*\*

## SAMPLE ENTRIES

DEPTH	LENGTH	SAMPLE#	MNZN	ROCK	DESCRIPTION	ANG	AU
0000.0	0.0				COLLAR		
0015.0	15.0				CASING		
0020.0	5.0	FX024480	MVVW	CGLM	POLYMICTIC DARK GREY PEBBLES SUB ANGULAR TO ROUNDED TO 50MM MAX LOOSE PACKING OF PEBBLES CONSID MATRIX SCATT DISS PY		0.000
0025.0	5.0	FX024481	MVVW	CGL4	AS TO 20		0.000
0030.0	5.0	FX024482	MVVW	CGLM	AS TO 20 CLOSER PEBBLE PACKING		0.000
0035.0	5.0	FX024483	MVVW	CGL4	AS TO 30 PY PEBBLE AT 30.5		0.000
0040.0	5.0	FX024484	MVVW	CGLM	AS TO 30		0.000
0045.0	5.0	FX024485	MVVW	CGL4	AS TO 30		0.005
0050.0	5.0	FX024486	MVVW	CGL4	AS TO 20 5MM BAND HEAVY DISS PY AT 49.7		0.000
0055.0	5.0	FX024487	MVVW	ARNT	MG DARK GREY WITH PEBBLES SCATTERED THROUGHOUT		0.002
0062.5	7.5	FX024488	MVVW	ARNT	AS TO 55		0.000
0070.0	7.5	FX024489	MVVW	CGLM	AS TO 30		0.000
0075.0	5.0	FX024490	MVVW	CGL4	AS TO 30		0.000
0080.0	5.0	FX024491	MVVW	CGLM	AS TO 30		0.000
0085.0	5.0	FX024492	MVVW	CGLM	AS TO 30		0.000
0087.0	2.0	FX024493	MVVW	CGLM	AS TO 30		0.000
0095.0	8.0	FX024494	MVVW	ARNT	MG DARK GREY MASS OCC PEBBLE SCATT DISS PY		0.000
0100.0	5.0	FX024495	MVVW	ARNT	AS TO 95		0.000
0105.0	5.0	FX024496	MVVW	ARNT	AS TO 95		0.000
0110.0	5.0	FX024497	MVVW	ARNT	AS TO 95		0.000
0115.0	5.0	FX024498	MVVW	ARNT	AS TO 95		0.000
0120.0	5.0	FX024499	MVVW	ARNT	AS TO 95		0.002
0125.0	5.0	FX024500	MVVW	ARNT	AS TO 95		0.000
0130.0	5.0	FX015601	MVVW	ARNT	AS TO 95 LOC GRAIN SIZE VARIATION		0.000
0135.0	5.0	FX015602	MVVW	ARNT	AS TO 95		0.000
0140.0	5.0	FX015603	MVVW	ARNT	AS TO 95		0.000
0145.0	5.0	FX015604	MVVW	ARNT	AS TO 95 BECOMING FINER GRAINED		0.000
0150.0	5.0	FX015605	MVVW	ARNT	AS TO 95 FINER GRAINED		0.000
0155.0	5.0	FX015606	MVVW	CGLM	POLYMICTIC DARK GREY WITH MG MATRIX SUB-ANGULAR TO ROUNDED PEBBLES SCATT DISS PY SHARP CT WITH ARNT		0.000
0160.0	5.0	FX015607	MVVW	CGLM	AS TO 155		0.000

— T (strong)

