

2.21827

Report

On

Preliminary

Prospecting

On The

Walsh-Katrine Mine Property

For

Katrine Exploration and Development Inc.

&

CJP Exploration Inc.

Katrine Township

Larder Lake Mining Division



July 21, 2001



32D04NE2040

2.21827

OSSIAN

010

Table of Contents

Introduction.....	1
Summary.....	1
Property Location and Access.....	1
Topography and Vegetation.....	2
Description of Recent Work.....	2
Conclusions and Recommendations.....	2

Maps in Report

1	Claim Map, Katrine Twp. (M-357)	1:15,840.....	4
2	Claim 1242380	1:2000.....	5

Appendix

I	Assay Certificate.....	6
II	Persons who conducted the work.....	7



Introduction

This report is written on behalf of Katrine Exploration and Development Inc. and CJP Exploration Inc. to fulfill the assessment work requirements for the Walsh-Katrine Mine Project. This report covers the preliminary prospecting of vein #1 in June 2001 on un-patented mining claim numbered 1242380.

Summary

The Walsh- Katrine Property is located in Katrine and Ossian Townships, and consists of 2 un-patented claims totaling 7 units. The property is host to the historic Walsh-Katrine Mine that was in operation from 1920-1928. The recorded holders of this property are: Katrine Exploration and Development Inc. Box 385, 125 Thompson Blvd. Larder Lake, On, P0K 1L0 and CJP Exploration Inc. Box 140, 71 9th Ave. Larder Lake, On, P0K 1L0.

The exploration discussed in this report involves the preliminary prospecting of vein #1 to confirm historical grades. Total cost of this program was \$684.00 and includes this report.

Location and access

The Walsh-Katrine Property, is located along the Katrine and Ossian Township boundary near Mile Post 1. Claim 1242380 lies on the boundary while 1239133 is entirely within Katrine Township to the east of the Walsh-Katrine Mine shaft.

Access to the property is achieved by traveling East from the Town of Larder Lake along highway #66, to the Larder Lake Station road. From Highway #66 any vehicle can travel North about 13 km to Kinabik Creek. One would travel east up Kinabik Creek to the property. Water access is the preferred method to enter the area due to the extremely poor condition of the original access road to the north.

Topography and vegetation

The Walsh- Katrine property lies in an area with a wide variety of topographic features. Ridges rise as high as 100 feet with sharp cliffs on the west side and gentler slopes to the east. The lower area are often filled with muskeg or beaver ponds.

The area is heavily wooded, with large jack pine, spruce, tamarack and birch spread throughout the property.

Description of recent work

In June 2001 a preliminary examination of the #1 vein was made to confirm previously reported assay results. Due to the lack of exploration work in the last 40 years, the trench along vein #1 was found to be filled with debris and waste material. In order to properly sample the vein, the trench was blasted to expose fresh faces and clean out the debris. Following this, a number of samples were taken and sent to Swastika Laboratories for analysis.

Conclusions and Recommendations

The mineralization occurs in a felsic intrusive where quartz veins occupied zones of parallel fracturing. The historical data suggests the presence of at least four auriferous structures. The work done on vein #1 confirms the previously reported results to some extent. The author believes that the Walsh- Katrine property should have a full exploration program conducted in order to further re confirm some of the early data.

This program should include:

- 1) A full cut line grid should be established with a spacing of 100m and stations every 25m.
- 2) A smaller grid should be established over the mine site with a spacing of 50m and stations every 10m.
- 3) Magnetometer and VLF surveys should be carried out on the new 100m grid.

- 4) A grid should be established over the flooded area in the middle of claim 1242380, and Magnetometer/VLF surveys conducted during the winter months.
- 5) All diamond drill holes should be located and marked by GPS.
- 6) All trenches should be cleaned out and re sampled.

This proposed work program should be carried out in order to generate new targets for follow up examination.

Respectfully submitted,



David G. LaRocque

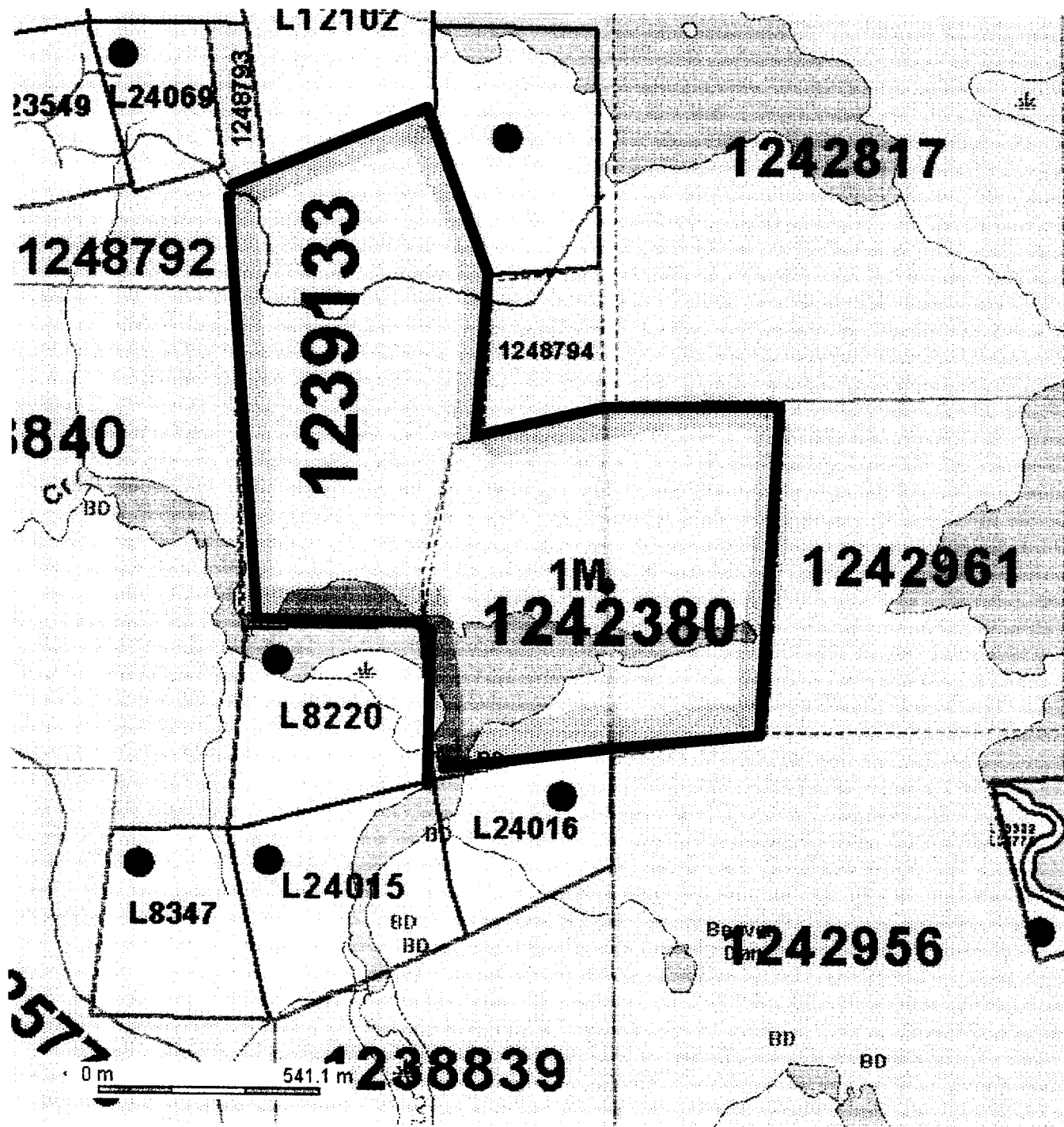

WALSH - KATRINE
Project

July 21, 2001

KATRINE & OSSIAN TWP.

- 4 -

2.21827

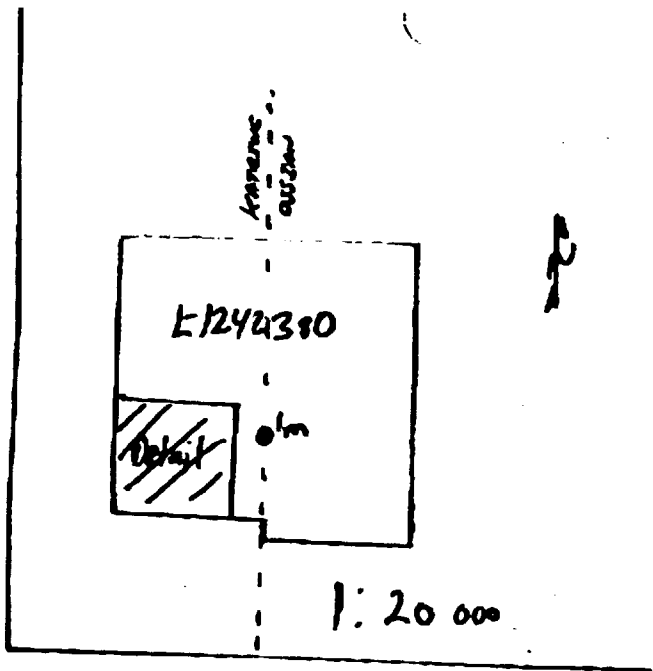

1:2500

Sketch showing
Location of #1 visit
sample.

X Sample location
 = cleared area.

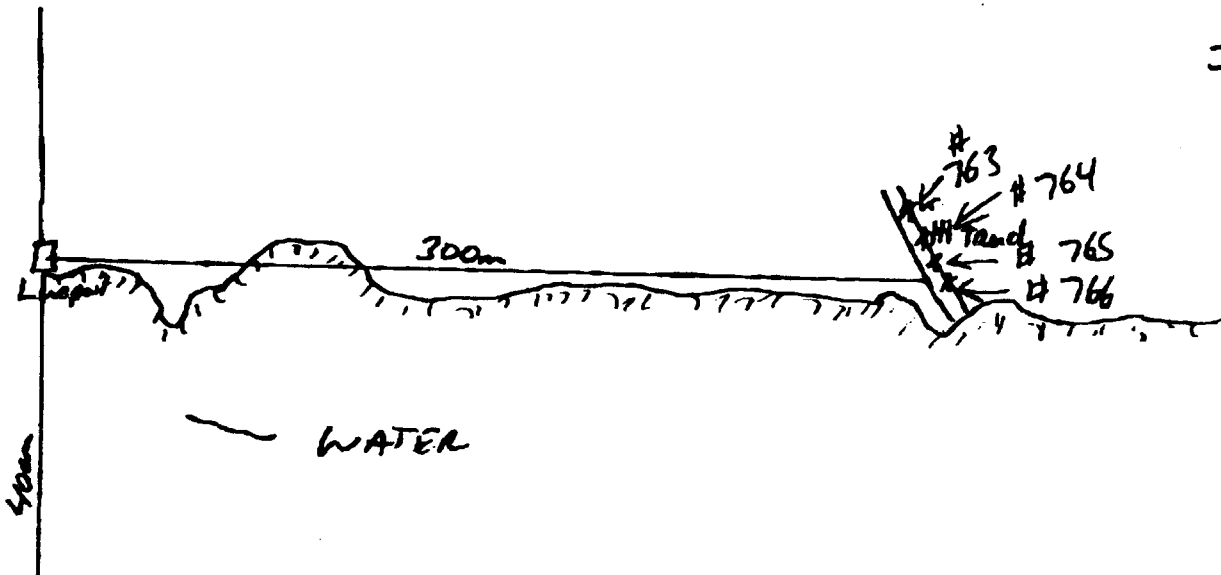

RECEIVED

NOV - 2 2001

GEOSCIENCE ASSESSMENT
OFFICE



Established 1928

Swastika Laboratories Ltd

Assaying - Consulting - Representation

Geochemical Analysis Certificate

1W-1301-RG1

Company: **KATRINE EXPLORATION & DEV.**

Project:

Date: JUN-15-01

Attn:

We hereby certify the following Geochemical Analysis of 4 rock samples submitted JUN-12-01 by .

Sample Number	Au PPB	Au Check PPB
763	1989	2091
764	2606	2537
765	740	-
766	1020	-

One assay ton used.

-6+

Certified by

Appendix II

Persons who carried out the work and the dates:

J. Ploeger Larder Lake, On June 12, 2001

D. LaRocque Larder Lake, On June 12, 2001

Report:

D. LaRocque Larder Lake, On July 21, 2001

Date: 2001-NOV-13

GEOSCIENCE ASSESSMENT OFFICE
933 RAMSEY LAKE ROAD, 6th FLOOR
SUDBURY, ONTARIO
P3E 6B5

KATRINE EXPLORATION AND DEVELOPMENT INC
BOX 385, 125 THOMPSON BLVD.
LARDER LAKE, ONTARIO
P0K 1L0 CANADA

Tel: (888) 415-9845
Fax: (877) 670-1555

Submission Number: 2.21827
Transaction Number(s): W0180.30498

Dear Sir or Madam

Subject: Approval of Assessment Work

We have approved your Assessment Work Submission with the above noted Transaction Number(s). The attached Work Report Summary indicates the results of the approval.

At the discretion of the Ministry, the assessment work performed on the mining lands noted in this work report may be subject to inspection and/or investigation at any time.

The revisions outlined in the Notice dated September 19, 2001 have been corrected. Accordingly, assessment work credit has been approved as outlined on the Declaration of Assessment Work Form that accompanied this submission.

If you have any question regarding this correspondence, please contact BRUCE GATES by email at bruce.gates@ndm.gov.on.ca or by phone at (705) 670-5856.

Yours Sincerely,



Ron Gashinski
Supervisor, Geoscience Assessment Office

Cc: Resident Geologist

Katrine Exploration And Development Inc
(Claim Holder)

Cjp Exploration Inc.
(Claim Holder)

Assessment File Library

Katrine Exploration And Development Inc
(Assessment Office)

