



32D04NW0066 2.13841 GAUTHIER

010

2.13841

Report on A Stripping, Sampling
and Geological Mapping Program,
Jascan Claims
Gauthier Township, Larder Lake
Mining Division

RECEIVED

JAN 14 1991

MINING LANDS SECTION

December 1990,
W. J. McGuinty
B. Leonard



32D04NW0066 2.13841 GAUTHIER

010C

Table of Contents

| | Page |
|--|------|
| 1.0 Introduction | 6 |
| 2.0 Property, Description, Location and Access | 7 |
| 3.0 Previous exploration of the property | 7 |
| 4.0 Regional Geology | 11 |
| 5.0 Current Exploration Program | 14 |
| 6.0 Geology and Geochemistry of stripped area | 15 |
| 7.0 Mineralization | 17 |
| 8.0 Conclusions and Recommendations | 17 |
| References | 20 |
| Statement of Qualifications: Leonard | 21 |
| McGuinty | 22 |

List of Figures

Figure 1 Property Location Map
Figure 2 Claim Disposition Map
Figure 3 Regional Geology Map
Figure 4 Stripping Plan
Figure 5 Jensen AFM Plot

List of Mapes

Back Pocket

Geology of Stripped Area
Map 1 (Scale 1"--20 Feet)

Appendix

Gold Assay & Whole Rock Certificates
Geochemical Analysis Invoices

1.0 Introduction

Queenston Mining Inc. is the owner of three (3) unpatented claims located in Gauthier township, Larder Lake Mining Division. These claims were acquired from Jascan Resources Inc. in October 1989. Queenston is actively involved in mineral exploration on several contiguous packages of ground, notably the Upper Canada Mine. As part of an ongoing exploration program to evaluate the extension of the Upper Canada Shear Zone, Queenston has begun evaluation of the Jascan group.

2.0 Property Description Location and Access

The Jascan property consists of 3 contiguous unpatented mining claims; L949740, L949781 and L949827. These claims are located in the township of Gauthier, Larder Lake Mining Division. Queenston holds an 100% interest in the group.

The property can be reached by travelling east from Kirkland Lake on highway 66 for 16 kilometers to the village of Dobie then for 3 kilometers northeasterly along the Beaverhouse Lake access road. The Beaverhouse road traverses all three Jascan claims.

The northerly portion of claims L949740 and L949827 are occupied by Little Larder Lake which contains tailings from the Upper Canada Mine. The remainder of the three claims is punctuated by low hills with mixed forest cover.

3.0 Previous Exploration of the Property

The property was originally mapped in 1938 by J. Thomson for the Ontario Department of Mines. At that time the claims were held under patent numbers L9911 (949740), L9912 (949781) and L39966 (949827). One pit was noted on claim L949827 and at that time, others of the same age have been seen in the field. These claims subsequently lapsed. Little evidence of work can be seen in the field to indicate exploration activity between 1938 and 1986.

1986 - Maree Investment Corporation

Maree Investment Corporation conducted a mine

hole drilling program on that portion of the Upper Canada Mines Tailings located within the boundaries of the Jascan group. Drilling delineated a mineral inventory of 472,000 tons of tailings grading 0.018 ounces/ton in a thin layer from 0 to 14 feet in thickness

1987 - Jascan Resources Inc.

Jascan performed ground magnetic and VLF-EM surveys on the claims in 1987. A baseline trending 135 degrees astronomic with north easterly trending grid lines on 200 foot intervals was cut for the surveys.

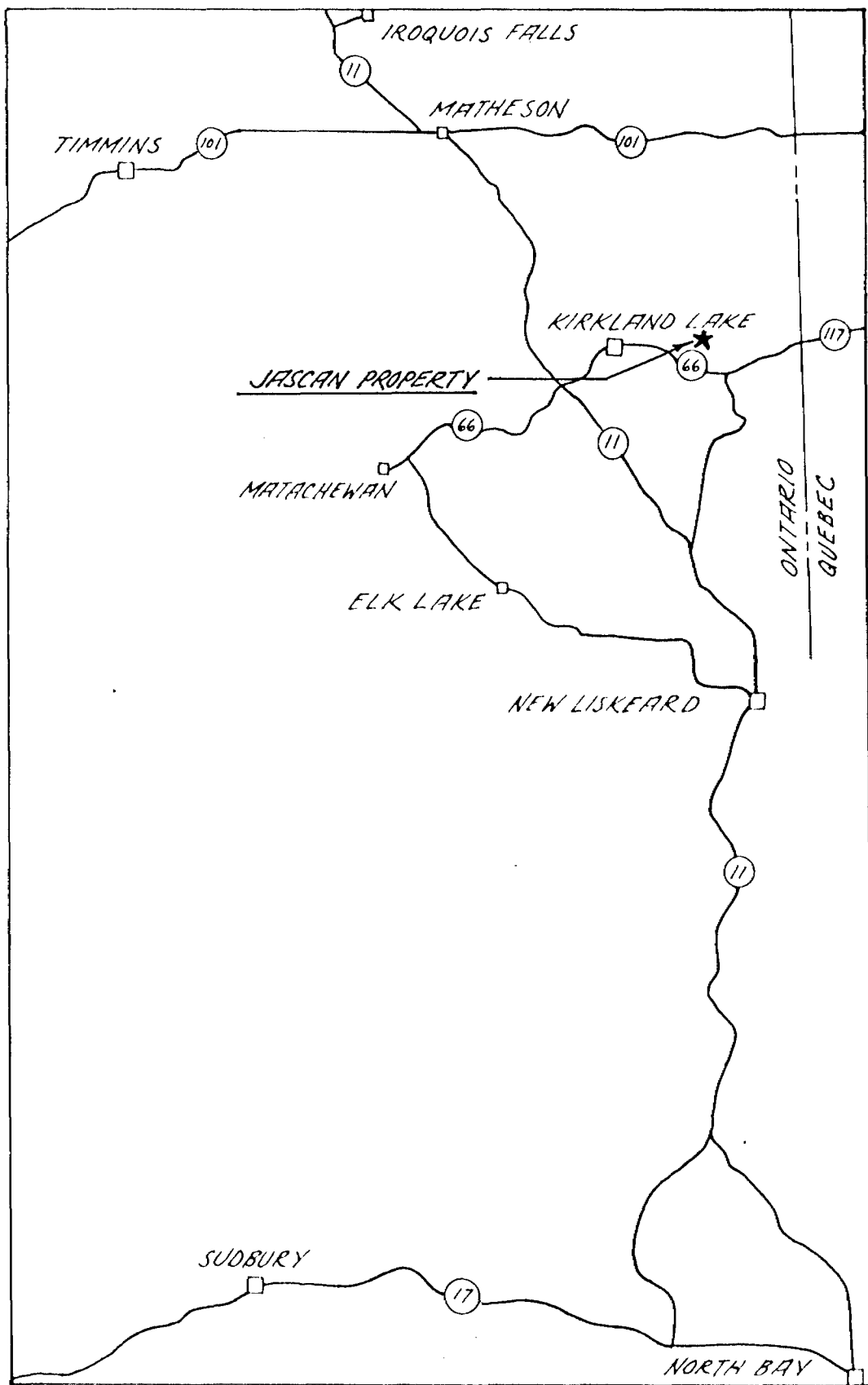

QUEENSTON MINING INC.
 JASCAN PROPERTY
 GAUTHIER TWP.
 PROPERTY LOCATION MAP
 SCALE 1" = 20 Mi. JAN./91

FIG. 1

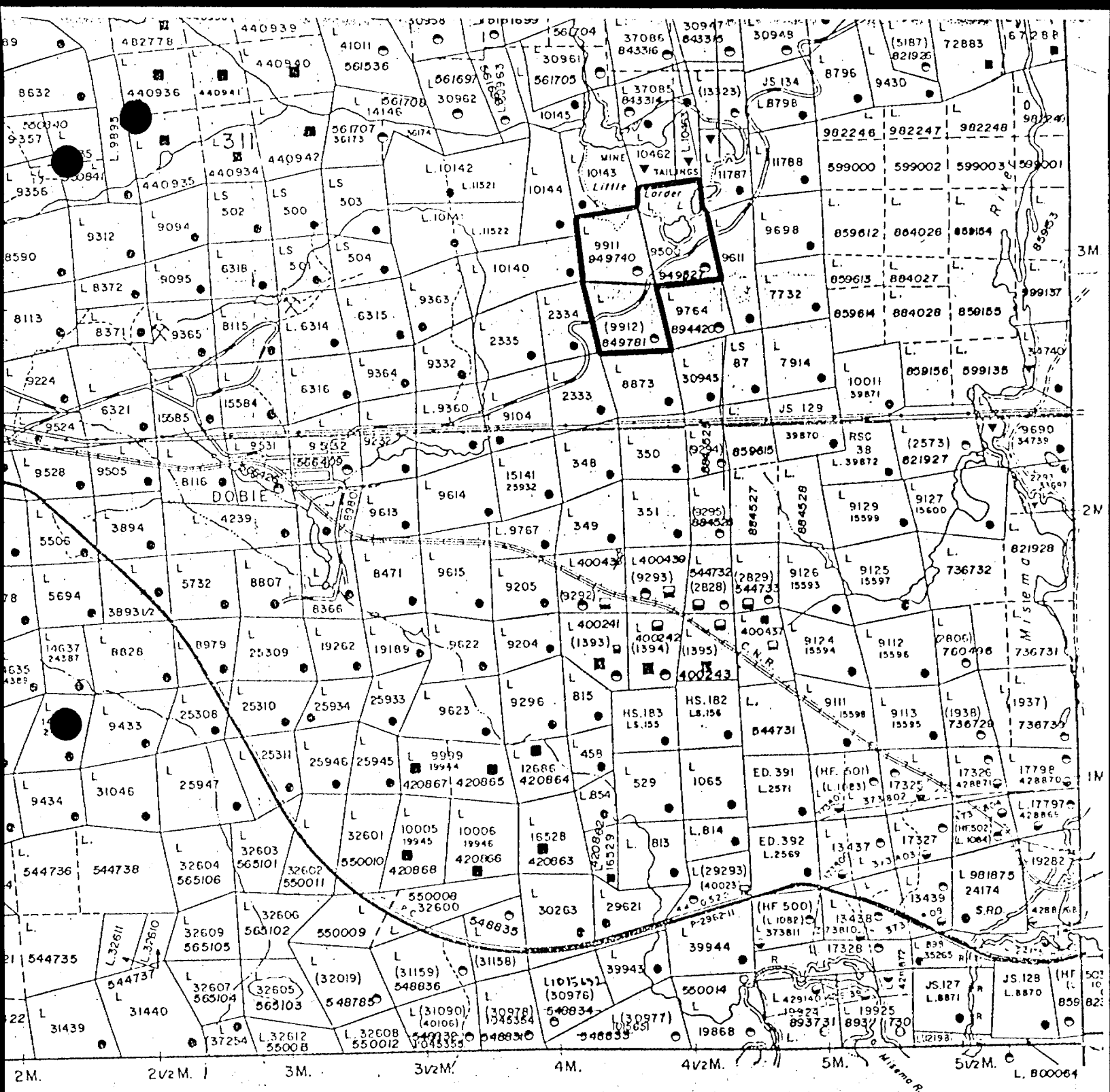

QUEENSTON MINING INC.
 JASCAN PROPERTY
 GAUTHIER TWP.
 CLAIM DISPOSITION MAP
 SCALE - 1" = 2640' JAN./91

4.0 Regional Geology

Gauthier township is situated in the southern part of the Archean aged (2.7 b.y.) Abitibi Subprovince. Volcanic rock of the belt consists of komatiitic, tholeiitic, alkalic lavas and associated interflow sediments. These volcanic sequences have been intruded by plutonic rocks of felsic composition. In Gauthier township specifically, Thomson identified two distinct assemblages; Keewatin age mafic to intermediate volcanics form the local basal series called the Kinojevis Group, enclosing a narrow basinal sequence of alkalic volcanics clastic sediments and syenitic intrusives known as the Timiskaming Group. The latter series of rocks hosts the Kirkland Lake Main Break and the Upper Canada shear from which a total of approximately 27 million ounces of gold has been produced. In Gauthier township the Timiskaming Group is roughly 3.7 kilometers thick and has a gross trend of approximately 100 degrees east. The northern boundary of this group is believed to be faulted although few localities are known where the contact is visible. The southern boundary is defined by the Larder Lake Break, a significant structure trending easterly over a distance of 250km. Thomson subdivides the Timiskaming series in Gauthier township into 4 sub groups. In order of abundance these are: A) Conglomerate, B) Greywackes and arkoses, C) Basic volcanics D) Syenite to gabbroic intrusive. Latterly, many of these rocks have been further subdivided and classified as trachytic (syenitic) in composition.

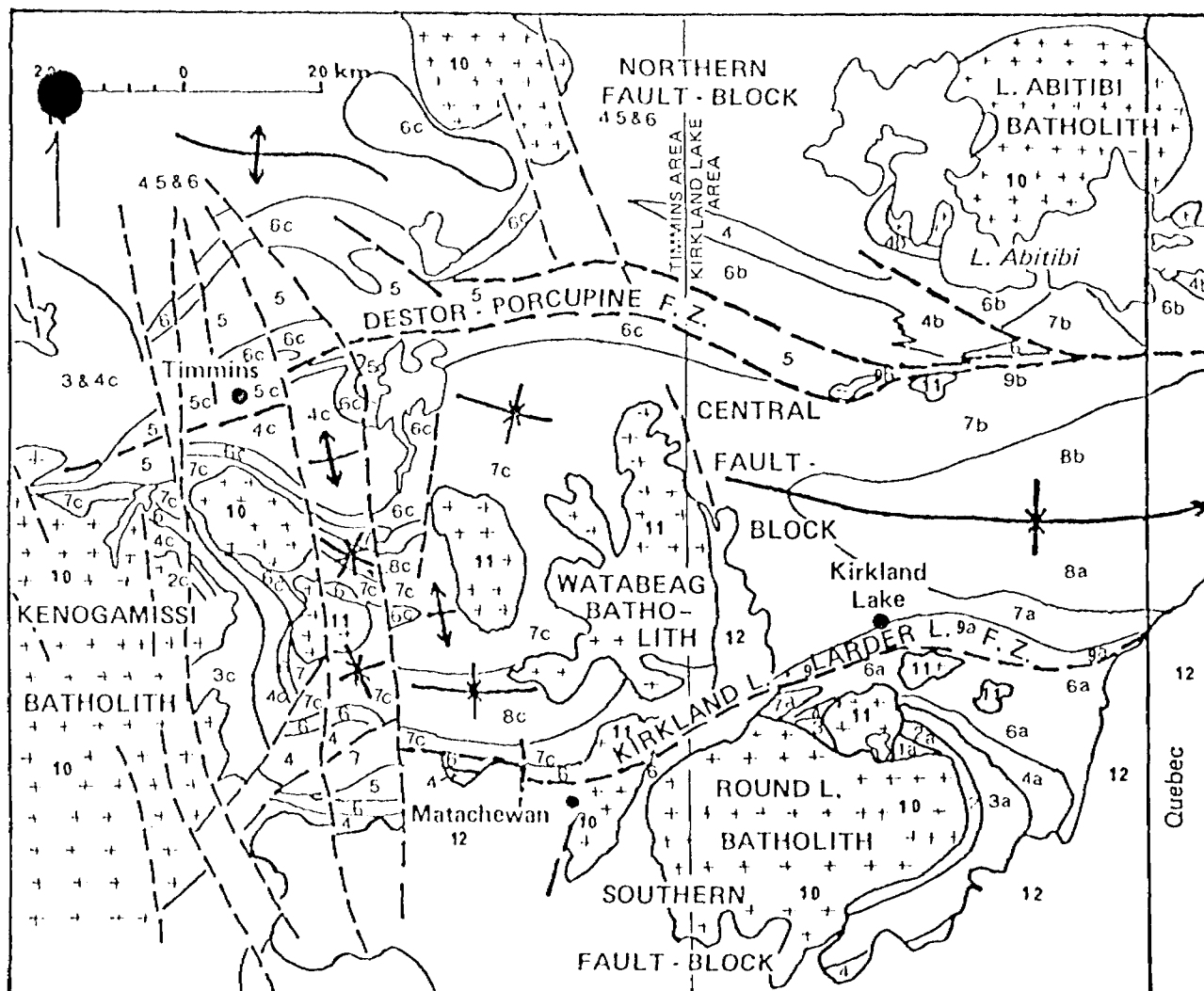

LEGEND

Proterozoic

- Keeweenawan diabase (not shown)
- 12 Cobalt Group

Archean

- Matachewan diabase (not shown)

Granitic rocks

- 11 Granodiorite, monzonite, quartz monzonite, syenite
- 10 Massive to gneissic quartz diorite, tonalite, trondhjemite

Upper Supergroup

- 9 9a* Timiskaming Group, 9b** Destor - Porcupine Complex
- 8 8a, 8b, Blake River Group, 8c*** Blake River (Upper Fm., Tisdale Group)

- 7 7a, 7b, Kinojevis Group, 7c Kinojevis Group, (Middle Fm., Tisdale Group)
- 6 6a Larder Lake Group, 6b Stoughton-Roquemaure Group, 6c Lower Fm., Tisdale Group
- 5 5c Porcupine Group

Lower Supergroups

- 4 4a Skead Group, 4b Hunter Mine Group, 4c Upper Fm., Deloro Group
- 3 3a Catherine Group, 3c Middle Fm., Deloro Group
- 2 2a Wabewawa Group, 2c Lower Fm., Deloro Group
- 1 1a Pacaud tuffs ****

*a refers to Kirkland Lake Area, south limb of synclinorium (Jensen 1978c, 1979).
 **b refers to Kirkland Lake Area, north limb of synclinorium (Jensen 1976, 1978b).
 ***c refers to Timmins Area (Pyke 1980)
 **** (Goodwin 1965).

REGIONAL GEOLOGY
 AFTER
 JENSEN & LANGFORD

The Jascan group straddles the northerly Timiskaming-Kinojevis contact, which appears to trend southeasterly through claim L949740 intersecting the southwestern corner of claim L949827. Exposure in claim L949781 and western L949740 are identified by Thomson as Timiskaming group rocks. The rock underlying claim L949827 is identified as acid fragmental lava, agglomerate and tuff by the same author.

The most significant structural feature in the vicinity of the Jascan claims is the Upper Canada shear. This shear hosts the Upper Canada mine which produced 1.5 million ounces of gold. Two notable possibilities for the extension of this structure are under evaluation by Queenston Mining Inc. O. D. M. map 50c describes a broad flexure in the strata hosting the Upper Canada shear. Should this structure be an early even in the Timiskaming the trace of the mineralized horizon rotates through nearly 60 degrees to from 060-070 degrees at the Upper Canada to roughly 135 degrees at a distance of 1km to the east. Should this structure be a late event the projection of the Upper Canada shear would traverse the Jascan claims. This possibility is further supported by a magnetometer survey conducted in 1988 on the Upper Canada property by Inco Limited. The magnetic signature of the underlying rocks indicate a persistent extension of lithologies from the mine site eastwards.

5.0 Current Exploration Program

Two days of mechanical stripping was carried out in 2 separate areas on the eastern portion of claim L949827 from June 20 to 21, 1990 by Alex McIntyre Limited using a John Deere 792 backhoe with a one cubic yard bucket. The areas were mapped and sampled on October 23, 24 and November 9, 1990. The following is a list of personnel, days and activities on the property:

| | | |
|----------------|-------------------------------------|--|
| Bill McGuinty | June 19, 20, 21 November 9, 1990 | Stripping supervision Geological mapping, sampling, report writing |
| Brad Leonard | Oct 23, 24 | Geological mapping, sampling, report writing |
| Paul Alexander | July 4, 5, 6 & 9 | Hydraulic stripping |
| Todd Morgan | June 19 & 20 July 4, 5, 6, & 9 | Hydraulic stripping |

29 samples were collected and sent to Swastika Labs in Swastika, Ontario for analysis of gold only. An additional 3 samples were sent to Swastika Labs for Whole Rock analysis. Results are appended to this report.

6.0 Geology and Geochemistry of stripped area

Both stripped areas are underlain by a dark green to pink-green mafic tuff, with numerous sub-angular to subrounded fragments up to 1cm in size, but more commonly 1-3mm in size. The rock appears as a massive, hard (silicified) chloritic fragmental unit, with moderate pervasive carbonate and hematite alteration. There is generally trace disseminated pyrite and minor specular hematite stringers.

Both areas also have a major joint set trending approximately 080 degrees and steep to vertical dips. A second joint set trends roughly north northwest with steep to vertical dips, and in some cases, displaces the main 080 degrees trend in both right and left handed motion up to a few centimeters.

Samples taken for whole rock geochemistry from both stripped areas range in silica compositions from 54 to 56% SiO₂, have iron contents that range from 6 to just over 9% Fe₂O₃, magnesium contents that range from less than 2.5% to more than 5% MgO and titanium contents that range from less than 0.5% and more than 0.85% TiO₂. When these values are plotted on a Jensen AFM diagram, they plot in the tholeiitic field between dacites and andesites (see accompanying AFM plot).

LITTLE LARDER
LAKE

TAILINGS

U.B
HYDRO
LINE

GULLY

TAILINGS

Derelict
cabin

Slash & o/b
pile

Spruce,
poplar, birch
forest

STRIPPED
AREA

Moss
covered
outcrop
Hilltop

skid trail

skid trail

Island

Lake

Ridge line

Spruce, alder
swamp

skid trail

EXISTING
TRAIL

CLAIM LINE

Marsh

STRIPPED
AREA

LINE 2E
9N

UPPER BEAVER ROAD

QUEENSTON MINING INC
JASCAN PROPERTY
STRIPPING PLAN
SCALE - 1"=100'

CP # 2
949827

FIG. 4

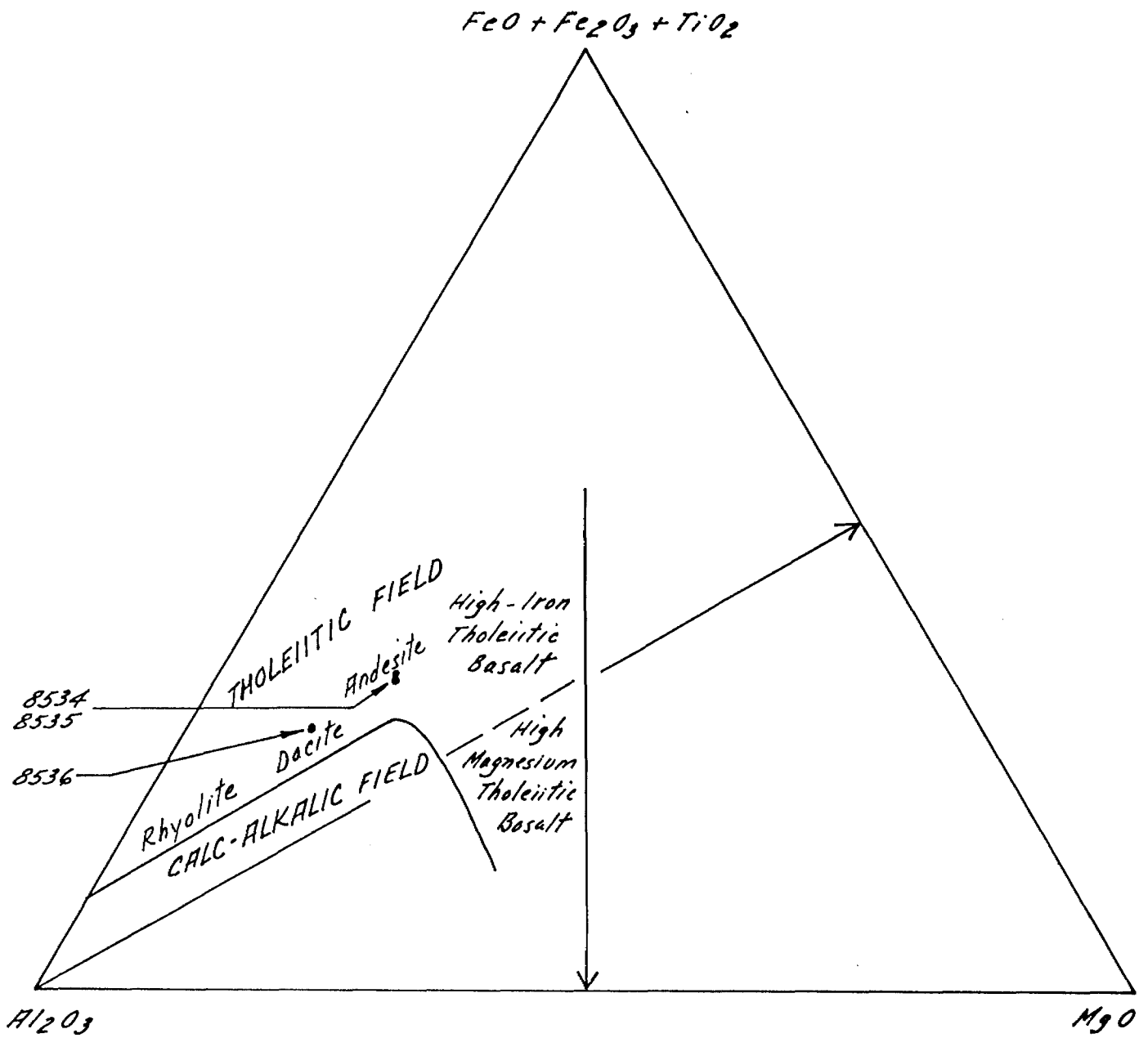

QUEENSTON MINING INC.
 JASCAN PROPERTY
 GAUTHIER TWP.
 JENSEN AFM PLOT

FIG. 5

7.0 Mineralization

Mineralization in the mafic tuffs is confined to trace to 1% fine disseminated pyrite.

In the southern portion of the stripped area, there are numerous narrow quartz veins and veinlets up to 5cm thick, mostly trending roughly 080 degrees along the main joint set. The quartz is massive and white with traces of fine pyrite and no anomalous gold values. An area of quartz stockwork is present in the southern part of the stripped area (see map in back pocket) with 1-2% specular hematite and 1-2% fine disseminated pyrite. There is one anomalous gold value of 1310 ppb.

In the south stripped area, numerous quartz veins and veinlets also occupy approximately the 080 degree joint set. There are almost an equal number of quartz veins following the north north-west joint set. Most quartz veins are several centimeters thick, with trace to 2% specular hematite and 1-2% fine disseminated pyrite. There is one anomalous gold value of 540 ppb associated with a north north-west trending, flat lying quartz vein in the central part of the stripped area.

8.0 Conclusions and Recommendations

The 3 claims Jascan property is underlain regionally Keewatin by acid fragmental agglomerates and tuffs. Two days of mechanical stripping, geological mapping and sampling were

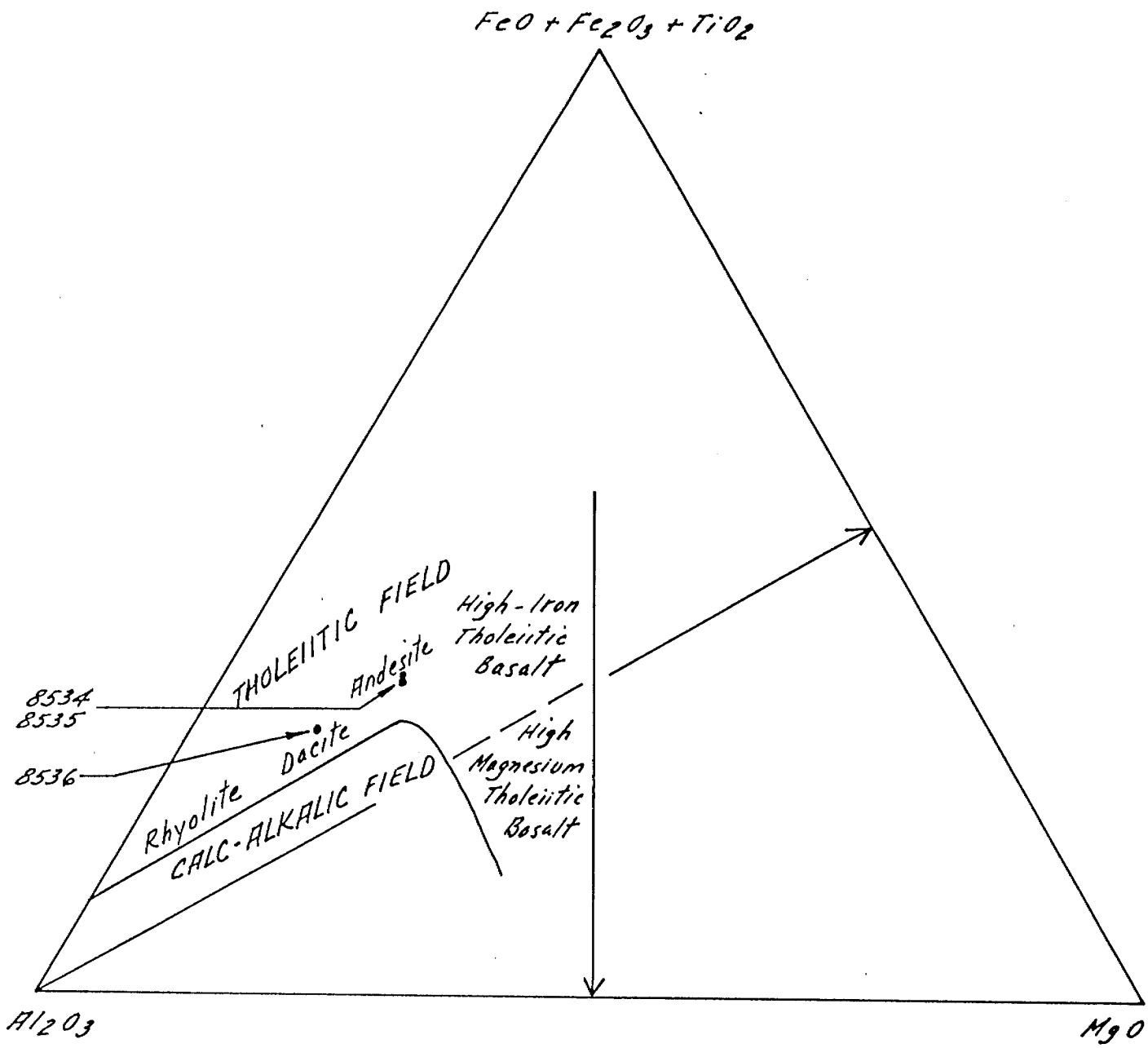

QUEENSTON MINING INC.
 JASCAN PROPERTY
 GAUTHIER TWP.
 JENSEN AFM PLOT

FIG. 5

perform on 2 areas on claim 949827 between mid June and mid November 1990 in order to locate a possible strike extension of the Upper Canada shear zone. Local geology is mapped as silicified mafic tuffs with numerous sub-angular to subrounded fragments up to 1cm in size. Whole rock analysis of the local geology reveals the exposed areas are underlain by silicified tholeiitic andesites to dacites with low TiO₂. The low TiO₂ values are probably the result of some subtle alteration feature not identified in mapping. Two anomalous gold values of 1310 and 540ppb were found from sampling.

No significant mineralization or structural indication of an extension of the Upper Canada shear was uncovered during the mechanical stripping program.

Due to the lack of encouraging results, no further work is recommenced at this time.

December 1990

W. J. McGuinty

Bradley Leonard
Bradley Leonard

Qual This report

References

- Thompson, J. E. & Griffis, A. T. Geology of Gauthier township, east
of Kirkland Lake Area. Ontario
Department of Mines Vol L part VIII,
1941 with accompanying map 50c, Township
of Gauthier.

CERTIFICATE OF QUALIFICATIONS

I, William John McGuinty of 61 McCamus Street, in the town of Kirkland Lake in the Province of Ontario,

Do hereby certify:

1. That I am a graduate of the University of Ottawa (1983) with a degree of Bachelor of Science (B Sc.) with Honours in Geology.
2. That I have been practicing my profession as a Geologist and been engaged in mineral exploration since 1981.
3. That this report is based on visits to the property.
4. That I have disclosed in this report all relevant material which to the best of my knowledge might have a bearing on the viability or recommendations to the project.
5. That I do not have, nor do I expect to receive, directly or indirectly any interest in the property reported on herein.
6. That I am exploration manager for Queenston Mining Inc.

December, 1990

W. J. McGuinty,
Kirkland Lake,
Ontario

CERTIFICATE OF QUALIFICATIONS

I, Bradley C. Leonard of 2081 Sunnyside Road in the
City of Sudbury, in the Province of Ontario

Do Hereby Certify that:

- 1) I am a graduate of the University of Toronto (1983) with a bachelor of Science degree (B.Sc.) with honours in geological sciences.
- 2) I have been practicing my profession as a geologist since 1983, and a consultant since 1988.
- 3) I have no interest, directly or indirectly in the property, of Queenston Mining Inc., nor do I expect to acquire any interest, directly or indirectly in either of the aforementioned company, or the property.
- 4) This report was prepared by me using government maps and reports; miscellaneous data on file in the files of the resident geologist, Ministry of Northern Development and Mines, Kirkland Lake, Ontario; and field visits to the property.

December 1990

Bradley C. Leonard B.Sc.
Consulting Geologist
Kirkland Lake, Ontario



Established 1928

Swastika Laboratories

A Division of Assayers Corporation Ltd.

Assaying - Consulting - Representation

Geochemical Analysis Certificate

0W-1760-RG1

Company: **QUEENSTON MINING INC.**

Date: NOV-13-90

Project:

Copy 1. BOX 193, KIRKLAND LAKE P2N 3H7

Attn: **B. McQUINTY**

2. FAX TO 567-7002

We hereby certify the following Geochemical Analysis of 12 ROCK samples submitted NOV-12-90 by B. McQUINTY.

Jasca

| Sample Number | Au ppb |
|---------------|--------|
| 8525 | 79 |
| 8526 | 91 |
| 8527 | 10 |
| 8528 | 21 |
| 8529 | 31 |
| 8530 | 17 |
| 8531 | 58/65 |
| 8532 | 51 |
| 8533 | 10 |
| 8534 | 34/24 |
| 8535 | 58 |
| 8536 | 21 |

Whole Rock Analysis results to follow

Certified by Donna Hartman



Swastika Laboratories

77

A Division of Assayers Corporation Ltd.

Assaying - Consulting - Representation

Established 1928

Geochemical Analysis Certificate

Company: **QUEENSTON MINING INC.**
Project: **DUFFET**
Attn: **W. McGuinty**

RECEIVED
JUL - 4 1990
QUEENSTON

0W-0894-RG1

Date: JUL-03-90

Copy to: Box 193, Kirkland Lake, Ont P2N 3H7
2. fax to 567-7002

We hereby certify the following Geochemical Analysis of 9 ROCK samples submitted JUN-28-90 by W. McGuinty.

| Sample Number | Au ppb | Au check ppb |
|---------------|--------|--------------|
| 28044 | 14 | |
| 28045 | 7 | |
| 28046 | 7 | |
| 28047 | 586 | 494 |
| 28048 | 7 | |
| 28049 | 75 | |
| 28050 | 1111 | 1509 |
| 72226 | Nil | |
| 72227 | Nil | |

Certified by 
G. Lebel / Manager



Established 1928

Swastika Laboratories

A Division of Assayers Corporation Ltd.

Assaying - Consulting - Representation

Geochemical Analysis Certificate

0W-1698-RG1

Company: QUEENSTON MINING INC.

Date: NOV-06-90

Project:

Copy 1. BOX 193, KIRKLAND LAKE P2N 3H7

Attn: BILL MCGUINTY

2. FAX TO 567-7002

We hereby certify the following Geochemical Analysis of 11 ROCK samples submitted NOV-01-90 by BILL MCGUINTY.

| Sample Number | Au ppb |
|---------------|--------|
| 8516 | 103 |
| ↓ 125066 | Nil |
| 125067 | Nil |
| 125068 | Nil |
| 125069 | Nil |
| 125070 | 17 |
| 125071 | Nil |
| 125072 | 10/27 |
| ● 125073 | 17 |
| 125074 | Nil |
| ↑ 125075 | Nil |

Certified by Deanna Gardner

SWASTIKA LABORATORIES

P.O. BOX 10, SWASTIKA, ONTARIO

TELEPHONE #: (705) - 642 - 3244

FAX #: (705) - 642 - 3300

I.C.A.P. WHOLE ROCK ANALYSIS

Lithium MetaBorate Fusion

SWASTIKA LABS
SWASTIKA ONT.

QUEENSTON MINING INC

T.S.L. REPORT No. : M - 8492 - 1

T.S.L. File No. : HQ207A

T.S.L. Invoice No. :

YOUR REFERENCE - DW-1760-F61

| SAMPLE # | SiO2 % | Al2O3 % | Fe2O3 % | CaO % | MgO % | Na2O % | F2O % | TiO2 % | MnO % | P2O5 % | LOI % | TOTAL % |
|----------|-----------|------------|------------|----------|----------|-----------|----------|-----------|----------|-----------|----------|------------|
| 8534 | 54.72 | 14.72 | 8.92 | 4.32 | 4.93 | 3.35 | 2.88 | 0.81 | 0.11 | 0.38 | 5.59 | 100.73 |
| 8535 | 54.20 | 14.86 | 9.19 | 6.29 | 4.95 | 3.43 | 3.46 | 0.70 | 0.15 | 0.36 | 1.84 | 99.13 |
| 8536 | 56.06 | 14.65 | 6.09 | 5.05 | 2.71 | 1.48 | 4.68 | 0.54 | 0.15 | 0.34 | 8.14 | 99.89 |

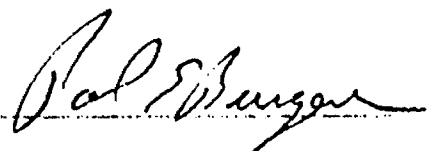

SWASTIKA LABORATORIES

P.O. BOX 19, SWASTIKA, ONTARIO

TELEPHONE #: (705) - 642 - 3211

FAX #: (705) - 642 - 3309

I.C.A.P. WHOLE ROCK

LITHIUM METABORATE FUSION

SWASTIKA LABS

SWASTIKA ONT.

T.S.L. REPORT No. : M - 8492 - 1

T.S.L. File No. : NO20RA

T.S.L. Invoice No. :

LAB REFERENCE - OW-1760-R61

ALL RESULTS FFM

| SAMPLE # | Ba ppm | Sr ppm | Zr ppm | Y ppm | Sc ppm |
|----------|-----------|-----------|-----------|----------|-----------|
| 8534 | 2269 | 390 | 124 | 21 | 20 |
| 8535 | 1472 | 1042 | 122 | 20 | 21 |
| 8536 | 1382 | 487 | 133 | 17 | 12 |

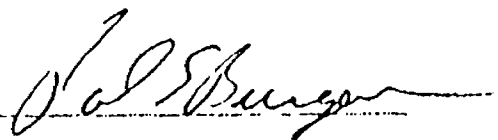

SWASTIKA LABORATORIES

P.O. BOX 10, SWASTIKA, ONTARIO

TELEPHONE #: (705) - 642 - 3244

FAX #: (705) - 642 - 3309

I.C.A.P. WHOLE ROCK

LITHIUM METABORATE FUSION

SWASTIKA LABS
SWASTIKA ONT.

T.S.L. REPORT No. : M - 8492 - 1

T.S.L. File No. : ND209A

T.S.L. Invoice No. :

LAB REFERENCE - OW-1760-R01

ALL RESULTS FFM

| SAMPLE # | Ba ppm | Sr ppm | Zr ppm | Y ppm | Sc ppm |
|----------|-----------|-----------|-----------|----------|-----------|
| 8534 | 2269 | 370 | 124 | 21 | 20 |
| 8535 | 1472 | 1042 | 122 | 20 | 21 |
| 8536 | 1382 | 487 | 133 | 17 | 12 |

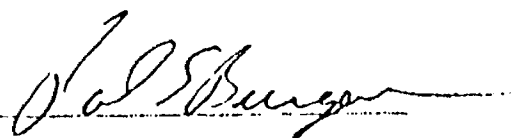

22614



SWASTIKA LABORATORIES

(A DIVISION OF ASSAYERS CORPORATION LIMITED)

P.O. BOX 10, SWASTIKA, ONTARIO P0K 1T0
TELEPHONE: (705) 642-3244 FAX (705) 642-3300

| | | | |
|------|-------|--------------|-------------|
| DATE | | TRANSPORTEUR | |
| JOUR | MOIS | ANNÉE | |
| 3 | JULY | 1990 | |
| DAY | MONTH | YEAR | SHIPPED VIA |

UA TO
 Queenston Mining Inc.
 Box 193
 Kirkland Lake, Ontario
 P2N 3H7
 W. McQuinty

1.5% LATE CHARGE OVER 30 DAYS (ANNUAL RATE 18%)

| | | | | | |
|----------------------------|-----------------------------|-----------------------|----------------------|-------------|-----------------|
| NO. D'EXEMPT. DE TAXE FÉD. | NO. D'EXEMPT. DE TAXE PROV. | VOTRE NO. DE COMMANDE | NOTRE NO DE COMMANDE | CONDITIONS | REP. DES VENTES |
| FED. LICENCE NO. | PROV. LICENCE NO. | Duffet | | NET 30 DAYS | |
| | | YOUR ORDER NO. | OUR ORDER NO. | TERMS | SALES REP. |

| QUANTITÉ QUANTITY | DESCRIPTION | PRIX UNITAIRE UNIT PRICE | MONTANT AMOUNT |
|-------------------|--------------------------------|--------------------------|-----------------|
| 9 | Au assays | \$ 8.75 | \$ 78.75 |
| 9 | Sample Handling | 3.00 | 27.00 |
| | Cert.#0W-0894-RG1 July 3, 1990 | | |
| | <i>Swastika Lab</i> | | |
| | <i>2019</i> | | |
| | <i>74.02</i> | | |
| | <i>1058 GENERAL expl.</i> | | |
| | <i>21.75 Duffet</i> | | |
| | <i>10.57</i> | | |
| | TOTAL | | \$ 95.17 |

| Description | Accr | Debit | Dr | Cr | Sub-total |
|---------------------------|------|-------|----|----|-----------|
| <i>Swastika Lab</i> | | | | | 105.75 |
| <i>2019</i> | | | | | |
| <i>74.02</i> | | | | | |
| <i>1058 GENERAL expl.</i> | | | | | 10.58 |
| <i>21.75 Duffet</i> | | | | | |
| <i>10.57</i> | | | | | |

FACTURE / INVOICE ANALYTICAL CHEMISTS • ASSAYERS • CONSULTANTS ESTABLISHED 1928

Certified by *G. Lebel*
 G. Lebel / Manager

P.O. Box 10, Swastika, Ontario P0K 1T0
 Telephone (705) 642-3244 FAX (705) 642-3300

Swastika Laboratories

Swastika, Ontario

POK 1T0
NOV - 9 1990

QUEENSTON MINING
KIRKLAND LAKE

INVOICE

NO: 23605

DATE: 11-06-90

PAGE: 1 of 1

SOLD TO:

SHIP TO:

Queenston Mining Inc.
P.O. Box 193
Kirkland Lake, Ontario
P2N 3H7

Same

| ITEM NO. | QUANTITY | UNIT | DESCRIPTION | F | P | UNIT PRICE | AMOUNT | |
|-----------|----------|------|------------------------------|-----|---|------------|--------------|--------|
| 11 | 1 | | Au Assays | | | 8.750 | 96.25 | |
| 11 | | | Description: Sample Handling | | | 3.000 | 33.00 | |
| | | | Cert#OW-1698-RG1 | | | | | |
| 33 | 1 | | Au Assays | | | 8.750 | 288.75 | |
| 33 | 1 | | Sample Handling | | | 3.000 | 99.00 | |
| | | | Cert#OW-1707-RG1 | | | | | |
| | | | -10% Discount | | | | 51.70 | |
| | | | Swastika Labs | 633 | | 105.75 | | |
| | | | | 757 | | 359.55 | | |
| Date | | | | | | | | |
| Chq # | | | | | | | | |
| COMMENTS: | | | | | | | TOTAL | 465.30 |

Certified by Norma Gardner

Swastika Laboratories
 P.O. Box 10
 Swastika, Ontario
 POK 1T0

INVOICE

RECEIVED
 DEC 10 1990
 QUEBEC
 KIRKLAND LAKE

NO: 23866
 DATE: 12-06-90
 PAGE: 1 of 1

SOLD TO:
 Queenston Mining Inc.
 P.O. Box 193
 Kirkland Lake, Ontario
 P2N 3H7

Same

| QTY | QUANTITY | UNIT | DESCRIPTION | UNIT PRICE | AMOUNT |
|--------------|----------|------|--|------------|--------|
| 3 | 1 | | Whole Rock Analysis Cert# QW-1760-R61 | 30.000 | 90.00 |
| | 1 | | Whole Rock Analysis Cr. Cert# QW-1879-R61 | 30.000 | 510.00 |
| | | | -10% Discount | | 60.00 |
| | | | Swastika Labs 1668 | 351.72 | |
| | | | 757 | 107.28 | |
| | | | 633 | 81.00 | 540.00 |
| | | | 67 | 20.00 | |
| TERMS: | | | | | |
| Net 30 Days | | | | | |
| TOTAL | | | | | 540.00 |

Technical Days are based on eight (8) hour Technical or Line-cutting days. Technical days include work performed by consultants, draftsmen, etc..

Type of Survey **Technical Geological Mapping and Reporting**

| Technical Days | | Technical Days Credits | | Line-cutting Days | | Total Credits | | No. of Claims | | Days per Claim | | |
|----------------|---|------------------------|---|-------------------|---|---------------|---|---------------|---|----------------|---|------|
| 3.5 | X | 7 | = | 24.5 | + | 0 | = | 24.5 | + | 1 | = | 24.5 |

Type of Survey **Technical Drafting**

| Technical Days | | Technical Days Credits | | Line-cutting Days | | Total Credits | | No. of Claims | | Days per Claim | | |
|----------------|---|------------------------|---|-------------------|---|---------------|---|---------------|---|----------------|---|------|
| 1.5 | X | 7 | = | 10.5 | + | 0 | = | 10.5 | + | 1 | = | 10.5 |

Type of Survey

| Technical Days | | Technical Days Credits | | Line-cutting Days | | Total Credits | | No. of Claims | | Days per Claim | | |
|----------------|---|------------------------|---|-------------------|---|---------------|---|---------------|---|----------------|---|--|
| | X | 7 | = | | + | | = | | + | | = | |

Type of Survey

| Technical Days | | Technical Days Credits | | Line-cutting Days | | Total Credits | | No. of Claims | | Days per Claim | | |
|----------------|---|------------------------|---|-------------------|---|---------------|---|---------------|---|----------------|---|--|
| | X | 7 | = | | + | | = | | + | | = | |



DOCUMENT
W 9008-00664

~~DEC 13~~
JAN 12

Instructions

- Please type or print.
- Refer to Subsection 77(19), the Mining Act for assessment work requirements and maximum credits allowed under this Subsection.
- Technical Reports, maps and proof of expenditures in duplicate should be submitted to Mining Lands Section, Mineral Development and Lands Branch.

Report of Work **2.13841**
(Expenditures, Subsection 77(19))

| | | |
|---|---------------------------------------|---|
| Type of Work Performed Geochemical Analysis | Mining Division Larder Lake | Township or Area Gauthier |
| Recorded Holder Queenston Mining Inc. | | Prospector's Licence No. 1770 |
| Address P. O. Box 193, 4 AlWende Avenue, Kirkland Lake, Ontario P2N 3H7 | | Telephone No. (705) 567-3261 |
| Work Performed By Queenston Mining Inc. | | |
| Name and Address of Author (of Submission) W. J. McGuinty, 4 AlWende Avenue, Kirkland Lake, Ontario P2N 3H7 | | Date When Work was Performed From: 20 06 90 To: 9 11 90 Day Mo. Yr. Day Mo. Yr. |

| | | | | | | | | | | | |
|--|-------------|--------------|-------------|-------------------------------|----------------------------|--------------|-------------|--------------|-------------|--------------|-------------|
| All the work was performed on Mining Claim(s); Indicate no. of days performed on each claim. *See Note No. 1 on reverse side | | | | Mining Claim 949827 | No. of Days 22.2 | Mining Claim | No. of Days | Mining Claim | No. of Days | Mining Claim | No. of Days |
| Mining Claim | No. of Days | Mining Claim | No. of Days | Mining Claim | No. of Days | Mining Claim | No. of Days | Mining Claim | No. of Days | Mining Claim | No. of Days |
| Mining Claim | No. of Days | Mining Claim | No. of Days | Mining Claim | No. of Days | Mining Claim | No. of Days | Mining Claim | No. of Days | Mining Claim | No. of Days |

| | | | |
|---|---|--------------------|--|
| Instructions Total days credits may be distributed at claim holder's choice. Enter number of days credits per claim in the expenditure days credit column (below). | Calculation of Expenditure Days Credits | | Total Number of Mining Claims Covered by this Report of Work |
| | Total Expenditures \$ 333.11 | ÷ 15 = 22.2 | 1 |

Mining Claims (List in numerical sequence). If space is insufficient, attach schedules with required information

| Mining Claim | | | Mining Claim | | | Mining Claim | | | Mining Claim | | |
|-----------------------------|--------|------------------|--------------|--------|------------------|--------------|--------|------------------|--------------|--------|------------------|
| Prefix | Number | Expend. Days Cr. | Prefix | Number | Expend. Days Cr. | Prefix | Number | Expend. Days Cr. | Prefix | Number | Expend. Days Cr. |
| L | 949781 | 22.2 | | | | | | | | | |
| RECEIVED | | | | | | | | | | | |
| DEC 03 1990 | | | | | | | | | | | |
| MINING LANDS SECTION | | | | | | | | | | | |

| | | |
|---|---|---|
| Total Number of Days Performed 22.2 | Total Number of Days Claimed 22.2 | Total Number of Days to be Claimed at a Future Date 0 |
|---|---|---|

Certification of Beneficial Interest *See Note No. 2 on reverse side

I hereby certify that, at the time the work was performed, the claims covered in this report of work were recorded in the current recorded holder's name or held under a beneficial interest by the current recorded holder.

Date: **09/11/90** Recorded Holder or Agent (Signature): *H. Kemshall*

Certification Verifying Report of Work

I hereby certify that I have a personal and intimate knowledge of the facts set forth in the Report of Work annexed hereto, having performed the work or witnessed same during and/or after its completion and the annexed report is true.

Name and Address of Person Certifying
W. J. McGuinty C/O Queenston Mining Inc., 4 AlWende Avenue, P. O. Box 193 (per G. Kemshall) Kirkland Lake, Ontario P2N 3H7

Telephone No. **(705) 567-3261** Date **Nov 13, 1990** Certified By (Signature) *H. Kemshall*

For Office Use Only

| | | | |
|---------------------------|-----------------------------------|---------------------------------------|--|
| Total Days Cr. Recorded | Date Recorded Nov 13/90 | Mining Recorder <i>[Signature]</i> | Received Stamp LARDER LAKE MINING DIVISION 30 NOV 13 PM 1 59 |
| Date Approved as Recorded | Principal Manager, Mining Lands | | |

REFERENCES

AREAS WITHDRAWN FROM DISPOSITION

- M.R.O. - MINING RIGHTS ONLY
- S.R.O. - SURFACE RIGHTS ONLY
- M.+S. - MINING AND SURFACE RIGHTS

Description Order No. Date Disposition File

TOWNSITE staking Restricted S.S. 30(b) MINING ACT

BARRICK POWER LINE
(Application pending under Public Lands Act)

SAND and GRAVEL

- M.T.C. PIT No. 1008 FILE 10421
- M.T.C. PIT 37-27

TOWNSHIP SUBJECT TO FORESTRY OPERATIONS

THE INFORMATION THAT APPEARS ON THIS MAP HAS BEEN COMPILED FROM VARIOUS SOURCES AND ACCURACY IS NOT GUARANTEED. THOSE WISHING TO STAKE MINING CLAIMS SHOULD CONSULT WITH THE MINING RECORDER, MINISTRY OF NORTHERN DEVELOPMENT AND MINES, FOR ADDITIONAL INFORMATION ON THE STATUS OF THE LANDS SHOWN HEREON.

NOTICE OF FORESTRY ACTIVITY
THIS TOWNSHIP / AREA FALLS WITHIN THE TIMSKAMING MANAGEMENT UNIT AND MAY BE SUBJECT TO FORESTRY OPERATIONS



200

ARNOLD TR.

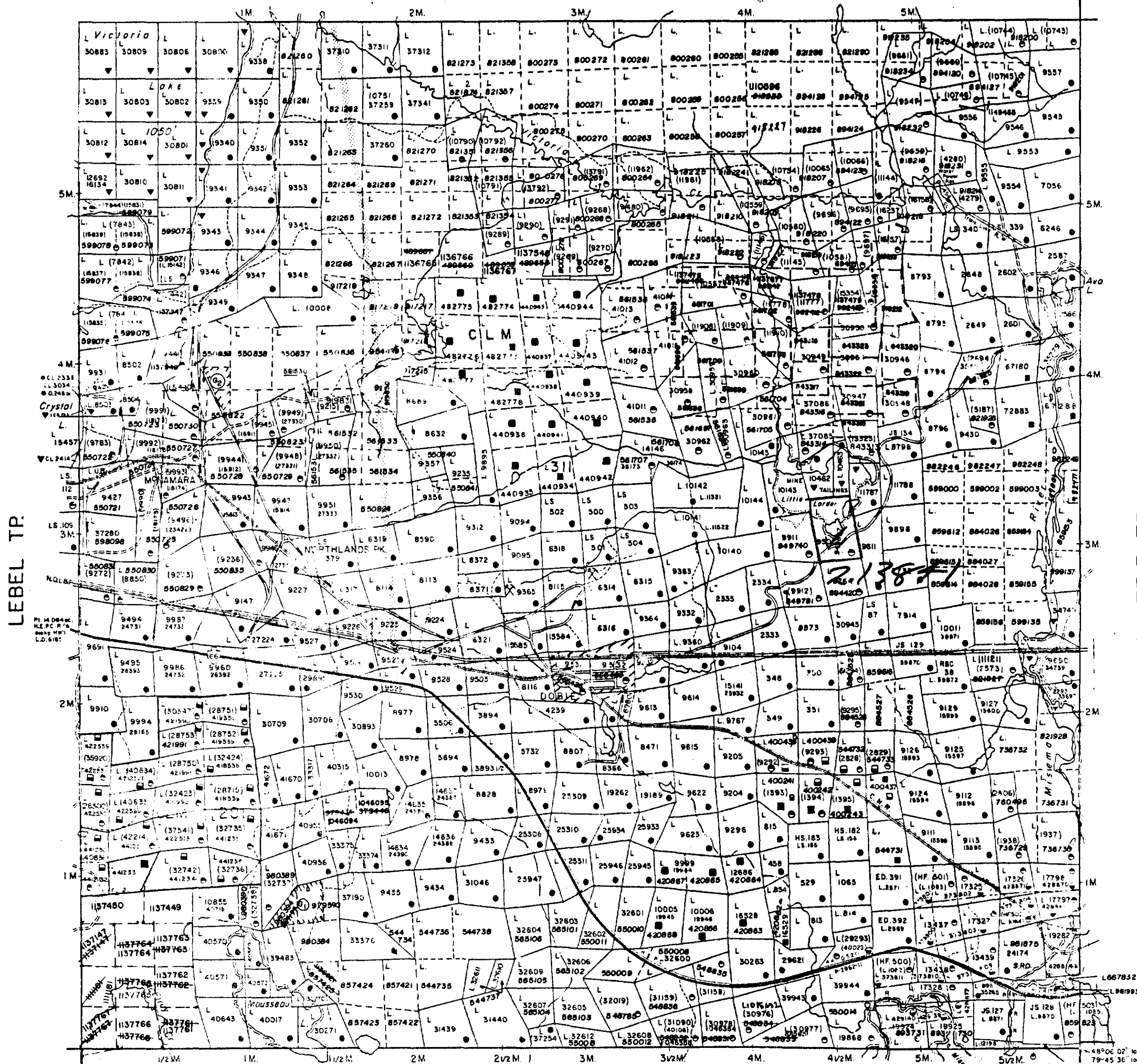

LEGEND

- HIGHWAY AND OTHER ROADS
- TRAILS
- SURVEYED LINES: TOWNSHIPS, BASE LINES ETC
- LOTS, MINING CLAIMS, PARCELS ETC
- UNSURVEYED LINES: LOT LINES
- PARCEL BOUNDARY
- MINING CLAIMS ETC
- RAILWAY AND RIGHT OF WAY
- UTILITY LINES
- NON-PERENNIAL STREAM
- FLOODING OR FLOODING RIGHTS
- SUBDIVISION OR COMPOSITE PLAN
- RESERVATIONS
- ORIGINAL SHORELINE
- MARSH OR MUSKEG
- MINES
- TRAVERSE MONUMENT

DISPOSITION OF CROWN LANDS

| TYPE OF DOCUMENT | SYMBOL |
|---------------------------------|--------|
| PATENT, SURFACE & MINING RIGHTS | ● |
| " SURFACE RIGHTS ONLY | ○ |
| " MINING RIGHTS ONLY | ○ |
| LEASE SURFACE & MINING RIGHTS | ■ |
| " SURFACE RIGHTS ONLY | ■ |
| " MINING RIGHTS ONLY | ■ |
| LICENCE OF OCCUPATION | ○ |
| ORDER-IN-COUNCIL | OC |
| RESERVATION | ○ |
| CANCELLED | ○ |
| SAND & GRAVEL | ○ |

NOTE: MINING RIGHTS IN PARCELS PATENTED PRIOR TO MAY 1 1913, VESTED IN ORIGINAL PATENTEE BY THE PUBLIC LANDS ACT, R.S.O. 1970, CHAP. 380, SEC. 63 SUBSEC.

SCALE: 1 INCH = 40 CHAINS

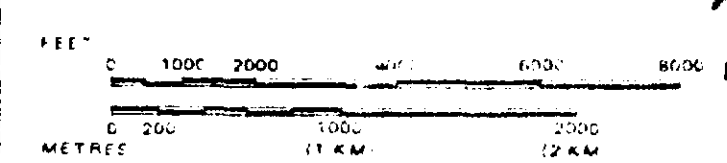

TOWNSHIP
GAUTHIER
M.N.R. ADMINISTRATIVE DISTRICT
KIRKLAND LAKE
MINING DIVISION
LARDER LAKE
LAND TITLES / REGISTRY DIVISION
TIMISKAMING

Ministry of Land Natural Resources Management Branch

DATE OF ISSUE

DEC 24 1980

DATE: JANUARY, 1985

NUMBER: FEBRUARY 8, 1988

6-3211

McELROY TR.

GENERAL SLOPE DIRECTION

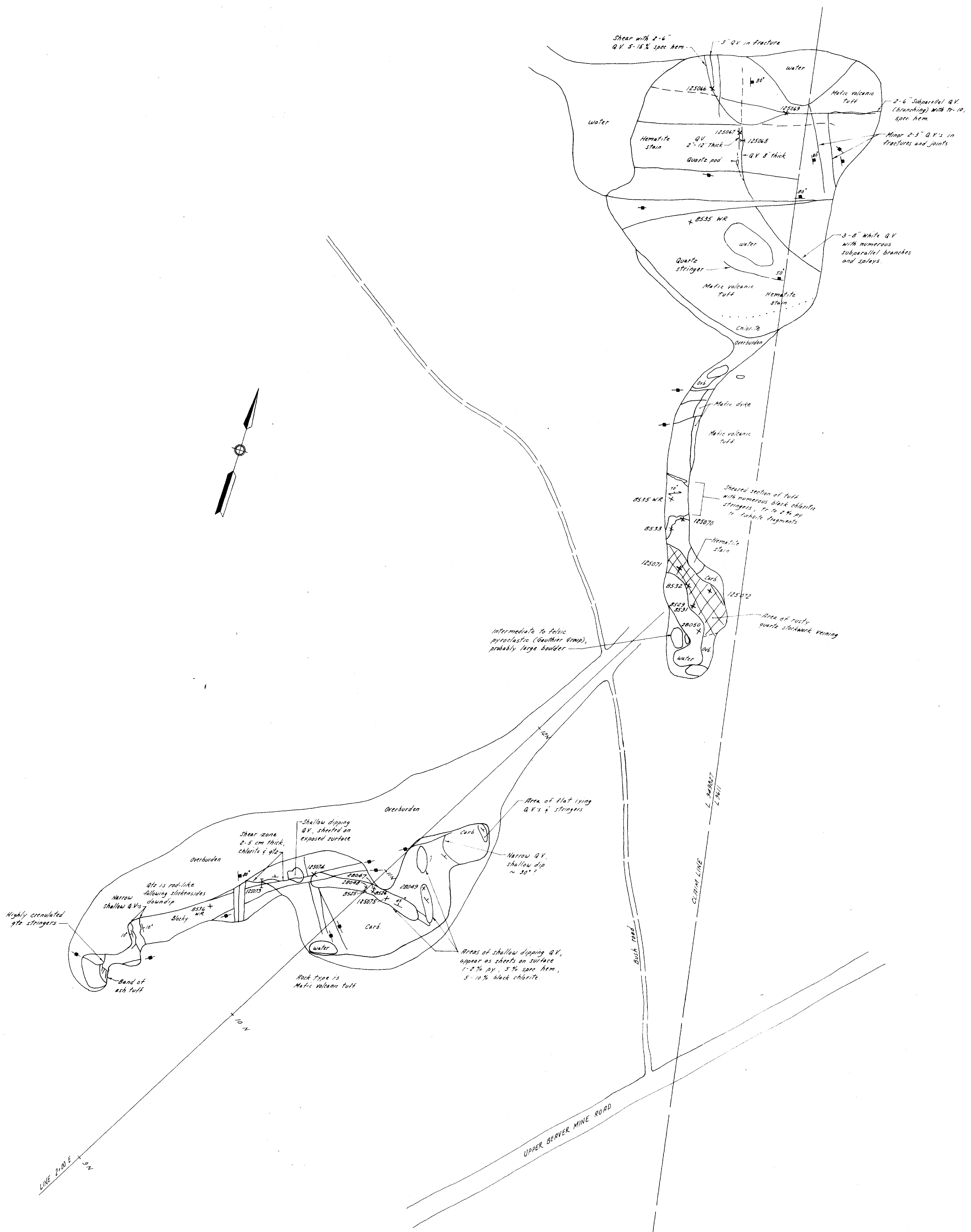

2.13841

| | | |
|----------------|----------|--|
| PROV. | ONTARIO | QUEENSTON MINING INC. DETAILED STRIPPING PLAN JASCAN PROPERTY |
| TWP. | GAUTHIER | |
| NTS | 3204 | |
| REF. | | |
| DWN. BY | BL/EE | |
| REVISIONS | DATE | BY |
| | | |
| SCALE 1" = 20' | | DATE NOV/90 |
| | | PLATE |

