



32D04NW0140 2.2975 GAUTHIER

010

REPORT ON
DRILLING,
STRIPPING,
ROCK TRENCHING,
&
ASSAYING

KL-106

RECEIVED
MAY 30 1978
MINING LANDS SECTION

18 - CLAIM GROUP
CASAN MINING LIMITED
GAUTHIER TOWNSHIP
EAST KIRKLAND LAKE GOLD AREA
ONTARIO

December 10, 1978

By; G.L. ROBERTS
P.ENG., M.E.I.C.

CANDALE MINING MANAGEMENT SERVICES LTD.

INTRODUCTION

This report describes the results of a program of drilling, stripping, rock sampling, and assaying conducted and carried out under the supervision of Candale Mining Management Services Ltd. covering an 18 claim group property of Casan Mining Limited located in Gauthier township, East Kirkland Lake gold area, Ontario. The work was carried out by the writer and his assistants in June, July, August, and September of this year (1978), using a line grid originally established on the property in the fall of 1976 and which had to be extensively restaked.

SURVEYED AREA

The 18 claims covered by this report are continuous and are identified as follows;

L-482773	L-440934
L-482774	L-440935
L-482775	L-440936
L-482776	L-440937
L-482777	L-440938
L-482778	L-440939
	L-440940
	L-440941
	L-440942
	L-440943
	L-440944
	L-440945

LOCATION AND ACCESS

The property is located at the north central part of Gauthier Township, one mile north of Dobie, tying onto the north of Upper Canada Mine. It extends northwesterly with its northwest part adjoining to the northeast of Crestland Mines Limited, formerly Northland Mines Limited.

Access was made by motor car from Kirkland Lake via Highway 66 to Northlands Park, and by a bush road from Northlands Park eastward through the No. 1 shaft area of Northland Mines to the bush road which runs across the central part of the property.

PREVIOUS WORK

In the winter of 1976-77, the company conducted a program of geophysical surveys on this 18 claim group. The surveys were carried out by Cana Exploration Consultants Limited, and the results were described by Dr. S.S.Szetu in a report dated January 20, 1977. Readers are referred to this report for the geophysical data and also to the history of the property.

It should be noted here that the airborne E.M. anomaly referred to in said report was conducted by Upper Canada Mines Limited, apparently prior to May, 1966, and the ground follow-up E.M. surveys were conducted in March and May, 1966 by Moreau Woodward & Company Limited of Toronto. While the first survey failed, the second survey succeeded in detecting a

conductor zone at an inferred depth of over 210' on the ground held under option by Upper Canada. The conductor zone opens to the west to a patented claim then held by Northland.

Data in the office of the Resident Geologist at Kirkland Lake also showed one hole drilled in 1966 on the then known as Taylor Option, logged by J.G.Bragg, Chief Geologist, Upper Canada Mines Limited. This hole was located at the central part of then Claim 79866 across the eastern section of the airborne E.M. anomaly, which showed stronger conduction to the west. The hole cut a narrow band of graphite sediments with occasional bands and nodules of pyrite at a considerable depth.

Another hole was drilled to a shallow depth of 148.6' at a location further east by the then owner of the property, Mr. T. C. Taylor, for assessment work purposes. According to Mr. Taylor, the drill site found near L28N, 1450' E. was the setup for this shallow hole.

As Casan Mining Limited now has claims covering the full lengths of the airborne conductor, including the unchecked and apparently more outstanding western section, detailed information about these drill holes and other relevant data will be added to the company's compilation map for further evaluation. During the month of June 1978 the company, Casan Mining Limited, conducted two programs, a geological survey and a radiation survey on this 18 claim group. The surveys were carried out by Cana Exploration Consultants Limited under the direction of Dr. S.S.Szetu and the results are described by the author, Dr. S.S. Szetu in his reports dated July 20, 1978 and August 21, 1978.

GEOLOGY

The north part of the property is mostly underlain by Keewatin acid volcanics and the central part is underlain by Timiskaming sediments with two narrow zones of interbanded acid volcanics. The south west part of the property is underlain by Algoman Syenite and porphyry syenite, intruding the sediments.

The volcanics and sediments are steeply dipping and apparently schistosed to various degrees. The contacts between the various rock formations are all covered by overburden.

GENERAL

The geological report produced for Casan Mining Limited by Cana Exploration Consultants Ltd. and written by Dr.S.S. Szetu dated July 20, 1978 requested that detailed surface sampling of the claims held by this company should be carried out before any drilling exploration be undertaken.

Casan Mining Limited contracted with Dynamic Construction Ltd. of Toronto to undertake the excavation of trenches and surface blasting, trenching and drilling that would allow detailed sampling of the rock areas available for exploration.

TOPOGRAPHY

Most of the area covered by the claims involved is covered with glacial sand overburden to depths of up to 150'. Few areas have rock exposed on or near the surface which would allow sampling to a definitive extent. Many swamps and a few creeks are present. Sand eskers rising to 100' are common.

OLD WORKINGS

Old trenches that could be found were from the 1920's and the most recent 1940's exploration periods and as such were fully overgrown with trees and in many cases had reverted to their original sand overburdened condition.

RESEARCH OF PREVIOUS EXPLORATION

Extensive research was conducted into the previous drilling programs and with the help of the Northern Miner records and the few Consolidated Northland Mine records that were still available, we have produced a map showing all previous drill holes carried out on the property.

A personal interview between myself and Mr. Byrne, who conducted the drilling operation for Consolidated Northland Mines in the 1940's confirmed that no instrumentation in Magnometer, Electromagnetic or Radiation were ever conducted on these claims during their ownership.

It is interesting to note that when the up to date E.M. anomalies we have since obtained are plotted over the old drilling holes that all drill holes miss the newly indicated E.M. anomalies.

TIME PERIOD OF WORK INVOLVED

Surface sampling was carried out by machine and hand labour over the period of the summer of 1978.

PICKET LINE RESTAKING

Extensive restaking of the picket lines had to be carried out as the original pickets had been knocked down by government

tree planting machines. This took a considerable amount of time and held up the crews for several days.

ROAD CONSTRUCTION

Vehicle roads had to be repaired and cut to facilitate the entry of vehicles onto the property. Bridges over beaver dams had to be rebuilt.

OBSERVATIONS

An interview with Mr. T.C. Taylor, who is now retired and who was, at one time, underground drilling superintendent for the old Upper Canada Gold Mines which hold the adjacent claims to the south of Casan's stated that any mineral occurrence on these properties would only be struck at a depth in excess of 1000' since this had been the general record of Upper Canada findings. Mr. Taylor had held at one time or another several claims to the north of Casan's which he had drilled personally or had contracted to Upper Canada for drilling and development.

From Mr. Taylor's experience and drilling information recorded and verbal, that was obtained from employees of the old Consolidated Northland gold mines, it was evident that shallow (i.e. 100' - 400') diamond drilled holes would not give positive indications of the true ore holding at economic development depths but that only holes in excess of 1000' would be of any true worth.

CONCLUSION OF RESEARCH

Original plans were therefore abandoned and additional ground surveys and trenching assessments should be conducted in order to locate a test hole that would minimize the risk of obtaining a 'dry hole' and that would justify the expense of the one hole depth of 2000' at a cost of \$60,000 per hole minimum.

GENERAL WORK UNDERTAKEN

Dynamic Construction Ltd under our direction opened up for inspection the following;

1/ Approximately 1305 linear feet of trenching, including removal of trees, overburden blasting and breakage and excavation of rock.

2/ Twenty-five (25) drill holes between 6' - 8' in depth to determine bed rock.

3/ 12' deep shaft - removal of overburden, pumping out of ground water, excavation of rock in a 6' X 6' square shaft.

4/ 5' pit - removal of overburden, pumping out of water, breakage and excavation of rock.

ROCK SAMPLING

In each of the already named above areas, a careful study was made of the trenches and pits for mineralization. The trenches and pits were thoroughly examined. The walls and floors which contained outcrop were cross sectioned and veins or areas in which there was either mineralization or which looked anomolous were removed from their location, catalogued, and subjected to assaying. The detailed results of the work conducted in each of these locations is described in detail on the following pages along with copies of the assayed analysis received from an independent technical service laboratory.

INVOICE

dynamic construction ltd.

1350 WINDING TRAIL, #86
MISSISSAUGA, ONTARIO L4Y 2T8

INVOICE TO: CASAN MINING LIMITED
Suite 220
12 Richmond St. E.,
Toronto, Ontario

For work carried out during 1978 on the 18 claims known as the Old Northland Gold Mines;

1305 linear feet of trenching, including removal of trees, overburden blasting and breakage of rock

25 drill holes - 6-8' auger holes to determine bed rock

12' shaft removal of overburden, pumping out of ground water, breakage and removal of rock

5' pit Removal of overburden, pumping out of water, breakage and removal of rock.

Work completed of Kirkland Lake Claims;

L16N	75'	New Trench
L20N	120'	Reopened Trench
L24N	25' bore holes,	6' depth -
L4S	100'	Reopened Trench
	12' shaft	Excavation
	300'	Reopened Trench
	50'	Reopened Trench
L24N	160'	Reopened Trench
L28N	150'	Reopened Trench
L22S	150'	Reopened Trench
	100'	Reopened Trench
L16S	100'	Reopened Trench
	5' pit	

Total 1305' trenching
25 X 6' drill holes, 150 linear feet
12' depth shaft 6' X 6'
5' depth pit

TRENCH AND PIT ANALYSIS SUMMARY

- 1/ LOCATION PIT C L. 440934
TRENCH NEAR BEAVER DAM
SAMPLE NO. 2795
- 2/ DRAWING REFERENCE PLAN NO 10D
LINE NO. L16S
- 3/ TOPOGRAPHY SWAMPY
BEAVER DAM
- 4/ DATE SEPTEMBER 1978
- 5/ DETAILS OF PIT REOPENED OLD PIT AND CARRIED
OUT NEW EXCAVATION IN AREA
- 6/ SAMPLING CARRIED OUT BY MR. KARL RFMAZKI
- 7/ DETAILS OF SAMPLING CHIP SAMPLING OF 10 AREAS
FROM THIS TRENCH WERE
OBTAINED. THE MOST PROMISING
SAMPLE WAS ASSAYED
- 8/ RESULTS OF ASSAY SEE FOLLOWING SHEET
- 9/ EXCAVATION CARRIED OUT BY DYNAMIC CONSTRUCTION LTD
SEPTEMBER 1978

- CHEMICAL RESEARCH AND ANALYSIS
- CONTRACT LABORATORIES

TECHNICAL SERVICE LABORATORIES

DIVISION OF BURGNER TECHNICAL ENTERPRISES LIMITED

1301 FEWSTER DRIVE, MISSISSAUGA, ONT. L4W 1A2

TELEPHONE: (416) 625-1544

TELEX 06-960215

CERTIFICATE OF ANALYSIS

SAMPLE(S) FROM Burhamdale Investments

REPORT No.

T - 08064

Inv. #9018

SAMPLE(S) OF ROCK

Gold (Au) oz/ton

2795

<0.001

Samples, Pulps and Rejects discarded after two months

DATE September 20th, 1978.

SIGNED

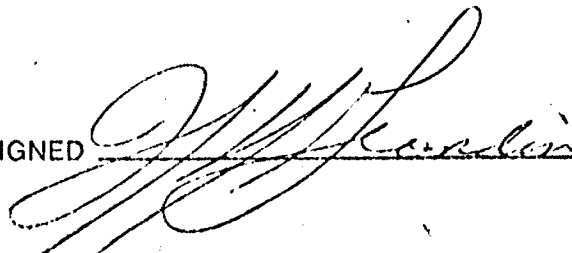

TRENCH AND PIT ANALYSIS SUMMARY

L. 440939

- 1/ LOCATION PIT D
SAMPLE NO. 2803
- 2/ DRAWING REFERENCE PLAN NO 10
LINE NO L4S
- 3/ TOPOGRAPHY TREE AND BUSH OVERBURDEN
HEAVY SPRUCE REGROWTH
- 4/ DATE AUGUST 1978
- 5/ DETAILS OF PIT OLD PIT RE-EXCAVATED, DEEPEMED
AND EXTENDED
- 6/ SAMPLING CARRIED OUT BY MR. KARL REMAZKI
MR. G.I. ROBERTS
MR. G.C. ROBERTS
- 7/ DETAILS OF SAMPLING CHIP SAMPLING OF 25 AREAS
FROM THIS TRENCH PORTION WERE
OBTAINED - THE MOST PROMISING
SAMPLE WAS ASSAYED
- 8/ RESULTS OF ASSAY SEE FOLLOWING SHEET
- 9/ EXCAVATION CARRIED OUT BY DYNAMIC CONSTRUCTION LTD

X-RAY ASSAY LABORATORIES

LIMITED

LESMILL ROAD

DON MILLS ONTARIO M3B 2T8

445-5755

Certificate of Analysis

NO. 3470 PAGE

TO.

CASBON MINING LTD.,
Attn: K. Remazki

RECEIVED Aug. 29/78

INVOICE NO. 3470

SAMPLE(S) OF 6 rock

SUBMITTED TO US SHOW RESULTS AS FOLLOWS:

Sample Auoz/ton

2797	nil
99	0.04
2800	nil
01	nil
02	nil
03	nil

X-RAY ASSAY LABORATORIES LIMITED

Aug. 31/78.

DATE

CERTIFIED BY

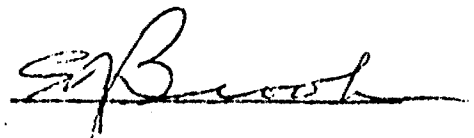

TRENCH AND PIT ANALYSIS SUMMARY

- L. 440939
- 1/ LOCATION PIT D
SAMPLE NO 4

 - 2/ DRAWING REFERENCE PLAN 10
LINE NO. L4S

 - 3/ TOPOGRAPHY TREE & BUSH OVERBURDEN
HEAVY SPRUCE REGROWTH

 - 4/ DATE JULY 1978

 - 5/ DETAILS OF PIT OLD PIT RE-EXCAVATED, DEEPENED
AND EXTENDED

 - 6/ SAMPLING CARRIED OUT BY MR. KARL REMAZKI

 - 7/ DETAILS OF SAMPLING CHIP SAMPLING OF 10 AREAS FROM
THIS TRENCH PORTION WERE
OBTAINED - THE MOST PROMISING
SAMPLE WAS ASSAYED

 - 8/ RESULTS OF ASSAY SEE FOLLOWING SHEETS

 - 9/ EXCAVATION CARRIED OUT BY DYNAMIC CONSTRUCTION LTD

- CHEMICAL RESEARCH AND ANALYSIS
- CONTRACT LABORATORIES

TECHNICAL SERVICE LABORATORIES

DIVISION OF BURGNER TECHNICAL ENTERPRISES LIMITED

1301 FEWSTER DRIVE, MISSISSAUGA, ONT. L4W 1A2

TELEPHONE: (416) 625-1544

TELEX 06-960216

CERTIFICATE OF ANALYSIS

SAMPLE(S) FROM Candale Mines,
Unit 86,
1350 Winding Trail,
Mississauga, Ontario.

REPORT No.

T - 07937

Inv. #8876

SAMPLE(S) OF ROCKS

	<u>#2</u>	<u>#3</u>	<u>#4</u>
Gold (Au) oz /ton	0.003	0.008	0.001

Samples, Pulps and Rejects discarded after two months

DATE August 31, 1978.

SIGNED *[Signature]*



- CHEMICAL RESEARCH AND ANALYSIS
- CONTRACT LABORATORIES

TECHNICAL SERVICE LABORATORIES

DIVISION OF BURGNER TECHNICAL ENTERPRISES LIMITED.

1301 FEWSTER DRIVE, MISSISSAUGA, ONT. L4W 1A2

TELEPHONE: (416) 625-1544

TELEX 06-960215

CERTIFICATE OF ANALYSIS

Semiquantitative Spectrographic

SAMPLE(S) FROM Candale Mines,
Unit 86,
1350 Winding Trail,
Mississauga, Ontario.

REPORT No.
T - 07937

Inv. #8876

SAMPLE(S) OF ROCKS

	Sample #2	Sample #3	Sample #4		Sample #2	Sample #3	Sample #4
Aluminum (Al ₂ O ₃)	H	H	H	Manganese	.05%	.1%	.05%
Antimony	-	-	-	Magnesium (MgO)	2%	2%	3%
Arsenic	-	1%	-	Molybdenum	-	-	-
Barium	.2%	.2%	.2%	Neodymium (Nd ₂ O ₃)	-	-	-
Beryllium (BeO)	-	-	-	Nickel	.002%	.001%	.002%
Bismuth	-	-	-	Phosphorus	-	-	-
Boron	.01%	.005%	-	Silver	-	-	-
Calcium (CaO)	2%	3%	2%	Silicon (SiO ₂)	H	H	H
Cadmium	-	-	-	Sodium (Na ₂ O)	2%	2%	2%
Cerium (CeO ₂)	-	-	-	Strontium	.1%	.2%	.1%
Chromium	-	-	.02%	Tantalum (Ta ₂ O ₅)	-	-	-
Cobalt	<.01%	<.01%	<.01%	Thorium (ThO ₂)	-	-	-
Columbium (Cb ₂ O ₅)	-	-	-	Tin	-	-	-
Copper	.005%	.002%	.001%	Titanium	.2%	.2%	.5%
Gallium	.001%	.001%	.001%	Tungsten	-	-	-
Germanium	-	-	-	Uranium (U ₃ O ₈)	-	-	-
Iron (Fe)	5%	5%	5%	Vanadium	.02%	.02%	.02%
Lanthanum (La ₂ O ₃)	-	-	-	Yttrium (Y ₂ O ₃)	.001%	.001%	.001%
Lead	-	.01%	-	Zinc	-	-	-
Lithium (Li ₂ O)	-	-	-	Zirconium (ZrO ₂)	.01%	.01%	<.01%
Extra Elements							
Cesium				Platinum			
Gold				Rhenium			
Hafnium				Rubidium			
Indium				Tellurium			
Palladium				Thallium			

Figures are approximate:

CODE H - High - 10 - 100% approx.
M - Medium - 1 - 10% approx.
L - Low - .1 - 1% approx.

- Not Detected - Elements looked for but not found
X Not Looked For
< Less Than

Samples, Pulp and Rejects discarded after two months

DATE August 31st, 1978.

SIGNED

Debra



TRENCH AND PIT ANALYSIS SUMMARY

1/ LOCATION

PIT D
SAMPLE NO.5

L.440939

2/ DRAWING REFERENCE

PLAN NO. 10
LINE NO. L4S

3/ TOPOGRAPHY

TRFE & BUSH OVERBURDEN
HEAVY SPRUCE REGROWTH

4/ DATE

JULY 1978

5/ DETAILS OF PIT

OLD PIT RE-EXCAVATED, DEEPENED,
AND EXTENDED

6/ SAMPLING CARRIED OUT BY

MR. KARL REMAZKI

7/ DETAILS OF SAMPLING

CHIP SAMPLING OF 10 AREAS
FROM THIS TRENCH PORTION
WERE OBTAINED, THE MOST PROMISING
SAMPLE WAS ASSAYED

8/ RESULTS OF ASSAY

SEE FOLLOWING SHEET

9/ EXCAVATION CARRIED OUT BY

DYNAMIC CONSTRUCTION LTD.

X-RAY ASSAY LABORATORIES

LIMITED

43 LESMILL ROAD

DON MILLS ONTARIO M3B 2T8

445-5755

Certificate of Analysis

NO. 3469 PAGE

TO. CANDATE MINING
Attn: K. Remazki

RECEIVED Aug. 29/78

INVOICE NO. 3469

SAMPLE(S) OF 4 rock

SUBMITTED TO US SHOW RESULTS AS FOLLOWS:

Sample Auoz/ton

1	nil
5	trace
6	0.02
200	0.02

Note: traces less than 0.01 oz/ton Au

X-RAY ASSAY LABORATORIES LIMITED

DATE Aug. 31/78.

CERTIFIED BY

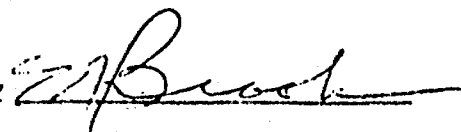

TRENCH AND PIT ANALYSIS SUMMARY

L. 440939

- 1/ LOCATION PIT D
SAMPLE NO 2

- 2/ DRAWING REFERENCE PLAN 10D
LINE NO. L4S

- 3/ TOPOGRAPHY TREE & BUSH OVERBURDEN
HEAVY SPRUCE REGROWTH

- 4/ DATE JULY 1978

- 5/ DETAILS OF PIT OLD PIT RE-EXCAVATED, DEEPENED
AND EXTENDED

- 6/ SAMPLING CARRIED OUT BY MR. KARL REMAZKI

- 7/ DETAILS OF SAMPLING CHIP SAMPLING OF 10 AREAS
FROM THIS PORTION OF THE
TRENCH WERE OBTAINED, THE
MOST PROMISING SAMPLE WAS
ASSAYED

- 8/ RESULTS OF ASSAY SEE FOLLOWING SHEET

- 9/ EXCAVATION CARRIED OUT BY DYNAMIC CONSTRUCTION LTD.

- CHEMICAL RESEARCH AND ANALYSIS
- CONTRACT LABORATORIES

TECHNICAL SERVICE LABORATORIES

DIVISION OF BURGNER TECHNICAL ENTERPRISES LIMITED

1301 FEWSTER DRIVE, MISSISSAUGA, ONT. L4W 1A2

TELEPHONE: (416) 625-1544

TELEX 06-960215

CERTIFICATE OF ANALYSIS

SAMPLE(S) FROM Candale Mines,
Unit 86,
1350 Winding Trail,
Mississauga, Ontario.

REPORT No.

T - 07937

Inv. #8876

SAMPLE(S) OF ROCKS

	<u>#2</u>	<u>#3</u>	<u>#4</u>
Gold (Au) oz/ton	0.003	0.008	0.001

Samples, Pulps and Rejects discarded after two months

DATE August 31, 1978.

SIGNED

[Signature]



- CHEMICAL RESEARCH AND ANALYSIS
- CONTRACT LABORATORIES

TECHNICAL SERVICE LABORATORIES

DIVISION OF BURGNER TECHNICAL ENTERPRISES LIMITED

1301 FEWSTER DRIVE, MISSISSAUGA, ONT. L4W 1A2

TELEPHONE: (416) 625-1544

TELEX 06-960215

CERTIFICATE OF ANALYSIS

Semiquantitative Spectrographic

SAMPLE(S) FROM Candale Mines,
Unit 86,
1350 Winding Trail,
Mississauga, Ontario.

REPORT No.

T - 07937

Inv. #8876

SAMPLE(S) OF ROCKS

	Sample # 2	Sample #3	Sample #4		Sample #2	Sample #3	Sample #4
Aluminum (Al ₂ O ₃)	H	H	H	Manganese	.05%	.1%	.05%
Antimony	-	-	-	Magnesium (MgO)	2%	2%	3%
Arsenic	-	1%	-	Molybdenum	-	-	-
Barium	.2%	.2%	.2%	Neodymium (Nd ₂ O ₃)	-	-	-
Beryllium (BeO)	-	-	-	Nickel	.002%	.001%	.002%
Bismuth	-	-	-	Phosphorus	-	-	-
Boron	.01%	.005%	-	Silver	-	-	-
Calcium (CaO)	2%	3%	2%	Silicon (SiO ₂)	H	H	H
Cadmium	-	-	-	Sodium (Na ₂ O)	2%	2%	2%
Cerium (CeO ₂)	-	-	-	Strontium	.1%	.2%	.1%
Chromium	-	-	.02%	Tantalum (Ta ₂ O ₅)	-	-	-
Cobalt	<.01%	<.01%	<.01%	Thorium (ThO ₂)	-	-	-
Columbium (Cb ₂ O ₅)	-	-	-	Tin	-	-	-
Copper	.005%	.002%	.001%	Titanium	.2%	.2%	.5%
Gallium	.001%	.001%	.001%	Tungsten	-	-	-
Germanium	-	-	-	Uranium (U ₃ O ₈)	-	-	-
Iron (Fe)	5%	5%	5%	Vanadium	.02%	.02%	.02%
Lanthanum (La ₂ O ₃)	-	-	-	Yttrium (Y ₂ O ₃)	.001%	.001%	.001%
Lead	-	.01%	-	Zinc	-	-	-
Lithium (Li ₂ O)	-	-	-	Zirconium (ZrO ₂)	.01%	.01%	<.01%
Extra Elements							
Caesium				Platinum			
Gold				Rhenium			
Hafnium				Rubidium			
Indium				Tellurium			
Palladium				Thallium			

Figures are approximate:

CODE H - High -- 10 - 100% approx.
M - Medium -- 1 - 10% approx.
L - Low -- .1 - 1% approx.

- Not Detected - Elements looked for but not found
X Not Looked For
< Less Than

Samples, Pulps and Rejects discarded after two months

DATE August 31st, 1978.

SIGNED

Rehan



TRENCH AND PIT ANALYSIS SUMMARY

L.440939

- 1/ LOCATION PIT E (LOST TRENCH)
SAMPLE NO 2801

- 2/ DRAWING REFERENCE PLAN NO 10
LINE NO L4S

- 3/ TOPOGRAPHY TREE, SAND & BUSH OVERBURDEN
HEAVY SPRUCE REGROWTH

- 4/ DATE AUGUST 1978

- 5/ DETAILS OF PIT OLD PIT RE-EXCAVATED, DEEPENED
AND EXTENDED

- 6/ SAMPLING CARRIED OUT BY MR. KARL REMAZKI

- 7/ DETAILS OF SAMPLING CHIP SAMPLING OF 15 AREAS FROM
THIS TRENCH WERE OBTAINED
THE MOST PROMISING SAMPLE WAS
ASSAYED

- 8/ RESULTS OF ASSAY SEE FOLLOWING SHEET

- 9/ EXCAVATION CARRIED OUT BY DYNAMIC CONSTRUCTION LTD

X-RAY ASSAY LABORATORIES

LIMITED

45 LESMILL ROAD

DON MILLS ONTARIO M3B 2T8

445-5755

Certificate of Analysis

NO. 3470 PAGE

TO.
CARBON MINING LTD.,
Attn: K. Remazki

RECEIVED Aug. 29/78

INVOICE NO. 3470

SAMPLE(S) OF 6 rock

SUBMITTED TO US SHOW RESULTS AS FOLLOWS:

Sample	Auoz/ton
2797	nil
99	0.04
2800	nil
01	nil
02	nil
03	nil

X-RAY ASSAY LABORATORIES LIMITED

Aug. 31/78.

DATE

CERTIFIED BY

[Signature]

TRENCH AND PIT ANALYSIS SUMMARY

1/ LOCATION

PIT F
SAMPLE NO 2802

L.440939

2/ DRAWING REFERENCE

PLAN NO 10
LINE L4S

3/ TOPOGRAPHY

TREE & BUSH OVERBURDEN
HEAVY SPRUCE REGROWTH

4/ DATE

AUGUST 1978

5/ DETAILS OF PIT

OLD PIT RE-EXCAVATED
DEEPEMED & EXTENDED

6/ SAMPLING CARRIED OUT BY

MR. KARL REMAZKI
MR. G.L. ROBERTS
MR. G.C. ROBERTS

7/ DETAILS OF SAMPLING

CHIP SAMPLING OF 15 AREAS
FROM THIS TRENCH WERE OBTAINED
THE MOST PROMISING SAMPLE
WAS ASSAYED

8/ RESULTS OF ASSAY

SEE FOLLOWING SHEET

9/ EXCAVATION CARRIED OUT BY

DYNAMIC CONSTRUCTION LTD

X-RAY ASSAY LABORATORIES

LIMITED

LESMILL ROAD

DON MILLS ONTARIO M3B 2T8

445-5755

Certificate of Analysis

NO. 3470 PAGE

TO.
CASSON MINING LTD.,
Attn: K. Remazki

RECEIVED Aug. 29/78

INVOICE NO. 3470

SAMPLE(S) OF 6 rock

SUBMITTED TO US SHOW RESULTS AS FOLLOWS:

Sample Auoz/ton

2797	nil
99	0.04
2800	nil
01	nil
02	nil
03	nil

X-RAY ASSAY LABORATORIES LIMITED

Aug. 31/78.

DATE

CERTIFIED BY

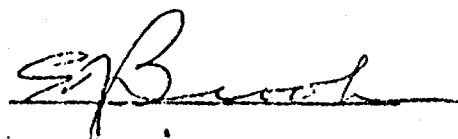

TRENCH AND PIT ANALYSIS SUMMARY

- L.482778
- 1/ LOCATION PIT G
SAMPLE 2976
- 2/ DRAWING REFERENCE PLAN NO 10
LINE L16N
- 3/ TOPOGRAPHY 2' - 3' OVERBURDEN
SPRUCE TREE REGROWTH AREA
- 4/ DATE AUGUST 1978
- 5/ DETAILS OF PIT NEW TRENCH
- 6/ SAMPLING CARRIED OUT BY MR. KARL REMAZKI
- 7/ DETAILS OF SAMPLING CHIP SAMPLING OF 10 AREAS
FROM THIS TRENCH WERE OBTAINED
THE MOST PROMISING SAMPLE WAS
ASSAYED
- 8/ RESULTS OF ASSAY SEE FOLLOWING SHEET
- 9/ EXCAVATION CARRIED OUT BY DYNAMIC CONSTRUCTION LTD

- CHEMICAL RESEARCH AND ANALYSIS
- CONTRACT LABORATORIES

TECHNICAL SERVICE LABORATORIES

DIVISION OF BURGNER TECHNICAL ENTERPRISES LIMITED

1301 FEWSTER DRIVE, MISSISSAUGA, ONT. L4W 1A2

TELEPHONE: (416) 825-1544
TELEX 06-960215

CERTIFICATE OF ANALYSIS

SAMPLE(S) FROM **Cassan Mining,
Unit 86,
1350 Winding Trail,
Mississauga, Ontario.**

REPORT No.
T - 07938

Inv. #8875

SAMPLE(S) OF ROCKS

	<u>2796</u>	<u>2798</u>
Gold (Au) oz/ton	0.001	0.001

amples, Pulps and Rejects discarded after two months

DATE August 31st, 1978.

SIGNED *A. Delbrun*



- CHEMICAL RESEARCH AND ANALYSIS
- CONTRACT LABORATORIES

TECHNICAL SERVICE LABORATORIES

DIVISION OF BURGNER TECHNICAL ENTERPRISES LIMITED

1301 FEWSTER DRIVE, MISSISSAUGA, ONT. L4W 1A2

TELEPHONE: (416) 625-1544

TELEX 06-960215

CERTIFICATE OF ANALYSIS

Semiquantitative Spectrographic

SAMPLE(S) FROM

Cassan Mining,
Unit 86,
1350 Winding Trall,
Mississauga, Ontario.

REPORT No.

T - 07938

SAMPLE(S) OF

ROCKS

	Sample 2796	Sample 2798	Sample	Sample 2796	Sample 2798	Sample
Aluminum (Al ₂ O ₃)	H	H	Manganese	.05%	.05%	
Antimony	-	-	Magnesium (MgO)	3%	2%	
Arsenic	-	-	Molybdenum	-	-	
Barium	.1%	.2%	Neodymium (Nd ₂ O ₃)	-	-	
Beryllium (BeO)	-	-	Nickel	.005%	.002%	
Bismuth	-	-	Phosphorus	-	-	
Boron	-	-	Silver	-	-	
Calcium (CaO)	2%	3%	Silicon (SiO ₂)	H	H	
Cadmium	-	-	Sodium (Na ₂ O)	2%	2%	
Cerium (CeO ₂)	-	-	Strontium	.05%	.1%	
Chromium	.03%	.01%	Tantalum (Ta ₂ O ₅)	-	-	
Cobalt	<.01%	<.01%	Thorium (ThO ₂)	-	-	
Columbium (Cb ₂ O ₅)	-	-	Tin	-	-	
Copper	.001%	.002%	Titanium	.5%	.5%	
Gallium	.001%	.001%	Tungsten	-	-	
Germanium	-	-	Uranium (U ₃ O ₈)	-	-	
Iron (Fe)	5%	5%	Vanadium	.02%	.02%	
Lanthanum (La ₂ O ₃)	-	-	Yttrium (Y ₂ O ₃)	-	-	
Lead	-	-	Zinc	-	-	
Lithium (Li ₂ O)	-	-	Zirconium (ZrO ₂)	<.01%	.01%	
Extra Elements						
Cesium			Platinum			
Gold			Rhenium			
Hafnium			Rubidium			
Indium			Tellurium			
Palladium			Thallium			

Figures are approximate:

CODE H - High - 10 - 100% approx.
M - Medium - 1 - 10% approx.
L - Low - .1 - 1% approx.

- Not Detected - Elements looked for but not found
X Not Looked For
< Less Than

Samples, Pulps and Rejects discarded after two months

DATE August 31st, 1978.

SIGNED

[Signature]



TRENCH AND PIT ANALYSIS SUMMARY

- L. 482778
- 1/ LOCATION PIT H
SAMPLE NO 2797
 - 2/ DRAWING REFERENCE PLAN 10A
L16N
 - 3/ TOPOGRAPHY 2'0" - 3'0" OVERBURDEN
SPRUCE TREE REGROWTH AREA
APPROX 2' 0" ELEVATION ABOVE SWAMP
 - 4/ DATE AUGUST 1978
 - 5/ DETAILS OF PIT NEW TRENCH
 - 6/ SAMPLING CARRIED OUT BY MR. KARL REMAZKI
MR. G.C. ROBERTS
 - 7/ DETAILS OF SAMPLING CHIP SAMPLING OF 10 AREAS
FROM THIS TRENCH WERE OBTAINED
THE MOST PROMISING SAMPLE WAS
ASSAYED
 - 8/ RESULTS OF ASSAY SEE FOLLOWING SHEET
 - 9/ EXCAVATION CARRIED OUT BY DYNAMIC CONSTRUCTION LTD

X-RAY ASSAY LABORATORIES

LIMITED

LESMILL ROAD

DON MILLS ONTARIO M3B 2T8

445-5755

Certificate of Analysis

NO. 3470 PAGE

TO. CASZON MINING LTD.,
Attn: K. Remazki.

RECEIVED Aug. 29/78

INVOICE NO. 3470

SAMPLE(S) OF 6 rock

SUBMITTED TO US SHOW RESULTS AS FOLLOWS:

Sample Auoz/ton

2797	nil
99	0.04
2800	nil
01	nil
02	nil
03	nil

X-RAY ASSAY LABORATORIES LIMITED

Aug. 31/78.

DATE

CERTIFIED BY

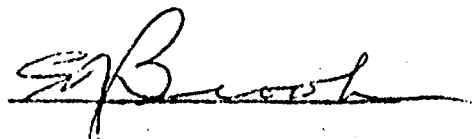

TRENCH AND PIT ANALYSIS SUMMARY

- L.482778
- 1/ LOCATION PIT I
SAMPLE 2798
 - 2/ DRAWING REFERENCE DRAWING NO.10
LINE L16N
 - 3/ TOPOGRAPHY 2' - 3' OF SAND OVERBURDEN
SPRUCE TREE REGROWTH AREA
 - 4/ DATE AUGUST 1978
 - 5/ DETAILS OF PIT NEW TRENCH
 - 6/ SAMPLING CARRIED OUT BY MR. KARL REMAZKI
MR. G.C. ROBERTS
MR. G.L. ROBERTS
 - 7/ DETAILS OF SAMPLING CHIP SAMPLING OF 10 AREAS
FROM THIS TRENCH WERE OBTAINED
THE MOST PROMISING SAMPLE WAS ASSAYED
 - 8/ RESULTS OF ASSAY SEE FOLLOWING SHEET
 - 9/ EXCAVATION CARRIED OUT BY DYNAMIC CONSTRUCTION LTD

- CHEMICAL RESEARCH AND ANALYSIS
- CONTRACT LABORATORIES

TECHNICAL SERVICE LABORATORIES

DIVISION OF BURGNER TECHNICAL ENTERPRISES LIMITED

1301 FEWSTER DRIVE, MISSISSAUGA, ONT. L4W 1A2

TELEPHONE: (416) 625-1544

TELEX 06-960215

CERTIFICATE OF ANALYSIS

SAMPLE(S) FROM **Cassan Mining,
Unit 86,
1350 Winding Trail,
Mississauga, Ontario.**

REPORT No.

T - 07938

Inv. #8875

SAMPLE(S) OF ROCKS

	<u>2796</u>	<u>2798</u>
Gold (Au) oz/ton	0.001	0.001

amples, Pulps and Rejects discarded after two months

DATE August 31st, 1978.

SIGNED *A. Delman*



TRENCH AND PIT ANALYSIS SUMMARY

L. 482778

- 1/ LOCATION PIT J
SAMPLE NO 2799
- 2/ DRAWING REFERENCE PLAN 10
LINE L16N
- 3/ TOPOGRAPHY 2'0" to 3'0" OVERBURDEN
SPRUCE TREE REGROWTH AREA
- 4/ DATE AUGUST 1978
- 5/ DETAILS OF PIT NEW TRENCH
- 6/ SAMPLING CARRIED OUT BY MR. KARL REMAZKI
MR. G.L. ROBERTS
- 7/ DETAILS OF SAMPLING CHIP SAMPLING OF 5 AREAS
FROM THIS TRENCH WERE OBTAINED
THE MOST PROMISING SAMPLE WAS
ASSAYED
- 8/ RESULTS OF ASSAY SEE FOLLOWING SHEET
- 9/ EXCAVATION CARRIED OUT BY DYNAMIC CONSTRUCTION LTD

X-RAY ASSAY LABORATORIES

LIMITED

LESMILL ROAD

DON MILLS ONTARIO M3B 2T8

445-6755

Certificate of Analysis

NO. 3470 PAGE

TO. **CASSON MINING LTD.,**
Attn: K. Remazki

RECEIVED Aug. 29/78

INVOICE NO. 3470

SAMPLE(S) OF 6 rock

SUBMITTED TO US SHOW RESULTS AS FOLLOWS:

Sample Auoz/ton

2797	nil
99	0.04
2800	nil
01	nil
02	nil
03	nil

X-RAY ASSAY LABORATORIES LIMITED

Aug. 31/78.

DATE

CERTIFIED BY

S. B. Brook

TRENCH AND PIT ANALYSIS SUMMARY

L.482776

- 1/ LOCATION PIT M
SAMPLE NO 2800
- 2/ DRAWING REFERENCE PLAN NO 10
LINE NO L28N
- 3/ TOPOGRAPHY ROCK OUTCROP WITH HEAVY SPRUCE
GROWTH
- 4/ DATE AUGUST 1978
- 5/ DETAILS OF PIT OLD PIT RE-EXCAVATED AND
DEFPENED
- 6/ SAMPLING CARRIED OUT BY MR. KARL REMAZKI
MR. G.L. ROBERTS
MR. G.C. ROBERTS
- 7/ DETAILS OF SAMPLING CHIP SAMPLING OF 15 AREAS
FROM THIS TRENCH WERE OBTAINED
THE MOST PROMISING SAMPLE WAS
ASSAYED +
- 8/ RESULTS OF ASSAY SEE FOLLOWING SHEET
- 9/ EXCAVATION CARRIED OUT BY DYNAMIC CONSTRUCTION LTD

X-RAY ASSAY LABORATORIES

LIMITED

LESMILL ROAD

DON MILLS ONTARIO M3B 2T8

445-5755

Certificate of Analysis

NO. 3470 PAGE

TO. CARBON MINING LTD.,
Attn: K. Remazki

RECEIVED Aug. 29/78

INVOICE NO. 3470

SAMPLE(S) OF 6 rock

SUBMITTED TO US SHOW RESULTS AS FOLLOWS:

Sample Auoz/ton

2797 nil

99 0.04

2800 nil

01 nil

02 nil

03 nil

X-RAY ASSAY LABORATORIES LIMITED

Aug. 31/78.

DATE

CERTIFIED BY

TRENCH AND PIT ANALYSIS SUMMARY

- 1/ LOCATION PIT N L.482773
SAMPLE NO 6
- 2/ DRAWING REFERENCE PLAN NO 10
LINE NO L24N
- 3/ TOPOGRAPHY TREE & BUSH OVERBURDEN
HEAVY SPRUCE REGROWTH
- 4/ DATE JULY 1978
- 5/ DETAILS OF PIT OLD PIT RE-EXCAVATED, DEEPENED
AND EXTENDED
- 6/ SAMPLING CARRIED OUT BY MR. KARL REMAZKI
- 7/ DETAILS OF SAMPLING CHIP SAMPLING OF 10 AREAS
FROM THIS PORTION OF THE TRENCH
WERE OBTAINED, THE MOST PROMISING
SAMPLE WAS ASSAYED
- 8/ RESULTS OF ASSAY SEE FOLLOWING SHEET
- 9/ EXCAVATION CARRIED OUT BY DYNAMIC CONSTRUCTION LTD

X-RAY ASSAY LABORATORIES

LIMITED

LESMILL ROAD

DON MILLS ONTARIO M3B 2T8

445-5755

Certificate of Analysis

NO. 3469 PAGE

TO. CANDATE MINING
Attn: K. Remazki

RECEIVED Aug. 29/78

INVOICE NO. 3469

SAMPLE(S) OF 4 rock

SUBMITTED TO US SHOW RESULTS AS FOLLOWS:

Sample Auoz/ton

1	nil
5	trace
6	0.02
200	0.02

Note: traces less than 0.01 oz/ton Au.

X-RAY ASSAY LABORATORIES LIMITED

DATE

Aug. 31/78.

CERTIFIED BY

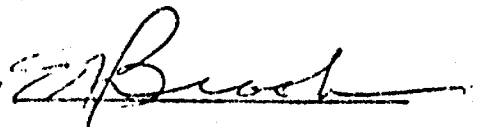

TRENCH AND PIT ANALYSIS SUMMARY

L.482773

- 1/ LOCATION PIT N
SAMPLE NO. 200
- 2/ DRAWING REFERENCE PLAN NO 10
LINE NO L24N
- 3/ TOPOGRAPHY TREE & BUSH OVERBURDEN
- 4/ DATE AUGUST 1978
- 5/ DETAILS OF PIT OLD PIT RE-EXCAVATED, DEEPENED
AND EXTENDED
- 6/ SAMPLING CARRIED OUT BY MR. KARL REMAZKI
- 7/ DETAILS OF SAMPLING CHIP SAMPLING OF 10 AREAS
FROM THIS PORTION OF THE TRENCH
WERE OBTAINED - THE MOST PROMISING
SAMPLE WAS ASSAYED
- 8/ RESULTS OF ASSAY SEE FOLLOWING SHEET
- 9/ EXCAVATION CARRIED OUT BY DYNAMIC CONSTRUCTION LTD

X-RAY ASSAY LABORATORIES

LIMITED

LESMILL ROAD

DON MILLS ONTARIO M3B 2T8

445-5755

Certificate of Analysis

NO. 3469 PAGE

TO. CANDATE MINING
Attn: K. Remazki

RECEIVED Aug. 29/78

INVOICE NO. 3469

SAMPLE(S) OF 4 rock

SUBMITTED TO US SHOW RESULTS AS FOLLOWS:

Sample Auoz/ton

1	nil
5	trace
6	0.02
200	0.02

Note: traces less than 0.01 oz/ton Au

X-RAY ASSAY LABORATORIES LIMITED

DATE

Aug. 31/78.

CERTIFIED BY

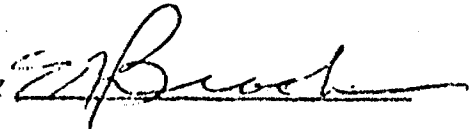

TRENCH AND PIT ANALYSIS SUMMARY

L.482773

- 1/ LOCATION PIT N
SAMPLE NO 3
- 2/ DRAWING REFERENCE PLAN 10
LINE L24N
- 3/ TOPOGRAPHY TREE & BUSH OVERBURDER
HEAVY SPRUCE REGROWTH
- 4/ DATE JULY 1978
- 5/ DETAILS OF PIT OLD PIT RE-EXCAVATED, DEEPEMED
AND EXTENDED
- 6/ SAMPLING CARRIED OUT BY MR KARL REMAZKI
- 7/ DETAILS OF SAMPLING CHIP SAMPLING OF 10 AREAS FROM
THIS PORTION OF THE TRENCH
WERE OBTAINED - THE MOST PROMISING
SAMPLE WAS ASSAYED
- 8/ RESULTS OF ASSAY SEE FOLLOWING SHEET
- 9/ EXCAVATION CARRIED OUT BY DYNAMIC CONSTRUCTION LTD

- CHEMICAL RESEARCH AND ANALYSIS
- CONTRACT LABORATORIES

TECHNICAL SERVICE LABORATORIES

DIVISION OF BURGNER TECHNICAL ENTERPRISES LIMITED

1301 FEWSTER DRIVE, MISSISSAUGA, ONT. L4W 1A2

TELEPHONE: (416) 625-1544

TELEX 06-960215

CERTIFICATE OF ANALYSIS

SAMPLE(S) FROM Candale Mines,
Unit 86,
1350 Winding Trail,
Mississauga, Ontario.

REPORT No.
T - 07937

Inv. #8876

SAMPLE(S) OF ROCKS

	<u>#2</u>	<u>#3</u>	<u>#4</u>
Gold (Au) oz/ton	0.003	0.008	0.001

amples, Pulps and Rejects discarded after two months

DATE August 31, 1978.

SIGNED

[Handwritten Signature]



- CHEMICAL RESEARCH AND ANALYSIS
- CONTRACT LABORATORIES

TECHNICAL SERVICE LABORATORIES

DIVISION OF BURGNER TECHNICAL ENTERPRISES LIMITED

1301 FEWSTER DRIVE, MISSISSAUGA, ONT. L4W 1A2

TELEPHONE: (416) 625-1544

TELEX 06-960215

CERTIFICATE OF ANALYSIS

Semiquantitative Spectrographic

SAMPLE(S) FROM Candale Mines,
Unit 86,
1350 Winding Trail,
Mississauga, Ontario.

REPORT No.
T - 07937

Inv. #8876

SAMPLE(S) OF ROCKS

	Sample # 2	Sample # 3	Sample # 4		Sample # 2	Sample # 3	Sample # 4
Aluminum (Al ₂ O ₃)	H	H	H	Manganese	.05%	.1%	.05%
Antimony	-	-	-	Magnesium (MgO)	2%	2%	3%
Arsenic	-	1%	-	Molybdenum	-	-	-
Barium	.2%	.2%	.2%	Neodymium (Nd ₂ O ₃)	-	-	-
Beryllium (BeO)	-	-	-	Nickel	.002%	.001%	.002%
Bismuth	-	-	-	Phosphorus	-	-	-
Boron	.01%	.005%	-	Silver	-	-	-
Calcium (CaO)	2%	3%	2%	Silicon (SiO ₂)	H	H	H
Cadmium	-	-	-	Sodium (Na ₂ O)	2%	2%	2%
Cerium (CeO ₂)	-	-	-	Strontium	.1%	.2%	.1%
Chromium	-	-	.02%	Tantalum (Ta ₂ O ₅)	-	-	-
Cobalt	<.01%	<.01%	<.01%	Thorium (ThO ₂)	-	-	-
Columbium (Cb ₂ O ₅)	-	-	-	Tin	-	-	-
Copper	.005%	.002%	.001%	Titanium	.2%	.2%	.5%
Gallium	.001%	.001%	.001%	Tungsten	-	-	-
Germanium	-	-	-	Uranium (U ₃ O ₈)	-	-	-
Iron (Fe)	5%	5%	5%	Vanadium	.02%	.02%	.02%
Lanthanum (La ₂ O ₃)	-	-	-	Yttrium (Y ₂ O ₃)	.001%	.001%	.001%
Lead	-	.01%	-	Zinc	-	-	-
Lithium (Li ₂ O)	-	-	-	Zirconium (ZrO ₂)	.01%	.01%	<.01%
Extra Elements							
Caesium				Platinum			
Gold				Rhodium			
Hafnium				Rubidium			
Indium				Tellurium			
Palladium				Thallium			

Figures are approximate:

ODE H - High - 10 - 100% approx.
M - Medium - 1 - 10% approx.
L - Low - .1 - 1% approx.

- Not Detected - Elements looked for but not found
X Not Looked For
< Less Than

Samples, Pulps and Rejects discarded after two months

DATE August 31st, 1978.

SIGNED

Debra



TRENCH AND PIT ANALYSIS SUMMARY

- 1/ LOCATION PIT O L.482773
SAMPLE NO 1
- 2/ DRAWING REFERENCE PLAN 10D
LINE NO 124N
- 3/ TOPOGRAPHY TREE & BUSH OVERBURDEN
HEAVY SPRUCE REGROWTH
- 4/ DATE JULY 1978
- 5/ DETAILS OF PIT OLD PIT RE-EXCAVATED,
DEEPEMED AND EXTENDED
- 6/ SAMPLING CARRIED OUT BY MR. KARL REMAZKI
- 7/ DETAILS OF SAMPLING CHIP SAMPLING OF 10 AREAS
FROM THIS PORTION OF THE TRENCH
WERE OBTAINED, THE MOST PROMISING
SAMPLE WAS ASSAYED
- 8/ RESULTS OF ASSAY SEE FOLLOWING SHEET
- 9/ EXCAVATION CARRIED OUT BY DYNAMIC CONSTRUCTION LTD

X-RAY ASSAY LABORATORIES

LIMITED

LES MILL ROAD

DON MILLS ONTARIO M3B 2T8

445-5755

Certificate of Analysis

NO. 3469 PAGE

TO. CANDATE MINING
Attn: K. Remazki

RECEIVED Aug. 29/78

INVOICE NO. 3469

SAMPLE(S) OF 4 rock

SUBMITTED TO US SHOW RESULTS AS FOLLOWS:

Sample Auoz/ton

1	nil
5	trace
6	0.02
200	0.02

Note: traces less than 0.01 oz/ton Au

X-RAY ASSAY LABORATORIES LIMITED

DATE Aug. 31/78.

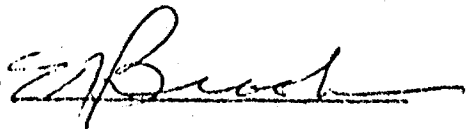
CERTIFIED BY 

NOTES

400' surface rights reservation along the shores of all lakes and rivers.

© M.T.C. File 101421 Pit No.1666

ARNOLD TP. M.321

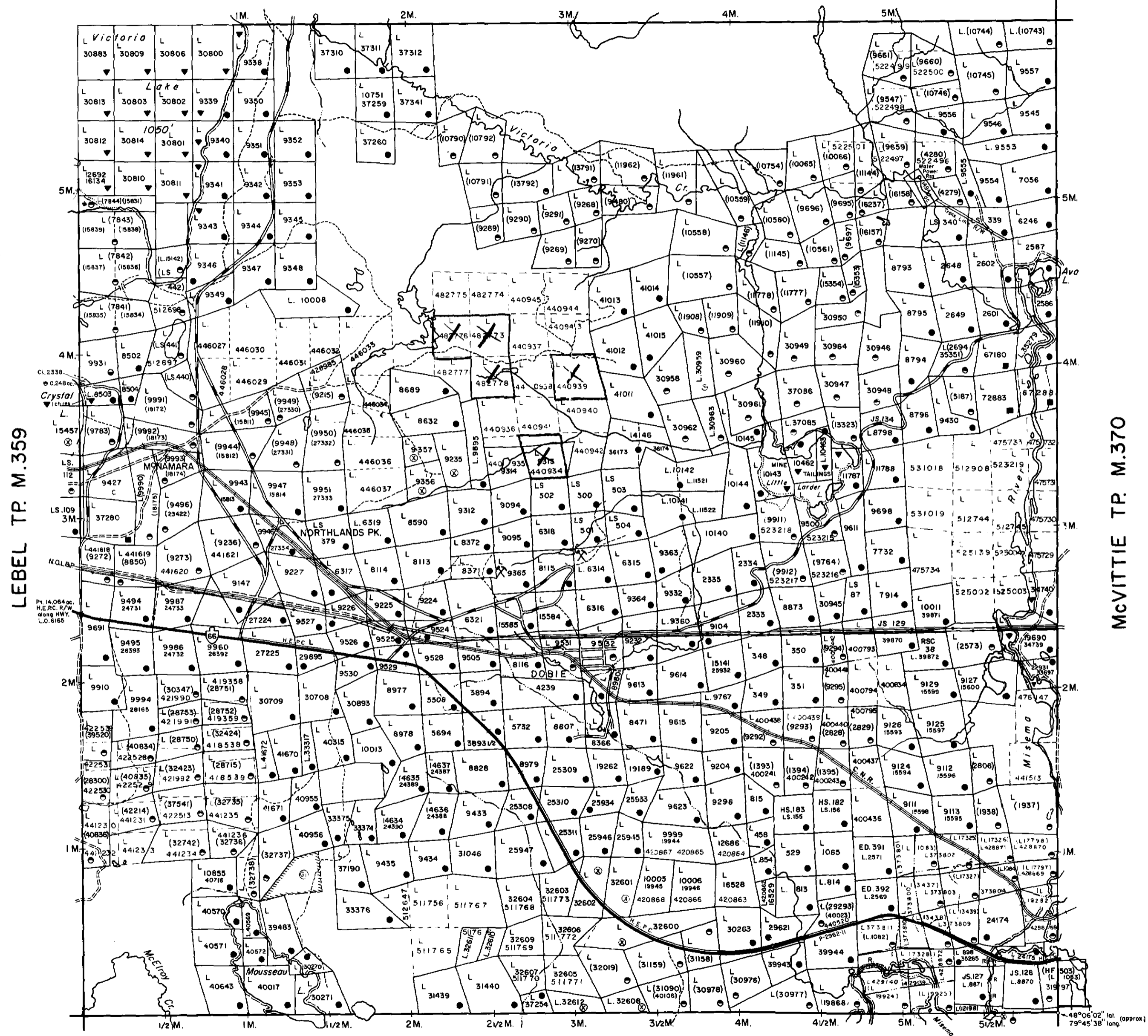

LEBEL TP. M.359

McVITTIE TP. M.370

McELROY TP. M.366

LEGEND

- HIGHWAY AND ROUTE No.
- OTHER ROADS
- TRAILS
- SURVEYED LINES:
 - TOWNSHIPS, BASE LINES, ETC.
 - LOTS, MINING CLAIMS, PARCELS, ETC.
- UNSURVEYED LINES:
 - LOT LINES
 - PARCEL BOUNDARY
 - MINING CLAIMS ETC.
- RAILWAY AND RIGHT OF WAY
- UTILITY LINES
- NON-PERENNIAL STREAM
- FLOODING OR FLOODING RIGHTS
- SUBDIVISION
- ORIGINAL SHORELINE
- MARSH OR MUSKEG
- MINES

DISPOSITION OF CROWN LANDS

TYPE OF DOCUMENT	SYMBOL
PATENT, SURFACE & MINING RIGHTS	
" SURFACE RIGHTS ONLY	
" MINING RIGHTS ONLY	
LEASE, SURFACE & MINING RIGHTS	
" SURFACE RIGHTS ONLY	
" MINING RIGHTS ONLY	
LICENCE OF OCCUPATION	
CROWN LAND SALE	C.S.
ORDER-IN-COUNCIL	OC
RESERVATION	
CANCELLED	
SAND & GRAVEL	

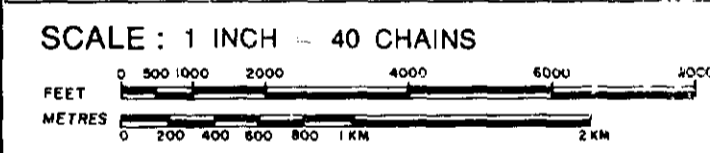

ACRES	HECTARES
40	16

TOWNSHIP 2,2975
GAUTHIER
 DISTRICT
 TIMISKAMING
 MINING DIVISION
 LARDER LAKE

Ministry of Natural Resources
 Ontario Surveys and Mapping Branch
 Date JAN. 1973 Plan No. **M.350**
 Whitney Block
 Queen's Park, Toronto

DATE OF ISSUE
 MAY 31 1979
 SURVEYS AND MAPPING
 BRANCH



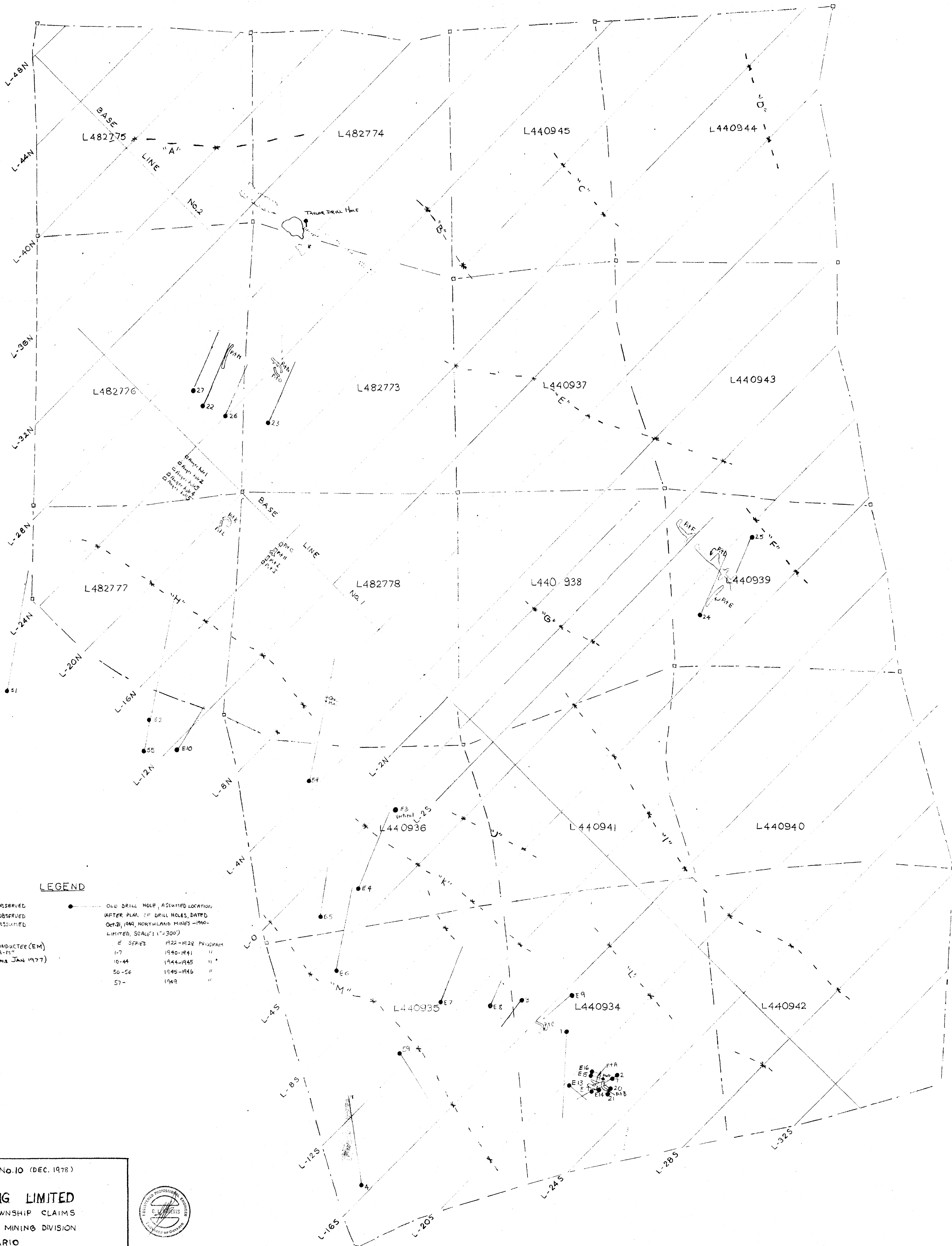
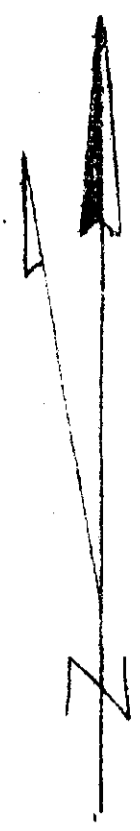

LEGEND

- CLAIM POST OBSERVED
- CLAIM LINE OBSERVED
- - - CLAIM LINE ASSUMED
- TRENCH
- * - INDICATED CONDUCTOR (EM) AND INFERRED AXIS "A-M" (BY CANA EXPLORATIONS JAN 1977)
- OLD DRILL HOLE, ASSUMED LOCATION, AFTER PLAN OF DRILL HOLES, DATED OCT. 21, 1949, NORTHLAND MINES - 1940 LIMITED, SCALE: 1"=300'
- E SERIES 1922-1929 PROGRAM
- 1-7 1940-1941 "
- 10-44 1944-1945 "
- 50-56 1945-1946 "
- 57- 1949 "

PLAN No. 10 (DEC. 1978)

CASAN MINING LIMITED
GAUTHIER TOWNSHIP CLAIMS
LARDER LAKE MINING DIVISION
ONTARIO

SCALE: 1"=200'

DEC. 1978



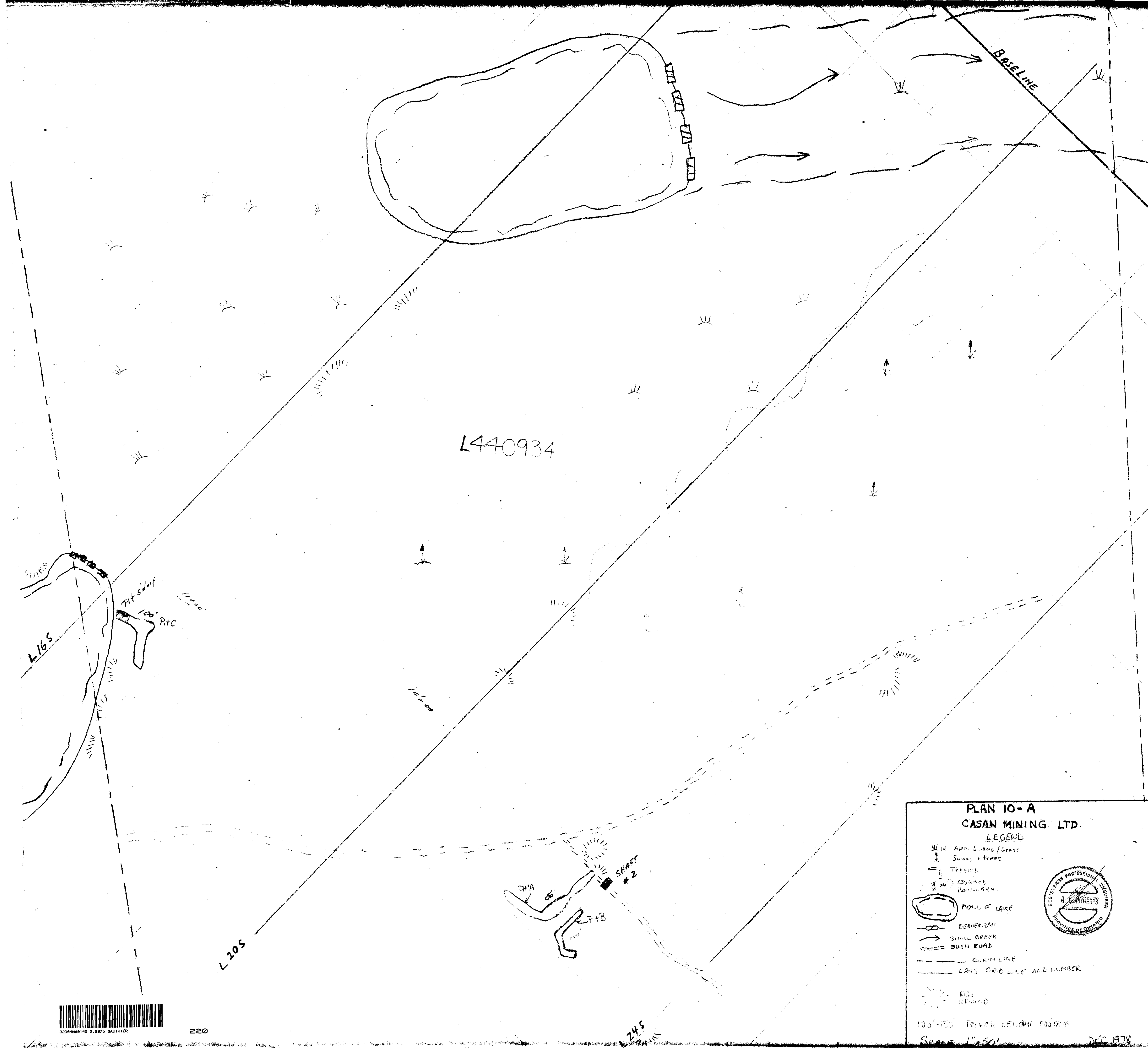

PLAN 10-A
CASAN MINING LTD.
LEGEND

- MUD, SAND, SWAMP / GRASS
- SWAMP + TREES
- TRENCH
- ASSUMED BOUNDARY AREA
- POND OF LAKE
- BEAVER DAM
- SMALL CREEK
- BUSH ROAD
- CLAIM LINE
- L245 GRID LINE AND NUMBER
- HIGH CORNER
- 100'-150' TRENCH CENTER FOOTING
- SCALE 1"=50'

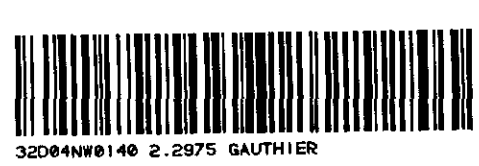

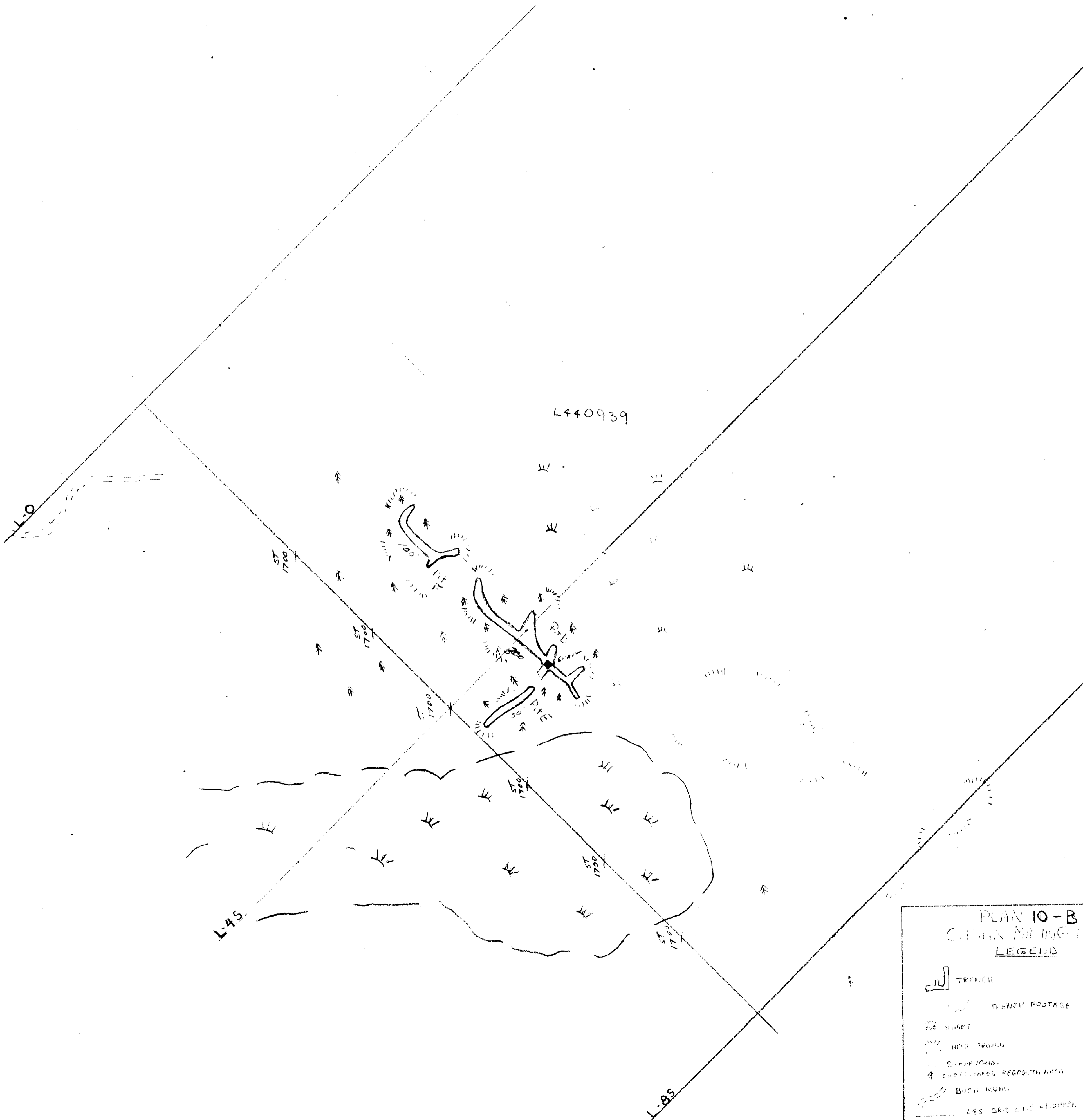

PLAN 10-B
CROWN MINING LIMITED
LEGEND

	TRAIL
	TRENCH FOOTAGE
	SHRUB
	ROAD BOUND
	SLOPE INDIC
	ESTIMATED REGRADUATION AREA
	BUSH ROAD
	L-85 GRID LINE + 100 FT

Scale = 1" = 50'

DEC 197

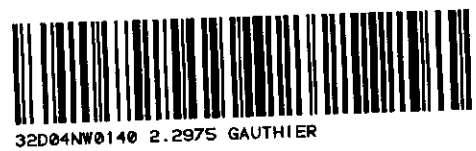

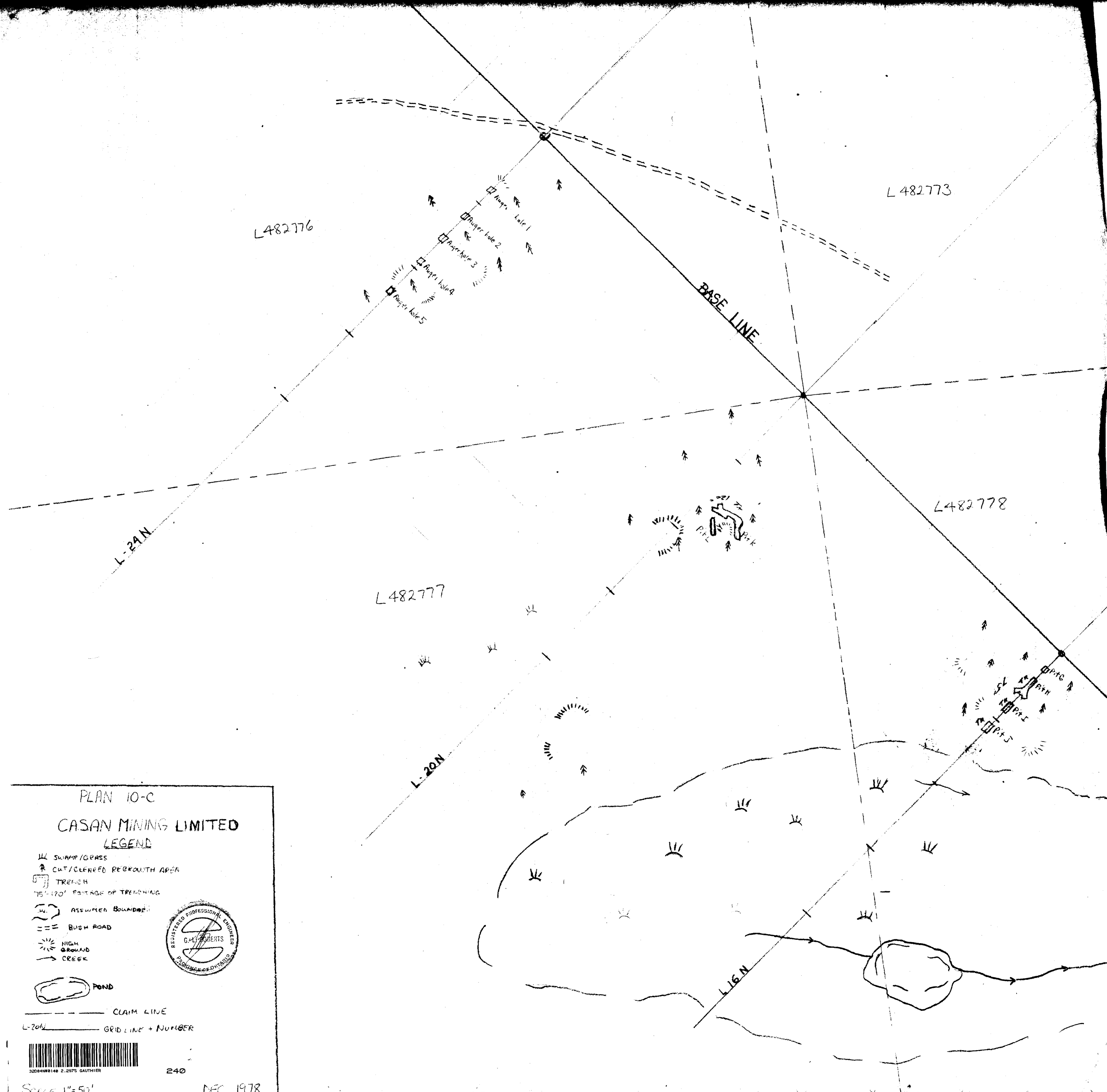

PLAN 10-C

CASAN MINING LIMITED

LEGEND

- ▨ SWAMP/GRASS
- ↑ CUT/CLEARED REBROUATH AREA
- ▭ TRENCH
- 75'-120' PORTAGE OF TRENCHING
- ⌋ ASSUMED BOUNDARY
- === BUSH ROAD
- ☀ HIGH GROUND
- CREEK



POND

--- CLAIM LINE

L-20N GRID LINE + NUMBER



240

SCALE 1"=50'

DEC. 1978

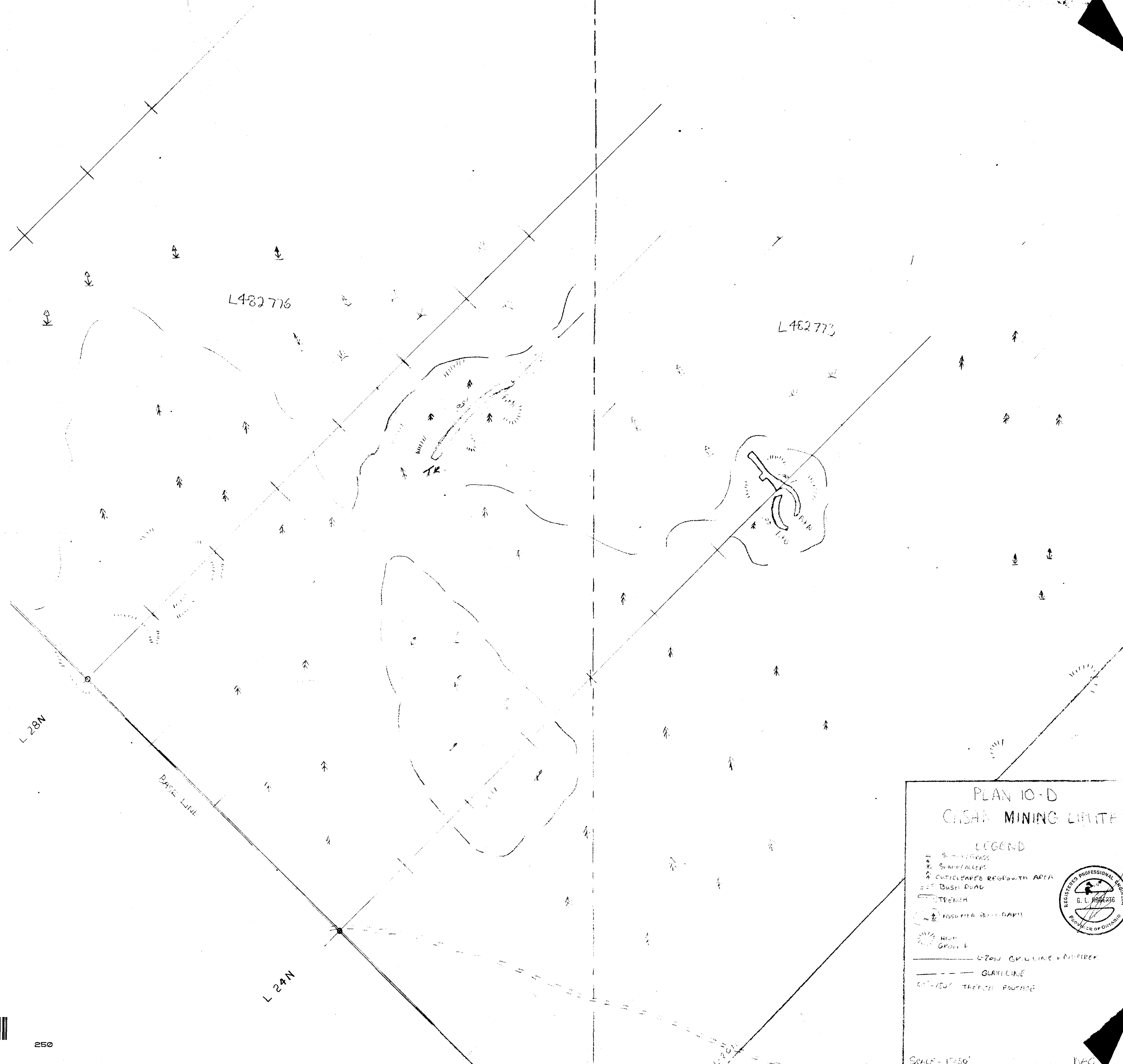

PLAN 10-D
CISA MINING LIMITED

LEGEND

- SURVEY POINTS
- ▲ SURVEY POINTS
- ▲ OUTCROPPED REGROWTH AREA
- BUSH ROAD
- TRENCH
- ISSUESIA BUSH PANS
- ☀ HIGH GROUND
- 6" ZONE GRAD LINE + 4" BUFFER
- GRAD LINE
- 60' WIDE TRENCH ROUTING

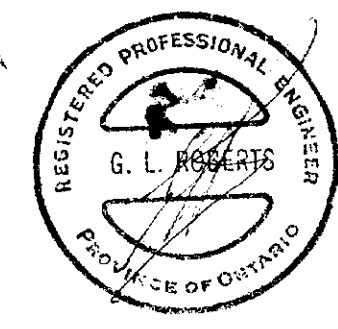

SCALE - 1"=50'

DEC

