

DIAMOND DRILLING



32D04NW0155 32 GAUTHIER

010

Township: Gauthier

Report No: 32

WORK PERFORMED FOR: Thomas Taylor

RECORDED HOLDER: SAME AS ABOVE [X]

: OTHER [ ]

<u>CLAIM No.</u>	<u>HOLE No.</u>	<u>FOOTAGE</u>	<u>DATE</u>	<u>NOTE</u>
L 78966	66-1	788'	June-July/66	(1)

NOTES: (1) placed on filed October 2/87

# DIAMOND DRILL HOLE LOG

Hole No. 66-1  
 Azimuth South  
 Dip -55° 200' -49°, 400' -39°, 600' -37°  
 Length 788'  
 Drilled By Heath and Sherwood Drilling Limited  
 Logged By J. G. Bragg  
 Date Started June 10, 1966  
 Date Completed July 7, 1966  
 Location Claim L-79866 580' North and 300' West of No. 2 Post  
 Size of Core AXT to 536, then EXT to End of Hole

*at 662' hole enters  
 Crested Butte  
 ground*

## LOG

0' - 173'	Overburden 0-110 Silty Sand 110-173 Gravel
173' - 234'	Light gray carbonate - sericite schist derived from 7 rhyolite or trachyte, Schistosity 55°. Occasional generally narrow fragmental zones with fragments 1/8" to 2" angular but somewhat indefinite.
234' - 244.3'	Sheared rhyolite flow breccia
244.3' - 245.7'	Vein - white quartz - carbonate chlorite Vn diagonal to core
245.7 - 249.2	Similar to 173' - 234'
249.2 - 293.0	Sheared rhyolite agglomerate. Abundant angular fragments. Lost core 277.7' - 279', 285' - 286', 292.0' - 292.8
293.0 - 397.7	Graphitic sediments. Contact at 293' sharp, not shown by core. Schistosity 55°, variable with local crystallizations. Occasional narrow bands and <sup>nodules</sup> <del>no</del> streaks of pyrite
397.7 - 435.0	Carbonate - sericite - biotite schist derived from rhyolite flow. Schistosity 45° to core. Five feet of ground core in section from 423' - 431', some cave this section. Three feet of ground core from 431' to 435'.
435.0 - 459.6	Sheared rhyolite flow breccia. Light gray occasional less than 1/8 inch white quartz stringers.
459.6 - 465.0	Ground Core
465.0 - 490.	Carbonate - sericite schist derived from flow breccia. Core badly broken up. Occasional white quartz stringers. Core angle 50° - 70°
490.0' - 526.0'	Dark gray carbonate sericite - chlorite schist derived from flow breccia. Occasional less than 4" near solid pyrite bands parallel schistosity (50° - 70° to core.) Some graphitic material along shear planes.
526.0 - 528.0	Ground Core
528.0 - 533.8	Similar to 490 - 526. Shearing 65° to core
533.8 - 536.0	Ground Core (Changed to E Core)

536.0 - 588.0	Banded graphitic sediments becoming graphite schist, locally slightly crenulated. Shearing and banding 70° - 75°. Few pyrite bands and nodules.
588.0 - 666.7	Graphitic sediments with abundant generally angular, Occasionally rounded pebbles. Finely banded sediments uncommon but occurring occasionally in short sections. Pyrite occurs as 1/8" to 1/2" blebs, generally irregular but occasionally well-rounded = ? pebble replacement.
666.7 - 669.0	Ground Core
669.0 - 737.3	Black to dark grey (graphitic) - biotite schist derived from sediments. Ghost-like squeezed pebbles and occasional possible boulder. Banding 60° - 70° occasional streak and blob of pyrite. Alternating grey and black beds width 1/8" to 6" Lost core 677-680, 725-726
737.3 - 741.0	Ground core
741.0 - 747.5	Black graphitic sediments, few very narrow grey bands
747.5 - 751.0	Ground Core
751.0 - 762.0	Similar to 741 - 747.5'
762.0 - 780.0	Grey sheared sediments with abundant angular black biotite and ? graphite fragments, 1/8" - 1/2" long oriented parallel to schistosity and banding. Numerous small sedimentary grains.
780.0 - 786.0	Ground Core
786.0 - 788.0	Similar to 762 - 780
788.0	End of Hole

66-1SAMPLINGOZ. AU./TON

197.3 - 198.0	1 1/2" White quartz stringer	.01
244.3 - 245.7	Vein	Tr
299.8 - 303.3	Graphite schist and pyrite bands	Tr
318.0 - 322.0	" " " "	Tr
360.0 - 364.0	" " " "	
406.7 - 408.0	Pyrite + 1 1/2" white quartz	Tr
437.5 - 440.0	Quartz Stringers	.02
456.0 - 459.6	" "	.01
472.0 - 473.0	" "	Tr
492.0 - 496.0	Pyrite Stringers	Tr
496.0 - 497.0	" "	Tr
517.6 - 518.1	5" White quartz Stringer	.03
524.5 - 525.6	Near Solid Pyrite	Tr
529.0 - 530.0	" "	.02
662.1 - 664.4	Rounded Pyrite Aggregates	Tr

W67 08 7725



32D04NW0155 32 GAUTHIER

900

ONTARIO

## THE MINING ACT REPORT OF WORK

required for each  
type of work to be  
recorded.To the Recorder of Larder Lake Mining DivisionI, Thomas Taylor B19987  
name of Recorded Holder Miner's LicenceDobu Ont.  
do hereby report the performance of 626 Post Office Address days of diamond drilling  
type of work

not before reported to be applied on the following contiguous claims

Claim No.	Days	Claim No.	Days	Claim No.	Days
L-77725	60	L-79866	40	L-79872	40
L-77726	-	L-79867	40	L-79873	40
L-77727	80	L-79868	40		
L-77728	80	L-79869	40		
L-77729	40	L-79870	40		
L-77730	40	L-79871	40		

All the work was performed on Mining Claim (s) L-79866  
(In the case of geological and/or geophysical survey (s) where more than 18 claims are involved attach a schedule)

## READ CAREFULLY: THE FOLLOWING INFORMATION IS REQUIRED BY THE MINING RECORDER.

For Manual Work, Stripping or Opening up of Mines, Sinking Shafts or Other Actual Mining Operations - Names and addresses of the men who performed the work and the dates and hours of their employment.

For Diamond and other Core Drilling - Footage, No. and angle of holes and diameter of core. Name and address of owner or operator of drill. Dates when drilling was done. Signed core log and sketch in duplicate.

For Compressed Air or Other Power Driven or Mechanical Equipment

Type of drill or equipment. Names and addresses of men engaged in operating equipment and the dates and hours of their employment.

For Power Stripping - Type of equipment. Name and address of owner or operator. Amount expended. Dates on which work was done. Proof of actual cost must be submitted within 30 days of recording.

With each of the above types of work sketches are required to show the location and extent of the work in relation to the nearest claim post. In the case of diamond or other core drilling the sketch must be submitted in duplicate.

For Geological and Geophysical Survey - The names and addresses of men employed as well as dates. Type of instrument used in the case of geophysical survey. Reports and maps in duplicate must be filed with the Minister within 60 days of recording.

For Land Survey - the name and address of Ontario Land surveyor.

The Required Information is as Follows: (Attach a list if this space is insufficient)

Hole 16-1 626 feet - 85° South AXT core taken  
 Heath & Sherwood Drilling Ltd.  
 1140s on Bay Ave Kirk Lake, Ont.  
 Toronto, Ont. 1966

Date Jan 4, 1967

Signature of Recorded Holder or Agent

The Mining Act  
Certificate Verifying Report of WorkI, John Gordon Bragg  
Dobu  
(Post Office Address)

hereby certify:

1. That I have a personal and intimate knowledge of the facts set forth in the report of work annexed hereto, having performed the work or witnessed same during and/or after its completion.
2. That the annexed report is true.

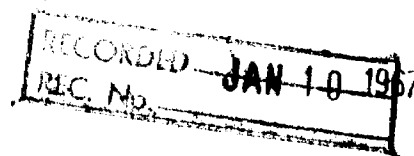
Dated Jan 4 19 67 Signature

THE PENALTY FOR MAKING A FALSE STATEMENT IN THIS REPORT AND/OR CERTIFICATE IS \$500. OR SIX MONTHS IMPRISONMENT OR BOTH

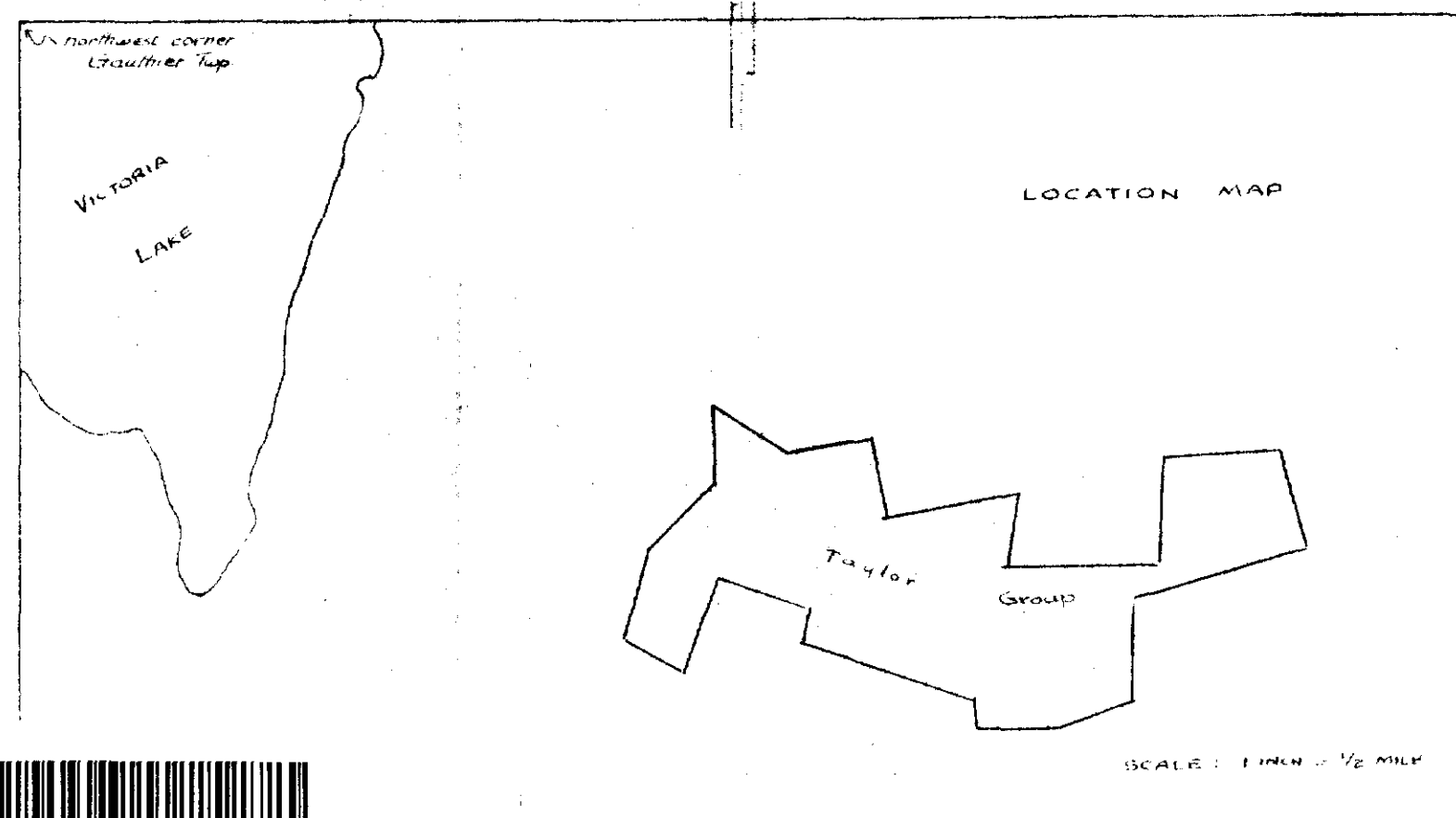
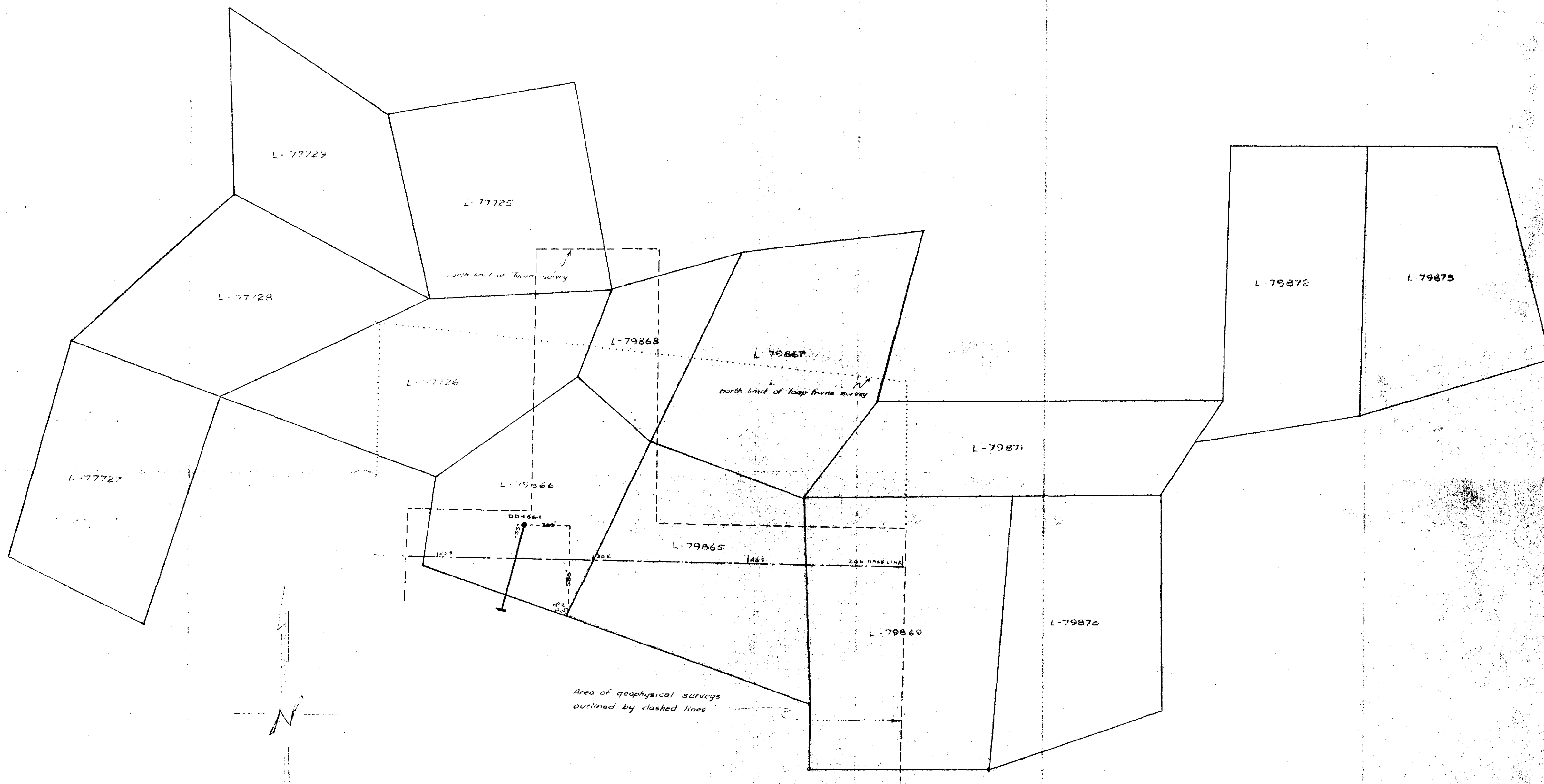

GAUTHIER DDR #32

NO.		REFERENCE DRWGS.		UPPER CANADA MINES LTD.	
		Shows location of D.D.H. 66-1		<b>TAYLOR OPTION</b> <b>GAUTHIER TWP.</b>	
BY	DATE	REVISIONS		DRAWN AND	DATE
				CHECKED	SCALE
				APPROVED	1" = 400'



32084N0155 32 GAUTHIER