



Ministry of Northern Development and Mines

Ministère du Développement du Nord et des Mines

Diamond Drilling Log Journal de forage au diamant

Complete this form and related sketch in duplicate. Remplir en deux exemplaires la présente formule et le croquis annexé

32D04NW0157 W9390.00347 MORRISSETTE

010

Forage n° ML-1-93  
Page n°

Drilling Company: T. LINK  
 Date Started: JULY 1/93  
 Date Completed: JULY 20/93  
 Exploration Co. Owner or Options: TERRY LINK  
 Company of exploration, proprietor or titulaire d'option: TERRY LINK

Collar Elevation: 970'  
 Bearing of hole from true North/Position du forage par rapport au nord vrai: South  
 Dip of Hole at Inclinaison du forage au Collar/collier: 48°  
 Logged by: TERRY LINK  
 Date of description: DEC. 20/93  
 Submitted by (Signature): TERRY LINK  
 Date Submitted: DEC. 23/93  
 Deposited by (Signature): TERRY LINK  
 Date of deposit: DEC. 23/93

Address/Location where core stored: Core stored at William Link Residence, Lot 4, Con. 1 Harris Twp. Morrisette Township

Map Reference No. G-3217  
 Location (Twp, Lot, Con. or Lat. and Long.): Morrisette Township  
 Claim No. L. 802834

Footage/Avancement From/De	To/A	Rock Type Type de roche	Description (Colour, grain size, texture, minerals, alteration, etc.)	Core Section Sample Length (m) / Longueur de l'échantillon	Your Sample No. / N° d'échantillon du prospecteur	Sample Footage/Inventaire de prélèvement (m) / Longueur de l'échantillon	From/De	To/A	Assays T/Analyses minéralurgiques
0	1	CASING							
1	35	DACITE	1-30' breccia - light green fragments in black matrix. Size of fragments less than 2" in diameter. At 16' - 2" white quartz vein at 60° to core axis. At 20' - 3" " " 30° " " 30-35' flow - very fine grained, light green. 35' - 187' very fine grained, grey-green. Numerous quartz and calcite stringers. 187' - 212' schist - grey, green, brown laminations trace to 1" pyrite. Quartz carb. veins up to 4" wide, mostly at 500° to core axis. 212' - 233' tuff - grey blue with white mineral speckled throughout. Occasional quartz-carb veinlets. 233' - 259' breccia - light green fragments in grey blue matrix. 259' - 282' very fine grained, green-green andesite. 282' - 285' breccia as above.						
35	556	ANDESITE							

Property Name: MALLARD LAKE

Additional credit available. See Assessment Work Regulation.  
 † Des crédits supplémentaires sont offerts. Consulter les règlements relatifs aux travaux d'évaluation.  
 Nota: Dans cette formule, lorsqu'il désigne des personnes, le masculin est utilisé au sens neutre.



Ministry of Northern Development and Mines

Ministère du Développement du Nord et des Mines

**Diamond Drilling Log**  
Journal de forage au diamant

Complete this form and related sketch in duplicate. Remplir en deux exemplaires la présente formule et le croquis annexé

Fill in on every page. Remplir ces cases à chaque page

Hole No. Forage n°: **ML-1-93**  
Page No. Page n°: **2**

Drilling Company Compagnie de forage		Bearing of hole from true North/Position du forage par rapport au nord vrai		Dip of Hole at Inclinaison du forage au Collar/collier		Address/Location where core stored Adresse/endroit où la carotte est stockée		Reference No. N° de référence sur la carte		Claim No. N° de concession minière	
Date Started Date de commencement du forage		Collar Elevation Élévation du collier		Logged by Inscrit par		Year Sample No. N° d'échantillon du prospecteur		Sample Length Longueur de l'échantillon		Location (Twp. Loc. Con. or Lat. and Long.) Emplacement (canton, lot, concession, ou latitude et longitude)	
Date Completed Date d'achèvement		Date Logged Date d'inscription au journal		Submitted by (Signature) Déposé par (signature)		Core Number N° de carottes		Property Name Nom de la propriété			
Exploration Co., Owner or Operator Compagnie d'exploration, propriétaire ou titulaire d'option		Date Submitted Date de dépôt		Description (Colour, grain size, texture, minerals, alteration, etc.) Description (Couleur, granulométrie, texture, minéraux, transformation, etc.)		Assays / Analyses minéralurgiques					
Footage/Avancement		Rock Type Type de roche									
From/De	To/A										
				285'-307' fine grained, grey-green andesite with trace to 1% pyrite. Chloritic gashes throughout. Occasional quartz-carbonate veins at 65:75° to core axis.							
				307'-470' glomerophyritic andesite flow - fine grained at edges grading to coarse grained at center of flow. Medium green with very pale green phenocrysts. Chloritic gashed throughout.							
				414'-416' irregular pink quartz vein + epidote.							
				470'-488' amygdaloidal andesite - green-grey, medium grained, grading to fine grained. Amygdules 1/4" to 1/2" in diameter, dark green to emerald green carbonate and are translucent. Some stringers + veinlets of quartz-carbonate.							
				499' - 1" quartz-carb. vein at 10° to core axis							
				494' - 2" " " " 70° " " "							
				488' - 498' fragmental - white to light green angular fragments in dark green matrix. Size up to 1/4" diameter.							
				At 498' - 1" quartz-carb. vein at 40° to core axis.							

6204 (03/91)  
 \* For features such as foliation, bedding, schistosity, measured from the long axis of the core.  
 \* Exemples de caractéristiques : foliation, schistosité, stratification. L'angle est mesuré par rapport à l'axe longitudinal de la carotte.  
 † Additional credit available. See Assessment Work Regulation.  
 † Des crédits supplémentaires sont offerts. Consulter les règlements relatifs aux travaux d'évaluation.  
 Nota : Dans cette formule, lorsqu'il désigne des personnes, le masculin est utilisé au sens neutre.



Ministry of Northern Development and Mines

**Diamond Drilling Log**

**Journal de forage au diamant**

Complete this form and related sketch in duplicate. Remplir en deux exemplaires la présente formule et le croquis annexé

Fill in on every page Rempilr ces cases à chaque page

Hole No. Forage n° **ML-93**  
Page No. Page n° **3**

Drilling Company Compagnie de forage		Collar Elevation Elevation du collier		Basing of hole from true North/Position du forage par rapport au nord vrai		Dip of Hole at Inclination du forage au	
Date Hole Started Date de commencement du forage		Date Logged Date d'inscription au journal		Logged by Inscrit par		Collar/collier	
Date Completed Date d'achèvement		Date Submitted Date de dépôt		Submitted by (Signature) Déposé par (signature)		P.L.M.	
Exploration Co., Owner or Optionee Compagnie d'exploration, propriétaire ou titulaire d'option							
Address/Location where core stored Adresse/endroit où le carotte est stockée				Map Reference No. N° de référence sur la carte			
Location (Twp, Lot, Con. or Lat. and Long.) Emplacement (canton, lot, concession, ou latitude et longitude)				Property Name Nom de la propriété			

Footage/Avancement From/De	Rock Type Type de roche	Description (Colour, grain size, texture, minerals, alteration, etc.) Description (Couleur, granulométrie, texture, minéraux, transformation, etc.)	Core Interval Intervalle de carottage	Year Sample No. N° d'échantillon du prospecteur	Sample Description Description de l'échantillon	From/De	Total	Assays †/Analyses minéralurgiques
		493'-495' quartz-carb. veinlets minor pyrite						
		498'-549' andesoidal andesite - light green, very fine grained. Amibolites are 1/4" to 1/2" in diameter.						
		549'-550' 4" Interflow sediment - dark grey with 3% pyrite overall.						
		551'-554" breccia						
		554'-556' rock mottled light green and grey-green						
556 970	BASALT	556-577' fine grained grey-green						
		577'-594' fine grained lighter green						
		594'-613' fine grained light grey						
		Extensive irregular quartz filled hairline fractures in above sections.						
		613'-789' very fine to fine grained grey-green						
		with occasional quartz stringers and veins						
		741'-746' Spiditized						
		754'-756' "						
		762'-762' 8" "						

0204 (03/81) \* For features such as foliation, bedding, schistosity, measured from the long axis of the core.  
\* Exemples de caractéristiques : foliation, schistosité, stratification. L'angle est mesuré par rapport à l'axe longitudinal de la carotte.  
† Additional credit available. See Assessment Work Regulation.  
† Des crédits supplémentaires sont offerts. Consulter les règlements relatifs aux travaux d'évaluation.



Ministry of Northern Development and Mines

Ministère du Développement du Nord et des Mines

**Diamond Drilling Log**

**Journal de forage au diamant**

Complete this form and related sketch in duplicate. Remplir en deux exemplaires la présente formule et le croquis annexé

File No. Forage n° **ML-1-93**  
Page No. Page n° **4**

Drilling Company / Compagnie de forage

Date Hole Started / Date de commencement du forage

Exploration Co., Owner or Optionee / Compagnie d'exploration, propriétaire ou titulaire d'option

Collar/Elevation / Élévation du collier

Dip of Hole at / Inclinaison du forage au

Stamp of hole from true North / Position du forage par rapport au nord vrai

Total Footage / Avancement total du forage

Logged by / Inscrit par

Date Logged / Date d'inscription au journal

Date Submitted / Date de dépôt

Submitted by (Signature) / Déposé par (signature)

Map Reference No. / N° de référence sur la carte

Location (Twp, Lot, Con. or Lat. and Long.) / Emplacement (canton, lot, concession, ou latitude et longitude)

Property Name / Nom de la propriété

Footage/Avancement From/De	Rock Type Type de roche	Description (Colour, grain size, texture, minerals, alteration, etc.) Description (Couleur, granulométrie, texture, minéraux, transformation, etc.)	Core Interval / Longueur de la carotte (en pieds)	Sample Characteristics / Caractéristiques de l'échantillon		Assays / Analyses minéralurgiques
				From/De	To/A	
		773'-789' amygdaloidal				
		789'-925' fine to medium grained grey-green				
		857'-858'6" graphite seams with minor pyrite and magnetite				
		892'-917' numerous quartz stringers and veinlets				
		900'-901' irregular white quartz vein with a few chalcocypite grains				
		925'-970' medium to coarse grained basalt				
		927'-953' magnetite disseminated throughout				
		970' end of hole				

0204 (02/81)

\* For features such as foliation, bedding, schistosity, measured from the long axis of the core.  
\* Exemples de caractéristiques : foliation, schistosité, stratification. L'angle est mesuré par rapport à l'axe longitudinal de la carotte.

† Additional credit available. See Assessment Work Regulation.  
† Des crédits supplémentaires sont offerts. Consulter les règlements relatifs aux travaux d'évaluation.  
Nota : Dans cette formule, lorsqu'il désigne des renseignements le machinisme utilisé au cours des travaux.

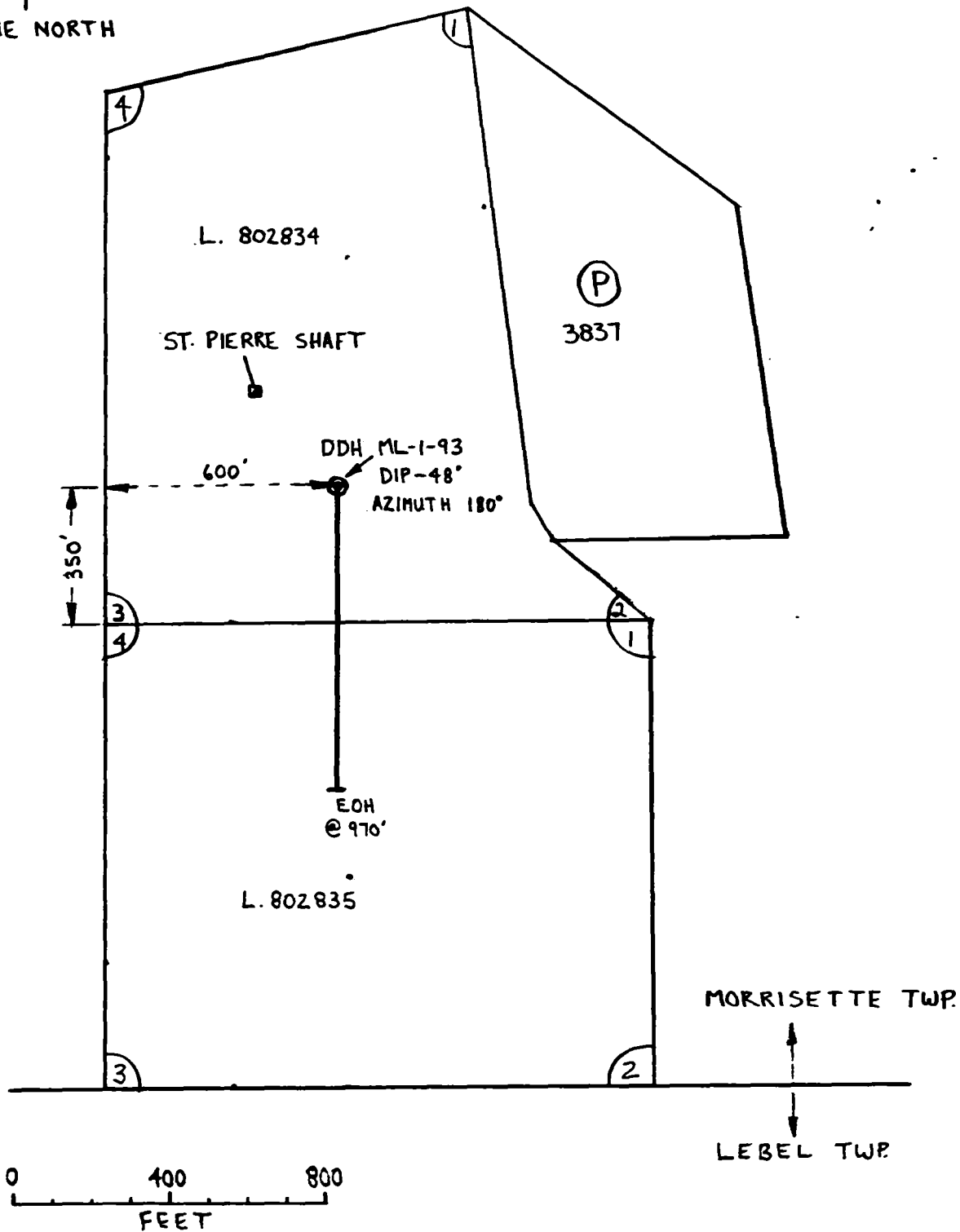
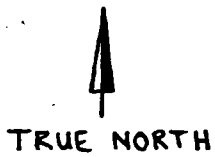

DIAMOND DRILL HOLE LOCATION  
PLAN MAP  
DDH ML-1-93  
MORRISETTE TWP.  
T. LINK DEC. 1993

ML-1-93

DACITE

Breccia

CLAIM # L 802834

CLAIM # L 802835

Shist

Tuff

Breccia

Breccia

ANDESITE

Glomeroporphyritic

Amygdaloidal

Breccia

Amygdaloidal

Interflow Sediment

Amygdaloidal

Graphite, pyrite, magnetite

Disseminated magnetite  
~ 2%

BASALT

DRILL HOLE SECTION

DDH: ML-1-93

DIP: 48° AT COLLAR

AZIMUTH: 180°

T. LINK DEC. 1993

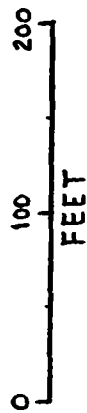

EOH @ 970'

# Report of Work Conducted After Recording Claim

## Mining Act

Transaction Number  
DOCUMENT NO.  
9380-00347

Personal information collected on this form is obtained under the authority of the Mir this collection should be directed to the Provincial Manager, Mining Lands, Minis Sudbury, Ontario, P3E 6A5, telephone (705) 670-7264.

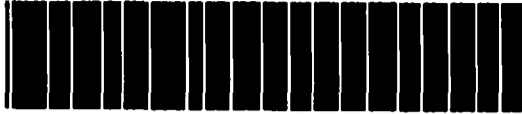

32D04NW0157 W9380.00347 MORRISETTE

900

- Instructions:**
- Please type or print and submit in duplicate.
  - Refer to the Mining Act and Regulations for requirements of filing assessment work or consult the Mining Recorder.
  - A separate copy of this form must be completed for each Work Group.
  - Technical reports and maps must accompany this form in duplicate.
  - A sketch, showing the claims the work is assigned to, must accompany this form.

Recorded Holder(s) <b>TERRY LINK</b>		Client No. <b>160409</b>
Address <b>240 GEORGINA AVE, APT 108, HAILEYBURY, ONT POJ-1KO</b>		Telephone No. <b>(705) 672-3851</b>
Mining Division <b>LARDER LAKE</b>	Township/Area <b>MORRISETTE TWP.</b>	M or G Plan No. <b>G-3217</b>
Dates Work Performed From: <b>JULY 1/93</b>		To: <b>JULY 20/93</b>

**Work Performed (Check One Work Group Only)**

Work Group	Type
Geotechnical Survey	
Physical Work, Including Drilling	<b>DIAMOND DRILLING, MOBILIZATION &amp; DEMOBILIZATION</b>
Rehabilitation	
Other Authorized Work	
Assays	
Assignment from Reserve	

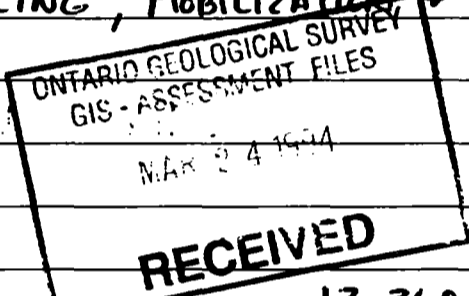

Total Assessment Work Claimed on the Attached Statement of Costs \$ **13,360.00**

**Note:** The Minister may reject for assessment work credit all or part of the assessment work submitted if the recorded holder cannot verify expenditures claimed in the statement of costs within 30 days of a request for verification.

**Persons and Survey Company Who Performed the Work (Give Name and Address of Author of Report)**

Name	Address
<b>TERRY LINK</b>	<b>240 GEORGINA AVE., HAILEYBURY, ONT POJ-1KO</b>

(attach a schedule if necessary)

**Certification of Beneficial Interest \* See Note No. 1 on reverse side**

I certify that at the time the work was performed, the claims covered in this work report were recorded in the current holder's name or held under a beneficial interest by the current recorded holder.	Date <b>DEC. 23/93</b>	Recorded Holder or Agent (Signature) <i>Terry Link</i>
--	---------------------------	---

**Certification of Work Report**

I certify that I have a personal knowledge of the facts set forth in this Work report, having performed the work or witnessed same during and/or after its completion and annexed report is true.		
Name and Address of Person Certifying <b>TERRY LINK 240 GEORGINA AVE., HAILEYBURY, ONT. POJ-1KO</b>		
Telephone No. <b>(705) 672-3851</b>	Date <b>DEC 23/93</b>	Certified By (Signature) <i>Terry Link</i>

**For Office Use Only**

Total Value Cr. Recorded <b># Applied 2040.</b>	Date Recorded <b>Dec 23/93</b>	Mining Recorder <i>Ray Stoll</i>	Received Stamp <b>RECEIVED</b>
Deemed Approval Date <b>March 23/94</b>	Date Approved <b>Mar 22/94</b>	Date Notice for Amendments Sent	
Reserve \$ <b>11320</b>			

Work Report Number Applying for Reserve	Claim Number (see Note 2)	Number of Claim Units
	L 802834	1
	L 802835	1
	L 1013303	1
	L 1013304	1
	L 1013305	1
Total Number of Claims		5

Value of Assessment Work Done on this Claim	Value Applied to this Claim	
\$ 6,000.00		
\$ 7,360.00		
	\$ 680.00	
	\$ 680.00	
	\$ 680.00	
Total Value Work Done		\$ 13,360.00
Total Value Work Applied		\$ 2,040.00

Value Assigned from this Claim	Reserve: Work to be Claimed at a Future Date	
\$ 2,040.00	\$ 3,960.00	
	\$ 7,360.00	
Total Assigned From		\$ 2,040.00
Total Reserve		\$ 11,320.00

Credits you are claiming in this report may be cut back. In order to minimize the adverse effects of such deletions, please indicate from which claims you wish to prioritize the deletion of credits. Please mark (✓) one of the following:

- 1.  Credits are to be cut back starting with the claim listed last, working backwards.
- 2.  Credits are to be cut back equally over all claims contained in this report of work.
- 3.  Credits are to be cut back as prioritized on the attached appendix.

In the event that you have not specified your choice of priority, option one will be implemented.

**Note 1:** Examples of beneficial interest are unrecorded transfers, option agreements, memorandum of agreements, etc., with respect to the mining claims.

**Note 2:** If work has been performed on patented or leased land, please complete the following:

I certify that the recorded holder had a beneficial interest in the patented or leased land at the time the work was performed.	Signature	Date
---	-----------	------



Statement of Costs for Assessment Credit

État des coûts aux fins du crédit d'évaluation

Mining Act/Loi sur les mines

Transaction No./N<sup>o</sup> de transaction: DOCUMENT No.:  
9380 - 00347

Personal information collected on this form is obtained under the authority of the Mining Act. This information will be used to maintain a record and ongoing status of the mining claim(s). Questions about this collection should be directed to the Provincial Manager, Minings Lands, Ministry of Northern Development and Mines, 4th Floor, 159 Cedar Street, Sudbury, Ontario P3E 6A5, telephone (705) 670-7264.

Les renseignements personnels contenus dans la présente formule sont recueillis en vertu de la Loi sur les mines et serviront à tenir à jour un registre des concessions minières. Adresser toute question sur la collecte de ces renseignements au chef provincial des terrains miniers, ministère du Développement du Nord et des Mines, 159, rue Cedar, 4<sup>e</sup> étage, Sudbury (Ontario) P3E 6A5, téléphone (705) 670-7264.

1. Direct Costs/Coûts directs

Type	Description	Amount Montant	Totals Total global
Wages Salaires	Labour Main-d'oeuvre		
	Field Supervision Supervision sur le terrain		
Contractor's and Consultant's Fees Droits de l'entrepreneur et de l'expert-conseil	Type DIAMOND DRILLING		
	970' x 13.00/A.		\$12,610.00
Supplies Used Fournitures utilisées	Type		
Equipment Rental Location de matériel	Type		
Total Direct Costs / Total des coûts directs			\$12,610.00

2. Indirect Costs/Coûts indirects

\*\* Note: When claiming Rehabilitation work Indirect costs are not allowable as assessment work. Pour le remboursement des travaux de réhabilitation, les coûts indirects ne sont pas admissibles en tant que travaux d'évaluation.

Type	Description	Amount Montant	Totals Total global
Transportation Transport	Type		
Food and Lodging Nourriture et hébergement			
Mobilization and Demobilization Mobilisation et démobilitation	Mobilization	450.00	450.00
	Demobilization	300.00	300.00
Sub Total of Indirect Costs / Total partiel des coûts indirects			\$750.00
Amount Allowable (not greater than 20% of Direct Costs) / Montant admissible (n'excédant pas 20 % des coûts directs)			\$750.00
Total Value of Assessment Credit (Total of Direct and Allowable Indirect costs) / Valeur totale du crédit d'évaluation (Total des coûts directs et indirects admissibles)			\$13,360.00

Note: The recorded holder will be required to verify expenditures claimed in this statement of costs within 30 days of a request for verification. If verification is not made, the Minister may reject for assessment work all or part of the assessment work submitted.

Note: Le titulaire enregistré sera tenu de vérifier les dépenses demandées dans le présent état des coûts dans les 30 jours suivant une demande à cet effet. Si la vérification n'est pas effectuée, le ministre peut rejeter tout ou une partie des travaux d'évaluation présentés.

Filing Discounts

- Work filed within two years of completion is claimed at 100% of the above Total Value of Assessment Credit.
- Work filed three, four or five years after completion is claimed at 50% of the above Total Value of Assessment Credit. See calculations below:

Total Value of Assessment Credit	Total Assessment Claimed
	x 0.50 =

Remises pour dépôt

- Les travaux déposés dans les deux ans suivant leur achèvement sont remboursés à 100 % de la valeur totale susmentionnée du crédit d'évaluation.
- Les travaux déposés trois, quatre ou cinq ans après leur achèvement sont remboursés à 50 % de la valeur totale du crédit d'évaluation susmentionné. Voir les calculs ci-dessous.

Valeur totale du crédit d'évaluation	Evaluation totale demandée
	x 0,50 =

Certification Verifying Statement of Costs

I hereby certify: that the amounts shown are as accurate as possible and these costs were incurred while conducting assessment work on the lands shown on the accompanying Report of Work form.

that as TERRY LINK I am authorized (Recorded Holder, Agent, Position in Company)

to make this certification

Attestation de l'état des coûts

J'atteste par la présente: que les montants indiqués sont le plus exact possible et que ces dépenses ont été engagées pour effectuer les travaux d'évaluation sur les terrains indiqués dans la formule de rapport de travail ci-joint.

Et qu'à titre de \_\_\_\_\_ je suis autorisé (titulaire enregistré, représentant, poste occupé dans la compagnie)

à faire cette attestation.

Signature: Terry Link Date: Dec. 23/93

**REFERENCES**

**AREAS WITHDRAWN FROM DISPOSITION**

- M R O MINING RIGHTS ONLY
- S R O SURFACE RIGHTS ONLY
- M + S MINING AND SURFACE RIGHTS

Description	Order No.	Date	Disposition	File
Section 36/101	118 W 2079	5-1-9	M.R.M.R.	160705
Section 36/101	118 W 2079	5-1-9	M.R.M.R.	160705

SAND and GRAVEL

THE INFORMATION THAT APPEARS ON THIS MAP HAS BEEN COMPILED FROM VARIOUS SOURCES, AND ACCURACY IS NOT GUARANTEED. THOSE WISHING TO STAKE MINING CLAIMS SHOULD CONSULT WITH THE MINING RECORDER, MINISTRY OF NORTHERN DEVELOPMENT AND MINES, FOR ADDITIONAL INFORMATION ON THE STATUS OF THE LANDS SHOWN HEREON.

**NOTES**

Surface rights on Mining Claim L 10772 temporarily withdrawn File 43155

Mining Claims outlined thus are subject to rights and privileges granted by Mining Court Order April 1, 1946 File: 19697

**NOTICE OF FORESTRY ACTIVITY**

THIS TOWNSHIP / AREA FALLS WITHIN THE TIMISKAMING MANAGEMENT UNIT AND MAY BE SUBJECT TO FORESTRY OPERATIONS. THE MNR UNIT FORESTER FOR THIS AREA CAN BE CONTACTED AT: P.O. BOX 129 SWASTKA, ONT. POK ITO 705-642-3222

**Bisley Twp.**

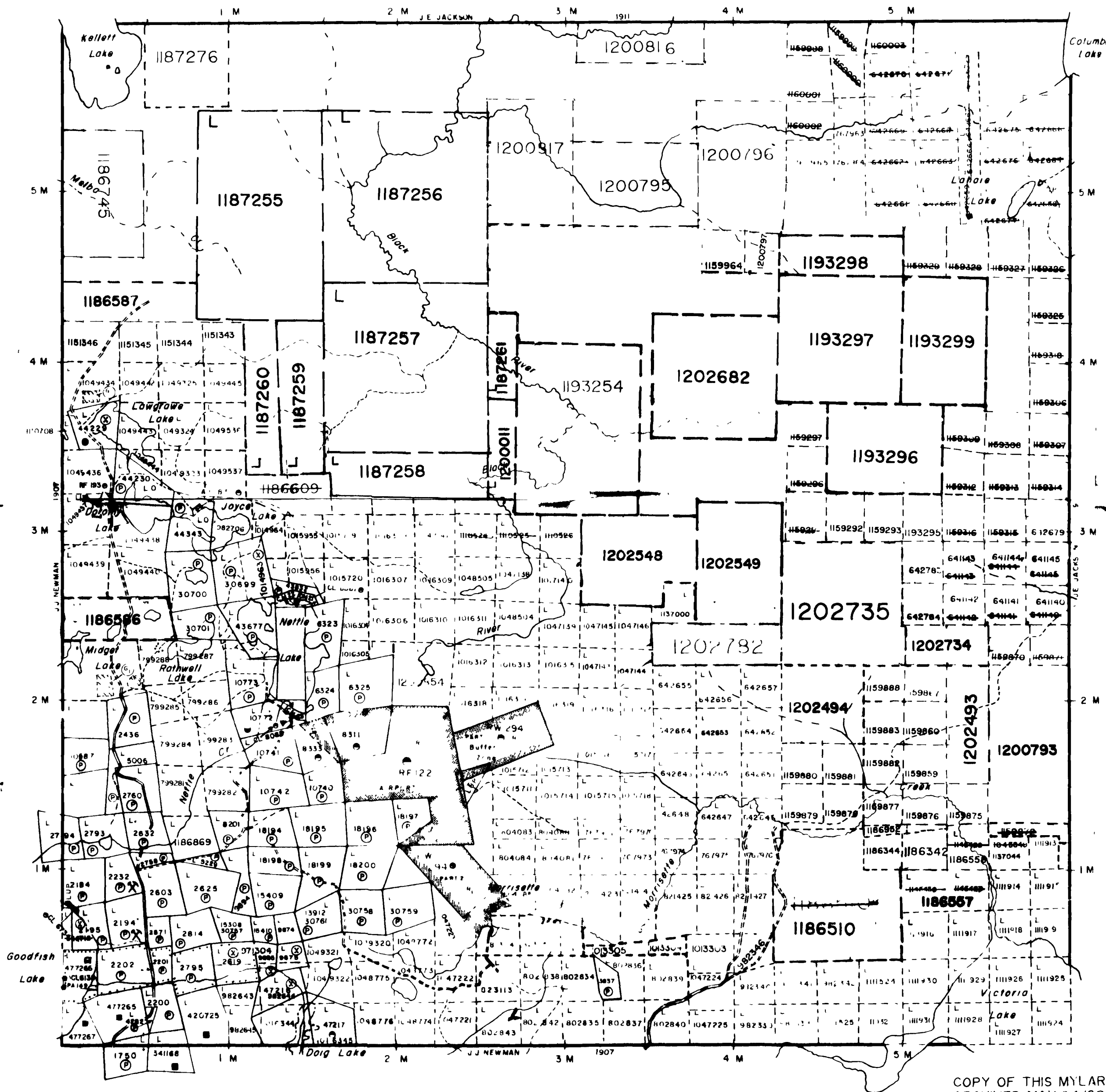

COPY OF THIS MYLAR ARCHIVED MAY 04/92  
ARCHIVED MAY 31, 1994

**LEGEND**

- HIGHWAY AND ROUTES
- OTHER ROADS
- TRAILS
- SURVEYED LINES
- TOWNSHIP BASE LINES ETC.
- LOTS MINING CLAIMS ETC.
- INSURVED LINES
- LOT LINES
- PARCEL BOUNDARY
- MINING CLAIMS ETC.
- RAILWAY AND RIGHT OF WAY
- UTILITY LINES
- NON PERENNIAL STREAM
- FLOODING OR FLOODPLAIN
- SUBDIVISION OR DISPOSITION PLAN
- RESERVATIONS
- ORIGINAL SHORELINE
- MARSH OR MUSKELGEE
- MINES
- TRAVERSE MONUMENT

**DISPOSITION OF CROWN LANDS**

TYPE OF DOCUMENT	SYMBOL
PATENT SURFACE & MINING RIGHTS	○
SURFACE RIGHTS ONLY	○
MINING RIGHTS ONLY	○
LEASE SURFACE & MINING RIGHTS	○
SURFACE RIGHTS ONLY	○
MINING RIGHTS ONLY	○
LICENCE OF OCCUPATION	○
ORDER IN COUNCIL	○
RESERVATION	○
CANCELLED	○
SAND & GRAVEL	○

NOTE: MINING RIGHTS IN PARCELS PAID FOR BY THE MAJOR INTERESTED PARTIES UNDER THE PROVISIONS OF THE CROWN LANDS ACT, 1910, ARE NOT SHOWN ON THIS MAP.

SCALE 1 INCH = 40 CHAINS

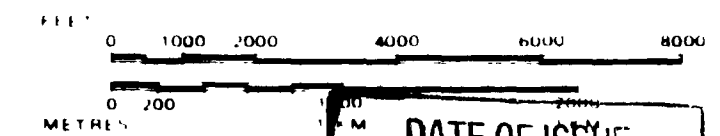

DATE OF ISSUE

JUL 12 1994

TOWNSHIP LARDER LAKE MINING RECORDER'S OFFICE

**MORRISETTE**

M.N.R. ADMINISTRATIVE DISTRICT  
KIRKLAND LAKE  
MINING DIVISION  
LARDER LAKE  
LAND TITLES / REGISTRY DIVISION  
TIMISKAMING



Date JANUARY 1985

Number

G-3217

CIRCULATED FEB 26, 1990



32D4NW0167 W9380 00347 MORRISETTE