

32D04NW0162 12 GAUTHIER

Diamond Drilling

010

Township of GAUTHIER

Report No: 12

Work performed by: Lake Beaverhouse Mines Ltd.

Claim No	Hole No	Footage	Date	Note
L 67180	A-1	504'	June/61	

Notes:

REPORT of WORK.

Claim No. L-67180.

Gauthier Township.

scale; 1 inch - 250 feet.

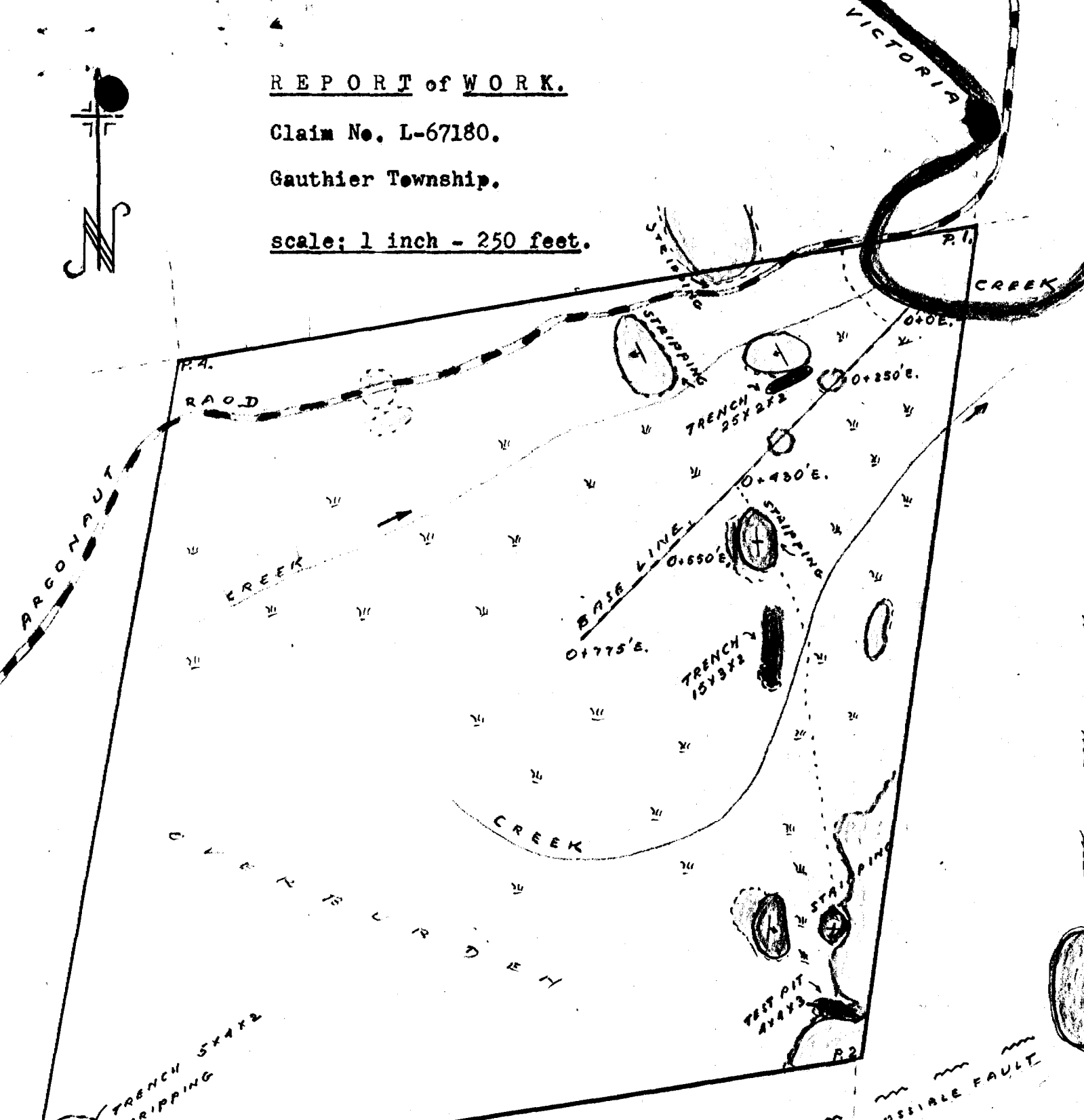
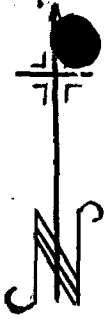

LEGEND

- SIGNS
- TRENCH
 - TEST PIT AND VEIN
 - STRIKE & DIP OF SCHIST.
 - SWAMP
 - OVERBURDEN

- FEEDSPAR PORPH.
- BASIC SYENITE
- TUFF
- LAMPROPH.
- BASIC VOLCAN.
- ACID VOLCAN.

1-27180

DIAMOND DRILL RECORD

PROPERTY Lake Beaverhouse Mines Ltd. 21 Claim Group

LAT. 180' South No. 1 Post

LOCATION: DEP. 400' West No. 1 Post

ELEVATION OF COLLAR Gauthier Twpnship

DATUM Claim L-67180

DIRECTION AT START: BEARING S 56 W
DIP -45

LOGGED BY W. Hainsworth HOR. COMP. _____

PURPOSE OF HOLE _____ VER. COMP. _____

TESTS

Ft.	Dip.	Ast. Bearing	Ft.	Dip.	Ast. Bearing	Core	
						Ft. Received	p.c. Recovery

HOLE NUMBER A-1

SHEET NO. 1

SECTION FROM 0' TO 504'

STARTED June 2 - 1961

COMPLETED June 7 - 1961

ULTIMATE DEPTH 504'

PROPOSED DEPTH _____

DRILLED BY Continental Diamond Drilling

HONEY PRINTING SERVICE, TORONTO-4604

Distance		ROCK	DESCRIPTION	Sample No.	Length Ft.	ANALYSIS								
From	To					As.	Ag.	Pb.	Zn.	Cu.		Ave.		
0	31	Casing												
31	24	Fragmental Tuff	Light grey, siliceous, locally showing good banding at 60° to core. from 70.4-71, splashes of qtz at 88.2, 1" qtz strg at 121.9, 1" bank bullish qtz vein											
124	149	Greywache	Siliceous, at 131, 1" qtz-carbonate vein from 141-144, series of qtz-brown carbonate strgs											
149	504	Fragmental Tuff	As before, local heavy contorted bedding From 149-153, carbonated at 246.5, minor pyrite and sl. qtz. from 311-312, few qtz strgs at 55° to core from 333.5-338, carbonated Possible <u>fault</u> structure at 336' from 345-346, bullish qtz vein from 428-429.5, altered with qtz carbonate strgs from 432.5-434.5 - Lost core at 444.5, 6" qtz vein at 469, lightly altered											
	504	-----	End of Hole											

CORE DIAMETER = 1 1/4" (A-X)

John R. Brudger P. Eng.

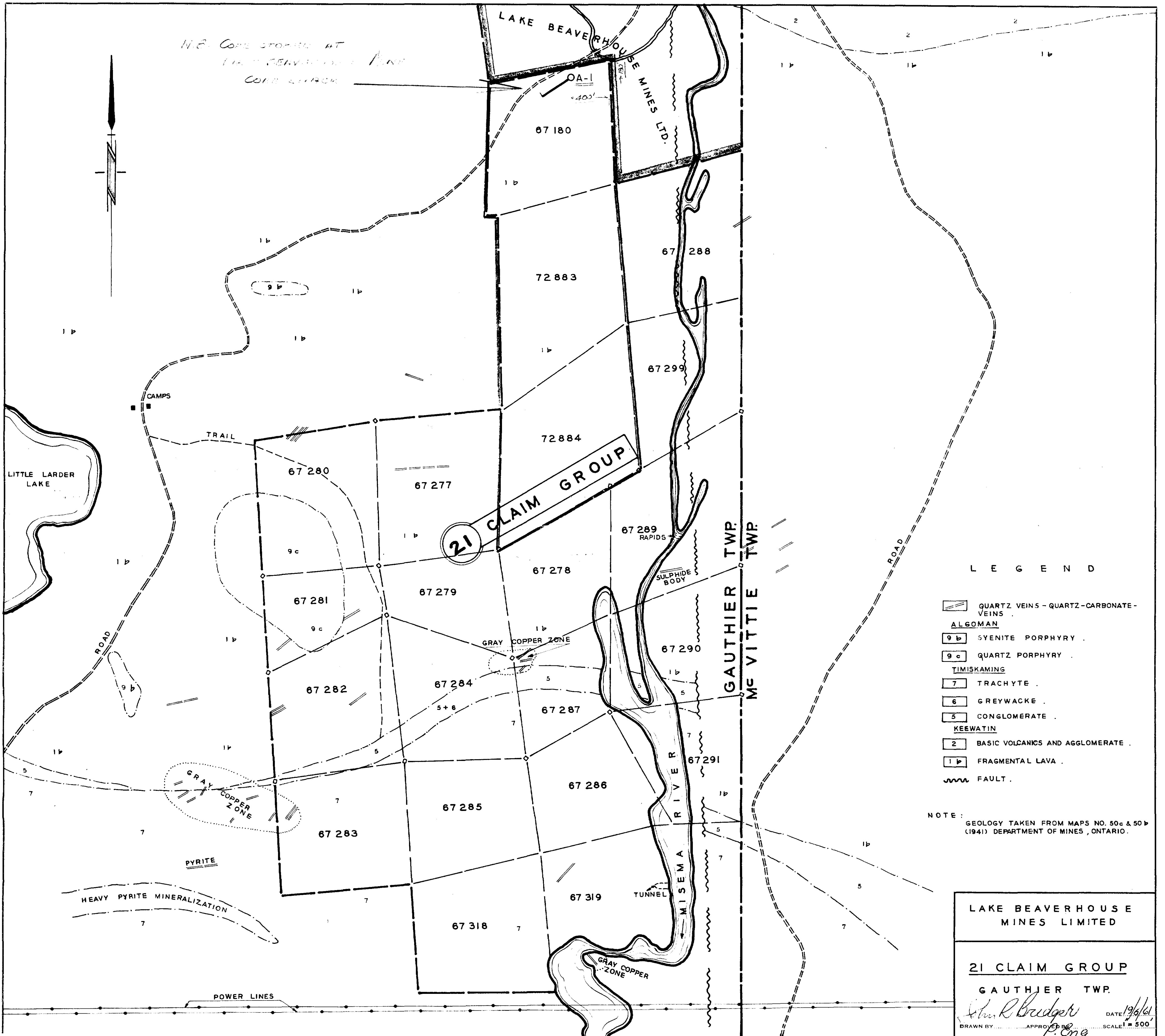

N.B. Core stopped at
 100' level
 Core stuck

21 CLAIM GROUP

LEGEND

- QUARTZ VEINS - QUARTZ-CARBONATE-VEINS
- ALGOMAN**
- SYENITE PORPHYRY
- QUARTZ PORPHYRY
- TIMISKAMING**
- TRACHYTE
- GREYWACKE
- CONGLOMERATE
- KEEWATIN**
- BASIC VOLCANICS AND AGGLOMERATE
- FRAGMENTAL LAVA
- FAULT

NOTE: GEOLOGY TAKEN FROM MAPS NO. 50c & 50d (1941) DEPARTMENT OF MINES, ONTARIO.

LAKE BEAVERHOUSE
 MINES LIMITED

21 CLAIM GROUP

GAUTHIER TWP.

Drawn by *Wm R. Budgett* DATE 19/6/61
 Approved by *P. Eng* SCALE 1" = 500'

