



32D04NW0288 39 LEBEL

010

DIAMOND DRILLING

TOWNSHIP: LEBEL

REPORT NO:39

WORK PERFORMED FOR: George E. Harrison

RECORDED HOLDER: Same as Above [xx]
: Other []

<u>Claim No.</u>	<u>Hole No.</u>	<u>Footage</u>	<u>Date</u>	<u>Note</u>
L.67766	100	221'	Sept/59	(1)
	101	113'	Oct/59	(1)
	102	120.5'	July-Aug/60	(1)
	107	115'	Sept-Oct/61	(1)
	109	120'	Aug/63	(1)
	110	122'	Aug/63	(1)

NOTES: (1) Received from Mining Recorder - cancelled claims - placed on file Main Office, June/88

KIRKROYAL
G.M.C.

G. E. HARRISON CLAIMS
Label Township

Larder Lake Mining Division

DIAMOND DRILL HOLE LOG

Hole No.:	100	Date Finished:	Sept 20/59
Direction:	N 20° W	Location:	Claim L-67766
Depth:	221.0'	Dip:	42°
Core Size:	EKT	Logged by:	D. W. Tully
Date Started:	Sept 16/59	Drilled by:	T. Martin, 61 2nd st. Kirkland Lake, Ont.

Footage	Description	Sample No.	Width Of Sample	Value
0.0 - 11.0	Casing			
12.4	Greywacke, massive with pale bluish quartz stringers		1.4	
13.9	Greywacke			
14.4	Rust seam			
30.0	Slate and varved greywacke - bedding @ 65 - 75 degrees			
32.8	Greywacke, massive, dark grey			
34.2	Greywacke, massive, 1/2" stringers pale bluish quartz / fine pyrite		1.4	
36.0	Greywacke with fine pyrite / massive 1/2" stringers pale bluish quartz		1.8	
37.5	Greywacke with fine stringers pale blue quartz and fine pyrite		3.3	
39.0				
40.5	Greywacke with 1" dark bluish brecciated quartz stringer		1.5	
43.3	Veined zone of milky quartz		1.8	
44.6	Greywacke with stringers milky quartz		1.3	
46.9	Shale and varved greywacke - bedding at 55 degrees			
48.3	Veined zone of milky quartz		1.4	
49.9	Ground core			
51.4	Veined zone of milky quartz		1.5	
52.6	Greywacke, massive, dark grey			
53.8	Greywacke, massive, dark grey with stringers bluish quartz		1.2	
63.5	Shale, slate and varved greywacke - bedded at 60° - 70°			
71.4	Greywacke			
73.4	Greywacke with pale bluish quartz stringers		2.0	
75.5	Greywacke - bedded - fine pale blue quartz stringers		2.1	
77.1	Greywacke			
83.0	Slate and bedded greywacke	Blocky		

Footage	Description	Width Sample No. of Sample	Value
83.0 - 86.0	Ground core	Blocky	
86.6	Slate and varved greywacke	"	
88.1	Ground core		
90.4	Slate and varved greywacke with grain size gradation indicating tops south at 90°		
100.4	Slate and varved greywacke - shearing at 50° - 65°		
101.0	Ground core		
102.0	as above	very Blocky	
106.8	Ground core		
107.4	as above	" "	
108.4	Ground core		
109.5	as above	" "	
110.1	Ground core		
111.0	as above	" "	
112.9	Slate and varved greywacke - bedded at 70°		
113.7	Ground core		
126.8	Greywacke with cherty like pebbles		
129.3	Greywacke with pale blue bands		2.5
136.0	Slate - finely laminated	Blocky	
138.0	Ground core		
149.2	as above	"	
153.0	sheared zone	"	
155.5	Greywacke, bedded with milky quartz veins and fine pyrite		2.3
161.0	Sheared greywacke and slat Schistosity at 70°		
162.6	Milky to pale bluish quartz vein with fine chloritic inclusions		1.6
165.0	Greywacke, sericitized with scattered milky quartz stringers		2.4
167.1	Greywacke highly dragfolded		
170.4	Greywacke, sericitized and highly dragfolded, quartz stringers		3.3
174.3	Greywacke, sericitized, massive		
177.4	Highly sheared slate with milky quartz stringers		3.1
179.6	Greywacke, scattered milky quartz stringers		2.2
188.3	Slate with shear zones at 181 - 183 and 185 - 186		
193.0	Ground core		
194.2	Milky quartz vein		
196.0	Ground core		
201.8	Greywacke, sericitized with pale bluish areas		5.8
203.8	Greywacke, sericitized with pale bluish areas		2.0
206.0	Greywacke, sericitized with pale bluish areas		2.2
208.5	Greywacke, sericitized with pale bluish areas		2.5
211.0	Greywacke, sericitized with pale bluish areas		2.5
213.6	Slate, highly sheared with glassy quartz stringers		2.6

- 215.3	Slate	very blocky
216.5	Ground core	
221.0	Slate with greywacke	" "

End of Hole

~~SEE~~ KIRKROYAL

G. E. HARRISON CLAIMS
Lebel Township

Larder Lake Mining Division

DIAMOND DRILL HOLE LOG

Hole No.:	101	Date Started:	October 5, 1959
Direction:	N 20° W	Date Finished:	Oct. 12, 1959
Depth:	113.0'	Dip:	67°
Core Size:	EXT	Logged By:	D. W. Tully
Locatipn:	Claim L-67766	Drilled BY:	T. Martin, 61 2nd St., Kirkland Lake

Footage	Description	Sample No.	Width of Sample	Value
	Hole Collared on Bedrock - no casing			
00 - 0.4	Greywacke with slaty beds			
1.5	Ground core			
1.8	Greywacke with slaty beds and rust zones			
2.6	Ground core			
4.5	Greywacke with slaty beds			
6.2	Ground core			
8.0	Greywacke with slaty beds			
8.5	Ground core			
9.4	Ground core with slaty beds, sheared at 45°			
10.5	Ground core			
16.2	Ground core with slaty beds			
17.7	4" banded zone in greywacke with sparse pyrite	3.5	1.5	
19.6	Greywacke and shale			
20.0	Ground core			
36.2	Greywacke - bedding at 40° - 45° with scattered pale blue quartz stringers			
38.3	Ground core			
39.4	Greywacke			
40.8	Ground core			
41.5	Pale grey quartz vein with chloritic inclusions		0.7	
42.6	Ground core			
43.5	Pale grey quartz vein with chloritic inclusions		0.9	
46.1	Ground core			
46.5	Pale grey quartz vein			
47.4	Ground core			
48.1	Pale grey quartz vein			
49.1	Ground core			

		<u>Sample No.</u>	<u>Width Of Sample</u>	<u>Value</u>
49.1 - 50.0	Greywacke - sericitized			
52.3	Greywacke - sericitized with pale blue quartz stringers		2.3	
56.2	Ground core			
58.2	Greywacke - sericitized			
60.0	Greywacke - sericitized with a 6" banded zone and fine pale blue quartz stringers		1.8	
52.7	Greywacke			
70.0	Conglomerate - sheared @ 40°			
71.6	Ground core			
72.8	Greywacke - massive			
76.0	Ground core			
76.8	Conglomerate			
88.2	Slate and varved greywacke - Blochy			
90.0	Ground core			
92.0	Slate and varved greywacke - Blochy			
93.3	Ground core			
100.0	Slate and varved greywacke - Blochy			
100.8	Ground core			
102.5	Slate and varved greywacke - Blochy			
106.7	Ground core			
113.0	Slate and varved greywacke - Blochy			

End of Hole

KIRKROYAL
GML

DIAMOND DRILL HOLE LOG

Hole No. : 102
Direction : S45°E
Dip : -45°
Depth : 120.6'
Core Size : 7/8"
Location : Claim No. 67766
LEBEL Tp

Date Started : July 29, 1960
Date Finished : August 12, 1960
Logged by : D. W. Tully, Dossie, Ont.
Drilled by : T. Martin,
61 Second Street,
Kirkland Lake, Ont.

<u>Footage</u>	<u>Description</u>	<u>Sample No.</u>	<u>Width</u>	<u>Value</u>
0 - 14.0'	Casing			
23.0'	Pebble Conglomerate (Blocky)			
24.0'	Grey Quartz Vein with Pyrite	62815	1.0'	
26.3'	Greywacke, sheared at 60°			
30.2'	Ground Core			
31.0'	Greywacke, sericitized and sheared			
32.3'	Ground Core			
36.5'	Greywacke, grey, massive			
45.0'	Greywacke, bedded at 45°			
57.6'	Pebble Conglomerate			
60.2'	Ground Core			
63.5'	Greywacke, sericitized, bedded (Blocky)			
65.0'	Shale, laminated at 45°	"		
66.3'	Ground Core			
69.0'	Shale and interbedded Greywacke	"		
69.8'	Ground Core			
76.0'	Shale and interbedded Greywacke	"		
80.5'	Ground Core			
95.0'	Shale and interbedded Greywacke (Very Blocky)			
97.5'	Ground Core			
109.6'	Shale and interbedded Greywacke	" "		
112.5'	Ground Core			
120.5'	Shale and interbedded Greywacke			

END

~~Note~~ Reported August 30/60
L.67767 to L.67772 incl.

RECORDED AUG 30 1960
REC. No.

G. E. HARRISON CLAIMS
Lebel Township

Larder Lake Mining Division

DIAMOND DRILL HOLE LOG

MINING
RECORD
OCT 13 1961
KIRKLAND LAKE - ONT.

Hole No. - <u>107</u>	Date started	- Sept. 26, 1961
Direction - S 80W	Date finished	- Oct. 5, 1961
Depth - 115.0	Location	- Claim L - 67766
Core size - EXT	Logged by	- D. W. Tully
Dip - 45	Drilled by	- T. Martin
Core stored on property		61 Second Street Kirkland Lake, Ont

Footage

Description

0.0 - 2.3'	Casing
6.5	Greywacke, massive, blocky
11.4	Conglomerate, pebbles and sub-angular fragments of porphyry
13.6	Rusty - blocky zone
20.6	Conglomerate as above
20.9	Tuff, red spotted variety
27.6	Contact phase of Feldspar Porphyry
29.2	Feldspar Porphyry, two distinct generations of phenocrysts
30.4	Contact phase of above
35.9	Dark green minette-like dyke, intrusive relationship to porphyry
48.2	Feldspar Porphyry indeterminate
48.5	Pinkish to jaspery quartz vein
61.3	Feldspar porphyry
84.2	Dark green minette like dyke with inclusions at 68.5'
88.7	Zone of inclusions
115.0	Dark green minette like dyke, intersecting glassy quartz stringers at 101.2'

End of Hole

G. E. HARRISON CLAIMS
LEBEL TOWNSHIP

Kirk Royal
G.M.L.

LARDER LAKE MINING DIVISION
DIAMOND DRILL LOG

Hole No. - 109
Direction - Due North
Dip - 50 degrees
Depth - 120.0 Feet
Core size - EXT
Core stored on property

Hole started - August 19, 1963
Hole Completed - August 22, 1963
Location - Claim L-67766
Logged By - D. W. Tully
Dobie, Ontario
Drilled By - T. Martin
91 Government Road West
Kirkland Lake, Ontario

<u>FOOTAGE</u>	<u>DESCRIPTION</u>
0.0 - 1.0	Casing
18.5	Trachyte Breccia, pinkish grey, carbonate areas, 1', 2', 7' 18' rusty seams
20.7	Trachyte breccia, pinkish grey, quartz-carbonate ss
27.0	Trachyte Breccia, pinkish grey
31.5	Tuff, grey green altered, many rusty fracture zones.
32.5	Pink porphyry dyke, quartz-carbonate ss
37.5	Zone of pink porphyry dykes, rusty at 37.5'
50.0	Tuff, pinkish grey green, scattered porphyry dykes
54.0	Tuff, grey green
55.2	Blocky zone - fault breccia at 55'
60.5	Tuff, grey green, scattered quartz-carbonate ss
63.4	Quartz - carbonate ss zone - fine pyrite
77.5	Tuff, grey green, blocky zone, rusty at 71'
120.0	Tuff, grey green, green mariposite - like - inclusions. Rusty at 86.5' and 119.5'

END OF HOLE

G. E. HARRISON CLAIMS
LEBEL TOWNSHIP

LARDER LAKE MINING DIVISION
DIAMOND DRILL LOG

Hole No. - 110
Direction - Due South
Dip - 50 degrees
Depth - 122.0 Feet
Core size - EXT
Core stored at property

Hole started - August 23, 1963
Hole Completed - August 27, 1963
Location - Claim L-67766
Logged By - D. W. Tully
Dobie, Ontario
Drilled by - T. Martin
91 Government Road West
Kirkland Lake, Ontario

FOOTAGE

DESCRIPTION

0.0 - 1.0	Casing	
2.0		Rusty, vuggy, leached zone
11.0		Tuff, grey green, many rusty seams.
27.0		Tuff, grey green, shearing at 35-50°
37.5		Tuff, grey green, quartz- carbonate ss, rusty seams
48.5		Tuff, grey green, green mariposite - like inclusions
49.5		Quartz - carbonate ss zone
53.2		Tuff, grey green, scattered quartz- carbonate ss
53.6		Rusty zone
70.4		Tuff, grey green, green mariposite - like inclusions
73.0		Rusty, Blacky zone
101.0		Tuff, grey green, scattered quartz- carbonate ss.
101.2		Rusty seam
119.0		Tuff, grey green, scattered quartz- carbonate ss
122.0		Tuff, pinkish grey green

END OF HOLE



32D04NW0288 39 LEBEL

900

relation to corner posts, and nature and extent thereof.

Form 12 A

THE MINING ACT



REPORT OF WORK

ONTARIO

To the Recorder of Larder Lake Mining Division:

I, George E. Harrison
(Name of Applicant)
Whittier Crescent - Lorne Park, Ontario
(Post Office Address)

the recorded holder of mining claim No. 67766 hereby report the performance of ~~94~~ ⁹⁴ days' work not before reported, to be applied to this claim.

*This mining claim is one of a group of contiguous claims numbered L - 67766, 67, 68, 69, 70, 71, 72

of which I am the recorded holder under Mining License No. A-54350 and the work was performed on mining claim(s) L-67766 and is to be applied in respect of mining claim(s) L-67766, 67, 68, 69, 70, 71, 72
(*Complete above section only if applicable)

The work is as follows:

Stripping or opening up mines, sinking shafts or other actual mining operations

The names and addresses of the men who performed the work and the dates upon which each man worked in its performance are: (If more space is required, attach list).

.....
.....
.....

Total No. of days

Diamond or other Core Drilling

Footage drilled 334.0 No. of holes drilled 2 Angle Minus 42 and 67degrees
Diameter of core 15/16 inches Names and addresses of owner and operator of drill Thomas Martin, 81 Second Street, Kirkland Lake, Ontario

Dates upon which drilling was done September 16 - October 12, 1959
(Core log and Sketch in duplicate by core examiner accompanies this Report.)

Total No. of days 334.0 feet

Work by Compressed Air or other Power Driven Rock Drill or Mechanical Equipment.

Type of drill.....
Names and addresses of men engaged in operating drill.....

Dates upon which each man worked.....
Total No. of days.....

RECORDED OCT 22 1959
REC. No.

The penalty for making a false statement in this certificate is \$500. or six months imprisonment or both.

Power Stripping

Type of equipment used
Names and addresses of owner and operators
.....
.....
.....
.....
.....
.....
.....
.....
.....
Amount expended \$
Dates on which work was done Total No. of days

Date Oct. 20 1959
Donald W. Tully
.....
For G. E. Harrison
Signature of Recorded Holder or Agent

The Mining Act
CERTIFICATE VERIFYING REPORT OF WORK

I, Donald W. Tully
Dobie Ontario
Township of Gauthier (post-office address)
(City, town, village or township)

1. That I have a personal and intimate knowledge of the facts set forth in the report of work annexed hereto.
2. That the grounds of my knowledge are I was present on the property when the work was performed.
3. That the annexed report is true.

.....
Donald W. Tully
(Signature)
Dated October 20, 1959. 19 Dobie, Ontario.
(post-office address)

The penalty for making a false statement in this certificate is
\$500. or six months imprisonment or both.

IMPORTANT

Attach sketch showing location of work in relation to corner posts, and nature and extent thereof.

Form 12 A
20M-60-2134

THE MINING ACT



ONTARIO

REPORT OF WORK

To the Recorder of Larder Lake Mining Division:

I, G. E. Harrison
(Name of Applicant)
Whittier Crescent, Lorne Park, Ontario
(Post Office Address)

the recorded holder of mining claim No. L - 67766 (Lebel Twp) hereby report the performance of ~~43~~ 66 days' work not before reported, to be applied to this claim.

*This mining claim is one of a group of contiguous claims numbered

L - 67766, 67, 68, 69, 70, 71, 72

of which I am the recorded holder under Mining License No. A - 34330 and the work

was performed on mining claim (s) L - 67766 and L - 67769 and is to be applied

in respect of mining claim (s) As above (*Complete above section only if applicable)

The work is as follows:

Stripping or opening up mines, sinking shafts or other actual mining operations.

The names and addresses of the men who performed the work and the dates upon which each man worked in its performances are: (If more space is required, attach list).

.....
.....
.....
.....

Diamond or other Core Drilling Total No. of days

Footage drilled 350.0' No. of holes drilled 2 Angle - 45 and -75
Diameter of core FY.T. Names and addresses of owner and operator of
drill T. Martin, 61 Second Street, Kirkland Lake, Ontario

Dates upon which drilling was done September 7 - October 5, 1961
(Core log and Sketch in duplicate by core examiner accompanies this Report.)

Total No. of days 350.0'
Work by Compressed Air or other Power Driven Rock Drill or Mechanical Equipment.

Type of drill
Names and addresses of men engaged in operating drill,

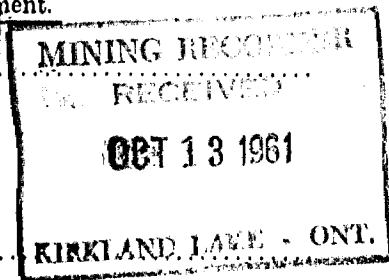

Dates upon which each man worked
Total No. of days

The penalty for making a false statement in this certificate is \$500. or six months imprisonment or both.

IMPORTANT

Attach sketch showing location of work in relation to corner posts, and nature and extent thereof.

Form 12 A
20M-60-2134

THE MINING ACT



REPORT OF WORK

To the Recorder of LARDER LAKE Mining Division:

I, G. E. HARRISON
(Name of Applicant)
WHITTIER CRESCENT, LORNE PARK, ONTARIO
(Post Office Address)

the recorded holder of mining claim No. L-67766 hereby report the performance of 24 days' work not before reported, to be applied to this claim.

*This mining claim is one of a group of contiguous claims numbered L-67766, 67, 68, 69, 70, 71, 72

of which I am the recorded holder under Mining License No. A-34330 and the work was performed on mining claim (s) L-67766 and is to be applied in respect of mining claim (s)

(*Complete above section only if applicable)

The work is as follows:

Stripping or opening up mines, sinking shafts or other actual mining operations.

The names and addresses of the men who performed the work and the dates upon which each man worked in its performances are: (If more space is required, attach list).

.....
.....
.....

Diamond or other Core Drilling Total No. of days #109, 110

Footage drilled 242.0 No. of holes drilled 2 Angle -50°

Diameter of core EXT Names and addresses of owner and operator of drill T. MARTIN, 91 Govt Rd. West - KIRKLAND LAKE, ONT.

Dates upon which drilling was done Aug. 19 - 27, 1963
(Core log and Sketch in duplicate by core examiner accompanies this Report.)

Total No. of days 242.0

Work by Compressed Air or other Power Driven Rock Drill or Mechanical Equipment.

Type of drill
Names and addresses of men engaged in operating drill,

Dates upon which each man worked
Total No. of days

RECORDED SEP 3 1963
C No.

The penalty for making a false statement in this certificate, \$500. or six months imprisonment or both.

Power Stripping

Type of equipment used
Names and addresses of owner and operators
.....
.....
.....
.....
Amount expended \$
Dates on which work was done
Total No. of days

Date *Sept., 1963*

Donald W. Tully
Signature of Recorded Holder or Agent

The Mining Act

CERTIFICATE VERIFYING REPORT OF WORK

I, *DONALD W. TULLY*
..... *DOBIE*
..... (post-office address)
..... *Gauthier Township, ONT.*
..... (City, town, village or township)

hereby certify:

- 1. That I have a personal and intimate knowledge of the facts set forth in the report of work annexed hereto.
- 2. That the grounds of my knowledge are *I logged the core*
- 3. That the annexed report is true.

Dated *Sept.* 19 *63*
..... *Donald W. Tully*
..... (Signature)
..... *DOBIE, ONTARIO*
..... (post-office address)

The penalty for making a false statement in this certificate is \$500. or six months imprisonment or both.

MINING RECORDER
RECEIVED
OCT 13 1961
KIRKLAND LAKE - ONT.

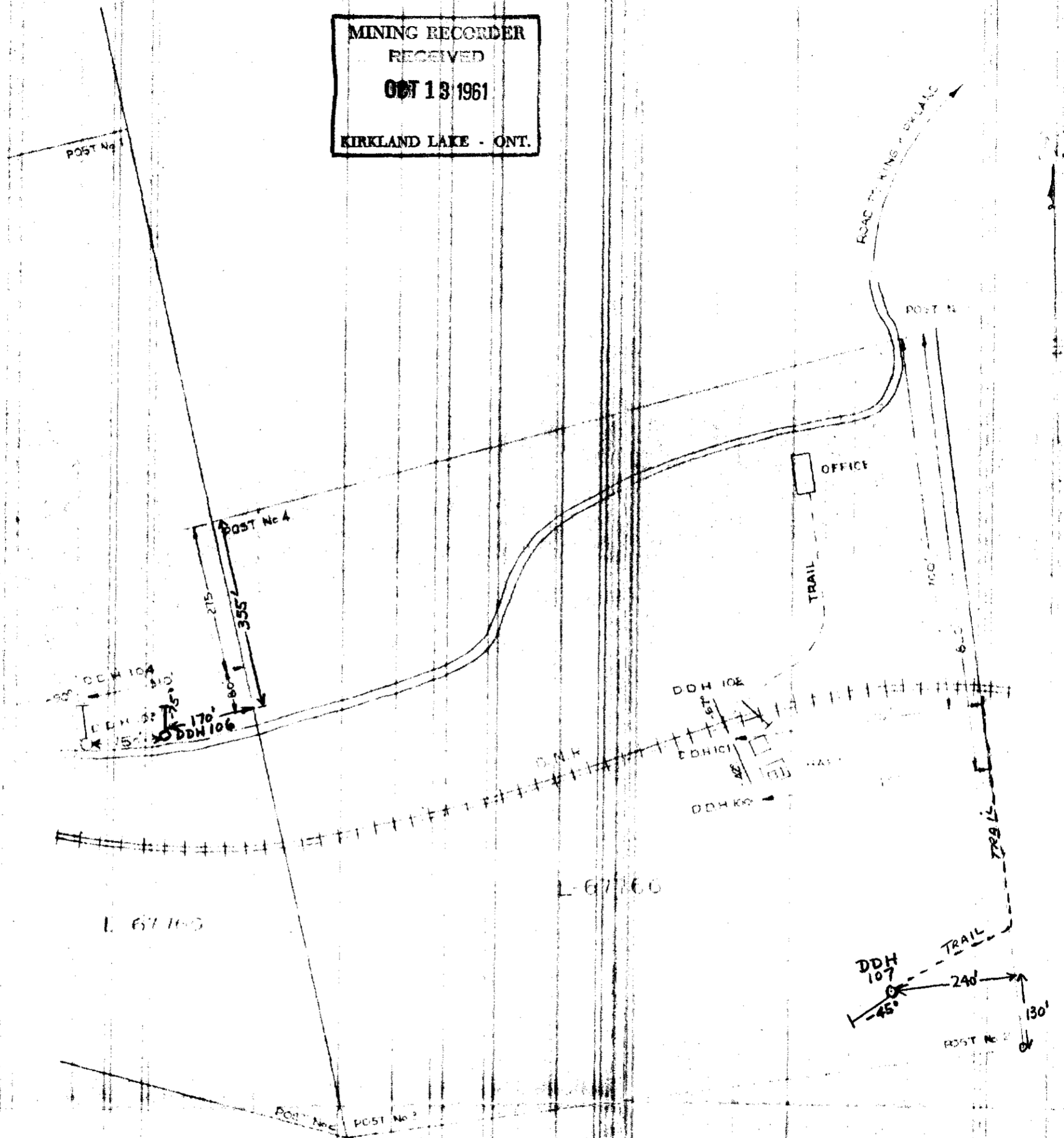

G. F. HARRISON CLAIMS L 67756 & 69
LEVEL
PLAN SHOWING LOCATION
OF
DRILL HOLES



32084NW0268 39 LABEL

200

1" 200'

OCTOBER 8, 1961

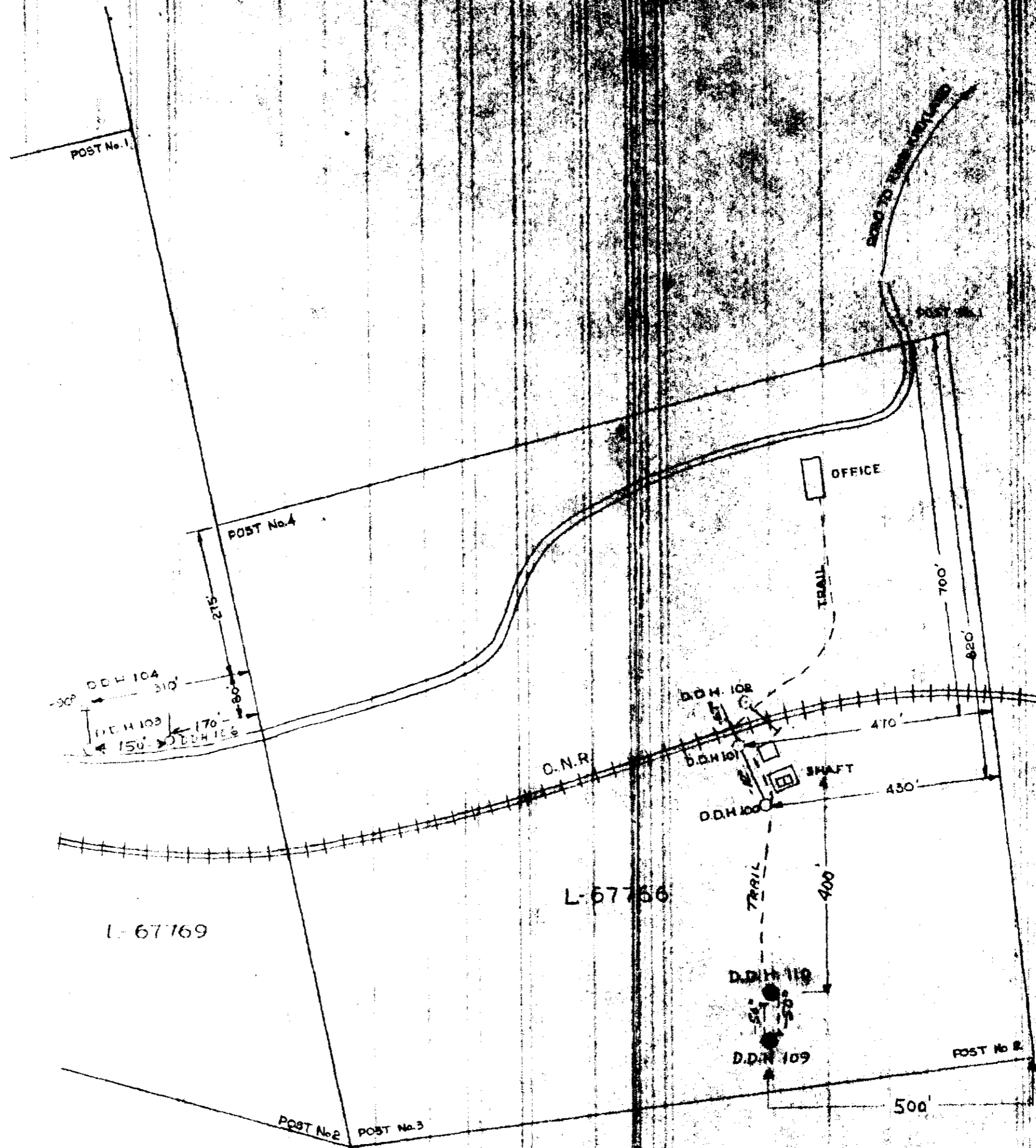

G.E. HARRISON CLAIMS L-67766 & 69
 LEVEL TOWNSHIP
 PLAN SHOWING LOCATION
 OF
 DIAMOND DRILL HOLES 102, 103, 104,
 109, 110



32084NW0288 39 LABEL

210

SCALE: 1" = 200'

AUGUST 28, 1963