



REPORT ON PROSPECTING

HEARST TOWNSHIP, ONTARIO

A prospecting trip was made to claim L1136762 to obtain samples for assay and examine rock types along the shore line of Larder Lake south from Enright Point. Alex Bath and Jim Garber travelled from Timmins to Pearl Beach east of Larder Lake, Ontario. From there a boat was launched and used to travel to the site. The area was traversed by boat and by walking on the land a ways in from the shore line.

Fifteen samples were taken, examined and later assayed for gold and arsenic. Most samples consisted of Tholiitic basalts with trace to 3% pyrite. The boat was used to return to Pearl Beach and then from there return to Timmins.

Assays and sample descriptions are attached.

Respectfully submitted

R.A. MacGregor, P. Eng.

2.14573

Costs

Alex Bath 1 day @ 150/day Prospecting
Jim Garber 1 day @ 150/day "
RA MacGregor 1/2 day @ 150/day Report

Total 375

Assays

188.59

101.11

Total 290

Boat

20

Transportation

Timmins → Larder Lake → Pearl Beach

& Return 366 km @ .3 = 110

Meals

2 lunches @ 5.34

11

Grand Total 806

RECEIVED

MAY 21 1992

MINING LANDS BRANCH

Larder Lake

#4 post L1136762

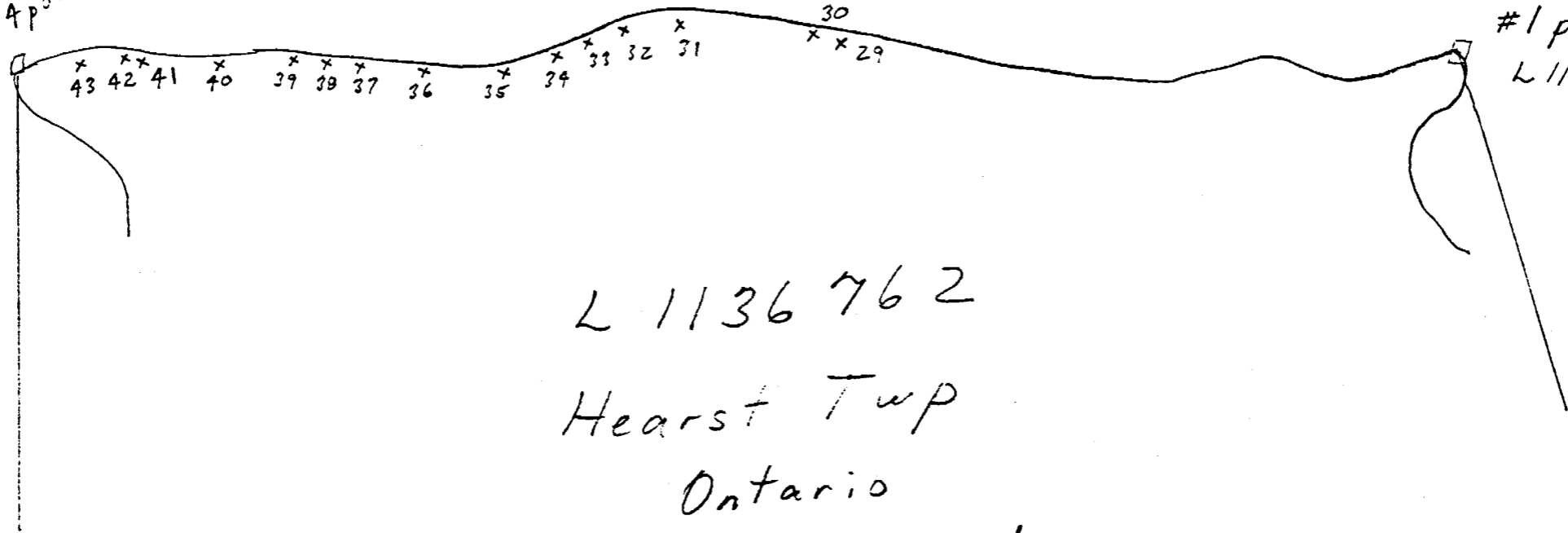

#1 post
L1136762

L 1136762

Hearst Twp

Ontario

Scale 1" = 200'



Swastika Laboratories

A Division of Assayers Corporation Ltd.

Assaying - Consulting - Representation

Established 1928

Assay Certificate

1W-3853-RA1

Company: NORANDA EXPL. CO. LTD.

Date: SEP-16-91

Project:

Copy 1. P.O. BOX 1205, TIMMINS, ONT. P4N 7J5

Attn: JOHN WAKEFORD/COLIN MACKENZIE

2. FAX TO 268-9572

We hereby certify the following Assay of 15 ROCK samples submitted SEP-03-91 by A.C. BATH.

Sample Number	Au g/tonne	Au oz/ton	Au check g/tonne	Au check oz/ton	As ppm
18029	0.02	.001			1
18030	0.01	.001			4
18031	0.01	.001			3
18032	0.04	.001			2
18033	0.02	.001	0.03	.001	2
18034	0.01	.001			3
18035	0.01	.001			3
18036	0.01	.001			3
18037	0.01	.001			4
18038	0.01	.001			3
18039	0.01	.001			7
18040	0.01	.001			4
18041	0.01	.001			4
18042	0.01	.001			3
18043	0.01	.001	0.01	.001	5

Certified by Donna Gardner

P.O. Box 10, Swastika, Ontario P0K 1T0

Telephone (705) 642-3244

FAX (705) 642-3300

Swastika Laboratories
P.O. Box 10
Swastika, Ontario
P0K 1T0

INVOICE

NO: 25017

DATE: 09-04-91

PAGE: 1 of 1

GST Registration Number: R 100294743

SOLD TO:

SHIP TO:

Noranda Exploration Co Ltd
P.O. Box 1205
Timmins, Ontario
P4N 7J5

Same

ITEM NO.	QUANTITY	UNIT	DESCRIPTION	G	P	UNIT PRICE	AMOUNT
N327	15	1	Au Assays	3		8.750	131.25
	15	1	Sample Handling	3		3.000	45.00
			Cert#1W-3853-RA1				
			3-GST @ 7 %, Excluded				12.34
COMMENTS:						TOTAL	188.59

SWASTIKA LABORATORIES

PAID
SEP 18/91

WITH THANKS

Jardner
188.59

Net 30 Days

Swastika Laboratories
P.O. Box 10
Swastika, Ontario
P0K 2T0

INVOICE

NO: 2595B

DATE: 09-16-91

PAGE: 1 of 1

GST Registration Number: R 100294743

SOLD TO:
Noranda Exploration Co Ltd
P.O. Box 1205
Timmins, Ontario
P4N 7J5

SHIP TO:
Same

ITEM NO.	QUANTITY	UNIT	DESCRIPTION	G	P	UNIT PRICE	AMOUNT
N327	1		Cert#1W-3853-RA1	3		5.300	5.30
			3-GST @ 7 %, Excluded				0.61

SWASTIKA LABORATORIES

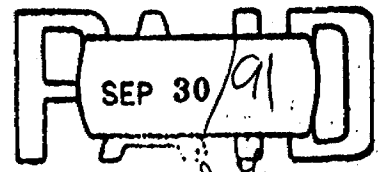

COMMENTS:
Noted Days

TOTAL

101.14

GAS

Report of Work Conducted After Recording Claim

Transaction Number

DOCUMENT No.

Mining Act W

9280-00072

92-10

Personal information collected on this form is obtained under the authority of the Mining Act. This information will be used for correspondence. Questions about this collection should be directed to the Provincial Manager, Mining Lands, Ministry of Northern Development and Mines, Fourth Floor, 159 Cedar Street, Sudbury, Ontario, P3E 6A5, telephone (705) 870-7264.

2.14573

- Instructions:**
- Please type or print and submit in duplicate.
 - Refer to the Mining Act and Regulations for required Recorder.
 - A separate copy of this form must be completed.
 - Technical reports and maps must accompany this.
 - A sketch, showing the claims the work is assigned.



32D04SE0108 2.14573 HEARST

900

Recorded Holder(s) <i>RA MacGregor</i>	Client No. <i>162287</i>
Address <i>28 Ford St Sault Ste Marie Ont</i>	Telephone No. <i>949-4250</i>
Mining Division <i>Larder Lake</i>	Township/Area <i>Hearst</i>
Dates Work Performed From: <i>August 29/91</i>	To: <i>March 10/92</i>
	M or G Plan No. <i>G-3213</i>

Work Performed (Check One Work Group Only)

Work Group	Type
Geotechnical Survey	
Physical Work, Including Drilling	<i>Prospecting</i>
Rehabilitation	
Other Authorized Work	
Assays	<i>Analysis of samples</i>
Assignment from Reserve	

RECEIVED

MAY 21 1992

MINING LANDS BRANCH

Total Assessment Work Claimed on the Attached Statement of Costs \$ 806

Note: The Minister may reject for assessment work credit all or part of the assessment work submitted if the recorded holder cannot verify expenditures claimed in the statement of costs within 30 days of a request for verification.

Persons and Survey Company Who Performed the Work (Give Name and Address of Author of Report)

Name	Address
<i>Alex Bath</i>	<i>57 Tower St. Kirkland Lake Ont</i>
<i>Jim Garber</i>	<i>60 Shirley St South Timmins Ont.</i>
<i>R.A. MacGregor</i>	<i>28 Ford St Sault Ste Marie Ont.</i>
<i>Swaztika Labs</i>	<i>Box 10 Swaztika Ont.</i>

(attach a schedule if necessary)

Certification of Beneficial Interest * See Note No. 1 on reverse side

I certify that at the time the work was performed, the claims covered in this work report were recorded in the current holder's name or held under a beneficial interest by the current recorded holder.	Date <i>March 10/92</i>	Recorded Holder or Agent (Signature) <i>[Signature]</i>
--	----------------------------	--

Certification of Work Report

I certify that I have a personal knowledge of the facts set forth in this Work report, having performed the work or witnessed same during and/or after its completion and annexed report is true.

Name and Address of Person Certifying <i>R. A. MacGregor 28 Ford St. Sault Ste Marie Ont.</i>	PLA 4N4
Telephone No. <i>949-4250</i>	Date <i>March 10/92</i>
Certified By (Signature) <i>[Signature]</i>	

For Office Use Only

Total Value Cr. Recorded <i>8806</i>	Date Recorded <i>MARCH 17, 1992</i>	Mining Recorder <i>[Signature]</i>	Received Stamp <i>LARDER LAKE MINING DIVISION</i>
	Deemed Approval Date <i>JUNE 15, 1992</i>	Date Approved	
	Date Notice for Amendments Sent		<i>2 PM 17 PM 2 27</i>



Personal information collected on this form is obtained under the authority of the Mining Act. This information will be used to maintain a record and ongoing status of the mining claim(s). Questions about this collection should be directed to the Provincial Manager, Minings Lands, Ministry of Northern Development and Mines, 4th Floor, 159 Cedar Street, Sudbury, Ontario P3E 6A5, telephone (705) 670-7264.

Les renseignements personnels contenus dans la présente formule sont recueillis en vertu de la Loi sur les mines et serviront à tenir à jour un registre des concessions minières. Adresser toute question sur la collecte de ces renseignements au chef provincial des terrains miniers, ministère du Développement du Nord et des Mines, 159, rue Cedar, 4^e étage, Sudbury (Ontario) P3E 6A5, téléphone (705) 670-7264.

1. Direct Costs/Coûts directs

Type	Description	Amount Montant	Totals Total global
Wages Salaires	Labour Main-d'oeuvre	375	
	Field Supervision Supervision sur le terrain		375
Contractor's and Consultant's Fees Droits de l'entrepreneur et de l'expert-conseil	Type		
Supplies Used Fournitures utilisées	Type Assays	198.59	
	Assays	101.11	
			290
Equipment Rental Location de matériel	Type Boat	20	
			20
Total Direct Costs Total des coûts directs		685	

2. Indirect Costs/Coûts indirects

** Note: When claiming Rehabilitation work Indirect costs are not allowable as assessment work. Pour le remboursement des travaux de réhabilitation, les coûts indirects ne sont pas admissibles en tant que travaux d'évaluation.

Type	Description	Amount Montant	Totals Total global
Transportation Transport	Type Auto	109.80	
RECEIVED MAY 21 1992 MINING LANDS BRANCH			
Food and Lodging Nourriture et hébergement	Meals	10.68	11
Mobilization and Demobilization Mobilisation et démoblisation			
Sub Total of Indirect Costs Total partiel des coûts indirects			121
Amount Allowable (not greater than 20% of Direct Costs) Montant admissible (n'exécédant pas 20 % des coûts directs)			
Total Value of Assessment Credit (Total of Direct and Allowable indirect costs) Valeur totale du crédit d'évaluation (Total des coûts directs et indirects admissibles)			806

Note: The recorded holder will be required to verify expenditures claimed in this statement of costs within 30 days of a request for verification. If verification is not made, the Minister may reject for assessment work all or part of the assessment work submitted.

Note: Le titulaire enregistré sera tenu de vérifier les dépenses demandées dans le présent état des coûts dans les 30 jours suivant une demande à cet effet. Si la vérification n'est pas effectuée, le ministre peut rejeter tout ou une partie des travaux d'évaluation présentés.

Filing Discounts

1. Work filed within two years of completion is claimed at 100% of the above Total Value of Assessment Credit.
2. Work filed three, four or five years after completion is claimed at 50% of the above Total Value of Assessment Credit. See calculations below:

Total Value of Assessment Credit	Total Assessment Claimed
	× 0.50 =

Remises pour dépôt

1. Les travaux déposés dans les deux ans suivant leur achèvement sont remboursés à 100 % de la valeur totale susmentionnée du crédit d'évaluation.
2. Les travaux déposés trois, quatre ou cinq ans après leur achèvement sont remboursés à 50 % de la valeur totale du crédit d'évaluation susmentionné. Voir les calculs ci-dessous.

Valeur totale du crédit d'évaluation	Evaluation totale demandée
	× 0,50 =

Certification Verifying Statement of Costs

I hereby certify: that the amounts shown are as accurate as possible and these costs were incurred while conducting assessment work on the lands shown on the accompanying Report of Work form.

that as Recorded holder I am authorized (Recorded Holder, Agent, Position in Company)

to make this certification

Attestation de l'état des coûts

J'atteste par la présente: que les montants indiqués sont le plus exact possible et que ces dépenses ont été engagées pour effectuer les travaux d'évaluation sur les terrains indiqués dans la formule de rapport de travail ci-joint.

Et qu'à titre de _____ je suis autorisé (titulaire enregistré, représentant, poste occupé dans la compagnie)

à faire cette attestation.

Signature [Signature] Date March 10/92

McVITTIE TWP.

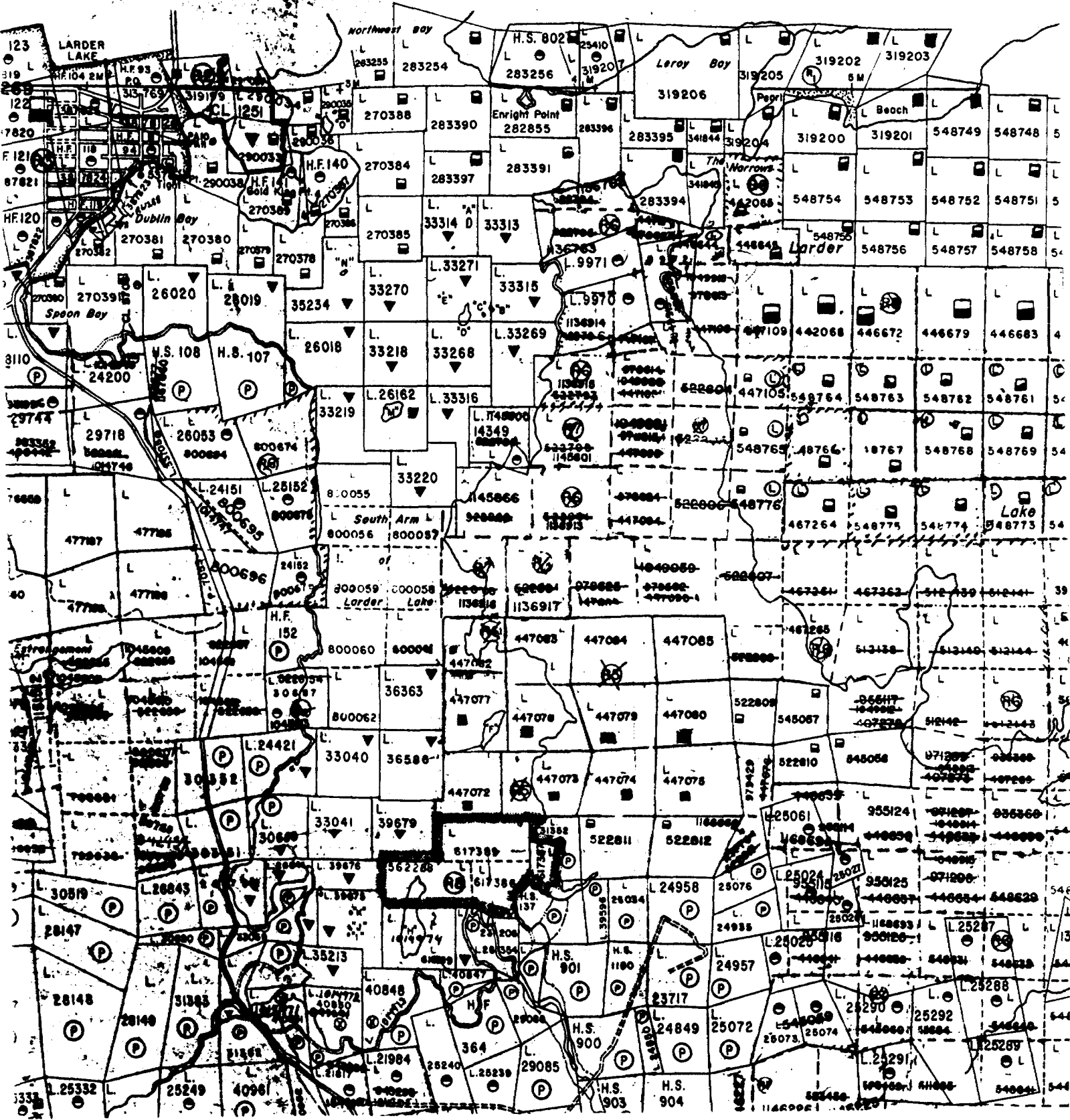



Ontario

Ministry of
Northern Development
and Mines

Ministère du
Développement du Nord
et des Mines

Geoscience Approvals Section
Mining Lands Branch
159 Cedar Street, 4th Floor
Sudbury, Ontario
P3E 6A5

Telephone: (705) 670-7264
Fax: (705) 670-7262

Our File: 2.14573
Transaction #: W9280.00072

June 16, 1992

Mining Recorder
Ministry of Northern Development
and Mines
4 Government Road East
Kirkland Lake, Ontario
P2N 1A2

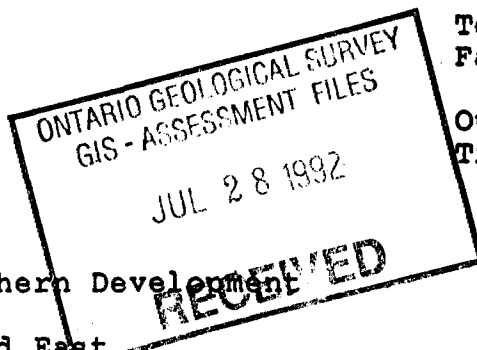

Dear Sir:

RE: APPROVAL OF ASSESSMENT WORK ON MINING CLAIM L 1136762 IN HEARST TOWNSHIP.

A Notice of Deficiency was not issued on this Report of Work prior to the 90 day deemed approval date and as outlined in subsection 6(5) of the Mining Act Regulations this Report of Work is therefore deemed approved as of JUNE 15, 1992.

Please indicate this approval on the claim record sheets.

If you require further information please contact Clive Stephenson at (705) 670-7251.

Yours sincerely,

Ron C. Gashinski
Senior Manager, Mining Lands Branch
Mines and Minerals Division

CD1
CDS/jl
Enclosures:

cc: Assessment Files Office
Toronto, Ontario

Resident Geologist
Kirkland Lake, Ontario

REFERENCES

AREAS WITHDRAWN FROM DISPOSITION

M.R.O. - MINING RIGHTS ONLY

O-L-90 - SURFACE RIGHTS ONLY

M.+S. - MINING AND SURFACE RIGHTS

- | Description | Order No. | Date | Disposition | File |
|--|-----------|------|-------------|------|
| (R1) SURFACE RIGHTS WITHDRAWN FROM STAKING SECTION 36/80 ORDER NO. W14/80 | | | | |
| (R2) SURFACE & MINING RIGHTS WITHDRAWN FROM STAKING SECTION 36/80 ORDER NO. W65/84
O-L-90 NR OPENS W65/84 | | | | |
| (R3) MINING RIGHTS WITHDRAWN FROM STAKING SECTION 36/80 ORDER NO. W9/85
O-L-89 NR OPENS PART OF W9/85 | | | | |
| (R4) SURFACE & MINING RIGHTS WITHDRAWN FROM STAKING SECTION 36/80 ORDER NO. W17/85
O 32/85 OPENS M 17/85 | | | | |
| (R5) SURFACE & MINING RIGHTS WITHDRAWN FROM STAKING SECTION 36/80 ORDER NO. W36/85
O-22/85 OPENS M 36/85 | | | | |
| (R5) SURFACE & MINING RIGHTS WITHDRAWN FROM STAKING SECTION 36/80 ORDER NO. W38/85
O-L-90 OPENS PART OF W8/86
O 24/85 OPENS PART OF W38/85
O 25/85 OPENS PART OF W38/85
O 26/85 OPENS PART OF W38/85
O 63/87 OPENS PART OF W38/85
O 97/87 OPENS PART OF W38/85
O-L-90 OPENS PART OF W38/85
O-L-90 OPENS PART OF W38/85 | | | | |
| (R6) SURFACE & MINING RIGHTS WITHDRAWN FROM STAKING SECTION 36/80 ORDER NO. W7/86
O 74/86 OPENS PART OF W7/86
O 98/87 OPENS PART OF W7/86
O-L-90 OPENS PART OF W7/86
O-L-90 OPENS PART OF W7/86
O-L-90 OPENS PART OF W7/86
O-L-90 OPENS PART OF W7/86 | | | | |
| (R7) SURFACE & MINING RIGHTS WITHDRAWN FROM STAKING SECTION 36/80 ORDER NO. W8/86
O 64/87 OPENS PART OF W8/86
O 23/88 OPENS PART OF W8/86
O-L-90 OPENS PART OF W8/86
O-L-90 NR OPENS PART OF W8/86
O-L-90 NR OPENS PART OF W8/86 | | | | |
| (R8) SURFACE & MINING RIGHTS WITHDRAWN FROM STAKING SECTION 36/80 ORDER NO. W9/86
O-L-90 OPENS PART OF W9/86 | | | | |
| (R9) SURFACE & MINING RIGHTS WITHDRAWN FROM STAKING SECTION 36/80 ORDER NO. W11/86
O 75/86 OPENS W11/86 | | | | |
| (R10) SURFACE & MINING RIGHTS WITHDRAWN FROM STAKING SECTION 36/80 ORDER NO. W50/86
O-8/88 OPENS PART OF W50/86
O 60/87 OPENS PART OF W50/86
O-L-90 OPENS PART OF W50/86
O-L-90 NR OPENS PART OF W50/86 | | | | |

NOTES

Township of Hearst lies entirely within the CORPORATION of the TOWNSHIP OF LARDER LAKE

STAKING OF MINING CLAIMS WITHIN THE TOWN OF LARDER LAKE SHOWN THUS SUBJECT TO SEC 37(b) OF THE MINING ACT R.S.O. 1970

McVITTIE TWP.

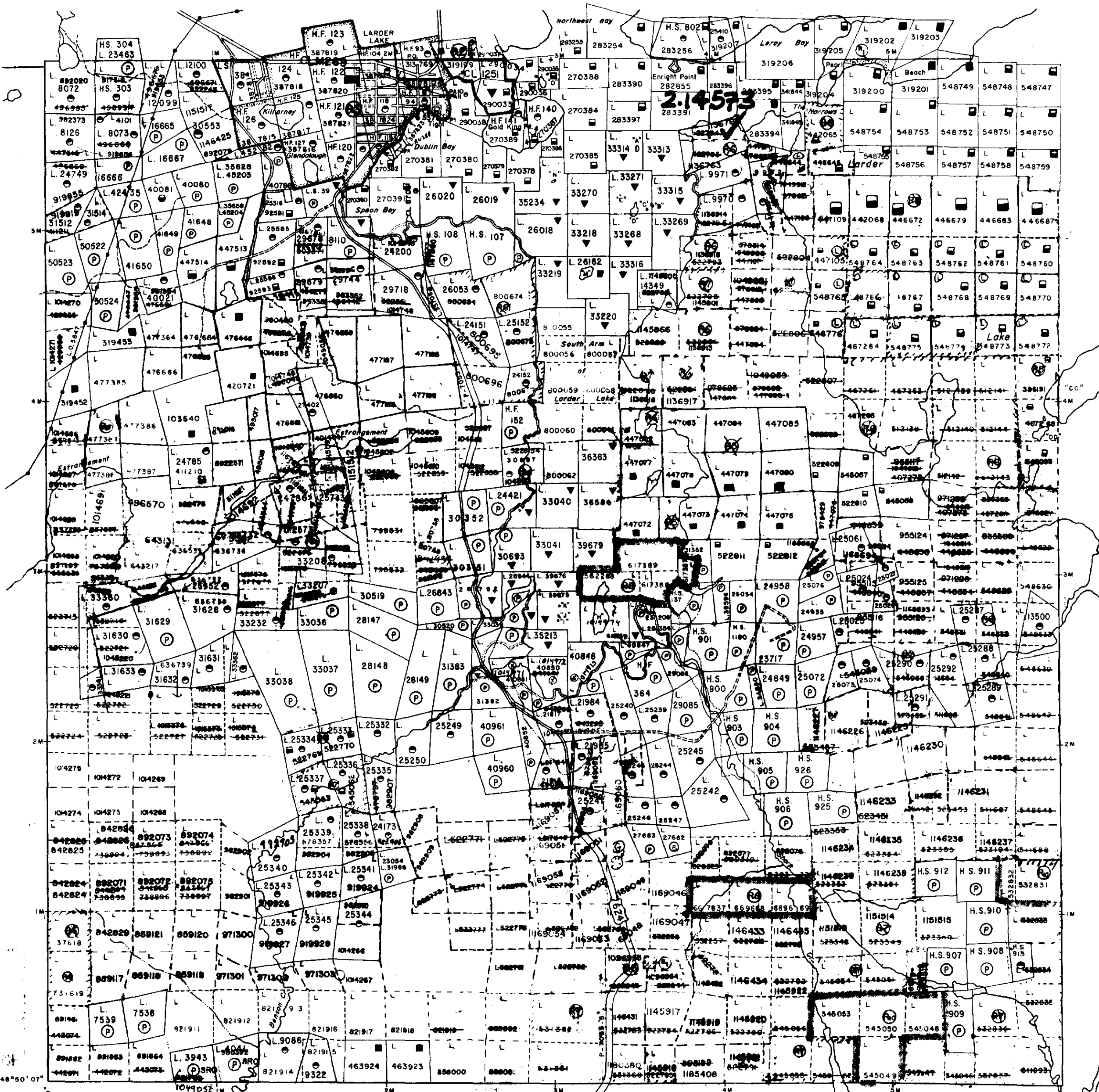

McELROY TWP.

McFADDEN TWP.

SKEAD TWP.

NOTICE OF FORESTRY ACTIVITY

THIS TOWNSHIP AREA FALLS WITHIN THE

TOWNSHIP MANAGEMENT UNIT

NO MAY BE SUBJECT TO FORESTRY OPERATIONS

THE MNR UNIT FORESTER FOR THIS AREA CAN BE CONTACTED AT: P.O. BOX 489

BRASOLA, ONT.

L0K 1T0

705-642-5222

TOWNSHIP SUBJECT TO FORESTRY OPERATIONS

COPY OF THIS MYLAR ARCHIVED APR.15/92

LEGEND

- HIGHWAY AND ROUTE No.
- OTHER ROADS
- TRAILS
- SURVEYED LINES: TOWNSHIPS, BASE LINES, ETC.
- LOTS, MINING CLAIMS, PARCELS, ETC.
- UNSURVEYED LINES
- LOT LINES
- PARCEL BOUNDARY
- MINING CLAIMS ETC.
- RAILWAY AND RIGHT OF WAY
- UTILITY LINES
- NON-PERENNIAL STREAM
- FLOODING OR FLOODING RIGHTS
- SUBDIVISION OR COMPOSITE PLAN
- RESERVATIONS
- ORIGINAL SHORELINE
- MARSH OR MUSKEG
- MINES
- TRAVERSE MONUMENT

DISPOSITION OF CROWN LANDS

TYPE OF DOCUMENT	SYMBOL
PRESENT, SURFACE & MINING RIGHTS	○ or ●
SURFACE RIGHTS ONLY	○ SRC or ●
MINING RIGHTS ONLY	○ M or ●
LEASE, SURFACE & MINING RIGHTS	■
SURFACE RIGHTS ONLY	□
MINING RIGHTS ONLY	◻
LICENCE OF OCCUPATION	▽
ORDER-IN-COUNCIL	OC
RESERVATION	⊙
CANCELLED	⊖
SAND & GRAVEL	⊙

NOTE: MINING RIGHTS IN PARCELS PATENTED PRIOR TO MAY 6, 1913, VESTED IN ORIGINAL PATENTEE BY THE PUBLIC LANDS ACT, R.S.O. 1970, CHAP. 380, SEC. 63, SUBSEC. 1.

SCALE: 1 INCH = 40 CHAINS

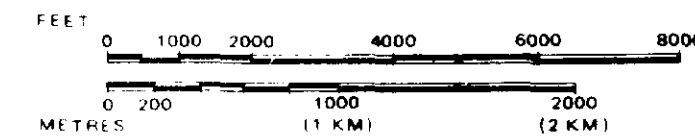

Replaced on Aug 19, 1987

TOWNSHIP

HEARST

M.N.R. ADMINISTRATIVE DISTRICT
 KIRKLAND LAKE
 MINING DIVISION
 LARDER LAKE
 LAND TITLES / REGISTRY DIVISION
 TIMISKAMING

Ministry of Natural Resources
 Land Management Branch
 Ontario

Date: FEBRUARY, 1985
 Number: **G-3213**

