

Diamond Drill

32D04SE0294 14 HEARST

010

Township of HEARST

Report N<sup>o</sup> 14

Work performed by: Falconbridge Copper Limited

Claim N <sup>o</sup>	Hole N <sup>o</sup>	Footage	Date	Note
L 447514	LL-77-1	505.0'	Mar/77	(1)

Notes:

(1) #64-77



THE MINING ACT - MINISTRY OF NATURAL RESOURCES  
DIAMOND DRILLING LOG

Start a new page for every new hole, but fill in top portion of form only on first page for each hole.

FILL IN ON EVERY PAGE

HOLE NO. L.L. 77-1 PAGE NO. 1

DRILLING COMPANY MCKNIGHT DIAMOND DRILLING		COLLAR ELEVATION 1000 ft.	BEARING OF HOLE FROM TRUE NORTH 090° Az	TOTAL FOOTAGE 505' AG	DIP OF HOLE AT collar -50°	LOCATION OF HOLE IN RELATION TO A FIXED POINT ON THE CLAIM D.D.H. L.L. # 77-1	MAP REFERENCE NO. 32 D/4	CLAIM NO. 447514
DATE HOLE STARTED March 2 <sup>nd</sup> , 1977	DATE COMPLETED March 6 <sup>th</sup> , 1977	DATE LOGGED March 8 <sup>th</sup> , 1977	LOGGED BY C.D.A. Comba, MSc.	150 ft   -42°	400 ft   -26°			LOCATION (Tp., Lot, Con. OR Lat. and Long.) Hearst Township
EXPLORATION CO., OWNER OR OPTIONEE FALCONBRIDGE COPPER LIMITED LAKE DEFAULT DIVISION		DATE SUBMITTED March 10 <sup>th</sup> , 1977	SUBMITTED BY (Signature) <i>C.D.A. Comba</i>		503 ft   -19°	380 ft		#3 POST 447514
				503 ft   103° Az				

FOOTAGE FROM	TO	ROCK TYPE	DESCRIPTION Colour, grain size, texture, minerals, alteration, etc.	PLANAR FEATURE ANGLE	CORE SPECIMEN FOOTAGE +	YOUR SAMPLE NUMBER	SAMPLE FOOTAGE		SAMPLE LENGTH	ASSAYS +
							FROM	TO		
0	20.0	Casing	Sand							
20.0	61.4	Greywacke	Thinly bedded (< 1/16" < 4"), commonly graded with tops up hole. Coarser grained sections lt. grey; fine grained sections dk. grey	45°						
61.4	65.9	Graphitic greywacke	Similar to above (20-61.4) but contains up to 35% massive black graphite intercalated with greywacke. Bieby pyrite 5%							
65.9	73.0	Andesite dyke	Lt. grey-green massive featureless, uniform. No chills. Contacts at 45° to C.A.							
73.0	76.3	Greywacke	Variously bedded and contorted except at 74' when thinly bedded material is tectonically displaced 1/16" on successive hairline fractures.							
76.3	79.0	Massive Graphite	Black, massive with thinly bedded greywacke 76.5 to 79. Bedding at 45° cut by hairline carbonate filled fractures at 1/4" intervals. Pyrite in printing planes, as nodules and thin beds < 10%	45°						AMAX
79.0	236	Volcaniclastic breccia	Shattered lt. grey-green massive featureless clasts in graphitic matrix. Blebs and wispy filaments of pyrite and graphite (magnetite) may be associated with the graphitic matrix. Rare to 220'. After 220' the core is barren of sulphides. Rare specks of chalcocite associated with pyrite. At 121.6 a 2" wide carbonate vein at 30° to the C.A. hosts half a dozen euhedral sphalerite crystals up to 1/8" long. Breccia sections may be separated by thin beds of massive graphite ranging in thickness from 1/4" to several feet. The size and frequency of these graphite-rich horizons decreases down hole, and C.A. angles increase from 45° to 70°.							
236.0	287.3	Microdiorite dyke	Med. grey-green fine grained gabbroic. No chills. Contacts at 30-35° to C.A.							
287.3	297.5	Volcaniclastic breccia	Less than 20% graphite as matrix to intensely shattered lt. grey-green clasts.							
297.5	300.5	Microdiorite dyke	Similar to dyke 286 to 287.5. Lower contact at 55° to C.A.							
300.5	420.0	Volcaniclastic breccia	Angular massive featureless clasts up to 4-5" are intercalated with thin screens, 1/4"-2" wide, of lapillae sized sharply looking clasts of similar lithology. All clasts are set in a graphitic chloritic matrix. Graphite content gradually decreases from 15% at start of section to 10%. Clasts are frequently cracked or crazed as if by shattering. Thin screens are 65-75° to C.A.							
420.0	422.8	Lamprophyre dyke	Med. grey-green with black specks; fine grained to med. grained. Carbonate-rich							
422.8	434.0	Volcaniclastic breccia	As above section 300.5 to 420.0							
434.0	471.0	Lamprophyre dyke	Upper section 420.0 to 422.8. Upper contact at 45° Lower contact at 80° to C.A.							
471.0	505	Volcaniclastic breccia	Similar to section 300.5 to 420.0 but graphite content drops to 5-10% or less.							
505			End of hole.							

Hearst map  
M 354

677



ELROY TWP. M-36

900

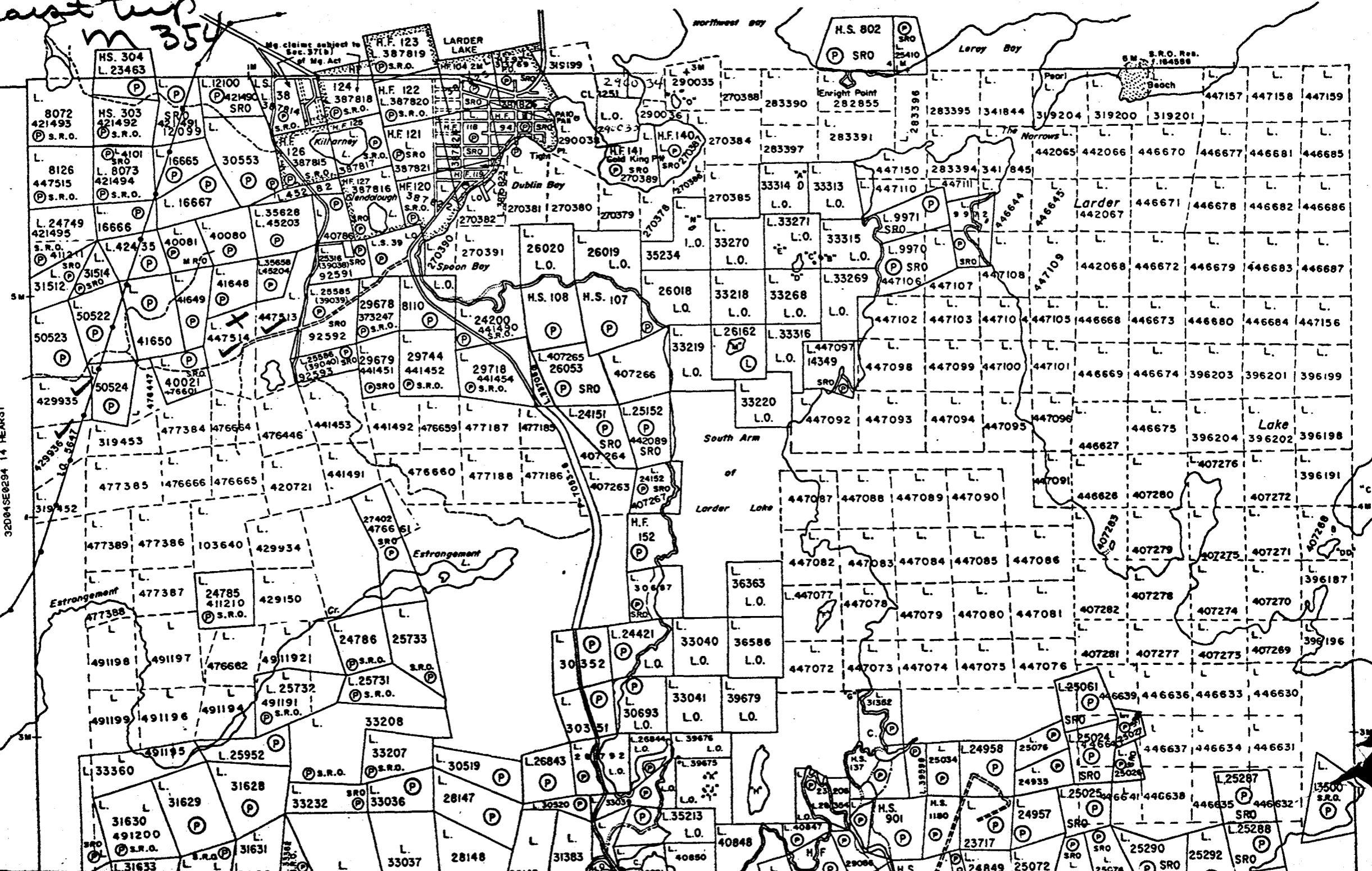

320045E0294 14 HEARST

3M