



32D04SE0305 2.1402 HEARST

010

2,114.02  
B  
0 1/10  
1

PROGRESS REPORT ON THE  
ROBBINS - LARDER PROJECT - HEARST TWP., ONT.  
KERR ADDISON MINES LIMITED 1973

---

General

An exploration agreement was signed with C. Robbins to option a property comprising 25 claims, the former Martin-Bird gold property held in the name of R. MacGregor, and 20 claims acquired by Robbins, all located four miles southwest of Larder Lake in Hearst Twp.

Field work commenced in August, consisting of line cutting to orient geological mapping and prospecting, followed by a drill programme testing the Martin-Bird gold structures in the mine area.

Programme objective was to outline an open-pittable deposit of 500,000 tons or better grading in the order of 0.10 oz. Au. per ton that could be milled at the Kerr Addison plant at Virginiatown.

Total cumulative work performance during period August, 1973 to October, 1973 when drilling terminated was as follows:

Line cutting	- 24.8 miles
Drilling	- 2714 feet

Results

The attached geological plan, and vertical sections (1" = 50') indicates a zone, 1000 feet long, 120 feet wide, tested to a depth of 100 feet grading a minimum of 0.03 oz. Au/ton or a possible maximum of 0.12 oz. Au/ton. The zone could be considered as open to the west for an additional 500 feet. Core sample averages of split core indicated a low average as opposed to sludge samples that indicated the maximum possibility.

Future Plans

In order to more accurately define the actual gold tenor within the zone, bulk milling of the cores will be carried out, the results of which will govern the next phase of exploration.

Respectfully submitted,

  
D. M. HENDRICK,  
Chief Geologist - Exploration.

DMH:lma

D. M. Henschick

G. J. Hinse

Robbins-Jarder Option - "0 - 10" - Progress Report

November 13, 1973

The purpose of this memo is to assess the results to date and to recommend further work. It appears possible that the grade outlined by the core assays does not represent the amount of gold contained in the zone. In this regard, this memo will deal with a zone as defined within its geologic contact which would be suitable for mining purposes.

The property is held under option from C. Robbins who in turn holds under option from E. MacGregor, 134 Palace Drive, Sault Ste. Marie, Ontario, and comprises 25 patented mining claims which MacGregor obtained from Martin-Bird Gold Mines Limited following the settlement of a court case. Robbins has acquired 20 claims adjoining the Martin-Bird property to the east, covering a possible extension of the gold zones along strike.

Price paid by Robbins for the MacGregor claims was \$10,000 cash for a 90% interest. Robbins owns outright the additional 20 claims for which he paid \$1,000.00. These claims are included in the option also.

MacGregor - 25 claims

128854; 128885; 129086; 129596; HF 364; HS 900; HS 901; HS 1180 (1606);  
123717; 124849; 124850; 124935; 124957; 124958; 125034; 125072; 125076;  
131352; HF 137; 140852; 140960; 140961; 140847; 140848; 140850 and  
140851.

Robbins - 20 claims

367333; 367334; 367340; 367341; 367342; 367343; 367344; 367345; 367346;  
367347; 367460; 367461; 367462; 367463; 367464; 367465; 367466; 367467;  
367468 and 367469.

The property is located 4 miles southwest of Jarder Lake. Distance from the mill at Lac to Martin-Bird is 14.5 miles, including a 1.7 mile section of road to be built, from the highway connecting Jarder Lake to Englehart, to the mine site.

The Martin-Bird Company was incorporated in 1936 and it acquired 9 claims from the Martin-Bird syndicate. Development work, consisting of two shafts of 400' each with levels at 125, 250, 375 and a sublevel at 320 feet, 10,301 feet of underground drifting, 5,279 feet of underground cross-cutting, 319 feet of raising, close to 30,000 feet of underground diamond drilling were completed in 1939 before operations were shut down in May 1939. Additional surface diamond drilling was undertaken during 1945 and 1946. C. A. Pain (April 2, 1945) estimated the ore reserves at 157,600 tons of 0.14 and 23,500 tons of 0.206 ozs. gold per ton. The property has been dormant since 1946. From the records available, the work appears to have been thorough and professional, although in some documents, the estimates of ore reserves and proceeds are bit promotional.

There is no supporting evidence that all the zones have not been explored.

Work by Empire Minerals to date this year consists of 1,917.0 feet of diamond drilling.

Work done to date by this company consists of 24,300 miles of line cutting, generally in the drift area, extending from 400 E to 2000 W, and also over the drift to the east, and 2,715.6 feet of diamond drilling in 10 holes. Additional holes 1 - 3 and 4 drilled by Empire Minerals was also carried out.

At the level of the mine the country rock is largely greywacke with minor amounts of quartz conglomerate. These are intruded by bodies of syenite porphyry, with minor associated small amounts of lamprophyre. A band of gneiss is also visible along the east side of Sharp Creek. An east-west trending diastrophic zone is visible in the south of the main workings.

The main vein zone at the mine is located along a zone in the sedimentary rock. The bedding plane is sharply dragged to the east. The vein zone strikes about 43°, which direction coincides with a zone of secondary veining, or rock contraction, which may be seen on the surface along the strike to the west. There is no record of any noticeable shear or fault structure in the mine. On the surface the veins occur as irregular quartz bodies in the greywacke or the greywacke.

The vein zone in the main mine strikes 43° - 45° and dips steeply to the north. The country rock is very largely greywacke with small bodies of syenite porphyry and lamprophyre. The vein zones consist of quartz veins of irregular shape and direction. These are twisting and discontinuous bodies which are irregularly shaped. The quartz contains a considerable amount of pyrite and other minerals. It is also commonly found on the surface as quartz veins. The vein zone is described as zones of light green to light yellowish quartz. The vein zone is described as zones of light green to light yellowish quartz. The vein zone is described as zones of light green to light yellowish quartz. Gold values are low and are found in the tips of the veins and are carried in sulphides in the alluvial deposits. The veins are largely pyrite with traces of chalcopyrite and sphalerite. Along the veins in both coarse and fine grained pyrite bodies are found, which may contain native gold.

The geological map of the mine has been outlined by the previous development work on the mine. It is suggested that the possibility that these zones could be developed in the future should be considered which would average between 1000 and 2000 feet.

The geological map of the mine was compiled and a report by J. Barrett, April 13, 1954, is attached. The level in the vicinity of the No. 1 shaft is 1000 feet above the level of the 12 feet above the 300 foot sub-level.

On the 375 ft. level there is a slight alteration of the rock for a width of 6 feet, but only one foot of it - a quartz vein - is gold bearing. The No. 1 shaft roadway slashes out at a depth of about 350 feet. Most of the ore contacts are projected.

Geologizing of the last 20 claim group has been completed and the map has been filed. In the shaft area, geologizing is completed from line 400 to 400 B, from 400 C to 400 D.

Drill results to date have outlined a zone of an average true width of 119.7 feet over a strike length of 1,000 feet indicating a possibility of close to 1,000 tons per vertical foot containing a minimum of .03 ozs. of gold per ton as indicated by the core assays. Sludges, where collected returned in 4 holes a grade of .11 to .13 ozs. per ton and in one hole a grade of .02 ozs. per ton.

Several tables are hereby annexed and the possibility that the occurrence of auriferous free gold in this zone could be compared to the carbonate ore mined at Chesterville and here, is studied on the tables as to what grades could be expected if this was a proper case. At this stage, it should be pointed out that the rule-of-thumb used at Kerr or at Chesterville arrives at grades that are slightly higher than those obtained by core averages and by combining the core with the sludge averages.

The following conclusions are drawn out from the results of tables A, B and C:

1) Weighted core average is the same as the one obtained by using the Chesterville rule-of-thumb at a minimum, i.e. .03 ozs. per ton.

2) Kern's minimum grade of 1.5x the arithmetic average is close to the weighted sludge and core average, i.e. .08 ozs. per ton.

3) The grade obtained by using the maximum of Chesterville rule-of-thumb is close to slightly higher than the grade mentioned above, i.e. .09 to .09 ozs. per ton.

4) The grade obtained by using the No. 3 assumption, Chesterville, is the same as the arithmetic average, i.e. .054 ozs. per ton.

If this type of occurrence, auriferous free gold, can be compared to the carbonate ore mined at Kerr and Chesterville, it is reasonably safe to assume that the actual grade of the deposit could be more than the one indicated by weighted core averages. There is a possibility that the actual grade could be as high as the one indicated by combining the weighted core average and the sludge averages.

Geological mapping and the meagre information we have from Martin-Bird records indicates that the zone extends past 1800 W.

No attempts are being made to estimate the actual cost of mining the zone, but costs obtained are quoted as to indicate that a relatively low cost would be expected.

Orchard Hill Allard Open Pit

Length 200' - Width 25' - Depth 90 - 100'

Spillage 1.00 - Mining incl. transportation \$1.70/ton

1972 - Mining \$3.50 V/O ratio 2/1

Double - haulage to mill .10¢ ton/mile 3 miles +

single - Joburke - haulage .04¢ ton/mile 70 miles

Mill cost at here including marketing \$2.14/ton.

Further work is required to assess the grade of the zone and bulk sampling of the cone's rejects of holes # 3 and # 10 will be analysed to check against the weighted core averages. Pilot milling of these samples would provide a better answer, but the facilities have not been located as yet.

GJM:sgw  
Incl.

G. J. Hinse

3/1/74

D. E. Hendrick

C. J. Hinse

Hobbs-Lander Option - "0 - 10" - Progress Report

November 13, 1973

Table "A"

"0 - 10"

Hobbs-Lander Option

Geological Contact - Arithmetic Average used at Kerr

<u>Hole #</u>	<u>From</u>	<u>To</u>	<u>Core Length</u>	<u>Weighted Average</u>	<u>No. of Samples</u>	<u>Total Au. Values</u>	<u>Arithmetic Average</u>	<u>Minimum 1.5x</u>	<u>Maximum 2.0x</u>	<u>True Width</u>
10	21.0	164.2	135.2	.02	36	157	.044	.07	.09	104'
9	20.0	211.6	191.6	.014	46	72	.016	.03	.03	146'
8	24.5	255.0	230.5	.043	43	189	.044	.07	.09	125'
7	110.0	225.0	115.0	.018	27	63	.023	.03	.05	92'
6	20.3	147.0	126.7	.046	31	337	.11	.16	.22	111'
5	40.0	214.0	174.0	.003	44	34	.013	.02	.03	146'
4	48.5	218.0	169.5	.027	47	557	.12	.18	.24	127'
3	26.6	230.4	143.8	.054	39	316	.081	.12	.16	124'
2	48.8	222.5	153.7	.051	33	170	.045	.07	.09	125'
1	131.0	251.3	120.3	<u>.022</u>	38	172	.045	.07	.09	<u>93'</u>
			WA	.03						119.3'

E. H. Hendrick

G. J. Hinse

Robbins-larder Option - "0 - 10" - Progress Report

November 13, 1973

Table "B"

	<u>True Width</u>	<u>Arithmetic Average</u>	<u>Minimum Grade</u>	<u>Maximum Grade</u>	<u>Core &amp; Sludge</u>
# 10	104'	.044	.07	.09	.065
# 9	146'	.016	.02	.03	.07
# 8	125'	.044	.07	.09	----
# 7	92'	.023	.03	.05	----
# 6	111'	.110	.16	.22	.08
# 5	146'	.013	.02	.03	.01
# 4	127'	.120	.18	.24	.08*
# 3	124'	.080	.12	.16	----
# 2	125'	.045	.07	.09	----
# 1	93'	.045	.07	.09	----
Average	119.3'	.054	.08	.11	

\*Part of sludge missing 190.0 - 218.0'



D. M. Hendrick

G. J. Hinse

Robbins-larder Option - "O - 10" - Progress Report

November 13, 1973

Table "C"

Wilton's formula - Chesterville

In carbonate zone, one sample in 10 assaying above .50 ozs. of gold per ton returned a mill head of .15

<u>Hole #</u>	<u>Number of Samples</u>	<u>Sights of Visible Gold</u>	<u>Above .50</u>	<u>.25 to .50</u>	<u>.10 to .25</u>	<u>Results of Assay V.G. in Samples</u>
1	38	2	0	3	3	2 negative?
2	38	0	1	0	4	
3	39	1	2	1	6	1 negative
4	47	0	1	1	2	1 negative
5	44	2	0	0	1	
6	31	1	3	0	0	1 negative
7	27	2	0	1	2	
8	43	0	0	1	6	
9	46	1	0	1	1	1 negative?
10	<u>36</u>	<u>1</u>	<u>1</u>	<u>0</u>	<u>3</u>	1 negative?
	389	12	8	8	28	

1) 1 in 10 = 38.9 samples,  $\frac{8}{38.9} \times .15 = .03$

2) Assuming  $\frac{1}{5}$  weight for samples assaying from .25 to .50 and  $\frac{1}{5}$  weight for samples assaying from .10 to .25, we have  $8 + 4 + 5 = 17$   
 $\frac{17}{38.9} \times .15 = .066$

3) Assuming .50 for an assay containing visible gold, we have  $8 + 6 = \frac{14}{38.9} \times .15 = .054$

4) Assuming .50 for an assay containing visible gold, included in 2, we have  
 $\frac{22}{38.9} \times .15 = .09$



32D04SE0305 2.1402 HEARST

020

KERR ADDISON MINES LIMITED  
GEOLOGICAL REPORT  
ON  
ROBBINS - LARDER OPTION "O - 10"  
"EAST 20 CLAIM GROUP"

---

INTRODUCTION

The property was geologized during the Fall of 1973 to search for the eastern extension of the Martin Bird gold bearing shear zone.

PROPERTY

The property is held under option from C. D. Robbins, 130 Brunelle Street, Beloeil, Quebec, and it consists of 20 unsurveyed claims of approximately 40 acres each, numbered as follows: 367338, 367339, 367340, 367341, 367342, 367343, 367344, 367345, 367346, 367347, 367460, 367461, 367462, 367463, 367464, 367465, 367466, 367467, 367468 and 367469.

LOCATION AND ACCESS

The property is located 4 miles southeast of the Town of Larder Lake. It is accessible from the secondary highway connecting Larder Lake to Englehart and via the old Martin Bird mine road, a driving distance of 5.2 miles from Larder Lake.

PREVIOUS WORK

Part of the property was formerly held by Arc Mining Syndicate Limited and Velvet Larder Mines Limited. Numerous surface trenches and pits are evidence of past intense prospecting activity.

GEOLOGY

The area is underlain essentially by Timiskaming sedimentary argillites, sandstones and conglomerates with occasional outliers of Cobalt

sediments of similar nature. Minor exposures of Keewatin volcanic rocks do occur as andesite agglomerate.

The Timiskaming sedimentary rocks as well as the volcanic rocks have been extensively intruded by syenite. Minor intrusives such as lamprophyre and diabase dikes also occur.

Strike of bedding and flows is generally north-south with dips being vertical; these, however, are altered at close proximity to faults and intrusives.

#### WORK DONE

##### a) Line Cutting and Chaining

A line grid, with a base line striking north 55° east was established from the # 1 shaft of the Martin Bird property. Lines were turned off at 90° to the base line at every 400 feet. A second base line was also cut at 3700 feet south of the first base line. The grid comprises 19.4 miles of cut lines.

##### b) Geological Survey

The entire claim group was mapped at a scale of 1" = 200'. The general geology and structure of the claim group have been described above.

##### Detailed Geology

Keewatin - Volcanic Agglomerate - This rock unit is dark green and contains 90% subangular, elongated and foliated fragments in a calcite matrix.

Timiskaming - The argillite is dark green, finely bedded and foliated, with foliation well developed parallel to bedding and parallel to fault zones. It contains essentially clay sized particles with chloritic alteration.

The greywacke is a sandstone of dark greyish-green colour with

variable amounts of sand particles and chloritic clay matrix. Foliation is influenced by the matrix content.

The conglomerate consists of well rounded 1" - 2" diameter boulders of variable composition which constitute 70% of the conglomerate; the matrix is essentially chloritized clay particles with varying amounts of sand sized particles.

The chert is a finely banded unit, dark to light grey in colour with an aphanitic texture.

Algoman - The syenite has light pink to mauve colour, is usually porphyritic and contains up to 40% euhedral crystals of twined microcline feldspar embedded in a darker aphanitic matrix of feldspar. The syenite contains less than 5% quartz grains but many quartz stringers. Generally, the syenite contains 1% pyrite as fine cubic grains.

The texture and colour of the syenite varies according to the quantities of digested country rock.

Multiple injections have introduced porphyritic syenite and aplite dikes within the main mass.

The lamprophyre is dark grey and speckled. It contains elongated assemblies of chlorite and or biotite (30%) in a fine matrix of feldspar (70%).

Huronian (Cobalt Series) - These units consist of flat lying beds of argillites, sandstones and tillites.

... ..

immediately to the west of the claim group under study, lie within a fault which has deflected the north-south trending sedimentary beds parallel to it (north  $55^{\circ}$  east), induced fracturing in the syenite as well as in the sediments and thus permitted the circulation of "ore bearing solutions". These solutions bleached the syenite, altered the argillites to carbonate, fuchsite and magnetite rich zones and gave birth to numerous quartz-carbonate stringers. The gold occurs as fine grains within the pyrite cubes as well as in the quartz-carbonate stringers.

This fault extends eastward: its extension has not been well prospectable due to the thickness of the overburden. Only a few deep trenches reveal its presence.

The syenite in the area contains appreciable quantities of pyrite (1%) as well as numerous stringers of quartz-carbonate and large veins. Samples randomly assayed have always yielded traces of gold. It appears that, in general, the syenite is auriferous and is probably genetically associated with the gold occurrences on the Martin Bird property: similar occurrences are possible on this property if the structural control (fault) is effective in the concentration of gold.

#### CONCLUSIONS AND RECOMMENDATIONS

Since a few trenches have revealed the presence of the extension of the fault which contains the gold occurrences on the Martin Bird property, a few drill holes to the east could provide helpful information as to the economic potentials of this claim group.

Respectfully submitted,

*G. J. Hinse*

G. J. Hinse, P. Eng.

December 20, 1973

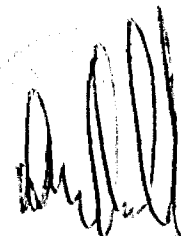

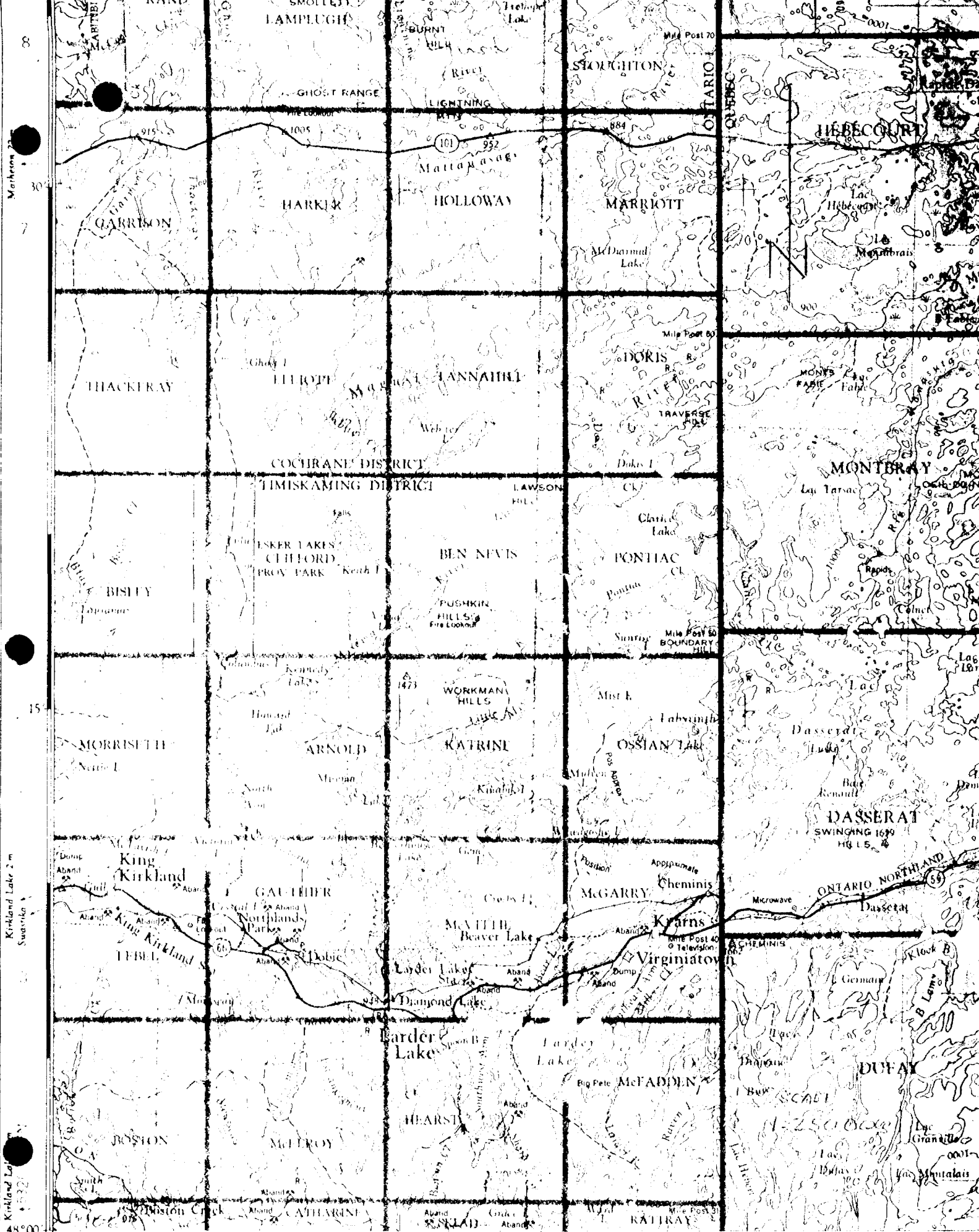

30  
7  
15  
2 m  
48°00'

80°00' PACAUD 4 45 30'

KERR ADDISON MINES LIMITED

LABOUR CONTRACT

I, Robert Phillips of 441 MENARD ST., ROUYN, QUEBEC

do hereby contract to do X days of (casual labour (claim staking (linecutting) for Kerr Addison Mines

Limited, at the rate of (\$ per day. (\$ per claim. (\$ per mile.

Additional terms (if any):

KERR ADDISON MINES LIMITED

(Field Representative

DATE: JUN - 5 1973

SIGNED Robert Phillips (Contractor)

WITNESSED J.M. V... (Witness)

Required data on Contractor

- 1. Address for forwarding balance of pay 441 MENARD STREET, ROUYN, QUEBEC
2. Unemployment insurance book or Application for Social Insurance Number.
3. Signed TDI form (TPDI form, if working in Quebec), unless Contractor is willing to be taxed at the single rate.

NOTES TO FILED REPRESENTATIVE:

- 1. Please send a separate letter of notification to Head Office IMMEDIATELY upon signing the contract, enclosing U.I.C. book or Application for Social Insurance Number. 431-467-062
2. A separate contract should be completed in duplicate for each person who is to be paid by the Company.
3. This form replaces the regular Employment Notice and Monthly Time Record only for the period contracted for, and should be completed and mailed to Head Office IN DUPLICATE when the contract has been terminated.

DATES WORKED:

From: JUN - 5 1973 To: AUG - 7 1973

GROSS EARNINGS: 18.7 (days) at (\$ per day) = \$ 1321.80
1.84 (miles) at (\$ per mile)

Amount of personal purchases: \$

Advances to Contractor by Field Representative: \$

TOTAL DEDUCTIONS (Not to exceed 75% of amount earned) \$

ACCOUNT CODES: 0-100-13-13800

RECEIVED ABOVE ADVANCE OF EARNINGS

Robert Phillips CONTRACTOR

nce of earnings will be mailed from the HEAD OFFICE of this Company shortly contract has been terminated.



KERR ADDISON MINES LIMITED

LABOUR CONTRACT

REJEAN THIBAUT

of 70 DES OBLATS ST. WEST, ROUYN

I hereby contract to do X days of (casual labour / claim staking / linocutting) for Kerr Addison Mines Limited

at the rate of (\$ \_\_\_\_\_ per day, \$ \_\_\_\_\_ per claim, \$ 60.00 per mile, 75.00 " " )

Additional terms (if any):

KERR ADDISON MINES LIMITED

..... R. Hume .....  
(Field Representative)  
DATE: JUN - 5 1973

SIGNED R. Jean T. Thibault (Contractor)  
WITNESSED M. W. ...

Required data on Contractor

- 1. Address for forwarding balance of pay ..... 70 DES OBLATS ST. WEST, ROUYN, QUEBEC
2. Unemployment Insurance book or Application for Social Insurance Number.
3. Signed TDI form (TPDI form, if working in Quebec), unless Contractor is willing to be taxed at the single rate.

NOTES TO FILED REPRESENTATIVE:

- 1. Please send a separate letter of notification to Head Office IMMEDIATELY upon signing the contract, enclosing U.I.C. book or Application for Social Insurance Number. 210 907 804
2. A separate contract should be completed in duplicate for each person who is to be paid by the Company.
3. This form replaces the regular Employment Notice and Monthly Time Record only for the period contracted for, and should be completed and mailed to Head Office IN DUPLICATE when the contract has been terminated.

DATES WORKED:

From: JUN - 5 1973 To: AUG - 7 1973

GROSS EARNINGS: 1973 (days) at (\$ \_\_\_\_\_ per day) = \$ \_\_\_\_\_  
184 (claims) at (\$ \_\_\_\_\_ per claim) = \$ \_\_\_\_\_  
2500 (miles) at (\$ 60.00 per mile) = \$ \_\_\_\_\_

Amount of personal purchases: \$ \_\_\_\_\_  
Advances to Contractor by Field Representative: \$ \_\_\_\_\_  
TOTAL DEDUCTIONS (Not to exceed 75% of amount earned) \$ \_\_\_\_\_

ACCOUNT CODES: PC 80 1 1 1 1 1 1  
100 13 1 1 1 1 1 1  
0 100 13 1 1 1 1 1 1

RECEIVED ABOVE ADVANCE ON EARNINGS  
R. Jean T. Thibault  
CONTRACTOR

Balance of earnings will be mailed from the HEAD OFFICE of this Company shortly after contract has been terminated.

KERR ADDISON MINES LIMITED

LABOUR CONTRACT

I, ALCIDE THIBAUT of 116 TARDIF ST, ROUYN, QUEBEC

do hereby contract to do X days of (casual labour / claim staking / linecutting) for Kerr Addison Mines Limited, at the rate of (\$ \_\_\_\_\_ per day. / \$ \_\_\_\_\_ per claim. / \$ 60.00 per mile. / 75.00)

Additional terms (if any):

KERR ADDISON MINES LIMITED

..... G. Hogue .....  
(Field Representative)

DATE: JUN - 5 1973

SIGNED Alcide Thibault  
(Contractor)

WITNESSED J. M. White

Required data on Contractor:

1. Address for forwarding balance of pay ..... 116 TARDIF STREET  
ROUYN, QUEBEC .....
2. Unemployment Insurance book or Application for Social Insurance Number.
3. Signed TDI form (TPDI form, if working in Quebec), unless Contractor is willing to be taxed at the single rate.

NOTES TO FILED REPRESENTATIVE:

1. Please send a separate letter of notification to Head Office IMMEDIATELY upon signing the contract, enclosing U.I.C. book or Application for Social Insurance Number. 201 316 247
2. A separate contract should be completed in duplicate for each person who is to be paid by the Company.
3. This form replaces the regular Employment Notice and Monthly Time Record only for the period contracted for, and should be completed and mailed to Head Office IN DUPLICATE when the contract has been terminated.

DATES WORKED:

From: JUN - 5 1973 To: AUG - 7 1973

GROSS EARNINGS: 1773 (days) at (\$ \_\_\_\_\_ per day) = \$ \_\_\_\_\_  
194 (claims) at (\$ \_\_\_\_\_ per claim) = \$ \_\_\_\_\_  
75.00 (miles) at (\$ 60.00 per mile) = \$ \_\_\_\_\_  
# 75.00

Amount of personal purchases: \$ \_\_\_\_\_

Advances to Contractor by Field Representative: \$ \_\_\_\_\_

TOTAL DEDUCTIONS (Not to exceed 75% of amount earned) \$ \_\_\_\_\_

ACCOUNT CODES: PC 91 13 11220  
PO 11 12 11220  
11 12 13 11220

RECEIVED ABOVE ADVANCE ON EARNINGS  
Alcide Thibault  
CONTRACTOR

Balance of earnings will be mailed from the HEAD OFFICE of this Company shortly after contract has been terminated.

DETAILS OF DISBURSEMENTS FOR PERIOD ENDING September 30, 1973 19\_\_

DATE		NATURE OF EXPENDITURE	NAME OF JOB OR PROPERTY	V	AMOUNTS	
Sept	4	use of pers. vehicle (88 <sup>6.02</sup> miles)	0-10A-5 Robbin's Larder Option		10	56
	5	" "	0-10A-5		10	56
	6	" "	0-10A-5		10	56
	7	" "	0-10A-5		10	56
	10	" "	0-10A-5		10	56
	11	" "	0-10A-5		10	56
	12	" "	0-10A-5		10	56
	13	" "	0-10A-5		10	56
	14	" "	0-10A-5		10	56
	17	" "	0-10A-5		10	56
	18	" "	0-10A-5		10	56
	19	" "	0-10A-5		10	56
	20	" "	0-10A-5		10	56
	21	" "	0-10A-5		10	56

14 1.234

McVITTIE TWP. M-370

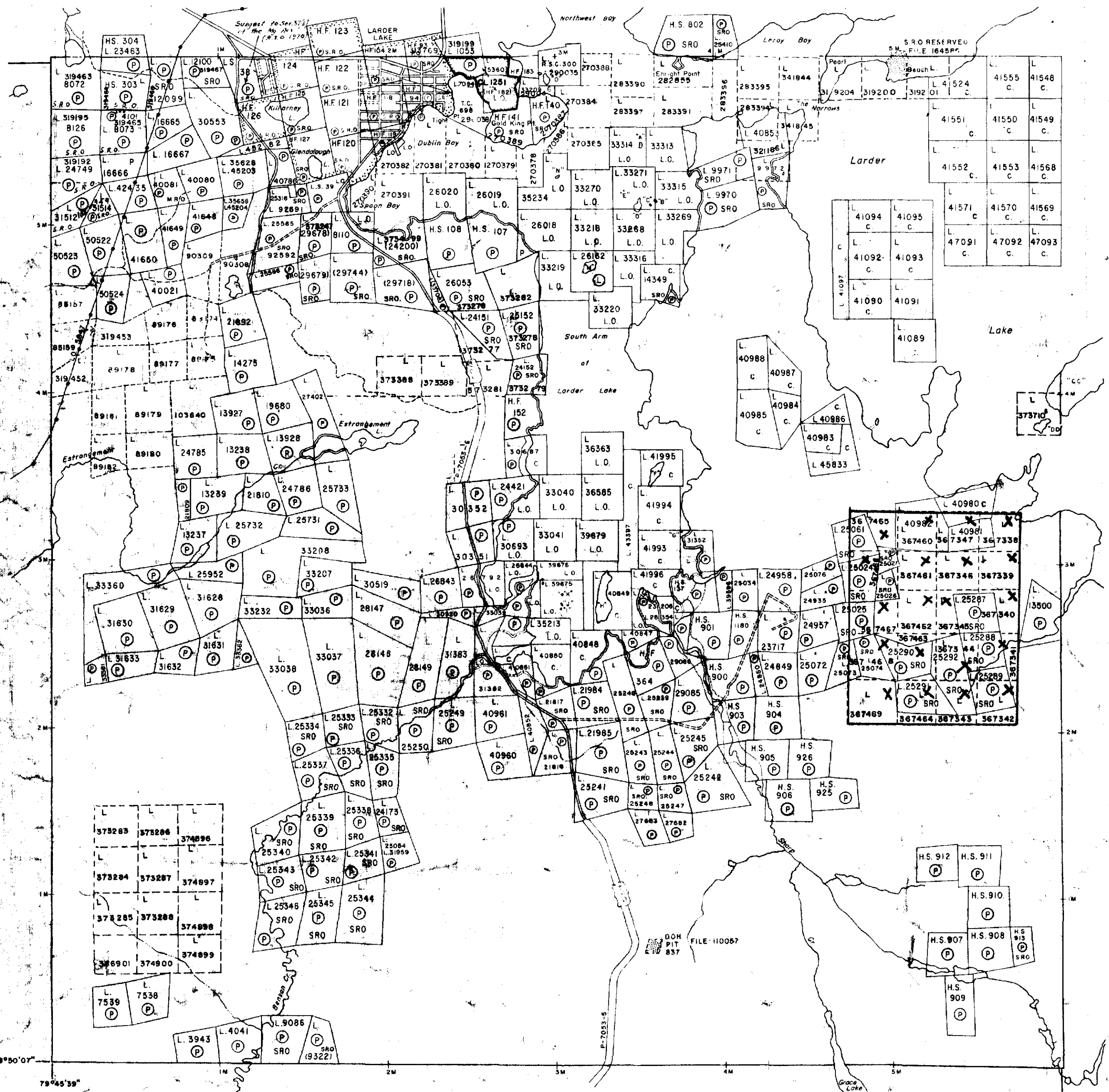

MCELROY TWP. M-366

McFADDEN TWP. M-368

THE TOWNSHIP OF HEARST

HEARST

DISTRICT OF TIMISKAMING

LARDER LAKE MINING DIVISION

SCALE: 1-INCH 40 CHAINS

LEGEND

- PATENTED LAND ● or (P)
- CROWN LAND SALE C.S
- LEASES (L)
- LOCATED LAND Loc.
- LICENSE OF OCCUPATION L.O.
- MINING RIGHTS ONLY M.R.O.
- SURFACE RIGHTS ONLY S.R.O.
- ROADS
- IMPROVED ROADS
- KING'S HIGHWAYS
- RAILWAYS
- POWER LINES
- MARSH OR MUSKEG
- MINES
- CANCELLED
- PATENTED S.R.O.

NOTES

400' Surface-Rights reservation around all lakes and rivers.

Township of HEARST lies entirely within THE CORPORATION OF THE TOWNSHIP OF LARDER LAKE created on 31st DECEMBER 1945 Municipal Board Order PF B-4045-6 FILE #29282.

Staking of mining claims within the area shown thus ~~is~~ - Town of Larder Lake - subject to Sec. 37(b) of the Mining Act (R.S.O. 1970).

MINING LANDS - DATE OF ISSUE  
JAN 31 1974  
MINISTRY OF NATURAL RESOURCES

File-2.1402

PLAN NO. M-354

ONTARIO  
MINISTRY OF NATURAL RESOURCES  
SURVEYS AND MAPPING BRANCH

SKEAD TWP. M-387



32004SER305 2.1402 HEARST

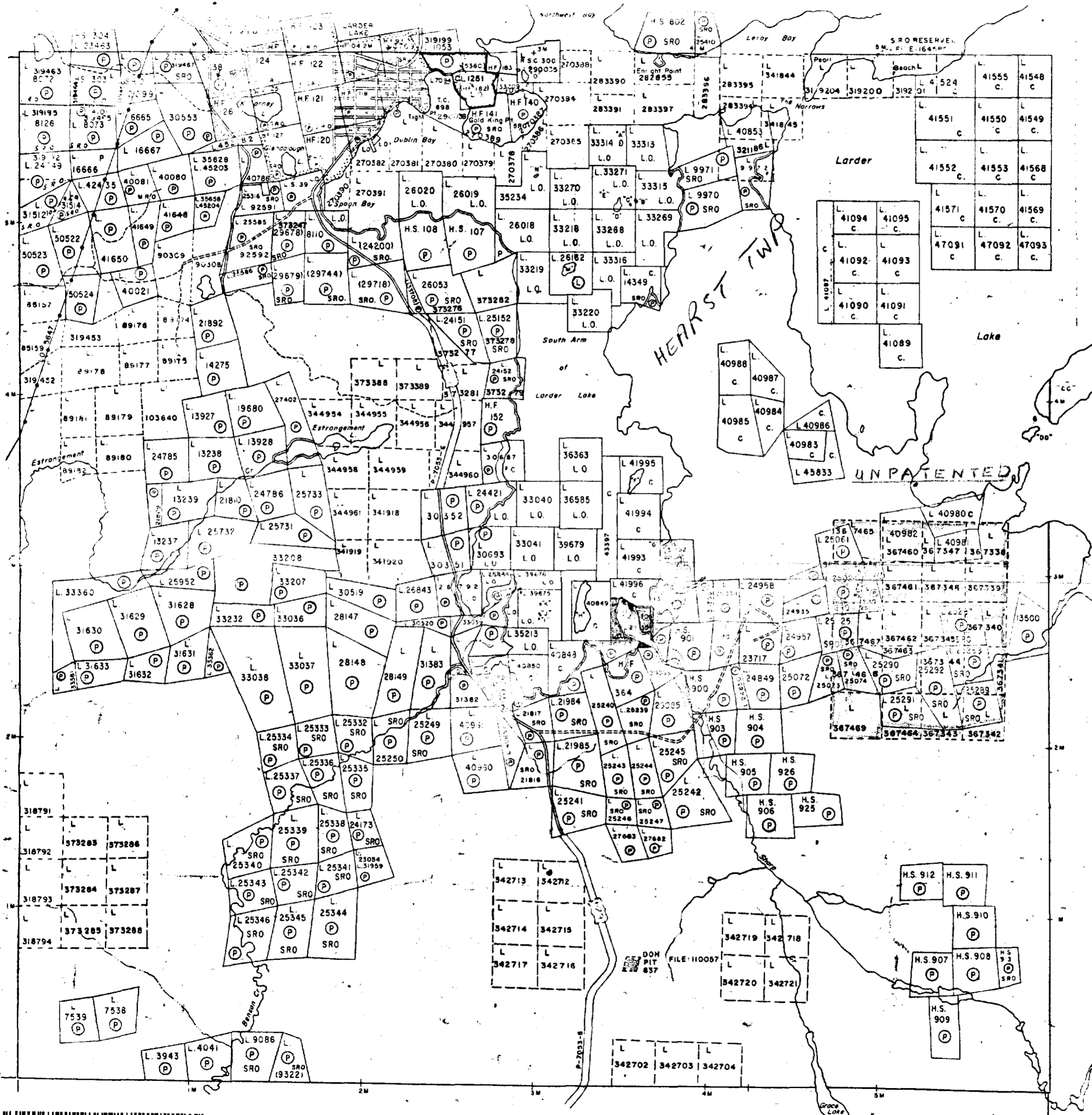

McFADDEN TWP. M-368





24958

clay oven

367465

clay oven

24955

367460

24957

25072

clay oven

367463

367469

367444

367442

367441

367443

367445

clay oven

clay oven

L-0

L-1E

L-2E

L-3E

L-4E

L-5E

L-6E

L-7E

L-8E

L-9E

KE  
ROB  
HEARS

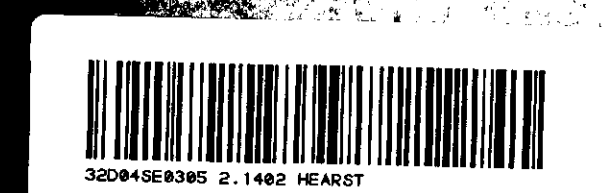

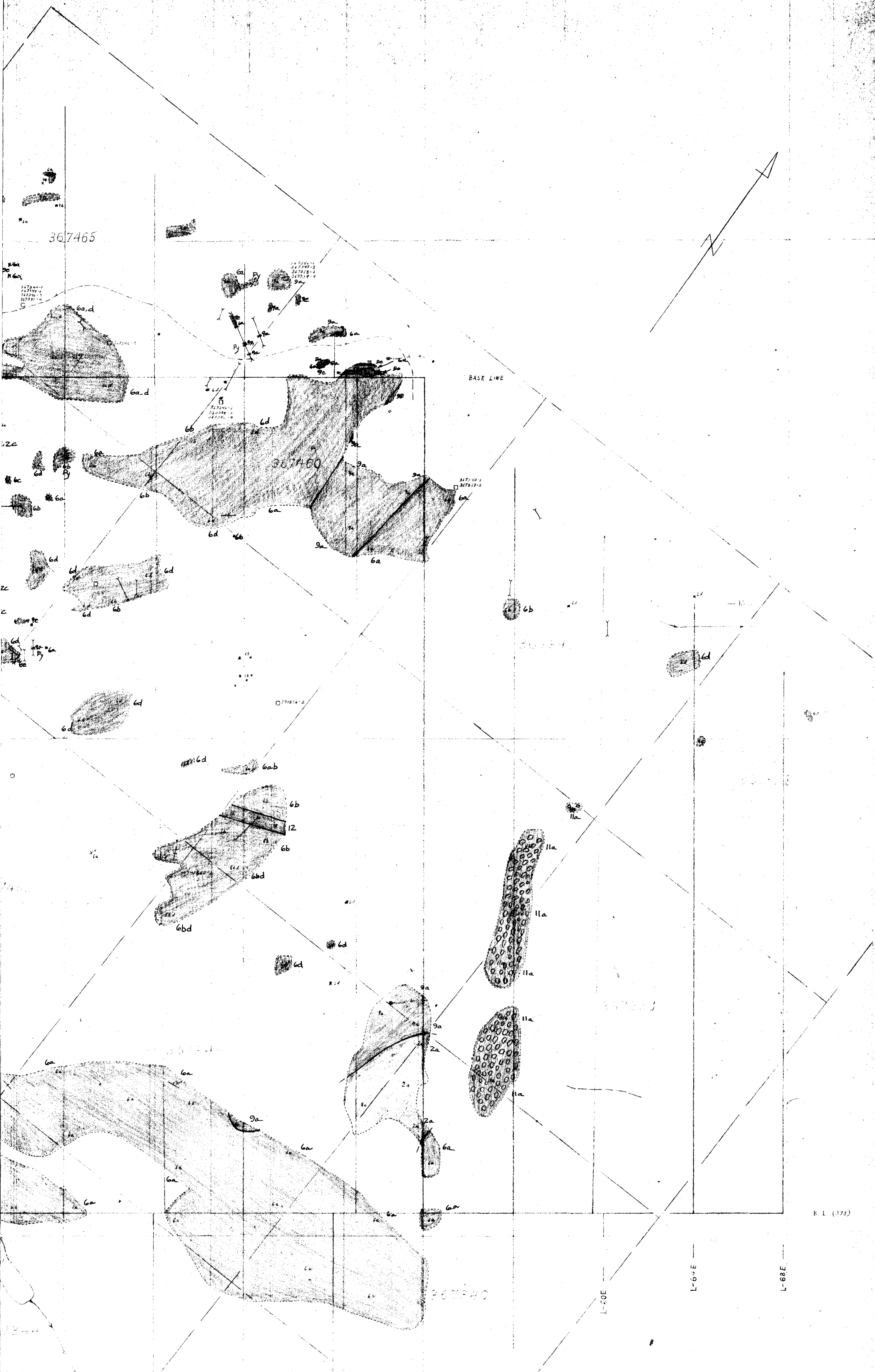

**LEGEND**

- | GEOLOGY |                             |
|---------|-----------------------------|
| 11a     | CONGLOMERATE (LOCAL SERIES) |
| 12      | SLAIN PIT                   |
| 9c      | ANDESITE                    |
| 9b      | ANDESITE                    |
| 9a      | ANDESITE                    |
| 6a      | GREYWACKE                   |
| 6b      | SANDSTONE                   |
| 6d      | SLATE AND ARGILLITE         |
| 6c      | IRON FORMATION              |
| 5a      | CONGLOMERATE                |
| 2a      | ANDESITE                    |
| 2c      | FLOW BRECCIA                |
| +       | SCHISTOSITY                 |
| -       | BEDDING                     |
| □       | SLAIN PIT                   |
| -       | TRENCH                      |
| ○       | OUTCROP AREA                |
| x       | SMALL OUTCROP               |
| -       | TRAIL                       |
| -       | CREEK                       |
| Py      | PYRITE                      |
| Ch      | CHALCOPHITE                 |
| Ga      | GALENA                      |

KERR-ADDISON MINES LTD  
ROBBINS - LARDER OPTION 0 - 10"

HEARST TWP ONTARIO

GEOLOGICAL SURVEY

MAPPING: EDOUARD CHARTRE  
FERNAND POULIDT

SCALE 1" = 200'

NOVEMBER 1973





