



32D04SE0331 2.14697 SKEAD

010

## REPORT ON PROSPECTING

## SKEAD TOWNSHIP, ONTARIO

A prospecting trip was made to northern Skead Township by Damien Duff and Richard Labine who travelled from Timmins where they were joined by R. MacGregor. The area can be reached by travelling south from Larder Lake along Highway 624. The purpose of the prospecting was to examine and collect samples of potential gold mineralization in carbonatized and syenite rocks of the Manor area and Lincoln-Nipissing shear zone. Eight samples were collected and later assayed for gold.

Analysis and sample locations are attached.

Respectfully submitted

R.A. MacGregor, P. Eng.

RECEIVED

AUG 25 1992

MINING LANDS BRANCH

Lot 5

Lot 6

Hwy 624

L 341838

SI dump  
54  
52  
Manor shaft

57 x 55

59 x 58

L 892017

L 341839



Con 6  
Con 5

Sampling - Prospecting Area  
Skead Township Ont.

Scale 1" = 400'



# Swastika Laboratories

A Division of Assayers Corporation Ltd.

Assaying - Consulting - Representation

Established 1928

## Geochemical Analysis Certificate

1W-3328-RG1

Company: **FALCONBRIDGE LIMITED (TIMMINS)**  
 Project: **8105**  
 Attn: **DAMIEN DUFF**

Date: **JUL-09-91**  
 Copy 1. P.O.BOX 1140 TIMMINS, ONT. P4N 7H9  
 2. FAX# 264-6080 PH# 267-1188

We hereby certify the following Geochemical Analysis of 8 CORE samples submitted JUL-05-91 by .

Sample Number	Au ppb	MAP LOCATION #	Description
08551	171	3	MARITIC TUFF
08552	5	3	CARBONATIZED MANDRE SHEAR
08553	10	3	FELSIC DYKE AT MANDRE SHAFT
08554	5	3	CARBONATIZED MANDRE SHEAR
08555	5	4	ROADSIDE CHERT HORIZON
08557	5	6	"SEDIMENT"
08558	254	7	GREEN CARB ROCK
08559	106	7	BYENITE NR. GREEN CARB ROCK
08560 Not Rec'd	-	-	-

RECEIVED

AUG 25 1992

MINING LANDS BRANC

Certified by Donna Gardner

Swastika Laboratories  
 P.O. Box 10  
 Swastika, Ontario  
 P0K 1T0

**INVOICE**

NO: 25289

DATE: 07-09-71

PAGE: 1 of 1

SOLD TO: Invention Number: R 100294743

SHIP TO:

Same

Falconbridge Exol Ltd  
 Box 1140  
 Timmins, Ontario  
 P4N 2H2

ITEM NO.	QUANTITY	UNIT	DESCRIPTION	G	P	UNIT PRICE	AMOUNT
075	8	1	MT. Devices			8.000	64.00
	8	1	Sample Material			2.700	21.60
			Perth 10-3321-RC1 48105				
			D. Duff				
			3-081 @ 7 % Excluded				5.99
						<b>TOTAL</b>	<b>91.59</b>

SWASTIKA LABORATORIES

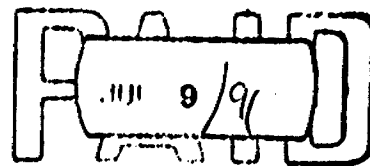

WITH THANKS

*[Signature]*

COMMENTS:  
 Lot 30 Lays

**RECEIVED**

AUG 25 1992

MINING LANDS BRANCH

**Report of Work Conducted After Recording Claim**

Mining Act

Transaction Number	92-4
CLAIM NO.	9280 00109

*GAS*



32D04SE0331 2.14697 SKEAD

to be used for correspondence. Questions about Mining Act and Mines, Fourth Floor, 159 Cedar Street,

**14697**

900

- Instructions:**
- Please type
  - Refer to the Mining Act and Regulations for requirements of mining assessment work or consult the Mining Recorder.
  - A separate copy of this form must be completed for each Work Group.
  - Technical reports and maps must accompany this form in duplicate.
  - A sketch, showing the claims the work is assigned to, must accompany this form.

Recorded Holder(s)	<i>RA MacGregor</i>	Client No.	<i>162287</i>
Address	<i>28 Ford St Sault Ste Marie Ont</i>	Telephone No.	<i>949-4250</i>
Mining Division	<i>Larder Lake</i>	Township/Area	<i>Skead</i>
Dates Work Performed	From: <i>July 4/91</i>	To: <i>March 5/92</i>	M or G Plan No. <i>M-387</i>

**Work Performed (Check One Work Group Only)**

Work Group	Type
Geotechnical Survey	
Physical Work, Including Drilling	<i>Prospecting, Report</i>
Rehabilitation	
Other Authorized Work	
Assays	<i>Analysis of samples</i>
Assignment from Reserve	

**RECEIVED**  
AUG 25 1992

MINING LANDS BRANCH

Total Assessment Work Claimed on the Attached Statement of Costs \$ 740

Note: The Minister may reject for assessment work credit all or part of the assessment work submitted if the recorded holder cannot verify expenditures claimed in the statement of costs within 30 days of a request for verification.

**Persons and Survey Company Who Performed the Work (Give Name and Address of Author of Report)**

Name	Address
<i>Damien Duff</i>	<i>571 Moneta Ave Timmins Ont</i>
<i>Richard Labine</i>	<i>571 Moneta Ave Timmins Ont</i>
<i>R. A. MacGregor</i>	<i>28 Ford St. Sault Ste Marie Ont.</i>

(attach a schedule if necessary)

**Certification of Beneficial Interest \* See Note No. 1 on reverse side**

I certify that at the time the work was performed, the claims covered in this work report were recorded in the current holder's name or held under a beneficial interest by the current recorded holder.	Date	Recorded Holder or Agent (Signature)
	<i>March 5/92</i>	<i>[Signature]</i>

**Certification of Work Report**

I certify that I have a personal knowledge of the facts set forth in this Work report, having performed the work or witnessed same during and/or after its completion and annexed report is true.

Name and Address of Person Certifying	Date	Certified By (Signature)
<i>RA MacGregor 28 Ford St Sault Ste Marie Ont.</i>	<i>March 5/92</i>	<i>[Signature]</i>
Telephone No.		
<i>949-4250</i>		

**For Office Use Only**

Total Value Cr. Recorded	Date Recorded	Mining Recorder	Received Stamp
<i>Applied 200.</i>	<i>June 9, 1992</i>	<i>[Signature]</i>	LARDER LAKE
	Deemed Approval Date	Date Approved	
	<i>Sept. 7, 1992</i>		
	Date Notice for Amendments Sent		

Work Report Number for Applying Reserve	Claim Number (see Note 2)	Number of Claim Units
	L341838	1
	L341839	1
	L892017	1
	L980393	1
	L1180402	1
5		
Total Number of Claims		

Value of Assessment Work Done on this Claim	Value Applied to this Claim
340	<del>0</del>
200	<del>0</del>
200	<del>0</del>
	<del>340</del> <sup>km</sup>
	<del>400</del> <sup>km</sup> 200
740	20740
Total Value Work Done	Total Value Work Applied

Value Assigned from this Claim	Reserve: Work to be Claimed at a Future Date
<del>340</del>	340 <sup>km</sup>
<del>200</del>	200 <sup>km</sup>
200	
RECEIVED AUG 25 1992 MINING LANDS BRANCH	
20740	5540
Total Assigned From	Total Reserve

Credits you are claiming in this report may be cut back. In order to minimize the adverse effects of such deletions, please indicate from which claims you wish to prioritize the deletion of credits. Please mark (✓) one of the following:

- Credits are to be cut back starting with the claim listed last, working backwards.
- Credits are to be cut back equally over all claims contained in this report of work.
- Credits are to be cut back as prioritized on the attached appendix.

In the event that you have not specified your choice of priority, option one will be implemented.

**Note 1:** Examples of beneficial interest are unrecorded transfers, option agreements, memorandum of agreements, etc., with respect to the mining claims.

**Note 2:** If work has been performed on patented or leased land, please complete the following: 92-4

I certify that the recorded holder had a beneficial interest in the patented or leased land at the time the work was performed.

Date: June 3/92  
Signature: [Signature]



Ministry of  
Northern Development  
and Mines

Ministère du  
Développement du Nord  
et des mines

Statement of Costs  
for Assessment Credit

État des coûts aux fins  
du crédit d'évaluation

Mining Act/Loi sur les mines

Transaction No./N° de transaction

Personal information collected on this form is obtained under the authority of the Mining Act. This information will be used to maintain a record and ongoing status of the mining claim(s). Questions about this collection should be directed to the Provincial Manager, Minings Lands, Ministry of Northern Development and Mines, 4th Floor, 159 Cedar Street, Sudbury, Ontario P3E 6A5, telephone (705) 670-7264.

Les renseignements personnels contenus dans la présente formule sont recueillis en vertu de la Loi sur les mines et serviront à tenir à jour un registre des concessions minières. Adresser toute question sur la collecte de ces renseignements au chef provincial des terrains miniers, ministère du Développement du Nord et des Mines, 159, rue Cedar, 4<sup>e</sup> étage, Sudbury (Ontario) P3E 6A5, téléphone (705) 670-7264.

1. Direct Costs/Coûts directs

Type	Description	Amount Montant	Totals Total global
Wages Salaires	Labour Main-d'oeuvre	525	
	Field Supervision Supervision sur le terrain		525
Contractor's and Consultant's Fees Droits de l'entrepreneur et de l'expert- conseil	Type Assays	91.59	
			92
Supplies Used Fournitures utilisées	Type		
Equipment Rental Location de matériel	Type		
Total Direct Costs Total des coûts directs			617

2. Indirect Costs/Coûts indirects

\*\* Note: When claiming Rehabilitation work indirect costs are not allowable as assessment work.  
Pour le remboursement des travaux de réhabilitation, les coûts indirects ne sont pas admissibles en tant que travaux d'évaluation.

Type	Description	Amount Montant	Totals Total global
Transportation Transport	Type Auto	114	
RECEIVED AUG 25 1992 MINING LANDS BRANCH			
			114
Food and Lodging Nourriture et hébergement	Meals	16.02	16
Mobilization and Demobilization Mobilisation et démobilisation			
Sub Total of Indirect Costs Total partiel des coûts indirects			130
Amount Allowable (not greater than 20% of Direct Costs) Montant admissible (n'excédant pas 20 % des coûts directs)			123
Total Value of Assessment Credit (Total of Direct and Allowable Indirect costs)			740
Valeur totale du crédit d'évaluation (Total des coûts directs et indirects admissibles)			

Note: The recorded holder will be required to verify expenditures claimed in this statement of costs within 30 days of a request for verification. If verification is not made, the Minister may reject for assessment work all or part of the assessment work submitted.

Note: Le titulaire enregistré sera tenu de vérifier les dépenses demandées dans le présent état des coûts dans les 30 jours suivant une demande à cet effet. Si la vérification n'est pas effectuée, le ministre peut rejeter tout ou une partie des travaux d'évaluation présentés.

Filing Discounts

- Work filed within two years of completion is claimed at 100% of the above Total Value of Assessment Credit.
- Work filed three, four or five years after completion is claimed at 50% of the above Total Value of Assessment Credit. See calculations below:

Total Value of Assessment Credit	Total Assessment Claimed
	× 0.50 =

Remises pour dépôt

- Les travaux déposés dans les deux ans suivant leur achèvement sont remboursés à 100 % de la valeur totale susmentionnée du crédit d'évaluation.
- Les travaux déposés trois, quatre ou cinq ans après leur achèvement sont remboursés à 50 % de la valeur totale du crédit d'évaluation susmentionné. Voir les calculs ci-dessous.

Valeur totale du crédit d'évaluation	Evaluation totale demandée
	× 0,50 =

Certification Verifying Statement of Costs

I hereby certify:  
that the amounts shown are as accurate as possible and these costs were incurred while conducting assessment work on the lands shown on the accompanying Report of Work form.

that as Recorded holder I am authorized  
(Recorded Holder, Agent, Position in Company)

to make this certification

Attestation de l'état des coûts

J'atteste par la présente :  
que les montants indiqués sont le plus exact possible et que ces dépenses ont été engagées pour effectuer les travaux d'évaluation sur les terrains indiqués dans la formule de rapport de travail ci-joint.

Et qu'à titre de \_\_\_\_\_ je suis autorisé  
(titulaire enregistré, représentant, poste occupé dans la compagnie)

à faire cette attestation.

Signature 	Date March 5/92
---------------	--------------------

# Costs

July 4<sup>th</sup> D Duff 1 day @ 150/day Prospecting  
R Labine 1 day @ 150/day "  
R MacGregor 1 day @ 150/day "  
March 5/92 " " 1/2 day @ 150/day Report  
Total 525

Assays

91.59

RECEIVED

92

AUG 25 1992

MINING LANDS BRANCH

## Transportation

Jimmins → Larder → property & return  
380 km @ .3 = 114

3 Lunches  
@ 5.34 each

16  
Less over 20% - 7

Grand Total 740



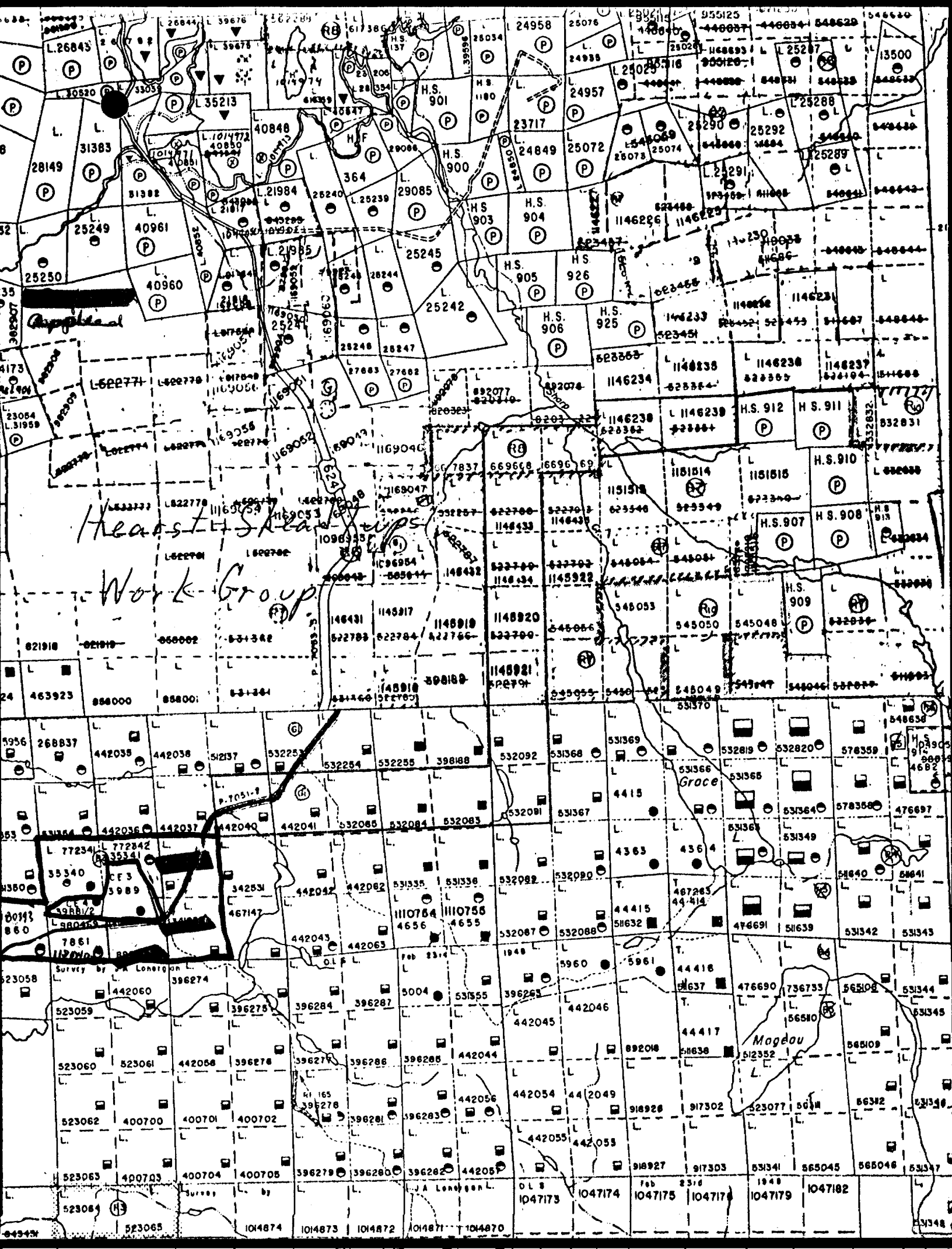

Heast Sea Group  
Work Group

Grace

Mogau

Survey by J.A. Longren

J.A. Longren

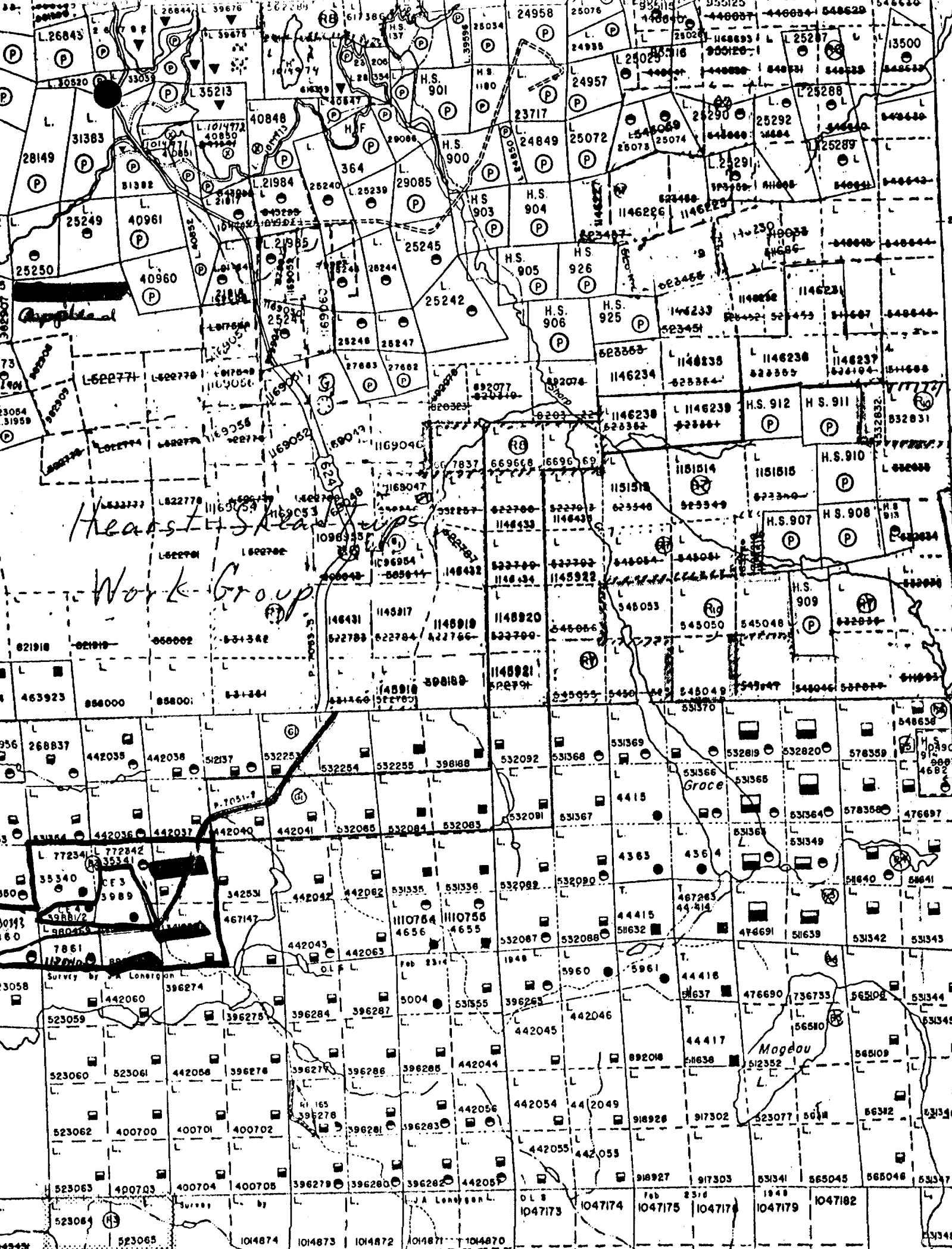



Ontario

Ministry of  
Northern Development  
and Mines

Ministère du  
Développement du Nord  
et des Mines

Mining Lands Branch  
Geoscience Approvals Section  
933 Ramsey Lake Road  
6th Floor  
Sudbury, Ontario  
P3E 6B5

Telephone: (705) 670-5853  
Fax: (705) 670-5863

October 19, 1992

Our File: 2.14697  
Transaction #W9280.109

Mining Recorder  
Ministry of Northern Development  
and Mines  
4 Government Road East  
Kirkland Lake, Ontario  
P2N 1A2

Dear Sir/Madam:

**Subject: APPROVAL OF ASSESSMENT WORK CREDITS ON MINING CLAIMS  
L341838 ET AL. IN SKEAD TOWNSHIP**

---

The assessment work credits for the Prospecting work filed under Section 9 of the Mining Act Regulations have been approved as originally filed.

The approval date is October 19, 1992.

Please indicate this approval on your claim record sheets.

Yours sincerely,

Ron C. Gashinski  
Senior Manager, Mining Lands Branch  
Mines and Minerals Division

LJ/jl  
Enclosures:

cc: Resident Geologist  
Kirkland Lake, Ontario

✓ Assessment Files Office  
Toronto, Ontario