



32D04SE0384 2.2887 SKEAD

010

X	X	RRRRR	A
XX	XX	RR RR	AAA
XX	XX	RR RR	AA AA
XXX		RR RR	AA AA
XXX		RRRRR	AAAAAAA
XX	XX	RR RR	AA AA
XX	XX	RR RR	AA AA
X	X	RR R	AA AA

MAJOR ELEMENTS

SUPERIOR NORTHWEST INC.

TOTAL IRON REPORTED AS FED
THE CONTRIBUTION OF TOTAL IRON TO THE SUM
IS CALCULATED AS FE203

REPORT NO. 4280

23-JAN-79

SAMPLES RECEIVED FROM R. A. MACGREGOR

RECEIVED
JAN 24 1979

23-JAN-79

X-RAY ASSAY LABORATORIES

FILE	SI02	AL203	CaO	MgO	Na2O	P2O	FeO	MNO	TiO2	P2O5	L O. I.	SUM
102	41.7	7.15	9.12	14.7	0.06	0.59	8.64	0.16	0.59	0.12	19.12	102.9
103	53.4	7.2	16.1	13.5	2.71	0.15	3.01	0.07	0.92	0.01	1.66	99.7
104	49.7	4.1	3.67	3.1	0.00	0.03	9.55	0.16	0.24	0.01	11.32	101.2
105	41.8	12.9	7.12	0.52	3.35	2.08	5.30	0.08	0.25	0.06	3.57	97.7
106	49.9	0.52	7.31	12.3	0.54	0.12	9.81	0.15	0.65	0.18	5.47	99.0
1038	8.19	2.17	16.1	15.1	0.09	0.80	1.15	0.05	0.09	0.09	42.66	99.1
1054	41.7	13.7	0.36	0.37	1.83	6.95	1.42	0.02	0.21	0.05	0.79	96.1
L-N 5001	45.1	10.9	11.1	12.4	0.36	1.24	9.56	0.20	0.70	0.19	5.44	98.2
L-N 5002	73.7	13.5	1.21	0.49	6.17	1.23	0.51	0.01	0.28	0.07	1.22	98.3
L-N 5003	37.6	2.19	1.74	55.6	0.00	0.01	8.64	0.14	0.13	0.01	13.55	101.7
L-N 5004	44.4	6.58	10.3	20.8	0.00	0.02	9.70	0.17	0.31	0.02	6.82	100.2
L-N 5004	34.1	18.1	1.21	5.16	1.04	3.73	7.73	0.09	0.74	0.10	4.39	99.4
L-N 5005	39.7	13.9	2.75	0.44	5.17	1.97	1.60	0.08	0.32	0.07	3.17	99.3
L-N 5007	49.1	12.6	6.66	9.36	2.23	1.02	10.3	0.19	0.73	0.05	3.48	99.4
L-N 5061	75.6	11.2	1.63	1.11	4.09	0.74	1.23	0.04	0.33	0.08	1.99	98.4
L-N 5089	51.6	13.2	8.26	6.08	2.48	0.55	11.8	0.19	1.00	0.08	3.22	99.7
L-N 5115	54.7	15.8	5.46	2.21	4.15	2.86	2.45	0.12	0.42	0.13	7.33	100.6
L-N 5128	39.6	9.12	9.26	10.5	0.20	3.67	8.13	0.15	0.66	0.48	19.23	100.9
L-N 5137	45.6	15.9	1.05	0.93	3.58	4.52	1.80	0.02	0.25	0.06	2.62	99.6

23-JAN-79

X-RAY ASSAY LABORATORIES

SAMPLE	SiO2	Al2O3	CaO	MgO	Na2O	K2O	FeO	MnO	TiO2	P2O5	L.O.I.	SUM
L-N 5155	39.8	7.1	10.2	15.4	0.00	0.80	8.98	0.18	0.61	0.16	18.23	102.6
L-N 5171	44.1	13.7	9.25	6.20	2.67	2.35	11.2	0.14	0.67	0.71	9.06	101.3
L-N 5185	47.4	13.8	9.72	6.24	2.62	2.84	10.5	0.16	0.64	0.89	3.58	99.7
L-N 5211	53.2	15.4	5.44	3.50	4.75	3.44	6.29	0.13	0.54	0.25	5.03	98.4
L-N 5217	55.3	13.1	5.34	7.32	4.65	1.68	5.77	0.10	0.40	0.14	3.61	98.1
L-N 5233	70.8	14.2	1.96	0.84	4.28	3.34	2.13	0.02	0.33	0.06	2.59	99.2
L-N 5235	75.6	10.5	0.53	0.50	2.75	2.43	1.23	0.01	0.19	0.04	1.60	99.5
L-N 5236	51.0	13.9	8.06	4.21	2.95	2.34	9.20	0.16	0.51	0.23	11.62	98.8
L-N 5281	63.2	17.5	2.70	2.88	5.69	0.74	0.35	0.01	0.54	0.02	1.28	99.0
L-N 5307	51.8	6.27	16.0	13.2	1.43	0.13	5.90	0.10	0.75	0.02	1.71	97.8
L-N 5327	34.9	0.72	3.81	37.0	0.00	0.01	7.20	0.10	0.05	0.01	17.03	101.6
L-N 5338	34.8	0.70	3.25	37.8	0.00	0.01	6.92	0.10	0.05	0.00	17.17	101.6

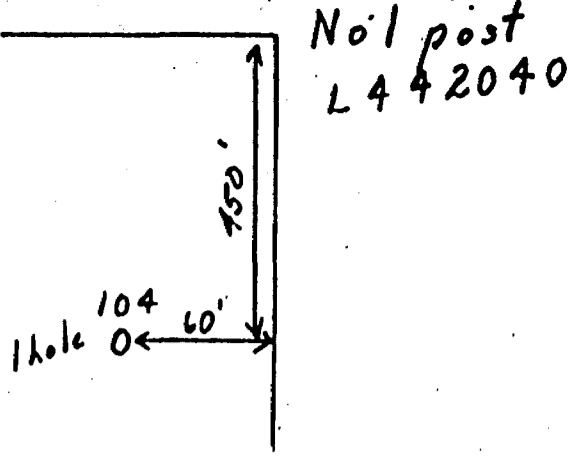

#4 post
L 396284

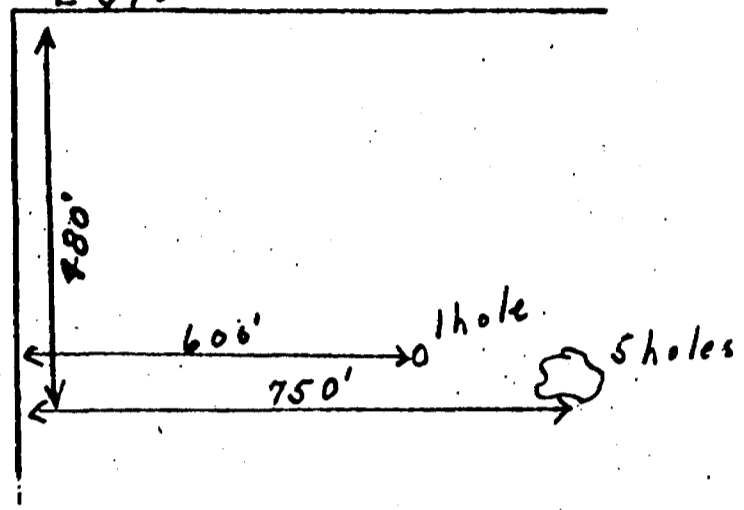

#4 post
L 396287

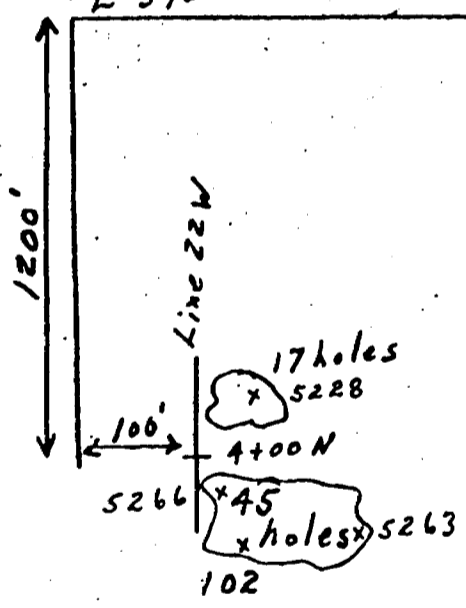

No. 1 post
L 396277

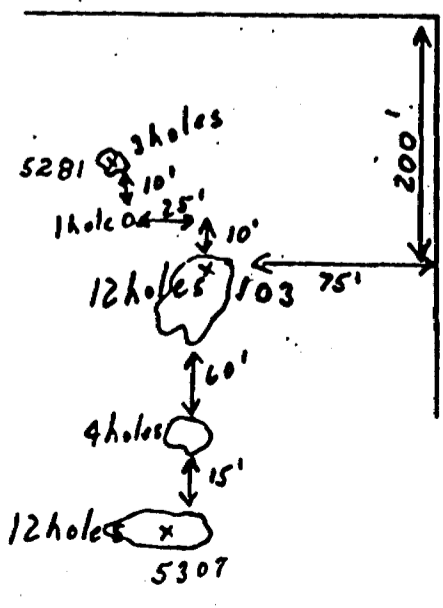

All holes 2' deep
and blasted

No 4 post
L 396286

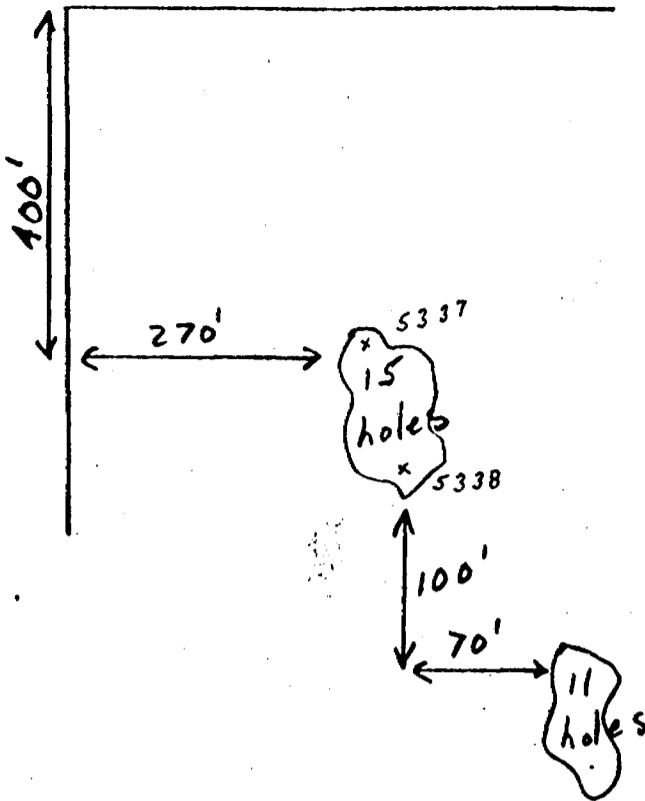

All holes 2' deep x samples
and blasted

No 1 post
L 442037

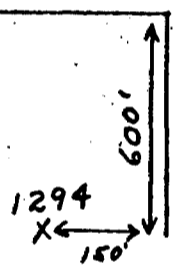

No 4 post L 442049

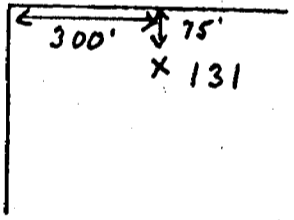

Samples only
Work previously reported

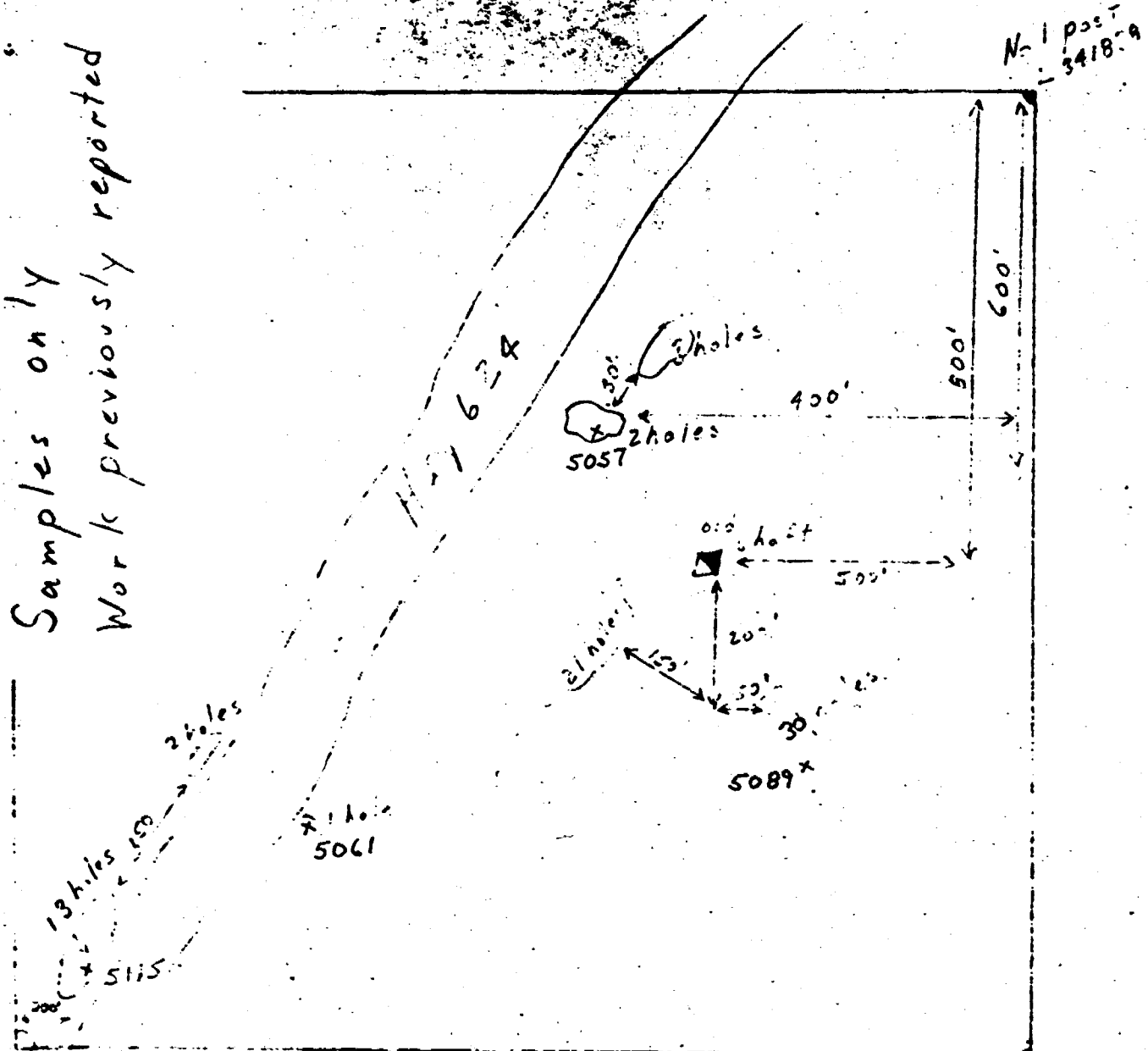

Drilling by Atlas Copco Cobra
Pluggger drill.
Work in progress - to be blasted
later. all holes 2' or more deep.

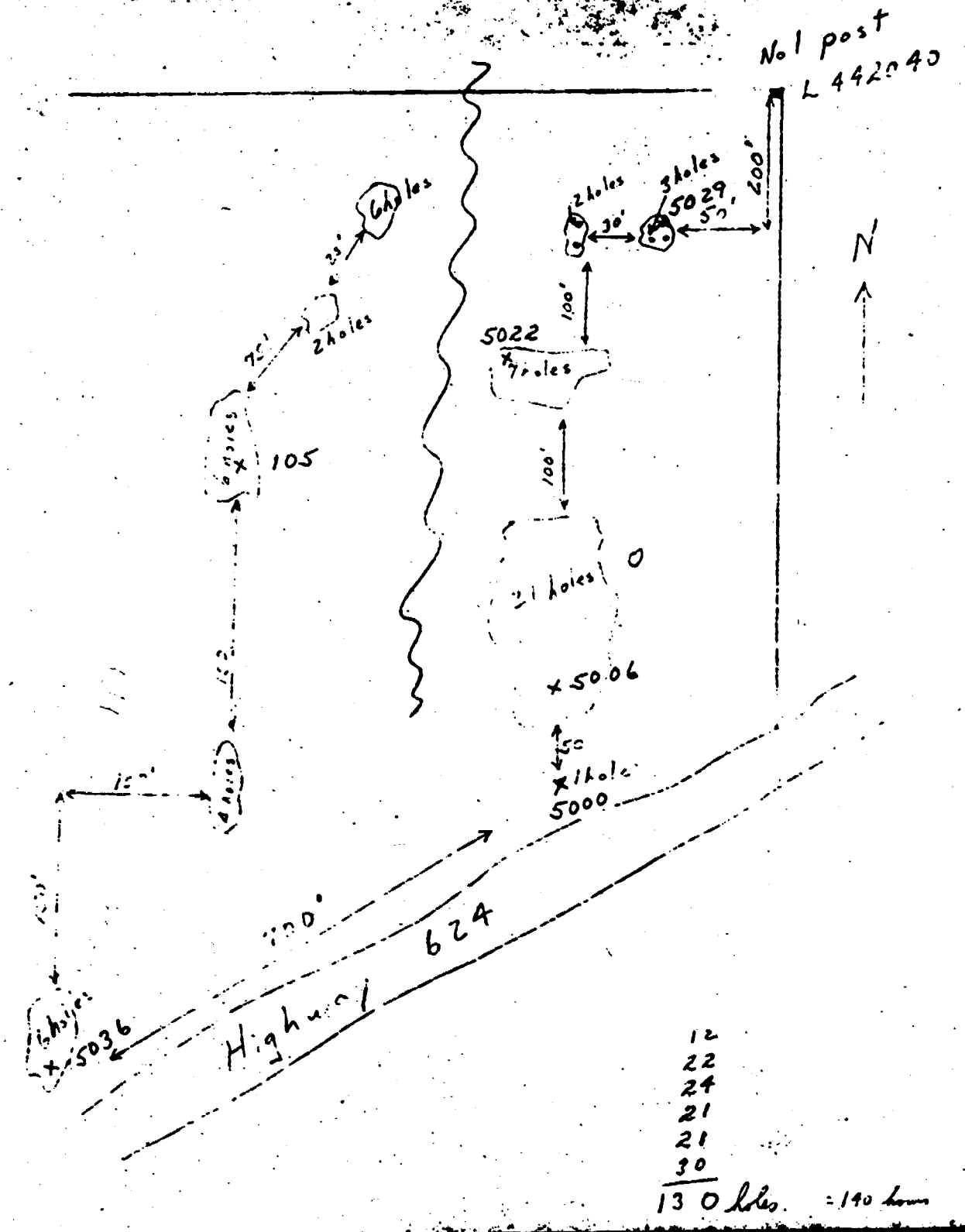

Samples only
Work previously reported

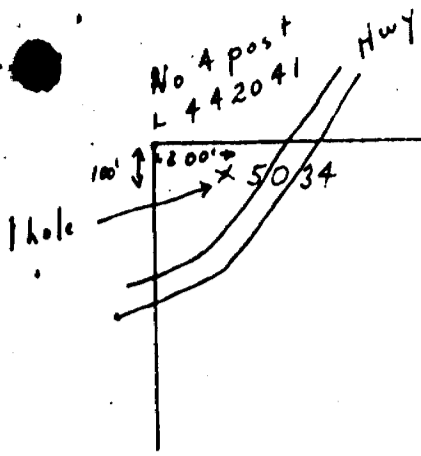

4 holes

#4 Post L 396284

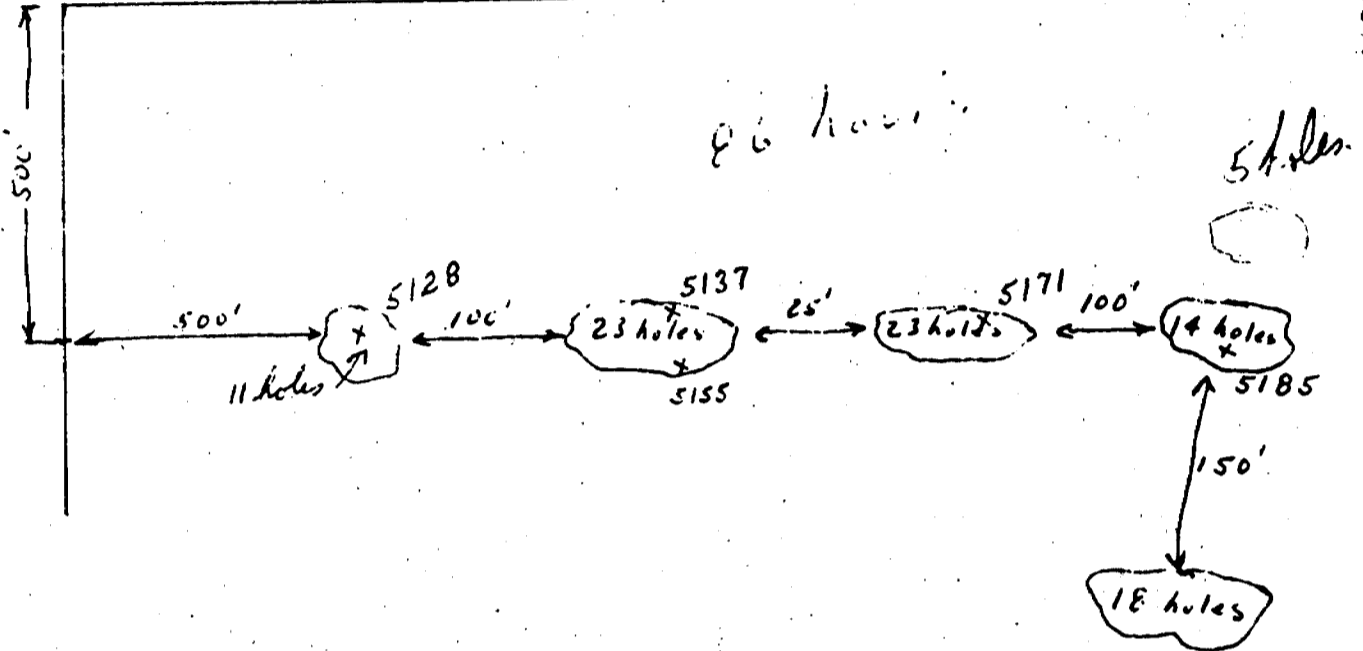

86 holes

5 holes

#4 Post L 396287

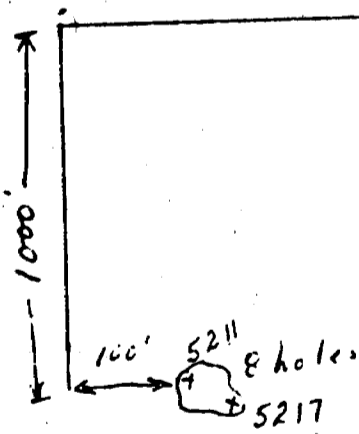

All holes are
2' deep to be
blasted later



Ontario



32D04SE0384 2.2887 SKEAD

900

Ministry of
Natural
Resources

Notification of recording
of assessment work credits

Recording Office
4 Gov't Road East
Kirkland Lake, Ontario
P2N 1A2

Supervisor, Projects Unit
Mining Lands Section
Ministry of Natural Resources
Room 1617, Whitney Block
Queen's Park, Toronto
M7A 1W3

RECEIVED

FEB 05 1979

MINING LANDS SECTION

Date of recording of work: January 31, 1979

Recorded holder: Robert A MacGregor

134 Palace Drive

Address: Sault Ste. Marie, Ontario

Township or Area: Skead township

Type of survey and number of Assessment days credit per claim	Mining claims
Geophysical	
Electromagnetic _____ days	L 442044 - 25 days
Magnetometer _____ days	L 442045 - 10.13 days
Radiometric _____ days	
Induced polarization _____ days	
Section 86 (18) <u>as listed</u> _____ days	
Geological _____ days	
Geochemical _____ days	
Man days <input type="checkbox"/>	Airborne <input type="checkbox"/>
Special provision <input type="checkbox"/>	Ground <input type="checkbox"/>

Notice to recorded holder:

Survey reports and maps in duplicate must be submitted to the Projects Unit, Toronto within 60 days from the date of recording of this work.

Reports and maps are being forwarded to the Projects Unit with this letter.

Mining recorder

c.c. Mr Robert A MacGregor