



32D04SW2003

2.18714

PACAUD

010

2.187 14

GEOPHYSICAL SURVEY
BARRY HOLLINGER 4 GROUP
NEW EAST/WEST GRID
PACAUD TOWNSHIP
LARDER LAKE MINING DIVISION
DISTRICT OF TIMISKAMING, ONTARIO

FOR

ALEXANDER H. PERRON

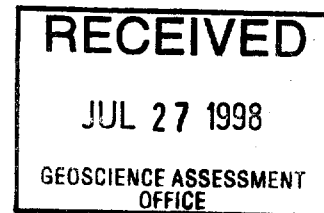

JULY 24, 1998

MISS WENDY K. WELLER
GEOTECH IN-TRAINING

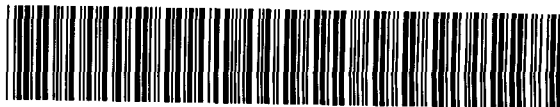

TABLE OF CONTENTS

SUMMARY. 1)

INTRODUCTION 1

ACCESS AND LOCATION. 1

PREVIOUS WORK. 1, 2

TOPOGRAPHY 2

GENERAL GEOLOGY. 2

INSTRUMENTATION. 2, 3

1998 ELECTROMAGNETIC AND MAGNETOMETER SURVEYS. 3, 4

CONCLUSIONS AND RECOMMENDATIONS. 4

BIBLIOGRAPHY 5

TECHNICAL DATA 6

ASSESSMENT DATA FORM 7

CERTIFICATE. 8

MAPS

CLAIM LOCATION MAP - Figure 1a). 1 a)

LOCATION MAP - Figure 1b) 1 b)

GROUND VLF-EM SURVEY 1998 - MAP NO. BH/98/vlf. . . IN BACK POCKET

GROUND MAGNETOMETER SURVEY 1998 - MAP NO. BH/98/mag.. IN BACK POCKET

SUMMARY

i)

This report is a Geophysical Survey, as required by The Ministry of Northern Development and Mines, for assessment work purposes, following the recommendations set forth in the Mining Act Regulations 1991.

The report includes an introduction to the property, general geology, field results and conclusions, based on the field survey.

Technical data is provided in the Assessment Data Form found at the back of this report. Field data is compiled on the accompanying plan maps at the back of the report.

GEOPHYSICAL SURVEY
BARRY HOLLINGER 4 GROUP
NEW EAST/WEST GRID
PACAUD TOWNSHIP
LARDER LAKE MINING DIVISION
DISTRICT OF TIMISKAMING, ONTARIO

INTRODUCTION

The claim group consists of four unpatented mining claims found in Pacaud Township, Concession VI, Lot 3.

On June 1, 1998, a new east grid was established. A new north/south baseline was cut, picket lines were established every 200 feet, stations were cut and measured every 100 feet.

The linecutting and chaining was contracted out to Mr. Maurice Sasseville, and crew.

The magnetometer survey was done by Mr. Richard Nash, the electromagnetometer survey was completed by Miss Wendy K. Weller. All drafting, contouring and report writing was done by Miss Wendy K. Weller.

ACCESS AND LOCATION

The Barry Hollinger Four Group lies in the middle half of Lot 3, Conc. VI approximately one and one half miles from the village of Boston Creek, which is twelve (12) miles southeast of the town of Kirkland Lake. (See Figure 1a).

The property is accessible via a secondary road that extends eastward from the village of Boston Creek into the Barry Hollinger Mine site. This road may be reached via highway 112 and highway 564. (See Figure 1 b).

PREVIOUS WORK

Scattered old trenching can be found throughout the property, however no records are available.

April, 1985 - Geophysical Survey
M Greer

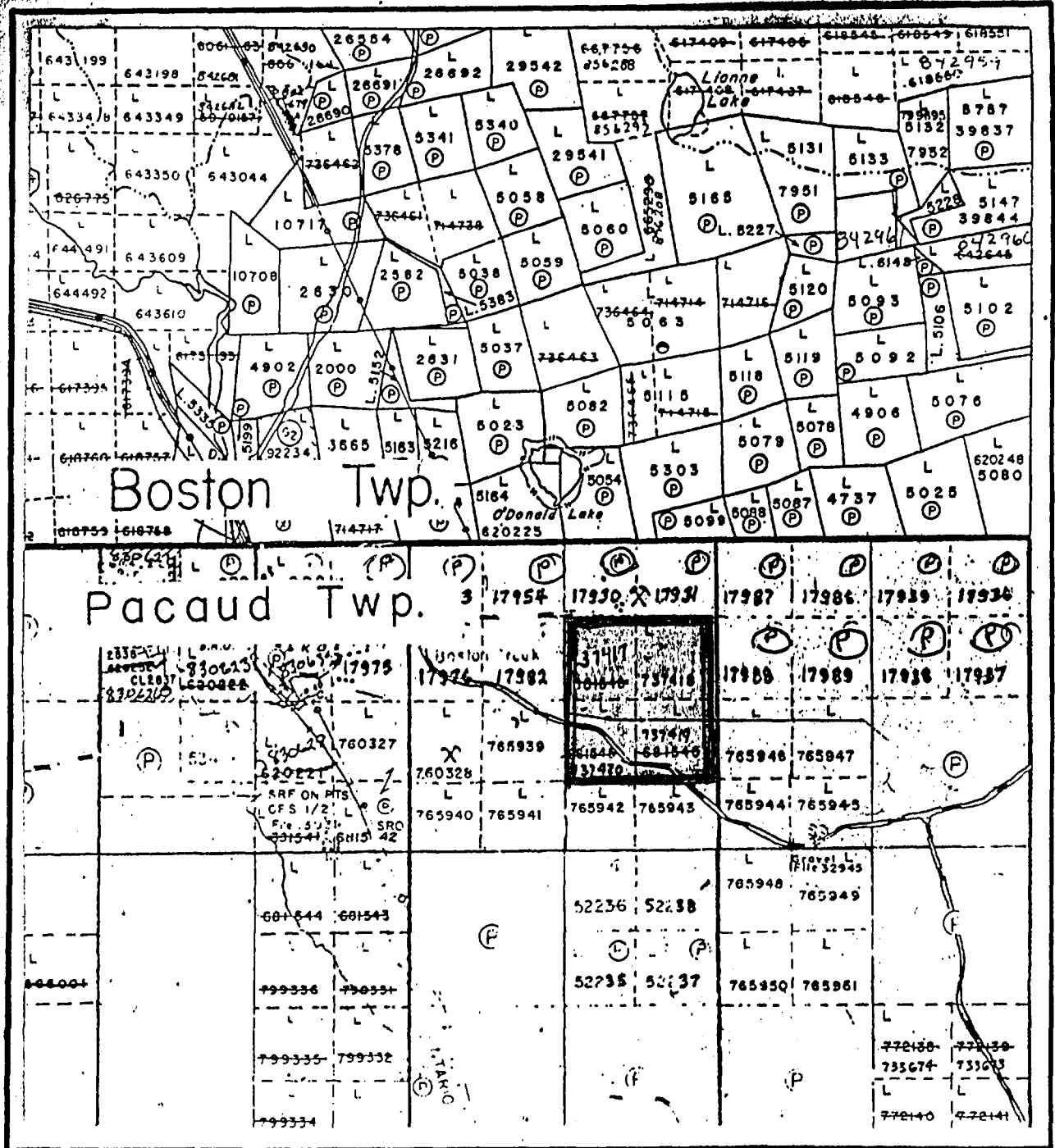

Claim Location Map

Scale: 1 inch to 1/2 mile

Taken from a June 1986

Figure 1a

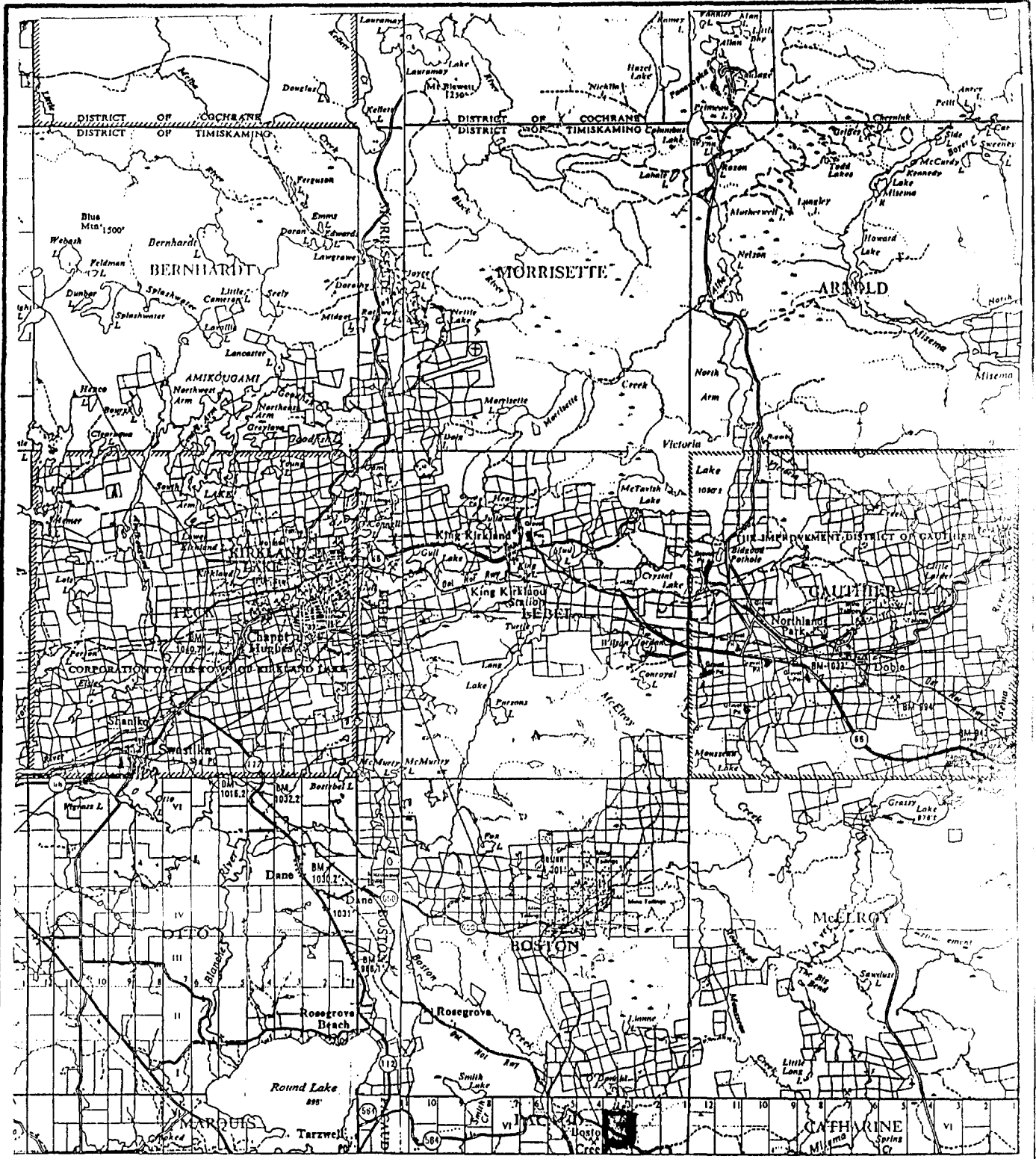

Location Map

Figure 1b

- August 1986 - Geological Survey
M. Greer
- April 1987 - Geophysical Survey
Barry Hollinger Joint Venture M. Greer
- August 1996 - Geophysical Survey
Barry Hollinger 4 Group Wendy K. Weller

The above reports can be viewed at the Regional Office.

TOPOGRAPHY

The terrain consists of low swampy areas surrounded by high steep hills, which has a large percentage of exposed outcrop.

A very large creek, pond system runs south/east through claim No. L-737419.

The vegetation in both claims ranges from alder, grass, balsam in the low lying areas to red jack pine and poplar, and silver and white birch on the outcrop showings.

GENERAL GEOLOGY

According to the O.D.M. Map No. 1957-4 the underlying bedrock consists of basic volcanic lava flows of the Keewatin age. These rock types are primarily gabbroic lava flows and andesite, basalt and pillow lava. The flows appear to be trending northwest-southeast and are facing east.

INSTRUMENTATION

Electromagnetic Survey:

The VLF-EM method uses as a source, one of the main submarine communications transmitters in the 15 to 25 kHz band found throughout the world. These submarine communication radio waves travel in a single mode parallel to the surface of the earth along the earth-air surface.

Without vertical conductors and travelling over flat ground, the magnetic field component of this radio or surface wave is horizontal and perpendicular to it's direction of travel.

VLF instruments are capable of picking up these structures that change the direction of the waves by measuring the tilt angle of the major axis of the polarization ellipse. This is illustrated by the tilt angle being zero on flat ground, but when a conductor is present the tilt angle will acquire a finite value. The direction of tilt indicates the direction of the conductor. Calculations of such parameters as depth, depth extent, dip and

width of the conductor is very minimal.

The VLF easily illustrates the location of the upper limit of dipping structures which can be seen or plotted as VLF profiles as areas of greatest change in tilt angle per unit of distance.

The instrument used for this EM survey was a Geonics VLF-EM16 Unit. The sensitivity of this unit is $\pm 1\%$ for the in-phase and $\pm 1\%$ for the quadrature. The operating frequency for the EM16 is from 15-25 kHz and the station selection is made by plug-in units.

For the purpose of this EM survey the station used was Cutler, Maine, which has a frequency of 24.0 kHz.

All the readings were taken facing north at 50 foot intervals and the topography was noted for future use in the interpretation of the EM results.

Magnetic Survey:

This system uses a backward motion of spinning protons of a hydrogen atom within a fluid of hydrogen and carbon. These spinning magnetic protons are caused to have two opposite poles by applying a magnetic field using a current within a coil of wire. When the current is stopped, the protons precess about the earth's magnetic field and in turn generate a small current in the wire. This frequency of precession is proportional to the earth's total magnetic field.

This instrument is read directly in gammas which is the absolute value of the earth's total field for that station.

1998 ELECTROMAGNETIC AND MAGNETOMETER SURVEYS

i) Magnetic Survey:

The field data is presented on a map at a horizontal scale of one inch to 200 feet, Map No. BH/98/mag, found at the back of this report,

The magnetic data is illustrated as isomagnetic contours (contour interval 100 gammas) on a map of corrected magnetic values recorded at each station,

The magnetic trend is in a north to north/west direction. The magnetic relief ranges from 58,022 gammas to 60,929 gammas.

In the southeast half of the grid a very large high magnetic structure crosses PL800N to PL1000S. This high

magnetic structure is heavily altered and sheared zones of the Pacaud fault.

In the northwest half of the grid a very large magnetic low structure is noted. The area is very flat, wet area. The vegetation in this area is alder and small stunted spruce and pine.

ii) Electromagnetic Survey:

There are 3 conductors found in this survey.

- Q1 - Crosses PL800N 1600E to PL1400N 1360E.
The area is very flat, wet alder bog. The conductor is north of the large creek which crosses the claim group.
- Q2 - Crosses PL200N 1360E to PL200S 1320E.
The conductor crosses the top and east side of a very steep and large outcrop.
- Q3 - Crosses PL400S 2300E to PL800S 2250E.
The conductor crosses the east slope of the very large outcrop that crosses the west side of the property.

To discover more about the conductive zones, the data is being Frazer filtered.

CONCLUSIONS AND RECOMMENDATIONS

Conductors 2 and 3 appear to have some association with the magnetic trend and structure. The VLF conductor axis is found to occur along the edge of a higher magnetic gradient.

The magnetic low indicates a change in the structure, possibly caused by a fault which also may be indicated by the EM response Q1.

All information is being compiled on the property at present to help determine future programs.

Respectfully submitted,



July 24, 1998

Miss Wendy K. Weller
Geotech In-training

BIBLIOGRAPHY

Sixty-sixth Annual Report of the
Ontario Department of Mines

Volume LXVI, Part 5, 1957

Geology of Boston Township and part of
Pacaud Township by K.D. Lawton

April 10, 1987 - Geophysical Survey Report on the
M. Greer Barry Hollinger Joint Venture
Boston and Pacaud Townships.

August 1996 - Geophysical Survey
Barry Hollinger 4 Group
Pacaud Township

Technical Data:

Line (mi/km):

No. of samples/stations:

ELECTROMAGNETIC SURVEY:

Instrument: GEONICS EM-16

Coil configuration: VERTICAL AND HORIZONTAL

Method: FIXED TRANSMITTER

Vertical scale: 1 INCH = $\begin{matrix} + \\ - \end{matrix}$ 40%

Frequency: 24.6 kHz

Operational technique:

ALL READINGS TAKEN FACING NORTH/EAST

Line traversed:

Line/picket spacing: 200 FT/100 FT.

Operator: MISS WENDY K. WELLER

Accuracy: $\begin{matrix} + \\ - \end{matrix}$ 1%

Coil separation: INFINITY

Parameters: IN-PHASE/QUADRATURE

Horizontal scale: 1 INCH = 200 FT.

Station: SEATTLE, WASHINGTON

MAGNETIC SURVEY:

Instrument: MCPHAR GP-8 PROTON

Base station: BL 0+00

Base station time: 30 MINUTES

Contour interval: 50 - 100 GAMMAS

Contoured by: MISS WENDY K. WELLER

Operational technique: SENSOR POLE MOUNT

Operator: RICHARD NASH

Accuracy: $\begin{matrix} + \\ - \end{matrix}$ 1 GAMMA

Diurnal method: CLOSED LOOP BL TIE

Location/value: BL000/59228

Datum subtracted: 58,000 GAMMAS

Horizontal scale: 1 INCH = 200 FEET

INDUCED POLARIZATION SURVEY

Transmitter used:

Method:

On time:

Off time:

Power source:

Electrode array:

Readings taken:

Operational technique:

Receiver used:

Frequency:

Range:

Delay time:

Output:

Electrode spacing:

Other data:

Assessment Data Form

Type of Work:

Prospecting: _____ Geological: _____
 Physical: _____ LINE CUTTING AND CHAINING _____
 Geophysical: _____ MAGNETOMETER AND ELECTROMAGNETIC SURVEYS _____
 Geochemical: _____ Drilling: _____
 Assays/Analyses: _____ Other work: _____

Cost of Work: \$5,311.00 Dollars Applied: \$4,800.00

Recorded Holder:

Name: ALEXANDER H. PERRON _____
 Address: 103 GOVERNMENT ROAD EAST, _____
 KIRKLAND LAKE, ONTARIO P2N 1A9 _____

Survey Company:

Name: GWEN RESOURCES LTD., _____
 Address: 103 GOVERNMENT ROAD EAST, _____
 KIRKLAND LAKE, ONTARIO P2N 1A9 _____

Survey/Report Information:

Start of work: JUNE 1, 1998 _____ End of work: JUNE 18, 1998 _____
 Draughting time: JULY 15,16, 1998 _____ Report time: JULY 23, 24, 1998 _____
 Completion of report: JULY 24, 1998 _____ Author: MISS WENDY K. WELLER _____
 Work performed on claim(s) L-737417, L-737418, L-737419, L-737420 _____

Work applied to claim(s) L-737417, L-737418, L-737419, L-737420 _____

Persons who performed work (supervisor first):

GWEN RESOURCES LTD. _____
 WENDY K. WELLER _____
 RICHARD NASH _____
 MR. M. SASSEVILLE AND CREW _____

C E R T I F I C A T E

I, Wendy K. Weller, of Kirkland Lake, Ontario, do hereby certify:

- 1) That I am a Geotech in Training and reside at:
71 Second Street, Apartment #2, Kirkland Lake, Ontario.
P2N 1R6,
- 2) That I graduated from the Haileybury School of Mines as a certified Diamond Driller in 1982. I have had a staking licence for the past 8 years.
- 3) That I was employed as a Diamond Driller for Heath & Sherwood for 1 year.
- 4) That I have been practising as a Geotech Trainee for a period of eight (8) years and I am qualified to write this report.
- 5) That I supervised and participated in this survey.

July 29/98
Date

Wendy K. Weller
Wendy K. Weller
Geotech Trainee



Declaration of Assessment Work Performed on Mining Land

Mining Act, Subsection 65(2) and 66(3), R.S.O. 1990

Transaction Number (office use) W9880.00448 Assessment Files Research Imaging



32D04SW2003 2.18714 PACAUD

900

of subsections 65(2) and 66(3) of the Mining Act. Under section 8 of the review the assessment work and correspond with the mining land holder. Recorder, Ministry of Northern Development and Mines, 6th Floor,

Instructions: - For work performed on Crown Lands before recording a claim, use form 0240. - Please type or print in ink.

2.18714

1. Recorded holder(s) (Attach a list if necessary)

Name: ALEXANDER H. PERRON, Client Number: #181257, Address: 103 GOVERNMENT ROAD EAST, KIRKLAND LAKE, ONT. P2N1A9, Telephone Number: (705) 567-3001, Fax Number: (705) 567-2158

2. Type of work performed: Check (✓) and report on only ONE of the following groups for this declaration.

- Geotechnical: prospecting, surveys, assays and work under section 18 (regs) [checked] Physical: drilling, stripping, trenching and associated assays Rehabilitation

Work Type: LINE CUTTING AND CHAINING, MAGNETOMETER AND ELECTROMAGNETIC SURVEYS, Office Use, Dates Work Performed: From 01/06/98 To 18/06/98, Township/Area: PACAUD, Mining Division: Larder Lake, Resident Geologist District: Kirkland Lake

Please remember to: - obtain a work permit from the Ministry of Natural Resources as required; - provide proper notice to surface rights holders before starting work; - complete and attach a Statement of Costs, form 0212; - provide a map showing contiguous mining lands that are linked for assessment work; - include two copies of your technical report.

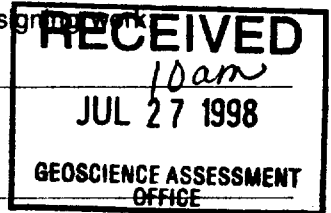

3. Person or companies who prepared the technical report (Attach a list if necessary)

Name: WENDY K. WELLER, Telephone Number: (705) 567-3001, Address: 103 GOVERNMENT ROAD EAST, KIRKLAND LAKE, ONT. P2N 1A9, Fax Number: (705) 567-2158

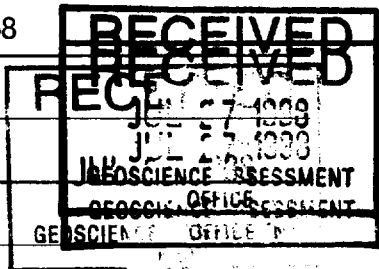

4. Certification by Recorded Holder or Agent

I, WENDY K. WELLER, do hereby certify that I have personal knowledge of the facts set forth in this Declaration of Assessment Work having caused the work to be performed or witnessed the same during or after its completion and, to the best of my knowledge, the annexed report is true.

Signature of Recorded Holder or Agent: Wendy K. Weller, Date: JULY, 1998, Agent's Address: 103 GOV'T RD. EAST, KIRKLAND LAKE, ONT. P2N 1A9, Telephone Number: (705) 567-3001, Fax Number: (705) 567-2158

Deemed Oct 22/98

5. Work to be recorded and distributed. Work can only be assigned to claims that are contiguous (adjoining) to the mining land where work was performed, at the time work was performed. A map showing the contiguous link must accompany this form.

Mining Claim Number. Or if work was done on other eligible mining land, show in this column the location number indicated on the claim map.		Number of Claim Units. For other mining land, list hectares.	Value of work performed on this claim or other mining land.	Value of work applied to this claim.	Value of work assigned to other mining claims.	Bank. Value of work to be distributed at a future date.
eg	TB 7827	16 ha	\$26,825	N/A	\$24,000	\$2,825
eg	1234567	12	0	\$24,000	0	0
eg	1234568	2	\$8,892	\$4,000	0	\$4,892
1	L-737417	1	\$1,328.00	\$1,200.00		\$128.00
2	L-737418	1	\$1,327.00	\$1,200.00		\$127.00
3	L-737419	1	\$1,327.00	\$1,200.00		\$127.00
4	L-737420	1	\$1,329.00	\$1,200.00		\$129.00
5						
6						
7						
8						
9						
10						
11						
12						
13						
14						
15						
Column Totals			\$5,311.00	\$4,800.00		\$511.00

I, WENDY K. WELLER, do hereby certify that the above work credits are eligible under subsection 7 (1) of the Assessment Work Regulation 6/96 for assignment to contiguous claims or for application to the claim where the work was done.
(Print Full Name)

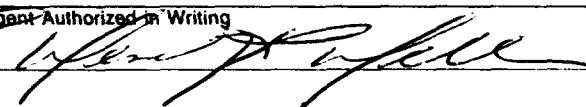
Signature of Recorded Holder or Agent Authorized in Writing:  Date: JULY 24, 1998

6. Instructions for cutting back credits that are not approved.

Some of the credits claimed in this declaration may be cut back. Please check (✓) in the boxes below to show how you wish to prioritize the deletion of credits:

- 1. Credits are to be cut back from the Bank first, followed by option 2 or 3 or 4 as indicated.
- 2. Credits are to be cut back starting with the claims listed last, working backwards; or
- 3. Credits are to be cut back equally over all claims listed in this declaration; or
- 4. Credits are to be cut back as prioritized on the attached appendix or as follows (describe):

Note: If you have not indicated how your credits are to be deleted, credits will be cut back from the Bank first, followed by option number 2 if necessary.

For Office Use Only Received Stamp <div style="text-align: center;"> RECEIVED LARDER LAKE MINING DIVISION JUL 24 1998 2.344 </div>	Deemed Approved Date	Date Notification Sent
	Date Approved	Total Value of Credit Approved
	Approved for Recording by Mining Recorder (Signature)	



Personal information collected on this form is obtained under the authority of subsection 8(1) of the Assessment Work Regulation 6/96. Under section 8 of the Mining Act, the information is a public record. This information will be used to review the assessment work and correspond with the mining land holder. Questions about this collection should be directed to the Chief Mining Recorder, Ministry of Northern Development and Mines, 6th Floor, 933 Ramsey Lake Road, Sudbury, Ontario, P3E 6B5.

2.18714

Work Type	Units of Work <small>Depending on the type of work, list the number of hours/days worked, metres of drilling, kilometres of grid line, number of samples, etc.</small>	Cost Per Unit of work	Total Cost
LINE CUTTING & CHAINING	11.27km X \$250.00/km		\$ 2,818.00
MAGNETOMETER SURVEY	11.27km X 105.00/km		\$ 1,183.00
ELECTROMAGNETIC SURVEY	11.27km X \$110.00/km		\$ 1,240.00
Associated Costs (e.g. supplies, mobilization and demobilization).			
RECEIVED LARDER LAKE MINING DIVISION JUL 24 1998 2:34 PM			
Transportation Costs			
1 TRUCK X 2 DAYS X 70 KM X .30¢/km			\$ 42.00
Food and Lodging Costs			
1 PEOPLE X 2 DAYS X \$7.00/person (Lunches)			\$ 28.00
Total Value of Assessment Work			\$ 5,311.00

Calculations of Filing Discounts:

1. Work filed within two years of performance is claimed at 100% of the above Total Value of Assessment Work.
2. If work is filed after two years and up to five years after performance, it can only be claimed at 50% of the Total Value of Assessment Work. If this situation applies to your claims, use the calculation below:

TOTAL VALUE OF ASSESSMENT WORK × 0.50 =

Note:

- Work older than 5 years is not eligible for credit.
- A recorded holder may be required to verify expenditures claimed in this statement of costs within 45 days of a request for verification and/or correction/clarification. If verification and/or correction/clarification is not received, the Minister may reject all or part of the assessment work submitted.

100% of costs claimed.
RECEIVED
JUL 27 1998
OFFICE

Certification verifying costs:

I, WENDY K. WELLER (please print full name), do hereby certify, that the amounts shown are as accurate as may reasonably be determined and the costs were incurred while conducting assessment work on the lands indicated on the accompanying Declaration of Work form as A-E-T I am authorized (recorded holder, agent, or state company position with signing authority) to make this certification.

REC
JUL 27 1998
GEOS

Signature: [Signature] Date: JULY 24, 1998

Geoscience Assessment Office
933 Ramsey Lake Road
6th Floor
Sudbury, Ontario
P3E 6B5

Telephone: (888) 415-9846
Fax: (877) 670-1555

October 6, 1998

Wendy K. Weller
ALEXANDER H. PERRON
103 GOVERNMENT RD. EAST.
KIRKLAND LAKE, Ontario
P2N-1A9

Visit our website at:
www.gov.on.ca/MNDM/MINES/LANDS/mlsmnpge.htm

Dear Sir or Madam:

Submission Number: 2.18714

Status

Subject: Transaction Number(s): W9880.00448 Deemed Approval

We have reviewed your Assessment Work submission with the above noted Transaction Number(s). The attached summary page(s) indicate the results of the review. **WE RECOMMEND YOU READ THIS SUMMARY FOR THE DETAILS PERTAINING TO YOUR ASSESSMENT WORK.**

If the status for a transaction is a 45 Day Notice, the summary will outline the reasons for the notice, and any steps you can take to remedy deficiencies. The 90-day deemed approval provision, subsection 6(7) of the Assessment Work Regulation, will no longer be in effect for assessment work which has received a 45 Day Notice. Allowable changes to your credit distribution can be made by contacting the Geoscience Assessment Office within this 45 Day period, otherwise assessment credit will be cut back and distributed as outlined in Section #6 of the Declaration of Assessment work form.

Please note any revisions must be submitted in **DUPLICATE** to the Geoscience Assessment Office, by the response date on the summary.

If you have any questions regarding this correspondence, please contact Steve Beneteau by e-mail at benetest@epo.gov.on.ca or by telephone at (705) 670-5855.

Yours sincerely,



ORIGINAL SIGNED BY
Blair Kite
Supervisor, Geoscience Assessment Office
Mining Lands Section

Work Report Assessment Results

Submission Number: 2.18714

Date Correspondence Sent: October 06, 1998

Assessor: Steve Beneteau

Transaction Number	First Claim Number	Township(s) / Area(s)	Status	Approval Date
W9880.00448	737417	PACAUD	Deemed Approval	September 28, 1998

Section:
14 Geophysical MAG
14 Geophysical VLF

Correspondence to:
Resident Geologist
Kirkland Lake, ON

Recorded Holder(s) and/or Agent(s):
Wendy K. Weller
ALEXANDER H. PERRON
KIRKLAND LAKE, Ontario

Assessment Files Library
Sudbury, ON

C-2

FROM DISPOSITION
 RIGHTS ON
 S.P. SURFACE RIGHTS ONLY
 M.P.S. MINING AND MINING RIGHTS

Description	Order No.	Date	Disposition	File

WHERE DISPOSITION OF CROWN LAND

BOSTON TOWNSHIP

MARCUSIS TOWNSHIP

CATHARINE TOWNSHIP

CHAMBERLAIN TOWNSHIP

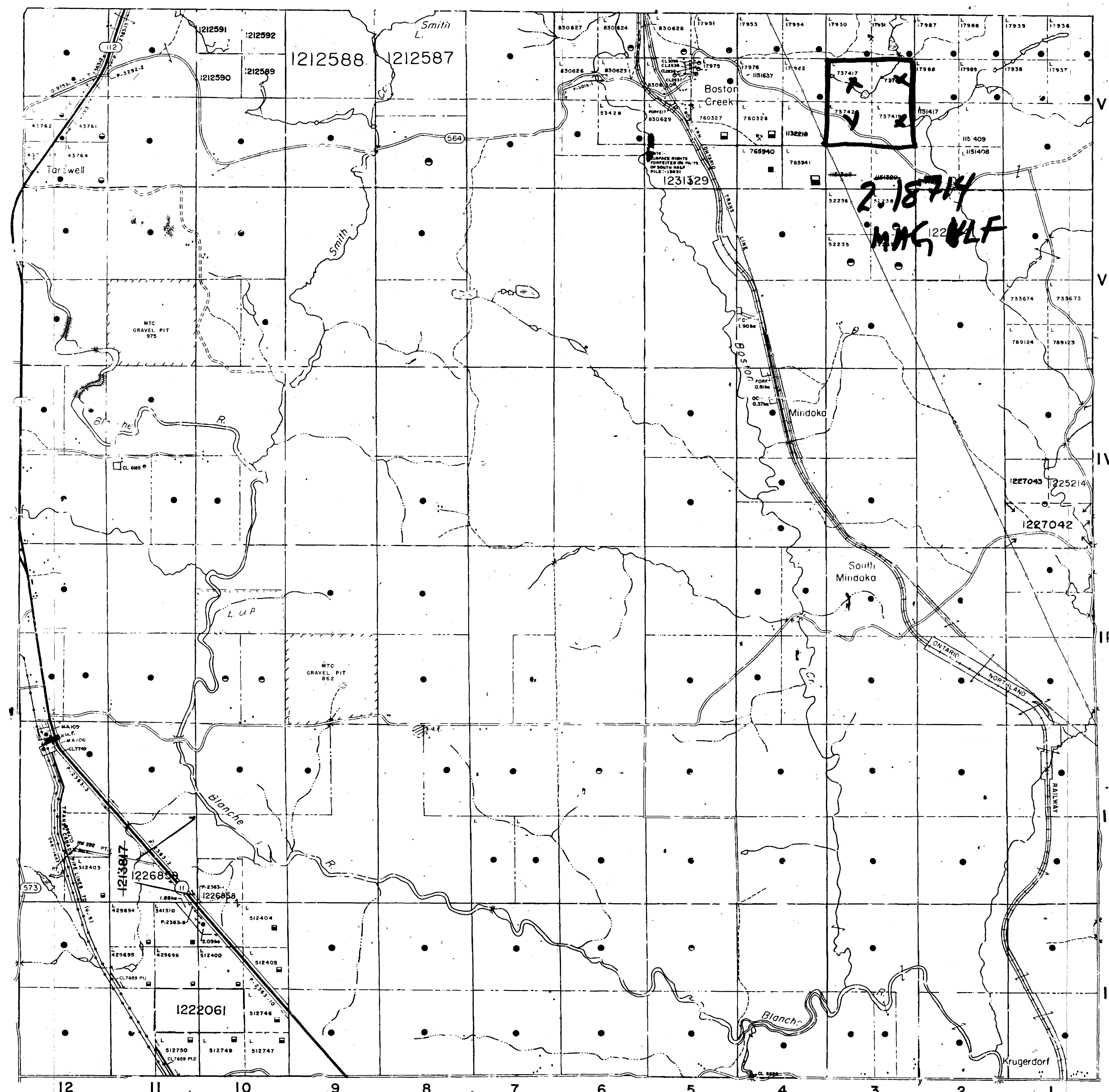

LEGEND

HIGHWAY AND ROUTE No.	
OTHER ROADS	
TRAILS	
SURVEYED LINES	
TOWNSHIP'S BASE LINES ETC.	
LOTS MINING CLAIMS PARCELS ETC.	
UNSURVEYED LINE	
LOT LINES	
PARCEL BOUNDARY	
MINING CLAIMS ETC.	
RAILWAY AND RIGHT OF WAY	
UTILITY LINES	
NON-PERENNIAL STREAM	
FLOODING OR FLOODING RIGHTS	
SUBDIVISION OR COMPOSITE PLAN	
RESERVATIONS	
ORIGINAL SHORELINE	
MARSH OR MUSKEG	
MINES	
TRAVERSE MONUMENT	

DISPOSITION OF CROWN LANDS

TYPE OF DOCUMENT	SYMBOL
PATENT, SURFACE & MINING RIGHTS	
SURFACE RIGHTS ONLY	
MINING RIGHTS ONLY	
LEASE, SURFACE & MINING RIGHTS	
SURFACE RIGHTS ONLY	
MINING RIGHTS ONLY	
LICENCE OF OCCUPATION	
ORDER-IN-COUNCIL	
RESERVATION	
CANCELLED	
SAND & GRAVEL	

NOTE: MINING RIGHTS IN PARCELS PATENTED PRIOR TO MAY 6, 1913, VESTED IN ORIGINAL PATENTEES BY THE PUBLIC LANDS ACT, R.S.O. 1910, CHAP. 300, SEC. 63, SUBSEC. 1

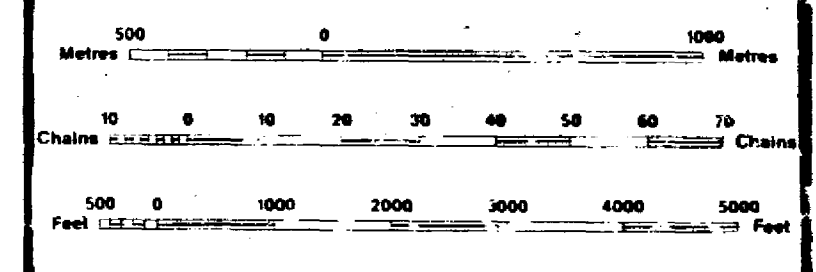

SCALE 1:20 000

DATE OF ISSUE
 OCT 01 1988
 PROVINCIAL RECORDING
 OFFICE - SUDBURY

THE INFORMATION THAT APPEARS ON THIS MAP HAS BEEN COMPILED FROM VARIOUS SOURCES, AND ACCURACY IS NOT GUARANTEED. THOSE WISHING TO STAKE MINING CLAIMS SHOULD CONSULT WITH THE MINING RECORDER, MINISTRY OF NORTHERN DEVELOPMENT AND MINES, FOR ADDITIONAL INFORMATION ON THE STATUS OF THE LANDS SHOWN HEREON.

TOWNSHIP
PACAUD
 M.N.R. ADMINISTRATIVE DISTRICT
KIRKLAND LAKE
 MINING DIVISION
LARDER LAKE
 LAND TITLES / REGISTRY DIVISION
TIMISKAMING

Ministry of Natural Resources
 Ontario
 Ministry of Northern Development and Mines

OCTOBER, 1988
 G-3697

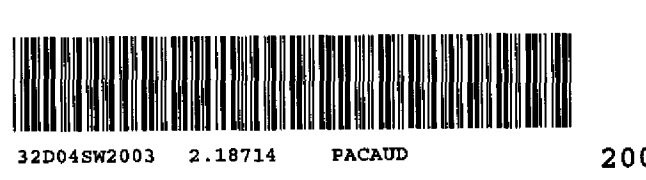

C-3697

GWT 2242AE

G-3697

PL 14 00N
 PL 12 00N
 PL 10 00N
 PL 8 00N
 PL 6 00N
 PL 4 00N
 PL 2 00N
 PL 0 00
 PL 2 00S
 PL 4 00S
 PL 6 00S
 PL 8 00S
 PL 10 00S

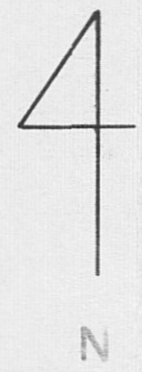
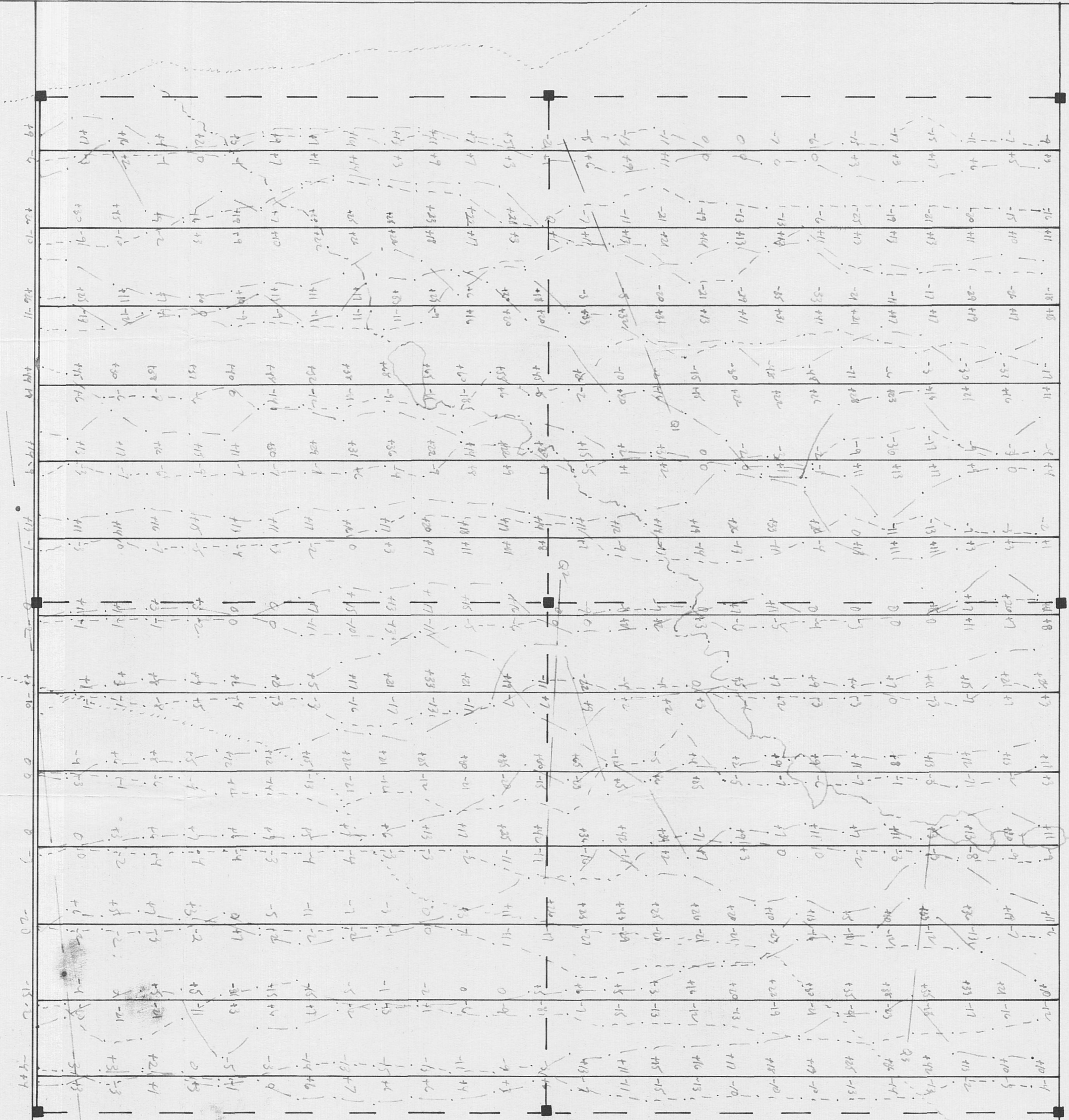

SYMBOLS

Claim post ■ Claim line --- Hydro line ●
 Concession line |
 Access road --- Pond Creek
 Inphase
 Quadrature
 Conductor axis --- Q1

INSTRUMENTATION

Instrument used GEONICS EM 16
 Station used Seattle, Washington
 Frequency 24.6
 Vertical scale 1" = 40'

2.18714

RECEIVED
 JUL 27 1998
 GEOSCIENCE ASSESSMENT
 OFFICE

GROUND VLF EM SURVEY 1998

BARRY HOLLINGER FOUR

PACAUD TOWNSHIP
 LARDER LAKE MINING DIVISION
 DISTRICT OF TIMISKAMING, ONTARIO

Scale: 1" = 200'

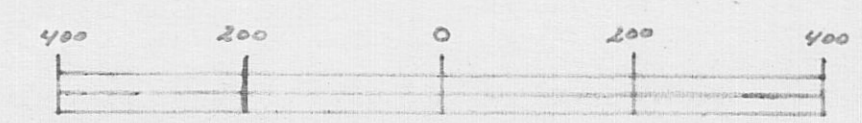

W. K. Weller

Report by WKWeller Date July 1998

Map no. BH / 98/vlf

LOT 3

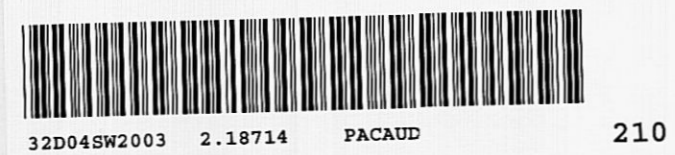

PL 14 00N
 PL 12 00N
 PL 10 00N
 PL 8 00N
 PL 6 00N
 PL 4 00N
 PL 2 00N
 PL 0 00
 PL 2 00S
 PL 4 00S
 PL 6 00S
 PL 8 00S
 PL 10 00S

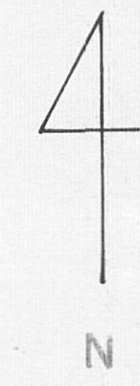
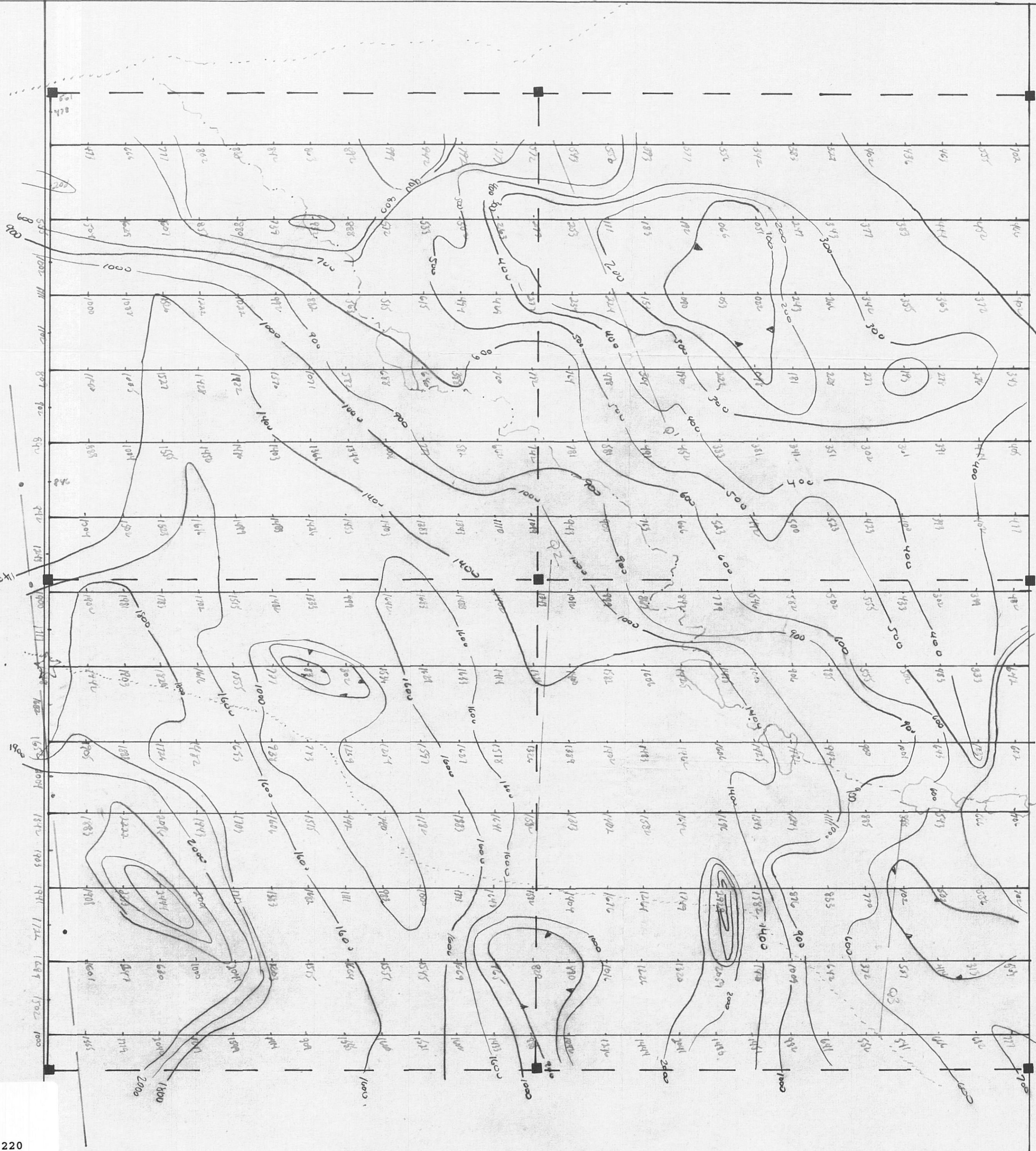

SYMBOLS

Claimpost ■ Claimline --- Hydroline ●
 Concession line | Access road Pond Creek
 Base station ☆ 57438
 Contour intervals 50-100 gammas

INSTRUMENTATION

Instrument used McPhar GP8 Proton Magnetometer
 Datum subtract 58000

VLF Conductor axis ——— Q1

2.18714

RECEIVED
 JUL 27 1998
 GEOSCIENCE ASSESSMENT
 OFFICE

GROUND MAGNETOMETER SURVEY 98

BARRY HOLLINGER FOUR

PACAUD TOWNSHIP
 LARDER LAKE MINING DIVISION
 DISTRICT OF TIMISKAMING, ONTARIO

Scale: 1" = 200'



Handwritten signature

Report by WKWeller Date July 1998

Map no BH/98/mag

