

Submission



32D05NE0059 63.3817 TANNAHILL

010

#1 Trench - 45'

Stripped & washed clay overburden
 Drilled & Blasted 2 lines of 8' holes
 Blast threw out approx. 100 tons of
 broken material as upper portion 4'-5' was
 an exposed cliff or shear.

Samples were taken across muck pile
 as per sketch & eventually analyzed
 in Toronto as per Report number B12924.

The exposed face was massive Basaltic
 Andesite (Greenstone) striking N.E. with
 N.W. shear zones. The greenstone contained
 numerous fine veinlets ($\frac{1}{8}$ " - $\frac{1}{4}$ ") of calcite
 & quartz but with no continuity as to
 direction.

Mineralization across the 45' went
 from 0 to weak to low-medium & was
 heaviest in the veinlets.

#2 Trench - 25' long

Stripped & washed clay overburden
 Top portion sheared so that broken
 material (approx. 80 ton) was thrown from
 the face.

Samples were taken as per sketch &
 Report number B12924.

The exposed face was massive greenstone
 cut by the same narrow veinlets of
 calcite & quartz. No continuity.

Mineralization weak to low-medium & greater
 in the veinlets than in the green stone.

Trench #3 - 20' long.
stripped & washed overburden
Massive green stone cut by a 6"
reddish porphy dyke. No Mineralization

Trench #2 - 15' long. blasted into
an old Pit.
stripped & washed overburden
Massive green stone cut by a reddish
porphy dyke which perforated out after
15'
No Mineralization.

D.D. Hole.
Drilled 35'. Exploration under expenses.
Massive green stone cut by same
veinlets as in Trench #1
Did not assay core which is still
available.

Pits #1 & 2 - cleaned debris from
old trenches & opened up holes to
blast with scaling bars.
Very little fly rock & pits filled
with surface water.

#3 Pit.
Blasted 6'-8' of clay-silt overburden
along the edge of running water in
a semi-bog area. This pit filled
with water & was used as a water
supply for the Diamond Drill.

Feb 11, 1981
For Mac Clarke Explorations D.A. Mac Keigan



Ministry of
Natural
Resources

Ontario
Geological
Survey

77 Grenville St.
11th Floor
Toronto, Ontario

Tel: 965-1337

Report Number
B 12924

Geoservices Laboratory Report

Date July 4, 1980

Issued To: Don MacKeigan, 229 Edmand Street, #305, Sudbury, Ontario

Sample Number	Gold Oz. Per Ton	Gold Value Per Ton	Silver Oz. Per Ton
1-0-10	Trace ∠.01		Trace ∠.1
1-10-25	Trace ∠.01		Trace ∠.1
1-25-35	Trace ∠.01		Trace ∠.1
1-35-45	Trace ∠.01		Trace ∠.1
2-0-10	Trace ∠.01		Trace ∠.1
2-10-20	Trace ∠.01		Trace ∠.1
2-20-25	.02		Trace ∠.1

Fees Received

14 Coups.
Card No. 3084

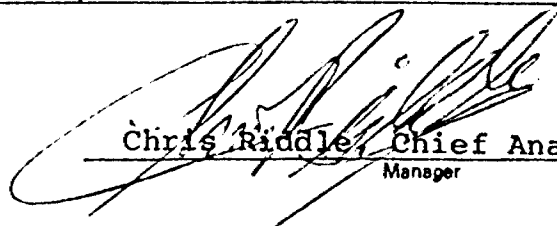
Chris Riddle, Chief Analyst
Manager

Except by special permission, reproduction of these results must include any
qualifying remarks made by this ministry with reference to any sample.

Claim # 559A17

L 26639

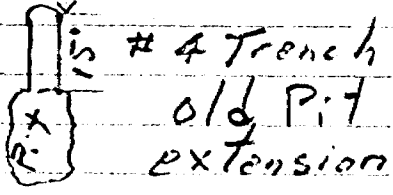
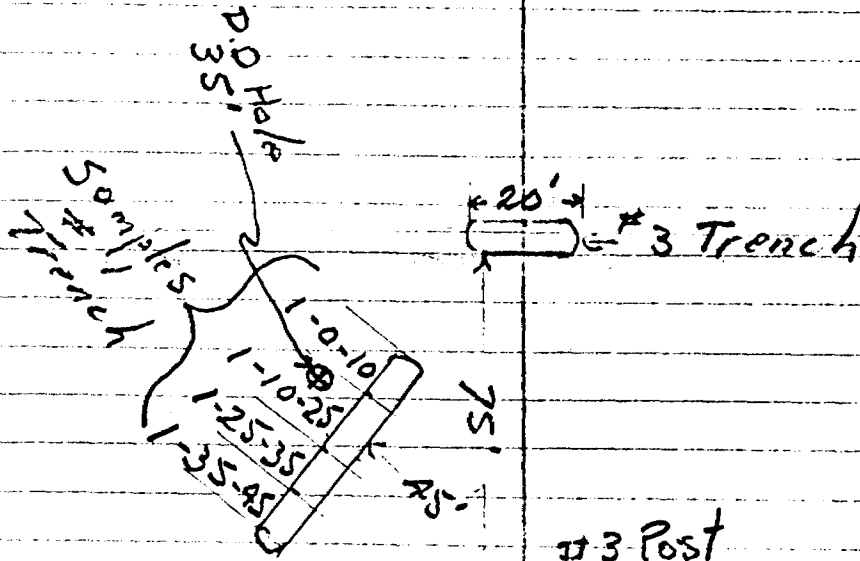

Claim # 559A18

L 26640

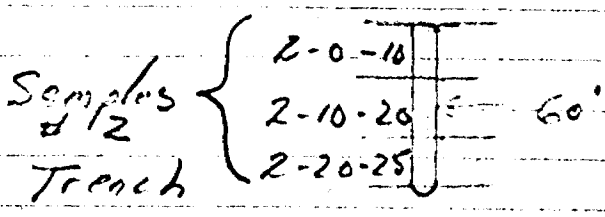

Scale: 1" = 40'

S

- 1a. Massive Basalt - Basaltic Andesite
- 1-b - Pillowed
- 1-k - contact Metamorphosed Amphibolite
- 2. unssubdivided Basalt - Basaltic Andesite.
- 2-EF. Andesite or Dacite Breccia - Tuff
- 5D. Contaminated rocks
- 2b - pillowed Andesite or Dacite
- 2G - Amygdaloidal Andesite or Dacite
- 1c. Basaltic Andesite flow - Breccia
- 5E. Feldspar Porphyry Dikes

C

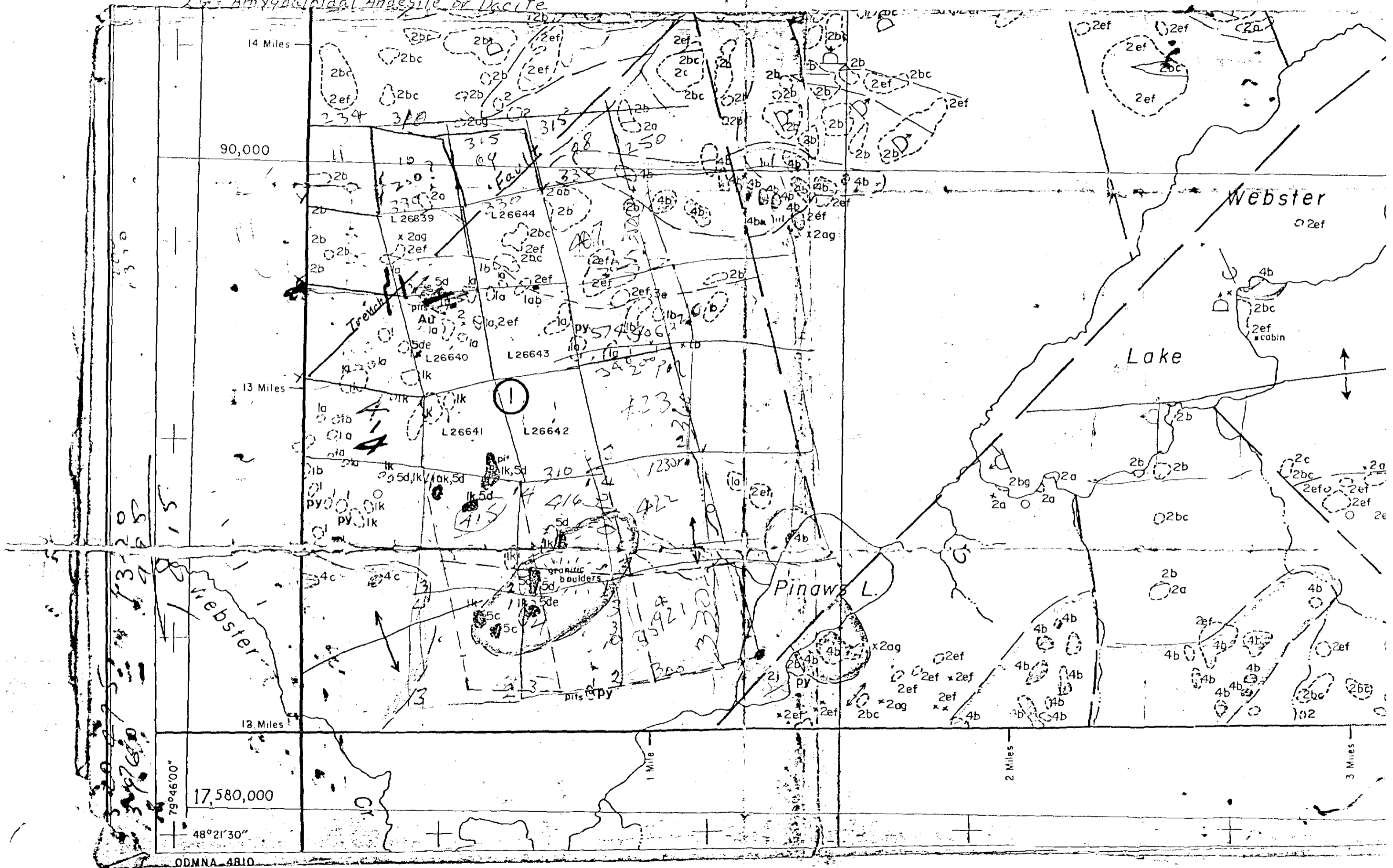

Tannahill Township

