



32005NW0058 63.5901 ELLIOTT

010

Summary of work performed on Anomaly #4 in the Geophysics Report.
All work performed by G. Bastarache, the owner.

Removed overburden	Aug 5 1991	10hrs @ \$10.00 p/h = \$100.00
Removed overburden	Aug 6 1991	10hrs @ \$10.00 p/h = \$100.00
Removed overburden	Aug 10 1991	10hrs @ \$10.00 p/h = \$100.00
Washing cleaning outcrop, sampling	Aug 12 1991	10hrs @ \$10.00 p/h = \$100.00
Sampling	Aug 12 1991	10hrs @ \$10.00 p/h = \$100.00
Removed more overburden by hand and washing bedrock	Aug 15 1991	10hrs @ \$10.00 p/h = \$100.00
Plugger (Cop. Co)	Sept 11 1991	10hrs @ \$10.00 p/h = \$100.00
Plugger (Cop. Co)	Sept 12 1991	10hrs @ \$10.00 p/h = \$100.00
Blasting	Sept 13 1991	10hrs @ \$10.00 p/h = \$100.00
Sampling	Sept 14 1991	10hrs @ \$10.00 p/h = \$100.00

Rock type on above work is ~~B~~ pillow Basalt

G. Bastarache



Established 1928

Swastika Laboratories

A Division of Assayers Corporation Ltd.

Assaying - Consulting - Representation

Assay Certificate

1W-3966-RA1

Company: **G. BASTARACHE**

Date: SEP-19-91

Project:

Copy 1. 25 TWEEDSMUIR #309, KIRKLAND LAKE

Attn:

We hereby certify the following Assay of 2 ROCK samples submitted SEP-13-91 by G. BASTARACHE.

Sample Number	Au oz/ton	Cu ppm	Pb ppm	Zn ppm
22475	Nil	176	190	605
22476	Nil	82	79	225

on claim 1110716 on pit

Certified by Donna Gardner

P.O. Box 10, Swastika, Ontario P0K 1T0
Telephone (705) 642-3244 FAX (705) 642-3300



Established 1928

Swastika Laboratories

A Division of Assayers Corporation Ltd.

Assaying - Consulting - Representation

Geochemical Analysis Certificate

1W-4127-RG1

Company: **G. BASTARACHE**

Date: OCT-07-91

Project:

Copy 1. 25 TWEEDSMUIR #309, KIRKLAND LAKE

Attn:

We hereby certify the following Geochemical Analysis of 2 ROCK samples submitted OCT-04-91 by .

Sample Number	Au ppb	Ag ppm	Cu ppm	Pb ppm	Zn ppm
22477		0.5	77	105	605
22478	Nil	0.6		43	291

*Assay from pit on 1110716
See map attached.*

Certified by Donna Gardner

P.O. Box 10, Swastika, Ontario P0K 1T0
Telephone (705) 642-3244 FAX (705) 642-3300

No. 170

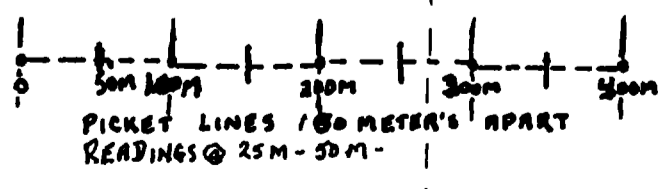
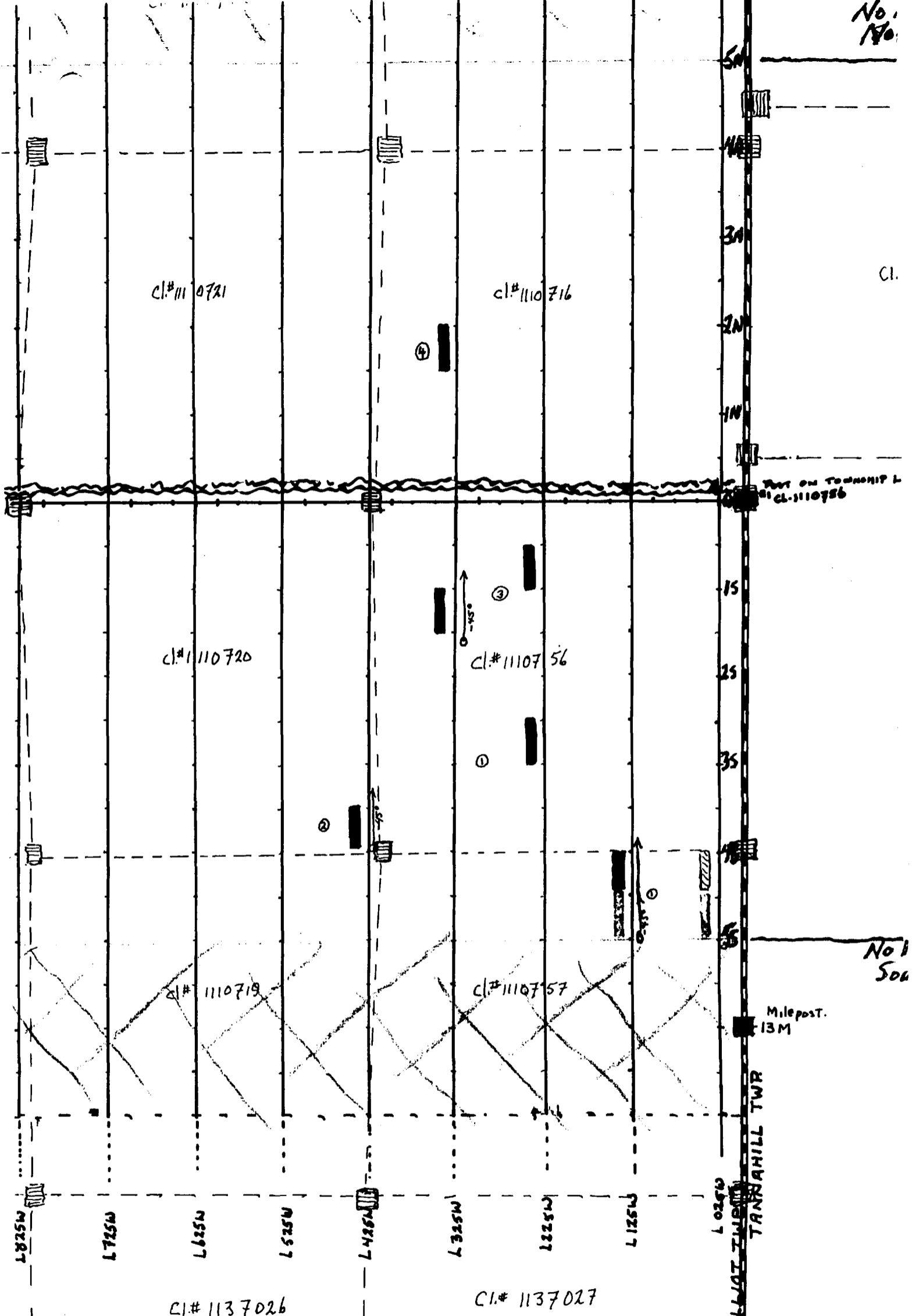

Claim post

Claim line

GERARD PASTARACHE

SCALE: 1:5000

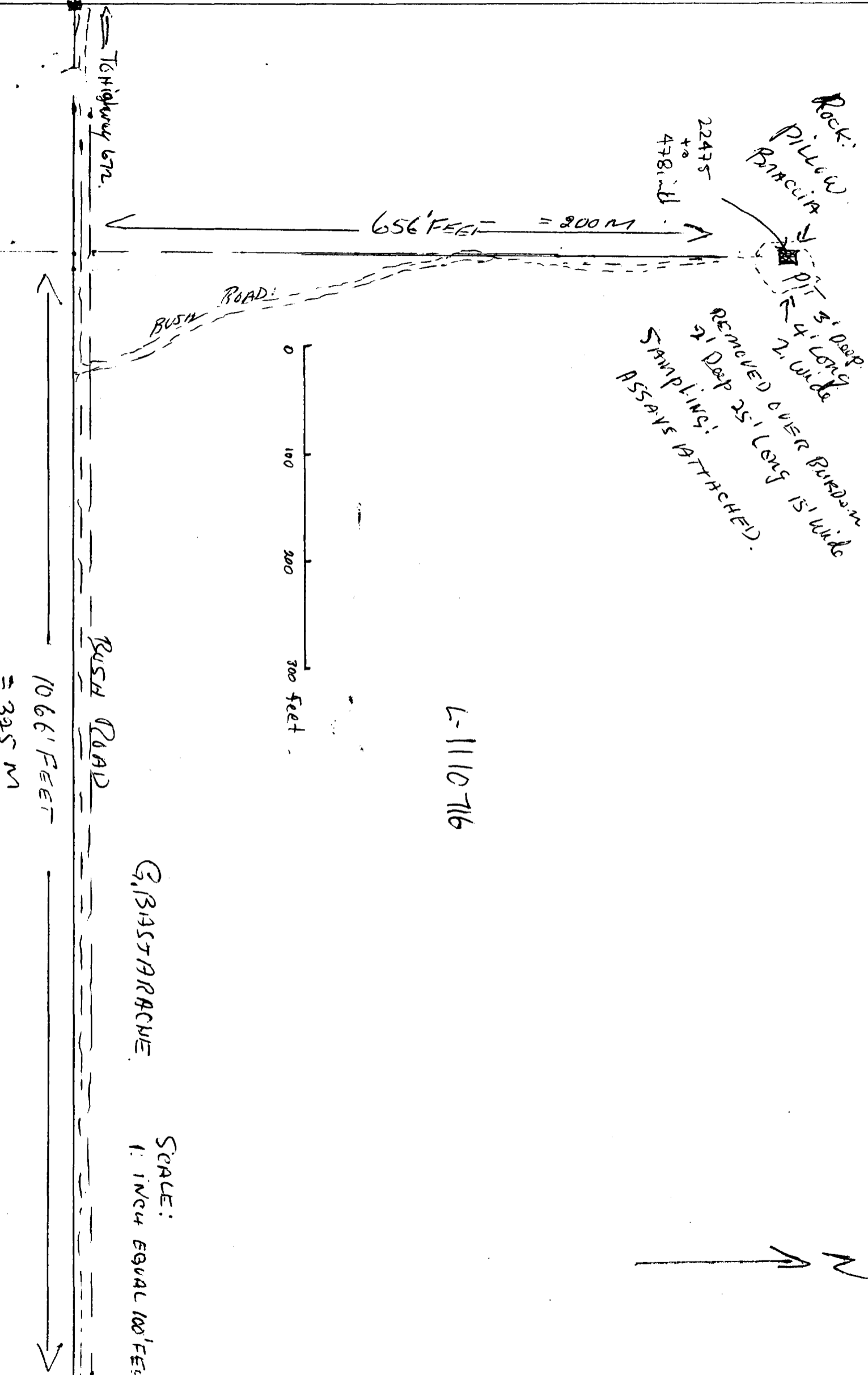

22475 to 47811

1-1110-716

G. BASTARACHE

SCALE: 1 INCH EQUAL 100 FEET



Ministry of Northern Development and Mines

A.F.L

Report of Work Co After Recording Cl

09180-5107 Mining Act



32005NW0058 63.5901 ELL10TT

900

Personal information collected on this form is obtained under the authority of the Mir this collection should be directed to the Provincial Manager, Mining Lands, Minis., Sudbury, Ontario, P3E 6A5, telephone (705) 670-7264.

63.5901

- Instructions:**
- Please type or print and submit in duplicate.
 - Refer to the Mining Act and Regulations for requirements of filing assessment work or consult the Mining Recorder.
 - A separate copy of this form must be completed for each Work Group.
 - Technical reports and maps must accompany this form in duplicate.
 - A sketch, showing the claims the work is assigned to, must accompany this form.

Recorded Holder(s) GERARD BASTARACHE Apt 309		Client No. M-15468/105509
Address 25 TWEEDSMUIR RD KIRKLAND LAKE ONT P2N 3M8		Telephone No. 1-705-568-8107
Mining Division LARDER LAKE ONT	Township/Area ELLIOTT TOWNSHIP	M or G Plan No. G-3633
Dates Work Performed From: Aug 6th 1991		To: Sept 14th 1991

Work Performed (Check One Work Group Only)

Work Group	Type
Geotechnical Survey	
Physical Work, Including Drilling	CLEAR OVER BURNING, SAMPLING, (PIT)
Rehabilitation	
Other Authorized Work	
Assays	
Assignment from Reserve	

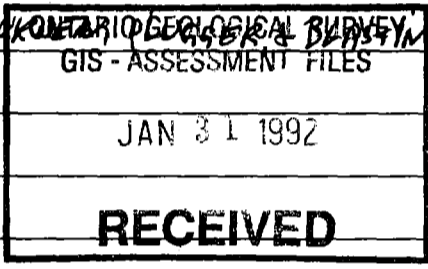

Total Assessment Work Claimed on the Attached Statement of Costs \$ 1000.00

Note: The Minister may reject for assessment work credit all or part of the assessment work submitted if the recorded holder cannot verify expenditures claimed in the statement of costs within 30 days of a request for verification.

Persons and Survey Company Who Performed the Work (Give Name and Address of Author of Report)

Name	Address
GERARD BASTARACHE	25 TWEEDSMUIR RD Apt 309 KIRKLAND LAKE ONT P2N 3M8

(attach a schedule if necessary)

Certification of Beneficial Interest * See Note No. 1 on reverse side

I certify that at the time the work was performed, the claims covered in this work report were recorded in the current holder's name or held under a beneficial interest by the current recorded holder.	Date Nov 6 1991	Recorded Holder or Agent (Signature) Gerard Bastarache
--	---------------------------	--

Certification of Work Report

I certify that I have a personal knowledge of the facts set forth in this Work report, having performed the work or witnessed same during and/or after its completion and annexed report is true.

Name and Address of Person Certifying Gerard Bastarache 25 Tweedsmuir Rd apt 309 Kirkland Lake, ont P2N 3 M8		
Telephone No. 1(705) 568-8107	Date Nov 6 1991	Certified By (Signature) Gerard Bastarache

For Office Use Only

Total Value Cr. Recorded \$1000.00 (banked)	Date Recorded Nov. 06/91	Mining Recorder 	Received Stamp NOV 6 11 3 04
	Deemed Approval Date _____ 215	Date Approved Nov. 06/91	
	Date Notice for Amendments Sent		



Statement of Costs
for Assessment Credit

État des coûts aux fins
du crédit d'évaluation

Transaction No./N° de transaction

DOCUMENT No.

W9180-05407

Mining Act/Loi sur les mines

Personal information collected on this form is obtained under the authority of the Mining Act. This information will be used to maintain a record and ongoing status of the mining claim(s). Questions about this collection should be directed to the Provincial Manager, Minings Lands, Ministry of Northern Development and Mines, 4th Floor, 159 Cedar Street, Sudbury, Ontario P3E 6A5, telephone (705) 670-7264.

Les renseignements personnels contenus dans la présente formule sont recueillis en vertu de la Loi sur les mines et serviront à tenir à jour un registre des concessions minières. Adresser toute question sur la collecte de ces renseignements au chef provincial des terrains miniers, ministère du Développement du Nord et des Mines, 159, rue Cedar, 4^e étage, Sudbury (Ontario) P3E 6A5, téléphone (705) 670-7264.

1. Direct Costs/Coûts directs

Type	Description	Amount Montant	Totals Total global
Wages Salaires	Labour / Main-d'oeuvre	\$1000	
	Field Supervision Supervision sur le terrain		\$1000.00
Contractor's and Consultant's Fees Droits de l'entrepreneur et de l'expert- conseil	Type Plugging & Blasting and Sampling		—
	Supplies Used Fournitures utilisées		
	Equipment Rental Location de matériel		
Total Direct Costs Total des coûts directs			\$1000.00

2. Indirect Costs/Coûts indirects

** Note: When claiming Rehabilitation work Indirect costs are not allowable as assessment work.
Pour le remboursement des travaux de réhabilitation, les coûts indirects ne sont pas admissibles en tant que travaux d'évaluation.

Type	Description	Amount Montant	Totals Total global
Transportation Transport	Type		
Food and Lodging Nourriture et hébergement			
Mobilization and Demobilization Mobilisation et démobilisation			
Sub Total of Indirect Costs Total partiel des coûts indirects			0
Amount Allowable (not greater than 20% of Direct Costs) Montant admissible (n'excédant pas 20 % des coûts directs)			
Total Value of Assessment Credit (Total of Direct and Allowable Indirect costs)		Valeur totale du crédit d'évaluation (Total des coûts directs et indirects admissibles)	\$1000.00

Note: The recorded holder will be required to verify expenditures claimed in this statement of costs within 30 days of a request for verification. If verification is not made, the Minister may reject for assessment work all or part of the assessment work submitted.

Note : Le titulaire enregistré sera tenu de vérifier les dépenses demandées dans le présent état des coûts dans les 30 jours suivant une demande à cet effet. Si la vérification n'est pas effectuée, le ministre peut rejeter tout ou une partie des travaux d'évaluation présentés.

Filing Discounts

1. Work filed within two years of completion is claimed at 100% of the above Total Value of Assessment Credit.
2. Work filed three, four or five years after completion is claimed at 50% of the above Total Value of Assessment Credit. See calculations below:

Total Value of Assessment Credit	Total Assessment Claimed
x 0.50 =	

Remises pour dépôt

1. Les travaux déposés dans les deux ans suivant leur achèvement sont remboursés à 100 % de la valeur totale susmentionnée du crédit d'évaluation.
2. Les travaux déposés trois, quatre ou cinq ans après leur achèvement sont remboursés à 50 % de la valeur totale du crédit d'évaluation susmentionné. Voir les calculs ci-dessous.

Valeur totale du crédit d'évaluation	Evaluation totale demandée
x 0,50 =	

Certification Verifying Statement of Costs

I hereby certify:
that the amounts shown are as accurate as possible and these costs were incurred while conducting assessment work on the lands shown on the accompanying Report of Work form.

that as _____ I am authorized
(Recorded Holder, Agent, Position in Company)

to make this certification

Attestation de l'état des coûts

J'atteste par la présente :
que les montants indiqués sont le plus exact possible et que ces dépenses ont été engagées pour effectuer les travaux d'évaluation sur les terrains indiqués dans la formule de rapport de travail ci-joint.

Et qu'à titre de _____ je suis autorisé
(titulaire enregistré, représentant, poste occupé dans la compagnie)

à faire cette attestation.

Signature _____ Date _____
Jan 24 1997

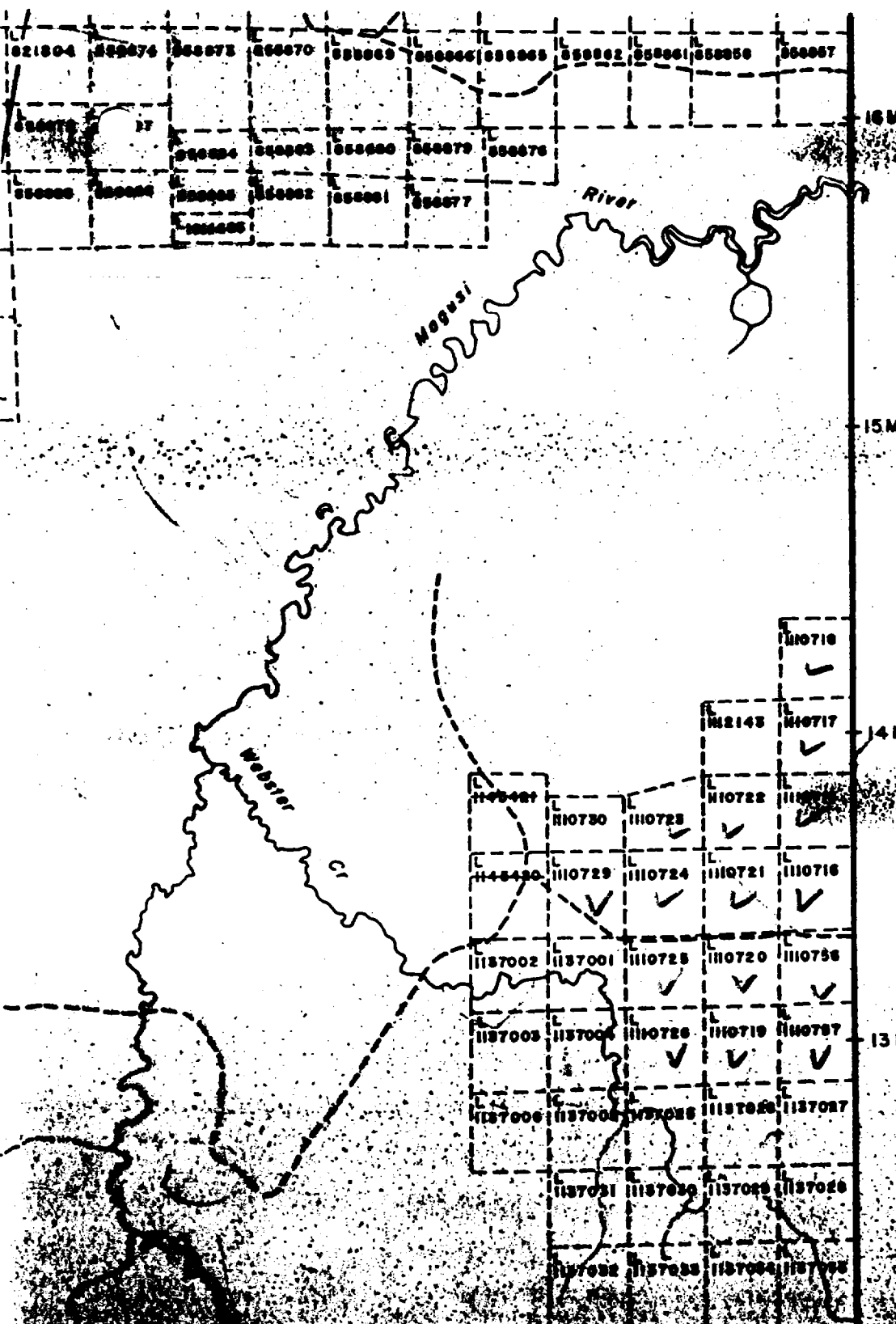

TANNAHILL TOWNSHIP

TYPE OF DOCUMENT
 PATENT SURFACE
 SURFACE MINING
 SURFACE MINING
 SURFACE MINING
 LICENCE OF OCCUPANCY
 ORDER-IN-COURT
 RESERVATION
 CANCELLED
 SAND & GRAVE

SCALE: 1 INCH
 FEET 0 1000
 METRES 0 200

TOWNSHIP
 ELLI
 M.N.R. ADMINISTRATION
 KIRKLAND
 MINING DIVISION
 LARGE SCALE