



32D05NW0098 63A.420 ELLIOTT

010

Geological Report

Ivan C. Stairs Property

Elliot Township

Ontario

Introduction

Ten claims were staked in May, 1962 in the following described location, and a prospecting and geological mapping program was carried out during the period of October 15 to November 19, 1962. The party consisted of two men working as line cutters and the writer, engaged with the geological mapping, sampling and prospecting. The two men assisted with this work also. Gold values had been reported from several old workings and this work was designed to explore the possibilities of the immediate area.

Property and Ownership

The property comprises ten mining claims located in the Larder Lake Mining Division and numbered as follows:

L-75957-58-59-60-61-62-63-64-65-66, all inclusive.

Claim L 75966 is registered in the name of G. S. Potter, Miner's License K-14641 and the remainder are registered in the name of J. Custance, License No. K-14450. By option agreement, ownership has been vested in the name of Ivan C. Stairs, Box 520, Bathurst, New Brunswick.

Location and Access

The property is situated in the north-west part of Elliot Township, in the District of Cochrane, Province of Ontario. The north-west corner of the group is one and a quarter miles south and one half mile east of the north-west corner of the township.

During periods of high water, aircraft can be used to land on Ghost Lake, near the south-east corner of the group. In the present case a small tractor and sloop was used and a narrow road suitable only for this type of transportation was made to the east part of the claims, a distance of three miles, starting at a point one and a half miles north of Simard's Sawmill which is connected by gravel road to Highway 101, ten miles north. From this point it is approximately thirty five miles west to Matheson, Ontario.

Details of Line Cutting and Survey

A total of 47,373 feet of line was cut. All lines were chained and stations established at 100 foot intervals. The base line, 6800 feet long has an astronomic bearing of 70 degrees.

The names and addresses of the persons engaged in the survey are as follows:

George S. Potter, Line Cutter and Geological Assistant  
Swastika, Ontario.

M. Beaudoin, Line Cutter and Geological Assistant  
Swastika, Ontario.

Harris Hanson, Party Chief  
Box 943, Kirkland Lake, Ontario.

Work was carried out during the period of October 15 to November 19, 1962.

The survey was generally confined to the existing lines but where deemed advisable, intervening traverses were made by pace and compass and all outcrops tied into appropriate stations.

#### Table of Formations

Cenozoic	
Recent	Peat
Pleistocene	Sand, gravel, boulders, clay. Great Unconformity
Precambrian	
Keweenawan ?	Olivine diabase Intrusive Contact
Algoman ?	Syenite Intrusive Contact
Volcanics	Andesite, Basalt, Porphyritic Basalt, Rhyolite, Chert

#### Topography and Drainage

The main drainage system of the property is the Ghost River which drains the lake of the same name and flows north through the east part of the claim group. In this area, it is a narrow fast moving stream, four to eight feet in width with short sections of sluggish waters.

Cedar and small black spruce grow thickly in flat, wet muskeg that occupies the area of the north and south boundaries of the property. Balsam, pine and birch are found in profusion in the central part of the group along a north-east trending ridge of higher ground. Clay, sand and gravel is well distributed on the ridge as well as scattered outcrops of rock.

#### General Geology

The bedrock of the property is thought to be entirely of Precambrian age. These rocks are exposed infrequently as much of the group is covered with unconsolidated material of Pleistocene age. The youngest rock seems to be an olivine diabase of medium to coarse texture and weathering a reddish brown colour.

No contact with other formations was observed but this rock is typical of the common olivine diabase of other areas that occurs as late north-south trending dikes.

Basic lavas outcrop infrequently along the north part of the claim group and in the south-west corner. These rocks are massive in appearance and range in colour from black to pale green. Considered in the field, the composition would seem to range from basalt to andesite. Minor

occurrences of spherulitic basalt were noted but not mapped separately. A zone about twenty feet wide is exposed in the north central part of claim L-75960. It contains a light dissemination of coarse cube pyrite.

A large outcrop of porphyritic basalt occurs in the south-east part of Claim L-75965. A certain amount of carbonatization and silicification has taken place along with light to heavy pyritization.

Massive pale grey to greenish rhyolites outcrop in the southern and north-east part of the property. They appear to be part of a succession of relatively narrow bands of acid and basic flows that are a geological feature of the general area.

The contact between the acid and basic rocks on the property is marked by a well developed zone of extreme silicification. Outcrops indicate a continuous zone of black to grey cherty material, quite glassy in texture and easily fractured. A small body of reddish coloured syenite occurs within the zone of silicification in the central-east part of claim L-75960. Certain outcrops of the syenite show marked silicification especially the most southern exposures of this intrusive type.

The syenite is a medium grained rock that appears to occupy an area of about three hundred feet by eight hundred feet. It has been well fractured and mineralized in places with light pyrite, specular iron and magnetite. A few quartz stringers were observed but the development of veining is rather weak.

#### Economic Considerations

The presence of gold has been indicated by panning and sampling at two different locations on the property. They are confined to the area of red syenite in the east part of claim L-75960 and the exposure of porphyritic basalt located in the south-east part of claim L-75965. Results from past work by other parties indicated very encouraging values to be present at both locations.

These areas have been extensively trenched in past years and it was not possible to sample properly due to extensive caving, water and ice. However, twelve representative grab samples from both areas showed low values in gold ranging from 0.005 ozs. to 0.10 ozs.

There was low content of pyrite in all the samples taken but the best values were associated with samples containing the most pyrite. Values of 0.02 ozs. were secured from lightly mineralized chert in close proximity to the syenite body.

On both showings it was noted that a certain amount of diamond drilling had been done by unknown parties. Several collars were found as well as scattered core. It would appear that within the immediate area of the old workings, the ground has been fairly well tested.

#### Summary and Recommendations

A contact between acid and basic volcanics cuts through the central part of the Stairs property in a northeasterly direction. The contact area is marked by a strong zone of silicification, the rocks being cherty and brittle in texture. At two points, three quarters of a mile apart, gold values have been secured within and closely adjacent to the

(4)

chert zone. The distribution of sulphides in silicified material is sparse but values appear to be connected closely with the pyrite which is usually present in fine disseminated form wherever fracturing has occurred.

The zone of cherty material traverses the entire property for a strike length of about one and a quarter miles with indicated widths of over four hundred feet. Much of this formation is unexplored. Within it, fracture patterns of sufficient strength may have developed deposits of sulphide gold ore.

It is recommended that the control lines already out, be utilized to conduct a geophysical survey of a type to be later considered, the objective being the locating of possible areas of gold bearing sulphide mineralization within the chert zone. It is suggested that this work be scheduled for the month of May, 1963.

I hereby certify details of this report correct in all respects.

Harris Hanson

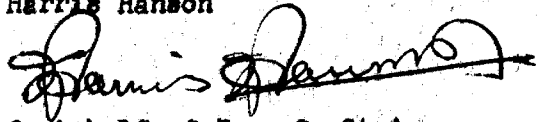

On behalf of Ivan C. Stairs

Kirkland Lake, Ontario.

January 5th, 1963

KEY MAP

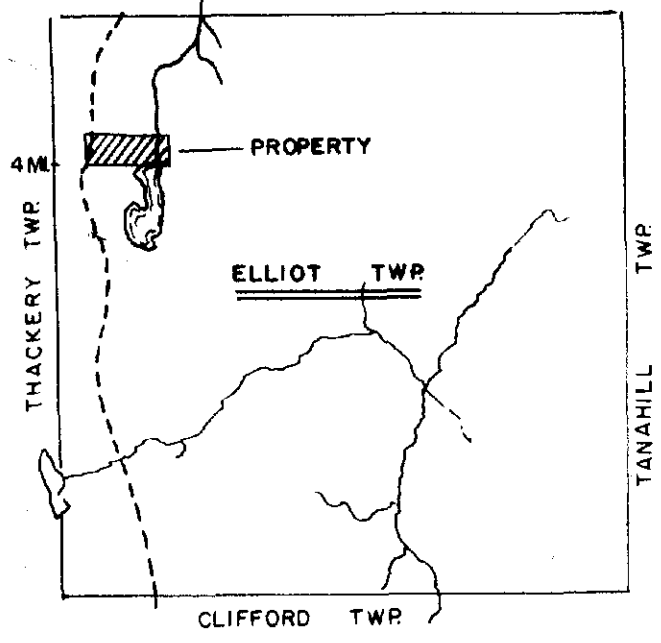

MAP SHOWING

GEOLOGICAL SURVEY OF IVAN C. STAIRS PROPERTY  
GHOST LAKE AREA - ELLIOT TWP.

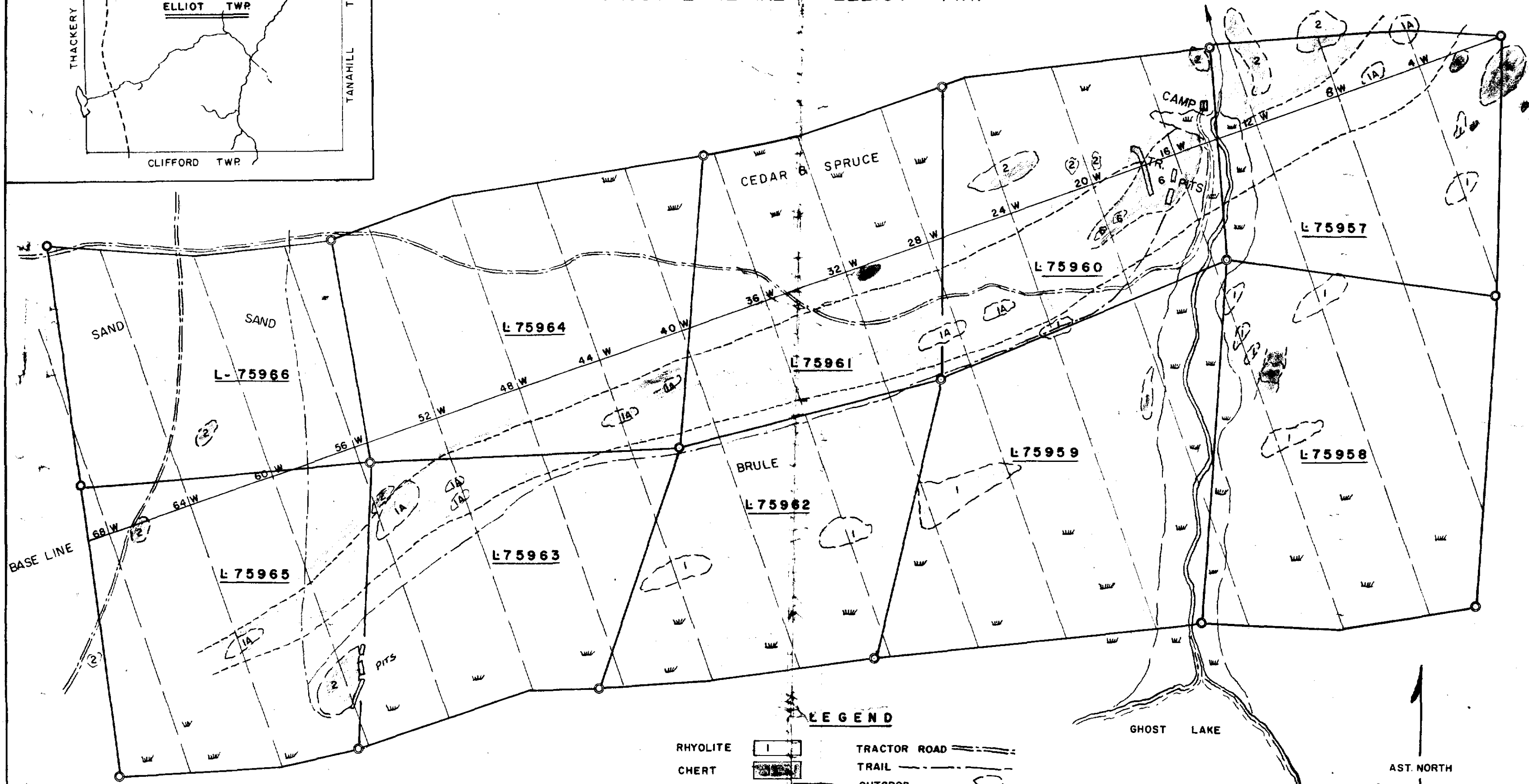

LEGEND

- RHYOLITE [Symbol]
- CHERT [Symbol]
- BASALT-ANDESITE [Symbol]
- DIABASE [Symbol]
- SYENITE [Symbol]
- TRACTOR ROAD [Symbol]
- TRAIL [Symbol]
- OUTCROP [Symbol]
- GEOLOGY BOUNDARY [Symbol]
- PICKET LINE [Symbol]

SCALE: ONE INCH = 400 FT.

AST. NORTH

Geology by  
H. HANSON  
Jan 5/63

