

afw

Ministry of Northern
Development and Mines

April 20th 1994

W9480-00324



32089W0110 W9480-00324 COOK

010

I am sending work outline and
charts. Could you please forward the
forms need to properly record this
work.

- ① Report of work conducted
after Recording claim
- ② Statement of costs for
Assessment Credits

Thank-you

Christine Mills

RECEIVED
LARDER LAKE
MINING DIVISION

APR 28 1994

April 20th 1994

Ministry of Northern
Development of Mines,

Work Outline for Cook Township
Claim Number 843121

The purpose of work done on this claim was to, follow up on quartz veins found in trench no. 7 which was reported in last years work. The nature of the rock and mineralization exposed was, sediments. The type of equipment used was, shovels, pick and bucket. This manual labour was done by, Charles Marshall, Derek Marshall, and Christine Mills, on Sept 2nd, 3rd, 4th, 5th and 6th of ¹⁹⁹³ They worked on trench no. 8 claim no. 843121 as shown on the following charts.

The work done on this claim is to be applied to claim no 971279, 971280, 971280, 971282, 971281, 971283.

Charles Marshall
Christine Mills

Charles Marshall
LIC K15629

Cook Township

MAGNETIC NORTH

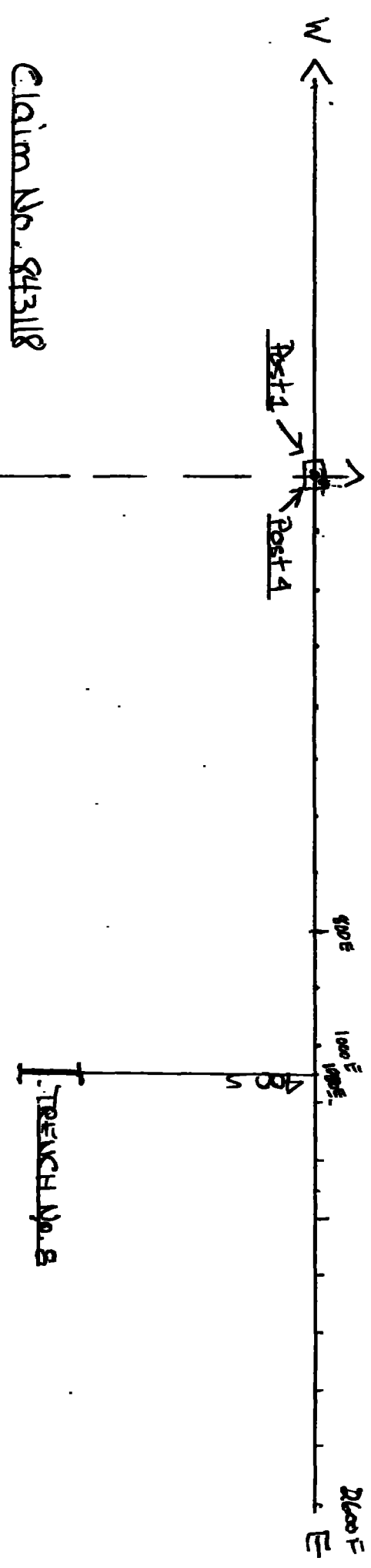

Claim No. 843121

Stripping Trench

1 X 1/2 X D

Trench 8
100 FT X 6 FT X 5 FT. Gravel

Work Performed on

September 2, 3, 4, 5, 6
1995

Work Performed By:

CHARLES MARSHALL

DEREK MARSHALL

CHRISTINE MILLS

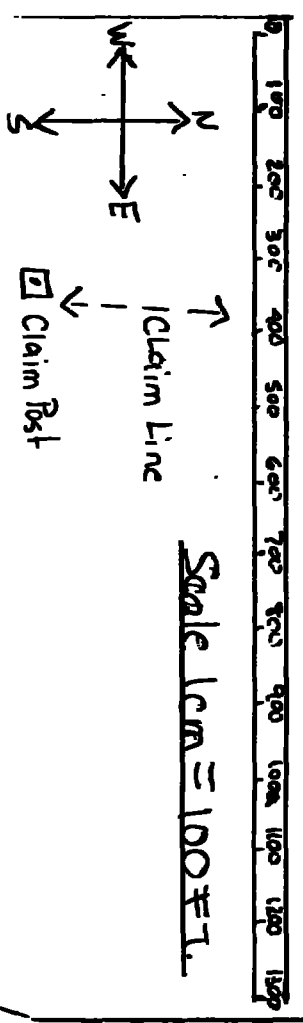

Cock Township

Charles Marshall

LIC. K15629

North

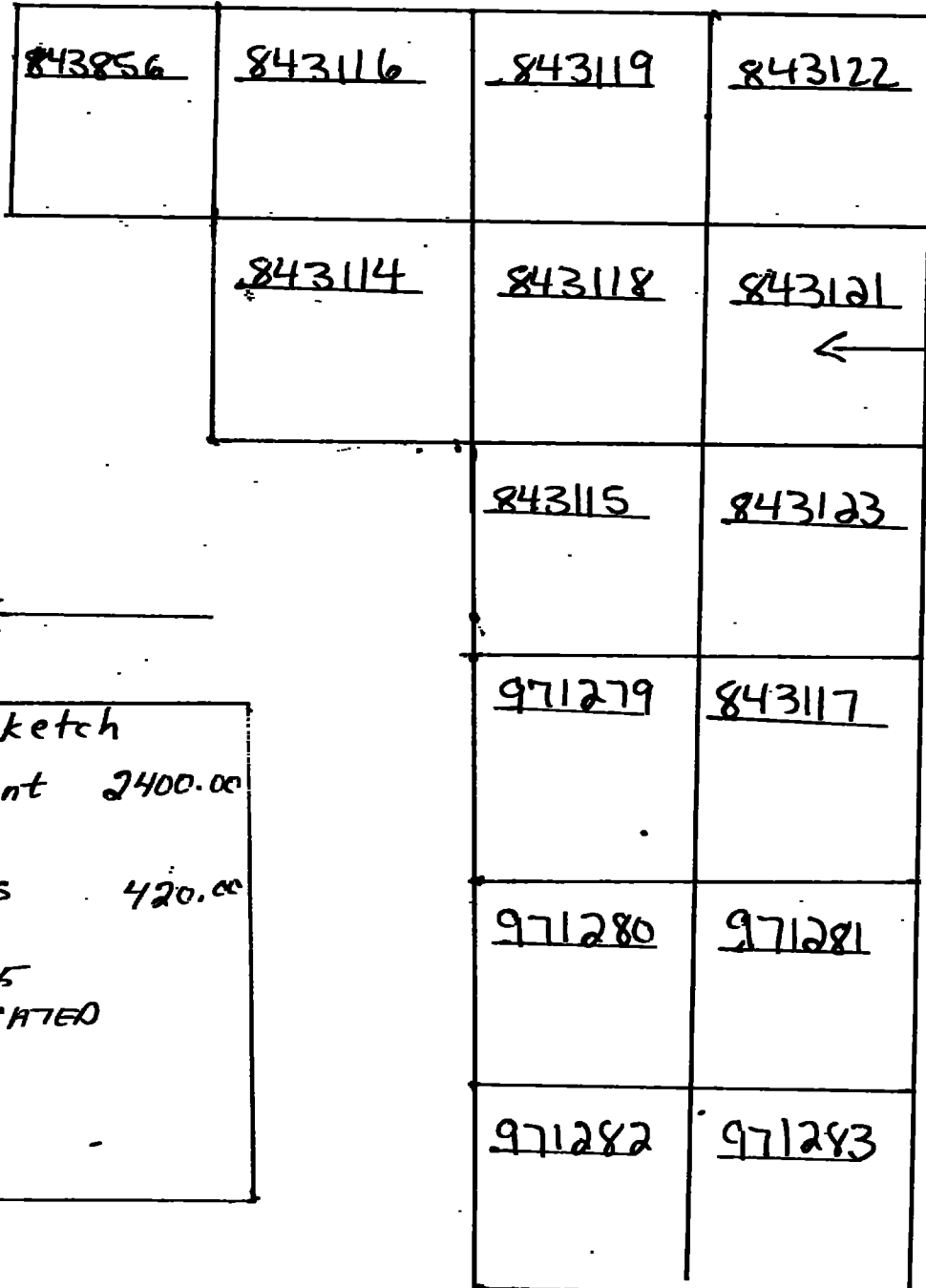

V

Work performed ←

West ←

→ East

IV

Lot 7

Lot 6

South



Group Sketch

Total Amount 2400.00

DIVIDED BY 5

CLAIMS EQUALS 420.00

APPLIED TO

EACH OF THE 5

CLAIMS INDICATED

- ① 971279
- ② 971282
- ③ 971280
- ④ 971281
- ⑤ 971283

COOK TOWNSHIP

Charles W. ...
LIC. K15629

NORTH
↑

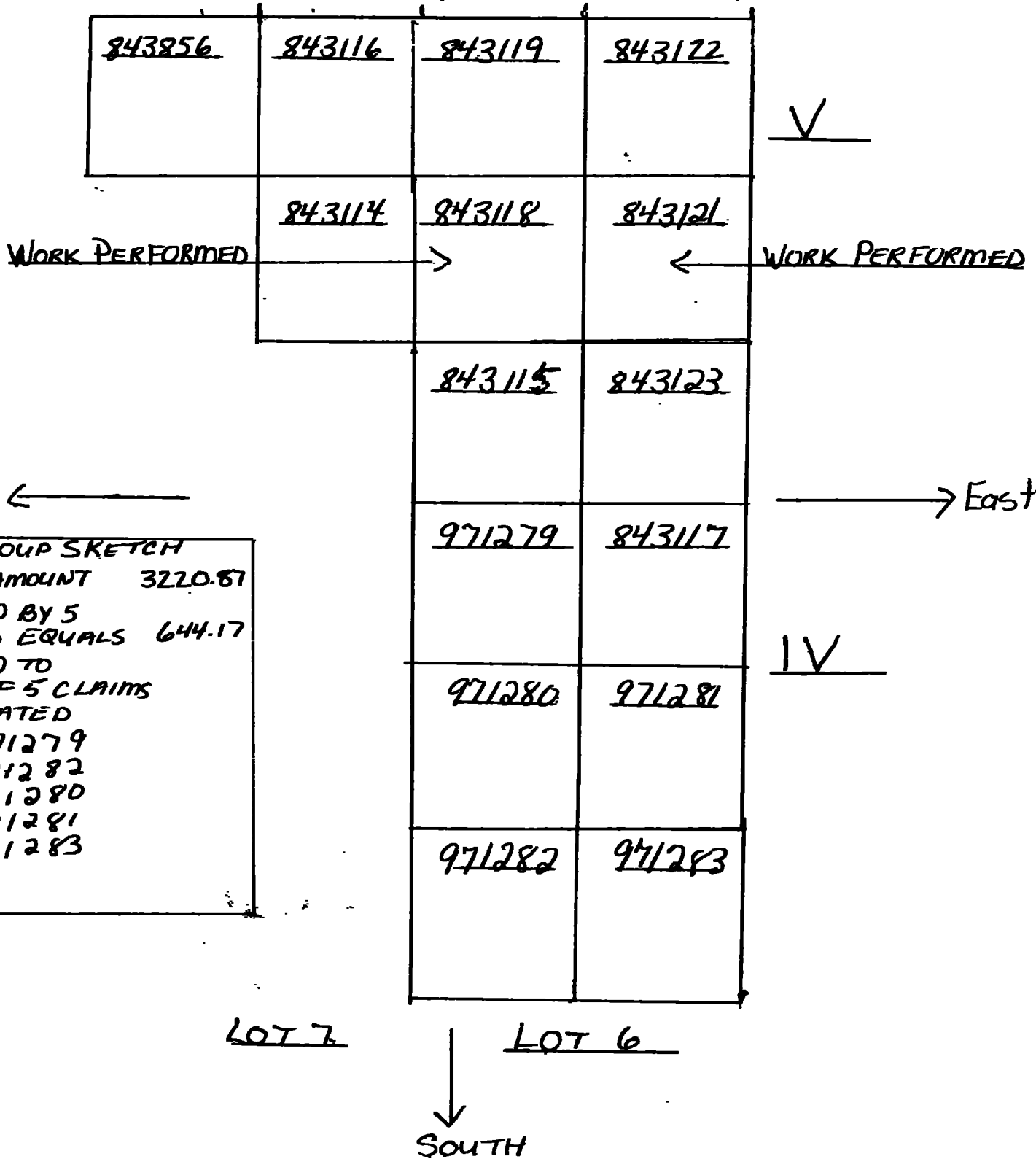

GROUP SKETCH
 TOTAL AMOUNT 3220.87
 DIVIDED BY 5
 CLAIMS EQUALS 644.17
 APPLIED TO
 EACH OF 5 CLAIMS
 INDICATED

- Ⓞ 971279
- Ⓞ 971282
- Ⓞ 971280
- Ⓞ 971281
- Ⓞ 971283



32D05NWD0110 WB480-00324 COOK

020

W 9480.00365

Appendix

Catharine Township--- Larder Lake Mining Division

Kirkland Lake Ont.
June 13/ 1994

Claim Numbers requiring work and number of dollars per claim

Claim Nos.-- 982371-982372 - need \$120.00 for 1994
I047991-I047992- .. \$200.00 .. 1994
I046145-I046146-I047147--\$200.00

Work done on claim 981315 - \$1,989.00

- 981315 -



CLAIM NO. - 981315

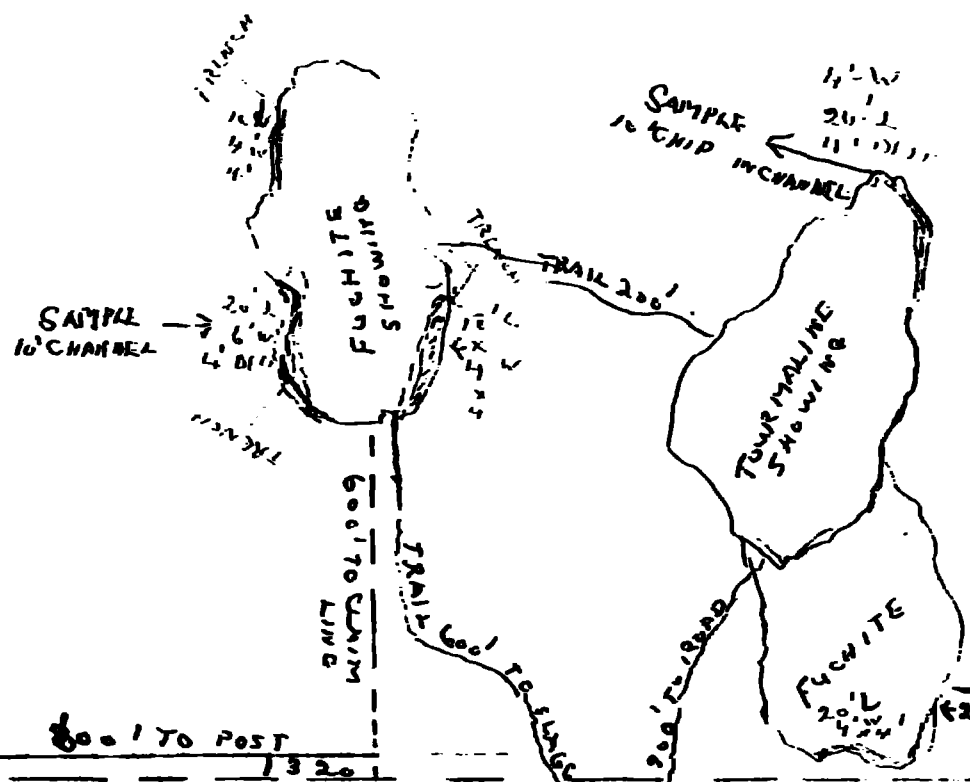

BENMO BASELINE ALSO CLAIM LINE E-W
TRAIL TO POST AT BASELINE

FERGUSON - WIGGLESWORTH
ANNET CLAIMS
CATHERINE TOWNSHIP

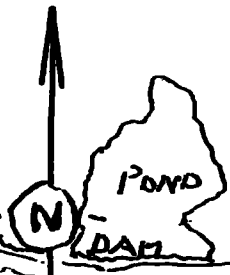

← 3 KILOMETRES TO HIGHWAY 624

0 100 200
SCALE 1" = 200'

NOTICE OF FORESTRY ACT
THIS TOWNSHIP / AREA FALLS WITHIN
TIMISKAMING MANAGEMENT UNIT
AND MAY BE SUBJECT TO FORESTRY
THE MNR UNIT FORESTER FOR THIS
CONTACTED AT: P.O. BOX 129
SWASTIKA, ONT.
705-642-3222

LEGEND:

- PATENTED LAND
- PATENTED FOR SURFACE RIGHTS ONLY
- LEASE
- LICENSE OF OCCUPANCY
- GROWN LAND SALES
- LOCATED LAND
- CANCELLED
- MINING RIGHTS ONLY
- SURFACE RIGHTS ONLY
- HIGHWAY ROUTE NO.
- ROADS
- TRAILS
- RAILWAYS
- POWER LINES
- MARSH OR MUSKEG
- MINES

*Used only with appropriate scale locations only

TOWNSHIP OF
CATHAR
DISTRICT OF
TIMISKAMING
LARDER LAKE
MINING DIVISION
SCALE: 1 INCH = 40 CHAINS

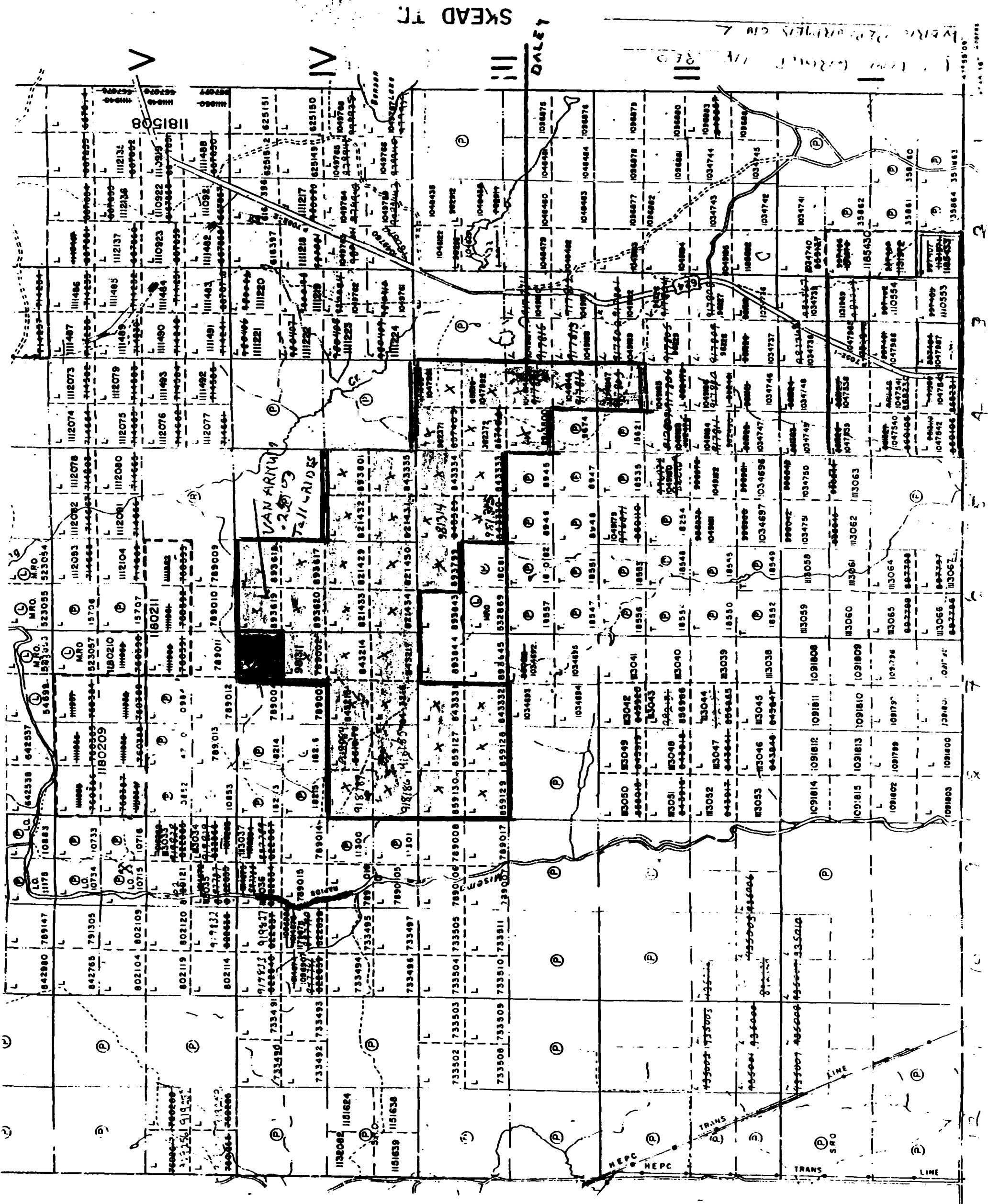



Ministry of
Northern Development
and Mines

Ontario

Report of Work Conducted After Recording Claim

Mining Act

DOCUMENT No.
Transaction Number
W 9480-00324

Personal information collected on this form is obtained under the authority of the MIA. This collection should be directed to the Provincial Manager, Mining Lands, Mini Sudbury, Ontario, P3E 6A5, telephone (705) 670-7284.



32D05NW0110 W9480-00324 COOK

900

- Instructions:**
- Please type or print and submit in duplicate.
 - Refer to the Mining Act and Regulations for requirements of the Recorder.
 - A separate copy of this form must be completed for each Work Group.
 - Technical reports and maps must accompany this form in duplicate.
 - A sketch, showing the claims the work is assigned to, must accompany this form.

215466

Recorded Holder(s) CHARLES MARSHALL		Client No. K15629
Address 382 VINE ST. APT 710 ST. CATHERINES		Telephone No. 905-934-3579
Mining Division KIRKLAND LAKE	Township/Area COOK	M or G Plan No.
Date Work Performed	From: Sept 2ND 1993	To: Sept 6th 1993

Work Performed (Check One Work Group Only)

Work Group	Type
Geotechnical Survey	
Physical Work, including Drilling	TRENCHING
Rehabilitation	
Other Authorized Work	
Assays	
Assignment from Reserve	

Ontario Geological Survey
MINES LIBRARY
JUL 12 1994
RECEIVED

Total Assessment Work Claimed on the Attached Statement of Costs \$ **2250.**

Note: The Minister may reject for assessment work credit all or part of the assessment work submitted if the recorded holder cannot verify expenditures claimed in the statement of costs within 30 days of a request for verification.

Persons and Survey Company Who Performed the Work (Give Name and Address of Author of Report)

Name	Address
CHARLES MARSHALL	382 VINE ST. APT 710 ST. CATHERINES
DEREK MARSHALL	510 CLARIDGE APT. 2 BURINGTON
CHRISTINE MILLS	3502 MULTER CT. BURINGTON

(attach a schedule if necessary)

Certification of Beneficial Interest * See Note No. 1 on reverse side

I certify that at the time the work was performed, the claims covered in this work report were recorded in the current holder's name or held under a beneficial interest by the current recorded holder.	Date May 16/94	Recorded Holder or Agent (Signature) C. Marshall
--	--------------------------	--

Certification of Work Report

I certify that I have a personal knowledge of the facts set forth in this Work report, having performed the work or witnessed same during and/or after its completion and annexed report is true.		
Name and Address of Person Certifying CHRISTINE MILLS		
Telephone No. (905) 335-0222	Date May 16, 94	Certified By (Signature) Christine Mills

For Office Use Only

Total Value Cr. Recorded \$ 2250.	Date Recorded May 19/94	Mining Recorder <i>[Signature]</i>	Received Stamp RECEIVED LARDER LAKE MINING DIVISION MAY 19 1994
	Deemed Approval Date August 17/94	Date Approved July 7/94	
	Date Notice for Amendments Sent		

Work Report Number for Applying Reserve	Claim Number (see Note 2)	Number of Claim Units
	843121	
	971279	
	971280	
	971281	
	971282	
	971283	
Total Number of Claims		6

Value of Assessment Work Done on this Claim	Value Applied to this Claim
\$2250.00	0
	\$450.00
	\$450.00
	\$450.00
	\$450.00
	\$450.00
Total Value Work Done	Total Value Work Applied
\$2250.00	\$2250.00

Value Assigned from this Claim	Reserve: Work to be Claimed at a Future Date
\$2250.00	
Total Assigned From	Total Reserve
\$2250.00	

Credits you are claiming in this report may be cut back. In order to minimize the adverse effects of such deletions, please indicate from which claims you wish to prioritize the deletion of credits. Please mark (✓) one of the following:

- Credits are to be cut back starting with the claim listed last, working backwards.
- Credits are to be cut back equally over all claims contained in this report of work.
- Credits are to be cut back as prioritized on the attached appendix.

In the event that you have not specified your choice of priority, option one will be implemented.

Note 1: Examples of beneficial interest are unrecorded transfers, option agreements, memorandum of agreements, etc., with respect to the mining claims.

Note 2: If work has been performed on patented or leased land, please complete the following:

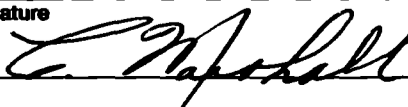
I certify that the recorded holder had a beneficial interest in the patented or leased land at the time the work was performed.	Signature 	Date May 16, 94
---	---	--------------------



Ministry of
Northern Development
and Mines

Ministère du
Développement du Nord
et des mines

**Statement of Costs
for Assessment Credit**

**État des coûts aux fins
du crédit d'évaluation**

Mining Act/Loi sur les mines

Transaction No./N° de transaction
DOCUMENT No.

W 9480 • 00324

Personal information collected on this form is obtained under the authority of the Mining Act. This information will be used to maintain a record and ongoing status of the mining claim(s). Questions about this collection should be directed to the Provincial Manager, Minings Lands, Ministry of Northern Development and Mines, 4th Floor, 159 Cedar Street, Sudbury, Ontario P3E 6A5, telephone (705) 670-7264.

Les renseignements personnels contenus dans la présente formule sont recueillis en vertu de la Loi sur les mines et serviront à tenir à jour un registre des concessions minières. Adresser toute question sur la collecte de ces renseignements au chef provincial des terrains miniers, ministère du Développement du Nord et des Mines, 159, rue Cedar, 4^e étage, Sudbury (Ontario) P3E 6A5, téléphone (705) 670-7264.

1. Direct Costs/Coûts directs

Type	Description	Amount Montant	Totals Total global
Wages Salaires	Labour Main-d'oeuvre	2250.	2250.00
	Field Supervision Supervision sur le terrain		
Contractor's and Consultant's Fees Droits de l'entrepreneur et de l'expert- conseil	Type		
Supplies Used Fournitures utilisées	Type		
Equipment Rental Location de matériel	Type		
Total Direct Costs Total des coûts directs			2250.00

2. Indirect Costs/Coûts indirects

** Note: When claiming Rehabilitation work Indirect costs are not allowable as assessment work.
Pour le remboursement des travaux de réhabilitation, les coûts indirects ne sont pas admissibles en tant que travaux d'évaluation.

Type	Description	Amount Montant	Totals Total global
Transportation Transport	Type		
Food and Lodging Nourriture et hébergement			
Mobilization and Demobilization Mobilisation et démobilisation			
Sub Total of Indirect Costs Total partiel des coûts indirects			
Amount Allowable (not greater than 20% of Direct Costs) Montant admissible (n'excédant pas 20 % des coûts directs)			
Total Value of Assessment Credit (Total of Direct and Allowable Indirect costs)		Value totale du crédit d'évaluation (Total des coûts directs et indirects admissibles)	

Note: The recorded holder will be required to verify expenditures claimed in this statement of costs within 30 days of a request for verification. If verification is not made, the Minister may reject for assessment work all or part of the assessment work submitted.

Note : Le titulaire enregistré sera tenu de vérifier les dépenses demandées dans le présent état des coûts dans les 30 jours suivant une demande à cet effet. Si la vérification n'est pas effectuée, le ministre peut rejeter tout ou une partie des travaux d'évaluation présentés.

Filing Discounts

1. Work filed within two years of completion is claimed at 100% of the above Total Value of Assessment Credit.
2. Work filed three, four or five years after completion is claimed at 50% of the above Total Value of Assessment Credit. See calculations below:

Total Value of Assessment Credit	Total Assessment Claimed
$\times 0.50 =$	2250.00

Remises pour dépôt

1. Les travaux déposés dans les deux ans suivant leur achèvement sont remboursés à 100 % de la valeur totale susmentionnée du crédit d'évaluation.
2. Les travaux déposés trois, quatre ou cinq ans après leur achèvement sont remboursés à 50 % de la valeur totale du crédit d'évaluation susmentionné. Voir les calculs ci-dessous.

Value totale du crédit d'évaluation	Evaluation totale demandée
$\times 0,50 =$	

Certification Verifying Statement of Costs

I hereby certify:
that the amounts shown are as accurate as possible and these costs were incurred while conducting assessment work on the lands shown on the accompanying Report of Work form.

that as [Signature] I am authorized
(Recorded Holder, Agent, Position in Company)

to make this certification

Attestation de l'état des coûts

J'atteste par la présente :
que les montants indiqués sont le plus exact possible et que ces dépenses ont été engagées pour effectuer les travaux d'évaluation sur les terrains indiqués dans la formule de rapport de travail ci-joint.

Et qu'à titre de _____ je suis autorisé
(titulaire enregistré, représentant, poste occupé dans la compagnie)

à faire cette attestation.

Signature [Signature] Date May 16/94



Ministry of Northern Development and Mines

Ontario

Report of Work Conducted After Recording Claim

Mining Act

DOCUMENT NO.

9480-00365

Personal information collected on this form is obtained under the authority of the Mining Act. This information will be used for correspondence. Questions about this collection should be directed to the Provincial Manager, Mining Lands, Ministry of Northern Development and Mines, Fourth Floor, 159 Cedar Street, Sudbury, Ontario, P3E 6A5, telephone (705) 670-7264.

- Instructions:**
- Please type or print and submit in duplicate.
 - Refer to the Mining Act and Regulations for requirements of filing assessment work or consult the Mining Recorder.
 - A separate copy of this form must be completed for each Work Group.
 - Technical reports and maps must accompany this form in duplicate.
 - A sketch, showing the claims the work is assigned to, must accompany this form.

Recorded Holder(s) <i>Ralph Ferguson</i> Roy Annett Shining Tree Ont.	<i>Fred Wigglesworth</i>	Client No. <i>131472</i> 102623
Address <i>101 Helen St. Matadewan POKIMU</i> Shining Tree General Delivery Ont.	<i>42 Churchill Drive Kirkland Lake Ont.</i>	Telephone No. <i>567-7936</i> <i>705-263-2054</i>
Mining Division <i>Larder Lake Div.</i>	Township/Area <i>Catherine Twp.</i>	M or G Plan No. <i>G 3615</i>
Date Work Performed From: <i>May 17 1994</i>	To: <i>May 19 1994</i>	

Work Performed (Check One Work Group Only)

Work Group	Type
Geotechnical Survey	
Physical Work, Including Drilling	<input checked="" type="checkbox"/> Trenching Cobra Plugger (I day cutting trail and hand Stripping site. Cleaning and flagging one-quarter mile base-claim line.
Rehabilitation	
Other Authorized Work	
Assays	
Assignment from Reserve	

Ontario Geological Survey
MINES LIBRARY
JUL 12 1994

Total Assessment Work Claimed on the Attached Statement of Costs \$ 1,989.00

Note: The Minister may reject for assessment work credit all or part of the assessment work submitted if the recorded holder cannot verify expenditures claimed in the statement of costs within 30 days of a request for verification.

RECEIVED

Persons and Survey Company Who Performed the Work (Give Name and Address of Author of Report)

Name	Address
<i>Fred Wigglesworth</i>	<i>42 Churchill Drive Kirkland Lake Ont. 3-days</i>
<i>Roy Annet</i>	<i>Shining Tree Ont. 3-- days</i>
<i>Tim O'Connor</i>	<i>Shining Tree Ont. 3 days</i>

(attach a schedule if necessary)

Certification of Beneficial Interest * See Note No. 1 on reverse side

I certify that at the time the work was performed, the claims covered in this work report were recorded in the current holder's name or held under a beneficial interest by the current recorded holder.	Date <i>June 13/1994</i>	Recorded Holder or Agent (Signature) <i>Fred Wigglesworth</i>
--	-----------------------------	--

Certification of Work Report

I certify that I have a personal knowledge of the facts set forth in this Work report, having performed the work or witnessed same during and/or after its completion and annexed report is true.		
Name and Address of Person Certifying <i>Fred Wigglesworth 42 Churchill Drive Kirkland Lake Ontario</i>		
Telephone No. <i>567-7936</i>	Date <i>June 13/1994</i>	Certified By (Signature) <i>Fred Wigglesworth</i>

For Office Use Only

Total Value Cr. Recorded <i>Applied #1240. Reserve \$749.</i>	Date Recorded <i>June 13/94</i>	Mining Recorder <i>[Signature]</i>	Received Stamp <i>MINING DIVISION JUN 13 11 11 50 RECEIVED</i>
	Deemed Approval Date <i>Sept 11/94</i>	Date Approved <i>July 7/94</i>	
	Date Notice for Amendments Sent		

Work Report Number for Applying Reserve	Claim Number (see Note 2)	Number of Claim Units
	L-981315	1
	L-982371	1
	L-982372	1
	L-1046145	1
	L-1046146	1
	L-1047147	1
	L-1047991	1
	L-1047992	1
Total Number of Claims		8

Value of Assessment Work Done on the Claim	Value Applied to this Claim
1,989.00	N/A
	1/20.00
	1/20.00
	1/20.00
	1/20.00
	1/20.00
	1/20.00
	1/20.00
Total Value Work Done	
1,989.00	1,240.00

Value Assigned from this Claim	Reserve: Work to be Claimed at a Future Date
1,240.00	749.00
Total Assigned From	
1,240.00	749.00

Credits you are claiming in this report may be cut back. In order to minimize the adverse effects of such deletions, please indicate from which claims you wish to prioritize the deletion of credits. Please mark (✓) one of the following:

- Credits are to be cut back starting with the claim listed last, working backwards.
- Credits are to be cut back equally over all claims contained in this report of work.
- Credits are to be cut back as prioritized on the attached appendix.

In the event that you have not specified your choice of priority, option one will be implemented.

Note 1: Examples of beneficial interest are unrecorded transfers, option agreements, memorandum of agreements, etc., with respect to the mining claims.

Note 2: If work has been performed on patented or leased land, please complete the following:

I certify that the recorded holder had a beneficial interest in the patented or leased land at the time the work was performed.	Signature	Date
---	-----------	------



Statement of Costs
for Assessment Credit

État des coûts aux fins
du crédit d'évaluation

Mining Act/Loi sur les mines

Transaction No./N° de transaction
DOCUMENT No.

W 9480 • 00365

Personal information collected on this form is obtained under the authority of the Mining Act. This information will be used to maintain a record and ongoing status of the mining claim(s). Questions about this collection should be directed to the Provincial Manager, Minings Lands, Ministry of Northern Development and Mines, 4th Floor, 159 Cedar Street, Sudbury, Ontario P3E 6A5, telephone (705) 670-7284.

Les renseignements personnels contenus dans la présente formule sont recueillis en vertu de la Loi sur les mines et serviront à tenir à jour un registre des concessions minières. Adresser toute question sur la collecte de ces renseignements au chef provincial des terrains miniers, ministère du Développement du Nord et des Mines, 159, rue Cedar, 4^e étage, Sudbury (Ontario) P3E 6A5, téléphone (705) 670-7284.

1. Direct Costs/Coûts directs

Type	Description	Amount Montant	Totals Total global
Wages Salaires	Labour Main-d'oeuvre	\$ 1,350	\$ 1,350.00
	Field Supervision Supervision sur le terrain		
Contractor's and Consultant's Fees Droits de l'entrepreneur et de l'expert- conseil	Type		
Supplies Used Fournitures utilisées	Type		
	Amax, caps.	\$ 42.00	\$ 42.00
	Fuse, gas	\$ 25.00	25.00
Equipment Rental Location de matériel	Type		
	Cobra Plugger	240.00	240.00
Total Direct Costs Total des coûts directs			\$ 1657.00

2. Indirect Costs/Coûts indirects

** Note: When claiming Rehabilitation work Indirect costs are not allowable as assessment work.
Pour le remboursement des travaux de réhabilitation, les coûts indirects ne sont pas admissibles en tant que travaux d'évaluation.

Type	Description	Amount Montant	Totals Total global
Transportation Transport	Type		
	Truck - Roy	\$ 108.00	\$ 108.00
	Truck - Fred	\$ 58.00	58.00
Food and Lodging Nourriture et hébergement	Camp Rent	\$ 100.00	108.00
	Food & fuel	\$ 100.00	100.00
Mobilization and Demobilization Mobilisation et démobilisation			

Sub Total of Indirect Costs
Total partiel des coûts indirects \$ 374.00

Amount Allowable (not greater than 20% of Direct Costs)
Montant admissible (n'excedant pas 20 % des coûts directs) \$ 332.00

Total Value of Assessment Credit
(Total of Direct and Allowable indirect costs) \$ 1989.00
Valeur totale du crédit d'évaluation (Total des coûts directs et indirects admissibles)

$1657.00 \times 20\% = 332.00$

$1657 + 332 = 1989$

Note: The recorded holder will be required to verify expenditures claimed in this statement of costs within 30 days of a request for verification. If verification is not made, the Minister may reject for assessment work all or part of the assessment work submitted.

Note: Le titulaire enregistré sera tenu de vérifier les dépenses demandées dans le présent état des coûts dans les 30 jours suivant une demande à cet effet. Si la vérification n'est pas effectuée, le ministre peut rejeter tout ou une partie des travaux d'évaluation présentés.

Filing Discounts

1. Work filed within two years of completion is claimed at 100% of the above Total Value of Assessment Credit.
2. Work filed three, four or five years after completion is claimed at 50% of the above Total Value of Assessment Credit. See calculations below:

Total Value of Assessment Credit	Total Assessment Claimed
	x 0.50 =

Remises pour dépôt

1. Les travaux déposés dans les deux ans suivant leur achèvement sont remboursés à 100 % de la valeur totale susmentionnée du crédit d'évaluation
2. Les travaux déposés trois, quatre ou cinq ans après leur achèvement sont remboursés à 50 % de la valeur totale du crédit d'évaluation susmentionné. Voir les calculs ci-dessous.

Valeur totale du crédit d'évaluation	Évaluation totale demandée
	x 0,50 =

Certification Verifying Statement of Costs

I hereby certify:
that the amounts shown are as accurate as possible and these costs were incurred while conducting assessment work on the lands shown on the accompanying Report of Work form.

that as Position in CHIMS I am authorized
(Recorded Holder, Agent, Position in Company)

to make this certification

Attestation de l'état des coûts

J'atteste par la présente :
que les montants indiqués sont le plus exact possible et que ce dépenses ont été engagées pour effectuer les travaux d'évaluation sur les terrains indiqués dans la formule de rapport de travail ci-join

Et qu'à titre de _____ je suis autorisé
(titulaire enregistré, représentant, poste occupé dans la compagnie)

à faire cette attestation.

Signature: Fred Wigglesworth Date: June 13/95

339

COOK 16

622.M

Guibord Twp.

Playfair Twp.

Barnet Twp.

Benoit Twp.

THE TOWNSHIP OF

COOK

DISTRICT OF COCHRANE

LARDER LAKE MINING DIVISION

SCALE: 1-INCH= 40 CHAINS

LEGEND

- PATENTED LAND (P)
- CROWN LAND SALE (S) or CS
- LEASES (L)
- LOCATED LAND (Loc)
- LICENSE OF OCCUPATION (L.O.)
- MINING RIGHTS ONLY (M.R.O.)
- SURFACE RIGHTS ONLY (S.R.O.)
- ROADS
- IMPROVED ROADS
- KING'S HIGHWAYS
- RAILWAYS
- POWER LINES
- MARSH OR MUSKEG
- MINES

NOTES

Area Withdrawn From Staking Under Mg. Act, 5 April 1951 Clause (d) Section 39

Gravel Reserve Shown Thus.

400' Surface rights reservation around all lakes & rivers

JUL 13 1994

Surface Rights Withdrawn under Sec. 36, The Mining Act R.S.O. 1980 ORDER NO. W-0190

(Trans Canada Pipeline Right of Way and Buffer Zone particularly 40.25 meters or 132 ft on either side of centre line of right of way)

NOTICE OF FORESTRY ACTIVITY

THIS TOWNSHIP / AREA FALLS WITHIN THE WATABEAG MANAGEMENT UNIT AND MAY BE SUBJECT TO FORESTRY OPERATIONS. THE MNR UNIT FORESTER FOR THIS AREA CAN BE CONTACTED AT: P.O. BOX 129 SWASTIKA, ONT. POK ITO 705-642-3222

PLAN NO.- M.339

ONTARIO
MINISTRY OF NATURAL RESOURCES
SURVEYS AND MAPPING BRANCH

VI

V

IV

III

II

I

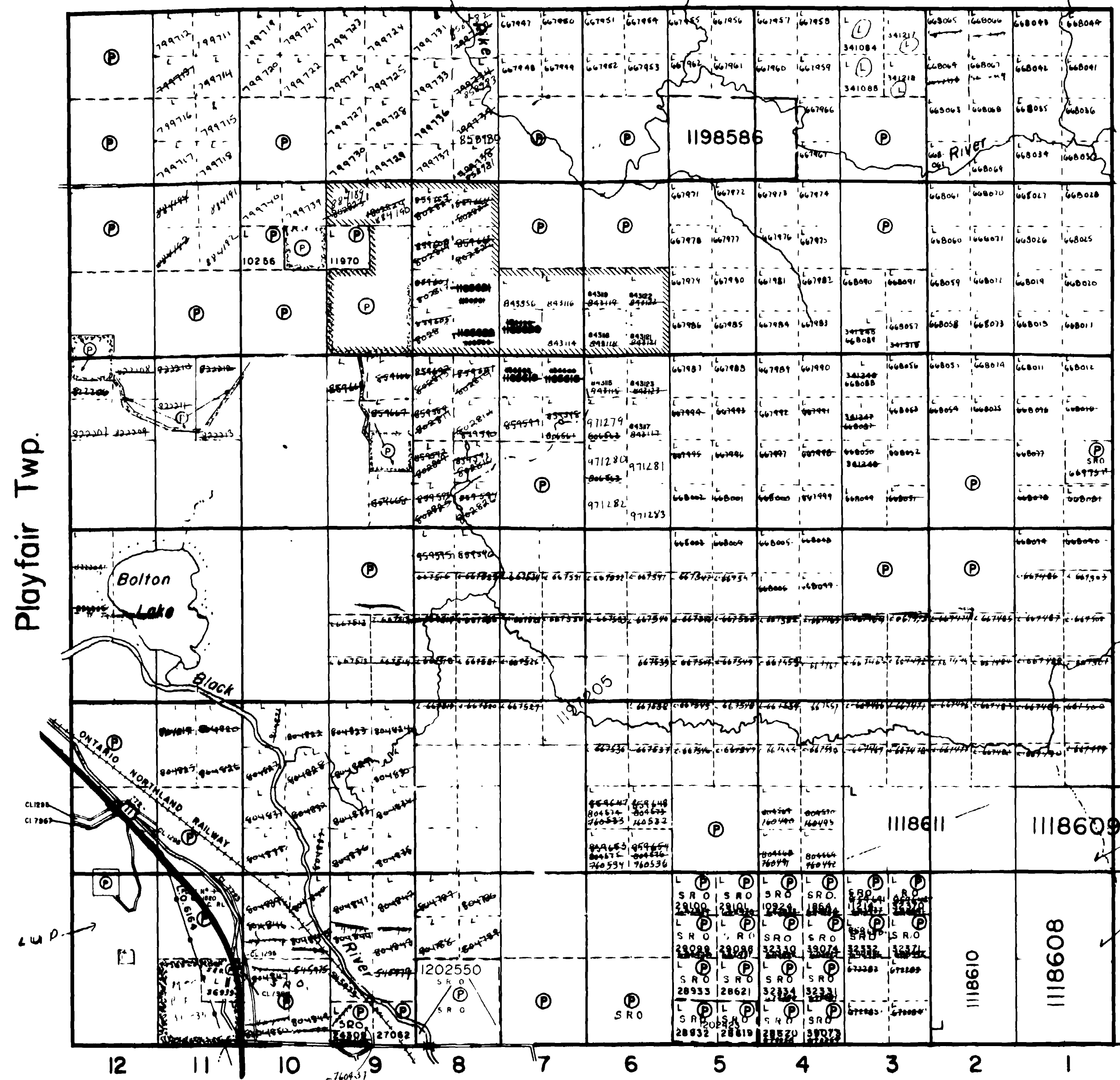

MUELROY TP

PACAUD TP

MARTER TP

VI

V

IV

III

II

I

0

SKEAD

T.E.S.

1:50,000 Scale
1:50,000 Scale

AREAS WITHDRAWN FROM DISPOSITION

- MRO MINING RIGHTS ONLY
- SRO SURFACE RIGHTS ONLY
- M+S MINING AND SURFACE RIGHTS

Description Order Date Disposition File

NOTICE OF FORESTRY ACTIVITY

THIS TOWNSHIP / AREA FALLS WITHIN THE TIMISKAMING MANAGEMENT UNIT AND MAY BE SUBJECT TO FORESTRY OPERATIONS. THE MNR UNIT FORESTER FOR THIS AREA CAN BE CONTACTED AT: P.O. BOX 129 SWASTIKA, ONT POK ITO 705-642-3222

LEGEND

- PATENTED LAND (P)
- PATENTED RIGHTS (R)
- MINING RIGHTS ONLY (MRO)
- SURFACE RIGHTS ONLY (SRO)
- CANCELLED (C)
- ROADS (R)
- TRAILS (T)
- RAILWAYS (R)
- POWER LINES (P)
- MARSH OR MUSKOG (M)
- MIR (M)

TOWNSHIP OF

CATHARINE

DISTRICT OF TIMISKAMING

LARDER LAKE MINING DIVISION

SCALE: 1 INCH = 100 METERS

DATE: 1990 03-3615



Ministry of Northern Development and Mines
Ministry of Northern Development and Mines

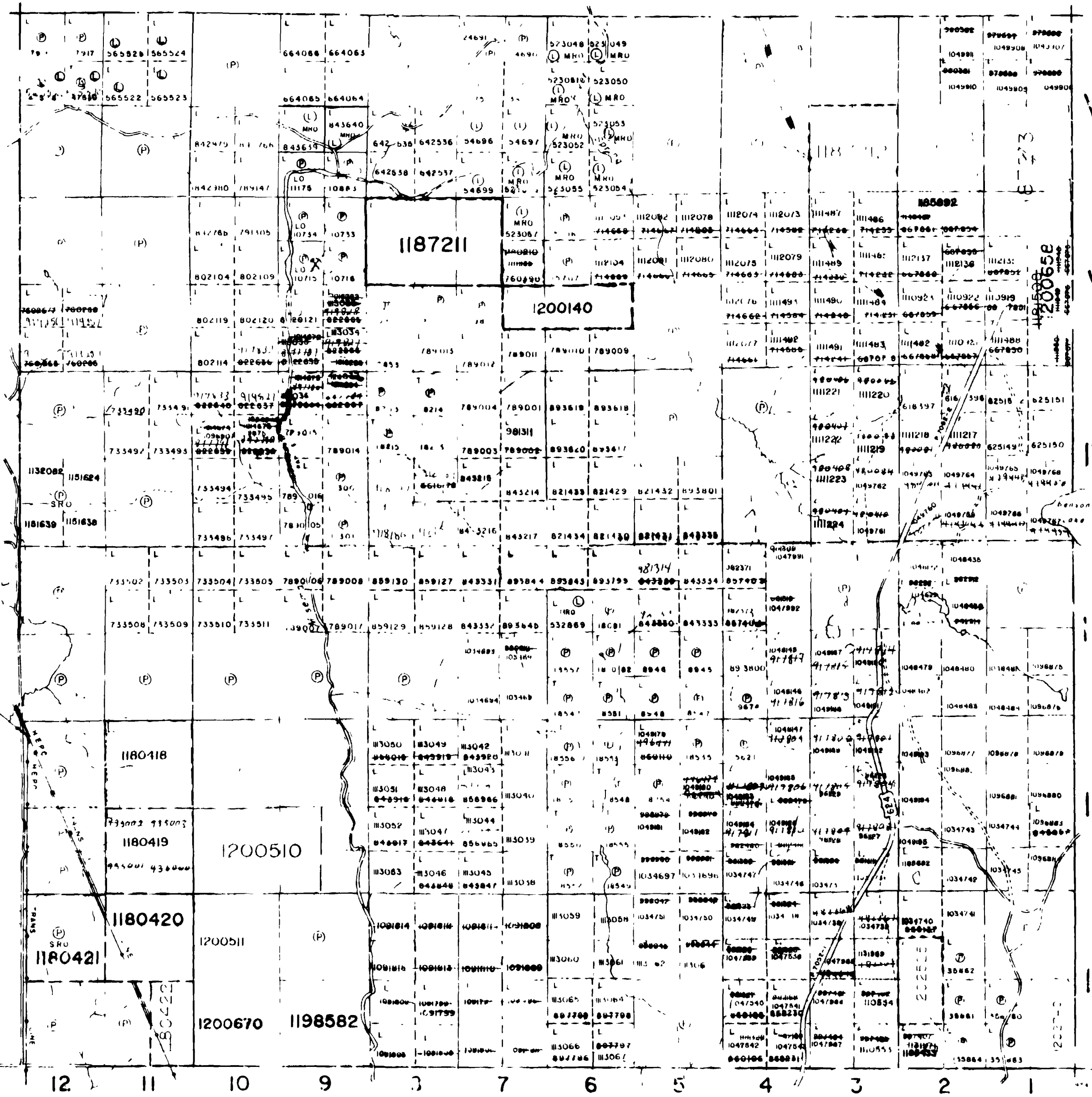

THE INFORMATION THAT APPEARS ON THIS MAP HAS BEEN COMPILED FROM VARIOUS SOURCES, AND ACCURACY IS NOT GUARANTEED THOSE WISHING TO STAKE MINING CLAIMS SHOULD CONSULT WITH THE MINING RECORDER, MINISTRY OF NORTHERN DEVELOPMENT AND MINES, FOR ADDITIONAL INFORMATION ON THE STATUS OF THE LANDS SHOWN HEREON.

COPY OF THIS MYLAR ARCHIVED NOV 12/91

ARCHIVED APR 21 1994



3200NW0110 W8480-00324 COOK