

32D05NW0151 2.11618 GARRISON

010

GEOCHEMICAL REPORT  
DDH LOGS

MIN-EN LABORATORIES LTD.

Specialists in Mineral Environments

705 West 15th Street North Vancouver, B.C. Canada V7M 1T2

PHONE: (604)980-5814 OR (604)988-4524

TELEX: VIA USA 7601067 UC

Certificate of GEOCHEM

Company: DURHAM GEOLOGICAL

File: B2-18/P1

Project: D-42

Date: JAN 13/88

Attention: R. MAASS

Type: ROCK GEOCHEM

We hereby certify the following results for samples submitted.

Sample Number	AU-FIRE PPB
9101	17
9102	3
9103	6
9104	4
9105	4
9106	3
9107	5
9108	2
9109	3
9110	6
9111	1
9112	22
9113	3
9114	5
9115	13
9116	49
9117	3
9118	97
9119	21
9120	3350
9121	1090
9122	1000

Certified by

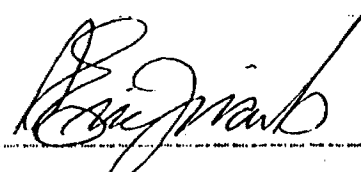

MIN-EN LABORATORIES LTD.

MIN-EN LABORATORIES LTD.

Specialists in Mineral Environments

705 West 15th Street North Vancouver, B.C. Canada V7M 1T2

PHONE: (604) 980-5814 OR (604) 988-4524

TELEX: VIA USA 7601067 UC

Certificate of ASSAY

Company: DURHAM GEOLOGICAL  
Project: D-42  
Attention: R. MAASS

File: 82-18/P1  
Date: JAN 14/88  
Type: ROCK ASSAY

We hereby certify the following results for samples submitted.

Sample Number	AU G/TONNE	AU OZ/TON
9120	3.80	0.111
9121	1.18	0.034
9122	1.06	0.031

Certified by 

MIN-EN LABORATORIES LTD.

**MIN-EN LABORATORIES LTD.**

*Specialists in Mineral Environments*

705 West 15th Street North Vancouver, B.C. Canada V7M 1T2

PHONE: (604)980-5814 OR (604)988-4524

TELEX: VIA USA 7601067 UC

Certificate of GEOCHEM

Company: DURHAM GEOLOGICAL  
Project: D-42  
Attention: R. MAASS

File: 82-19/P1  
Date: JAN 14/88  
Type: ROCK GEOCHEM

We hereby certify the following results for samples submitted.

Sample Number	AU-FIRE PPR
9123	580
9124	49
9125	6
9126	10
9127	13
9128	7
9129	6
9130	4
9131	12
9132	8
9133	59
9134	6
9135	295
9136	1500
9137	37
9138	11
9139	5
9140	175
9141	240
9142	9
9143	4
9144	13
9145	10
9146	8
9147	5
9148	4
9149	27
9150	345
9151	2850
9152	12000

Certified by



MIN-EN LABORATORIES LTD.

**MIN-EN LABORATORIES LTD.**

*Specialists in Mineral Environments*

705 West 15th Street North Vancouver, B.C. Canada V7M 1T2

PHONE: (604)980-5814 OR (604)988-4524

TELEX: VIA USA 7601067 UC

**Certificate of ASSAY**

Company: DURHAM GEOLOGICAL

Project: D-42

Attention: R. MAASS

File: 82-19/P1

Date: JAN 14/88

Type: ROCK ASSAY

We hereby certify the following results for samples submitted.

Sample Number	AU G/TONNE	AU OZ/TON
9136	1.80	0.053
9151	2.97	0.087
9152	13.40	0.391

Certified by

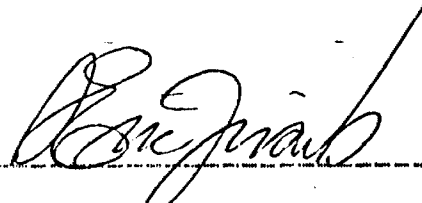

MIN-EN LABORATORIES LTD.

MIN-EN LABORATORIES LTD.

Specialists in Mineral Environments

705 West 15th Street North Vancouver, B.C. Canada V7M 1T2

PHONE: (604)980-5814 OR (604)988-4524

TELEX: VIA USA 7601067 UC

Certificate of GEOCHEM

Company: DURHAM GEOLOGICAL

Project: D-42

Attention: R. MAASS

File: 82-19/P2

Date: JAN 14/88

Type: ROCK GEOCHEM

We hereby certify the following results for samples submitted.

Sample Number	AU-FIRE PPB
9153	131

Certified by



MIN-EN LABORATORIES LTD.

**MIN-EN LABORATORIES LTD.**

*Specialists in Mineral Environments*

705 West 15th Street North Vancouver, B.C. Canada V7M 1T2

PHONE: (604) 980-5814 DR (604) 988-4524

TELEX: VIA USA 7601067 UC

**Certificate of GEOCHEM**

Company: DURHAM GEOLOGICAL  
Project: D-42  
Attention: R. MAASS

File: 82-27/P1  
Date: JAN 14/88  
Type: ROCK GEOCHEM

We hereby certify the following results for samples submitted.

Sample Number	AL-FIRE PPB
9154	435
9155	52
9156	143
9157	260
9158	104
9159	4000
9160	148
9161	7
9162	15
9163	4
9164	4
9165	2
9166	6

Certified by

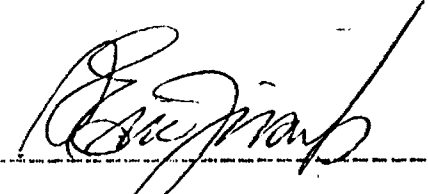

MIN-EN LABORATORIES LTD.

**MIN-EN LABORATORIES LTD.**

*Specialists in Mineral Environments*

705 West 15th Street North Vancouver, B.C. Canada V7M 1T2

PHONE: (604)980-5814 OR (604)988-4524

TELEX: VIA USA 7601067 UC

Certificate of ASSAY

Company: DURHAM GEOLOGICAL

Project: D-42

Attention: R. MAABS

File: 82-27/P1

Date: JAN 14/88

Type: ROCK ASSAY

We hereby certify the following results for samples submitted.

Sample Number	AU G/TONNE	AU OZ/TON
9159	4.78	0.139

Certified by \_\_\_\_\_



MIN-EN LABORATORIES LTD.



MIN-EN LABORATORIES LTD.

Specialists in Mineral Environments

705 West 15th Street North Vancouver, B.C. Canada V7M 1T2

PHONE: (604)980-5814 OR (604)988-4524

TELEX: VIA USA 7601067 UC

Certificate of GEOCHEM

Company: DURHAM GEOLOGICAL  
Project: D-42  
Attention: R. MAASS

File: B2-34/P1  
Date: JAN 15/88  
Type: ROCK GEOCHEM

We hereby certify the following results for samples submitted.

Sample Number	AU-FIRE PFB
9167	3
9168	34
9169	2
9170	5
9171	3
9172	6
9173	2
9174	15
9175	38
9176	3
9177	10
9178	9
9179	4
9180	3
9181	4
9182	2
9183	20
9184	13
9185	5
9186	3
9187	2
9188	4
9189	3
9190	4
9191	2

Certified by



MIN-EN LABORATORIES LTD.

**MIN-EN LABORATORIES LTD.**

*Specialists in Mineral Environments*

705 West 15th Street North Vancouver, B.C. Canada V7M 1T2

PHONE: (604) 980-5814 OR (604) 988-4524

TELEX: VIA USA 7601067 UC

**Certificate of GEOCHEM**

Company: DURHAM GEOLOGICAL

Project: D-42

Attention: RANDY MAASS

File: B2-40/P1

Date: JAN 16/88

Type: ROCK GEOCHEM

We hereby certify the following results for samples submitted.

Sample Number	AU-FIRE PPB
9192	17
9193	8
9194	3
9195	2
9196	6
9197	4
9198	25
9199	9
9200	7

Certified by



MIN-EN LABORATORIES LTD.

**MIN-EN LABORATORIES LTD.**

Specialists in Mineral Environments

705 West 15th Street North Vancouver, B.C. Canada V7M 1T2

PHONE: (604) 980-5814 OR (604) 988-4524

TELEX: VIA USA 7601067 UC

Certificate of Geochem

Company: DURHAM GEOLOGICAL  
Project: D-42  
Attention: R. MAASS

File: 82-42/P1  
Date: JAN 17/88  
Type: ROCK GEOCHEM

We hereby certify the following results for samples submitted.

Sample Number	AU-FIRE FPB
301	2
302	3
303	2
304	1
305	2
306	1
307	3
308	2
309	3
310	3
311	2
312	5
313	2
314	18 MRG-87-1
315	3 MRG-87-2
316	2
317	3
318	2
319	3
320	2
321	20
322	264

Certified by

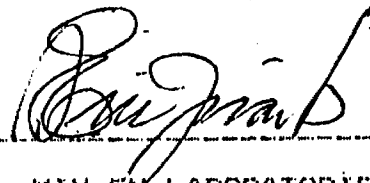

MIN-EN LABORATORIES LTD.

**MIN-EN LABORATORIES LTD.**

*Specialists in Mineral Environments*

705 West 15th Street North Vancouver, B.C. Canada V7M 1T2

PHONE: (604) 980-5814 DR (604) 988-4524

TELEX: VIA USA 7601067 UC

**Certificate of GEOCHEM**

Company: DURHAM GEOLOGICAL

Project: D-42

Attention: R. MAASS

File: B2-56/P1

Date: JAN 18/88

Type: ROCK GEOCHEM

We hereby certify the following results for samples submitted.

Sample Number	AU-FIRE PPM
323	61
324	9
325	6
326	24
327	8
328	88
329	65
330	104
331	13
332	9
333	6
334	40
335	7
336	58
337	5
338	3
339	8
340	8
341	6

Certified by



MIN-EN LABORATORIES LTD.

MIN-EN LABORATORIES LTD.

Specialists in Mineral Environments

705 West 15th Street North Vancouver, B.C. Canada V7M 1T2

PHONE: (604) 980-5814 OR (604) 988-4524

TELEX: VIA USA 7601067 UC

Certificate of GEOCHEM

Company: DURHAM GEOLOGICAL  
Project: D-42  
Attention: R. MAASS

File: B2-74/P1  
Date: JAN 22/88  
Type: ROCK GEOCHEM

We hereby certify the following results for samples submitted.

Sample Number	AU-FIRE PPB
0342	1
0343	3
0344	2
0345	14
0346	8
0347	6
0348	5
0349	4
0350	3
0351	3
0352	9
0353	2
0354	36
0355	3
0356	109
0357	124
0358	165
0359	133
0360	33
0361	8
0362	53
0363	12
0364	149
0365	87
0366	166

Certified by

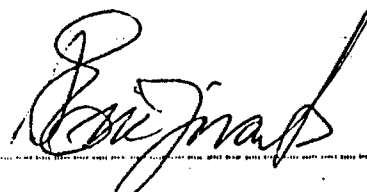

MIN-EN LABORATORIES LTD.

**MIN-EN LABORATORIES LTD.**

*Specialists in Mineral Environments*

705 West 15th Street North Vancouver, B.C. Canada V7M 1T2

PHONE: (604) 980-5814 OR (604) 988-4524

TELEX VIA USA 7601067 UC

Certificate of GEOCHEM

Company: DURHAM GEOLOGICAL  
 Project: D-42  
 Attention: R. MAABB

File: 02-85/P1  
 Date: JAN 23/88  
 Type: ROCK GEOCHEM

We hereby certify the following results for samples submitted.

Sample Number	AU-FIRE FPB
0367	17
0368	45
0369	10
0370	30
0371	19
0372	5
0373	6
0374	7
0375	5
0376	2
0377	46
0378	4
0379	5
0380	2
0381	1
0382	2
0383	1
0384	2
0385	1
0386	25
0387	1

Certified by

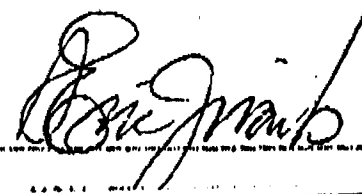

**MIN-EN LABORATORIES LTD.**  
*Specialists in Mineral Environments*  
 705 West 15th Street North Vancouver, B.C. Canada V7M 3T2

PHONE: (604) 980-5814 OR (604) 988-4524

TELEX: VIA USA 7601067 UC

Certificate of GEOCHEM

Company: DURHAM GEOLOGICAL  
 Project: D-42  
 Attention: R. MAASS

File: 82-96/P1  
 Date: JAN 23/88  
 Type: ROCK GEOCHEM

We hereby certify the following results for samples submitted.

Sample Number	AU-FIRE PPR
0388	1
0389	48
0390	10
0391	6
0392	1
0393	2
0394	3
0395	8
0396	1
0397	1
0398	8
0399	1
0400	2
0040	153
0041	5
0042	1
0043	2
0044	1

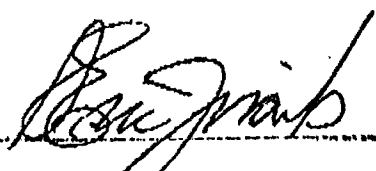
Certified by 

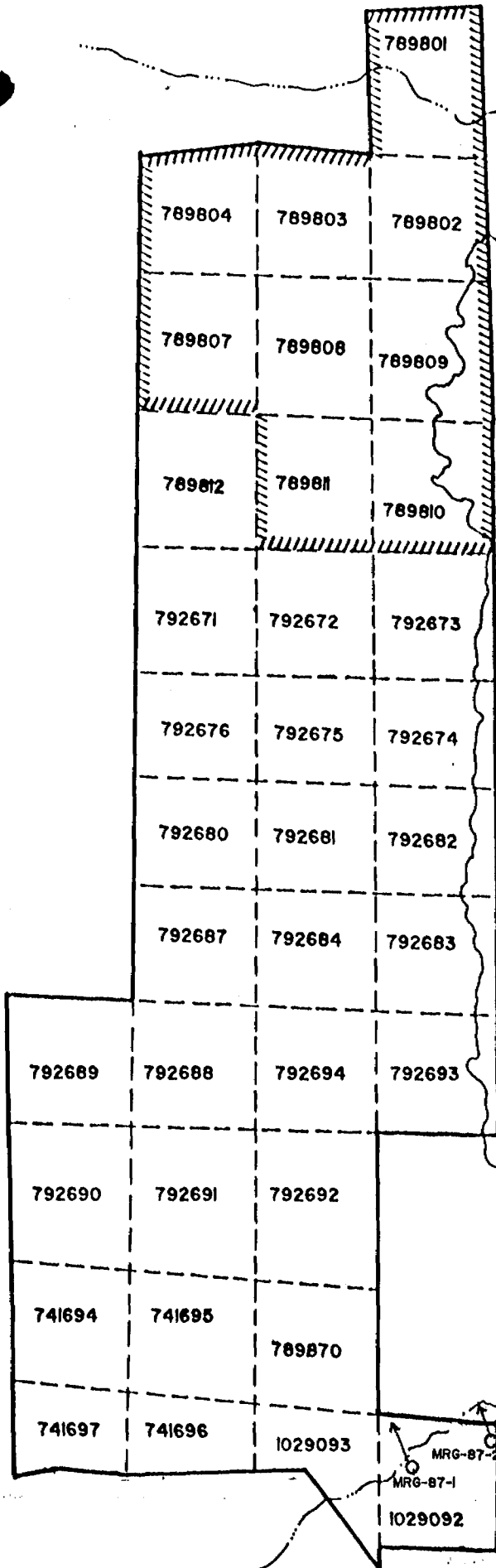

 Disputed claims

<b>REVISIONS</b>	<b>DURHAM GEOLOGICAL SERVICES INC.</b>		
	<i>For:</i> <b>Meridor Resources Ltd.</b>		
	<i>Title:</i> <b>Diamond Drill Hole Location Map Garrison Township</b>		
	<i>Date:</i> Feb. 1988	<i>Drawn:</i> C.G.	<i>Scale:</i> 1"=1/2mile
	<i>NTS:</i>	<i>Approved:</i>	<i>Pg.:</i>



DURHAM GEOLOGICAL SERVICES INC.  
Box 734  
TIMMINS, ONTARIO  
P4N 7G2

DIAMOND DRILL HOLE LOG

PROJECT: Meridor Resources Limited

AREA: Garrison Township

CLAIM NUMBER: 1029092

CORE SIZE: BQ

DRILLED BY: Norex Drilling

LOGGED BY: Randy D. Maass

CORE STORED AT Durham Geological  
Warehouse, Timmins

OBJECTIVE: Airborne Mag. Low

HOLE NUMBER: MRG-87-2

LOCATION: SE Corner of Property

AZIMUTH: 335°

DIP: -45°

DATE: December 1987

CASING: 22.0'

LENGTH: 1201.5'

ACID TEST	Depth	Dip
	0.0	45°
	400.0	44°
	1201.5	41°

DIAMOND DRILL HOLE LOG

Footage		ROCK TYPE AND DESCRIPTION	Core Angle to Axis	% Sulphides	SAMPLE			Analytical Result	
From	To				Number	From	To	Length	
0.0	22.0	Overburden, Boulders, Casing		1-2%	0315				
		Massive Mafic Volcanics			0316				
		-fine grain, massive, non-foliated			0317				
		-hard, silicified and not easily scratched			0318				
		-dark grey color with minor light green veinlets of epidote			0319				
		-hematite-filled fractures			0320				
		-coarse pyrite							
		47.0-47.5 Fault Breccia							
47.5	51.5	Bleached, Altered Mafic Volcanics		2-3%	0321				
		-not pervasive alteration							
		-unaltered sections are dark grey in color with altered areas light grey-brown in color-2-3% fine pyrite							
		-hard, silicified and not easily scratched							
		-fine grain, massive, not foliated							
51.5	56.5	Massive Mafic Volcanics							











- DIAMOND DRILL HOLE LOG

Footage		ROCK TYPE AND DESCRIPTION	Core Angle to Axis	% Sulphides	SAMPLE			Analytical Result		
From	To				Number	From	To	Length		
396.7	402.0	Altered Mafic Volcanics								
		-pink-orange color composed of dark green chloritic								
		and quartz								
		-numerous quartz and quartz-carbonate veinlets-								
		-minor fine pyrite								
		401-402 Fault Breccia Zone								
		-dark green chloritic matrix with orange angular								
		siliceous fragments								
402.0	668.0	Massive Mafic Volcanics			0371					
		-dark green color with veins of light green epidote			0372					
		red hematite and white quartz-carbonate-fine pyrite			0373					
		associated with veining			0374					
		-fine to medium grain size			0375					
		-non-foliated-hard, siliceous and not easily			0376					
		scratched			0377					
		-fine-medium grain size			0378					
		466.8-466.9 Fault Breccia Zone			0379					
					0380					
					0381					



DIAMOND DRILL HOLE LOG

Footage		ROCK TYPE AND DESCRIPTION	Core Angle to Axis	% Sulphides	SAMPLE			Analytical Result	
From	To				Number	From	To	Length	
668.0	1068.0	Greywacke/Argillite	70°	1-2%					
		-light to dark grey in color with the occasional							
		veinlet of quartz or quartz-carbonate							
		-fine grain with medium grain sections							
		-narrow yellow-green sericite altered							
		sections-soft and easily scratched							
		-well banded with alternating medium and fine							
		grain sediments							
		691.3 -692.6 sediments							
		-with numerous carbonate stringers giving the							
		rock a pseudo-brecciated texture							
		719.5-723.7 Silicified Sericite-Altered Sediments			0382				
		-quartz veinlets containing 1% fine pyrite							
		750.0-753.0 Graphitic Sediments			0383				
		783.6-796.0 Sediments			0384				
		-with several sericite-altered sections			0385				
		and quartz veining 1-2% fine pyrite			0386				
		931.0-952.0 Silicified Sediments			0387				
		-quartz-carbonate veins and sericite-altered							
		sections							



DIAMOND DRILL HOLE LOG

Footage		ROCK TYPE AND DESCRIPTION	Core Angle to Axis	% Sul-phides	SAMPLE			Analytical Result	
From	To				Number	From	To	Length	
1164.2	1186.9	Epidote-Altered Mafic Volcanics			041				
		-volcanics have been altered							
		by light green epidote, pink feldspar							
		and transparent quartz							
1186.9	1194.0	Porphyritic Mafic Volcanics							
1194.0	1201.5	Mafic Volcanics			042				
		-with quartz-carbonate, chlorite, feldspar,			043				
		epidote veinlets and stringers-several broken			044				
		and brecciated sections							
		1197.5-1201.5 Silicified Mafic Volcanics	1-2%						
		1-2% fine pyrite							
	1201.5	End of Hole							
		<i>Logged by Randy D Noosa</i>							

SENT BY: LARDER LK MINING RECDR; 9-15-88 2:13PM ;



32D05NW0151 2.11618 GARRISON

900

Department of Northern Development and Mines  
 REPORT OF WORK  
 (Geophysical, Geological, Geochemical and Expenditures)  
 DO W

Mining Act

"Expenditures" section may be entered in the "Expend. Days Cr." columns. - Do not use shaded areas below.

Type of Survey(s): **Geochemical Analysis** Township or Area: **Garrison**  
 Claim Holder(s): **H. L. Mineral Holdings Ltd** **2.11618** Prospector's Licence No.: **T-4645**  
 Address: **1900-999 West Hastings Street, Vancouver, B.C.**  
 Survey Company: **Min-En Labs** Date of Survey (from & to):  
 Name and Address of Author (of Geo-Technical report):

Credits Requested per Each Claim in Columns at right

Special Provisions	Geophysical	Days per Claim
For first survey: Enter 40 days. (This includes line cutting)	Electromagnetic	
	Magnetometer	
For each additional survey: using the same grid: Enter 20 days (for each)	Radiometric	
	Other	
	Geological	
	Geochemical	
Man Days Complete reverse side and enter total(s) here	Geophysical	Days per Claim
	Electromagnetic	
	Magnetometer	
	Radiometric	
	Other	
	Geological	
	Geochemical	
Airborne Credits Note: Special provisions credits do not apply to Airborne Surveys.	Electromagnetic	Days per Claim
	Magnetometer	
	Radiometric	

Mining Claims Traversed (List in numerical sequence)

Mining Claim			Mining Claim		
Prefix	Number	Expend. Days Cr.	Prefix	Number	Expend. Days Cr.
L	789807	63.5			
	789808	80.0			
	789809	80.0			
	789810	8.5			

LARDER LAKE MINING DIV.  
**RECEIVED**  
 JUN 30 1988  
 AM 7 18 (9) 10 11 12 1 2 3 4 5 16 PM

**RECORDED**  
 JUN 30 1988  
 Receipt #

Expenditures (excludes power stripping)

Type of Work Performed: **Assaying Drill Core (Section 77-19)**  
 Performed on Claim(s): **L 789805, L 789806, L 789813**  
 Calculation of Expenditure Days Credits  
 Total Expenditures: **\$ 3494.50** + **16** = **232** Total Days Credits  
 Instructions: Total Days Credits may be apportioned at the claim holder's choice. Enter number of days credits per claim selected in columns at right.

*Airborne credits allowed.*

Total number of mining claims covered by this report of work: **4**

For Office Use Only  
 Total Days Cr. Recorded: **173** Date Recorded: **June 30/88** Mining Recorder: **Blair Hite**  
 Date Approved as Recorded: **2 Nov 88** Branch Director: **[Signature]**  
 R.M.

Date: **June 22/88** Recorded Holder or Agent (Signature): **Randy Maass**

Certification Verifying Report of Work  
 I hereby certify that I have a personal and intimate knowledge of the facts set forth in the Report of Work annexed hereto, having performed the work or witnessed same during and/or after its completion and the annexed report is true.  
 Name and Postal Address of Person Certifying: **Randy Maass c/o Durham Geological Services Inc.**  
 Date Certified: **June 22/88** Certified by (Signature): **Randy Maass**  
 P. O. Box 734, Timmins, Ont. P4N 7G2



Ministry of Northern Development and Mines

Report of Work

(Geophysical, Geological, Geochemical and Expenditures)

DOCUMENT No. W8808-353 Mining Act

Instructions: - Please type or print. - If number of mining claims traversed exceeds space on this form, attach a list. Note: - Only days credits calculated in the "Expenditures" section may be entered in the "Expend. Days Cr." columns. - Do not use shaded areas below.

Form header containing: Type of Survey(s) Credit From Assaying Drill Core, Claim Holder(s) H. L. Mineral Holdings Limited, Address 1900-999 West Hastings Street, Vancouver, B.C. V6C 2W2, Survey Company, Date of Survey, Total Miles of line Cut, Name and Address of Author.

Credits Requested per Each Claim in Columns at right

Table with 3 columns: Special Provisions, Geophysical, Geological, Geochemical, and Days per Claim. Includes rows for first survey, additional surveys, man days, and airborne credits.

Mining Claims Traversed (List in numerical sequence)

Table with 4 columns: Mining Claim Prefix, Mining Claim Number, Expend. Days Cr., and Mining Claim Number. Includes handwritten entries for claims 792681, 795528, and 792686.

Expenditures (excludes power stripping)

Type of Work Performed Credit from Assaying Drill Core

Performed on Claim(s) L 789805, L789806, L 789813

Calculation of Expenditure Days Credits: Total Expenditures \$ + 15 = Total Days Credits

Instructions: Total Days Credits may be apportioned at the claim holder's choice. Enter number of days credits per claim selected in columns at right.

Date Aug. 5, 1988 Recorded Holder or Agent (Signature) Randy Moss

For Office Use Only: Total Days Cr. Recorded, Date Recorded Aug 8, 1988, Mining Recorder M. G. Williams, Date Approved Recorded, Signed Director allow.

Certification Verifying Report of Work

I hereby certify that I have a personal and intimate knowledge of the facts set forth in the Report of Work annexed hereto, having performed the work or witnessed same during and/or after its completion and the annexed report is true.

Name and Postal Address of Person Certifying

60/87

Instructions - Supply required data on a separate form for each type of work to be recorded (see table below).  
- For Geo-technical work use form no. 1362 "Report of Work (Geological, Geophysical, Geochemical and Expenditures)".

Official interest to Don McKinnon

Name and Address of Recorded Holder: Lloyd Roberts 20892, Randall Salo M21107 Mark Mills M21297 Marc Lefort M20976  
+ Sa Larry Salo M20010 - All addresses General Delivery Connaught.  
Prospector's Licence No. M20976

Summary of Work Performance and Distribution of Credits

Total Work Days Cr. claimed	Mining Claim			Work Days Cr.	Mining Claim			Work Days Cr.	Mining Claim			Work Days Cr.
	Prefix	Number			Prefix	Number			Prefix	Number		
3586 / 3386	See attached list.											
<input type="checkbox"/> Manual Work <input type="checkbox"/> Shaft Sinking Drifting or other Lateral Work. <input type="checkbox"/> Compressed Air, other Power driven or mechanical equip. <input type="checkbox"/> Power Stripping <input checked="" type="checkbox"/> Diamond or other Core drilling <input type="checkbox"/> Land Survey												

All the work was performed on Mining Claim(s): L789805 L789806, L789813

Required Information eg: type of equipment, Names, Addresses, etc. (See Table Below)

Contractor NOBEX DRILLING LTD. PERCAPINE ONT.

DATES OF DRILLING: Dec 4/86 - Jan 19/87

Hole No: CS86-5 250 L789813  
 CS86-6 250 L789813  
 CS86-7A 944 L789805  
 CS87-8 642 L789805  
 CS87-9 800 L789805  
 CS87-10 800 L789805

Inst rec'd Feb 6/87

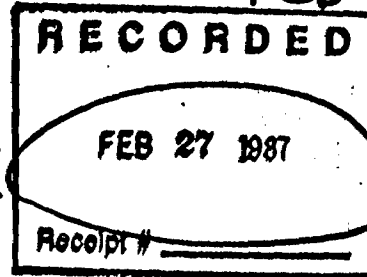
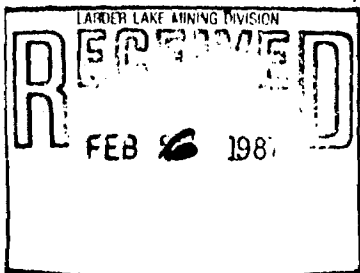

Total 3686 - 300 - Cr. for future use  
3386

Date of Report: Feb 27/87  
Recorded Holder or Agent (Signature): R Bruce Durham

Certification Verifying Report of Work

I hereby certify that I have a personal and intimate knowledge of the facts set forth in the Report of Work annexed hereto, having performed the work or witnessed same during and/or after its completion and the annexed report is true.

Name and Postal Address of Person Certifying

R BRUCE DURHAM

Box 734 TIMMINS ONT P4N7G2 Date Certified: Feb 27/87 Certified by (Signature): R Bruce Durham

Table of Information/Attachments Required by the Mining Recorder

Type of Work	Specific Information per type	Other Information (Common to 2 or more types)	Attachments
Manual Work	Nil	Names and addresses of men who performed manual work/operated equipment, together with dates and hours of employment.	Work Sketch: these are required to show the location and extent of work in relation to the nearest claim post.
Shaft Sinking, Drifting or other Lateral Work			
Compressed air, other power driven or mechanical equip.	Type of equipment	Names and addresses of owner or operator together with dates when drilling/stripping	
Power Stripping	Type of equipment and amount expended. Note: Proof of actual cost must be submitted within 30 days of recording.		

**DURHAM GEOLOGICAL SERVICES INC.**

1176 DELNITE ROAD, P.O. BOX 734  
TIMMINS, ONTARIO P4N 7G2

REFERENCE
3512B, 3511B, 3465B, 3462B, 3456B
3458B, 3423B, 3561B, 3419B, 3367B
3365B, 3543B

0540

PAY five thousand five hundred thirty-three 70/100 DOLLARS

DATE	CHEQUE NUMBER	TO THE ORDER OF	DESCRIPTION	CHEQUE AMOUNT
April 27	540	Min En Laboratoires		5533.70

705 West 15th Street  
Vancouver, B.C. V7M 1T2

DURHAM GEOLOGICAL SERVICES INC.

CONTINENTAL BANK OF CANADA  
190 Third Avenue, Timmins, Ontario P4N 1C3

PER \_\_\_\_\_

⑈000540⑈ ⑆66542⑈026⑆ 300⑈419⑈ ⑈0000553370⑈

14986

100-0997  
MONTREAL  
950

MIN-EN LABORATORIES LTD.

705 W. 15th St.  
North Vancouver, B.C.

Phone: 980-5814

AMCOVER REGIONAL  
DATA CENTRE

ANK OF MONTREAL

MR BT 30

MR BT 30

34



INVOICE

MIN-EN LABORATORIES LTD.  
705 WEST 15TH STREET  
NORTH VANCOUVER, B.C.  
CANADA V7M 1T2

INVOICE No 3563B

DATE: EB 11/87

PHONE: (604) 980-5814 OR 988-4524  
TELEX: 04-352828

TO : DURHAM GEOLOGICAL SERVICES  
BOX 734,  
TIMMINS, ONT.

FILE No: 72-119  
PROJECT:

*Cream Silver  
Garrison Township*

ATTENTION B. DURHAM/R. MAASS

QTY DESCRIPTION	UNIT PRICE	AMOUNT
50 ROCK GEOCHEM - MD. AS. FIRE AU	12.00	600.00
50 ROCK SAMPLE PREP	2.50	125.00
* TOTAL		725.00

*D-4 Total 3,494.50*

THESE ARE PROFESSIONAL SERVICES AND ARE PAYABLE WHEN RENDERED.  
OVER 30 DAYS 2% INTEREST PER MONTH WILL BE CHARGED.

# INVOICE

MINON LABORATORIES LTD.  
705 WEST 15TH STREET  
NORTH VANCOUVER, B.C.  
CANADA V7M 1T2

INVOICE No 3423B

DATE: JAN 29/87

PHONE: (604) 980-5814 OR 988-4524  
TELEX: 04-352828

TO : DURHAM GEOLOGICAL SERVICES  
BOX 734,  
TIMMINS, ONT.

FILE No: 72-057

PROJECT: GARRISON TWP.  
CREAM SILVER

ATTENTION B. DURHAM/R. MAASS

QTY DESCRIPTION	UNIT PRICE	AMOUNT
32 GEOCHEM - AS NO AU-FIRE	12.00	384.00
32 GEOCHEM SAMPLE PREP	2.50	80.00
* TOTAL		464.00

THESE ARE PROFESSIONAL SERVICES AND ARE PAYABLE WHEN RENDERED.  
OVER 30 DAYS 2% INTEREST PER MONTH WILL BE CHARGED.

INVOICE

MIN-EN LABORATORIES LTD.  
705 WEST 15TH STREET  
NORTH VANCOUVER, B.C.  
CANADA V7M 1T2

INVOICE No 3458B

DATE: FEB 3/87

PHONE: (604) 980-5814 OR 988-4524  
TELEX: 04-352828

TO : DURHAM GEOLOGICAL SERVICES  
BOX 734,  
TIMMINS, ONT.

FILE No: 72-071

PROJECT: CREAM SILVER  
GARRISON TOWNSHIP

ATTENTION B. DURHAM/R. MASS

QTY DESCRIPTION	UNIT PRICE	AMOUNT
27 ROCK GEOCHEM - MO, AS, FIRE AU	12.00	324.00
27 ROCK SAMPLE PREP	2.50	67.50
* TOTAL		391.50

THESE ARE PROFESSIONAL SERVICES AND ARE PAYABLE WHEN RENDERED.  
OVER 30 DAYS 2% INTEREST PER MONTH WILL BE CHARGED.

INVOICE

MINER LABORATORIES LTD.  
705 WEST 15TH STREET  
NORTH VANCOUVER, B.C.  
CANADA V7M 1T2

INVOICE No 3450B

DATE: JAN 31/87

PHONE: (604) 980-5814 OR 988-4524  
TELEX: 04-352878

TO : DURHAM GEOLOGICAL SERVICES  
BOX 734,  
TIMMINS, ONT.

FILE No: 72-063  
PROJECT:

CREAM SILVER  
GARRISON TWP.

ATTENTION: B. DURHAM/R. HAAS

QTY DESCRIPTION	UNIT PRICE	AMOUNT
27 GEOCHEM - AS NO AU FIRE	12.00	324.00
27 GEOCHEM SAMPLE PREP	2.50	67.50
* TOTAL		391.50

THESE ARE PROFESSIONAL SERVICES AND ARE PAYABLE WHEN RENDERED.  
LATER 30 DAYS 2% INTEREST PER MONTH WILL BE CHARGED.

INVOICE

MIN-EN LABORATORIES LTD.  
705 WEST 15TH STREET  
NORTH VANCOUVER, B.C.  
CANADA V7M 1T2

INVOICE No 3465B

DATE: FEB 3/87

PHONE: (604) 980-5814 OR 988-4524  
TELEX: 04-352828

TO : DURHAM GEOLOGICAL SERVICES  
BOX 734,  
TIMMINS, ONT.

FILE No: 72-074  
PROJECT: CREAM SILVER  
GARRISON TOWNSH

ATTENTION B. DURHAM/R. MAASS

QTY DESCRIPTION	UNIT PRICE	AMOUNT
22 GEOCHEM - AS MD AU-FIRE	12.00	264.00
22 GEOCHEM SAMPLE PREP	2.50	55.00
* TOTAL		319.00

THESE ARE PROFESSIONAL SERVICES AND ARE PAYABLE WHEN RENDERED.  
OVER 30 DAYS 2% INTEREST PER MONTH WILL BE CHARGED.

INVOICE

MIN-EN LABORATORIES LTD.  
705 WEST 15TH STREET  
NORTH VANCOUVER, B.C.  
CANADA V7M 1T2

INVOICE No 3511B

DATE: FEB 6/87

PHONE: (604) 980-5814 OR 988-4524  
TELEX: 04-352828

=====

TO : DURHAM GEOLOGICAL SERVICES  
BOX 734,  
TIMMINS, ONT.

FILE No: 72-091  
PROJECT: CREAM SILVER  
GARRISON TWP.

ATTENTION B. DURHAM/R. MAASS

=====

QTY DESCRIPTION	UNIT PRICE	AMOUNT
55 GEOCHEM - MO AS AU-FIRE	12.00	660.00
55 GEOCHEM SAMPLE PREP	2.50	137.50
* TOTAL		797.50

=====

THESE ARE PROFESSIONAL SERVICES AND ARE PAYABLE WHEN RENDERED.  
OVER 30 DAYS 2% INTEREST PER MONTH WILL BE CHARGED.

# INVOICE

MIN-EN LABORATORIES LTD.  
705 WEST 15TH STREET  
NORTH VANCOUVER, B.C.  
CANADA V7M 1T2

INVOICE No 3512B

DATE: FEB 6/87

PHONE: (604) 980-5814 OR 988-4524  
TELEX: 04-352828

=====

TO : DURHAM GEOLOGICAL SERVICES  
BOX 734.  
TIMMINS, ONT.

FILE No: 72-095  
PROJECT: ~~8~~ CREAM SILVER  
GARRISON TWP.

ATTENTION B. DURHAM/R. MAASS

=====

QTY	DESCRIPTION	UNIT PRICE	AMOUNT
28	GEOCHEM - MD AS AU-FIRE	12.00	336.00
28	GEOCHEM SAMPLE PREP	2.50	70.00
	* TOTAL		406.00

=====

THESE ARE PROFESSIONAL SERVICES AND ARE PAYABLE WHEN RENDERED.  
OVER 30 DAYS 2% INTEREST PER MONTH WILL BE CHARGED.

Northern Development and Mines

TYPE OF WORK  
(Geophysical, Geological, Geochemical and Expenditures)

DOCUMENT No.  
**WB808-305**

Instructions: - Please type or print.  
- If number of mining claims traversed exceeds space on this form, attach a list.  
Note: - Only days credits calculated in the "Expenditures" section may be entered in the "Expend. Days Cr." column.  
- Do not use shaded areas below.

Type of Survey(s) **Geochemical Analysis** Mining Act

Claim Holder(s) **H. L. Mineral Holdings Ltd.** Township or Area **Garrison**

Address **1900-999 West Hastings Street, Vancouver, B.C. V6C 2W2** Precinct or License No. **T-4645**

Survey Company **Min En Labs** Date of Survey (from & to) \_\_\_\_\_ Total Miles of line Cut \_\_\_\_\_

Name and Address of Author (for Geo-Technical report) \_\_\_\_\_ Day | Mo. | Yr. | Day | Mo. | Yr.

Credits Requested per Each Claim in Columns at right

Special Provisions	Geophysical	Days per Claim
For first survey: Enter 40 days. (This includes line cutting)	• Electromagnetic	
	• Magnetometer	
	• Radiometric	
	• Other	
For each additional survey: using the same grid: Enter 20 days (for each)	Geological	
	Geochemical	
Man Days Complete reverse side and enter total(s) here	Geophysical	Days per Claim
	• Electromagnetic	
	• Magnetometer	
	• Radiometric	
	• Other	
	Geological	
	Geochemical	
Airborne Credits Note: Special provisions credits do not apply to Airborne Surveys.	Electromagnetic	Days per Claim
	Magnetometer	
	Radiometric	

Mining Claims Traversed (List in numerical sequence)

Mining Claim	Expend. Days Cr.	Mining Claim	Expend. Days Cr.
Prefix	Number	Prefix	Number
L	789803		
	789802		
*	789804		
	789807		

ONTARIO GEOLOGICAL SURVEY ASSESSMENT FILES OFFICE  
NOV 10 1988

RECEIVED JUN 30 1988

RECORDED JUN 30 1988

RECEIVED JUL 5 1988

Expenditures (excludes power stripping)

Type of Work Performed **Assaying Drill Core**

Performed on Claim(s) **L 1029092** *Section 77-19*

Calculation of Expenditure Days Credits

Total Expenditures **\$ 2100.00** + **16** = **140** Total Days Credits

Instructions: Total Days Credits may be apportioned at the claim holder's choice. Enter number of days credits per claim selected in columns at right.

*\*Major portion credits allowed*

Total number of mining claims covered by this report of work. **4**

Date **June 22/88** Recorded Holder or Agent (Signature) **Randy Maass**

For Office Use Only

Total Days Cr. Days Recorded **120** Mining Recorder **Blair White**

Date Approved as Recorded **2 Nov 88** Branch Director **W. Lloyd**

Certification Verifying Report of Work

I hereby certify that I have a personal and intimate knowledge of the facts set forth in the Report of Work annexed hereto, having performed the work or witnessed same during and/or after its completion and the annexed report is true.

Name and Postal Address of Person Certifying **Randy Maass, c/o Durham Geological Services Inc.**

Box 734, Timmins, Ontario P4N 7G2

Date Certified **June 22/88** Certified by (Signature) **Randy Maass**





Ministry of Northern Development and Mines

Report of Work (Geophysical, Geological, Geochemical and Expenditures)

DOCUMENT No. W8808-354 Mining Act

Instructions: - Please type or print. - If number of mining claims traversed exceeds space on this form, attach a list. Note: - Only days credits calculated in the "Expenditures" section may be entered in the "Expend. Days Cr." columns. - Do not use shaded areas below.

Form header containing: Type of Survey(s) Credit From Assaying Drill Core, Claim Holder(s) H. L. Mineral Holdings Limited, Address 1900-999 West Hastings Street, Vancouver, B.C. V6C 2W2, Survey Company, Date of Survey, Total Miles of Line Cut, Name and Address of Author.

Credits Requested per Each Claim in Columns at right

Table with columns for Special Provisions, Man Days, Airborne Credits, and various survey types (Geophysical, Geological, Geochemical) with Days per Claim.

Mining Claims Traversed (List in numerical sequence)

Table with columns for Mining Claim Prefix, Number, Expend. Days Cr., and a second set of columns for Mining Claim Prefix, Number, Expend. Days Cr. Includes handwritten entry: L 792681 20.

Expenditures (excludes power stripping)

Form for Expenditures: Type of Work Performed Credit from Assaying Drill Core, Performed on Claim(s) L 1029092

Calculation of Expenditure Days Credits: Total Expenditures \$ + 15 = Total Days Credits

Instructions: Total Days Credits may be apportioned at the claim holder's choice. Enter number of days credits per claim selected in columns at right.

For Office Use Only

Form for Office Use Only: Total Days Cr. Recorded 20, Date Recorded Aug 8, 1988, Date Approved as Recorded Nov 88, Mining Recorder M.G. Williams, Branch District

Date Aug. 5/88, Recorded Holder or Agent (Signature) Randy Moore

Certification Verifying Report of Work

I hereby certify that I have a personal and intimate knowledge of the facts set forth in the Report of Work annexed hereto, having performed the work or witnessed same during and/or after its completion and the annexed report is true.

Name and Postal Address of Person Certifying: Randy D. Moore c/o Arthur Geological Services Inc.



DOCUMENT No. W8808.053/88 Mining Act

Instructions - Supply required data on a separate form for each type of work to be recorded (see table below). - For Geo-technical work use form no. 1362 "Report of Work (Geological, Geophysical, Geochemical and Expenditures)".

AMENDED

Name and Postal Address of Recorded Holder: L. Mineral Holdings Ltd., Lanny Anderson. Suite 1900, 999 West Hastings Street, Vancouver, B.C. V6C 2W2. 660 Suzanne Street, Timmins, Ontario. Prospector's Licence No. T-4645, M-24086

Summary of Work Performance and Distribution of Credits

Table with columns: Total Work Days Cr. claimed (2040), Mining Claim (Prefix, Number), Work Days Cr., Mining Claim (Prefix, Number), Work Days Cr., Mining Claim (Prefix, Number), Work Days Cr. Includes checkboxes for Manual Work, Shaft Sinking, etc.

All the work was performed on Mining Claim(s): L 1029092

Required Information eg: type of equipment, Names, Addresses, etc. (See Table Below)

Table with columns: Drilling Company (Norex Drilling, Porcupine, Ontario), Drill Hole # (MRG-87-1, MRG-87-2), Footage (987.0', 1201.5'). Includes dates of diamond drilling (December 8-31, 1987) and total footage (2188.5').

RECORDED FEB 26 1988 Receipt #

CARDER LAKE MINING DIV. FEB 26 1988

Date of Report: Feb. 24/88. Recorded Holder or Agent (Signature): Bruce Durham

Certification Verifying Report of Work

I hereby certify that I have a personal and intimate knowledge of the facts set forth in the Report of Work annexed hereto, having performed the work or witnessed same during and/or after its completion and the annexed report is true.

Name and Postal Address of Person Certifying: Bruce Durham, P.O. Box 734, Timmins, Ontario P4N 7G2

Date Certified: Feb. 24/88. Certified by (Signature): Bruce Durham

Table of Information/Attachments Required by the Mining Recorder

Table with columns: Type of Work, Specific information per type, Other information (Common to 2 or more types), Attachments. Rows include Manual Work, Shaft Sinking, Compressed air, Power Stripping, Diamond or other Core drilling.



35546

207

207

07860-041

07860-041

31

MIN-EN LABORATORIES LTD.

705 W. 15th St.

North Vancouver, B.C.

Phone: 980-5814

MR 88 18

*deposit only*

MR 88 18

0 1 2 3 4 5 6 7 8 9

RECEIVED  
VANCOUVER  
BANK OF MONTREAL

INVOICE

MIN-EN LABORATORIES LTD.  
705 WEST 15TH STREET  
NORTH VANCOUVER, B.C.  
CANADA V7M 1T2

INVOICE No 7452C

DATE: JAN 15/88

PHONE: (604) 980-5814 OR 988-4524  
TELEX: 04-352828

TO : DURHAM GEOLOGICAL SERVICES  
BOX 734,  
TIMMINS, ONT.  
P4N 7G2

FILE No: 82-34  
PROJECT: D-42

ATTENTION R. MAASS

QTY DESCRIPTION	UNIT PRICE	AMOUNT
25 ROCK GEOCHEM - AU FIRE	6.75	168.75
25 ROCK SAMPLE PREP	3.00	75.00
	* SUBTOTAL	243.75
2 PAGES SENT BY FAX	.50	1.00
LONG DISTANCE CALL		7.50
	* TOTAL	252.25

THESE ARE PROFESSIONAL SERVICES AND ARE PAYABLE WHEN RENDERED.  
OVER 30 DAYS 2% INTEREST PER MONTH WILL BE CHARGED.

**DURHAM GEOLOGICAL SERVICES INC.**  
 1176 DELNITE ROAD, P.O. BOX 734  
 TIMMINS, ONTARIO P4N 7G2

REFERENCE
INV. 7438 C, 7464 C,
7466 C, 7535 C, 7480 C,
→ 7519 C

2010

PAY one thousand one hundred and seven 25/100 DOLLARS

DATE	CHEQUE NUMBER	TO THE ORDER OF	DESCRIPTION	CHEQUE AMOUNT
Feb 18 2010		Min En Laboratoire		1107.25

705 West 15th Street  
 Vancouver, B.C. V7M 1T2

DURHAM GEOLOGICAL SERVICES INC.

PER *Bruce Hunter*

CONTINENTAL BANK OF CANADA  
 190 Third Avenue, Timmins, Ontario P4N 1C3

⑈002010⑈ ⑆66542⑈026⑆ 300-417⑈ ⑈0000110725⑈  
 104-105

H.L. MINERAL HOLDINGS \$ 1107.25  
 PORTION OF CHEQUE

- (INVOICES)
- 7438C
  - 7464C
  - 7466C
  - 7535C
  - 7480C
  - 7519C

35545

208  
MONTREAL  
JULY 18 1968  
0:30 U.S.

31

SECRET

MIN-EN LABORATORIES LTD.  
705 W. 15th St.  
North Vancouver, B.C.  
Phone: 980-5814

MR. 18

*Depart only*



SECRET

INVOICE

INVOICE No 7438C

DATE: JAN 14/88

RIES LTD.  
TH STREET  
EDMONTON, B.C.  
CANADA V7M 1T2

PHONE: (604) 980-5814 OR 980-4524  
TELEX: 04-352828

TO : DURHAM GEOLOGICAL SERVICES  
BOX 734,  
TIMMINS, ONT.  
P4N 7G2

FILE No: B2-27  
PROJECT: D-42

ATTENTION R. MAASS

QTY	DESCRIPTION	UNIT PRICE	AMOUNT
13	ROCK GEOCHEM - AU FIRE	6.75	87.75
1	ASSAY - AU	8.00	8.00
13	ROCK SAMPLE PREP	3.00	39.00
		* SUBTOTAL	134.75
6	PAGES FAXED	.50	3.00
	LONG DISTANCE CALL		7.50
		* TOTAL	145.25

THESE ARE PROFESSIONAL SERVICES AND ARE PAYABLE WHEN RENDERED.  
OVER 30 DAYS 2% INTEREST PER MONTH WILL BE CHARGED.



INVOICE

INVOICE No 7464C

DATE: JAN 18/88

ORATORIES LTD.  
15TH STREET  
VANCOUVER, B.C.  
CANADA V7M 1T2

PHONE: (604) 980-5814 OR 988-4524

TELEX: 04-352828

DURHAM GEOLOGICAL SERVICES  
BOX 734,  
TIMMINGS, ONT.  
P4N 7G2

FILE No: B2-040  
PROJECT: D-42

ATTENTION R. MAASS

QTY	DESCRIPTION	UNIT PRICE	AMOUNT
9	ROCK GEOCHEM - AU FIRE	6.75	60.75
9	ROCK SAMPLE PREP	3.00	27.00
* SUBTOTAL			87.75
3	PAGES FAXED (FILE B2-040 & B2-037)	.50	1.50
	LONG DISTANCE CALL		7.50
<b>TOTAL</b>			<b>96.75</b>

THESE ARE PROFESSIONAL SERVICES AND ARE PAYABLE WHEN RENDERED.  
OVER 30 DAYS 2% INTEREST PER MONTH WILL BE CHARGED.

INVOICE

LABORATORIES LTD.  
15TH STREET  
VANCOUVER, B.C.  
CANADA V7M 1T2

INVOICE No 7466C

DATE: JAN 18/88

PHONE: (604) 980-5814 OR 988-4524  
TELEX: 04-352828

TO : DURHAM GEOLOGICAL SERVICES  
BOX 734,  
TIMMINS, ONT.  
P4N 7G2

FILE No: B2-0042  
PROJECT: D-42

ATTENTION R. MAASS

QTY DESCRIPTION	UNIT PRICE	AMOUNT
22 ROCK GEOCHEM - AU FIRE	6.75	148.50
22 ROCK SAMPLE PREP	3.00	66.00
* SUBTOTAL		214.50
2 PAGES FAXED	.50	1.00
LONG DISTANCE CALL		7.50
<b>* TOTAL</b>		<b>223.00</b>

THESE ARE PROFESSIONAL SERVICES AND ARE PAYABLE WHEN RENDERED.  
OVER 30 DAYS 2% INTEREST PER MONTH WILL BE CHARGED.

INVOICE

INVOICE No 7535C

DATE: JAN 24/88

LABORATORIES LTD.  
1515 WEST 15TH STREET  
VANCOUVER, B.C.  
CANADA V7M 1T2

PHONE: (604) 980-5814 OR 988-4524  
TELEX: 04-352828

TO : DURHAM GEOLOGICAL SERVICES  
BOX 734,  
TIMMINS, ONT.  
P4N 7B2

FILE No: 82-85  
PROJECT: D-42

ATTENTION R. MAASS

QTY DESCRIPTION	UNIT PRICE	AMOUNT
21 ROCK GEOCHEM - AU FIRE	6.75	141.75
21 ROCK SAMPLE PREP	3.00	63.00
* TOTAL		204.75

THESE ARE PROFESSIONAL SERVICES AND ARE PAYABLE WHEN RENDERED.  
OVER 30 DAYS 2% INTEREST PER MONTH WILL BE CHARGED.

# INVOICE

LABORATORIES LTD.  
WEST 15TH STREET  
NORTH VANCOUVER, B.C.  
CANADA V7M 1T2

INVOICE No 7480C

DATE: JAN 18/88

PHONE: (604) 980-5814 OR 988-4524  
TELEX: 04-352828

DURHAM GEOLOGICAL SERVICES  
BOX 734,  
TIMMINS, ONT.  
P4N 7G2

FILE No: 82-056  
PROJECT: D-42

ATTENTION R. MAASS

QTY	DESCRIPTION	UNIT PRICE	AMOUNT
19	ROCK GEOCHEM - AU FIRE	6.75	128.25
19	ROCK SAMPLE PREP	3.00	57.00
		* SUBTOTAL	185.25
2	PAGES FAXED	.50	1.00
	LONG DISTANCE CALL		7.50
			<b>TOTAL 193.75</b>

THESE ARE PROFESSIONAL SERVICES AND ARE PAYABLE WHEN RENDERED.  
OVER 30 DAYS 2% INTEREST PER MONTH WILL BE CHARGED.

INVOICE

MIN-EN LABORATORIES LTD.  
705 WEST 15TH STREET  
NORTH VANCOUVER, B.C.  
CANADA V7M 1T2

INVOICE No 7519C

DATE: JAN 22/88

PHONE: (604)980-5814 DR 980-4524  
TELEX: 04-352828

TO : DURHAM GEOLOGICAL SERVICES  
BOX 734,  
TIMMINS, ONT.  
P4N 7G2

FILE No: 82-74  
PROJECT: D-42

ATTENTION R. MAASS

QTY	DESCRIPTION	UNIT PRICE	AMOUNT
25	ROCK GEOCHEM - AU FIRE	6.75	168.75
25	ROCK SAMPLE PREP	3.00	75.00
* TOTAL			243.75

THESE ARE PROFESSIONAL SERVICES AND ARE PAYABLE WHEN RENDERED.  
OVER 30 DAYS 2% INTEREST PER MONTH WILL BE CHARGED.

**DURHAM GEOLOGICAL SERVICES INC.**  
 1176 DELNITE ROAD, P.O. BOX 734  
 TIMMINS, ONTARIO P4N 7G2

REFERENCE
INV 7409C, 7539C,
7518C, 7436C,

2011

PAY one thousand one hundred ninety-nine 50/100 DOLLARS

DATE	CHEQUE NUMBER	TO THE ORDER OF	DESCRIPTION	CHEQUE AMOUNT
Feb 18/11	2011	Mim En Laboratories		1199.50

705 West 15th Street  
 Vancouver BC V7M1T2

DURHAM GEOLOGICAL SERVICES INC.

PER Bruce [Signature]

CONTINENTAL BANK OF CANADA  
 190 Third Avenue, Timmins, Ontario P4N 1C3

⑈00201⑈ ⑈66542⑈026⑈ ~~300669~~ 104105 ⑈0000119950⑈

H.L. MINERAL HOLDINGS  
 PORTION OF CHEQUE (INVOICES)  
 7409C  
 7539C  
 7436C \$ 748.75

3 5 5 4 4

2071 208  
2 MONTREAL  
JUN 23 1988  
07890-036

3 1

MIN-EN LABORATORIES LTD.  
705 W. 15th St.  
North Vancouver, B.C.  
Phone: 980-5814

MR. 88 18

*Robert Kelly*

MR. 88

2 10

# INVOICE

LABORATORIES LTD.  
15TH STREET  
VANCOUVER, B.C.  
CANADA V7M 1T2

INVOICE No 7409C

DATE: JAN 13/88

PHONE: (604) 980-5814 OR 988-4524  
TELEX: 04-352828

TO : DURHAM GEOLOGICAL SERVICES  
BOX 734,  
TIMMINS, ONT.  
P4N 7G2

FILE No: 82-18  
PROJECT: D-42

ATTENTION R. MAASS

QTY DESCRIPTION	UNIT PRICE	AMOUNT
22 ROCK GEOCHEM - AU FIRE	6.75	148.50
3 ASSAYS - AU	8.00	24.00
22 ROCK SAMPLE PREP	3.00	66.00
	* SUBTOTAL	238.50
2 PAGES SENT BY FAX LONG DISTANCE CALL	.50	1.00
		7.50
	* TOTAL	247.00

THESE ARE PROFESSIONAL SERVICES AND ARE PAYABLE WHEN RENDERED.  
OVER 30 DAYS 2% INTEREST PER MONTH WILL BE CHARGED.



INVOICE

LABORATORIES LTD.  
15TH STREET  
VANCOUVER, B.C.  
CANADA V7M 1T2

INVOICE No 7539C

DATE: JAN 24/88

PHONE: (604) 980-5814 DR 988-4524  
TELEX: 04-352828

: DURHAM GEOLOGICAL SERVICES  
BOX 734,  
TIMMINS, ONT.  
P4N 7G2

FILE No: 82-96  
PROJECT: D-42

ATTENTION: R. MAASS

QTY DESCRIPTION

18 ROCK GEDCHEM - AU FIRE  
18 ROCK SAMPLE PREP

UNIT PRICE	AMOUNT
6.75	121.50
3.00	54.00

\* TOTAL 175.50

WE ARE PROFESSIONAL SERVICES AND ARE PAYABLE WHEN RENDERED.  
A 30 DAYS 2% INTEREST PER MONTH WILL BE CHARGED.

INVOICE

RIES LTD.  
H STREET  
DOUVER, B.C.  
ADA V7M 1T2

INVOICE No 7436C

DATE: JAN 14/88

TEL: (604) 980-5814 OR 988-4524  
TELEX: 04-352828

TO : DURHAM GEOLOGICAL SERVICES  
BOX 734,  
TIMMINS, ONT.  
CAN 7G2

FILE No: 82-19  
PROJECT: D-42

ATTENTION R. MAASS

QTY	DESCRIPTION	UNIT PRICE	AMOUNT
31	ROCK GEOCHEM - AU FIRE	6.75	209.25
3	ASSAYS - AU	8.00	24.00
31	ROCK SAMPLE PREP	3.00	93.00
* TOTAL			326.25

THESE ARE PROFESSIONAL SERVICES AND ARE PAYABLE WHEN RENDERED.  
OVER 30 DAYS 2% INTEREST PER MONTH WILL BE CHARGED.

M.R.D. - MINING RIGHTS ONLY  
S.R.O. - SURFACE RIGHTS ONLY  
M+S. - MINING AND SURFACE RIGHTS

Description Order No. Date Disposition File  
Sec. 35/63.0/90 NW 63/63 2/2/83 SA 5 M P

Apply under Public Lands Act - Proposed  
hydro line

ABITIBI INDIAN RESERVE No. 70

RAND TOWNSHIP

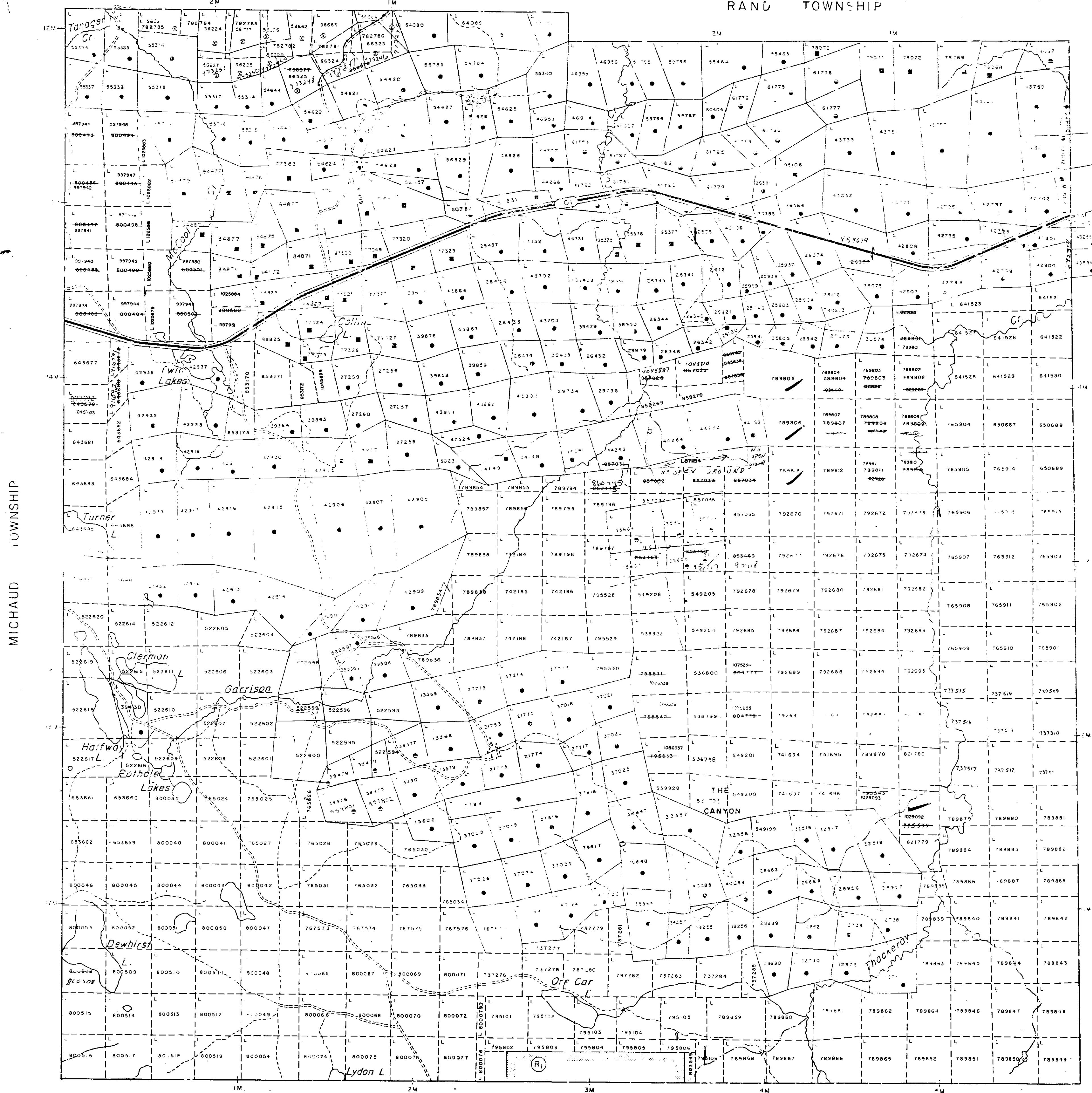

MICHAUD TOWNSHIP

HARKER TOWNSHIP

THACKERAY TOWNSHIP

LEGEND

- HIGHWAY AND ROUTES
- OTHER ROADS
- TRAILS
- SURVEYED LINES
- TOWNSHIP, BASE LINES ETC.
- LOTS, MINING CLAIMS, PARCELS ETC.
- UNSURVEYED LINES
- LOT LINES
- PARCEL BOUNDARY
- MINING CLAIMS ETC.
- RAILWAY AND RIGHT OF WAY
- UTILITY LINES
- NON PERENNIAL STREAM
- FLOODING OR FLOODING RIGHTS
- SUBDIVISION OR COMPOSITE PLAN
- RESERVATIONS
- ORIGINAL SHORELINE
- MARSH OR MUSKIES
- MINES
- TRAVERSE MONUMENT

DISPOSITION OF DOCUMENT

- TYPE OF DOCUMENT
- PATENT, SURFACE & MINING RIGHTS
  - SURFACE RIGHTS ONLY
  - MINING RIGHTS ONLY
  - LEASE, SURFACE & MINING RIGHTS
  - SURFACE RIGHTS ONLY
  - MINING RIGHTS ONLY
  - LICENCE OF OCCUPANCY
  - ORDER IN COUNCIL
  - RESERVATION
  - CANCELLED
  - SAND & GRAVEL

NOTE: MINING RIGHTS IN PARCELS PATENTED PRIOR TO MAY 6, 1913, VESTED IN ORIGINAL PATENTEE BY THE PUBLIC LANDS ACT, R.S.C. 1910, CHAP. 11, SEC. 63, SUBSEC. 1.

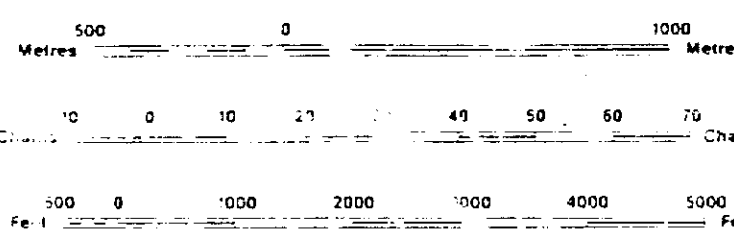

SCALE 1:20 000

Application for S.R.O. under public Lands Act.

DATE OF ISSUE

SEP 9 1988

LARDER LAKE  
MINING RECORDERS' OFFICE

TOWNSHIP  
**GARRISON**

M.N.R. ADMINISTRATIVE DISTRICT  
KIRKLAND LAKE  
MINING DIVISION  
LARDER LAKE  
LAND TITLES / REGISTRY DIVISION  
COCHRANE

Ministry of Natural Resources Ontario  
Ministry of Northern Development and Mines

Date SEPTEMBER 1988

Number G-3638

